

NOTE:
 LOCATION - HOWARD COUNTY NEAR COLUMBIA, MARYLAND, 5th ELECTION DISTRICT, TAX AND ZONING MAP NO. 100, SUBDIVISION, AREA 1, APPROXIMATELY 4.23 ACRES (184,875 SQ. FT.) 3-STORY MEDICAL OFFICE BLDG. APPROX. 45,000 SQ. FT. PARKING FOR MEDICAL OFFICE BLDG. 180 CARS (10' x 20' STALL) HOSPITAL PROPERTY ZONED R-40 and New Town MEDICAL OFFICE PROPERTY ZONED B-1 and New Town Zoning Case ZB # 691

APPROVED: FOR PUBLIC WATER AND PUBLIC SEWERAGE SYSTEMS, HOWARD COUNTY HEALTH DEPARTMENT	<i>Joyce M. Bough</i> 4-28-77 COUNTY HEALTH OFFICER DATE
APPROVED: HOWARD COUNTY OFFICE OF PLANNING AND ZONING	<i>Thomas J. Annis</i> 5-3-77 PLANNING OFFICER DATE
APPROVED: FOR PUBLIC WATER AND PUBLIC SEWERAGE, STORM DRAINAGE SYSTEMS AND PUBLIC ROADS, HOWARD COUNTY DEPARTMENT OF PUBLIC WORKS	<i>W. J. Regan</i> 4-26-77 DIRECTOR DATE
APPROVED: FOR PUBLIC WATER AND PUBLIC SEWERAGE, STORM DRAINAGE SYSTEMS AND PUBLIC ROADS, HOWARD COUNTY DEPARTMENT OF PUBLIC WORKS	<i>W. J. Regan</i> 4-26-77 CHIEF, BUREAU OF HIGHWAYS DATE
SHEET	TITLE
1	LOCATION PLAN
2	SITE GRADING PLAN
3	SEDIMENT CONTROL PLAN
4	STORM DRAIN PROFILES
5	WATER + SEWER PLAN

'PURPOSE STATEMENT'
 THE PURPOSE OF THIS REVISED SITE DEVELOPMENT PLAN IS TO PROVIDE A SPATIALLY ALIGNED, RIGHTING ACCESS DRIVE TO CONNECT WITH ACCESS ROAD ON PARCEL A, 11045 LITTLE PATUXENT PARKWAY.

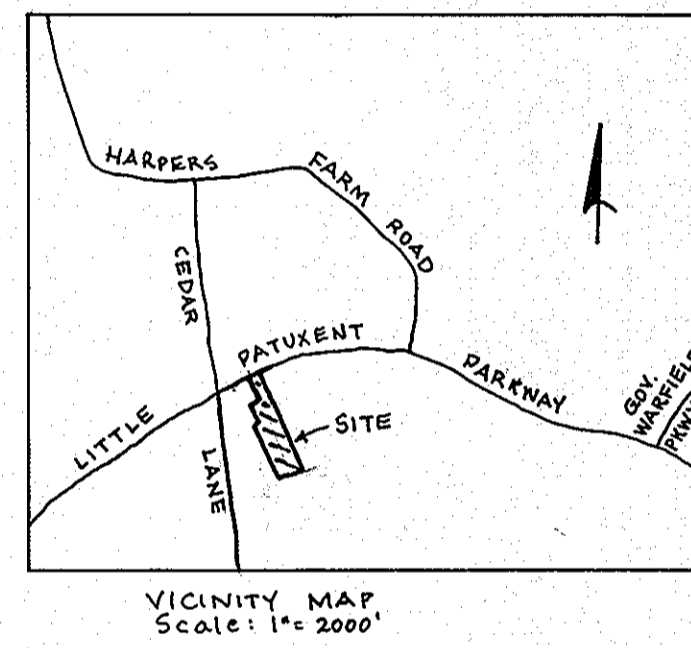

APPROVED
 DIVISION OF LAND DEVELOPMENT
 HOWARD COUNTY, MARYLAND
 DATE 3-7-77
JMM

APPLICANT:
 HOWARD COUNTY GENERAL HOSPITAL, INC.
 ATTN: VICTOR BROCKGOLD, PRESIDENT
 5735 CEDAR LANE
 COLUMBIA, MD 21044
 PHONE: 410-740-7912

OWNER:
 Howard County General Hospital, Inc.
 Little Patuxent Parkway
 Columbia, Maryland 21044

Total Emp. - 50
 Total Retail - 1400 S.F.

25-17-10	REVISION PLAN TO ADD ACCESS DRIVE, SEE PURPOSE STATEMENT	
3-23-77	TRUSS. REV.	
2-7-77	REV./HWD. CHY. LETTER DATED 1-27-77	
1-24-77		
Rev Date	Rev No.	Revision Description
RICHARD P. BROWNE ASSOCIATES ENGINEERS SURVEYORS PLANNERS ARCHITECTS PEACHTREE CITY, GEORGIA COLUMBIA, MD. WAYNE, N. J.		



LOCATION PLAN MEDICAL OFFICE BUILDING RECORDING #3648 HOWARD CO. GENERAL HOSPITAL TOWN CENTER, SEC. B, AREA 2, LOT 3		
Des. By	Scale 1" = 50'	Dwg. No. 1 of 6
Drn. By MAS	Date 9-30-76	Proj. No. 4090
Chk. By	Approved	

STORAGE LANE NOTE:
 1. PAVEMENT TO BE AS SHOWN ON HOWARD COUNTY ROAD CONSTRUCTION AND STANDARD SPECIFICATION DRAWING # D-3 DATED MAY 1, 1962. CURBS TO BE TYPICAL COMBINATION CURB AND GUTTER AS SHOWN ON DRAWING D-4-6 DATED MAY 1962.
 2. PARKING AREA PAVEMENT TO BE AS SHOWN ON DRAWING # P-11 DATED MAY 1962. CURBS MAY BE 7" BARRIOR AS SHOWN ON # P-10 DATED MAY 1962.

Howard Research and Development Corp.
 516/752
 R-40

F. Denis Light
 F. Denis Light #7617

NOTES :

1. Parking Lights to be Crouse Hinds Sodium Vapor mounted on 35' Aluminum poles directed as shown w/ 250 watt, 25,000 Lumin Luminaries.

LEGEND

- XTC 461.37 SPOT ELEV. T.C. = TOP OF CURB
- 466 EXISTING CONTOUR
- 466 NEW CONTOUR
- SS SANITARY SEWER
- ST STORM SEWER
- E ELECTRICAL (UNDERGROUND)
- T TELEPHONE (UNDERGROUND)
- W WATER

NOTES

SURVEY INFO FROM:
 RICHARD P. BROWNE ASSOCIATES
 COLUMBIA, MARYLAND

PARKING REQUIRED 39 CARS
 PARKING PROVIDED 180 CARS
 PARKING STALL SIZE 10' X 20'

CONTRACT LIMIT LINES, ARE PROPERTY LINES UNLESS OTHERWISE INDICATED
 LANDSCAPING OUTSIDE PROPERTY LINES N.I.C.

SEE SHEET 1 FOR OVERALL SITE PLAN FOR UTILITIES CONNECTIONS

PROVIDE 1 WHEEL STOP FOR EVERY 2 PARKING STALLS WHERE CURBS ARE NOT SHOWN

TOTAL EMP - 50
 TOTAL RETAIL - 1400 S.F.

PURPOSE STATEMENT
 THE PURPOSE OF THIS REVISED SITE DEVELOPMENT PLAN IS TO ADD A SIDEWALK ALONG THE EXISTING ACCESS DRIVE TO CONNECT WITH ACCESS ROAD ON PARCEL 'A', TO BE LITTLE PATIENT PARKWAY.

APPROVED
 DIVISION OF LAND DEVELOPMENT

HOWARD COUNTY, MARYLAND
 DATE 3-7-77
 [Signature]

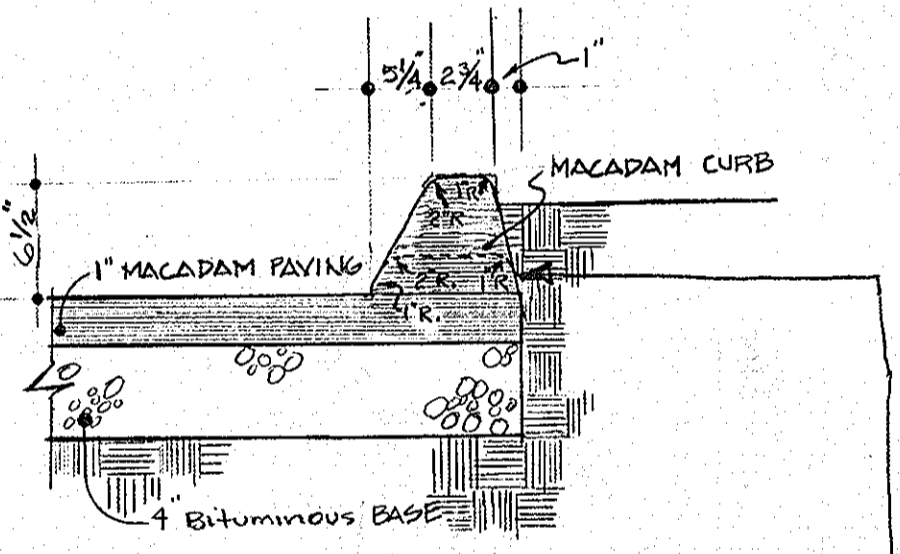
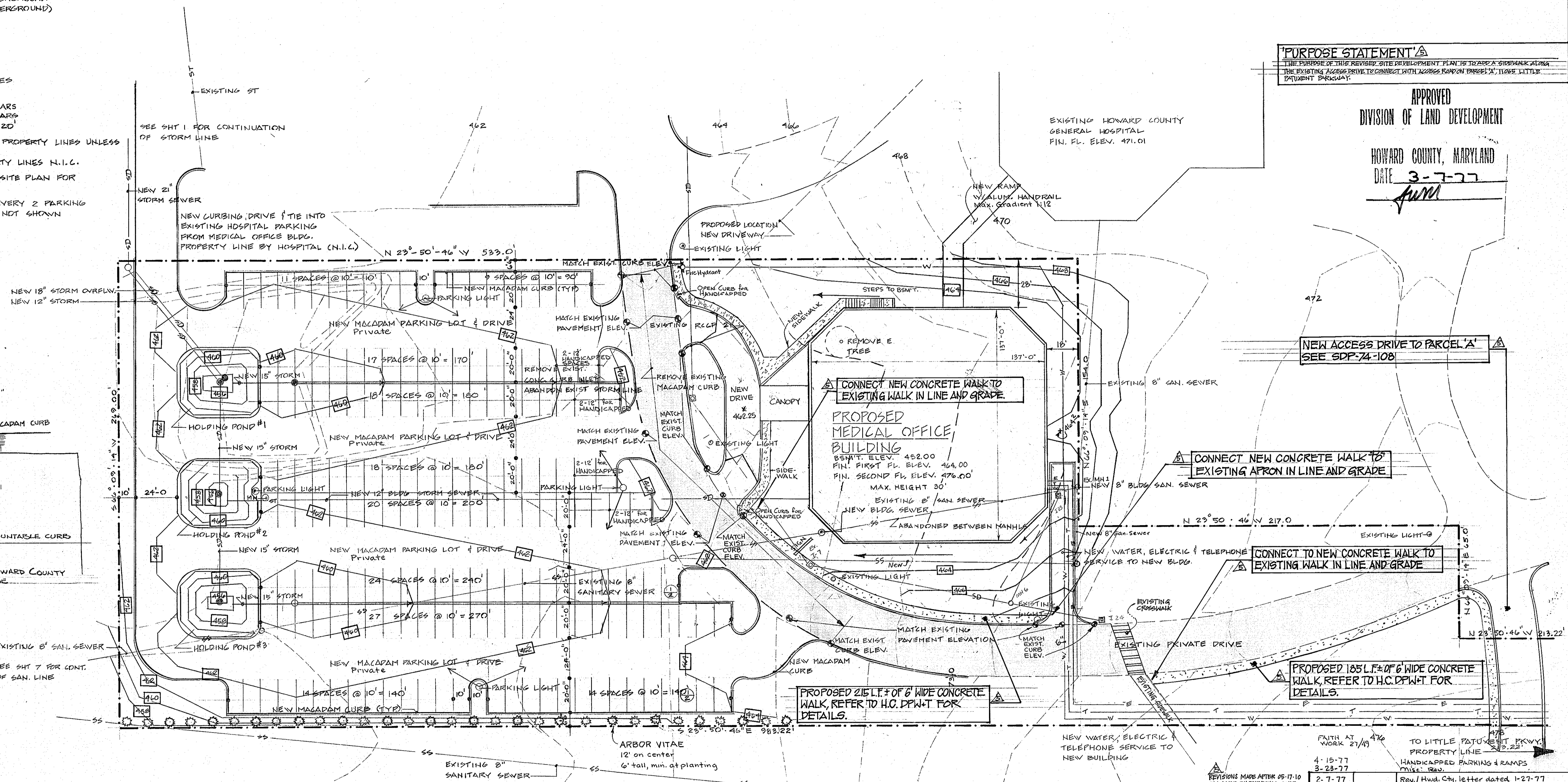

1 TRAVELWAY, PAVING & MOUNTABLE CURBS
 2 NOT TO SCALE

DRAWING D-39 PAGE 94 HOWARD COUNTY ROAD CONSTRUCTION CODE

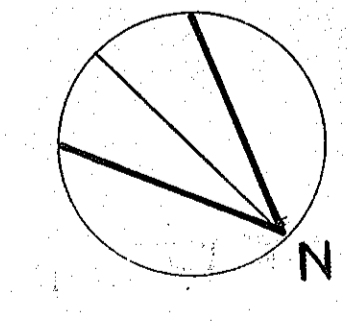

SITE PLAN
 SCALE 1" = 30'

APPROVED: FOR PUBLIC WATER AND PUBLIC SEWERAGE SYSTEMS, HOWARD COUNTY HEALTH DEPT.
 [Signature] 4-28-77
 HEALTH OFFICER DATE

APPROVED: HOWARD COUNTY OFFICE OF PLANNING & ZONING
 [Signature] 5-3-77
 PLANNING OFFICER DATE

APPROVED: FOR PUBLIC WATER, PUBLIC SEWERAGE, STORM DRAINAGE SYSTEMS AND PUBLIC ROADS, HOWARD CO. DEPT. OF PUBLIC WORKS.
 [Signature] 4-26-77
 DIRECTOR DATE

[Signature] 4/26/77
 CHIEF, BUREAU OF HIGHWAYS DATE

ELEVATION Scale: 1" = 30'

Parapit	Roof Elev. 488.00	2'
	Second Floor Elev. 476.00	12'
	First Floor Elev. 464.00	12'
	Basement Elev. 452.00	12'

NOTES: (Proposed Grading)

1. All construction shall be in accordance with Howard County Road Code and Standard Specifications.
2. Base will be primed in accordance with Sect. C-30-3 as provided in the Ho. Co. Road Construction Code and Standard Specifications.
3. Tack Coat is required in accordance with Sect. C-31-4 of the Ho. Co. Road Construction Code and Standard Specifications.
4. Storm Water management facilities will be maintained by the property owner, its successors, and assigns.

OWNER:
 Howard County General Hospital, Inc.
 Little Patuxent Parkway
 Columbia, Md. 21044

APPLICANT:
 HOWARD COUNTY GENERAL HOSPITAL, INC.
 ATTN: VICTOR BRACCALINO, PRESIDENT
 5755 STEPP LANE
 COLUMBIA, MD 21044
 PHONE: 410-740-7162

[Signature] F. Dennis Light #7617

REVISIONS MADE AFTER 05-17-10 BY JUDGE ENGINEERING CORP.

4-15-77	2-7-77	1-24-77
3-23-77		

FAITH AT WORK 2/1/79	TO LITTLE PATUXENT PKWY. PROPERTY LINE 2/22/79
4-15-77	HANDICAPPED PARKING & RAMPS
3-23-77	Misc. Rev.
2-7-77	Rev./Hwd. Cty. letter dated 1-27-77
1-24-77	

RICHARD P. BROWNE ASSOCIATES
 ENGINEERS SURVEYORS PLANNERS ARCHITECTS
 PEACHTREE CITY, GEORGIA
 COLUMBIA, MD. WAYNE, N. J.

5th Election Dist. Howard County, Md. Tax Map #35
SITE PLAN AND GRADING PLAN
 MEDICAL OFFICE BLDG. Recording # 3648
 HOWARD CO. GENERAL HOSPITAL
 TOWN CENTER SEC. B AREA 2 LOTS 3

Des. By	Scale 1" = 30'	Dwg. No.	2 of 6
Drn. By K.R.	Date 7-30-76	Proj. No.	
Chk. By	Approved		4090

LEGEND

- XTC 461.37 SPOT ELEV. T.C. + TOP OF CURB
- 466 EXISTING CONTOUR
- 470 NEW CONTOUR
- SS SANITARY SEWER
- ST STORM SEWER
- E ELECTRICAL (UNDERGROUND)
- T TELEPHONE (UNDERGROUND)
- W WATER

NOTES

SURVEY INFO FROM:
RICHARD P. BROWNE ASSOCIATES
COLUMBIA, MARYLAND

PARKING REQUIRED 29 CARS
PARKING PROVIDED 180 CARS
PARKING STALL SIZE 10' X 20'

CONTRACT LIMIT LINES ARE PROPERTY LINES UNLESS OTHERWISE INDICATED.

LANDSCAPING OUTSIDE PROPERTY LINES N.I.C.

SEE SHEET 1 FOR OVERALL SITE PLAN FOR UTILITY CONNECTIONS

PROVIDE 1 WHEEL STOP FOR EVERY 2 PARKING STALLS WHERE CURBS ARE NOT SHOWN

GENERAL NOTES

1. DIVERSION TERRACES (OR) FURROWS WILL BE UTILIZED TO REDUCE SLOPE LENGTHS WHERE POSSIBLE DURING LAND GRADING OPERATIONS.
2. PERMANENT VEGETATION WILL BE ESTABLISHED AS RAPIDLY AS POSSIBLE ON ALL EXPOSED FACES OF CUTS, AND FILLS AND OTHER AREAS FOLLOWING GRADING OPERATIONS.
3. TEMPORARY VEGETATION WILL BE APPLIED UPON COMPLETION ON ROUGH GRADING ON ALL OTHER DISTURBED AREAS WHERE SUCH AREAS WILL NOT BE BUILT ON WITHIN A PERIOD OF NINETY (90) DAYS.
4. STORM SEWER INLETS LOCATED BELOW HIGH SILT PRODUCING AREAS WILL BE PROTECTED BY THE USE OF APPROVED SILT TRAPS DURING CONSTRUCTION.

SEDIMENT & SOIL EROSION CONTROL

1. ALL SEDIMENT CONTROL MEASURES TO BE ADJUSTED TO MEET FIELD CONDITIONS AT TIME OF CONSTRUCTION AND BE CONSTRUCTION PRIOR TO ANY GRADING OR DISTURBANCE OF EXISTING SURFACE MATERIAL.
2. ALL SEDIMENT MEASURES SHALL BE UNDERTAKEN IN STRICT ACCORDANCE WITH THE APPROVED PLANS AND CRITERIA AND SPECIFICATIONS APPROVED BY THE HOWARD COUNTY SOIL CONSERVATION DISTRICT.
3. ALL SEEDING ON SEDIMENT CONTROL FACILITIES TO BE DONE IN ACCORDANCE WITH THE HO. CO. SOIL CONSERV. DISTRICT, SEE TEMP. SEEDING SPECS. ON THIS SHEET.
4. PERIODIC INSPEC. & MAINT. OF ALL SEDIMENT CONTROL STRUCT. MUST BE PROVIDED TO INSURE THE INTENDED PURPOSE IS ACCOMP.
5. CONTRACTOR INSTALLING THE ABOVE SHALL OBTAIN & FOLLOW THE STANDARDS & SPECS. FOR SOIL EROSION IN URBANIZING AREAS.
6. ALL SED. CNTRL. MEAS. ARE TO REMAIN IN PLACE UNTIL PERMISSION FOR THEIR REMOVAL HAS BEEN OBTAINED FROM THE HO. CO. SOIL CONSERVATION DISTRICT.
7. NOTIFY THE HO. CO. SOIL CONSERV. DIST. OFFICE PRIOR TO STARTING ANY WORK (465-5000 EXT. 378).
8. ON SITE INSPECTION AND MAINT. OF ALL SEDIMENT CNTRL. MEASURES INCLUDING CLEANOUT OF ALL SED. TRAPS & BEAMS AND PROPER ESTABLISHMENT OF ALL VEGETATION MEASURES WILL BE THE RESPONSIBILITY OF THE CONTRACTOR OR HIS REPRESENTATIVE ON THE SITE ON A CONT. DAY TO DAY BASIS.

MULCHING

1. MULCH MATERIALS SHOULD BE UNWEATHERED, UNCHOPPED SMALL GRAIN STRAW SPREAD AT THE RATE OF 1-1/2 TO 2 TONS PER ACRE.
2. SPREAD UNIFORMLY BY HAND OR MECHANICALLY SO THAT AT LEAST 75% OF THE SOIL SURFACE WILL BE COVERED. FOR UNIFORM DISTRIBUTION OF HAND SPREAD MULCH, DIVIDE AREA INTO APPROX. 1000 SQ. FT. SECTION AND PLACE ONE BALE APPROX. 100 LBS. OF MULCH FOR DISTRIBUTION WITHIN EACH SECTION APPROX. 65-100 LBS. BALE WILL BE REQUIRED.
3. MULCH TO BE ANCHORED WITH LIQUID BINDER AS SPECIFIED IN STANDARD SPECIFICATIONS FOR SOIL EROSION AND SEDIMENT CONTROL DATED JULY 1975.

TEMP. SEEDING SPECIFICATIONS

1. APPLY GROUND AGRIC. LIMESTONE AT THE RATE OF 2 TONS PER ACRE
2. APPLY A MINIMUM OF 500 LBS. PER ACRE OF 10-20-10 OR EQUIVALENT FERTILIZER
3. INCORPORATE BOTH LIME & FERTILIZER INTO THE TOP 3"-4" OF SURFACE SOIL BY DISKING OR OTHER SUITABLE MEANS.
4. SEED ONE OF THE FOLLOWING MIXTURES AT THE RATE SHOWN PER ACRE:
(AUGUST 1 TO NOVEMBER 1)
50 LBS. ITALIAN RYE GRASS OR
2 BU. RYE (SMALL GRAIN) OR
3 BU. WINTER OATS

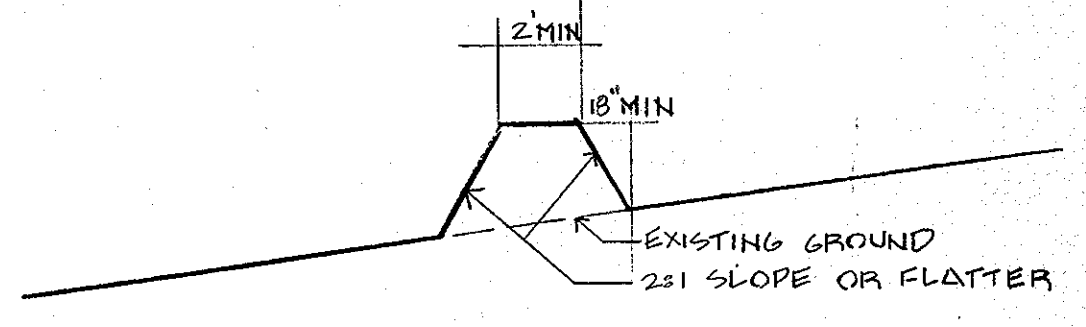

CROSS SECTION

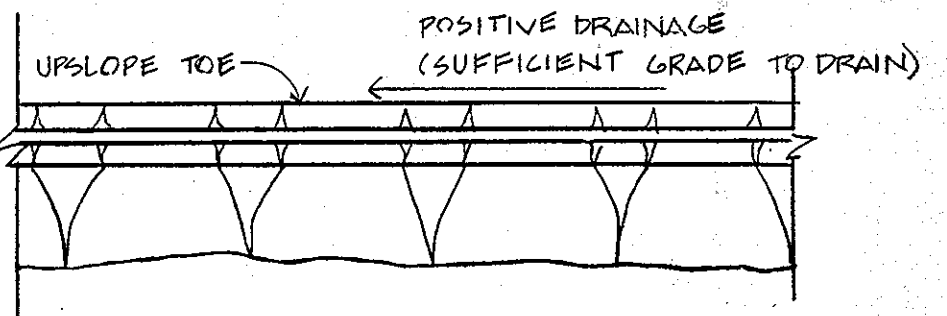

PERIMETER DIKE

2A NOT TO SCALE

CONSTRUCTION SEQUENCE

1. Install Sediment Control Facilities
2. Install Underground Utilities
3. Rough Grade Parking Lot
4. Clear and Excavate Parking Lot
5. Install Corbing
6. Install Paving
7. Backfill Building Site
8. Stabilize Disturbed Areas
9. Remove Sediment Control Facilities

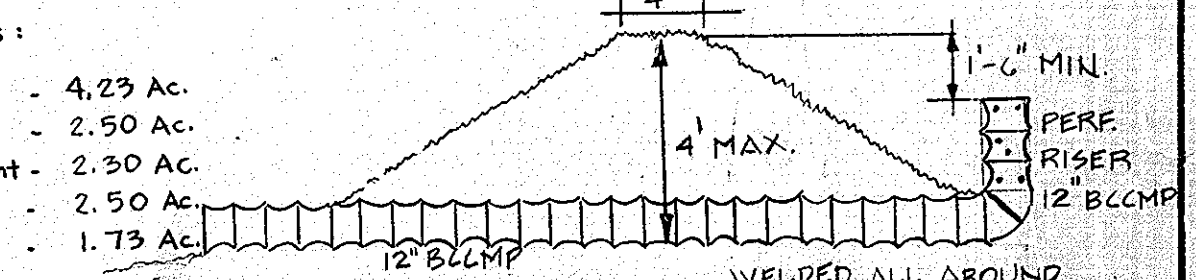
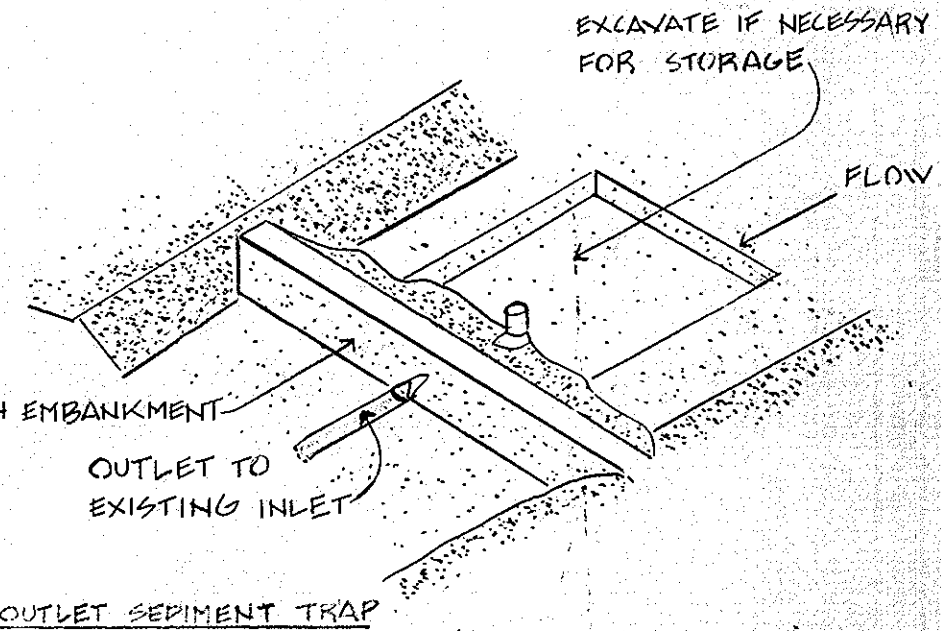

1A NO SCALE
NOTE: Wrap Riser in Polyfilter X

SITE ANALYSIS:

- Total Area - 4.23 Ac.
- Area Disturbed - 2.50 Ac.
- Area Roof + Pavement - 2.50 Ac.
- Area Stabilized - 2.50 Ac.
- Area Natural - 1.73 Ac.

THIS PLAN FOR SOIL EROSION & SEDIMENT CONTROL MEETS THE REQUIREMENTS OF THE HOWARD SOIL CONSERVATION DISTRICT.

APPROVED: Robert W. Zelman DATE 4-19-77
HOWARD SOIL CONSERVATION DISTRICT

SDP-77-32C
PLAN NUMBER

THIS PLAN HAS BEEN REVIEWED FOR THE HOWARD SOIL CONSERVATION DISTRICT & MEETS THE TECHNICAL REQUIREMENTS FOR SOIL EROSION & SEDIMENT CONTROL

APPROVED: Eric V. Korman DATE 4-19-77
U.S. SOIL CONSERVATION SERVICE

APPROVED: FOR PUBLIC WATER AND PUBLIC SEWERAGE SYSTEMS, HOWARD COUNTY HEALTH DEPT.

APPROVED: Joyce M. Boylous DATE 4-28-77
COUNTY HEALTH OFFICER

APPROVED: HOWARD COUNTY OFFICE OF PLANNING & ZONING

APPROVED: FOR PUBLIC WATER, PUBLIC SEWERAGE, STORM DRAINAGE SYSTEMS AND PUBLIC ROADS, HOWARD CO. DEPT. OF PUBLIC WORKS.

APPROVED: DATE 4-26-77

APPROVED: DATE 4-26-77



BY THE ENGINEER:
"I certify that this plan of Erosion and Sediment Control represents a practical and workable plan based on my personal knowledge of the site conditions and that it was prepared in accordance with the requirements of the Howard Soil Conservation District."
Signature of Engineer: Dennis Lipton
Date: 4-30-76

PERMANENT SEEDING SPECS.

1. BEFORE SEEDING APPLY THE FOLLOWING PER ACRE
2000 # GROUND AGRIC. LIMESTONE
1000 # 10-10-10 FERTILIZER
DISTRIBUTE INTO THE SOIL TO A DEPTH OF 2-3"
2. THEN SEED THE FOLLOWING MIXTURE AT THE RATE SHOWN PER ACRE:
50 LBS. KENTUCKY 31 TALL FESCUE
15 LBS. KOREAN LESPEDEZA
3. MULCH AS STATED UNDER MULCHING NOTES THIS SHEET.
4. SLOPES FLATTER THAN 3:1 IN LAWN
5. LIME & FERTILIZER AS ABOVE INCORPORATE AS ABOVE SEED TO 60# KENTUCKY BLUE GRASS AND 60# RED RESCUE. MULCH AS ABOVE.

PURPOSE STATEMENT
THE PURPOSE OF THIS REVISION SITE DEVELOPMENT PLAN IS TO ADD A SIDEWALK ALONG THE EXISTING ACCESS DRIVE TO COMPLY WITH ACCESS ROAD PARALLEL, 100'S LITTLE PATIENT PKWY.

OWNER'S CERTIFICATION FOR POND CONSTRUCTION

I CERTIFY THAT THE DEVELOPMENT & CONSTRUCTION FOR EROSION & SEDIMENT CONTROL WILL BE DONE ACCORDING TO THIS PLAN. I ALSO AUTHORIZE PERIODIC ON SITE EVALUATION BY THE HOWARD COUNTY SOIL CONSERVATION DISTRICT OR ITS AUTHORIZED AGENTS AS DEEMED NECESSARY. DEVIATION FROM THIS PLAN WILL NOT BE MADE UNLESS AUTHORIZED IN WRITING BY THE HOWARD SOIL CONSERVATION DISTRICT.
SIGNATURE: Robert W. Zelman
DATE: April 2, 1977

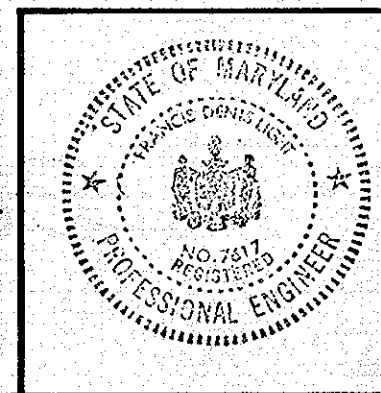

Rev. No.	Rev. No.	Revision Description
3-23-77		Rev. Hwd. Cty. letter dated 1-27-77
2-7-77		Rev. Hwd. Cty. letter dated 1-27-77
1-24-77		Rev. Hwd. Cty. letter dated 1-27-77
1-24-77		Rev. Hwd. Cty. letter dated 1-27-77

Des. By	Scale 1" = 30.0'	Dwg. No. 3 of 6
Drn. By K.R.	Date 4-30-76	Proj. No.
Chk. By	Approved	

* Previously 2.2 Acres at 0.86 impervious factor

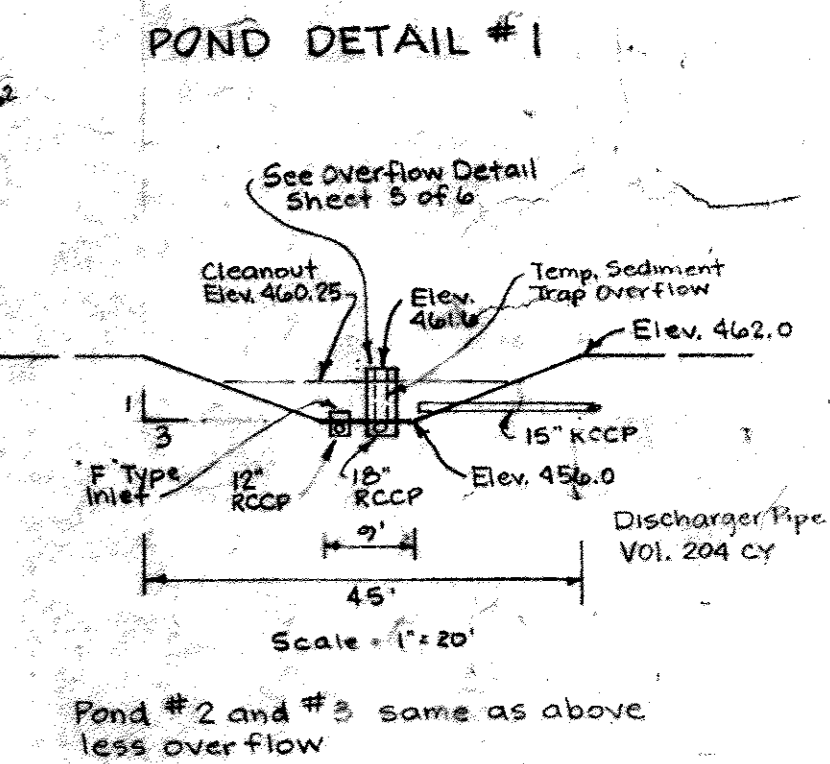

APPROVED
DIVISION OF LAND DEVELOPMENT
HOWARD COUNTY, MARYLAND
DATE 3-7-77
f Denis Light # 7617

- ELECTRICAL NOTES**
- ① DIRECT BURIAL CABLE 3\"/>
 - ② DIRECT BURIAL CABLE 2\"/>
 - ③ DIRECT BURIAL CABLE 3\"/>
 - ④ DIRECT BURIAL CABLE 2\"/>
 - ⑤ INCASD IN CONCRETE
- Note: Underground cable taken from design drawings if above ground features checked in field.

3-23-77	Misc Rev.
2-7-77	Revis Hwd City letter dated 1-27-77
1-24-77	
9-30-76	Resubmitted
5-20-76	Submitted for Final Approval
4-2-76	

Rev Date	Rev No.	Revision Description

RICHARD P. BROWNE ASSOCIATES
ENGINEERS SURVEYORS PLANNERS ARCHITECTS
PEACHTREE CITY, GEORGIA
COLUMBIA, MD. WAYNE, N. J.

DRAINAGE PLAN
TOWN CENTER SEC 8 AREA 2
MEDICAL OFFICE BUILDING
Recording # 8648
HOWARD COUNTY GENERAL HOSPITAL
5th Election District Tax Map 35

Des. By	Scale: 1" = 50'	Dwg. No. 4 of 6
Drn. By: AM, et.	Date: 3-16-77	Proj. No.
Chk. By	Approved	4070

APPROVED: For Public Water and Public Sewerage Systems, Howard County Health Department
County Health Officer *Joyce M. Jones* 4-28-77 Date

APPROVED: Howard County Office of Planning and Zoning
PLANNING DIRECTOR *William L. Harris* 5-31-77 Date
CHIEF DIVISION OF LAND DEVELOPMENT 4-11-77 Date

APPROVED: For Public Water, Public Sewerage, Storm Drainage systems and Public Roads, Howard County Department of Public Works
DIRECTOR *Robert M. McLeod* 4-26-77 Date
CHIEF BUREAU OF HIGHWAYS

STORM DRAINAGE STRUCTURE SCHEDULE

NO	TYPE	DWG #	PAGE #	INV.	IN	OUT	TOP ELEV.	REMARKS
MH3	Standard	D-103	15B	447.65	447.65	459.34		Storm Manhole
MH4	"	"	"	441.55	441.30	461.8		"
MH5	"	"	"	456.6	456.6	461.8		"
I-17	Type E	D-95	15B	456.5	456.5	459.5		Inlet
I-18	"	"	"	456.5	456.5	459.5		"
I-19	Type K	"	"	454.35	454.35	456.0		Inlet
I-20	Type K	"	"	453.90	453.90	456.0		"
I-21	Type K	"	"	453.26	453.26	456.0		"
E1	"	"	"	453.26	453.26	459.0		Overflow Inlet
E2	"	"	"	456.0	456.0			End Wall
E3	"	"	"	456.0	456.0			"
MH6	Standard	"	"	441.27	441.27	467.5		"
I23	Type E	"	"	441.87	441.87	463.5		"
I24	Type A	"	"	441.82	441.82			"

R-4341-A Ditch Grate, Steel Type
Heavy Duty - Total Weight 220 Pounds

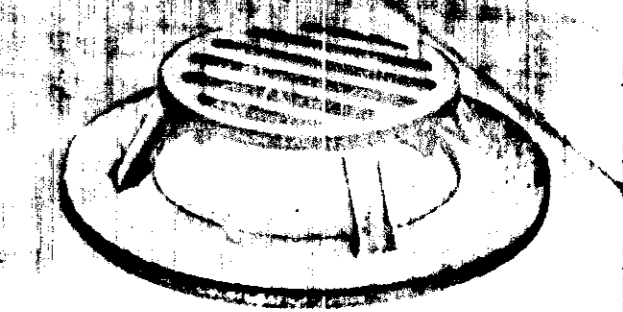
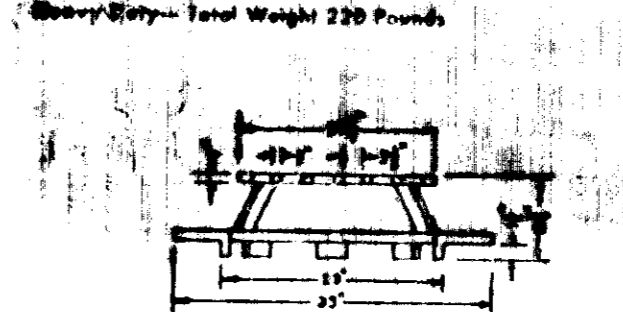

OVERFLOW DETAIL

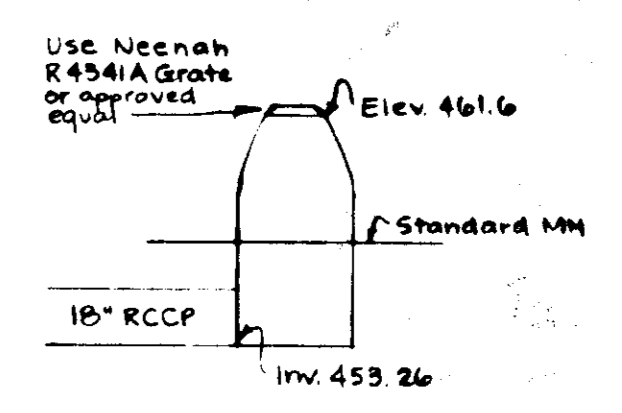

I-21 DETAIL

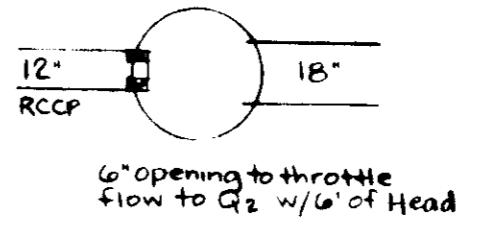

MH4 DETAIL

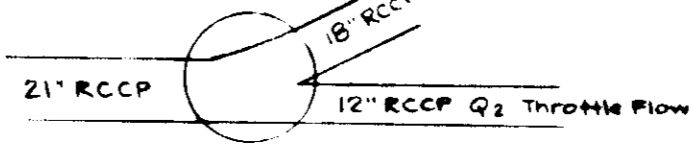

DRAINAGE SWALE DETAIL

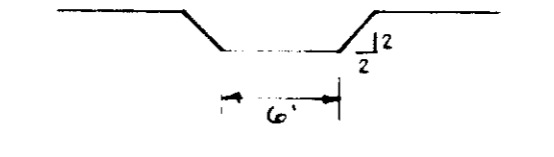

APPROVED: For Public Water and Public Sewerage Systems, Howard County Health Department
 County Health Officer, Date 4-28-77
 APPROVED: Howard County Office of Planning and Zoning
 Planning Director, Date 5-3-77
 APPROVED: For Public Water, Public Sewerage, Storm Drainage Systems and Public Roads, Howard County Dept. of Public Works
 Director, Date 4-26-77
 APPROVED: For Public Water and Public Sewerage Systems, Howard County Health Department
 County Health Officer, Date 4/28/77

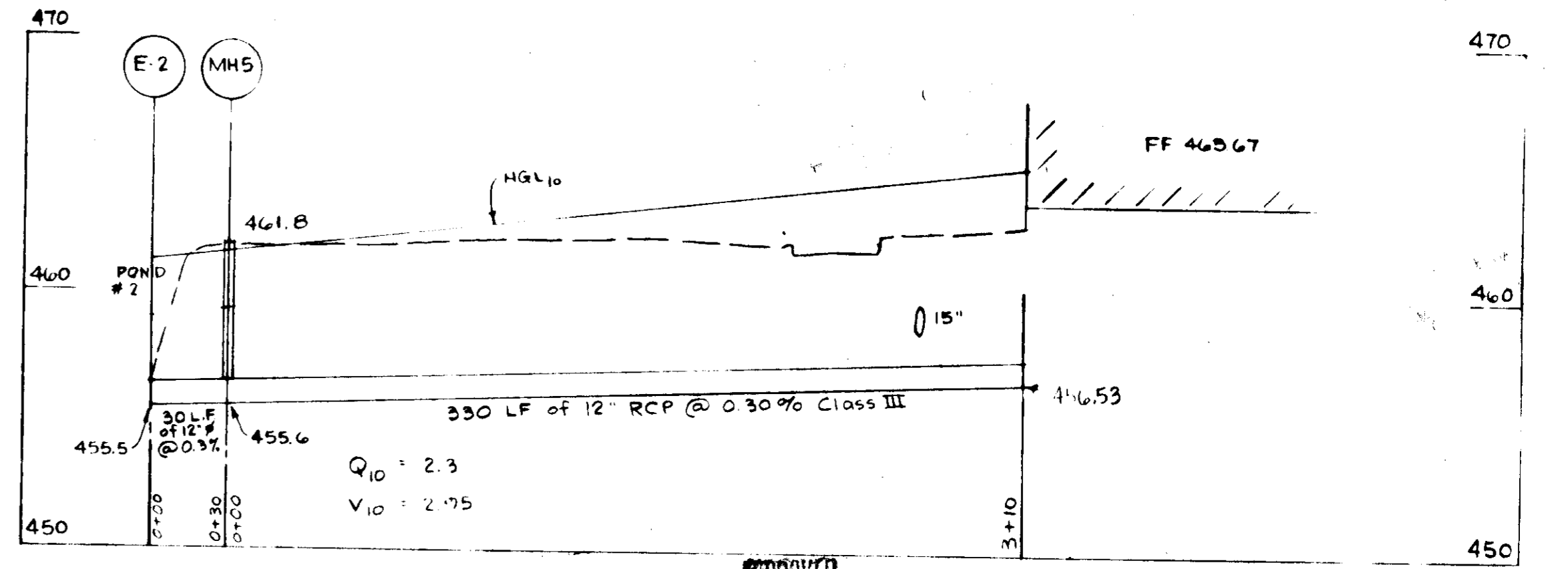
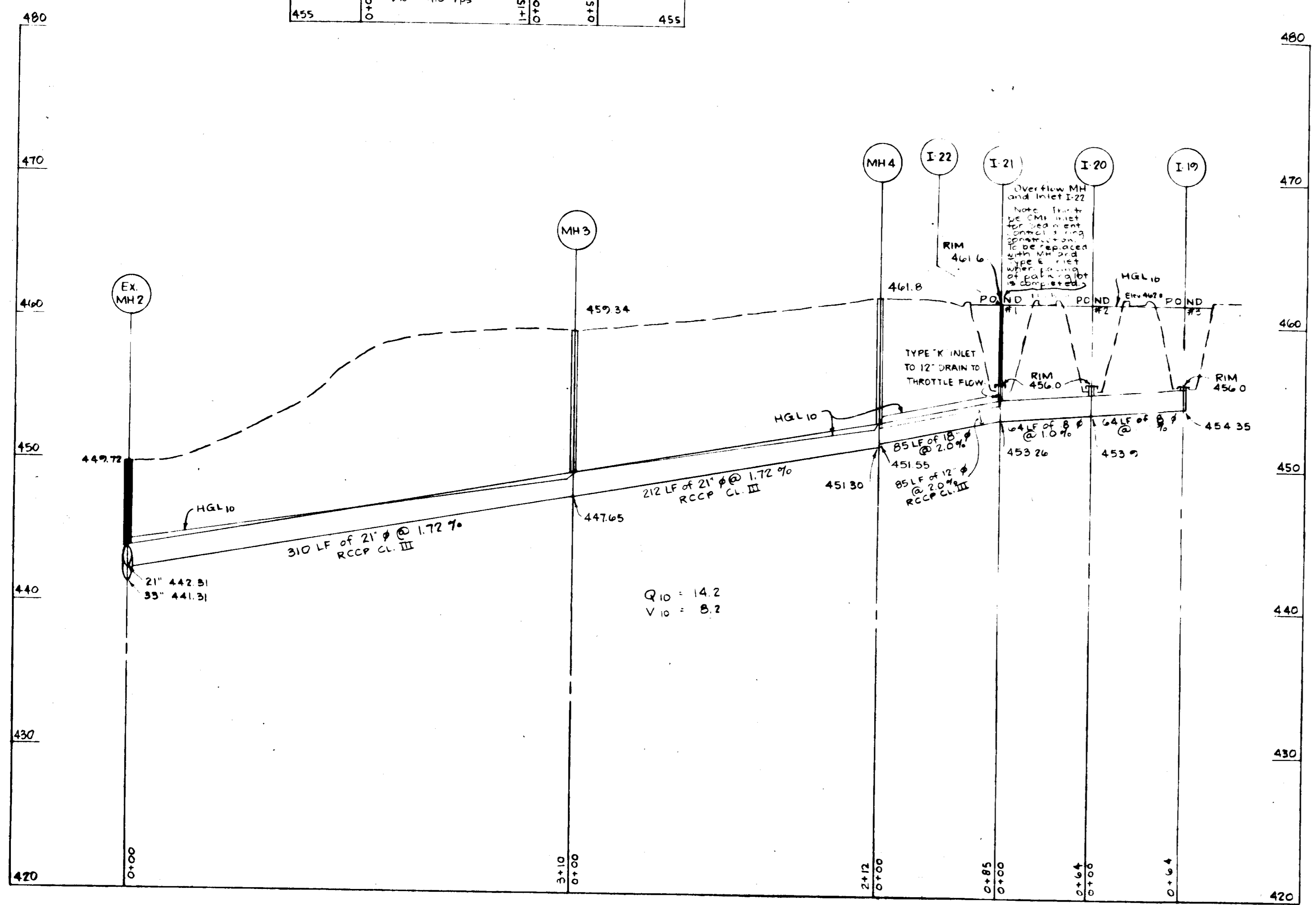
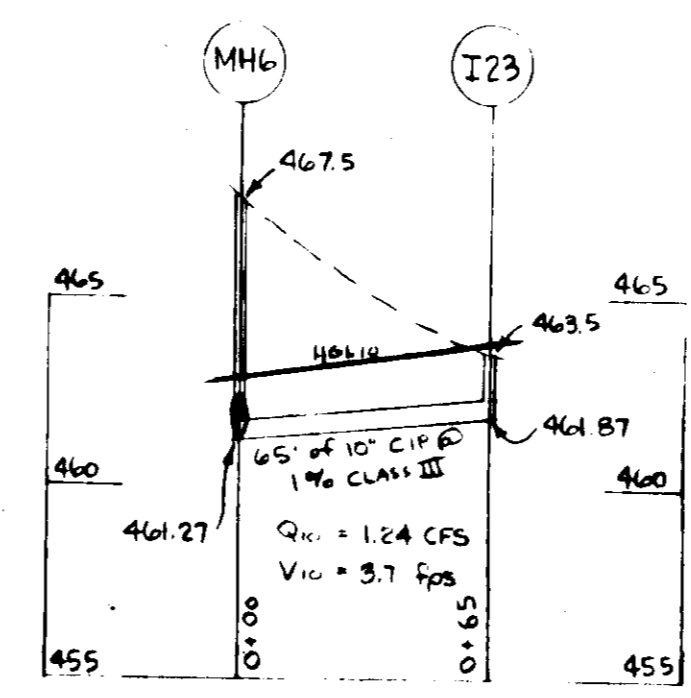
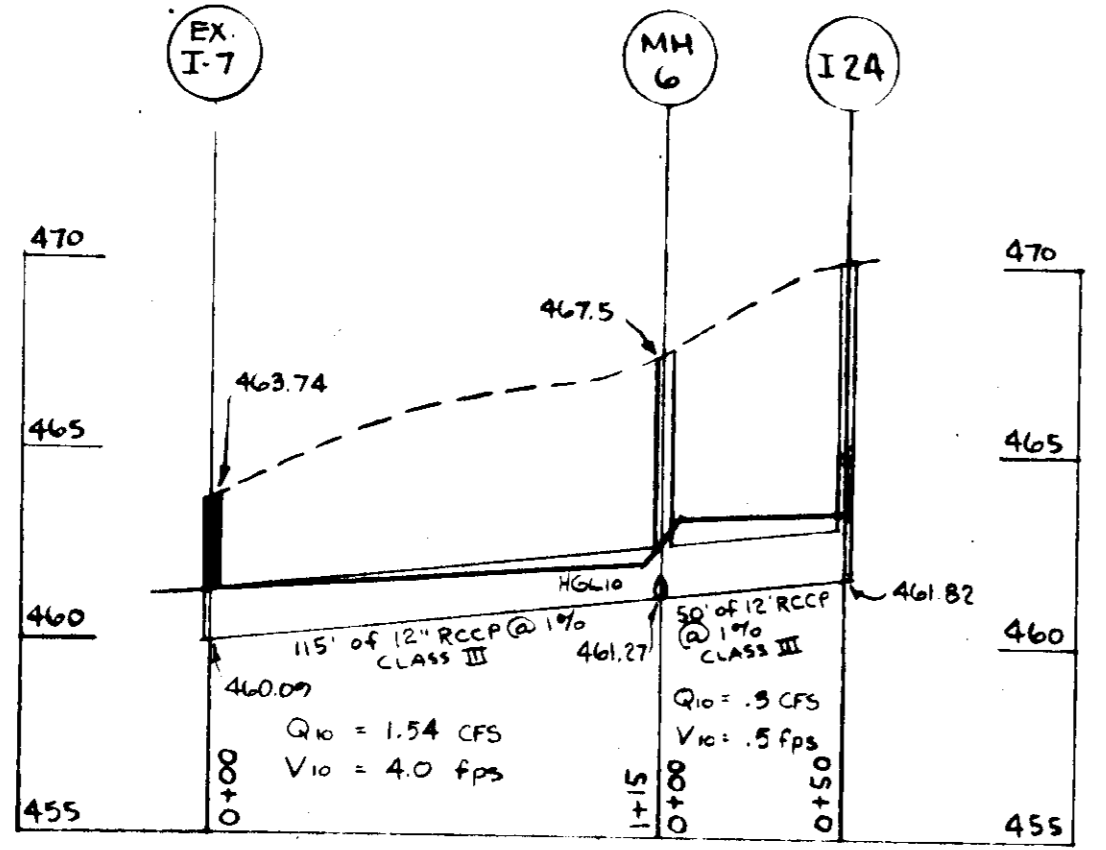

APPROVED: DIVISION OF LAND DEVELOPMENT

HOWARD COUNTY, MARYLAND
 DATE 3-7-77
 JWM

OWNER
 Howard County General Hospital
 Little Patients Parkway
 Columbia, Md 21044

1-4-77		
5-28-76		Submitted for Final Approval
Rev Date	Rev No.	Revision Description

RICHARD P. BROWNE ASSOCIATES
 ENGINEERS SURVEYORS PLANNERS ARCHITECTS
 PEACHTREE CITY, GEORGIA
 COLUMBIA, MD. WAYNE, N. J.

STORM DRAIN PROFILES
 TOWN CENTER SEC B AREA 2 PARCEL A
 MEDICAL OFFICE BUILDING
 Recording # 8648
HOWARD COUNTY GENERAL HOSPITAL
 5th Election District Tax Map 35

Des By FDL	Scale Horiz 1" = 50'	Dwg No. 50f6
Drn. By MK	Date 07-30-76	Proj. No.
Chk. By	Approved	

F. Dennis Light
 F. DENIS LIGHT #7617

DATE	
BY	
REVISION	
NOTE BOOK	
NO. OF WKS. CHECKED	
NO.	

DATE	
BY	
REVISION	
NOTE BOOK	
NO. OF WKS. CHECKED	
NO.	

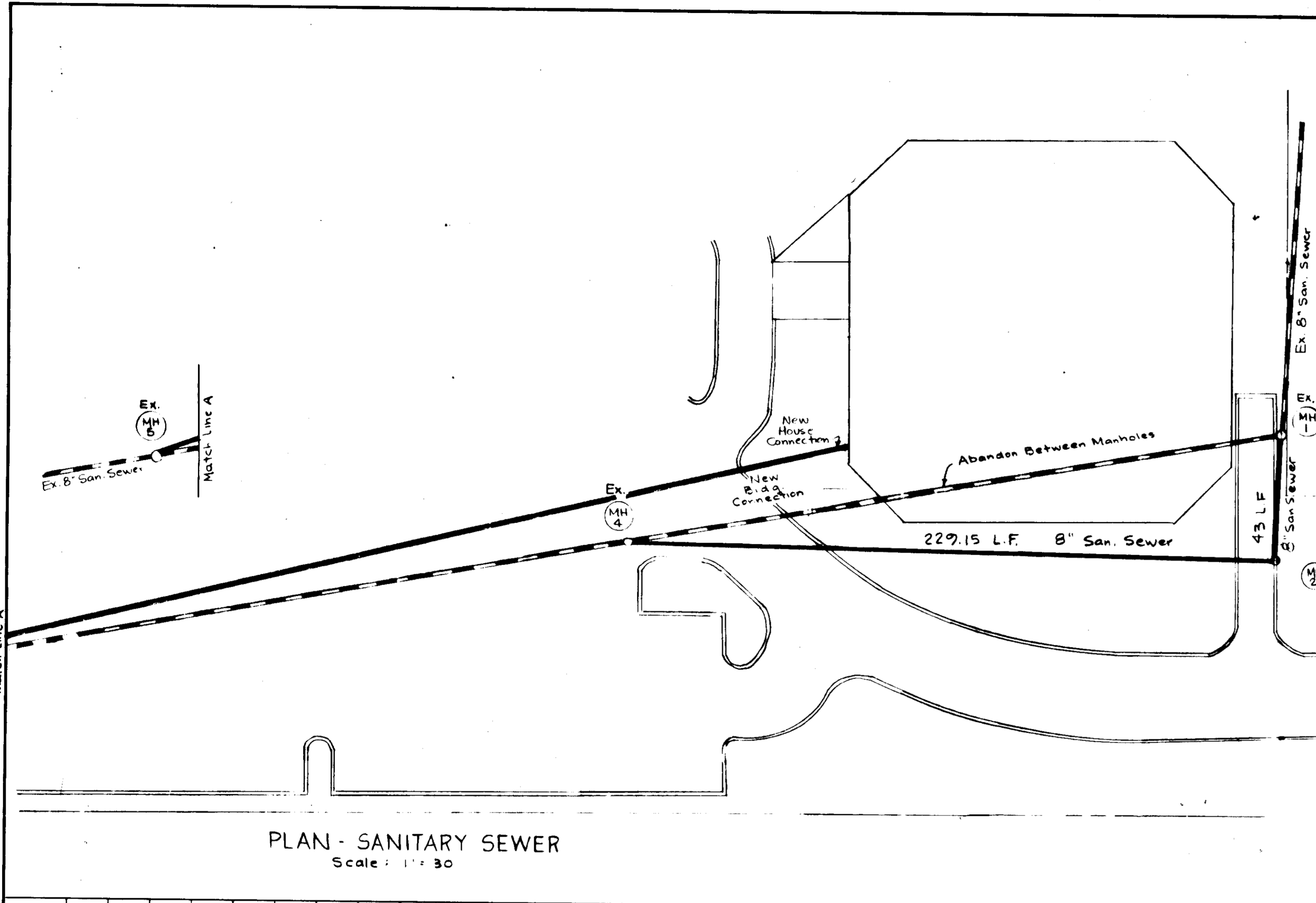

PLAN - SANITARY SEWER
Scale: 1" = 30'

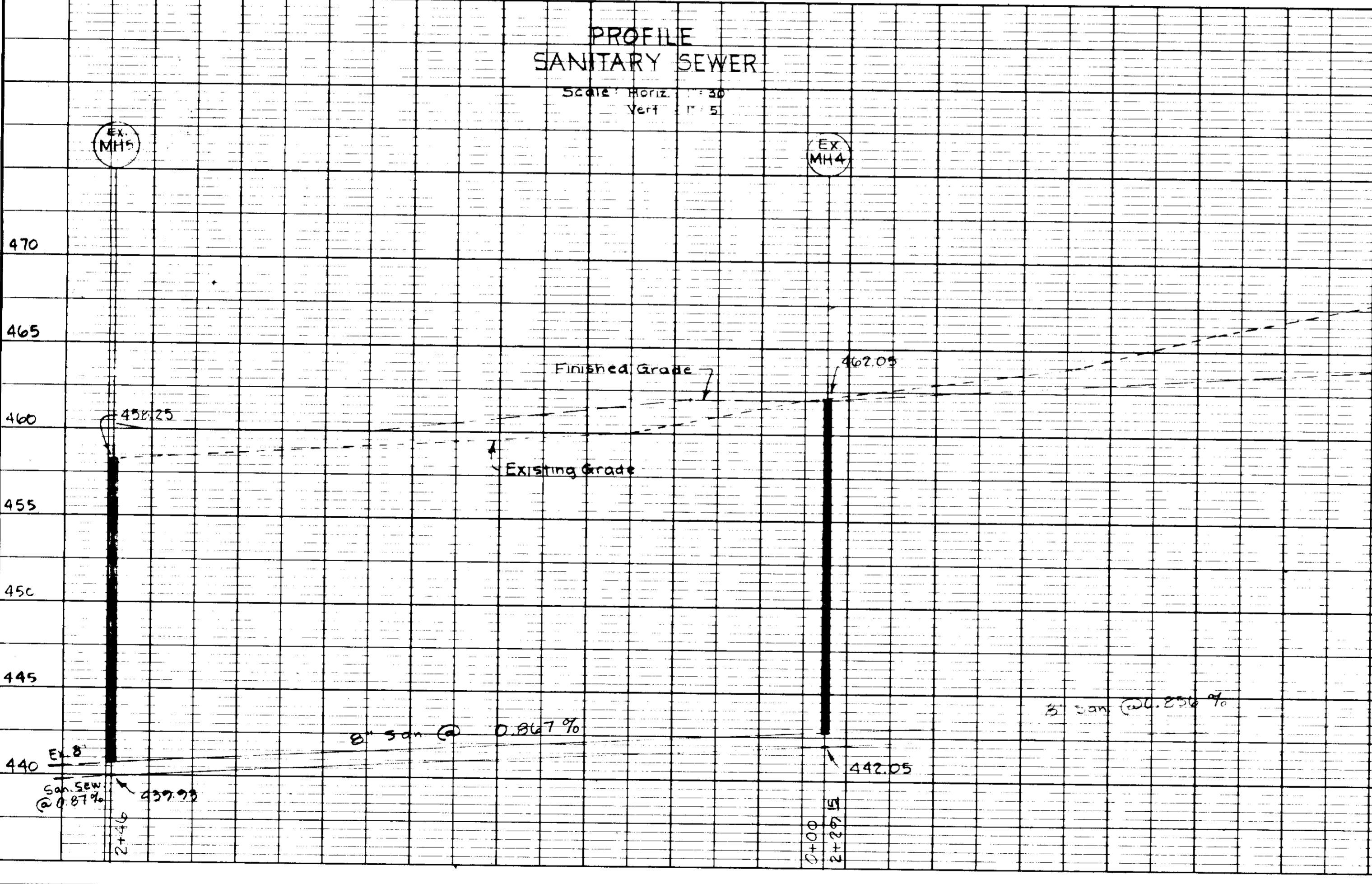

NOTE
Fire Hydrant shall meet approved specifications of Howard County Dept. of Public Works with 2-2 1/2" nominal standard Fire Dept connections & 1-1/4" Steam connection Baltimore City thread.



OWNER:
Howard County General Hosp.
Little Patient Parkway
Columbia, Md. 21044

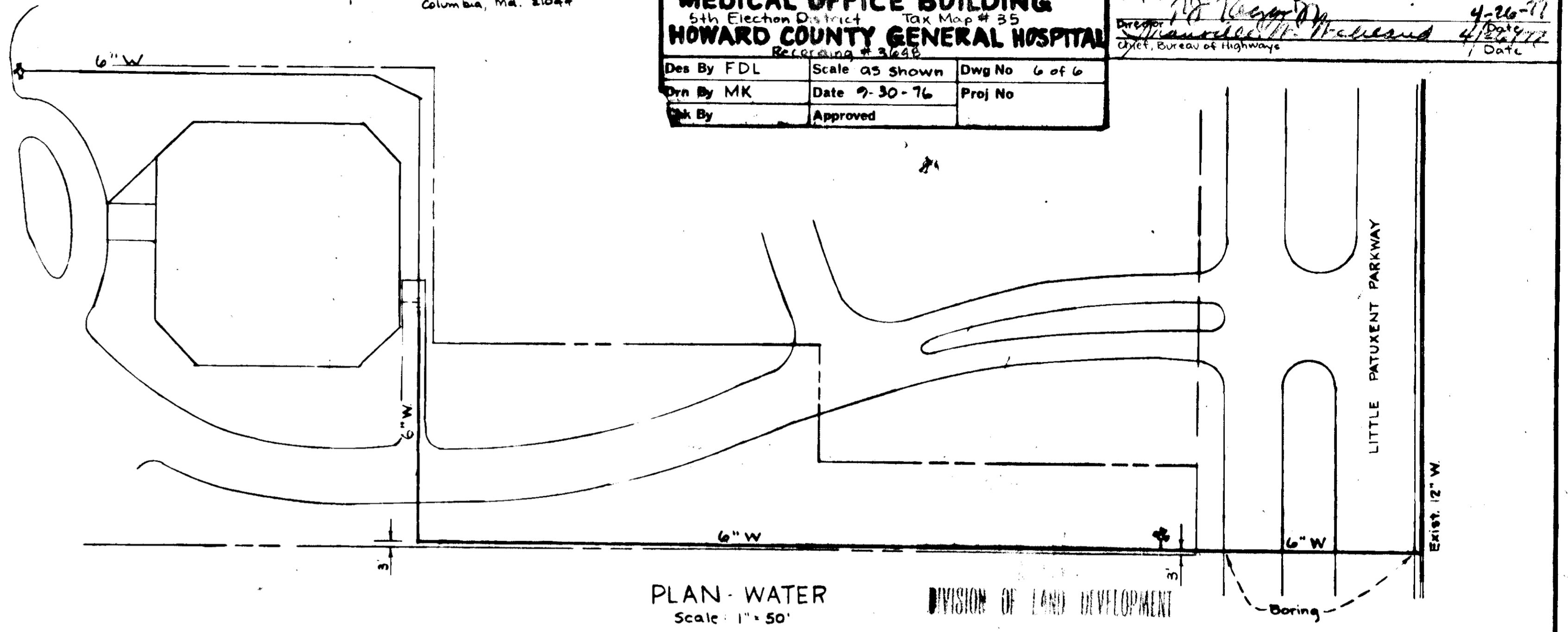

PLAN - WATER
Scale: 1" = 50'

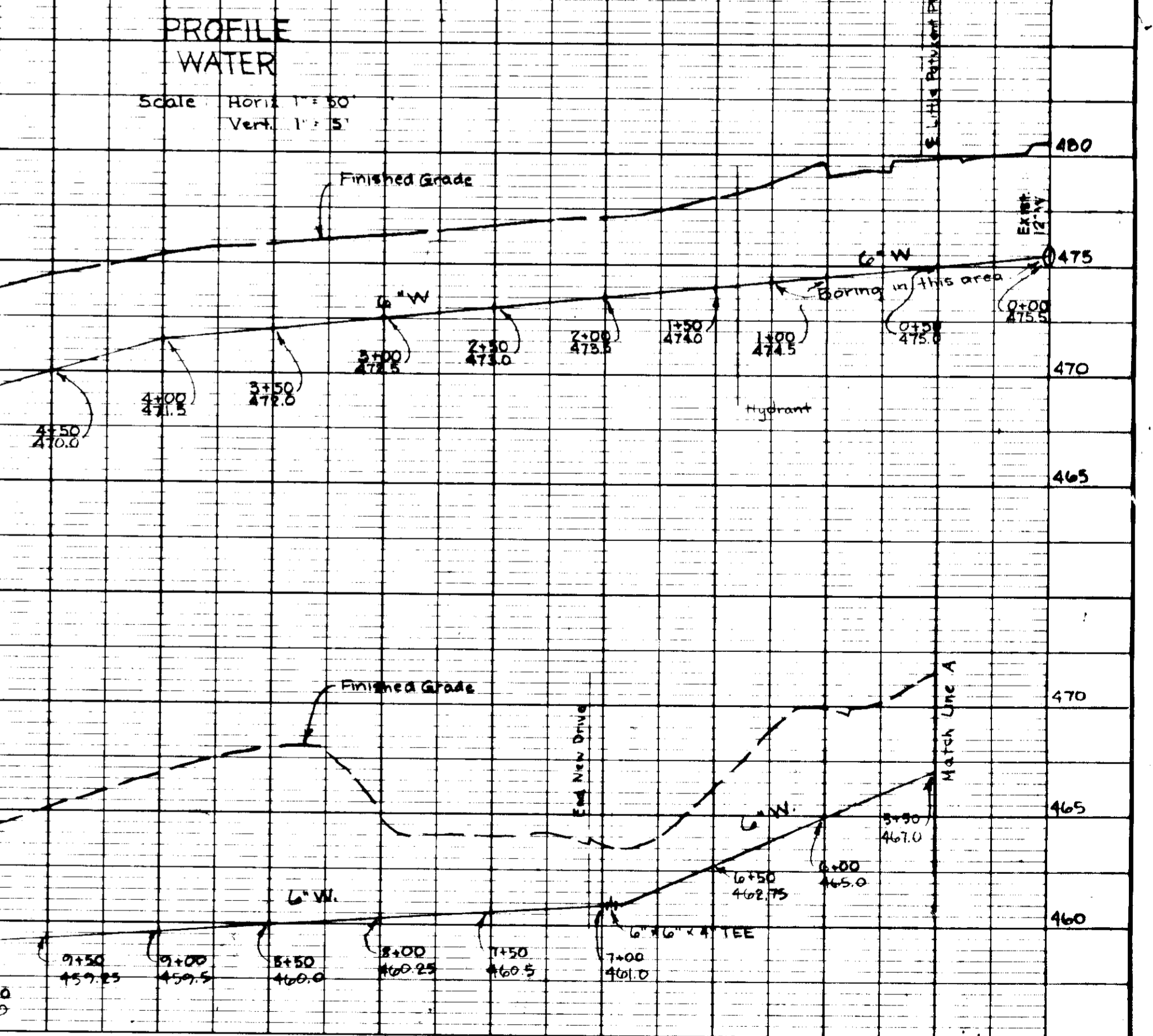

PROFILE WATER
Scale: Horiz. 1" = 50', Vert. 1" = 5'

3-23-77
2-7-77
1-24-77
5-28-76

Music Rev.
Res./Hub Ch. 10/27 dated 1-27-77

Submitted for Final Approval

Rev Date	Rev No	Reviser	Description

RICHARD P. BROUKE ASSOCIATES
Columbia, Maryland

ENGINEERS PLANNERS ARCHITECTS
Wayne, New Jersey

WATER and SEWER PLANS
TOWN CENTER SEC. D AREA 2 PARCEL A
MEDICAL OFFICE BUILDING
5th Election District Tax Map # 35
HOWARD COUNTY GENERAL HOSPITAL
Baltimore, Md. 21201

Des By FDL Scale as Shown Dwg No 6 of 6
Dwn By MK Date 9-30-76 Proj No
Chk By Approved

APPROVED: For Public Water and Public Sewerage Systems, Howard County Health Department
J. M. ... 4-28-77
County Health Officer Date
APPROVED: Howard County Office of Planning and Zoning
... 4-28-77
Planning Director Date
APPROVED: For Public Water, Public Sewerage, Storm Drainage Systems, and Public Roads, Howard County, Dept. of Public Works.
... 4-26-77
Director Date
Dist. Bureau of Highways