

NOTE:
SEE SPECIFICATIONS FOR
RAIL AND TIE DATA.

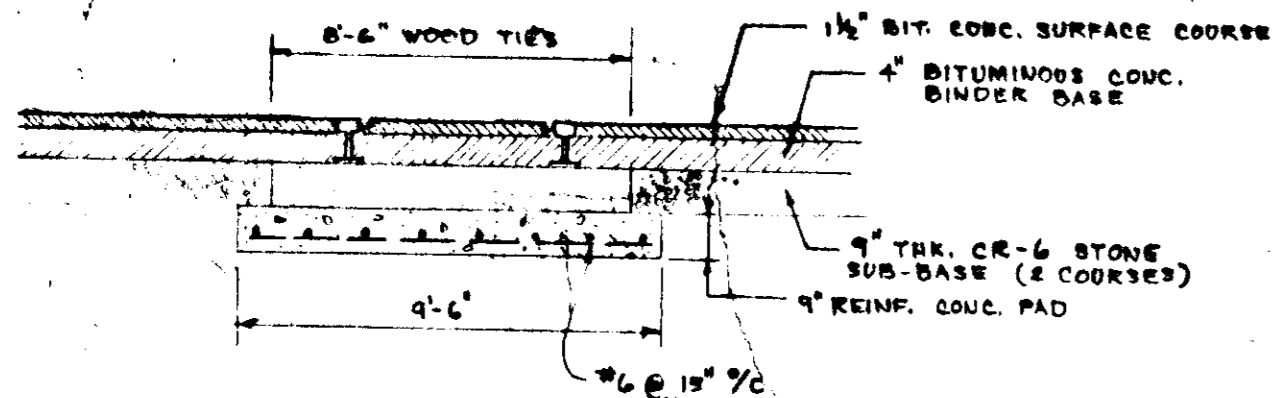

DETAIL OF R.R. IN PAVED AREAS
ABOVE PIPE CROSSING
NO SCALE

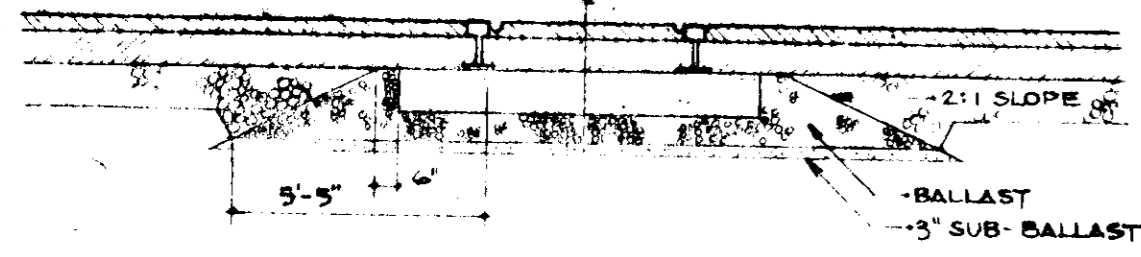

TYPICAL R.R. SIDING IN PAVED AREAS
NO SCALE

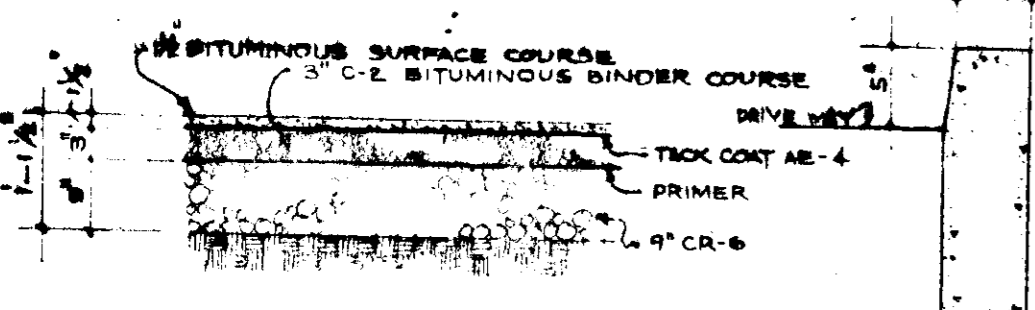

CONC. BARRIER CURB DETAIL
SCALE 3/4"=1'-0"

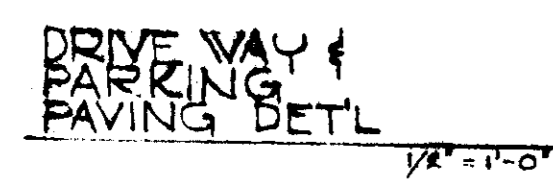

NOTE:
ALL STD. 7" CONC. CURB & GUTTER
SHALL BE IN ACCORDANCE WITH DRAWING
D-40 PAGE 98 OF HOWARD COUNTY ROAD
CONSTRUCTION CODE.

NOTES:

- AREA IS PORTION OF TAX MAP NO. 31.
- COVERAGE REQUIRED - 50% MAX.
SEWERAGE PROVIDED - 2 1/2%
POSSIBLE FUTURE COVERAGE - 41.5%
- SANTA BARBARA COURT RECORDED IN PLAT BOOK 28 FOLIO 20
AMONG THE LAND RECORDS OF HOWARD CO., MD.
- OFF-STREET PARKING:
REQD. 1 PARKING SPACE FOR TWO EMPLOYEES
BLDG. "A" = 14 EMPLOYEES PER SHIFT
BLDG. "B" = 33 EMPLOYEES PER SHIFT
TOTAL EMPLOYEES 47 PER SHIFT
PARKING SPACES REQD. = 24
PARKING SPACES PROVIDED 47
- SITE ANALYSIS
a. AREA OF PARCEL OVER PROP. IS 2.35 ACRES
QUIT CLAIM PROP. IS 1.997 ACRES
TOTAL IS 7.777 ACRES
- PRESENT ZONING, M-2
- TOTAL NUMBER OF EMPLOYEES
ON THREE SHIFTS = 140
ON ONE SHIFT = 47
- BLDG. "A" GROUND FLOOR = 22,500 SQ. FT.
BLDG. "A" MEZZANINE = 17,000 SQ. FT.
BLDG. "B" GROUND FLOOR = 60,000 SQ. FT.
BLDG. "B" MEZZANINE = 20,125 SQ. FT.
- SALES AREA - NONE
- PAINT STOR. BUILDING = 3,000 SQ. FT.
- ADDITION TO BLDG. "A" = 3,045 SQ. FT.

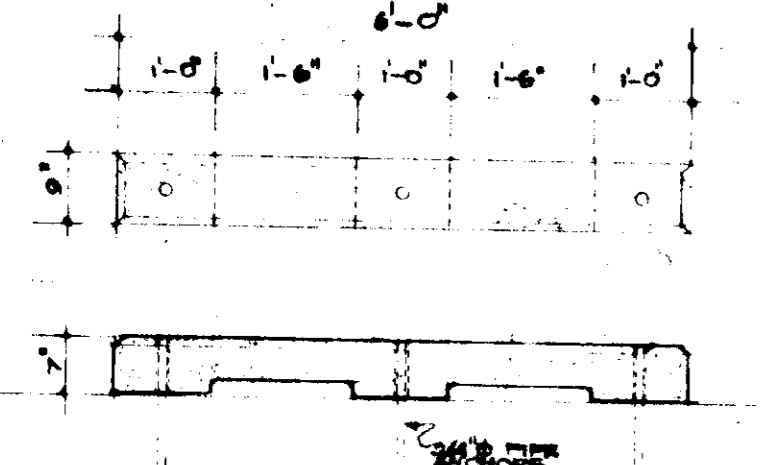

CONC. BUMPER DETL.
SCALE 1/2"=1'-0"

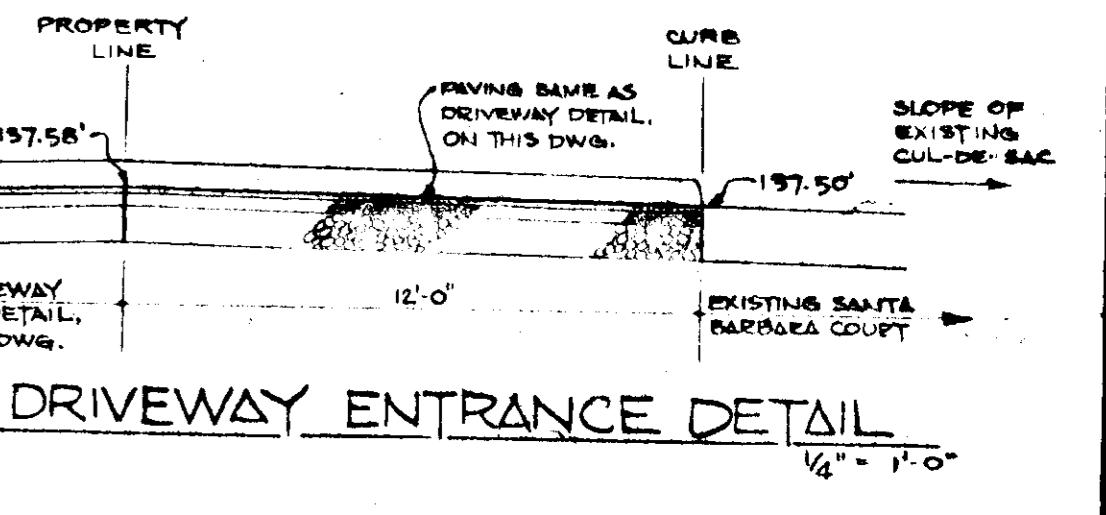
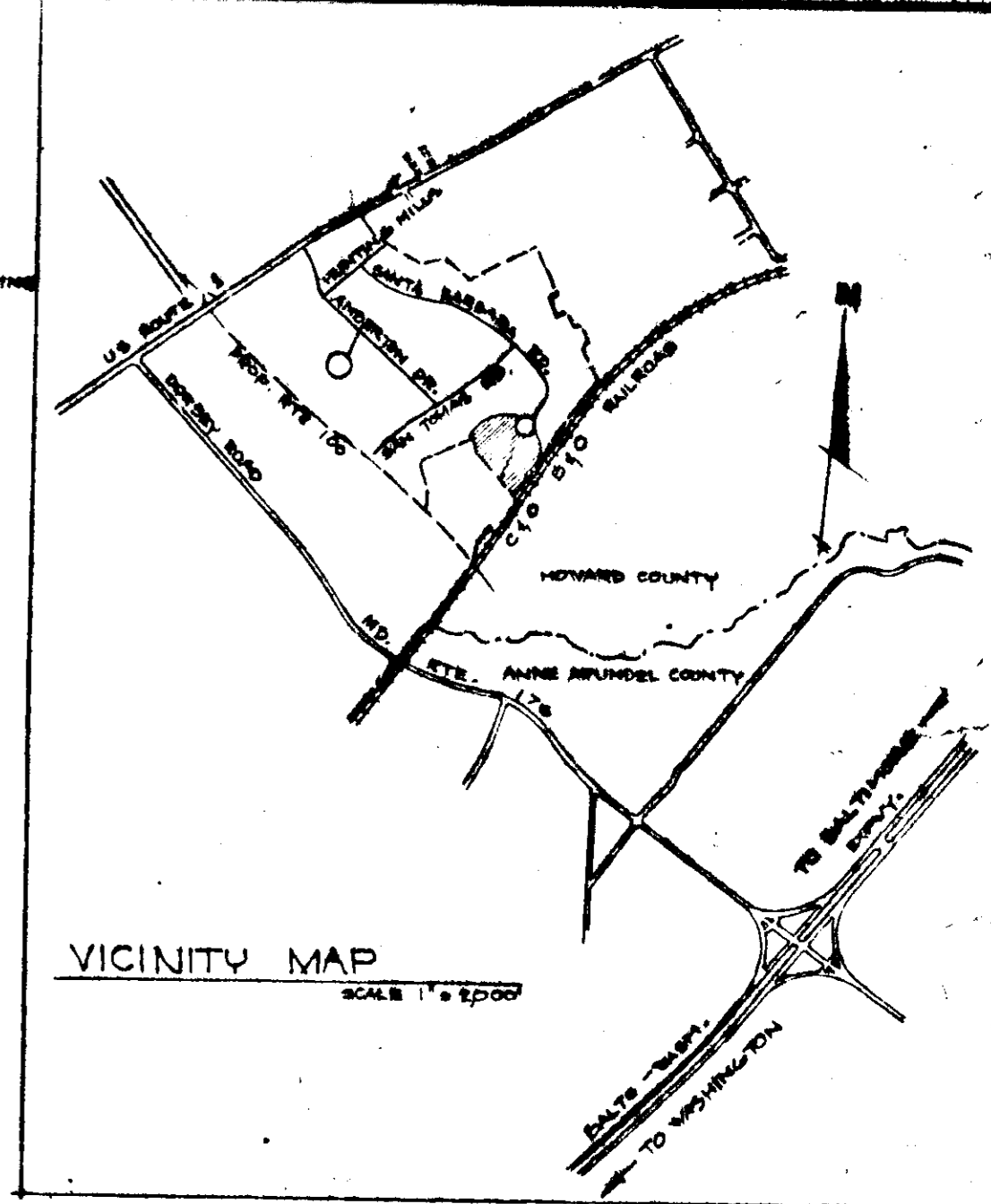
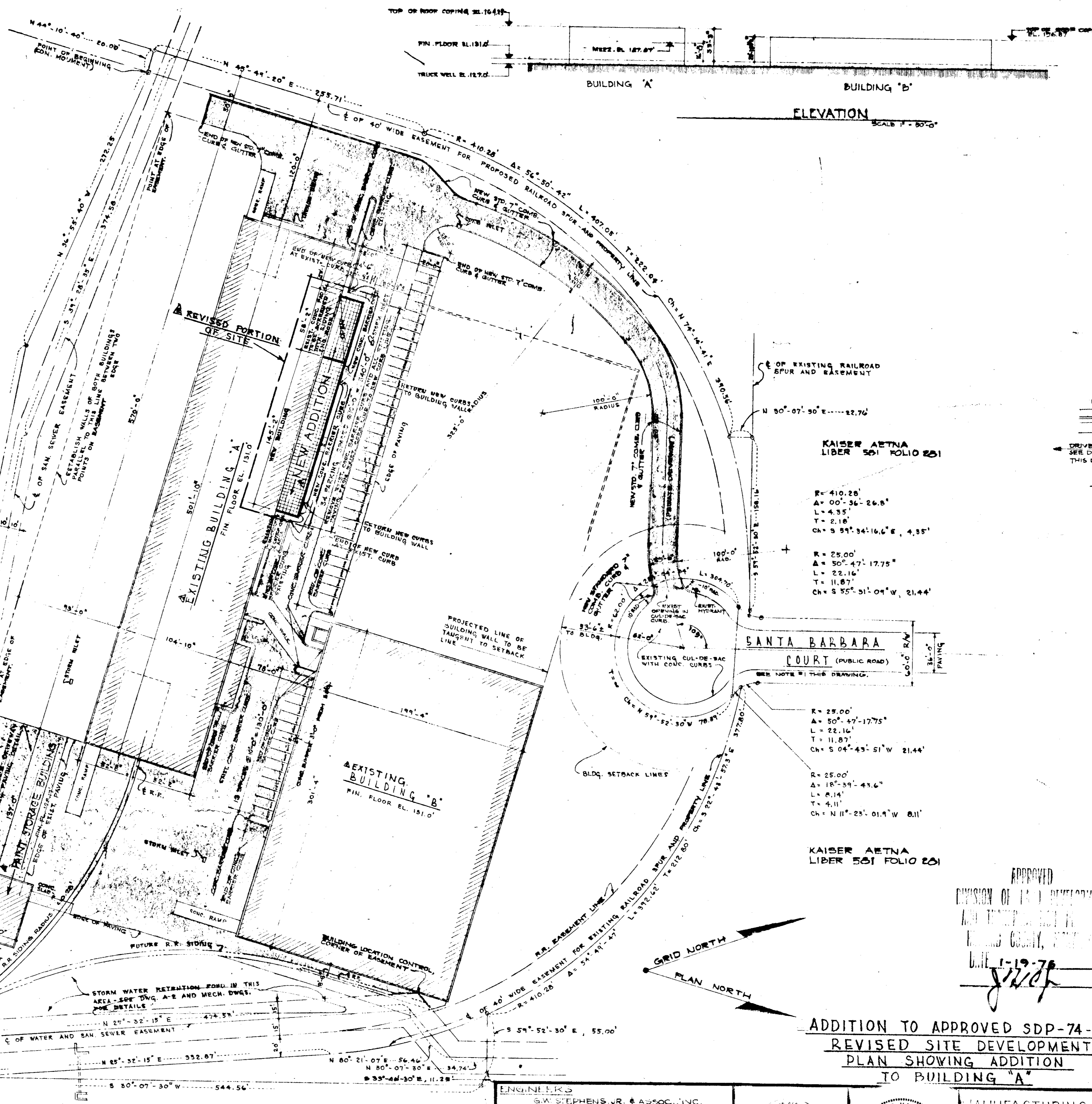

DRIVEWAY ENTRANCE DETAIL
1/4"=1'-0"

KAISER AETNA
LIBER 501 FOLIO 201

R= 410.28'
A= 00°-36'-26.8"
L= 4.35'
T= 2.18'
Ch= S 99°-34'-16.6" E, 4.35'

R= 25.00'
A= 50°-47'-17.75"
L= 22.16'
T= 11.87'
Ch= S 04°-45'-51" W, 21.44'

R= 25.00'
A= 18°-39'-43.6"
L= 4.14'
T= 4.11'
Ch= N 11°-23'-01.4" W, 8.11'

KAISER AETNA
LIBER 501 FOLIO 201

APPROVED
DIVISION OF LAND DEVELOPMENT
AND TRANSPORTATION PLANNING
HOWARD COUNTY, MARYLAND
DATE 1-19-76
[Signature]

ADDITION TO APPROVED SDP-74-55
REVISED SITE DEVELOPMENT
PLAN SHOWING ADDITION
TO BUILDING "A"

LEGEND	
—	PROPERTY LINE.
- - -	EASEMENT AND SETBACK LINE.
- · - · -	LINE OF EASEMENTS AND PROPERTY LINE WHERE SO NOTED.
APPROVED FOR PUBLIC WATER AND PUBLIC SEWERAGE SYSTEMS, HOWARD COUNTY HEALTH DEPARTMENT	
<i>[Signature]</i>	DATE 2/10/76
APPROVED: HOWARD COUNTY OFFICE OF PLANNING AND ZONING	
<i>[Signature]</i>	DATE 2-27-76
APPROVED FOR PUBLIC WATER, PUBLIC SEWERAGE AND STORM DRAINAGE SYSTEMS AND ROADS, HOWARD COUNTY DEPARTMENT OF PUBLIC WORKS	
<i>[Signature]</i>	DATE 2/20/76
APPROVED FOR HIGHWAY	
<i>[Signature]</i>	DATE 2/20/76

ENGINEERS
G.W. STEPHENS JR. & ASSOC., INC.
303 ALLEGHENY AVENUE
TOWSON MARYLAND 21284
(301) 825-8120

OWNER
CHICAGO METALLIC CORPORATION
4649 SOUTH AUSTIN AVENUE
CHICAGO, ILLINOIS 60650
(312) 458-5460



MANUFACTURING BUILDINGS
FOR
CHICAGO METALLIC CORPORATION
SANTA BARBARA COURT
ROUTE ONE HUNDRED BUSINESS PARK
ELECTION DIST. #1 HOWARD COUNTY
MARYLAND

BONNETT and BRAND
ARCHITECTS and ENGINEERS
100 W. CENTRE STREET
BALTIMORE MARYLAND
DATE 11-8-75
DRAWING NO. 674
SDP-1 OF 3

SITE PLAN
SCALE 1"=80'-0"

SDP-76-51

NEW ADDITION TO MANUFACTURING BUILDING "A" 12-22-75

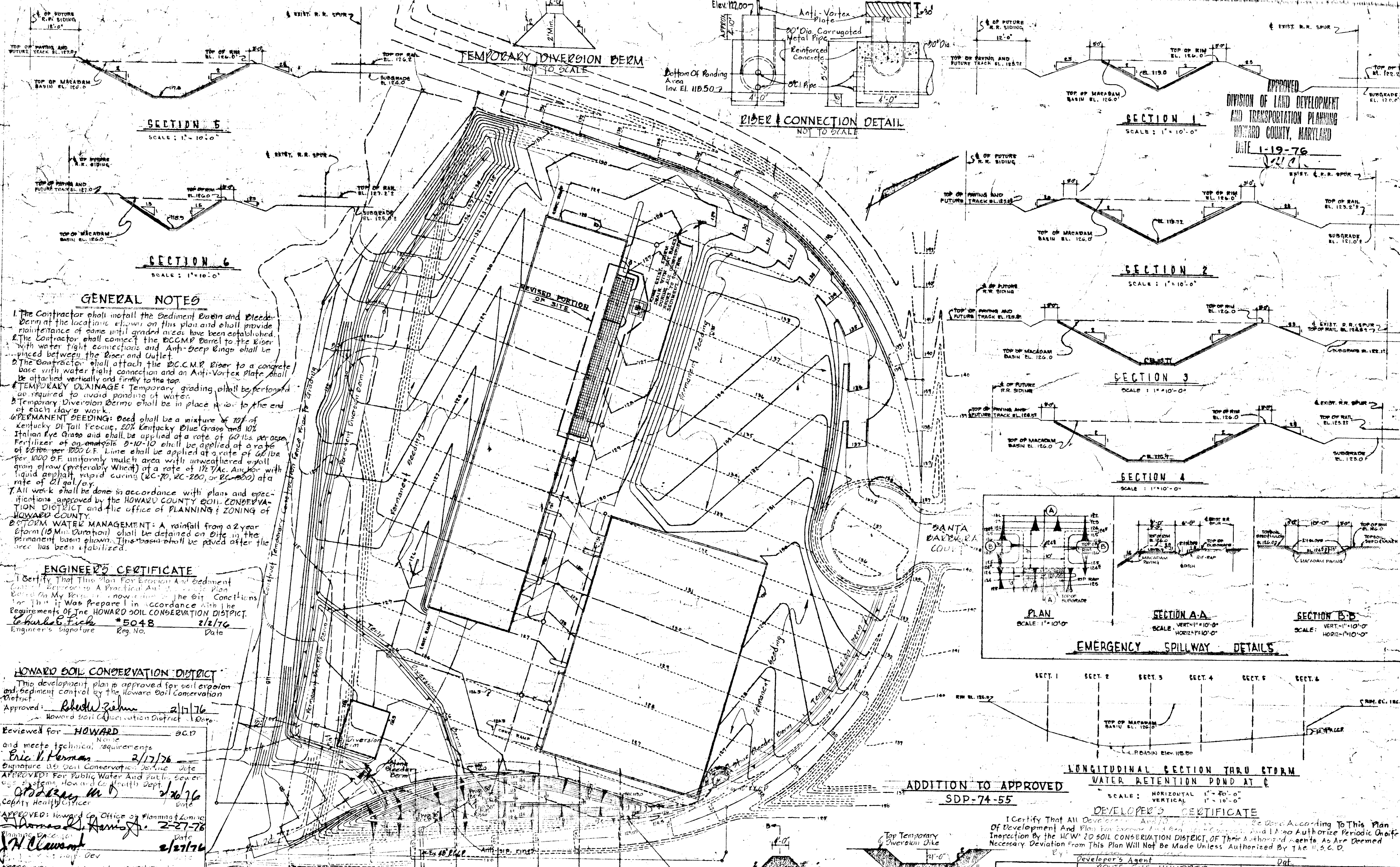

APPROVED
 DIVISION OF LAND DEVELOPMENT
 AND TRANSPORTATION PLANNING
 HOWARD COUNTY, MARYLAND
 DATE 1-19-76

SECTION 5
 SCALE: 1" = 10'-0"

SECTION 6
 SCALE: 1" = 10'-0"

RIVER CONNECTION DETAIL
 NOT TO SCALE

SECTION 1
 SCALE: 1" = 10'-0"

SECTION 2
 SCALE: 1" = 10'-0"

SECTION 3
 SCALE: 1" = 10'-0"

SECTION 4
 SCALE: 1" = 10'-0"

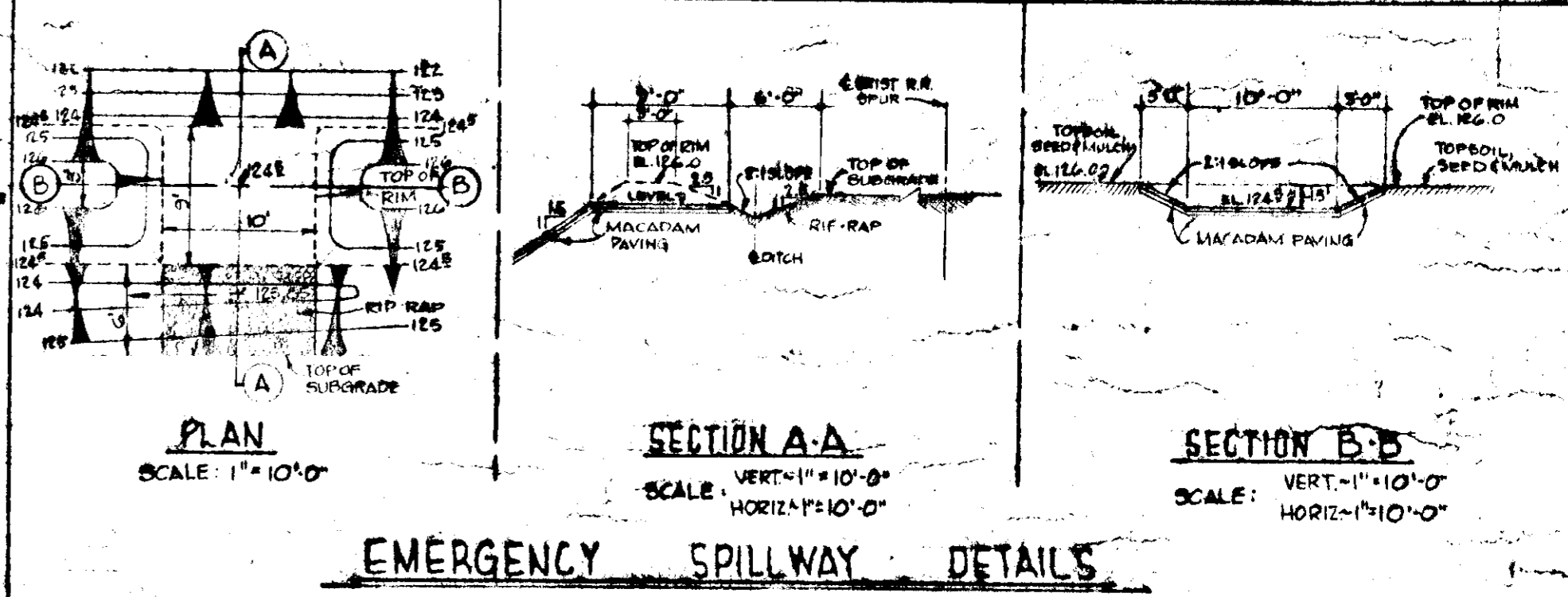

EMERGENCY SPILLWAY DETAILS

LONGITUDINAL SECTION THRU STORM
 WATER RETENTION POND AT C

SCALE: HORIZONTAL 1" = 20'-0"
 VERTICAL 1" = 10'-0"

ADDITION TO APPROVED
 SDP-74-55

DEVELOPER'S CERTIFICATE

I Certify That All Development and Construction of this Pond According to This Plan of Development and Plan for Erosion Control and I also Authorize Periodic Onsite Inspection by the HCW 2D SOIL CONSERVATION DISTRICT, OF Their Authorized Agents As Are Deemed Necessary Deviation From This Plan Will Not Be Made Unless Authorized By The H.S.C.D.

Developer's Agent

ROUTE ONE HUNDRED
 BUSINESS PARK
 GRAVING & EROSION CONTROL
 "PARCEL B"

CHICAGO METALLIC CORPORATION
 SANTA BARBARA COUNTY
 ROUTE ONE HUNDRED BUSINESS PARK
 ELEVATION DIST. HOWARD COUNTY
 MARYLAND



BONNER and BRANDT
 ARCHITECTS and ENGINEERS
 100 W. CENTRE STREET
 BALTIMORE, MARYLAND

DATE: OCT 21 1976
 SCALE: AS INDICATED
 SHEET NO. 674
 JOB NO. SDP-2
 OF 3

REVISIONS: 1/14/75
 11-21-76
 12-22-75

GENERAL NOTES

- The Contractor shall install the Sediment Basin and Bleeder Berm at the location shown on this plan and shall provide maintenance of same until graded areas have been established.
- The Contractor shall connect the D.C.C.M.P. Barrel to the River with water tight connections and Anti-Deep Rings shall be placed between the River and Outlet.
- The Contractor shall attach the D.C.C.M.P. Riser to a concrete base with water tight connection and an Anti-Vortex Plate shall be attached vertically and firmly to the top.
- TEMPORARY DRAINAGE: Temporary grading shall be performed as required to avoid ponding of water.
- Temporary Diversion Berms shall be in place prior to the end of each day's work.
- PERMANENT SEEDING: Seed shall be a mixture of 70% of Kentucky 21 Tail Fescue, 20% Kentucky Blue Grass and 10% Italian Ryegrass and shall be applied at a rate of 60 lbs. per acre. Fertilizer of an analysis 5-10-10 shall be applied at a rate of 25 lbs. per 1000 S.F. Lime shall be applied at a rate of 100 lbs. per 1000 S.F. uniformly match area with unweathered soil grain gravel (preferably Wheat) at a rate of 1/2 TAC Anchor with liquid asphalt rapid curing (AC-70, AC-200, or AC-2000) at a rate of 21 gal./sq. yd.
- All work shall be done in accordance with plans and specifications approved by the HOWARD COUNTY SOIL CONSERVATION DISTRICT and the office of PLANNING & ZONING OF HOWARD COUNTY.
- STORM WATER MANAGEMENT: A rainfall from a 2 year storm (15 Min. Duration) shall be detained on site in the permanent basin shown. This basin shall be paved after the area has been stabilized.

ENGINEER'S CERTIFICATE

I Certify That This Plan For Erosion and Sediment Control Represents A Practical and Feasible Plan Based On My Knowledge of the Site Conditions and That It Was Prepared in accordance with the Requirements of the HOWARD SOIL CONSERVATION DISTRICT.
 Charles E. Fick #5048 2/2/76
 Engineer's Signature Reg. No. Date

HOWARD SOIL CONSERVATION DISTRICT

This development plan is approved for soil erosion and sediment control by the Howard Soil Conservation District.
 Approved: Rhonda Zehner 2/1/76
 Howard Soil Conservation District Date

Reviewed for HOWARD SOIL CONSERVATION DISTRICT and meets technical requirements
 Eric V. Herman 2/17/76
 Signature H.S.C.D. Conservation District Date

APPROVED: For Public Water and Public Sewerage Systems Howard County Health Dept.
 Approved: M.D. 2/2/76
 County Health Officer Date

APPROVED: Howard Co. Office of Planning & Zoning
 Approved: J.N. Clouston 2/27/76
 Planning Director Date

APPROVED: For Public Water, Public Sewerage and Storm Drainage Systems and Roadways
 Approved: J.N. Clouston 2/20/76
 Director of Highways Date

Charles E. Fick
 Professional Engineer
 5048 2/2/76
 Reg. No. Date

STONE BLEEDER BERM
 NOT TO SCALE

STORM DRAIN STRUCTURE		SCHEDULE	
Number	Type	Howm. Co. Std. Detail	Page
I-1	E	Page 122	117.54
I-2	E	Page 122	126.00
I-3	E	Page 122	129.00
I-4	E	Page 122	132.00
I-5	E	Page 122	135.00
I-6	E	Page 122	138.00
M-1	Standard	Page 122	141.00
M-2	Standard	Page 122	144.00
M-3	Standard	Page 122	147.00
M-4	Standard	Page 122	150.00
E-1	C	Page 107	120.00
E-2	C	Page 107	121.00
E-3	C	Page 107	122.00
E-4	C	Page 107	123.00
E-5	C	Page 107	124.00
E-6	C	Page 107	125.00
E-7	C	Page 107	126.00
E-8	C	Page 107	127.00
E-9	C	Page 107	128.00
E-10	C	Page 107	129.00
E-11	C	Page 107	130.00
E-12	C	Page 107	131.00
E-13	C	Page 107	132.00
E-14	C	Page 107	133.00
E-15	C	Page 107	134.00
E-16	C	Page 107	135.00
E-17	C	Page 107	136.00
E-18	C	Page 107	137.00
E-19	C	Page 107	138.00
E-20	C	Page 107	139.00
E-21	C	Page 107	140.00
E-22	C	Page 107	141.00
E-23	C	Page 107	142.00
E-24	C	Page 107	143.00
E-25	C	Page 107	144.00
E-26	C	Page 107	145.00
E-27	C	Page 107	146.00
E-28	C	Page 107	147.00
E-29	C	Page 107	148.00
E-30	C	Page 107	149.00
E-31	C	Page 107	150.00
E-32	C	Page 107	151.00
E-33	C	Page 107	152.00
E-34	C	Page 107	153.00
E-35	C	Page 107	154.00
E-36	C	Page 107	155.00
E-37	C	Page 107	156.00
E-38	C	Page 107	157.00
E-39	C	Page 107	158.00
E-40	C	Page 107	159.00
E-41	C	Page 107	160.00
E-42	C	Page 107	161.00
E-43	C	Page 107	162.00
E-44	C	Page 107	163.00
E-45	C	Page 107	164.00
E-46	C	Page 107	165.00
E-47	C	Page 107	166.00
E-48	C	Page 107	167.00
E-49	C	Page 107	168.00
E-50	C	Page 107	169.00
E-51	C	Page 107	170.00
E-52	C	Page 107	171.00
E-53	C	Page 107	172.00
E-54	C	Page 107	173.00
E-55	C	Page 107	174.00
E-56	C	Page 107	175.00
E-57	C	Page 107	176.00
E-58	C	Page 107	177.00
E-59	C	Page 107	178.00
E-60	C	Page 107	179.00
E-61	C	Page 107	180.00
E-62	C	Page 107	181.00
E-63	C	Page 107	182.00
E-64	C	Page 107	183.00
E-65	C	Page 107	184.00
E-66	C	Page 107	185.00
E-67	C	Page 107	186.00
E-68	C	Page 107	187.00
E-69	C	Page 107	188.00
E-70	C	Page 107	189.00
E-71	C	Page 107	190.00
E-72	C	Page 107	191.00
E-73	C	Page 107	192.00
E-74	C	Page 107	193.00
E-75	C	Page 107	194.00
E-76	C	Page 107	195.00
E-77	C	Page 107	196.00
E-78	C	Page 107	197.00
E-79	C	Page 107	198.00
E-80	C	Page 107	199.00
E-81	C	Page 107	200.00

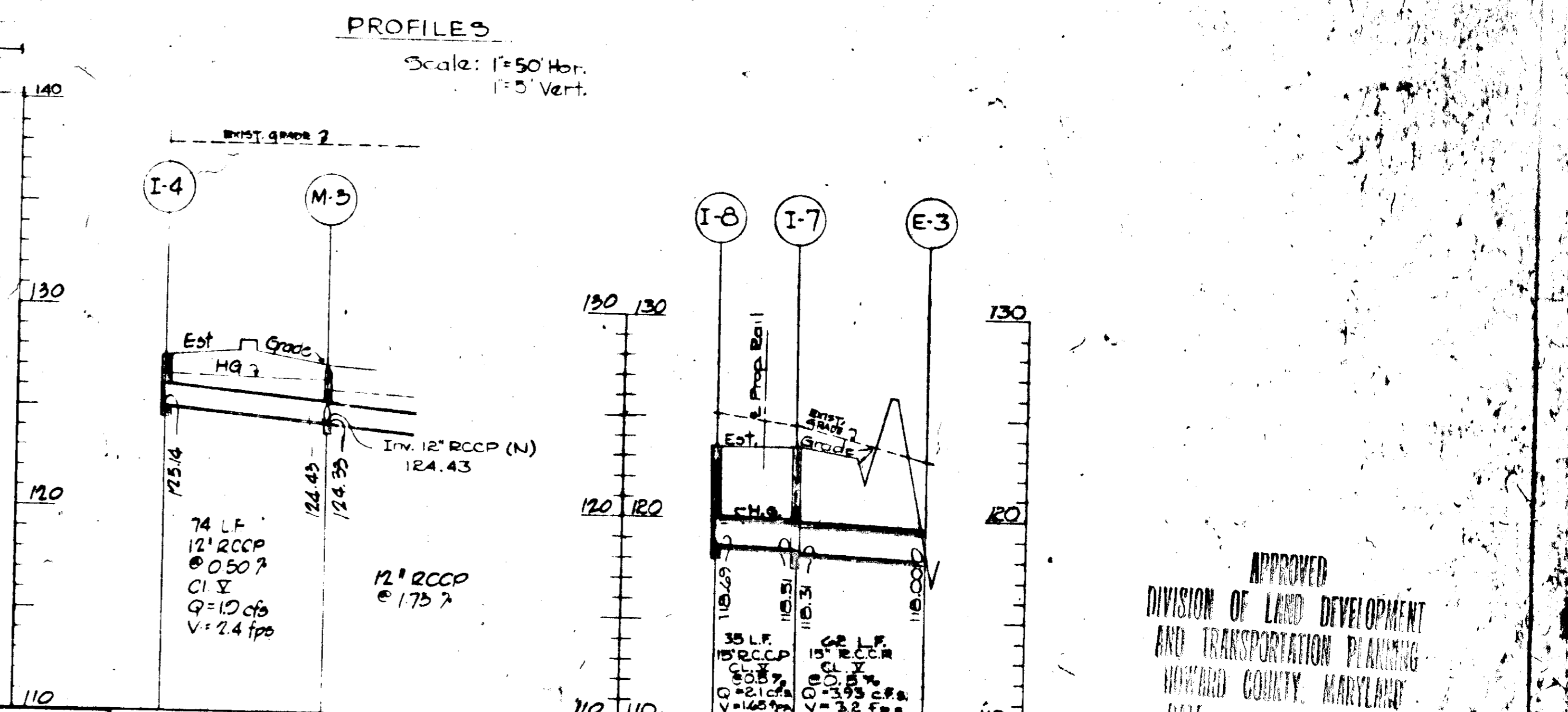
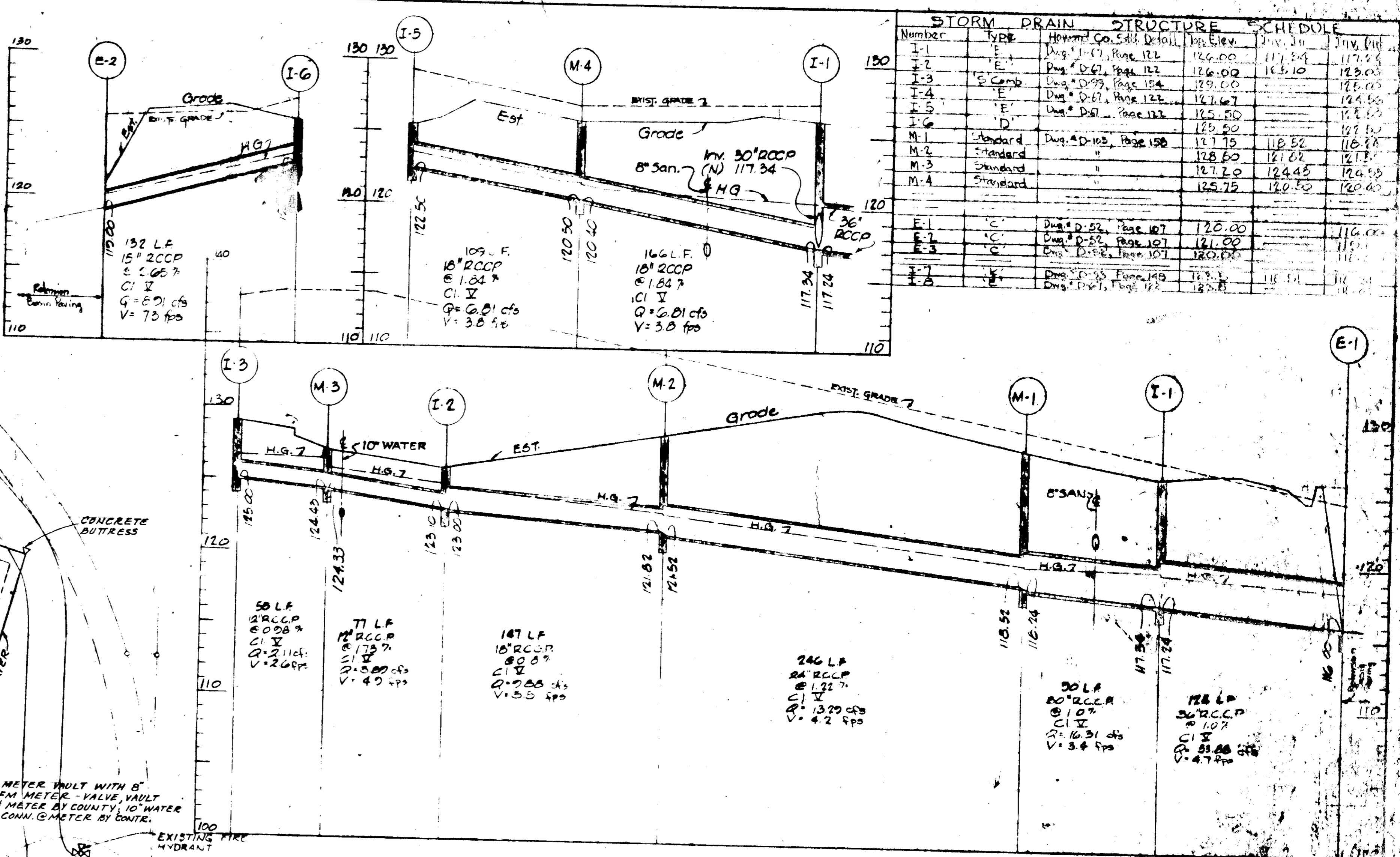
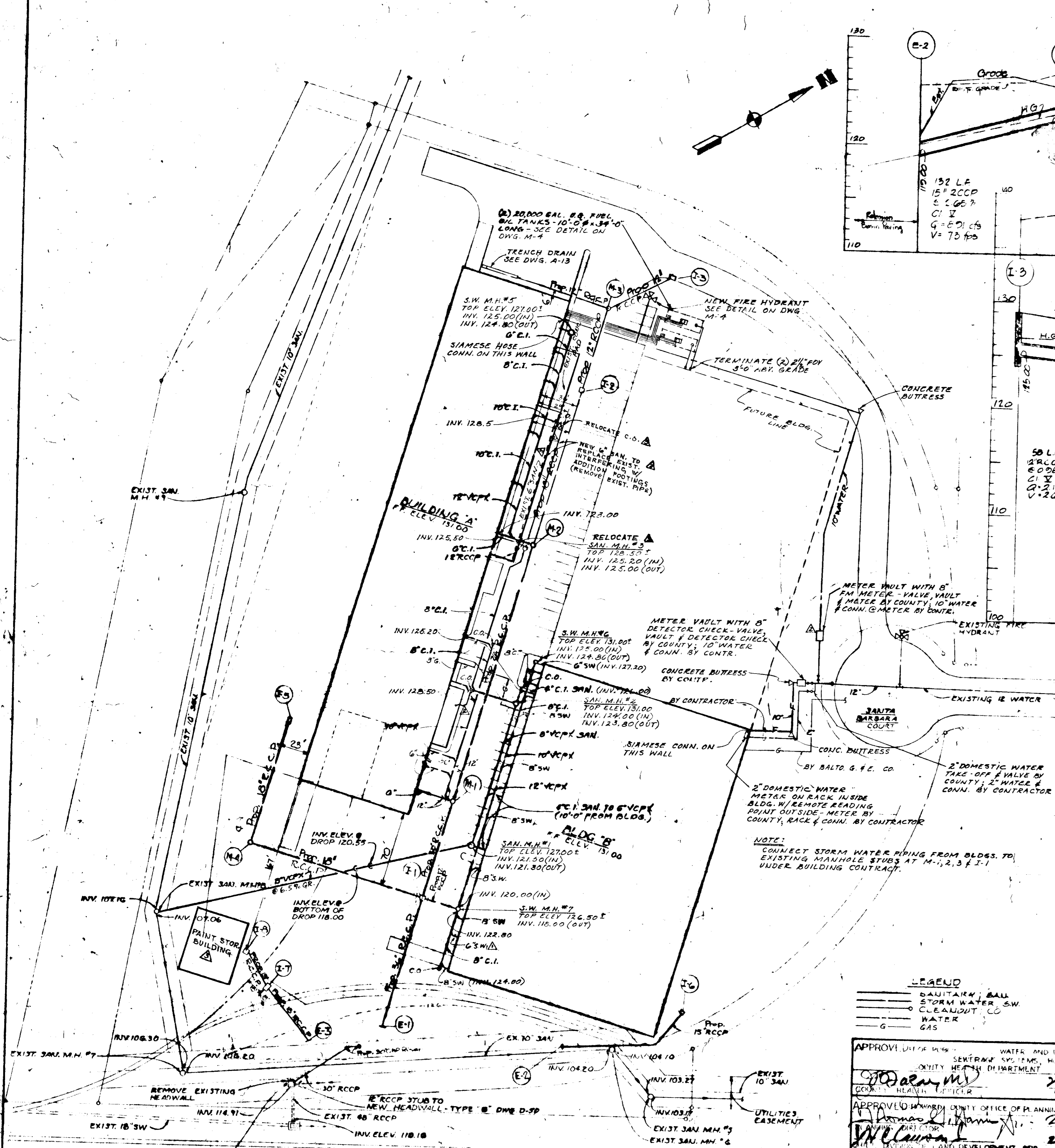

LEGEND
 - SANITARY BALL
 - STORM WATER S.W.
 - CLEANOUT CO.
 - WATER
 - GAS

APPROVED WATER AND SEWERAGE DEPARTMENT
 COUNTY HEALTH DEPARTMENT
 COUNTY PLANNING AND ZONING DEPARTMENT
 COUNTY OFFICE OF PLANNING AND ZONING
 COUNTY DEPARTMENT OF PUBLIC WORKS
 COUNTY DEPARTMENT OF PUBLIC WORKS

APPROVED MILLER SCHUERHOLZ AND ASSOCIATES
 MECHANICAL ELECTRICAL ENGINEERS
 SUITE 150, THE QUADRANGLE
 VILLAGE OF CROSS KEYS
 BALTIMORE, MARYLAND 21210

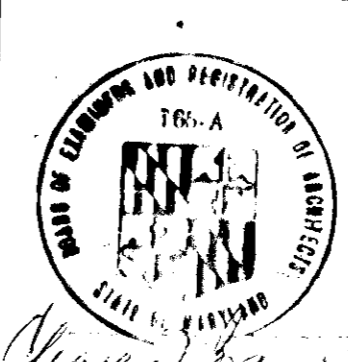

MANUFACTURING BUILDINGS
 FOR
CHICAGO METALLIC CORPORATION
 SANTA BARBARA COURT
 ROUTE ONE HILDFORD BUSINESS PARK
 ELECTION DIST. #1 HOWARD COUNTY
 BLOCK F MARYLAND

BONNETT and BRANDT
 ARCHITECTS and ENGINEERS
 100 W. CENTRE STREET
 BALTIMORE, MARYLAND
 DATE: 11-26-73
 DRAWING: SDP-3
 OF 3

ADDITION TO APPROVED SDP-74-55

APPROVED
 DIVISION OF LAND DEVELOPMENT
 AND TRANSPORTATION PLANNING
 HOWARD COUNTY, MARYLAND
 DATE 1-19-76