

GENERAL NOTES

1. ALL REFERENCES TO STANDARDS AND SPECIFICATIONS SHALL MEAN "THE STANDARDS AND SPECIFICATIONS FOR SOIL EROSION AND SEDIMENT CONTROL IN URBANIZING AREAS".
2. THE INITIAL SEDIMENT AND EROSION CONTROL FACILITIES ARE TO BE CONSTRUCTED IN CONJUNCTION WITH THE START OF THE CLEARING OPERATION.
3. CONTINUOUS INSPECTION AND MAINTENANCE TO BE PROVIDED TO INSURE EFFICIENCY OF ALL FACILITIES.
4. ALL SEDIMENT CONTROL FACILITIES TO REMAIN IN PLACE UNTIL PERMISSION FOR THEIR REMOVAL HAS BEEN OBTAINED FROM HOWARD SOIL CONSERVATION SERVICE. (465-3180 or 465-5000 EXT. 328)
5. CONTRACTOR INSTALLING THE SEDIMENT AND EROSION CONTROL FACILITIES SHALL OBTAIN AND FOLLOW THE SPECIFICATIONS FOR SILT AND SEDIMENT CONTROL AS DISTRIBUTED BY THE HOWARD SOIL CONSERVATION DISTRICT.
6. ALL DISTURBED AREAS ARE TO BE DIRECTED TO DRAIN TO THE SEDIMENT CONTROL FACILITIES PROVIDED. NO DISTURBED AREAS ARE TO BE ALLOWED TO DRAIN DIRECTLY OFF THE SITE.
7. ALL SEDIMENT CONTROL FACILITIES TO BE ADJUSTED AS NECESSARY TO MEET EXISTING FIELD CONDITIONS.
8. THE INITIAL CLEARING WILL BE LIMITED TO THOSE AREAS WHICH WILL BE USED FOR THE SEDIMENT CONTROL FACILITIES.
9. THE CONTRACTOR SHALL BE RESPONSIBLE FOR ASSURING THAT THE SEDIMENT CONTROL MEASURES ARE FUNCTIONAL ON A DAY-TO-DAY BASIS.
10. ALL FILL MATERIAL USED ON THIS SITE SHALL BE FREE OF DECOMPOSIBLE MATERIAL.
11. THE TOTAL AMOUNT OF EXCAVATION AND FILL AS SHOWN ON THESE PLANS HAS BEEN COMPUTED TO BE 80 CUBIC YARDS OF EXCAVATION AND 0 CUBIC YARDS OF FILL.
12. TOTAL SITE AREA = 0.6032 AC.
TOTAL DISTURBED AREA = 0.07 AC.
13. THE HOWARD SOIL CONSERVATION DISTRICT SHOULD BE INFORMED AT LEAST 24 HOURS BEFORE STARTING ANY WORK. PHONE 465-3180 OR 465-5000, EXT. 328.

ALL DISTURBED AREAS SHALL BE STABILIZED BY SOODING IN ACCORDANCE WITH THE FOLLOWING PROCEDURE:

- A. FERTILIZER MATERIALS WHICH SUPPLY 2-1/2 LBS. ACTUAL N PER 1,000 SQ.FT., 2-1/2 LBS. ACTUAL P205 PER 1,000 SQ.FT., AND 2-1/2 LBS. ACTUAL K2O PER 1,000 SQ.FT. CAN BE APPLIED.
- B. LIME SHALL BE APPLIED AT THE RATE OF 50 LBS. PER 1,000 SQ.FT. AND DISTRIBUTED UNIFORMLY OVER THE ENTIRE AREAS TO BE SOODED.
- C. SOD SHALL BE APPLIED IN CONFORMANCE WITH THE "STANDARDS AND SPECIFICATIONS FOR CRITICAL AREA STABILIZATION WITH SOD" (PAGE 3.400) OF THE "STANDARDS AND SPECIFICATIONS FOR SOIL EROSION AND SEDIMENT CONTROL IN URBANIZING AREAS".

APPROVED
DIVISION OF LAND DEVELOPMENT
AND RECREATION PLANNING
HOWARD COUNTY, MARYLAND
11/4/74
[Signature]

APPROVED FOR PUBLIC WATER AND PUBLIC SEWERAGE SYSTEMS - Howard County Health Department

[Signature] 12/14/74
County Health Officer

APPROVED: Howard County Office of Planning & Zoning
[Signature] 12-4-74
Planning Director

[Signature] 12/4/74
Chief, Division of Land Development

APPROVED FOR PUBLIC WATER AND PUBLIC SEWERAGE SYSTEMS, STORM DRAINAGE SYSTEMS AND PUBLIC ROADS - Howard County Department of Public Works

[Signature] 12/14/74
[Signature] 12/14/74
Chief Bureau of Highways

"I CERTIFY THAT THIS PLAN FOR EROSION AND SEDIMENT CONTROL REPRESENTS A PRACTICAL AND WORKABLE PLAN BASED ON MY PERSONAL KNOWLEDGE OF THE SITE CONDITIONS AND THAT IT WAS PREPARED IN ACCORDANCE WITH THE REQUIREMENTS OF THE HOWARD SOIL CONSERVATION DISTRICT."

[Signature] 7/26/74
SIGNATURE OF ENGINEER DATE

REVIEWED FOR Howard S.C.D.
NAME
AND MEETS TECHNICAL REQUIREMENTS
[Signature] DATE 11-18-74
SIGNATURE
U.S. SOIL CONSERVATION SERVICE
THIS DEVELOPMENT PLAN IS APPROVED FOR SOIL EROSION AND SEDIMENT CONTROL BY THE HOWARD SOIL CONSERVATION DISTRICT
APPROVED [Signature] DATE 11-18-74
HOWARD S.C.D.

"I CERTIFY THAT ALL DEVELOPMENT AND/OR CONSTRUCTION WILL BE DONE ACCORDING TO THIS PLAN OF DEVELOPMENT AND PLAN FOR EROSION AND SEDIMENT CONTROL. AND I ALSO AUTHORIZE PERIODIC ON-SITE INSPECTION BY THE HOWARD SOIL CONSERVATION DISTRICT OR THEIR AUTHORIZED AGENTS, AS ARE DEEMED NECESSARY. DEVIATION FROM THIS PLAN WILL NOT BE MADE UNLESS AUTHORIZED BY THE HOWARD SOIL CONSERVATION DISTRICT."
[Signature] 12/1/74
SIGNATURE OF DEVELOPER DATE



JOHNSON - M. CORDIC - THOMPSON, P.A.
ENGINEERS • PLANNERS • SURVEYORS
1820 ELTON ROAD
SILVER SPRING, MD.
434-7000 20803

PROPOSED STORAGE ADDITION
SEDIMENT CONTROL PLAN
FELDMAN-BLUMBERG TRACT
SIXTH ELECTION DISTRICT
HOWARD COUNTY, MARYLAND

OWNER: GEORGE G. Mc DANIEL, JR.
Box 505 Tel. 277-5270
Huntville - Md. 20706

DESIGN	SHEET 2 OF 3
DRAWN S.T.D.	DATE JULY 74
APPROVED [Signature]	SCALE 1" = 50'

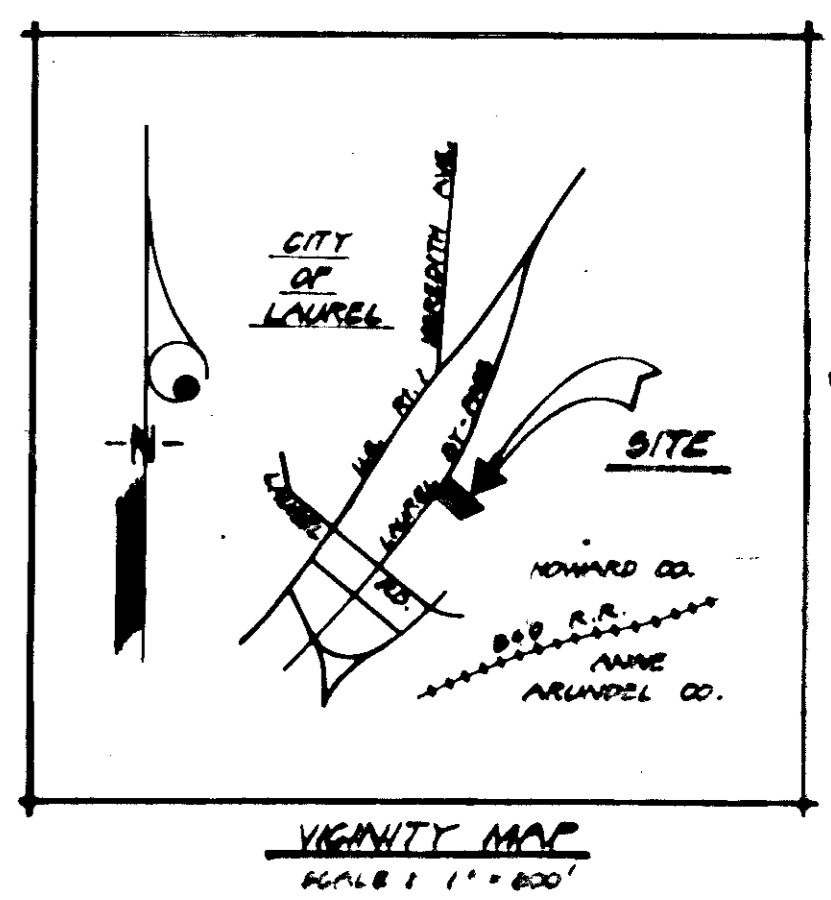
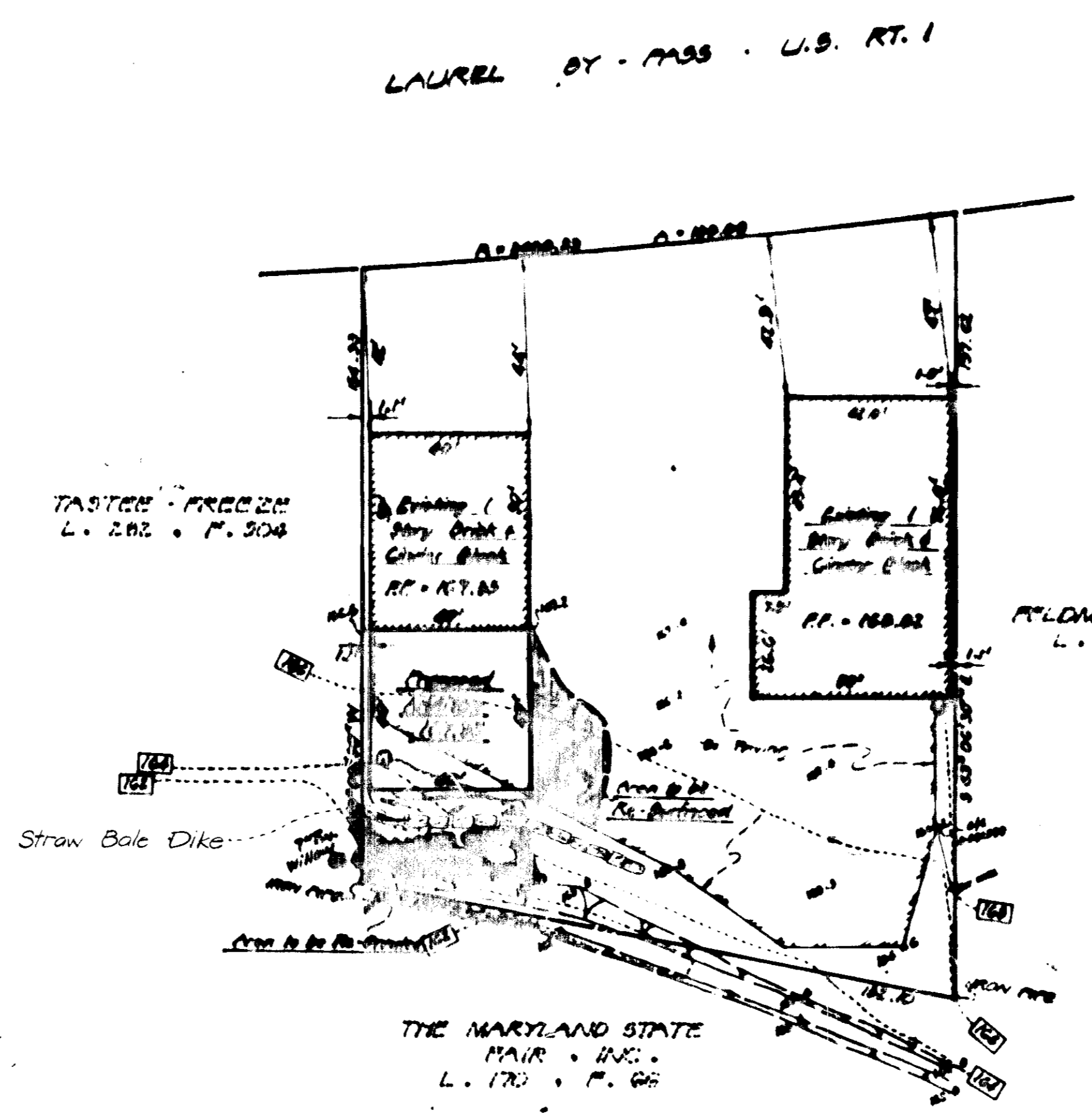
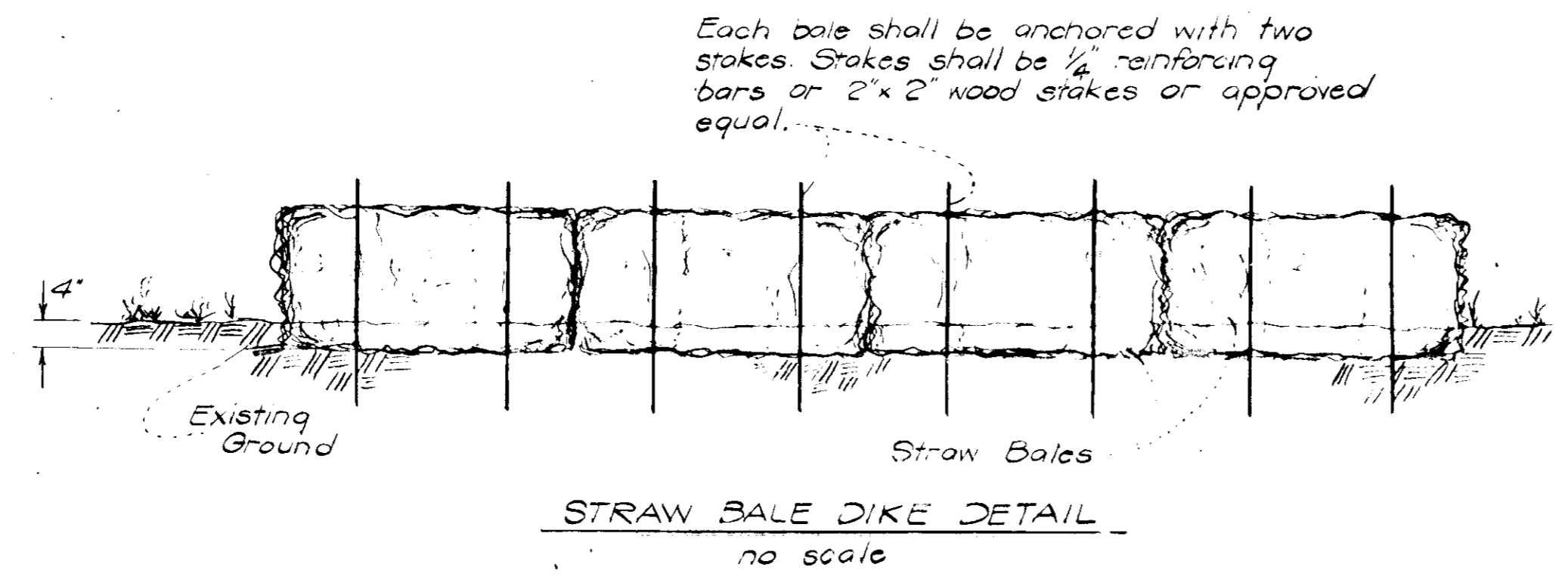

NOTES:

1. Utilities Shown Taken From Plans Furnished By Howard County Metropolitan Commission And Actual Field Location
2. Zone M-1
3. Area 26,874 sq. ft. or 0.6032 ac
4. No. of Employees 0
5. Gross Floor Area 1000 sq. ft.
6. Parking Required 0 Shown 0
7. Parcel Tax Map NS 50
8. Recorded Liber 808 Page 308

SEQUENCE OF CONSTRUCTION:

1. Straw bale sediment dike installed Sept. 74
 2. Building construction started Sept. 74
 3. Building construction, paving and final stabilization completed May 74
- *Weather dependent