

REVISIONS			
ISSUE	BY	DATE	DESCRIPTION

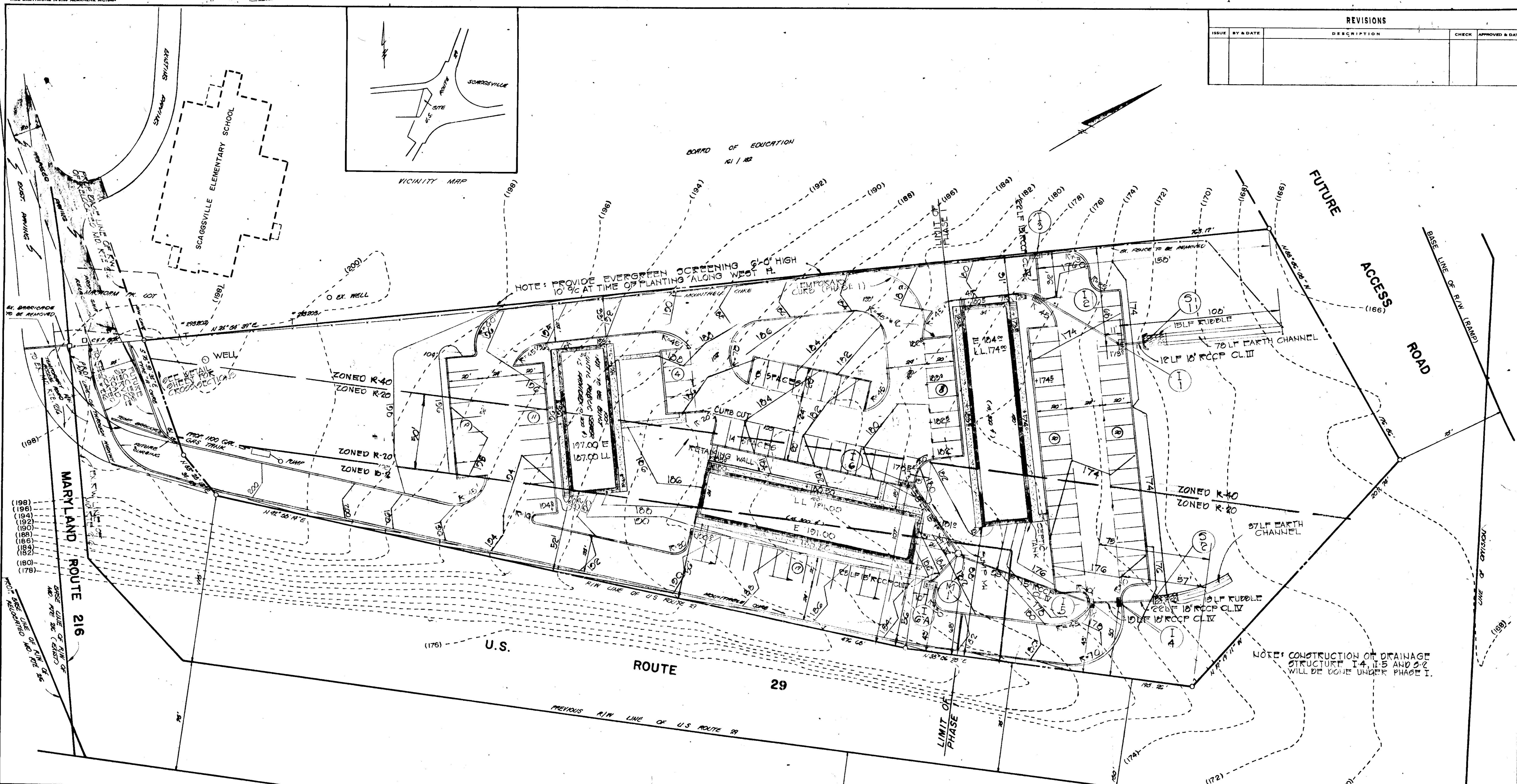

APPROVED FOR PRIVATE WATER AND PRIVATE SEWERAGE SYSTEMS.
 HOWARD COUNTY HEALTH DEPT.
[Signature] 10/17/74
 COUNTY HEALTH OFFICER

APPROVED HOWARD COUNTY OFFICE OF PLANNING & ZONING
 10-24-74
[Signature]
 PLANNING DIRECTOR

APPROVED FOR PRIVATE WATER AND PRIVATE SEWERAGE AND W. & S. STORM DRAINAGE SYSTEMS AND PAVES.
[Signature] 10/21/74
 DIRECTOR

APPROVED FOR PRIVATE WATER AND PRIVATE SEWERAGE AND W. & S. STORM DRAINAGE SYSTEMS AND PAVES.
[Signature] 10/21/74
 CHIEF, BUREAU OF HIGHWAYS

NOTE:
 EXISTING ZONING ON THIS PROPERTY IS R-40, R-20, & B-2
 SUBJECT TO A SPECIAL PERMIT.
 BOARD OF APPEALS DECISION:
 1. THAT THE PETITIONER PROVIDES ADEQUATE TREE SCREENING FOR THE PROPERTY.
 2. THAT THE LIGHTING INSTALLED AT THE PROPOSED OFFICE BUILDING AND PARKING FACILITIES BE OF SUCH INTENSITY AND DIRECTION SO AS TO NOT INTERFERE WITH THE BENEFICIAL ENJOYMENT OF THE SURROUNDING PROPERTY OWNERS IN THE USE OF THEIR PROPERTY.
 3. THAT ADEQUATE DRAINAGE FACILITIES BE MADE AVAILABLE TO THE SUBJECT PROPERTY SO AS NOT TO CAUSE INJURY TO ADJOINING PROPERTY BY THE INCREASE RUNOFF OF SURFACE WATER.
 B.A. CASE NUMBER 747C JULY 23, 1974

NOTES:
 1. AREA OF PARCEL: 3.86 ACRES
 2. PROPOSED BUILDING: 8-2, R-20, R-40
 3. NO. OF EMPLOYEES: 100
 4. TOTAL FLOOR SPACE: 40,000 sq ft
 5. TRX MAP: 46
 6. PRIVATE WATER & SEWER
 7. BUILDING COVERAGE: 24%
 8. PARKING REQUIRED: 25
 9. PARKING PROVIDED: 112
 10. DEED REFERENCE: GRS/008

NOTE:
 ROAD R/W LINES AND BEARINGS AND DISTANCES SHOWN HEREON ARE BASED ON S.R.C. R/W PLAT NO. 3892B.

NOTE:
 BASED ON FIELD R/W TOPO 8/19/74.

OWNER / DEVELOPER:
 RICHARD M. POULIOT
 9501 BRYANTWIRE NATIONAL PARK
 ELICOTT CITY, MD. 21043

NOTE:
 1. ALL ON-SITE PARKING & DRIVEWAY FACILITIES ARE PRIVATE.
 2. ALL INTERIOR CURB & GUTTER IS UNAVAILABLE.

LEGEND
 --- EX. CONTOURS
 --- PROP. CONTOURS
 --- S.P.E.T. ELEV.

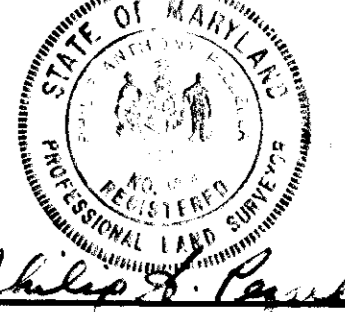

TITLE			
SITE DEVELOPMENT PLAN			
PROJECT			
POULIOT OFFICE BUILDING			
LOCATION			
FIFTH ELECTION DISTRICT HOWARD COUNTY, MARYLAND			
DATE:	DES. BY:	DRAWN BY:	CHKD. BY:
MARCH 1974	S	R	B
SCALE: 1" = 30'	JOB NO. 7382	DRWG. NO. 1 OF 4	



ENGINEERING
 PLANNING
 SURVEYING
 BY
BOENDER ASSOCIATES INC.
 BALTIMORE, MD. 466-7777
 SALISBURY, MD. 749-1286
 WESTMINSTER, MD. 946-9588

[Signature]
 DATE

REVISIONS			
ISSUE	BY & DATE	DESCRIPTION	CHECK APPROVED & DATE

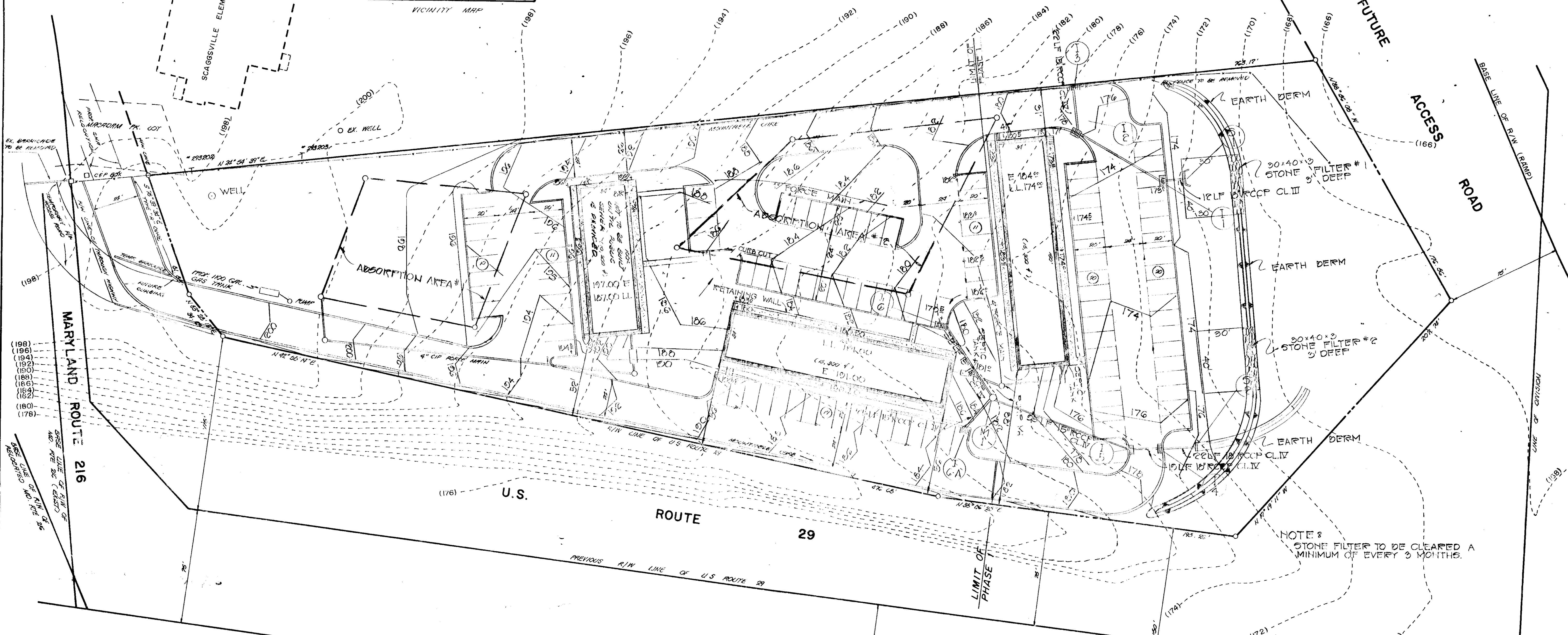
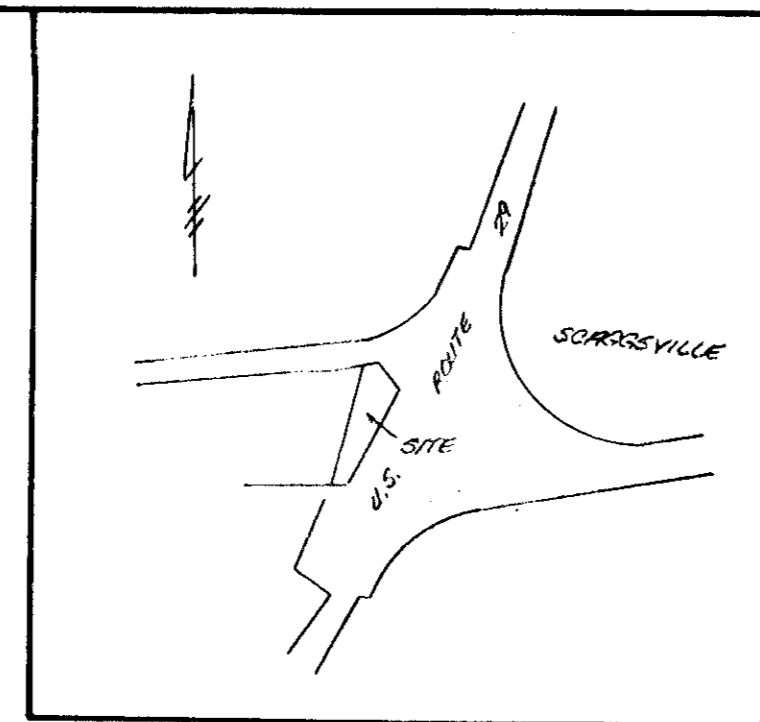

APPROVED FOR PRIVATE WATER AND PRIVATE SEWERAGE SYSTEMS:
 HOWARD COUNTY HEALTH DEPT.
 J. W. ... 10/11/74
 COUNTY HEALTH OFFICER

APPROVED HOWARD COUNTY OFFICE OF PLANNING & ZONING
 10-24-74
 PLANNING DIRECTOR

APPROVED FOR PRIVATE WATER AND PRIVATE SEWERAGE AND W.D. SYSTEM UPRGRADE SYSTEMS AND PERMS:
 W. ... 10/23/74
 DIRECTOR

APPROVED FOR PRIVATE WATER AND PRIVATE SEWERAGE AND W.D. SYSTEM UPRGRADE SYSTEMS AND PERMS:
 J. H. ... 10/21/74
 CHIEF, BUREAU OF HIGHWAYS

NOTE:
 EXISTING ZONING ON THIS PROPERTY IS R-10, R-20, & B-2 SUBJECT TO A SPECIAL PERMIT.
 BOARD OF APPEALS DECISION
 1. THAT THE PETITIONER PROVIDES ADEQUATE TREE SOFTENING FOR THE PROPERTY.
 2. THAT THE LIGHTING INSTALLED AT THE PROPOSED OFFICE BUILDING AND PARKING FACILITIES BE OF SUCH INTENSITY AND DIRECTION SO AS TO NOT INTERFERE WITH THE RESIDENCE ORIGINALLY OF THE PROPERTY.
 3. THAT ADEQUATE DRAINAGE FACILITIES BE MADE AVAILABLE TO THE SUBJECT PROPERTY SO AS NOT TO CAUSE INJURY TO ADJOINING PROPERTY BY THE INCREASED RAINFALL OF SURFACE WATER.

NOTES:
 1. AREA OF PARCEL: 3.86 ACRES
 2. PRESENT ZONING: B-2, R-20, R-30
 3. NO. OF EMPLOYEES: 100
 4. TOTAL FLOOR SPACE: 80,000 sq ft
 5. TOTAL WMP: 40
 6. PRIVATE WATER & SEWER
 7. BUILDING COVERAGE: 15%
 8. PARKING REQUIRED: 60
 9. LIGHTING PROVIDED
 10. LAND APPRAISAL: 100/100

NOTE:
 FOUND R/W LINES AND BEARINGS AND DISTANCES SHOWN HEREON WERE BASED ON S.R.C. R/W PLAN NO. 38926.

NOTE:
 BASED ON FIELD RUN TOPD 5/19/78.

OWNER / DEVELOPER:
 ROYALTY K. POULIOT
 9601 EASTHURST NATIONAL PARK
 COLLETT CITY, MD. 21036

NOTE:
 1. ALL ON-SITE PARKING & DRIVEWAY FACILITIES ARE PRIVATE.
 2. ALL INTERIOR CURB & GUTTER IS MOUNTAIN.

TITLE SEDIMENT CONTROL PLAN			
PROJECT POULIOT OFFICE BUILDING			
LOCATION FIFTH ELECTION DISTRICT HOWARD COUNTY, MARYLAND			
DATE: MARCH 1974	DES. BY: S	DRAWN BY: R	CHKD. BY: B
SCALE: 1" = 30'	JOB NO: 7382	DRWG. NO: 2 OF 4	DATE: 10/18/74

ENGINEERING
 PLANNING
 SURVEYING
 BY
BOENDER ASSOCIATES INC.
 BALTIMORE, MD. 466-7777
 SALISBURY, MD. 749-1286
 WESTMINSTER, MD. 848-6688

NO.	TYPE	INV. IN	INVERT	DEPTH	LOCATION	REMARKS
1-1	HO. CO. STD. CL. 15" INLET	162.50	162.45	173.0	AS SHOWN	SEE HO. CO. STD. DETAILS DRWG. D-100 & 101
1-2	HO. CO. STD. CL. 15" INLET	171.80	171.80	178.0	AS SHOWN	SEE HO. CO. STD. DETAILS DRWG. D-100 & 101
1-3	HO. CO. STD. S. COMB. INLET	173.00	173.00	178.0	AS SHOWN	SEE HO. CO. STD. DETAILS DRWG. D-100 & 101
1-4	HO. CO. STD. CL. 15" INLET	172.00	171.95	177.0	AS SHOWN	SEE HO. CO. STD. DETAILS DRWG. D-100 & 101
1-5	HO. CO. STD. CL. 15" INLET	172.70	172.64	177.0	AS SHOWN	SEE HO. CO. STD. DETAILS DRWG. D-100 & 101
1-6	HO. CO. STD. DDL. S. INLET	-	172.03	179.5	AS SHOWN	SEE HO. CO. STD. DETAILS DRWG. D-101 & 102
1-6A	HO. CO. STD. DDL. S. INLET	-	172.03	180.0	AS SHOWN	SEE HO. CO. STD. DETAILS DRWG. D-101 & 102
1-11	HO. CO. STD. MANHOLE	-	174.71	181.7	AS SHOWN	SEE HO. CO. STD. DETAILS DRWG. D-101 & 102
1-1	HO. CO. STD. C. ENDWALL	-	160.00	-	AS SHOWN	SEE HO. CO. STD. DETAILS DRWG. D-100 & 101
1-2	HO. CO. STD. C. ENDWALL	-	171.42	-	AS SHOWN	SEE HO. CO. STD. DETAILS DRWG. D-100 & 101

NOTE: TOP ELEV. OF STRUCTURES TO BE FIXED BY ENGINEER IN FIELD

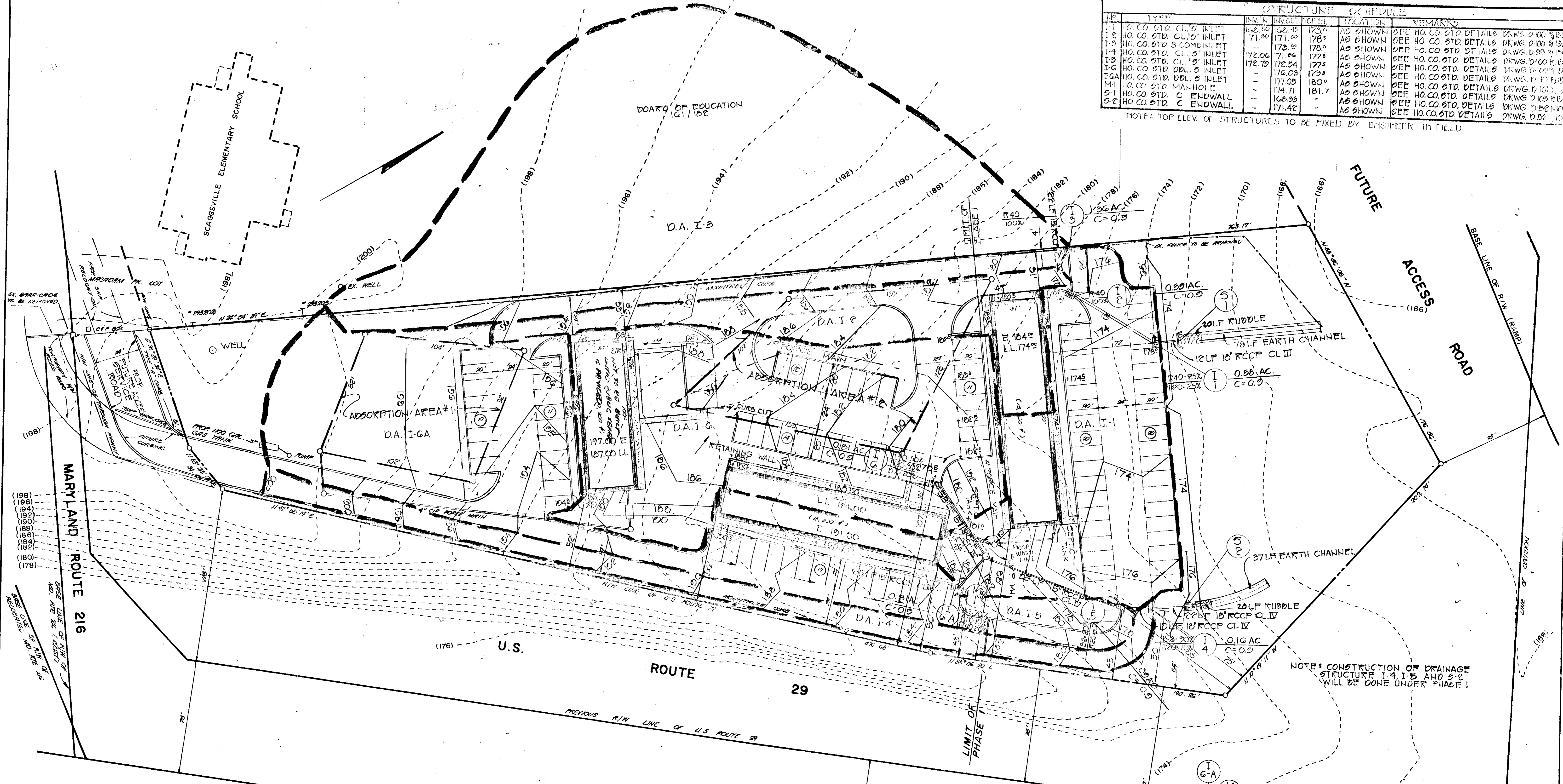

NOTE: CONSTRUCTION OF DRAINAGE STRUCTURE I-4, I-5 AND S-2 WILL BE DONE UNDER PHASE I

APPROVED FOR PRIVATE WATER AND PRIVATE SEWERAGE SYSTEMS:
 HOWARD COUNTY HEALTH DEPT.
 10/17/74
 COUNTY HEALTH OFFICER

APPROVED HOWARD COUNTY OFFICE OF PLANNING & ZONING
 10-24-74
 PLANNING DIRECTOR

APPROVED FOR PRIVATE WATER AND PRIVATE SEWERAGE AND WASTE WATER DISPOSAL SYSTEMS AND ROADS
 10/23/74
 DIRECTOR

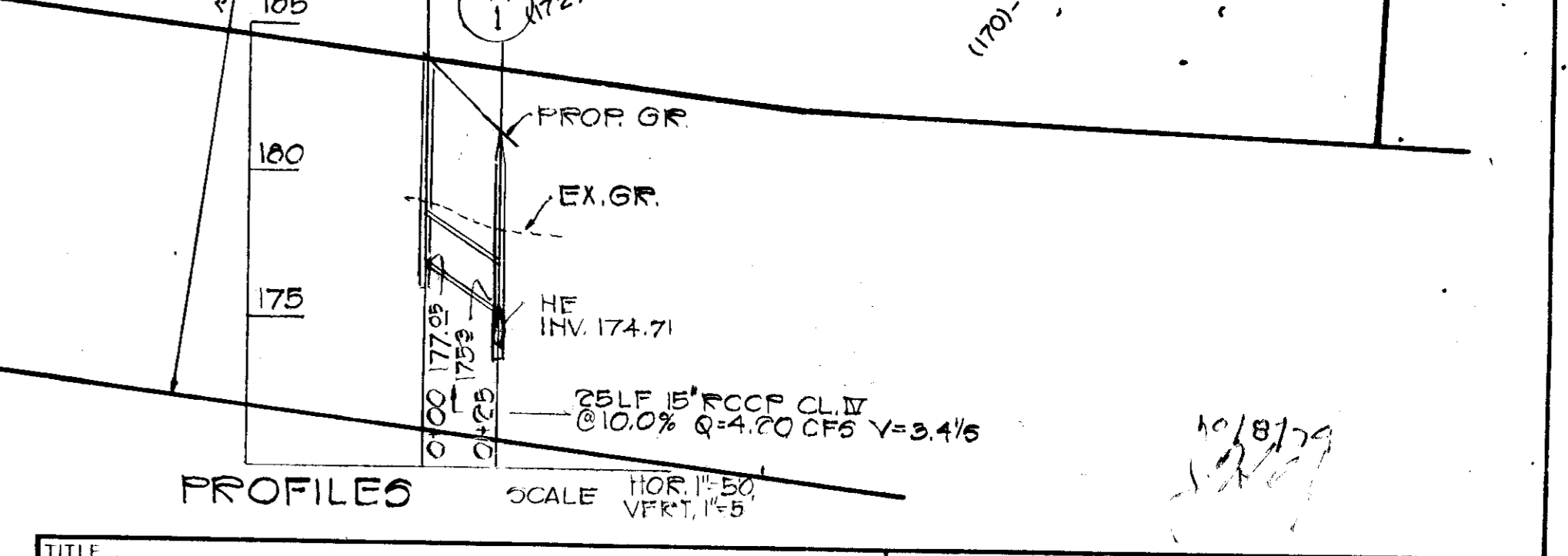
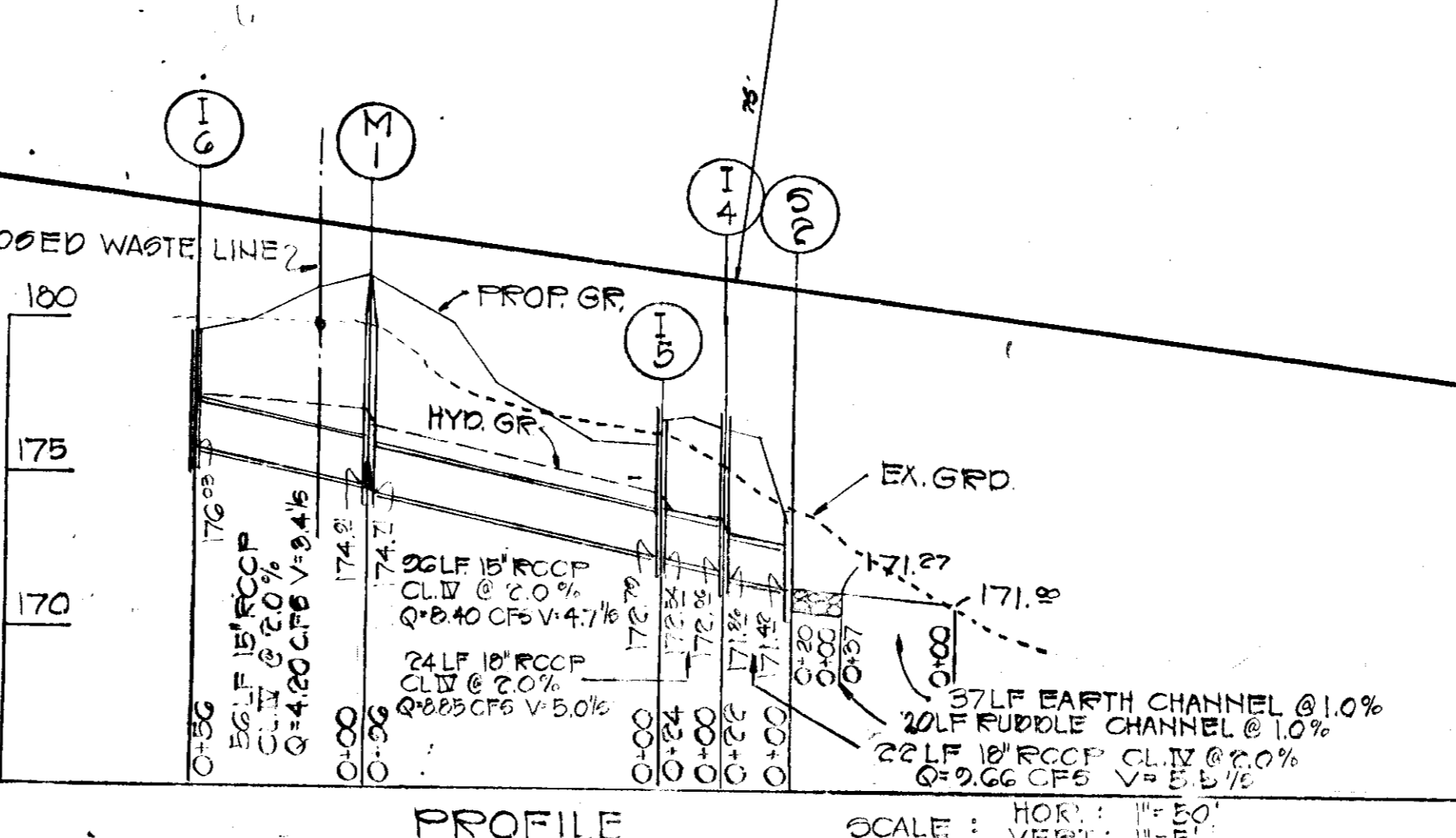
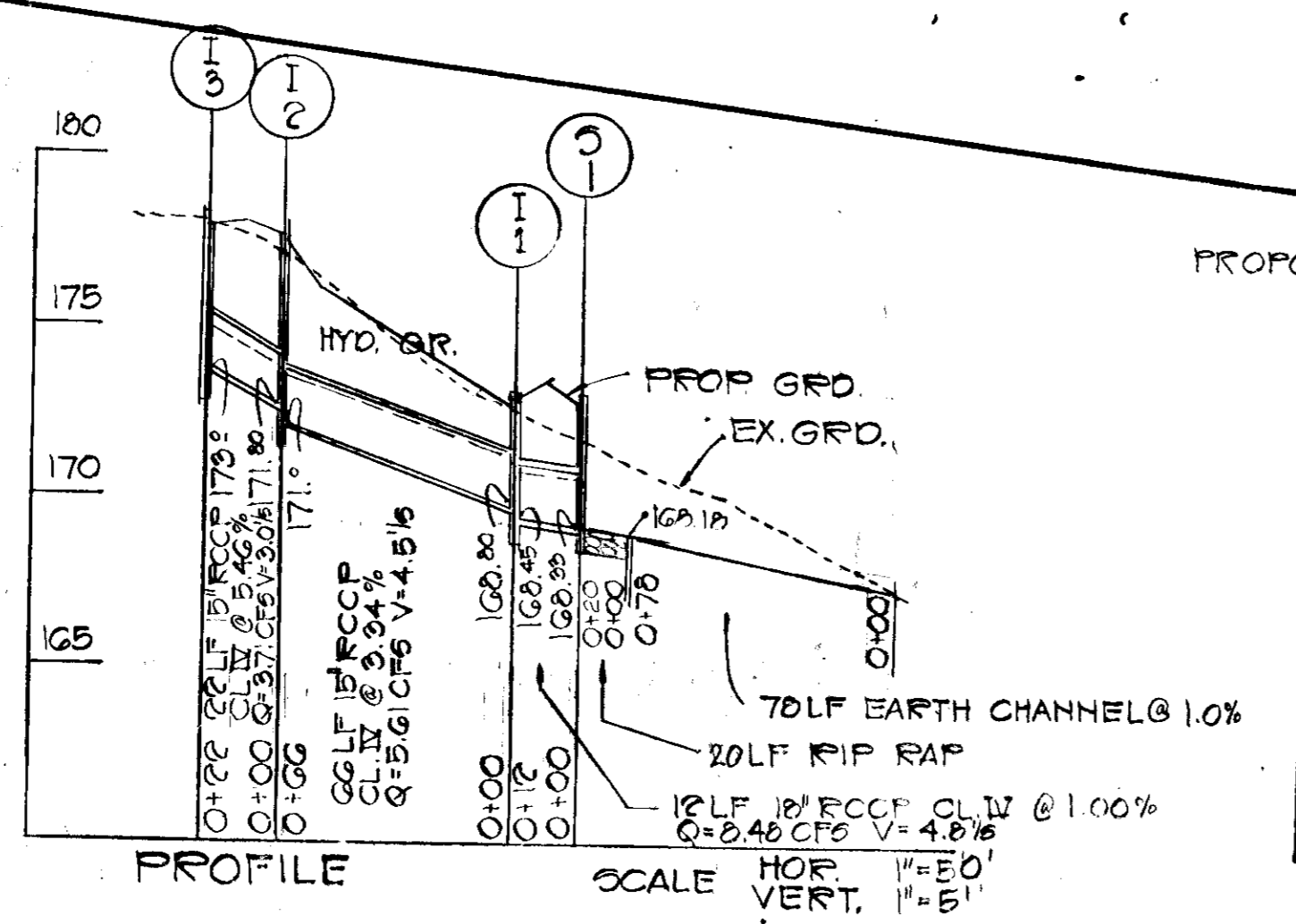

TITLE: DRAINAGE AREA MAP			ENGINEERING PLANNING SURVEYING BY BOENDER ASSOCIATES INC. BALTIMORE, MD. 466-7777 SALISBURY, MD. 740-7761 WESTMINSTER, MD. 848-5588	
PROJECT: POULIOT OFFICE BUILDING				
LOCATION: FIFTH ELECTION DISTRICT HOWARD COUNTY, MARYLAND	DATE: MARCH 1974	DES. BY: S	DRAWN BY: R	CHKD. BY: B
SCALE: 1" = 30'	JOB NO.: 7382	DRWG. NO.: 3 OF 4	DATE: 10/8/74	

SEDIMENT CONTROL NOTES

- 1) THE H. S. C. D. AND BUREAU OF LICENSE, INSPECTION, AND PERMITS WILL BE GIVEN 24 HOURS NOTICE PRIOR TO ANY GRADING.
- 2) ALL SEDIMENT CONTROL STRUCTURES SHOWN ON THIS PLAN, UNLESS OTHERWISE SPECIFIED, WILL BE INSTALLED AND STABILIZED IN ACCORDANCE WITH NOTE #9 PRIOR TO ANY OTHER GRADING OR EARTH DISTURBANCE ON THIS SITE.
- 3) AS SOON AS ROUGH GRADING IS COMPLETED, AREA TO BE PAVED WILL BE STABILIZED WITH BASE MATERIAL.
- 4) ALL CUT AND FILL SLOPES WILL BE A MAXIMUM OF 3 : 1.
- 5) FOLLOWING THE STABILIZATION OF ALL AREAS, UPGRADE THE AREA OF THE SEDIMENT CONTROL. MEASURES MAY BE REMOVED AND GRADED TO THE FINAL GRADES PLANNED AND STABILIZED IMMEDIATELY.
- 6) ELEVATIONS MARKED THUS (X) ARE FINISHED GRADES.
- 7) IN THE EVENT OF EXCESS OF MATERIAL, THE WASTE WILL BE STOCKPILED WITH A MAXIMUM 2:1 SLOPE ON AN AREA WHICH HAS BEEN CLEARED ON THE SITE, STOCKPILED MATERIAL WILL BE STABILIZED IN ACCORDANCE WITH NOTE #9.
- 8) SEDIMENT CONTROL MEASURES WILL NOT BE REMOVED UNTIL APPROVAL IS OBTAINED FROM THE H. S. C. D..
- 9) TEMPORARY STABILIZATION:
APPLY: 2000 LBS. / ACRE OR 46 LBS. / SQ. FT. OF PULVERIZED DOLOMITIC LIMESTONE.
500 LBS. / ACRE OR 11.5 LBS. / 1000 SQ. FT. OF 5-5-5 FERTILIZER. PLANT TO RYEGRASS @ 40 LBS. / ACRE. FERTILIZE WITH 5-10-10, AND MULCH WITH STRAW @ 1 1/2 TONS / ACRE.
- 10) PERMANENT STABILIZATION:
APPLY: 2000 LBS. / ACRE OF PULVERIZED DOLOMITIC LIMESTONE.
700 LBS. / ACRE OF 0-20-0 SUPER PHOSPHATE.
1000 LBS. / ACRE OF 5-10-10 FERTILIZER.
SEED: 85 LBS. / ACRE OF KENTUCKY 31 TALL FESCUE.
40 LBS. / ACRE OF KENTUCKY BLUE GRASS.
25 LBS. / ACRE OF ANNUAL RYE GRASS.
NOTE: SEEDING MAY BE DONE BETWEEN MARCH 1 - MAY 1, OR AUGUST 1 - OCTOBER 1 ONLY.
MULCH: 2 TONS / ACRE OF UNWEATHERED WHEATSTRAW, TIE MULCH DOWN WITH 480 GAL. / ACRE OF LIQUID ASPHALT.

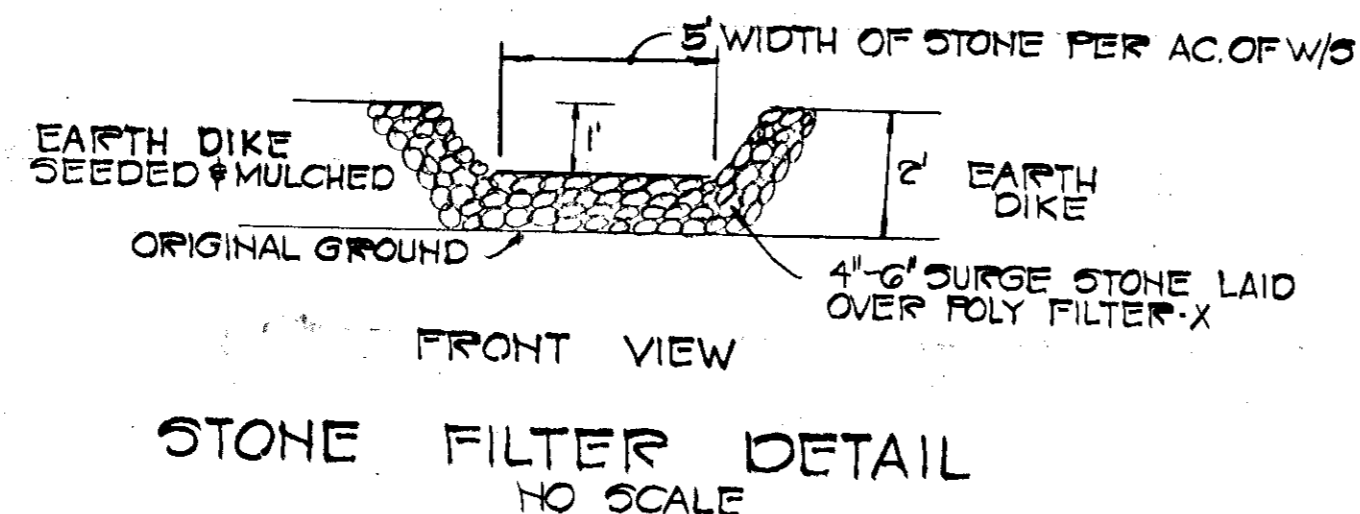
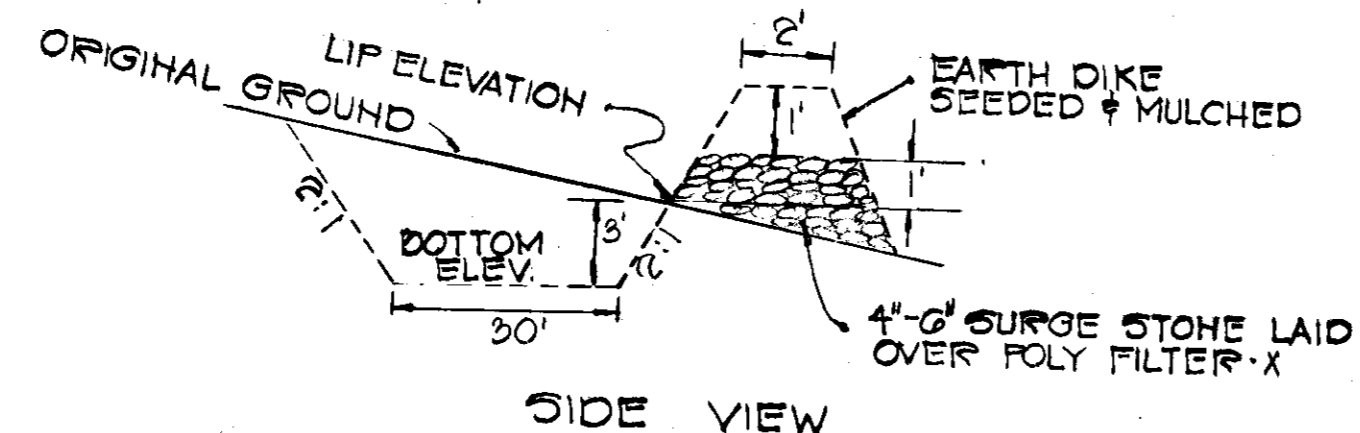

STONE FILTER DETAIL
NO SCALE

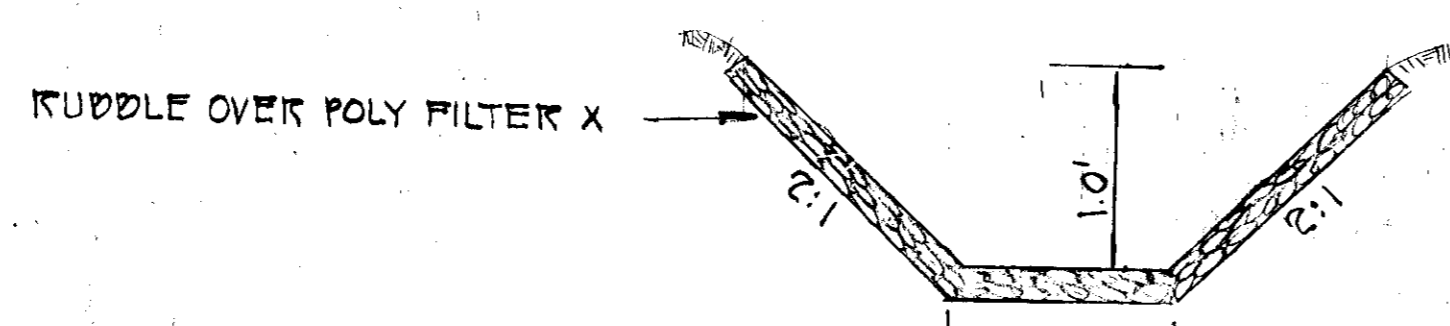

TYP. RIP RAP SEC. 5-2
NO SCALE

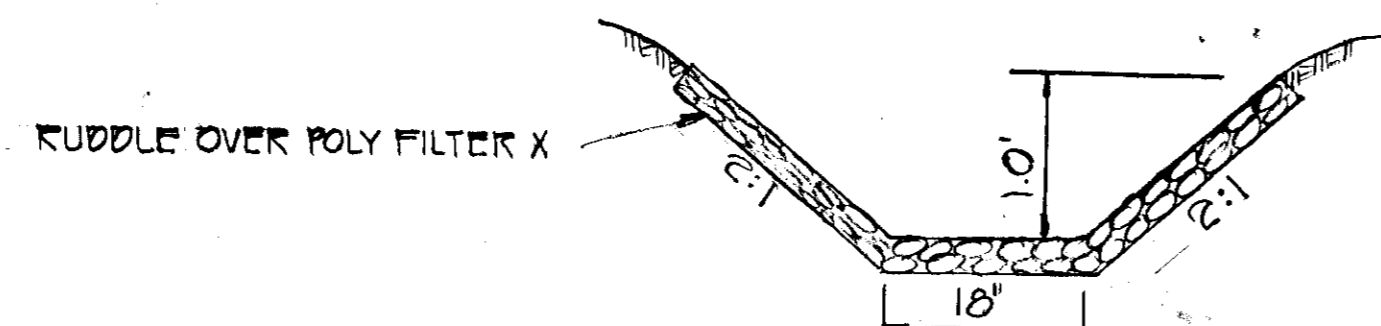

TYP. RIPRAP SEC. 3-1
NO SCALE

A=3.5
WP=6.1
HR=.57
DL=2.0%
V=.025
N=1.42
Q=14.44 CFS
QREQ=9.66 CFS

A=3.5
WP=6.1
HR=.57
DL=1.0%
V=.025
N=1.42
Q=10.22 CFS
QREQ=9.66 CFS

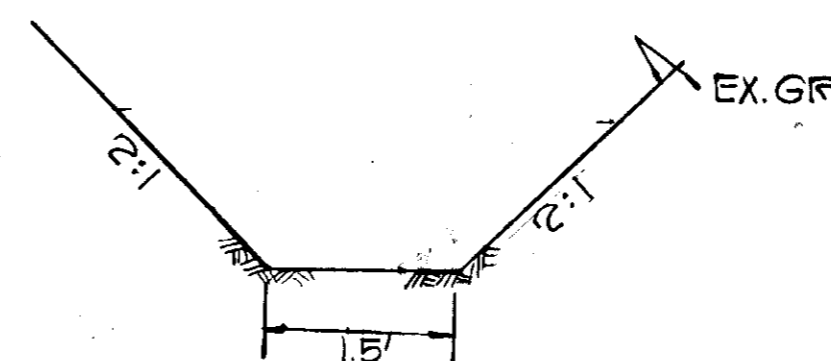

TYPICAL EARTH CHANNEL
NO SCALE

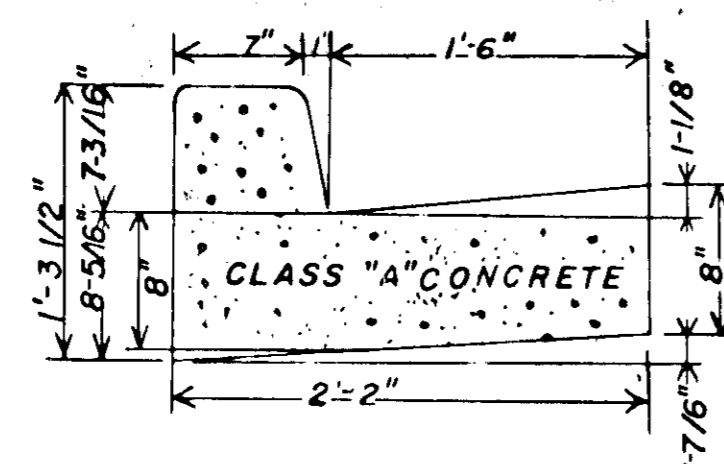

COMBINATION CURB & GUTTER DETAIL

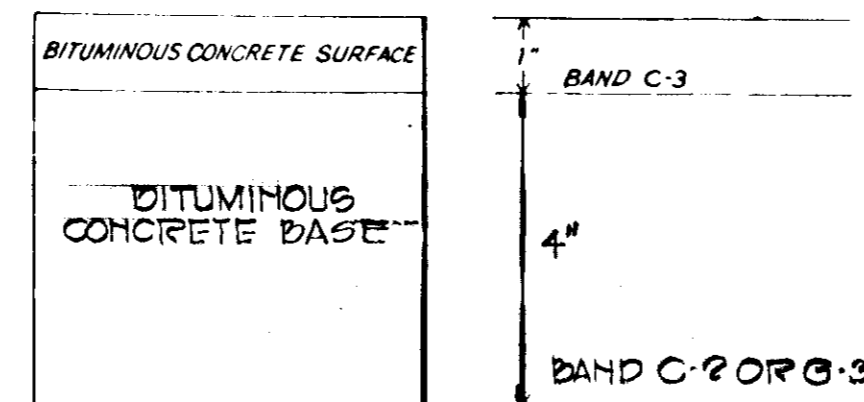

CLEARING AND GRADING: ARTICLE C-1
SUBGRADE: ARTICLE C-2
BASE COURSE: ARTICLE C-3 OR C-3B
SURFACE: ARTICLE C-3

TO BE CONSTRUCTED IN ACCORDANCE WITH THE HOWARD COUNTY ROAD CONSTRUCTION CODE AND SPECIFICATIONS

DRWG. D-13, PG. 08

TYPICAL PAVING SECTION ON-SITE

PAVING SPECIFICATION

- 1) BASE WILL BE PRIMED IN ACCORDANCE WITH SECTION C-30-3 AS PROVIDED IN THE HOWARD COUNTY ROAD CONSTRUCTION CODE AND STANDARD SPECIFICATIONS.
- 2) TACK COAT IS REQUIRED IN ACCORDANCE WITH SECTION C-31-4 OF THE HOWARD COUNTY ROAD CONSTRUCTION CODE AND STANDARD SPECIFICATIONS.

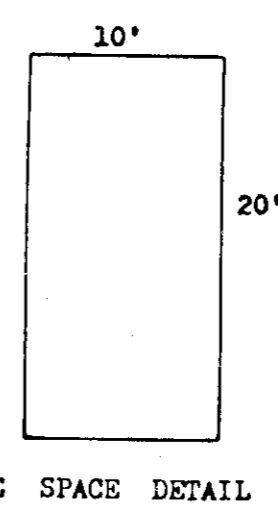

PARKING SPACE DETAIL

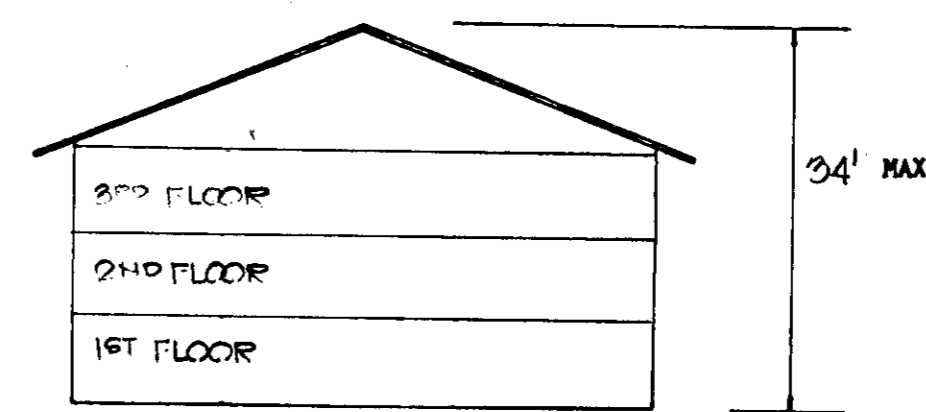

BUILDING PROFILE

APPROVED: FOR PRIVATE WATER AND PRIVATE SEWERAGE SYSTEMS.
HOWARD COUNTY HEALTH DEPARTMENT
[Signature] 10/17/74
COUNTY HEALTH OFFICER DATE

APPROVED: HOWARD COUNTY OFFICE OF PLANNING & ZONING.
[Signature] 10-24-74
PLANNING DIRECTOR DATE

[Signature] 10/24/74
CHIEF, DIVISION OF LAND DEVELOPMENT & TRANSPORTATION PLANNING DATE

APPROVED: FOR PRIVATE WATER AND PRIVATE SEWERAGE AND W.C. STORM DRAINAGE SYSTEMS AND ROADS.
[Signature] 10/23/74
DIRECTOR DATE

[Signature] 10/21/74
CHIEF, BUREAU OF HIGHWAYS DATE

REVIEWED FOR Howard S. C. D. AND PERMITS TECHNICAL REQUIREMENTS
[Signature] 10-16-74
U.S. SOIL CONSERVATION SERVICE DATE

THIS DEVELOPMENT PLAN IS APPROVED FOR SOIL EROSION AND SEDIMENT CONTROL BY THE HOWARD SOIL CONSERVATION DISTRICT
APPROVED: *[Signature]* 10-16-74
HOWARD SOIL CONSERVATION DIST. DATE

ENGINEER'S STATEMENT

I CERTIFY THAT THIS PLAN FOR EROSION AND SEDIMENT CONTROL REPRESENTS A PRACTICAL AND WORKABLE PLAN BASED ON MY PERSONAL KNOWLEDGE OF THE SITE CONDITIONS AND THAT IT WAS PREPARED IN ACCORDANCE WITH THE REQUIREMENTS OF THE HOWARD SOIL CONSERVATION DISTRICT.

[Signature] 12/27/73
DATE

[Signature] 4/10/74
DATE

DEVELOPER'S STATEMENT

I CERTIFY THAT ALL THE DEVELOPMENT AND / OR CONSTRUCTION WILL BE DONE ACCORDING TO THIS PLAN OF DEVELOPMENT AND PLAN FOR EROSION AND SEDIMENT CONTROL, AND I ALSO AUTHORIZE PERIODIC ON - SITE INSPECTION BY THE HOWARD SOIL CONSERVATION DISTRICT OR THEIR AUTHORIZED AGENTS, AS ARE DEEMED NECESSARY, DEVIATION FROM THIS PLAN WILL NOT BE MADE UNLESS AUTHORIZED BY THE HOWARD SOIL CONSERVATION DISTRICT.

[Signature] 12/27/73
DATE

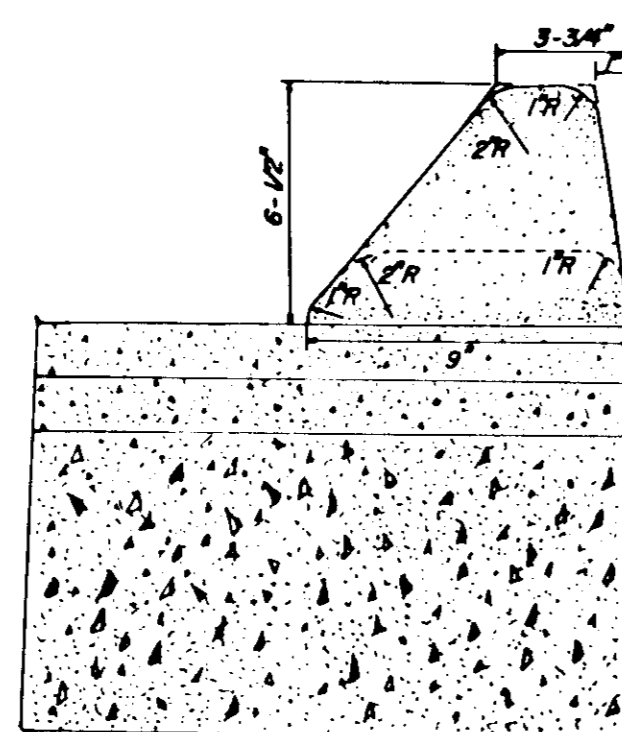

MOUNTABLE CURB DETAIL
NO SCALE

DRAWING D - 39 PAGE 04

SITE ANALYSIS:

- 1) TAX MAP NUMBER -
- 2) PARCEL NUMBER -
- 3) TOTAL AREA OF SITE -
- 4) PRESENT ZONING -
- 5) TOTAL NUMBER OF EMPLOYEES -
- 6) TOTAL FLOOR SPACE -
- 7) SUBDIVISION PLAT REFERENCE -

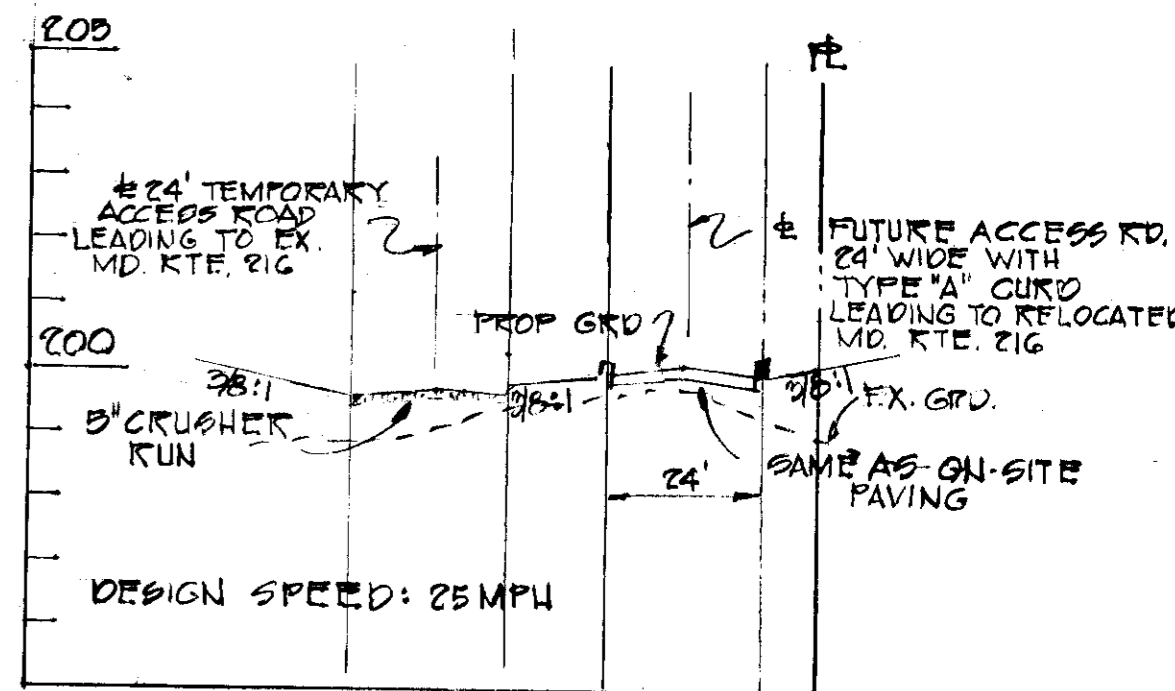

CROSS SECTION OF ACCESS ROADS TO MD. RTE. 216
NO SCALE

DIVERSION DIKE

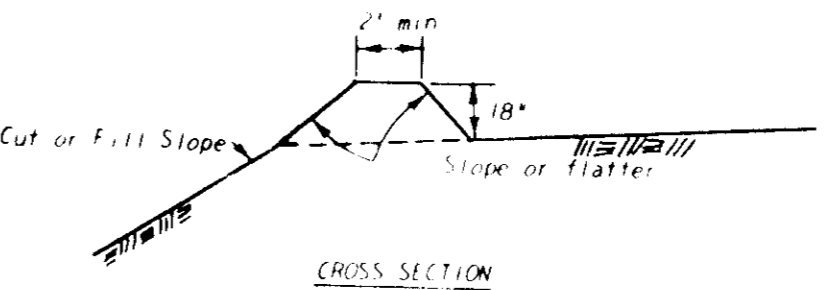

CROSS SECTION

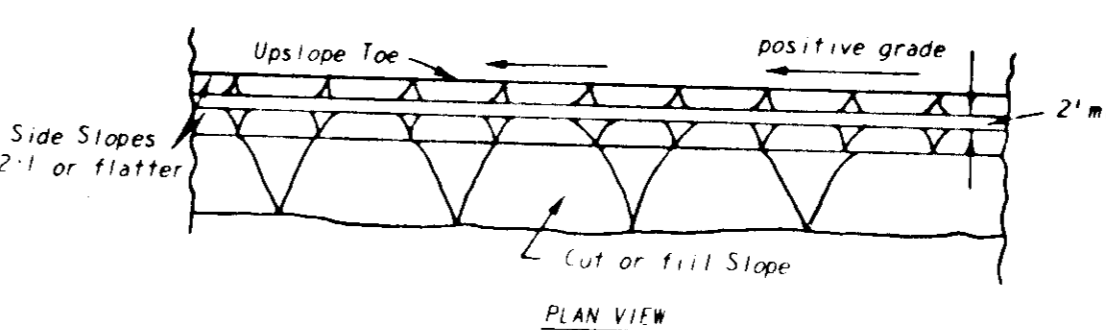

PLAN VIEW

General Notes:

1. All drawings Not to Scale.
2. All dikes must be machine compacted.
3. All diversion dikes must have positive grade draining to a stabilized outlet.
4. Diverted runoff will outlet onto a stabilized undisturbed area, a prepared level spreader, or into a grade stabilization structure.
5. Periodic inspection and required maintenance must be provided.

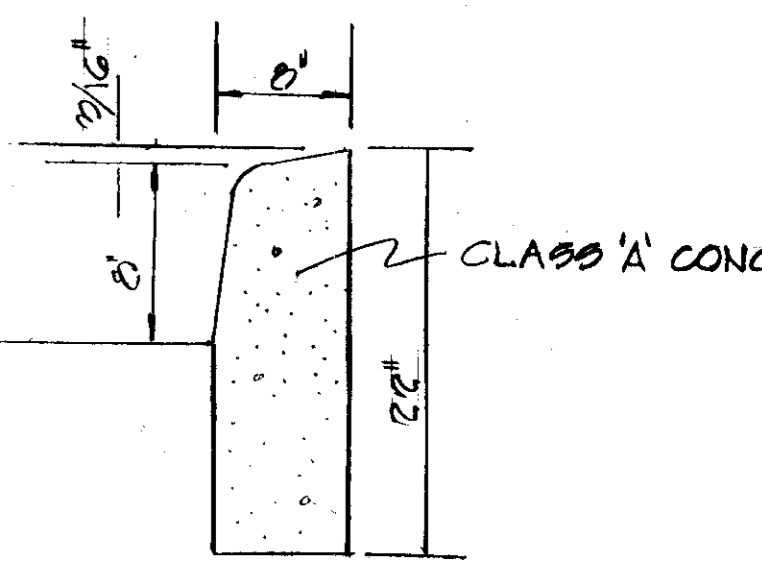

S.R.C. TYPE 'A' CURB
NO SCALE

TITLE	DETAIL SHEET		ENGINEERING PLANNING SURVEYING
PROJECT	FOULIOT OFFICE BUILDING		BY
LOCATION	8TH ELECTION DISTRICT, HOWARD CO., MD.		BOENDER ASSOCIATES INC.
DATE	3/26/74	DES. BY T.K.S.	DRAWN BY D.R. CHKD BY T.K.S.
SCALE	AS SHOWN	JOB NO. 7382	DRWG. NO. 4 OF 4

ENGINEERING PLANNING SURVEYING
BY
BOENDER ASSOCIATES INC.
ELICOTT CITY, MD. 21043
SALISBURY, MD. 21801
301 485-7272

SDP 24-67