

VICINITY MAP

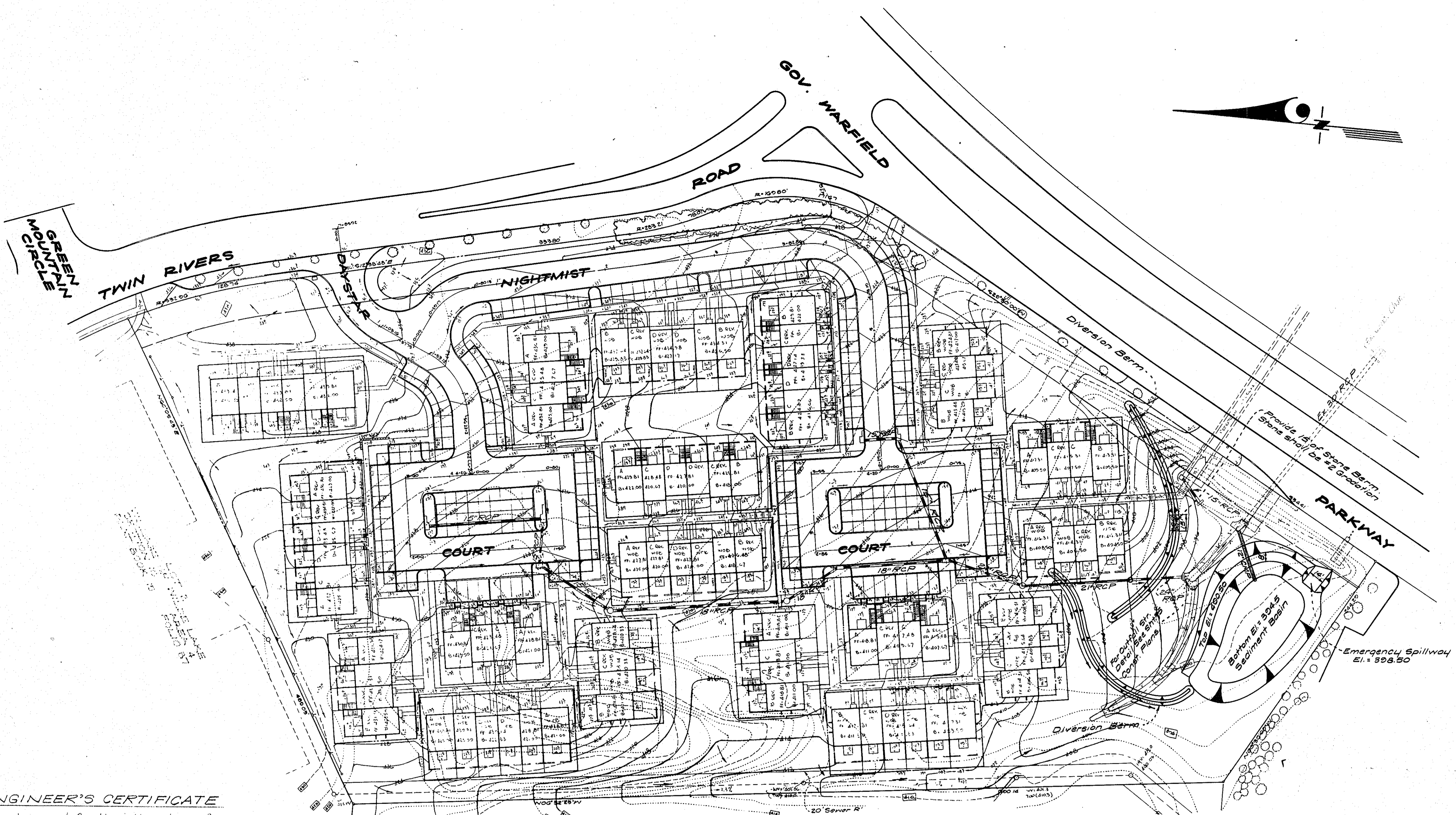

- GENERAL NOTES**
1. Prior to any construction, sediment control practices will be installed & stabilized. See General Note #6.
  2. Stabilization of disturbed ground to be done as soon after construction as possible.
  3. All Sediment Control Practices to conform to the "Erosion & Sediment Control Technical Handbook" as published by the Howard Soil Conservation District. For details & dimensions not shown on this plan refer to this handbook.
  4. Diversion Berms & Sediment Basins to be removed only after written approval from the Howard Conservation District has been obtained.
  5. All Diversion Berms will be temporarily seeded with Rye Grass after installation.
  6. All disturbed areas shall be finished graded to a slope of 3:1 or less; seed bed shall be prepared with 1 ton/100 of ground agricultural limestone and 10 tons/100 of 10-10-10 fertilizer; seeding shall be 3 lbs/1000 S.F. of 50-50 mixture of Kentucky Bluegrass and Creeping Red Fescue; and mulching shall be 1 1/2 tons/100 of weed free grain straw.
  7. Clean out of Sediment Basin shall be required when Sediment reaches 6" below top of riser.

**ENGINEER'S CERTIFICATE**

I hereby certify that the plan of development and the plan for control of silt & erosion meet the requirements, standards and specifications of the Howard Soil Conservation District.

*James M. Nelson*  
J. NELSON CLARK  
6-20-72  
Date



**DEVELOPER'S CERTIFICATE**

I hereby certify that all development and/or construction will be done according to this plan of development and plan of silt & sediment control.

*John A. Call*  
Signature  
6-20-72  
Date

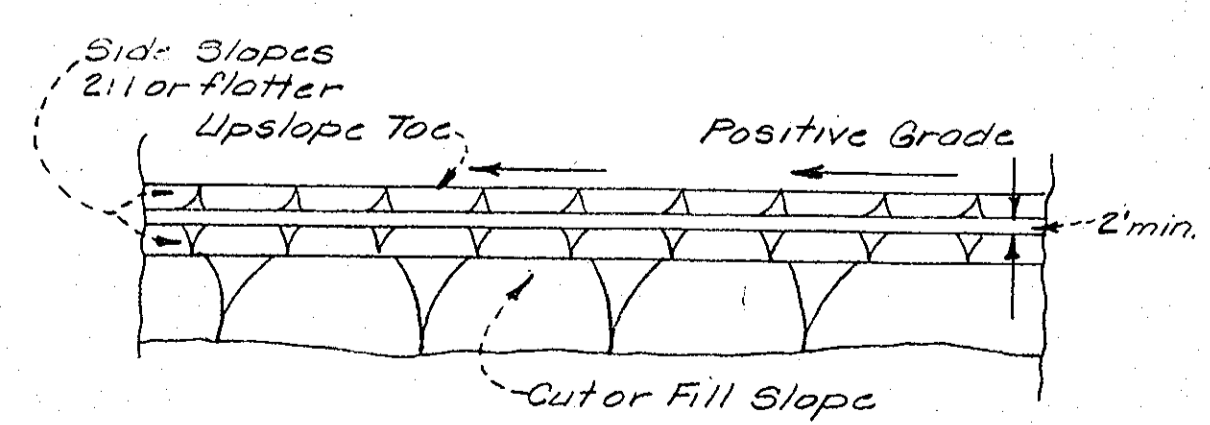
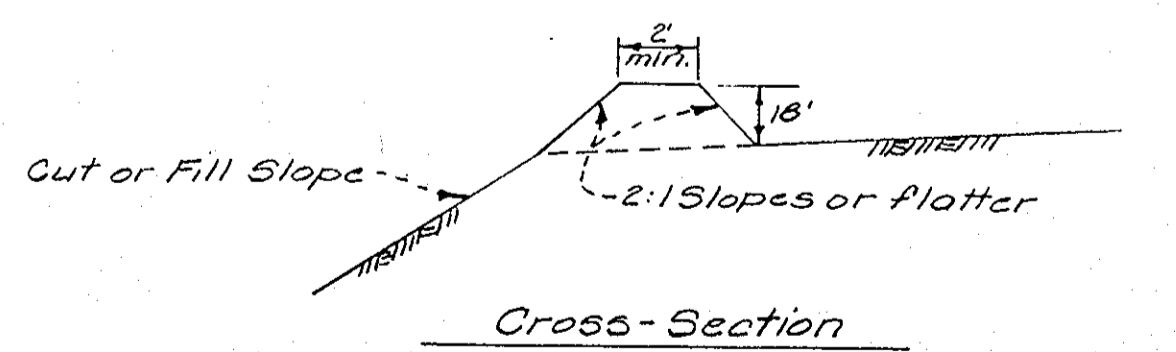

DIVERSION BERM  
M.S.C.D. D.B.-1

PLAN  
Scale: 1" = 50'

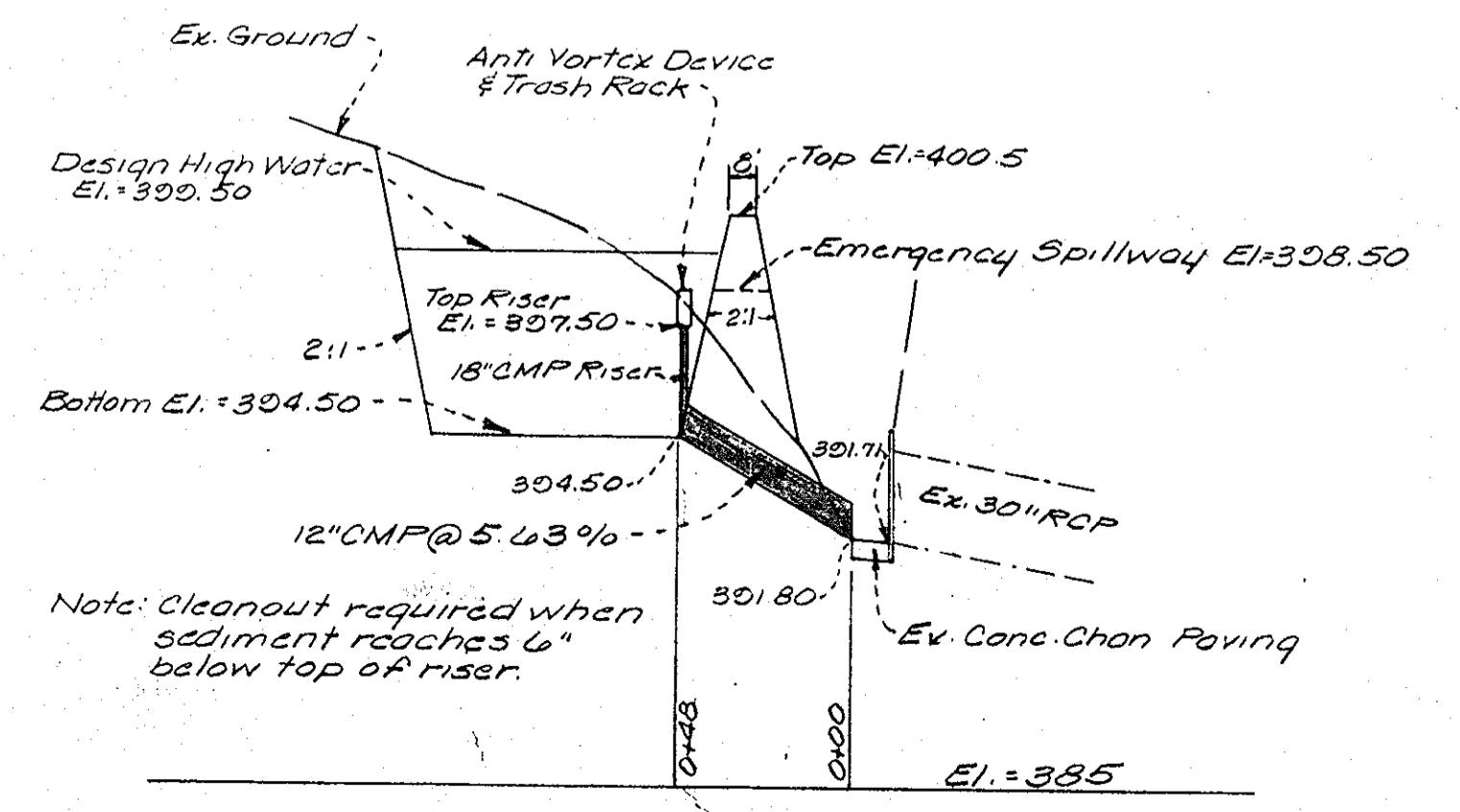

THIS DEVELOPMENT PLAN IS APPROVED FOR SOIL EROSION & SEDIMENT CONTROL BY THE HOWARD SOIL CONSERVATION DISTRICT

REVIEWED: *James M. Nelson*  
DISTRICT CONSERVATIONIST  
10-20-72  
DATE

APPROVED: *John A. Call*  
HOWARD SOIL CONSERVATION DISTRICT  
10-20-72  
DATE

<b>CLARK • FINEFROCK &amp; SACKETT</b> ENGINEERS • PLANNERS • SURVEYORS 11161 NEW HAMPSHIRE AVENUE • SILVER SPRING, MARYLAND 20904 • (301) 593-3400		
DESIGNED	SEDIMENT EROSION CONTROL PLAN	SCALE
D.A.B.	A Resubdivision of Lot 4	As Shown
DRAWN	<b>COLUMBIA</b>	DRAWING
Suzon	VILLAGE OF WILDE LAKE	1 of 1
CHECKED	SECTION 10	JOB NO.
G.N.C.	5TH ELECTION DISTRICT	72-485
DATE	FOR: RYLAND HOMES COLUMBIA DIVISION	FILE NO.
June, 1972	Suite 200 V.O.M. Office Building	1066-D
	Columbia, Maryland 21043	