

SITE PLAN SCALE 1" = 20'-0"

**GENERAL NOTES**

- NOTE THAT ON THESE PLANS ALL CONSTRUCTION MATERIALS AND DETAILS SHALL BE IN ACCORDANCE WITH THE LATEST REVISIONS OF THE HOWARD CO. ROAD CONSTRUCTION CODE AND STANDARD SPECIFICATIONS.
- PUBLIC WATER & SEWER FACILITIES ARE AVAILABLE & ADEQUATE.
- PROPOSED GRADE CONTOURS REPRESENT FINISHED GRADES. CONTRACTOR SHALL MAKE REQUIRED ALLOWANCES TO SUBGRADE FOR TOPSOIL, PAVING AND OTHER SURFACE FINISHES AS REQUIRED.
- LOCATIONS OF EXISTING UTILITIES ARE APPROXIMATE AND ARE OBTAINED FROM RECORD DRAWINGS. CONTRACTOR MUST VERIFY LOCATIONS AND DEPTH OF EXIST. UTILITIES BEFORE LAYING ANY PIPES.
- CONTRACTOR MUST NOTIFY THE FOLLOWING UTILITY COMPANIES PRIOR TO COMMENCING WORK:
  - BELL TELEPHONE SYSTEM 203-3649
  - LONG DISTANCE CABLE DIV. 303-3583
  - PALTO GAS & ELECTRIC CO. 527-8000 EXT. 691
- REFER TO DRAWING NO. S-11 FOR PROPERTY OUTLINE DATA, BUILDING DIMENSIONS, & TIES TO ADJACENT PROPERTY.
- REFER TO MECHANICAL PLANS FOR WATER, SEWER AND STORM DRAIN CONNECTIONS.
- REFER TO DRAWING NO. S-12 FOR UTILITY SKETCH PLAN & RELATED INFORMATION.
- THERE ARE NO EXISTING BUILDINGS ON THE SUBJECT SITE AT THE PRESENT TIME.
- THE PROPOSED TYPE OF BUILDING USE SHALL BE INCIDENTAL COMMERCIAL IN NATURE. TYPICAL USES: PET SHOP, SHOE STORE, BIKE SHOP, LAUNDRY, ETC.
- THERE ARE TO BE NO SIGNS, WALLS, OR FENCES CONSTRUCTED ON THIS SITE EXCEPT FOR STORE FRONT SIGN IDENTIFICATION SIGNS.
- A BUFFER SIGN SHALL BE PROVIDED BETWEEN THE SUBJECT PROPERTY AND THE ADJOINING PROPERTY TO THE NORTH TO CORRESPOND TO THE ACCOMPANYING PLAT DATED 2-14-72 FROM H.D. TO MATHIAS-PHILIP, INC. WHICH CLEARLY EXPLAINS THIS TOPIC.
- REFER TO ABOVE-MENTIONED CORRESPONDENCE RELATIVE TO EASEMENT AND CONSTRUCTION RIGHTS.

**GENERAL SITE INFORMATION**

- AREA OF SITE = 1.93+ ACRES
- PROJECTED NUMBER OF EMPLOYEES = 50
- TOTAL FLOOR AREA = 20,260 ± (ALL BLDGS. ARE SINGLE LEVEL)
- MAXIMUM BUILDING HEIGHT = 20'
- NUMBER OF PARKING SPACES PROVIDED = 98
- TRAFFIC ANALYSIS: A.D.T. = 600 TRIPS/DAY  
PEAK RATE = 60 TRIPS/HOUR

**SEDIMENT CONTROL NOTES:**

- SLAUSES IN REAR OF SHOPPING CENTER ARE TO BE GRADED USING REVERSE DRAIN PATTERN IN ORDER TO MINIMIZE EROSION & SOIL SLOTTATION. THESE ARE TO BE 30' WIDE.
- CONTRACTOR SHALL PROVIDE THE SEQUENCE OF CONSTRUCTION TO BE AS FOLLOWS:
  - STORM DRAIN CONSTRUCTION
  - INSTALLATION OF STONE BARRIERS

OWNED & DEVELOPED BY HOWARD RESEARCH & DEVELOPMENT CORP. COLUMBIA, MD.

PROPERTY DESCRIPTION: VILLAGE OF WILDE LAKE - SECTION 4 AREA 2 - LOTS 2-6 ELECTION DISTRICT NO. 6 RECORDED P.B. 12 FOLIO 38



5/3/72  
Thomas G. Harris Jr.

F.D.P. NO. PHASE 30-A

JOSEPH D. THOMPSON INC.  
Engineers & Surveyors  
1000 W. WASHINGTON ST.  
BETHESDA, MARYLAND 20814

APPROVED FOR CONSTRUCTION BY THE HOWARD COUNTY OFFICE OF PERMITS AND INSPECTION  
6-14-72  
6-14-72

APPROVED FOR CONSTRUCTION BY THE HOWARD COUNTY OFFICE OF PERMITS AND INSPECTION  
3-10-72  
6-14-72  
6-14-72

APPROVED FOR CONSTRUCTION BY THE HOWARD COUNTY OFFICE OF PERMITS AND INSPECTION  
6/6/72  
6/14/72

SITE PLAN DEVELOPMENT PLAN WILDE LAKE COMMERCIAL INC. HOWARD CO. MARYLAND  
SCALE: 1" = 20' DATE: OCT. 18, 1971  
RECORDED P.B. 12, FOLIO 38 DEVELOPMENT PLAN NO. 30-A

SDP72-64C

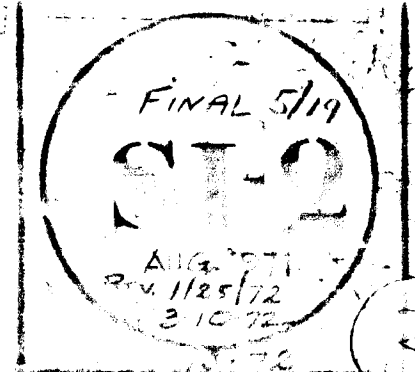
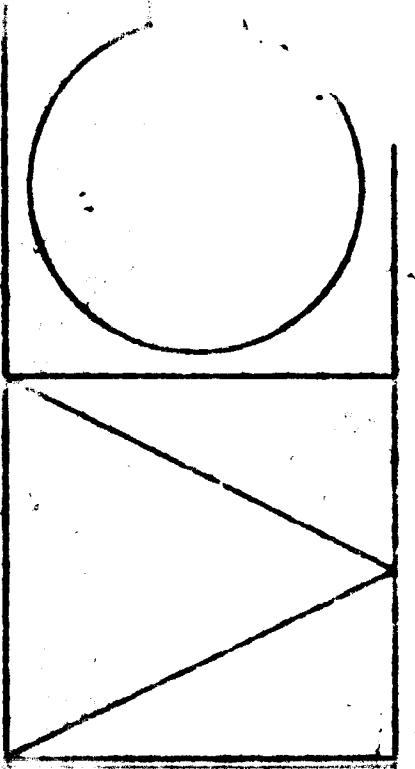

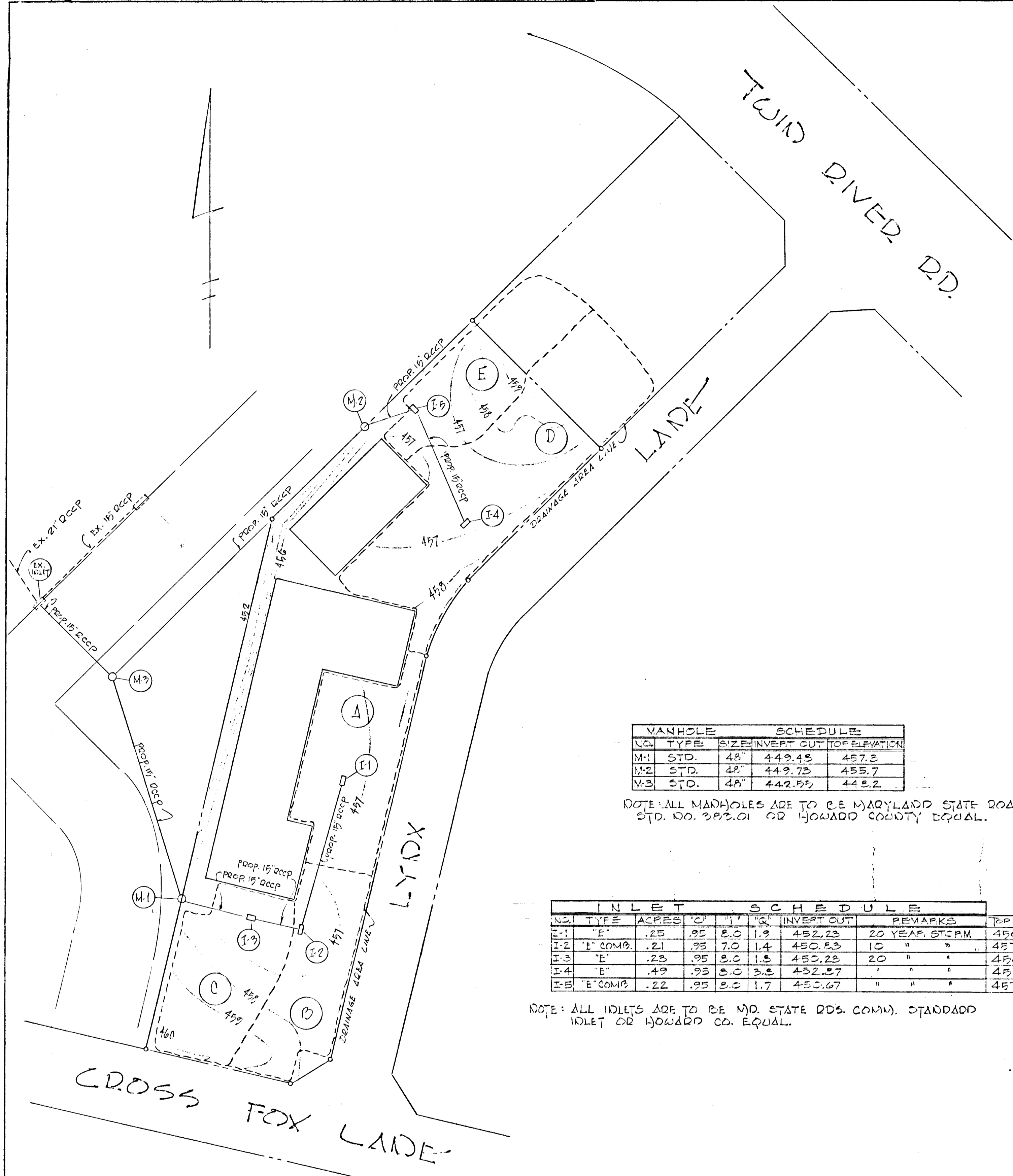

MANHOLE		SCHEDULE		
NO.	TYPE	SIZE	INVERT	TOP ELEVATION
M-1	STD.	48"	449.48	457.3
M-2	STD.	48"	449.73	455.7
M-3	STD.	48"	442.55	448.2

NOTE: ALL MANHOLES ARE TO BE MARYLAND STATE ROADS COMMISSION STD. NO. 382.01 OR HOWARD COUNTY EQUAL.

INLET		SCHEDULE			REMARKS	TOP ELEV.		
NO.	TYPE	ACRES	C	CA	INVERT	OUT		
I-1	"E"	.25	.95	8.0	1.3	452.25	20 YEAR STORM	456.25
I-2	"E" COMP.	.21	.95	7.0	1.4	450.83	"	457.0 (T.C.)
I-3	"E"	.23	.95	8.0	1.3	450.23	"	456.25
I-4	"E"	.49	.93	8.0	3.8	452.87	"	456.80
I-5	"E" COMP.	.22	.93	8.0	1.7	453.67	"	457.0 (T.C.)

NOTE: ALL INLETS ARE TO BE MD. STATE RDS. COM. STANDARD INLET OR HOWARD CO. EQUAL.

SITE PLAN  
DRAINAGE AREA MAP, PROFILES & DETAILS  
WILDE LAKE COMMERCIAL INC.  
HOWARD CO. MARYLAND  
SCALE: AS SHOWN DATE: OCT. 18, 1971  
REVISED: NOV. 2, 1971

JOSEPH D. THOMPSON INC.  
engineers & surveyors  
200 E. JOPPA ROAD  
BALTO. MD. 21204

APPROVED: For public water and public sewerage systems by Howard County Health Department.  
*Thomas L. Harris Jr.* 6-14-72  
County Health Officer Date  
APPROVED: Howard County, Office of Planning and Zoning  
*Thomas L. Harris Jr.* 6-14-72  
Planning Director Date  
APPROVED: Division of Land Development and Transportation Planning  
*J. W. Cleary* 6-14-72  
Date  
APPROVED: For public water, public sewerage and storm drainage systems and roads by Howard County Department of Public Works.  
*William A. Allen* 6/14/72  
Director Date  
*W. O. Felber* 6-12-72  
Chief, Bureau of Highways Date

APPROVED  
PLANNING BOARD  
OF HOWARD COUNTY  
DATE May 3, 1972  
*Thomas L. Harris Jr.*

STORM DRAIN FLOW COMPUTATIONS

LOCATION		ACRES			TIME CONC. MIN			PIPE 15" R.C.C.P.		REMARKS							
FROM	TO	ADFA	SIP	TOTAL	C	CA	ZCA	INLET	DDIN	TOTAL	I	Q	SIZE	SLOPE	VEL.	LENGTH	REMARKS
I-1	I-2	A	.25	—	.95	2.4	—	5	—	5	2.0	1.9	15"	.10	1.7	120	20 YR. STORM
I-2	—	B	.21	—	.95	.20	—	5	—	5	7.0	1.4	—	—	—	—	10 "
I-2	I-3	A-B	—	.46	—	—	.47	5	1.5	6.5	6.7	3.1	15"	.26	2.5	40	" "
I-3	—	C	.23	—	.95	2.2	—	5	—	5	2.0	1.8	—	—	—	—	20 "
I-3	M-3	A-C	—	.69	—	—	.73	6.5	.7	6.8	6.6	4.9	15"	.66	3.9	232	10 "
I-4	I-5	D	.49	—	.93	4.7	—	5	—	5	2.0	3.8	15"	0.4	3.1	100	20 "
I-5	—	E	.22	—	.93	2.2	—	5	—	5	2.0	1.7	—	—	—	—	" "
I-5	M-3	D-E	—	.71	—	—	.78	5	.5	5.5	6.7	5.4	15"	0.8	4.9	316	10 "
M-3	EX. INLET	A-E	—	1.40	—	—	1.51	6.8	1.0	7.8	6.4	9.7	15"	2.6	7.8	80	10 "

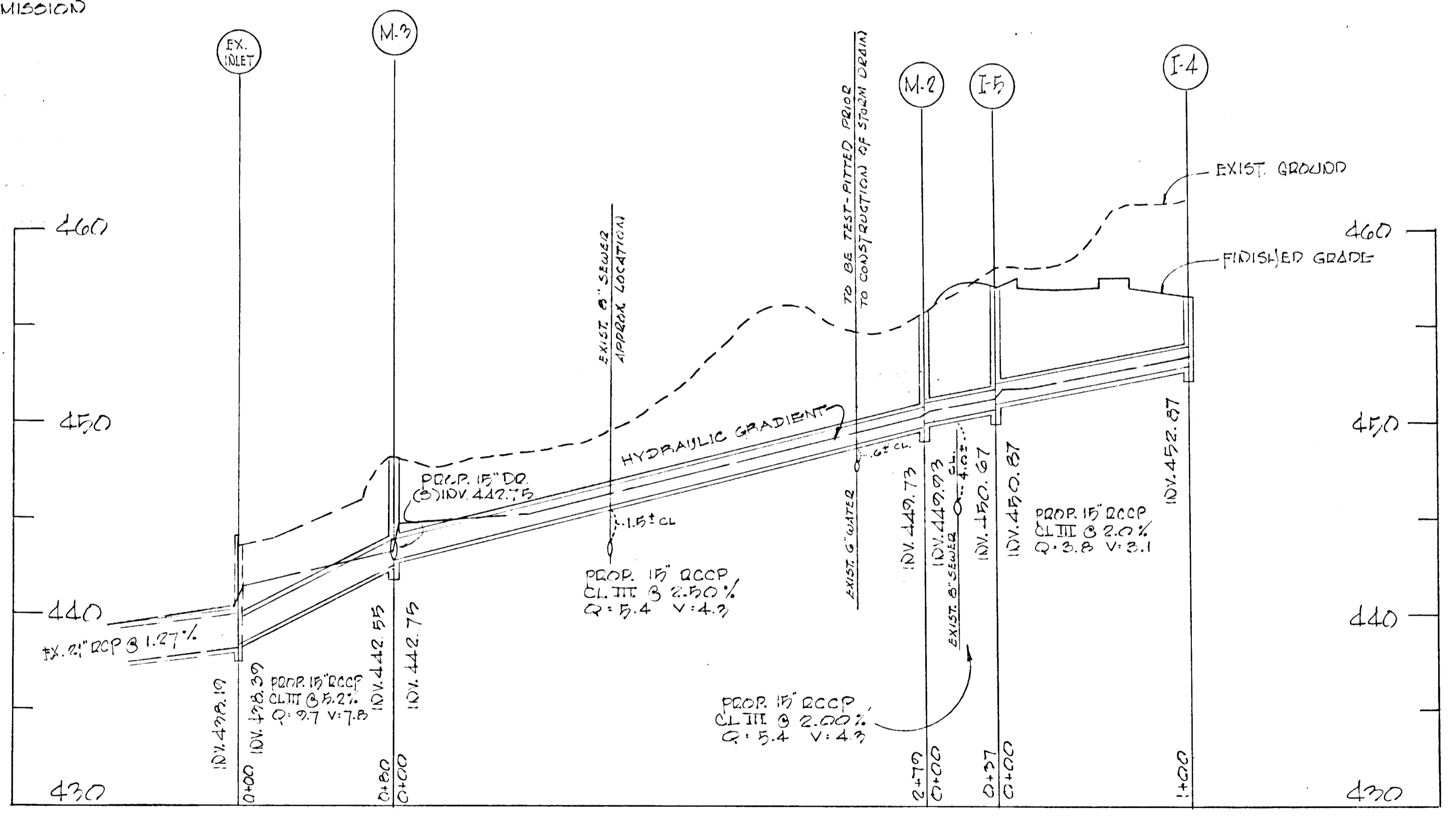
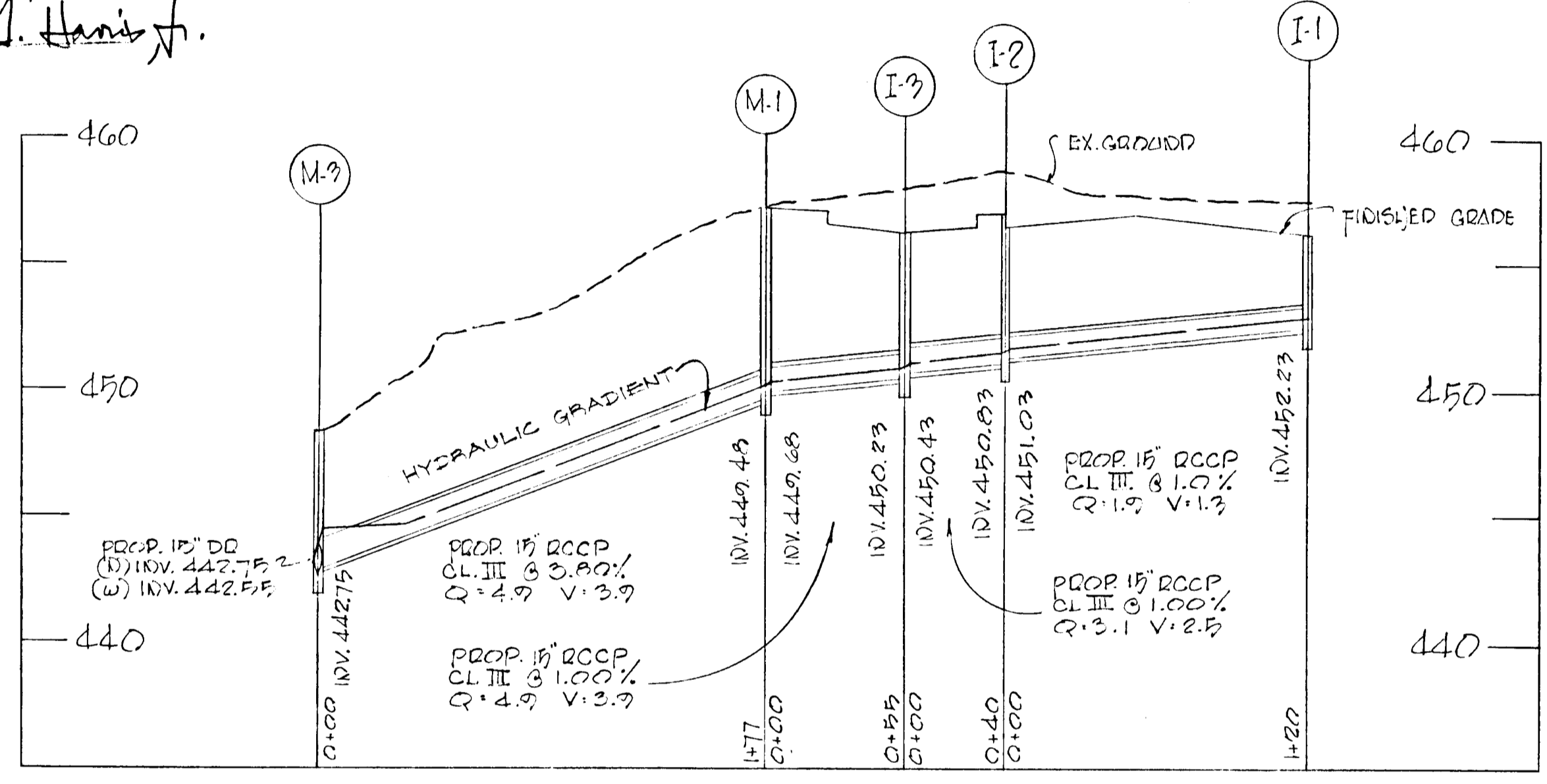

SCALE: HORIZONTAL: 1"=50'  
VERTICAL: 1"=10'

SDP 72-64C

C.P.F. D8-31-4

WILDE LAKE COMMERCIAL INCORPORATED  
 PROJECT OF COLUMBIA DEVELOPMENT CORPORATION  
 4815 S. COCKE  
 BALTIMORE, MARYLAND 21048  
 JAMES K. WOLFFORD  
 MECHANICAL ENGINEER

REV 1/25/72  
3-10-72  
4-13-72  
FINAL 5/11

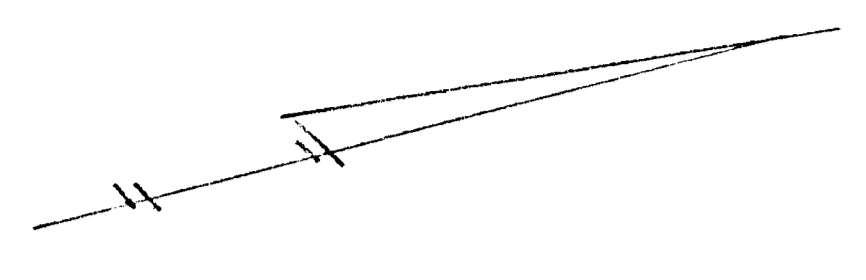

NOTE:  
 SEE "SITE PLAN - DEVELOPMENT PLAN" DRWG NO. SI-2  
 FOR COSITE STORM DRAIN LAYOUT.

APPROVED  
 PLANNING BOARD  
 OF HOWARD COUNTY  
 DATE 5-3-72  
 Thomas A. Harriott  
 Planning Director

APPROVED: For public water and public sewerage systems Howard County Health Department  
 City Health Officer  
 APPROVED: Howard County, Office of Planning and Zoning  
 Thomas A. Harriott, 6-14-72  
 Planning Director, Date  
 J. H. Clewley, 6-18-72  
 Director, Date  
 APPROVED: For public water, public sewerage and storm drainage systems and roads Howard County Department of Public Works.  
 William A. Acton, 6/1  
 Director, Date  
 W. O. Fulbert  
 Chief, Bureau of Highways

JOSEPH D. THOMPSON INC.  
 engineers & surveyors  
 200 E. JOPPA ROAD  
 BALTO. MD. 21204

SITE PLAN  
 OFFSITE STORM DRAINS  
 WILDELAKE COMMERCIAL INC.  
 HOWARD CO. MD.  
 SCALE: 1" = 20' DATE: OCT. 18, 1971  
 REVISION: DEC. 9, 1971

APPROVED FOR INCORPORATION

REVISIONS

NO. DATE BY

1 10/18/71 JDT

2 12/9/71 JDT

3 1/25/72 JDT

4 3/10/72 JDT

5 FINAL 5/11/72 JDT

ST-1  
 Rev. 1/25/72  
 3-10-72  
 FINAL 5/11

SDP 72-640 R.C.F. DR 2V-5