

APPROVED
PLANNING BOARD
OF ROCKVILLE COUNTY
DATE 6/30/71
James L. Harriott

SITE ANALYSIS

BLDG #	AREA IN SQ. FT.	AREA IN ACRES	TOTAL
1	6,415	0.147	25,254
2	11,892	0.272	35,616
3	6,415	0.147	25,254
4	6,415	0.147	25,254
5	6,415	0.147	25,254
6	6,415	0.147	25,254
7	6,415	0.147	25,254
8	6,415	0.147	25,254
9	12,830	0.294	40,508
10	12,830	0.294	40,508
TOTAL	102,300	2.32	318,480

SCHEDULE OF APARTMENTS

MODULE NUMBER	NO. OF UNITS	NO. OF BATHS	NO. OF GARAGES	NO. OF STAIRS	TOTAL
A	6	6	6	6	24
B	6	6	6	6	24
C	6	6	6	6	24
D	6	6	6	6	24
E	6	6	6	6	24
F	6	6	6	6	24
G	6	6	6	6	24
H	6	6	6	6	24
I	6	6	6	6	24
J	6	6	6	6	24
K	6	6	6	6	24
L	6	6	6	6	24
M	6	6	6	6	24
N	6	6	6	6	24
O	6	6	6	6	24
P	6	6	6	6	24
Q	6	6	6	6	24
R	6	6	6	6	24
S	6	6	6	6	24
T	6	6	6	6	24
U	6	6	6	6	24
V	6	6	6	6	24
W	6	6	6	6	24
X	6	6	6	6	24
Y	6	6	6	6	24
Z	6	6	6	6	24
TOTAL	100	100	100	100	400

APPROVED FOR PUBLIC WATER, PUBLIC SEWER & STORM DRAINAGE SYSTEMS
BY THE BOARD OF HEALTH, ROCKVILLE COUNTY, MARYLAND
DATE 9/24/71
APPROVED BY THE BOARD OF HEALTH, ROCKVILLE COUNTY, MARYLAND
DATE 10-4-71
APPROVED BY THE BOARD OF HEALTH, ROCKVILLE COUNTY, MARYLAND
DATE 10-4-71

NOTE: SEE DWGS. C-5 & C-6 FOR ROAD DIMENSIONS, CURB RADIUS, STORM DRAINAGE, ETC.

AUTUMN CREST APARTMENTS

ROBERT T. FOLEY, CO. ENGINEERS & ARCHITECTS
1100 CONNECTICUT AVE. NW
WASHINGTON, D.C.

MACRIS-FOWLER ASSOCIATES
CIVIL-STRUCTURAL ENGINEERS, SURVEYORS-PLANNERS
27 W. JEFFERSON ST.
ROCKVILLE, MD. 20850

DESIGNED BY: JAMES L. HARRIOTT
CHECKED BY: JAMES L. HARRIOTT
DATE: JULY 12, 71

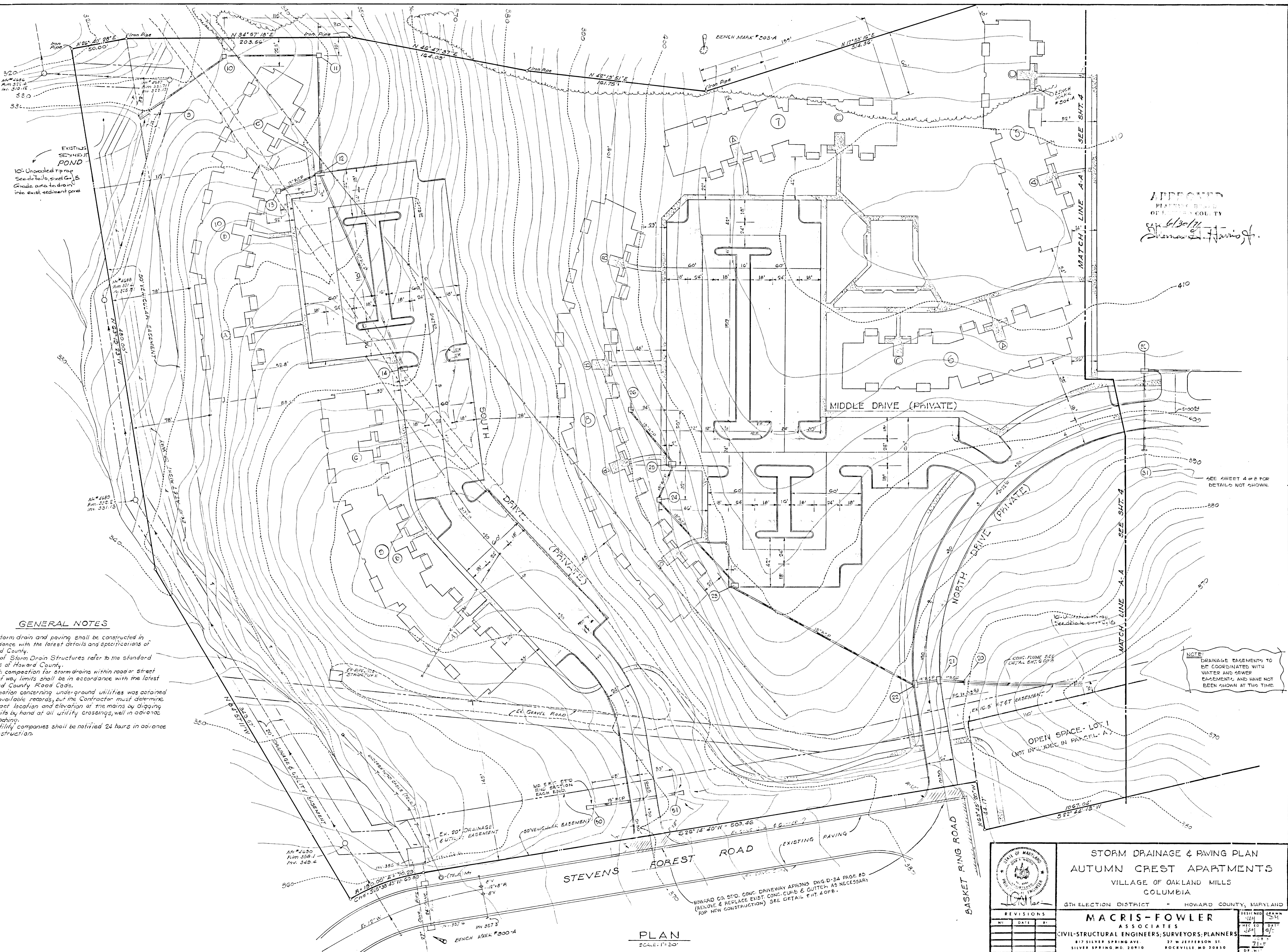

APPROVED
 PLANNING BOARD
 OF HOWARD COUNTY
 6/30/77
 Thomas L. Harris

GENERAL NOTES

1. All storm drain and paving shall be constructed in accordance with the latest details and specifications of Howard County.
2. Types of Storm Drain Structures refer to the standard details of Howard County.
3. Trench compaction for storm drains within road or street right-of-way limits shall be in accordance with the latest Howard County Road Co's.
4. Information concerning underground utilities was obtained from available records, but the Contractor must determine the exact location and elevation of the mains by digging test pits by hand at all utility crossings, well in advance of trenching.
5. All utility companies shall be notified 24 hours in advance of construction.

NOTE: DRAINAGE EASEMENTS TO BE COORDINATED WITH WATER AND SEWER EASEMENTS AND HAVE NOT BEEN SHOWN AT THIS TIME.

PLAN
 SCALE: 1" = 20'



STATE OF MARYLAND
 DEPARTMENT OF TRANSPORTATION
 DIVISION OF HIGHWAYS

STORM DRAINAGE & PAVING PLAN
 AUTUMN CREST APARTMENTS
 VILLAGE OF OAKLAND MILLS
 COLUMBIA

6TH ELECTION DISTRICT - HOWARD COUNTY, MARYLAND

DESIGNED BY: [Signature]
 DRAWN BY: [Signature]

MACRIS-FOWLER
 ASSOCIATES
 CIVIL-STRUCTURAL ENGINEERS, SURVEYORS, PLANNERS

817 SILVER SPRING AVE. 37 W. JEFFERSON ST.
 SILVER SPRING, MD. 20910 ROCKVILLE, MD. 20850
 (301) 581-0030 (301) 742-3454

REVISIONS		
NO.	DATE	BY

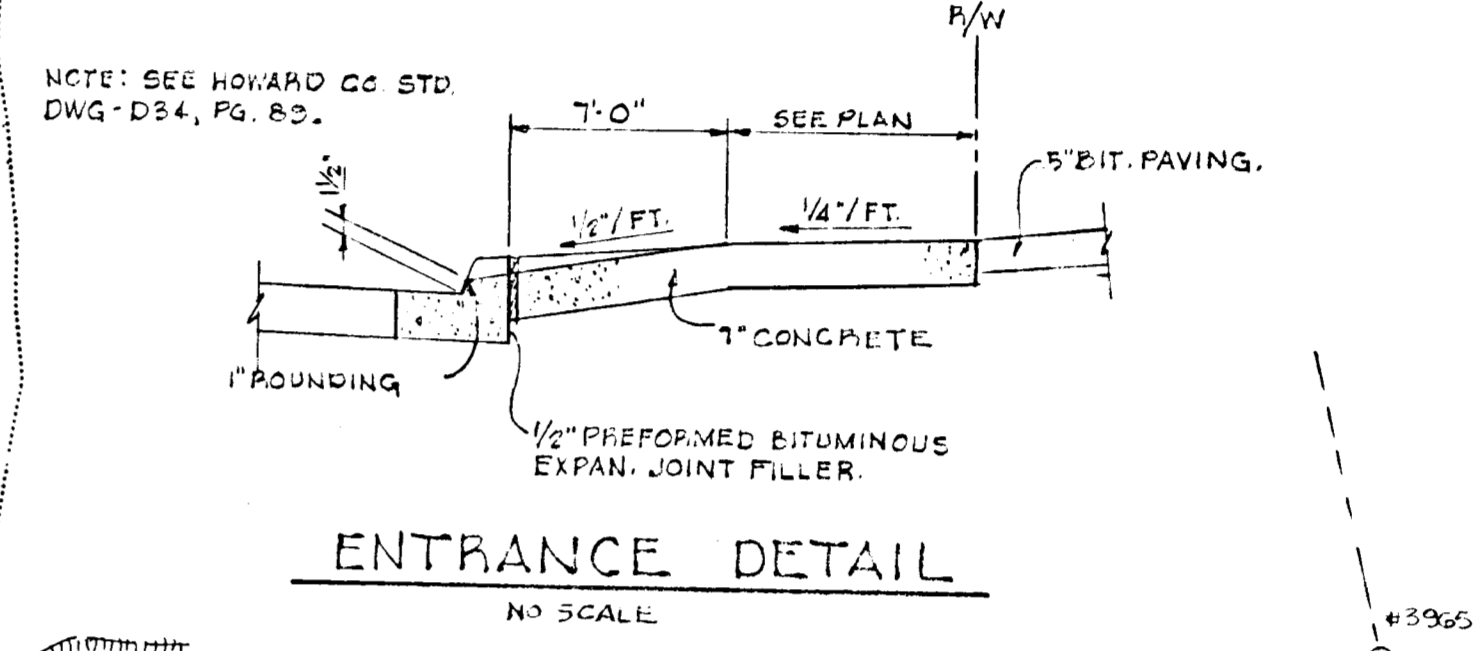
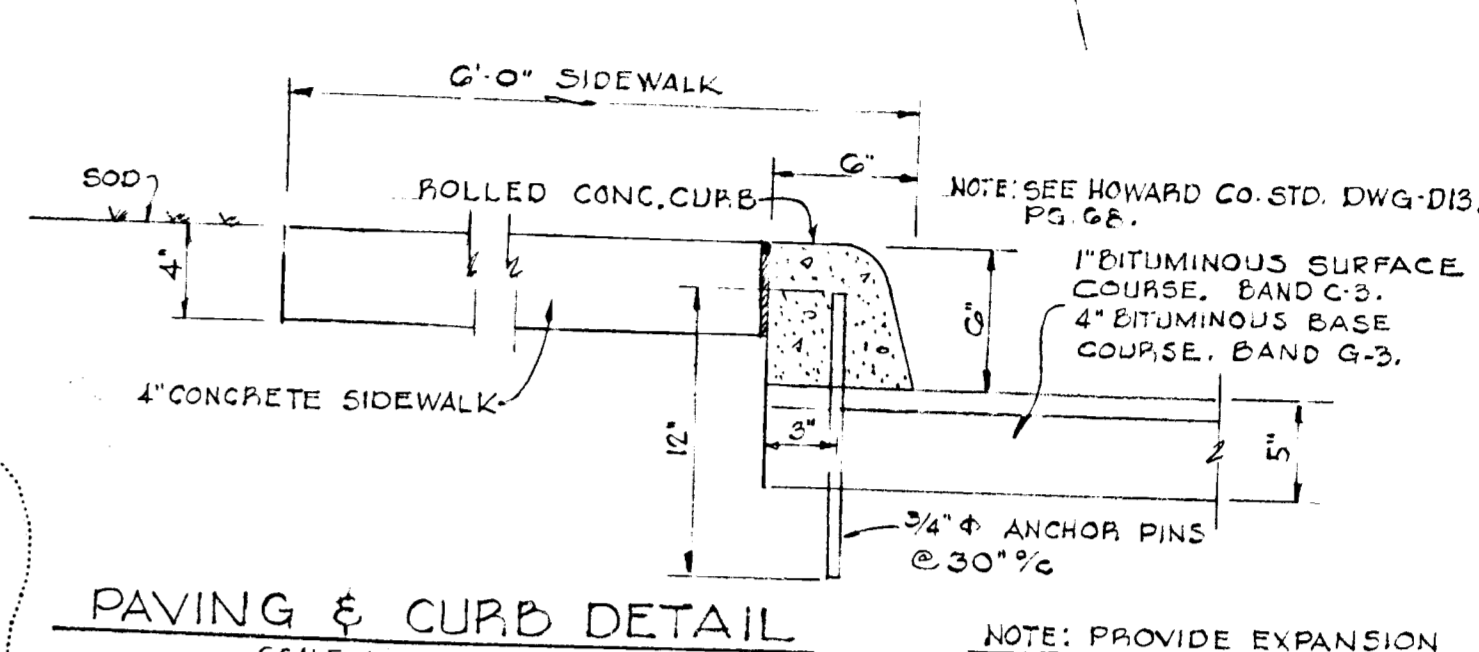

NOTE: DRAINAGE EASEMENTS TO BE COORDINATED WITH WATER AND SEWER EASEMENTS AND HAVE NOT BEEN SHOWN AT THIS TIME.

APPROVED
 PLANNING BOARD
 OF HOWARD COUNTY
 6/30/64
 Howard County Planning Board

STORM DRAINAGE & PAVING PLAN
 AUTUMN CREST APARTMENTS
 VILLAGE OF OAKLAND MILLS
 COLUMBIA

6TH ELECTION DISTRICT - HOWARD COUNTY, MARYLAND

DESIGNED BY
MACRIS-FOWLER
 ASSOCIATES
 CIVIL-STRUCTURAL ENGINEERS, SURVEYORS, PLANNERS
 817 SILVER SPRING AVE. SILVER SPRING MD 20910
 101 585 0030

DESIGNED DRAWN
 CHECKED DATE
 71-504
 DRAWING NO.
 1 OF 2

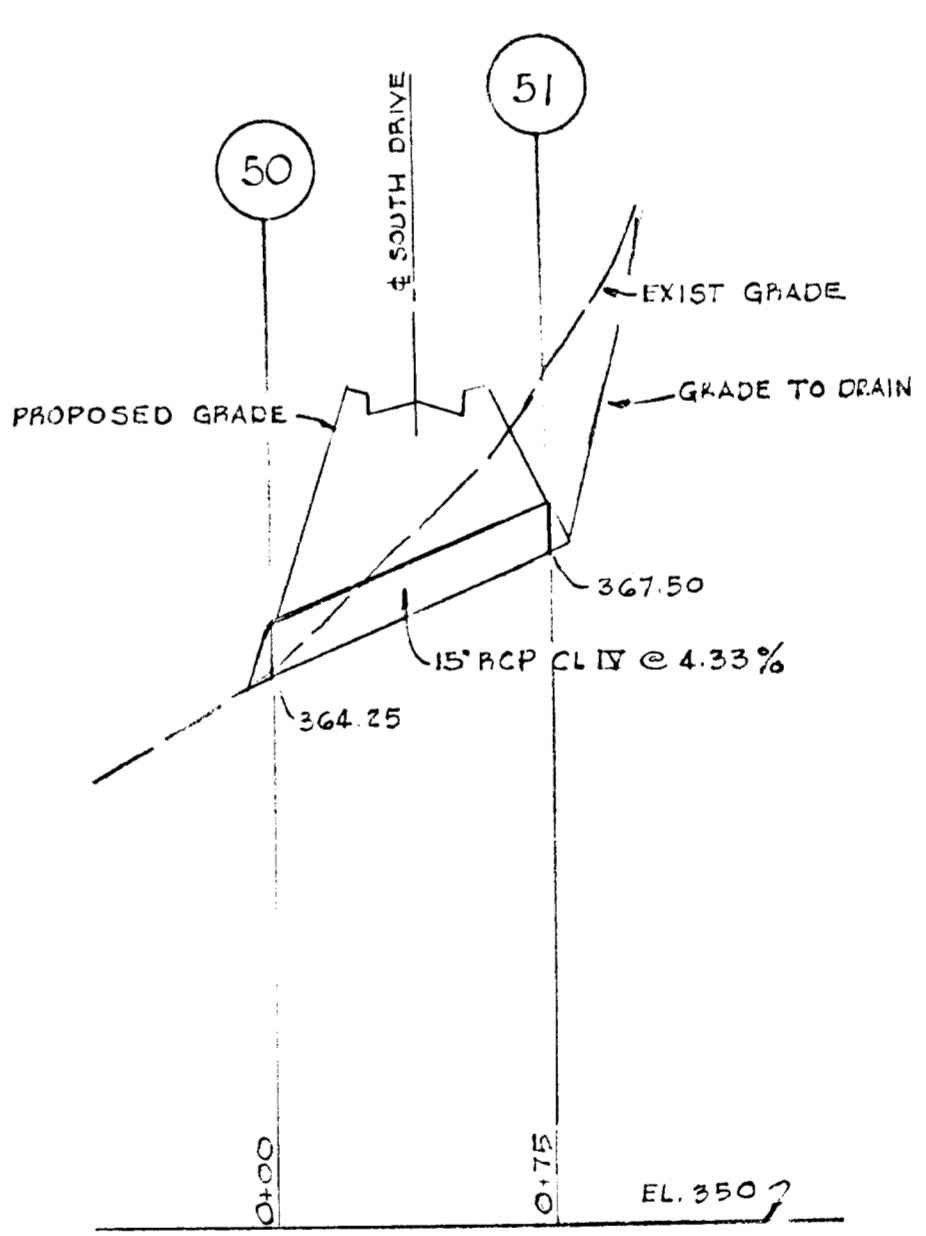
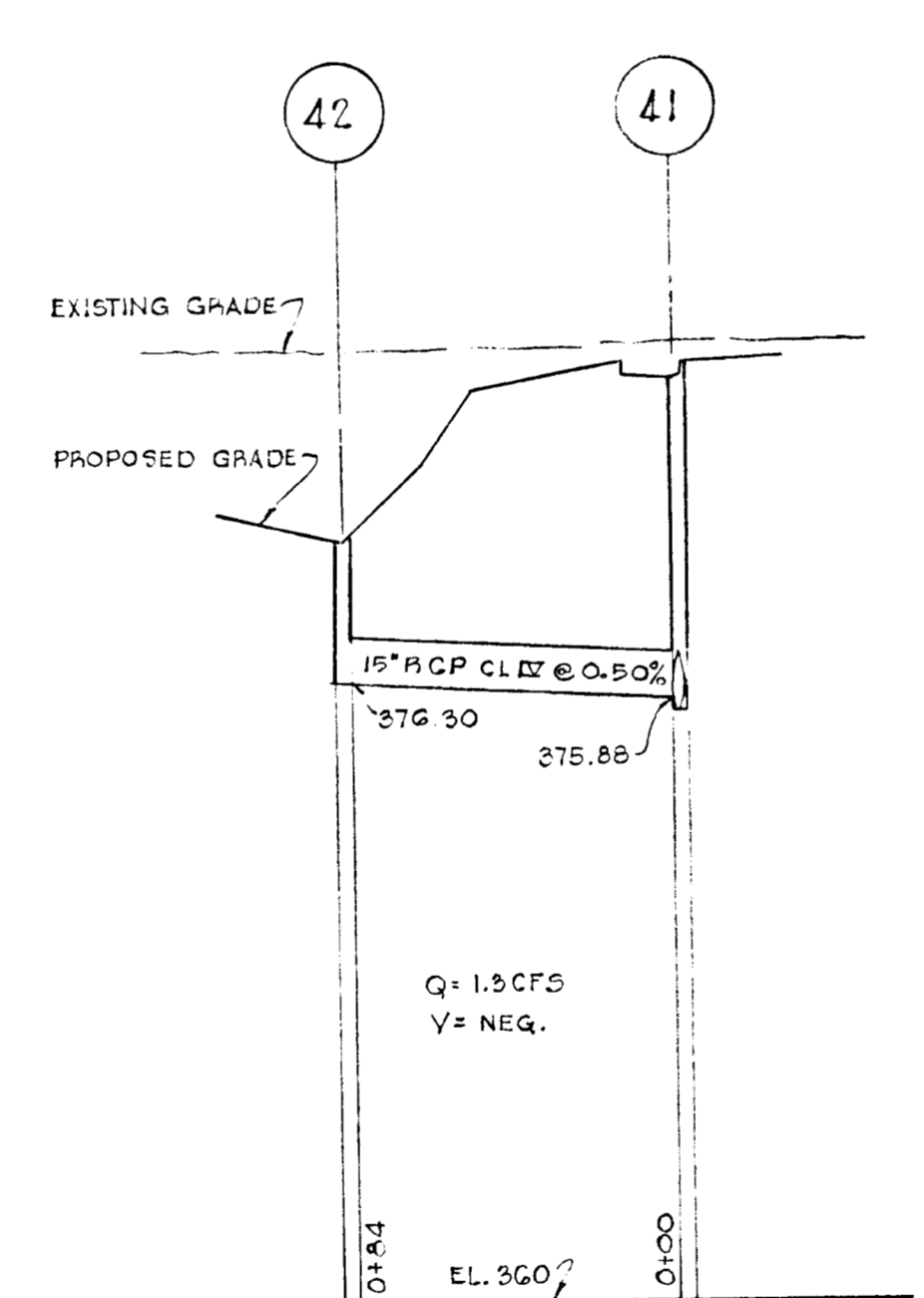
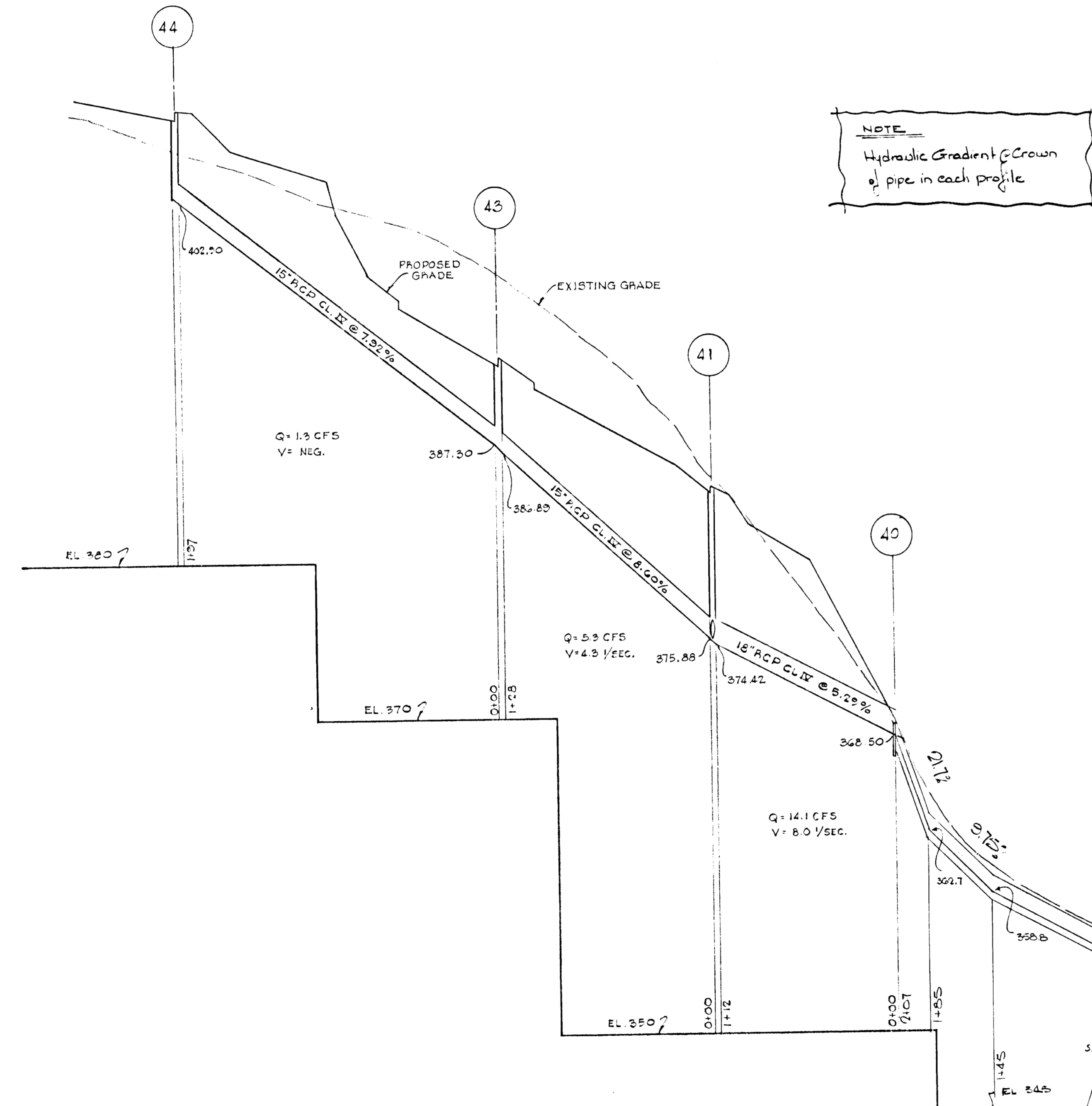
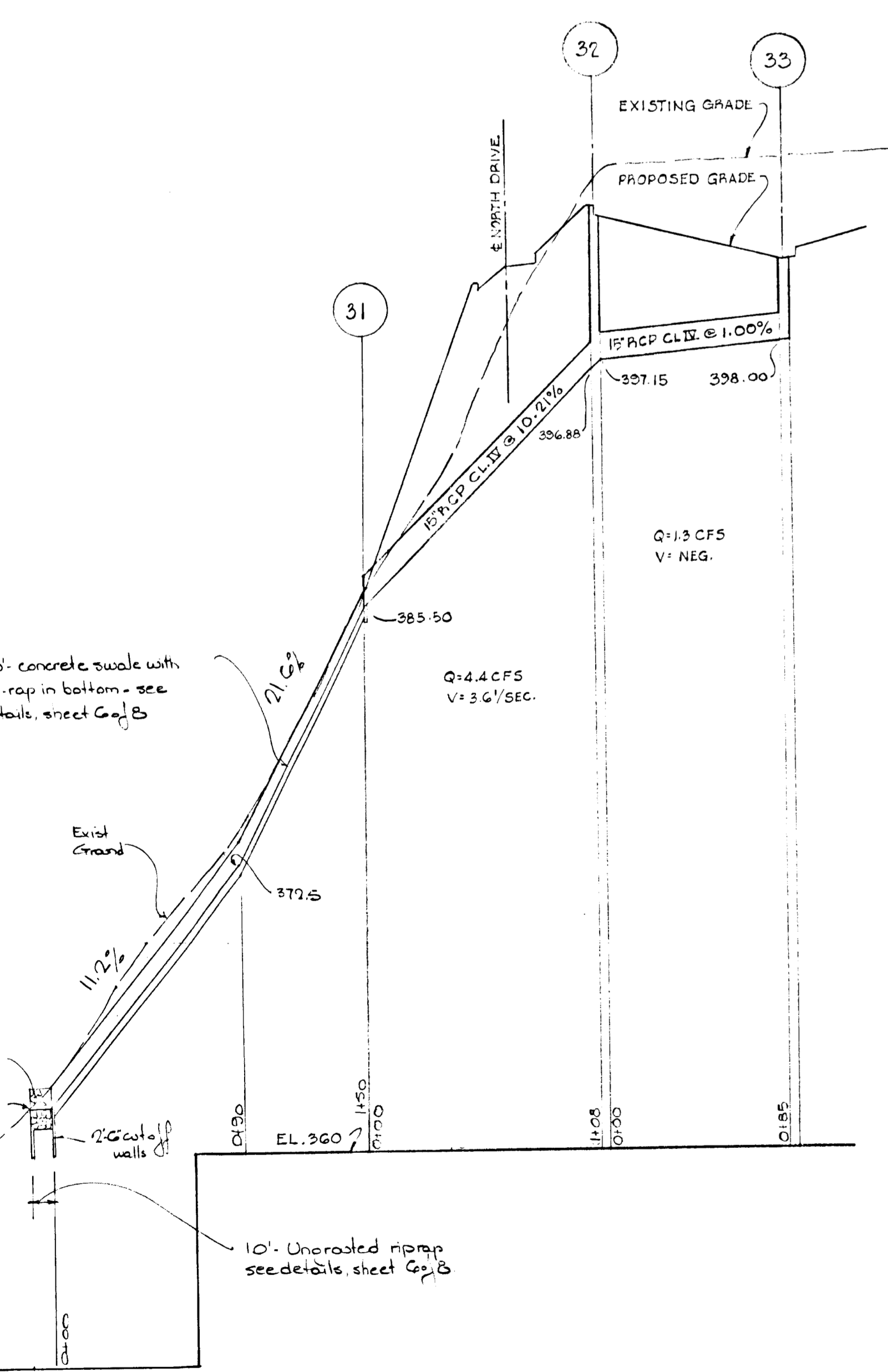
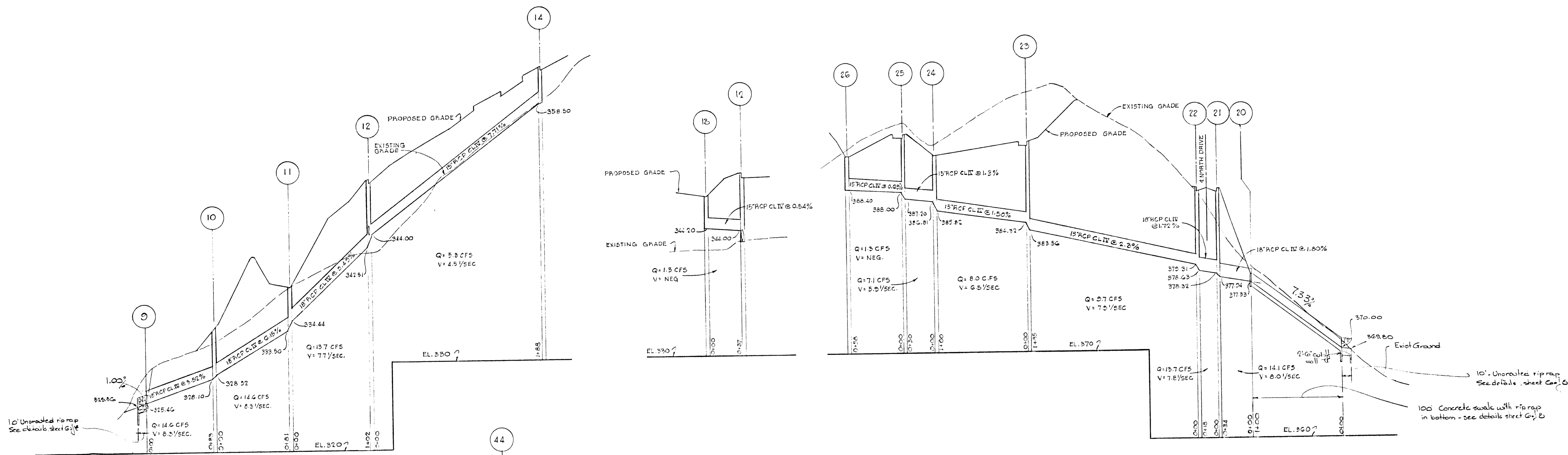

NOTE
Hydraulic Gradient Crown
of pipe in each profile

STORM DRAIN PROFILES
SCALE: 1" = 50' HORIZ.
1" = 5' VERT.

APPROVED
BOARD OF
HEALTH
OF HOWARD COUNTY
DATE: 4/12/11
THOMAS HUNTER

		STORM DRAINAGE PROFILES AUTUMN CREST APARTMENTS VILLAGE OF OAKLAND MILLS COLUMBIA 6TH ELECTION DISTRICT - HOWARD COUNTY, MARYLAND	
REVISIONS NO. DATE BY		DESIGNED DRAWN DATE DATE 7-1-504 5/2/11	
MACRIS-FOWLER ASSOCIATES CIVIL-STRUCTURAL ENGINEERS, SURVEYORS, PLANNERS 217 SILVER SPRING AVE. SILVER SPRING MD 20910 (301) 584-0030		27 W. JEFFERSON ST. ROCKVILLE MD 20850 (301) 584-1858	

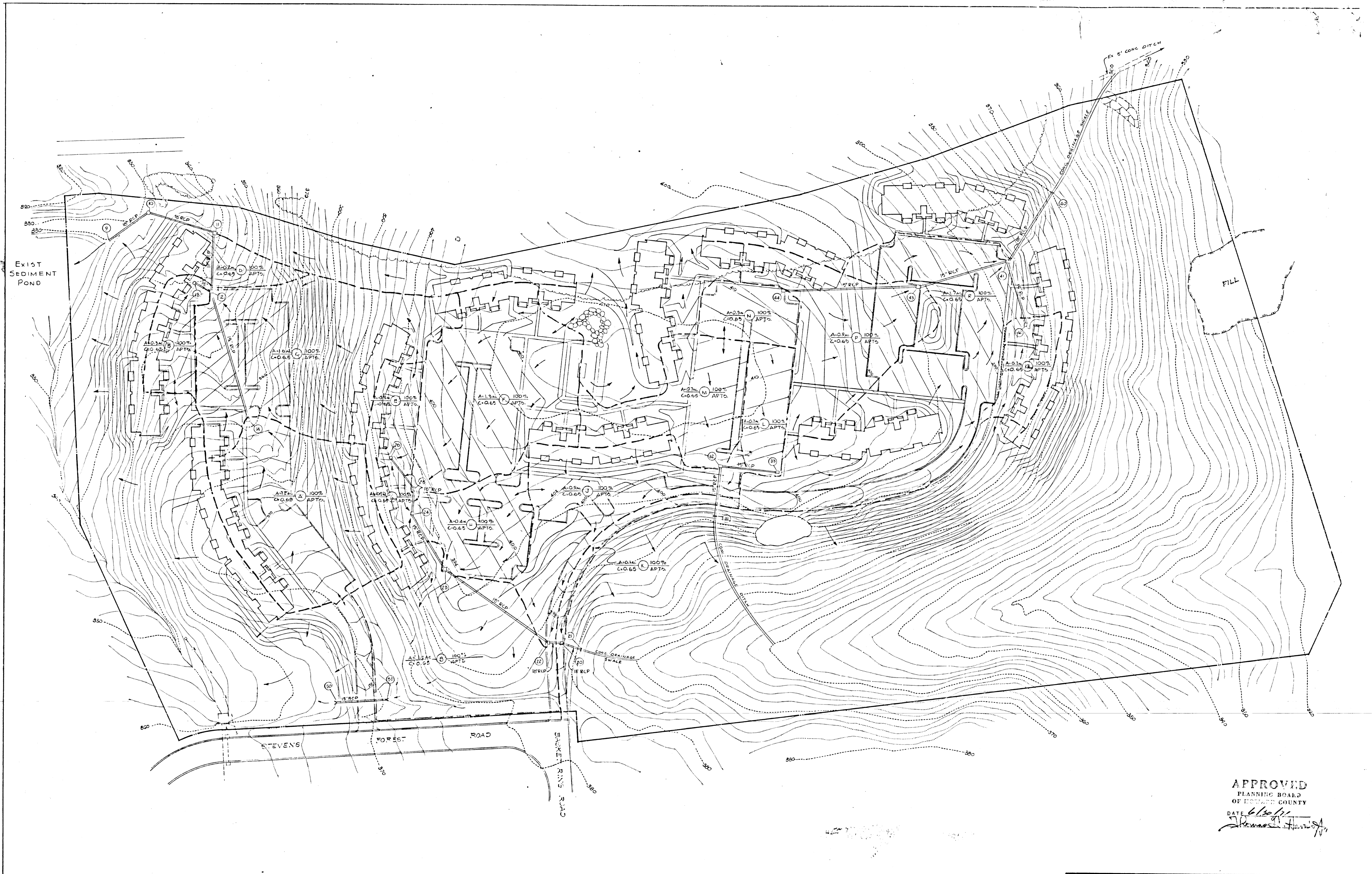

PLAN
SCALE 1"=40'

APPROVED
PLANNING BOARD
OF HOWARD COUNTY
DATE 6/30/71
Thomas J. ...

	DRAINAGE AREA MAP AUTUMN CREST APARTMENTS VILLAGE OF OAKLAND MILLS COLUMBIA	
	6TH ELECTION DISTRICT - HOWARD COUNTY, MARYLAND	
REVISIONS NO. DATE BY	MACRIS-FOWLER ASSOCIATES CIVIL-STRUCTURAL ENGINEERS, SURVEYORS, PLANNERS 817 SILVER SPRING AVE. SILVER SPRING, MD. 20910 1901 584-0010	
DATE DRAWN BY CHECKED BY APPROVED BY	27 W. JEFFERSON ST. ROCKVILLE, MD 20858 1971 743-8818	

BDP-1-100C

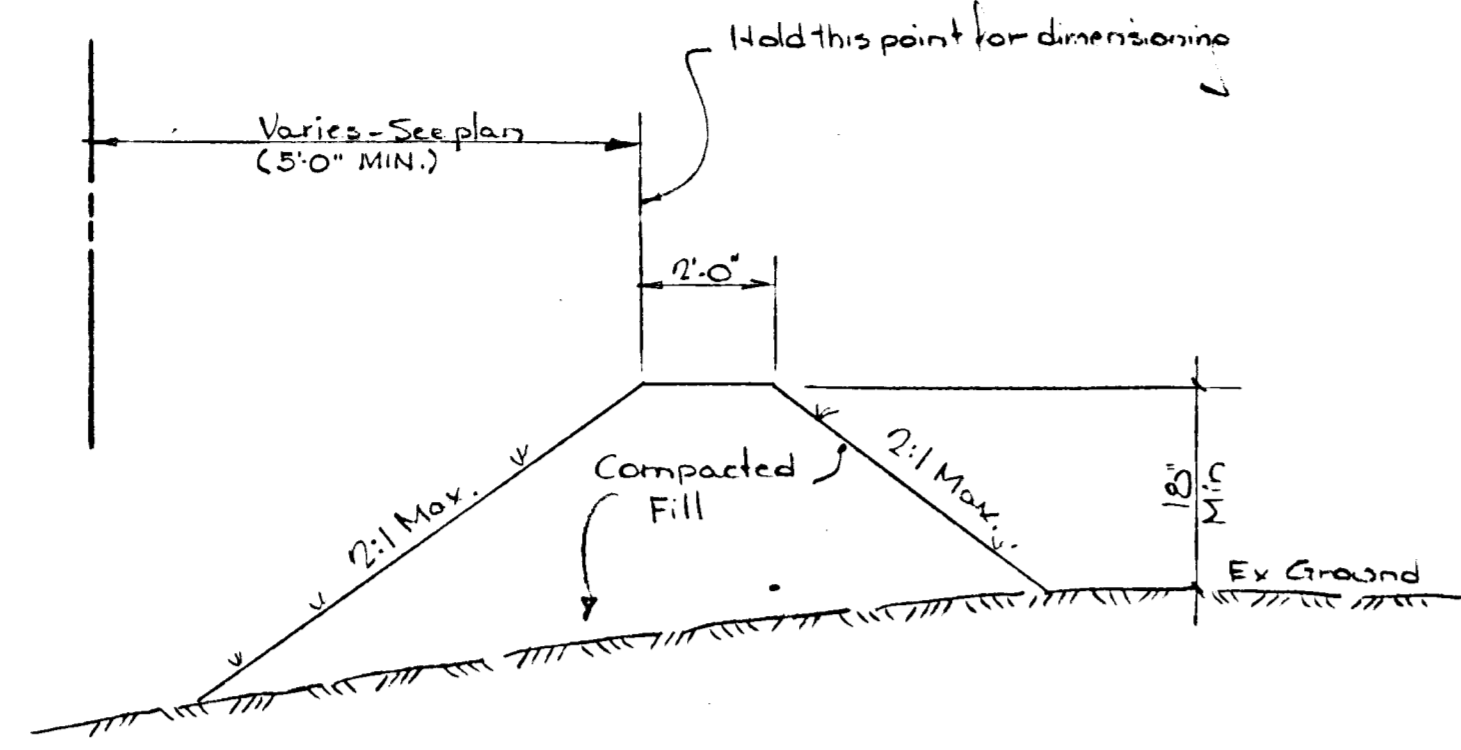

TYPICAL DIVERSION BERM

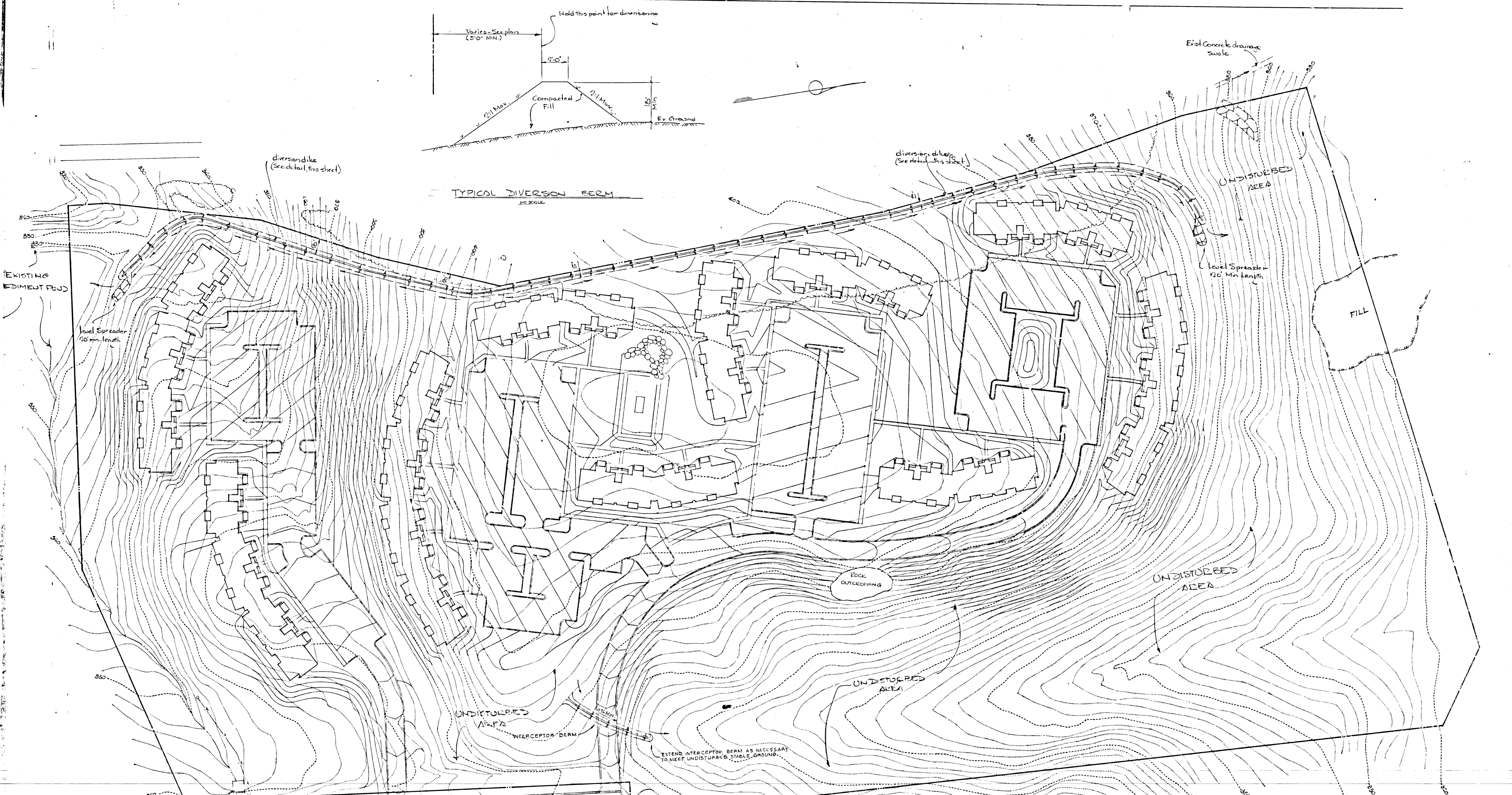

GENERAL NOTES

1. Prior to any clearing, grading or utility installation, the berms, basins, level spreaders and other measures shown on this plan shall be constructed.
2. Stabilization of disturbed ground shall be done as soon after construction is completed as practicable.
3. All berms shall be temporarily seeded after installation.
4. Berms and level spreaders shall not be removed without written approval from the Howard Soil Conservation District.
5. Slope and critical area stabilization shall adhere to the methods outlined in the "Erosion and Sediment Control Technical Handbook" published by the Howard Soil Conservation District.
6. See sheets 3 thru 7 for permanent drainage system.
7. The Contractor shall notify the Howard County Soil Conservation District 24 hours prior to commencement of construction.
8. The existing sediment pond N of property shall be cleaned prior to construction at an site construction.

CERTIFICATION BY THE PROFESSIONAL ENGINEER:
I certify that the plan of development and the plan for control of silt and erosion meets the requirements, standards and specifications of the Howard Soil Conservation District.
(Seal) *[Signature]* 6-1-71 date

CERTIFICATION BY THE DEVELOPER:
I certify that all development and/or construction will be done according to this plan of development, erosion control and sediment control.
(Seal) *[Signature]* 5-27-71 date

This development plan is approved for soil erosion and sediment control by the Howard Soil Conservation District.
Reviewed *[Signature]* 7-30-71 date
District Conservationist
Approved *[Signature]* 7-30-71 date
Howard Soil Conservation District

APPROVED
PLANNING BOARD
OF HOWARD COUNTY
DATE 6/26/71
[Signature]

PLAN
66-1171-30

	SOIL EROSION & SEDIMENT CONTROL PLAN AUTUMN CREST APARTMENTS VILLAGE OF OAKLAND MILLS COLUMBIA	
	6TH ELECTION DISTRICT - HOWARD COUNTY, MARYLAND	
REVISIONS NO. DATE BY	MACFIS-FOWLER ASSOCIATES CIVIL-STRUCTURAL ENGINEERS, SURVEYORS, PLANNERS 817 SILVER SPRING AVE. SILVER SPRING, MD. 20910 27 W. ALPHEA RD. ROCKVILLE, MD. 20850	