

LAND DEVELOPMENT
 MANUFACTURING PLANNING
 HOWARD COUNTY
 DATE 7/21/71
 J. H. [Signature]

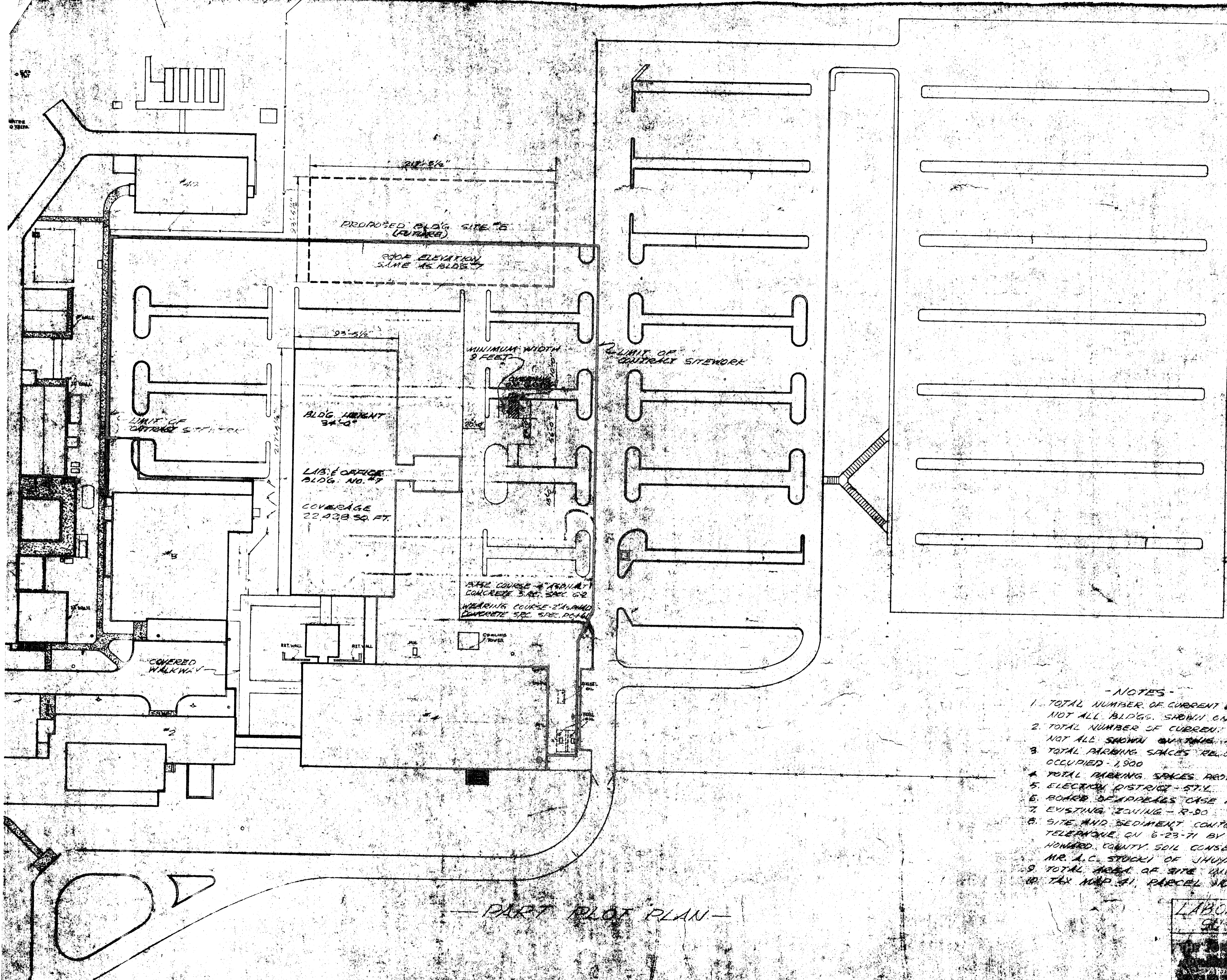

- NOTES -
1. TOTAL NUMBER OF CURRENT EMPLOYEES - 2,100
NOT ALL BLDGS. SHOWN ON THIS DWG.
 2. TOTAL NUMBER OF CURRENT PARKING SPACES - 1,711
NOT ALL SHOWN ON THIS DWG.
 3. TOTAL PARKING SPACES REQUIRED WHEN BLDG. #7 IS OCCUPIED - 1,900
 4. TOTAL PARKING SPACES PROVIDED - 1,957
 5. ELECTRIC DISTRICT - 57.1
 6. BOARD OF APPEALS CASE NO. 817-C
 7. EXISTING ZONING - R-90
 8. SITE AND SEDIMENT CONTROL APPROVED BY TELEPHONE ON 6-23-71 BY MR. R. CAMPBELL OF HOWARD COUNTY SOIL CONSERVATION DISTRICT & MR. A. C. STUCKEN OF JHUMPL.
 9. TOTAL AREA OF SITE INVOLVED APPROX. 5 ACRES
 10. TAX MAP #1 PARCEL NO. 123

- PART PLOT PLAN -

LABORATORY & OFFICE BLDG. NO. 7
 SUPPLEMENT TO DWG. 211
 DATE 7/21/71
 J. H. [Signature]