

NEW SHOP EXTENSION ON EXISTING FOUNDATION

INDUSTRIAL PLANT

FOR

AEROLAB SUPPLY COMPANY

WASHINGTON-BALTIMORE BLVD, LAUREL, MD

TAX MAP 47 - PARCEL 764
 ZONING (EXISTING) M-1
 OWNER & DEVELOPER: A. W. SHEPWOOD
 341 CHATHAM RD
 HYATTSVILLE MD 20783

DRAWN BY: C. J. CHAMBERLAIN MAP 19, 1971
 APPROVED BY: A. H. KELLEY PE #1979 (MD)
 SCALE 1" = 40'

VICINITY SKETCH

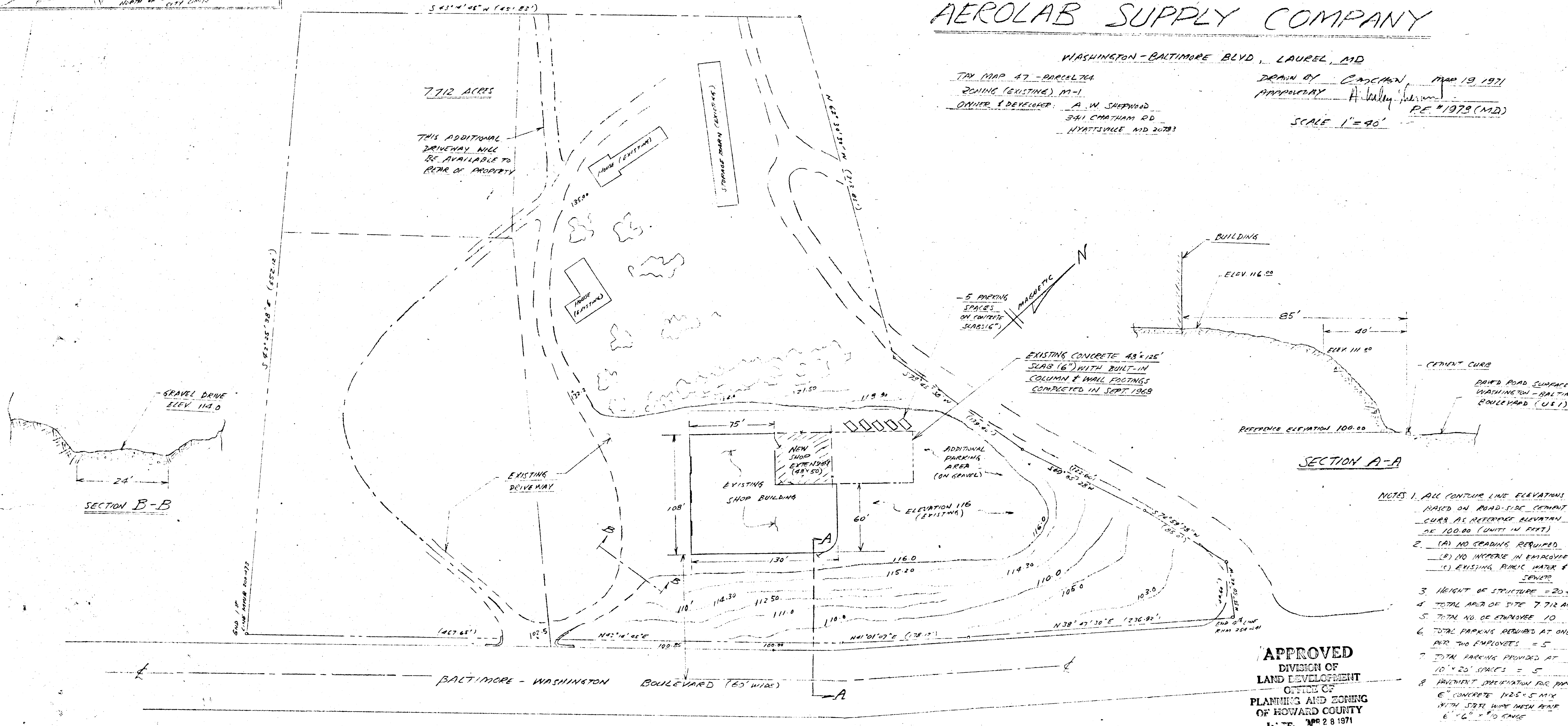
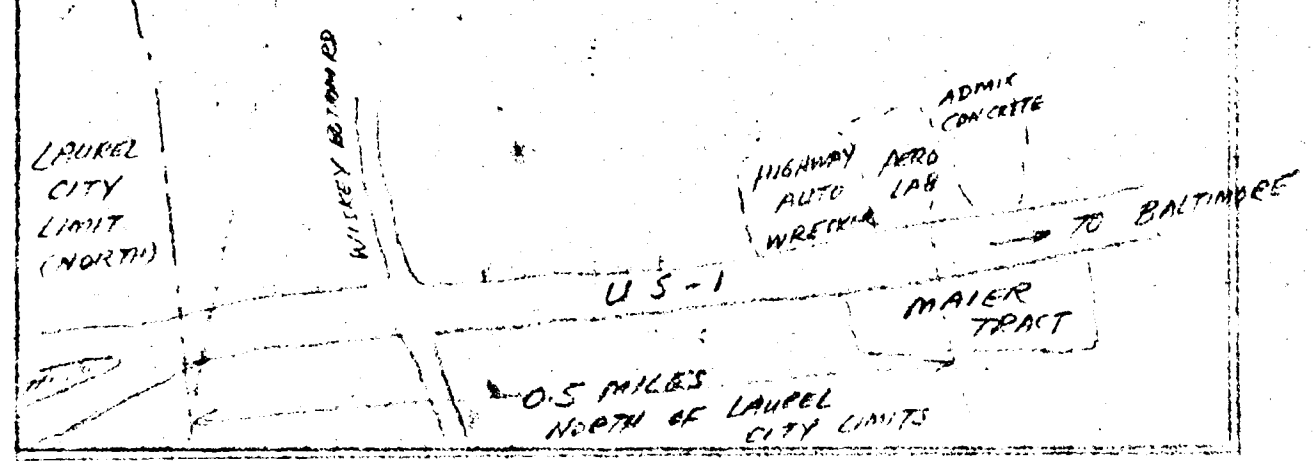

- NOTES:
1. ALL CONTOUR LINE ELEVATIONS BASED ON ROAD-SIDE CEMENT CURB AS REFERENCE ELEVATION OF 100.00 (UNITS IN FEET)
 2. (A) NO GRADING REQUIRED
 (B) NO INCREASE IN EMBANKMENT
 (C) EXISTING PUBLIC WATER & SEWER
 3. HEIGHT OF STRUCTURE = 20'-4"
 4. TOTAL AREA OF SITE 7.712 ACRES
 5. TOTAL NO. OF EMPLOYEES 10
 6. TOTAL PARKING REQUIRED AT ONE PER TWO EMPLOYEES = 5
 7. TOTAL PARKING PROVIDED AT 10' x 20' SPACES = 5
 8. PAVEMENT SPECIFICATION FOR PARKING: 6" CONCRETE 1 1/2" x 5" MIX WITH 3/8" STEEL WIRE MESH REINFC. 6" x 6" x 10 GAUGE

APPROVED
 DIVISION OF
 LAND DEVELOPMENT
 OFFICE OF
 PLANNING AND ZONING
 OF HOWARD COUNTY
 DATE: APR 28 1971