

ADDITION - ORIENTATION
MAIN & OUTLYING BLDGS

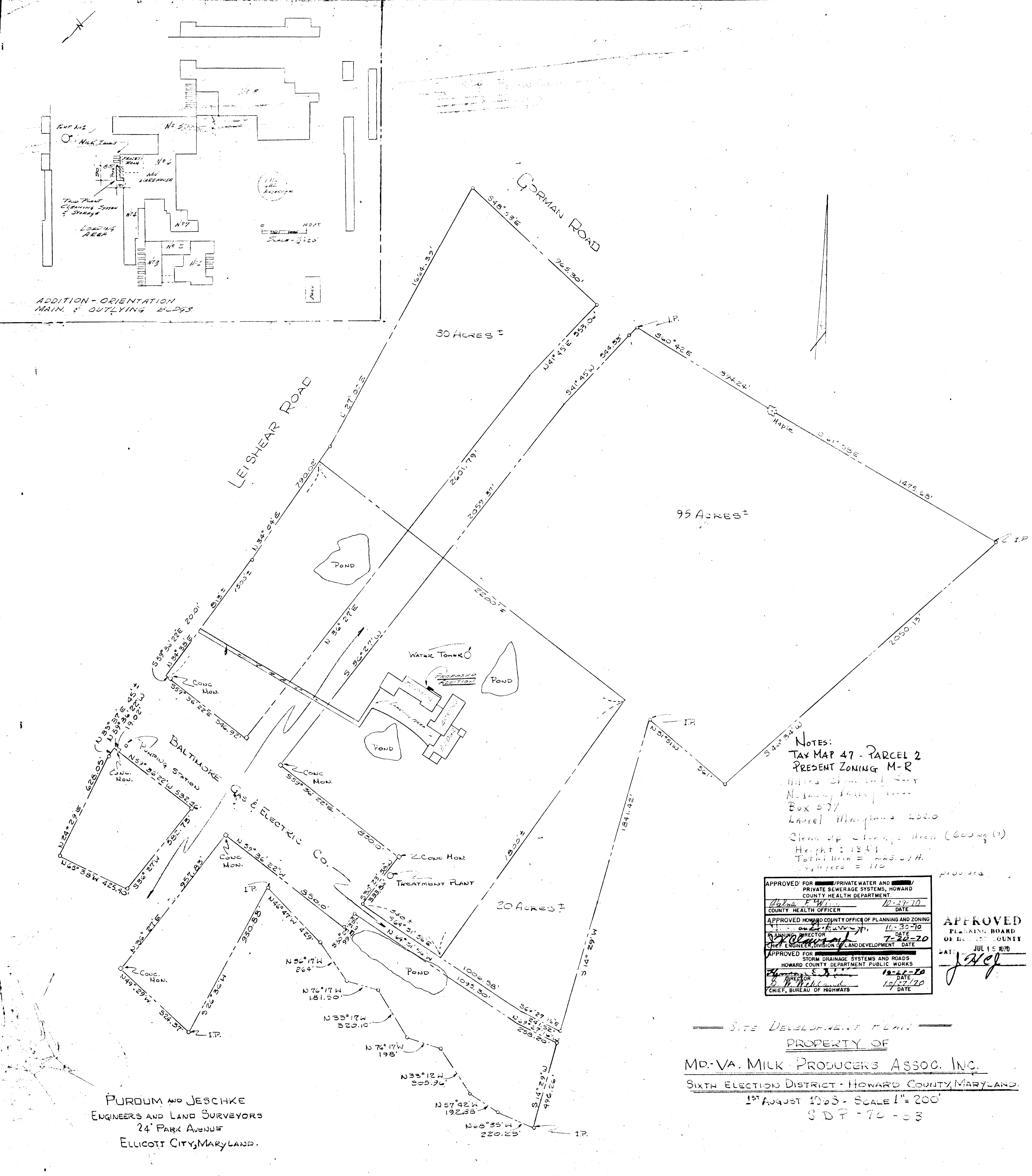

NOTES:
 TAX MAP 47 - PARCEL 2
 PRESENT ZONING M-R
 Hines Chemical Corp
 Mesbury Valley Road
 Box 577
 Laurel Maryland 20810
 Clean up Storage Area (600 sq ft)
 Height: 12.5 ft
 Total Area = 225.0 ft.
 Employees = 110

APPROVED FOR	PRIVATE WATER AND PRIVATE SEWERAGE SYSTEMS, HOWARD COUNTY HEALTH DEPARTMENT.
<i>Walter F. Williams</i>	10-29-70
COUNTY HEALTH OFFICER	DATE
APPROVED HOWARD COUNTY OFFICE OF PLANNING AND ZONING	
<i>Paul R. ...</i>	10-30-70
PLANNING DIRECTOR	DATE
<i>...</i>	7-22-70
CHIEF ENGINEER, DIVISION OF LAND DEVELOPMENT	DATE
APPROVED FOR	STORM DRAINAGE SYSTEMS AND ROADS, HOWARD COUNTY DEPARTMENT PUBLIC WORKS
<i>...</i>	10-22-70
DIRECTOR	DATE
<i>...</i>	10-27-70
CHIEF, BUREAU OF HIGHWAYS	DATE

APPROVED
 PLANNING BOARD
 OF HOWARD COUNTY
 DATE: JUL 15 1970
J. Hef

SITE DEVELOPMENT PLAN
 PROPERTY OF
 MD.-VA. MILK PRODUCERS ASSOC. INC.
 SIXTH ELECTION DISTRICT - HOWARD COUNTY, MARYLAND.
 1ST AUGUST 1968 - SCALE 1" = 200'
 S D P - 70 - 53

PURDUM AND JESCHKE
 ENGINEERS AND LAND SURVEYORS
 24 PARK AVENUE
 ELLICOTT CITY, MARYLAND.