

MICRO-BIORETENTION - PLANTING DATA

1. PLANTINGS WITHIN THE PONDING AREA OF THE MICRO-BIORETENTION ARE TO BE OF A MEDIUM TO HIGH WATER TOLERANCE.
2. PLANTINGS ALONG THE PERIMETER (BERM) AREA OF THE MICRO-BIORETENTION ARE TO BE OF A LOW TO MEDIUM WATER TOLERANCE.
3. AVOID PLANTINGS WITH EXCESSIVE ROOT MASS IN POND AREA OF THE MICRO-BIORETENTION NEAR O.B. PIPE AND UNDERDRAN.

MICRO-BIORETENTION PLANTING SCHEDULE

1	PANICUM VIRGATUM (SWITCH GRASS)	16
2	VERNONIA NOBILISSIMA	5
3	IRIS VERSICOLOR (IRIS)	8
4	HIBISCUS MOSCHEUTOS ROSE MALLOW	15
5	ACER RUBRUM (RED MAPLE)	1

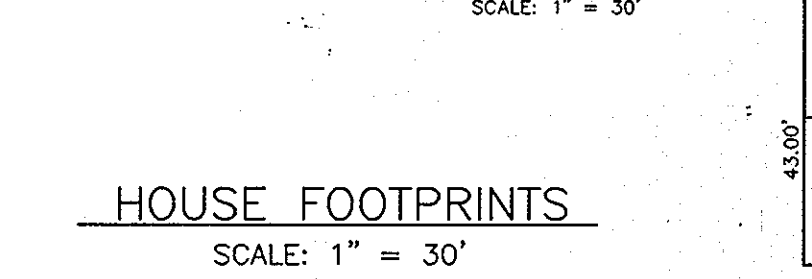
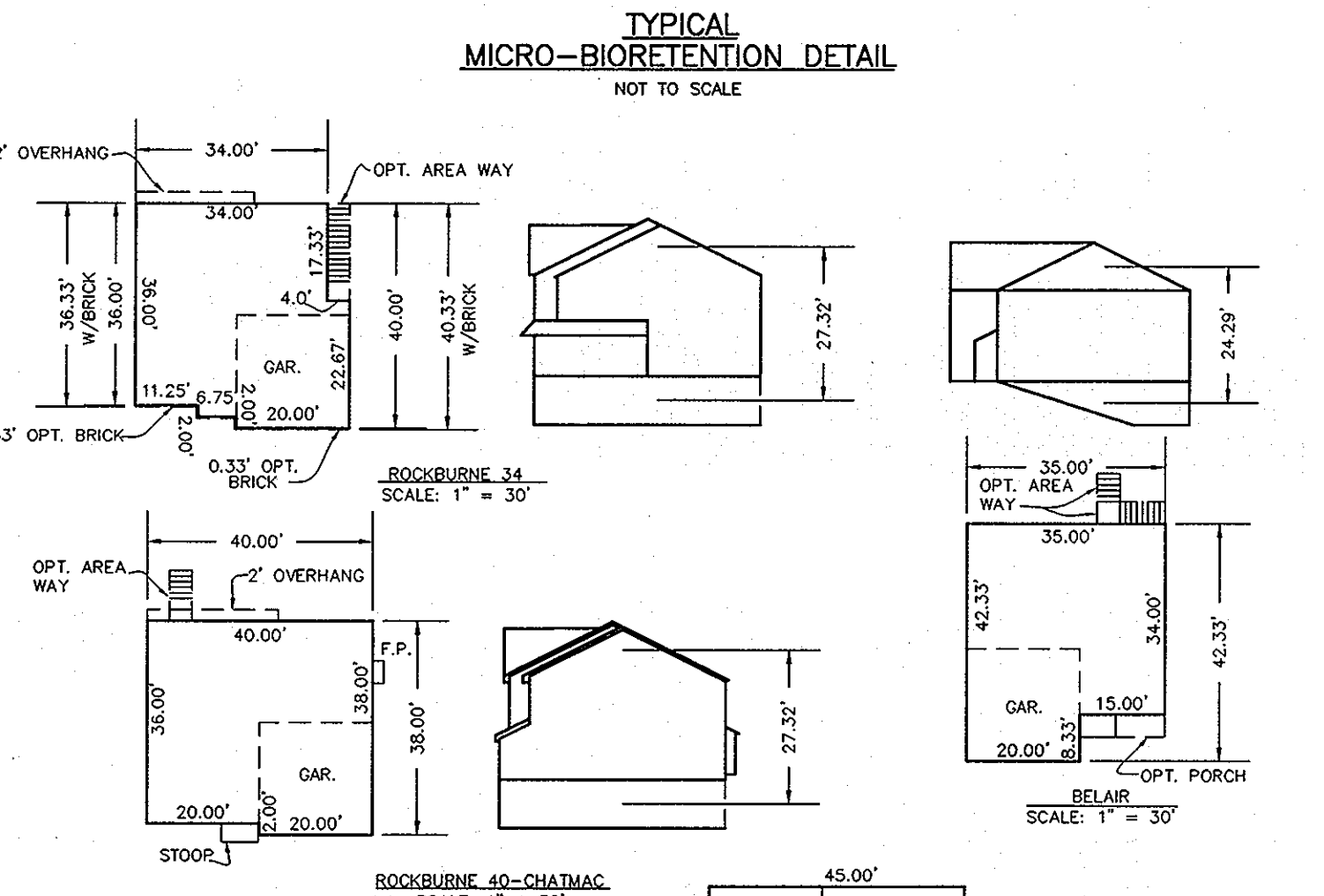
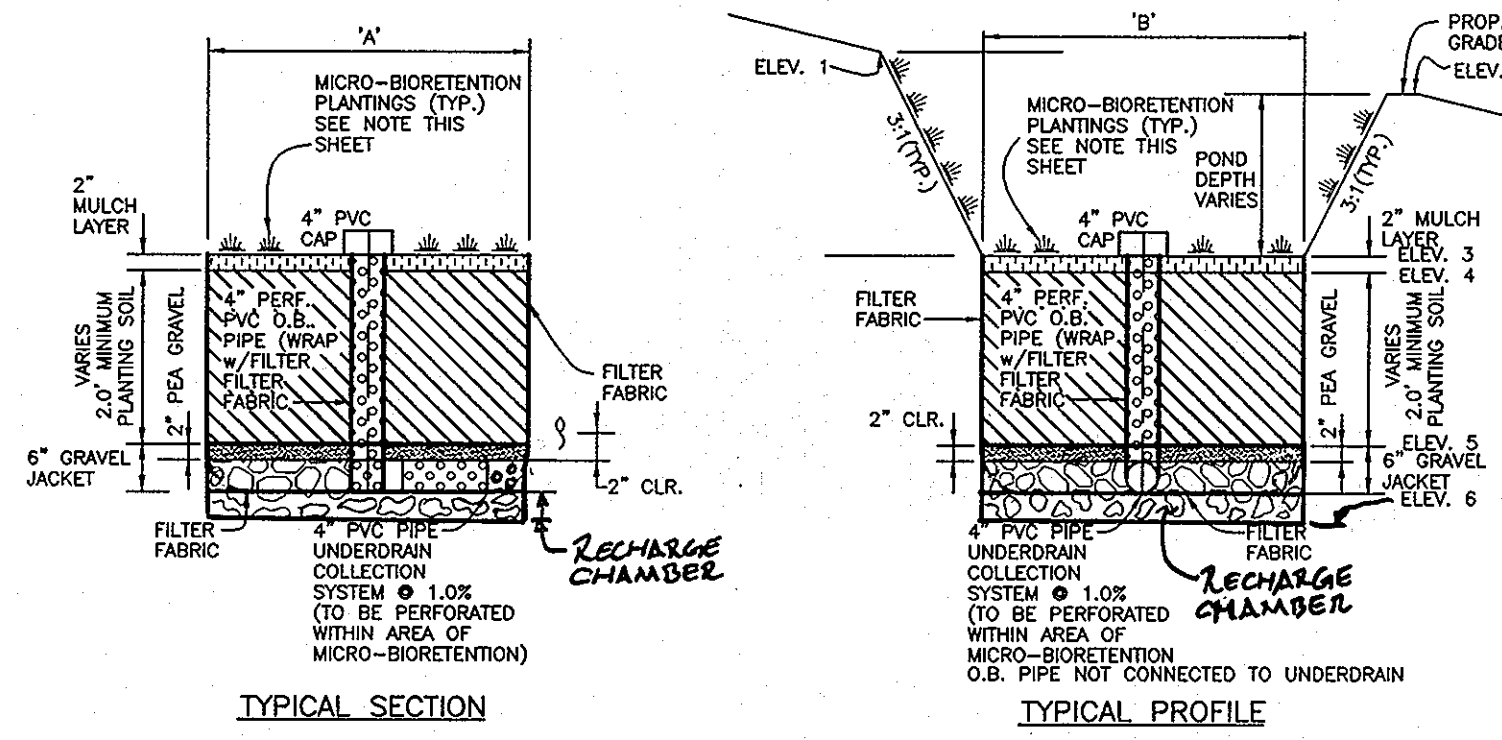
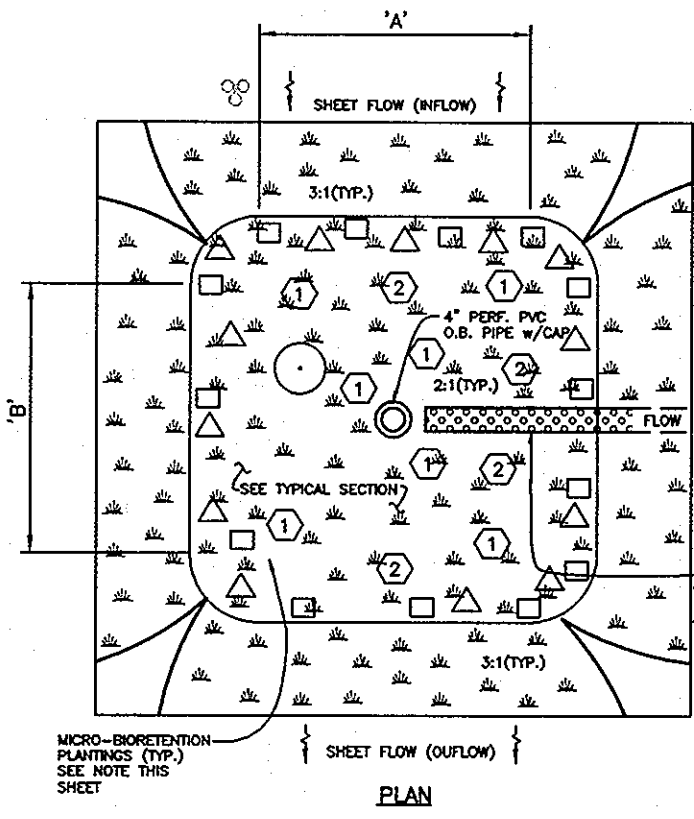

OPERATION AND MAINTENANCE SCHEDULE FOR LANDSCAPE INFILTRATION (M-3) MICRO-BIORETENTION (M-6), BORETENTION SWALE (M-8), BORETENTION SWALE (M-9), ENHANCED FILTERS (M-9)

A. THE OWNER SHALL MAINTAIN THE PLANT MATERIAL, MULCH LAYER AND SOIL LAYER ANNUALLY. MAINTENANCE OF MULCH AND SOIL IS LIMITED TO CORRECTING AREAS OF EROSION OR WASH OUT. ANY MULCH REPLACEMENT SHALL BE DONE IN THE SPRING. PLANT MATERIAL SHALL BE CHECKED FOR DISEASE AND INSECT INFESTATION AND MAINTENANCE WILL ADDRESS AND REMOVE SUCH MATERIAL AND PRUNING. ACCEPTABLE REPLACEMENT PLANT MATERIAL IS LIMITED TO THE FOLLOWING: 2000 MARYLAND STORMWATER DESIGN MANUAL VOLUME II, TABLE A.4.1 AND 2.
 B. THE OWNER SHALL PERFORM A PLANT INSPECTION AND IN THE FALL OF EACH YEAR. DURING THE INSPECTION, THE OWNER SHALL REMOVE DEAD AND DISEASED VEGETATION CONSIDERED BEYOND TREATMENT, REPLACE DEAD PLANT MATERIAL WITH ACCEPTABLE REPLACEMENT PLANT MATERIAL, TREAT DISEASED TREES AND SHRUBS, AND REPLACE ALL DEFICIENT STAKES AND WIRES.
 C. THE OWNER SHALL INSPECT THE MULCH EACH SPRING. THE MULCH SHALL BE REPLACED EVERY TWO TO THREE YEARS. THE PREVIOUS MULCH LAYER SHALL BE REMOVED BEFORE THE NEW LAYER IS APPLIED.
 D. THE OWNER SHALL CORRECT SOIL EROSION ON AN AS NEEDED BASIS, WITH A MINIMUM OF ONCE PER MONTH AND AFTER EACH HEAVY STORM.

DEVELOPER'S/BUILDER'S CERTIFICATE
 I/WE CERTIFY THAT THE LANDSCAPING SHOWN ON THIS PLAN WILL BE DONE ACCORDING TO THE PLAN, SECTION 16.124 OF THE HOWARD COUNTY CODE AND THE HOWARD COUNTY LANDSCAPE MANUAL. I/WE FURTHER CERTIFY THAT UPON COMPLETION OF LANDSCAPE INSTALLATION, ACCOMPANIED BY AN EXECUTED ONE YEAR GUARANTEE OF PLANT MATERIALS, WILL BE SUBMITTED TO THE DEPARTMENT OF PLANNING AND ZONING.
 DATE: 12/10/12
 CHRISTOPHER BROWN HARMONY BUILDERS

SWM DESIGN TABLE	
LOT 2	MB 1 MB 2
ELEV. 1	210.00 208.00
ELEV. 2	210.00 206.20
ELEV. 3	209.00 205.20
ELEV. 4	208.83 205.03
ELEV. 5	206.83 203.03
ELEV. 6	203.83 200.03

SWM DESIGN TABLE	
LOT 3	MB 3 MB 4
ELEV. 1	211.50 206.20
ELEV. 2	211.50 206.20
ELEV. 3	210.50 205.20
ELEV. 4	210.33 205.03
ELEV. 5	208.33 203.03
ELEV. 6	205.33 200.03

SWM DESIGN TABLE	
LOT 4	MB 5 MB 6
ELEV. 1	211.50 204.00
ELEV. 2	211.50 204.00
ELEV. 3	210.50 203.00
ELEV. 4	210.33 202.83
ELEV. 5	208.33 200.83
ELEV. 6	205.33 197.83

SHC TABLE	
'A'	8.0' 10.0'
'B'	5.0' 4.0'

ADDRESS CHART	
LOT NO.	INV. @ MAIN
2	199.30
3	192.85
4	190.02

ESD PRACTICE SUMMARY TABLE					
Practice	DA to practice	Q ₁	Q ₂	Q ₃	Q ₄
(M-3) Micro-Bioretention	#1	100	98	76	40
(M-4) Micro-Bioretention	#2	101	99	77	40
(M-5) Micro-Bioretention	#3	102	100	78	40
(M-6) Micro-Bioretention	#4	103	101	79	40
(M-7) Micro-Bioretention	#5	104	102	80	40
(M-8) Micro-Bioretention	#6	105	103	81	40
(M-9) Micro-Bioretention	#7	106	104	82	40
TOTAL (not including disconnection) =					729

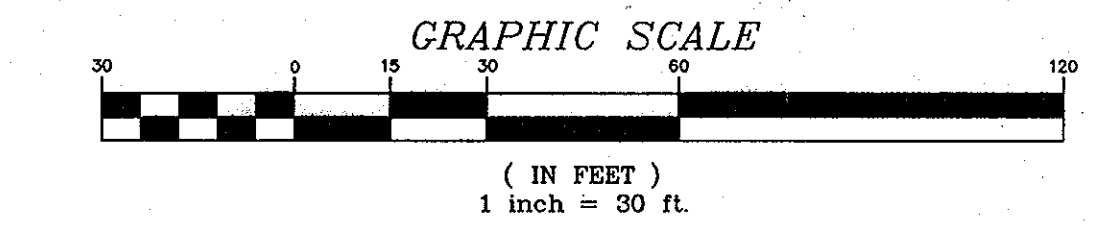

MATERIALS AND SPECIFICATIONS FOR (M-6) MICRO-BIORETENTION		
MATERIAL	SPECIFICATION	NOTES:
PLANTINGS (IF REQUIRED)	SEE APPENDIX A; TABLE A.4	PLANTINGS ARE SITE SPECIFIC
PLANTING SOIL (2.0' TO 4.0' DEEP)	LOAMY SAND (60-85%) & COMPOST (35-40%) OR LOAMY SAND (30%) & COMPOST (35-40%)	USDA SOIL TYPES: LOAMY SAND, SANDY LOAM; CLAY CONTENT <5%
ORGANIC CONTENT	MIN. 10% BY DRY WEIGHT (ASTM D2272)	N/A
MULCH	SHREDDED HARDWOOD	AGED 6 MONTHS, MINIMUM
PEA GRAVEL DIAPHRAGM	PEA GRAVEL: ASTM D-448	#8 OR #9 (1/8" TO 3/8")
GEOTEXTILES	N/A	PE TYPE 1 - NONWOVEN
GRAVEL (UNDERDRAINS & BERMS)	AASHTO M-43	#57 OR #6 (3/8" TO 3/4")
UNDERDRAIN PIPING	F758, TYPE PS28 OR AASHTO M-278	4" TO 6" RIGID SCH.40 PVC OR 30R35
POURED-IN-PLACE CONC. (IF REQUIRED)	MSHA MIX NO. 3; CONCRETE: 28 DAYS, NORMAL WEIGHT, AIR ENCLOSED; REINFORCING TO MEET ASTM 615-60	ON-SITE TESTING OF POURED-IN-PLACE CONC. REQUIRED; 28 DAY STRENGTH TEST AND SLUMP TEST; ALL CONC. DESIGN CAST -IN-PLACE OR PRE-CAST NOT USING PREVIOUSLY APPROVED STATE OR LOCAL STANDARDS; DESIGN DRAWINGS SEALED AND APPROVED BY A PROFESSIONAL STRUCTURAL ENGINEER LICENSED IN THE STATE OF MARYLAND; DESIGN TO INCLUDE MEETING ALL CODE 360.0.8.8. VERTICAL LOADING (H=10' OR H=20) ALLOWABLE HORIZONTAL LOADING (BASED ON SOIL PRESSURES); AND ANALYSIS OF POTENTIAL CRACKING SAND SUBSTITUTIONS SUCH AS DIALITE AND GRANSTONE (AASHTO) #10 ARE NOT ACCEPTABLE. NO CALCIUM CARBONATED OR DOLOMITIC SAND SUBSTITUTIONS ARE ACCEPTABLE. NO ROCK DUST CAN BE USED FOR SAND.
SAND	AASHTO M-6 OR ASTM C-33	0.02" TO 0.04"

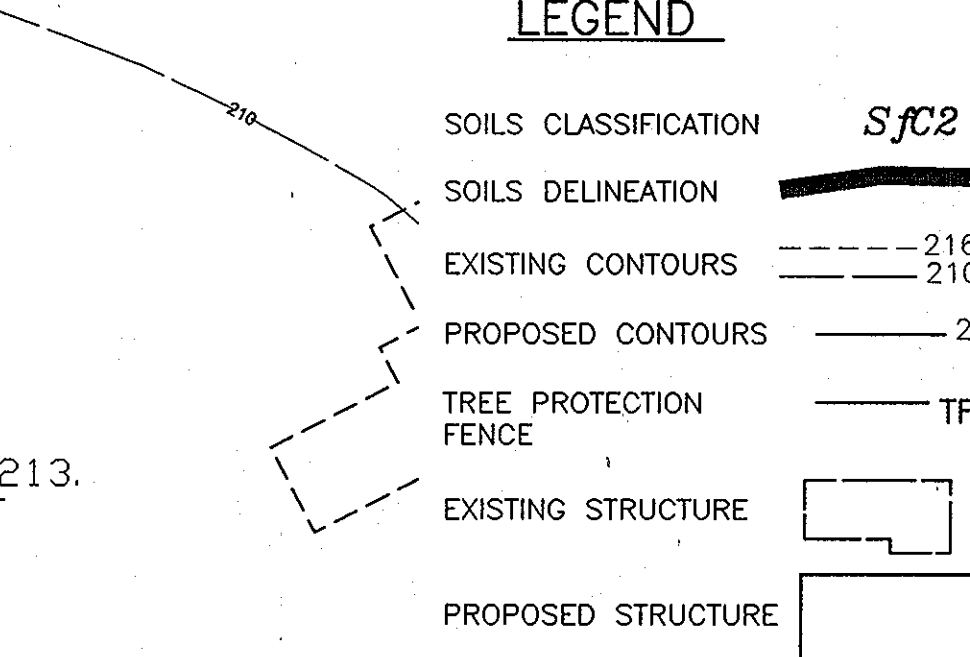

BENCHMARKS NAD'83 HORIZONTAL	
HO. CO. #38AA STAMPED BRASS DISK SET ON TOP OF CONCRETE BASE	N 561158.817' E 1389726.337' ELEVATION: 220.084'
HO. CO. #38BA STAMPED BRASS DISK SET ON TOP OF CONCRETE BASE	N 562553.314' E 1390967.86' ELEVATION: 186.184'

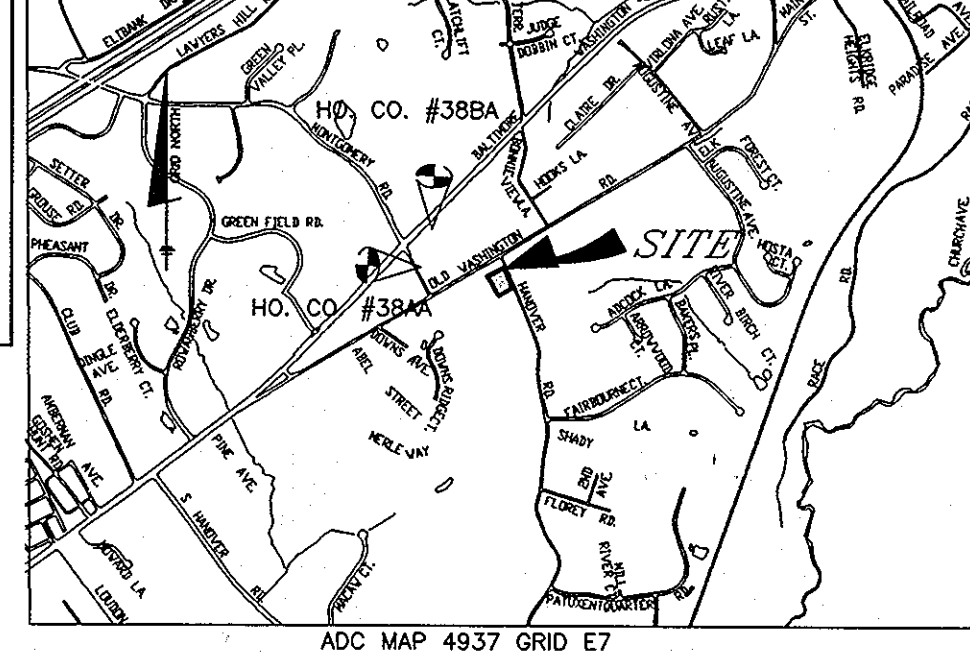

- LANDSCAPING NOTES**
1. PERIMETER LANDSCAPING SHALL BE PROVIDED BY THE PLANTINGS AS SHOWN ON THESE PLANS.
 2. TREES MUST BE A MINIMUM OF FOUR (4) FEET FROM THE CURB OR SIDEWALK AND MUST BE A MINIMUM OF FIVE (5) FEET FROM ANY STORM DRAIN.
 3. THIS PROPERTY IS WITHIN THE METROPOLITAN DISTRICT WATER AND SEWER SHALL BE PUBLIC, CONNECTING TO CONTRACT 14-4419-D FOR SEWER AND TO CONTRACT 44-0906 FOR WATER. DRAINAGE AREA IS WITHIN THE PATAPSCO RIVER AREA WATERSHED.
 4. A MINIMUM DISTANCE OF TWENTY (20) FEET MUST BE MAINTAINED BETWEEN ANY TREES LOCATED ALONG THE CURB LINE AND FROM ANY STREET LIGHTS.
 5. TREES MUST BE PLANTED A MINIMUM OF TEN (10) FEET FROM A DRIVEWAY.
 6. THIS PLAN HAS BEEN PREPARED IN ACCORDANCE WITH THE PROVISIONS OF SECS-18.24 OF THE HOWARD COUNTY CODE AND LANDSCAPE MANUAL.
 7. FINANCIAL SURETY FOR THE TOTAL REQUIRED LANDSCAPING WILL BE POSTED AS PART OF THE BUILDERS GRADING PERMIT IN THE AMOUNT OF \$3,600.00 (\$1,500.00 FOR 5 SHADE TREES AND \$2,100.00 FOR 7 STREET TREES).

AT THE TIME OF INSTALLMENT, ALL SHRUBS AND OTHER PLANTINGS HEREWITH LISTED AND APPROVED FOR THIS SITE SHALL BE OF THE PROPER HEIGHT REQUIREMENTS IN ACCORDANCE WITH THE HOWARD COUNTY LANDSCAPE MANUAL. IN ADDITION, NO SUBSTITUTIONS OR RELOCATION OF REQUIRED PLANTINGS MAY BE MADE WITHOUT PRIOR REVIEW AND APPROVAL FROM THE DEPARTMENT OF PLANNING AND ZONING. ANY DEVIATION FROM THIS APPROVED LANDSCAPE PLAN MAY RESULT IN DENIAL OR DELAY IN RELEASE OF LANDSCAPE SURETY UNTIL SUCH TIME AS ALL REQUIRED MATERIALS ARE PLANTED AND/OR REVISIONS ARE MADE TO APPLICABLE PLANS AND CERTIFICATES.

SITE ANALYSIS DATA CHART	
GENERAL SITE DATA	
1. PRESENT ZONING:	R-12
2. APPLICABLE DPZ FILE REFERENCES:	F-06-238, CONT. NO. 14-4419-D
3. DEED REFERENCE:	LIBER 9201 / FOLIO 560
4. PROPOSED USE OF SITE:	SINGLE-FAMILY DETACHED
5. PROPOSED WATER AND SEWER SYSTEMS:	PUBLIC AREA TABULATION
1. GROSS TRACT AREA:	0.93 AC±
2. AREA WITHIN 100-YEAR FLOODPLAIN:	0.00 AC±
3. TOTAL AREA OF 25% OR GREATER STEEP SLOPES:	0.00 AC±
4. NET TRACT AREA:	0.93 AC±
5. TOTAL NUMBER OF RESIDENTIAL UNITS/LOTS PROPOSED ON THIS SUBMISSION:	3
6. TOTAL NUMBER OF PARKING SPACES @ 2 PER UNIT (PARKING PROVIDED IN DRIVEWAY & GARAGE)	6
7. AREA OF ROAD RIGHT-OF-WAY:	0.00 AC±
8. OPEN SPACE ON-SITE TOTAL REQUIREMENTS (MINIMUM RESIDENTIAL LOT SIZE):	12,000 S.F.
9. THE MINIMUM OPEN SPACE REQUIREMENT OF SIX (6) WAYS MET THROUGH A PAYMENT OF A FEE-IN-LIEU OF OPEN SPACE IN THE AMOUNT OF \$4,500.00. THIS FEE WAS PAID UNDER F-06-238 AND IN ACCORDANCE WITH SECTION 16.121(1)(2)(i) OF THE SUBDIVISION AND LAND DEVELOPMENT REGULATIONS.	

SCHEDULE A PERIMETER LANDSCAPE EDGE					
CATEGORY	ADJACENT TO ROADWAY	ADJACENT TO PERIMETER PROPERTIES	NO	YES	TOTAL
PERIMETER NO. / LANDSCAPE TYPE	1 / A	2 / A			
LINEAR FEET OF (FRONTAGE/PERIMETER)	238.68	155.66			394.34
CREDIT FOR EXISTING VEGETATION: NO OR YES (W/LINEAR FEET) (DESCRIBE BELOW IF NEEDED)		2 EX. TREES			
CREDIT FOR WALL, FENCE OR BERM: NO OR YES (W/LINEAR FEET) (DESCRIBE BELOW IF NEEDED)					
NUMBER OF PLANTS REQUIRED: SHADE TREES, EVERGREEN TREES, OTHER TREES (2:1 SUBSTITUTE), SHRUBS		4	3	7	
NUMBER OF PLANTS PROVIDED: SHADE TREES, EVERGREEN TREES, OTHER TREES (2:1 SUBSTITUTE), SHRUBS (1:1 SUBSTITUTE)		2**	3	5**	

PUBLIC STREET TREE PLANTING LIST				
SYMBOL	QUANTITY	NAME	REMARKS	NOTES
⊙	7	PRUNUS SARGENTI 'SARGENT CHERRY'	2 1/2"-3" CAL.	STREET TREES TO BE PROVIDED BY THE BUILDER

SOILS LEGEND	
SOIL GROUP	SOIL TYPE
SC12	B SASSAFRAS GRAVELLY SAND LOAM, 9 TO 10 PERCENT SLOPES, MODERATELY ERODED
SD12	B SASSAFRAS LOAM, 10 TO 15 PERCENT SLOPES, MODERATELY ERODED

SHEET INDEX	
NO.	DESCRIPTION
1	SITE DEVELOPMENT PLAN, STORMWATER MANAGEMENT PLAN, LANDSCAPE PLAN AND NOTES AND DETAILS
2	SEDIMENT & EROSION CONTROL AND GRADING PLAN

PERIMETER LANDSCAPE PLANTING LIST			
SYMBOL	QUANTITY	NAME	REMARKS
⊙	3	ACER SACCABINUM VERNINA 'MORNING GLORY'	2 1/2"-3" CAL.
⊙	2	QUERCUS VENTRIS (LUTEA) 'YELLOWBLOW'	2 1/2"-3" CAL.

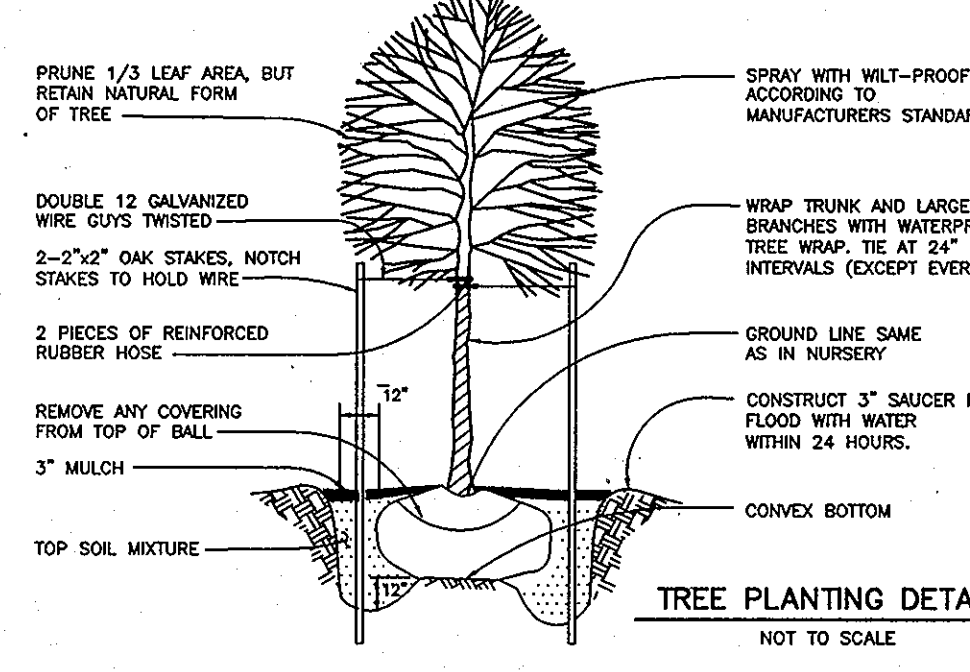

PERMIT INFORMATION CHART					
SUBDIVISION NAME:	SECTION/AREA:	PARCEL:			
BAKER PROPERTY		201			
PLAT:	BLOCK No.	ZONE:	TAX MAP:	ELECTION DISTRICT:	CENSUS TRACT:
21953	9	R-12	38	1	6012.01

BENCHMARK ENGINEERING, INC.
 ENGINEERS ■ LAND SURVEYORS ■ PLANNERS
 8480 BALTIMORE NATIONAL PIKE A STE 418
 ELLICOTT CITY, MARYLAND 21043
 PHONE: 410-465-6105 FAX: 410-465-6844
 www.benchmark-engineering.com

BAKER PROPERTY
 PROJECT: BAKER PROPERTY
 LOT 2 THRU 4 - SINGLE FAMILY DETACHED DWELLINGS
 PLAT NO. 21953; F-06-237; F-06-238
 LOCATION: TAX MAP 38 - GRID 9
 PARCEL 201
 1ST ELECTION DISTRICT
 HOWARD COUNTY, MARYLAND
 TITLE: SITE DEVELOPMENT PLAN, STORMWATER MANAGEMENT PLAN, LANDSCAPE PLAN AND NOTES AND DETAILS
 DATE: JULY 2012
 DECEMBER 2012
 PROJECT NO. 1853
 SCALE: AS SHOWN
 DRAWING 1 OF 2

Design: JC Draft: EDD Check: DAM

SEDIMENT CONTROL NOTES

- 1. A MINIMUM OF 24 HOURS NOTICE MUST BE GIVEN TO THE HOWARD COUNTY DEPARTMENT OF INSPECTION... 2. ALL VEGETATIVE AND STRUCTURAL PRACTICES ARE TO BE INSTALLED ACCORDING TO THE... 3. FOLLOWING INITIAL SOIL DISTURBANCE OR RESTORATION, PERMANENT OR TEMPORARY STABILIZATION SHALL BE COMPLETED WITHIN A 7 CALENDAR DAYS... 4. ALL SEDIMENT TRAPS/BASINS MUST BE FENCED AND WARNING SIGNS POSTED... 5. ALL DISTURBED AREAS MUST BE STABILIZED WITHIN THE TIME PERIOD SPECIFIED... 6. ALL SEDIMENT CONTROL STRUCTURES ARE TO REMAIN IN PLACE AND ARE TO BE MAINTAINED... 7. SITE ANALYSIS: TOTAL AREA OF SITE (THIS SUBMISSION) 0.93 ACRES... 8. ANY SEDIMENT CONTROL PRACTICE WHICH IS DISTRIBUTED BY GRADING ACTIVITY... 9. ADDITIONAL SEDIMENT CONTROL MUST BE PROVIDED, IF DEEMED NECESSARY... 10. ALL SITES WITH DISTURBED AREAS IN EXCESS OF 3 ACRES... 11. TRENCHES FOR THE CONSTRUCTION OF UTILITIES IS LIMITED TO THREE PIPE LENGTHS... PERMANENT SEEDING PREPARATIONS: SEEDING PREPARATION: LOOSEN UPPER THREE INCHES OF SOIL BY RANING, DISING OR OTHER ACCEPTABLE MEANS BEFORE SEEDING... SOIL AMENDMENTS: IN LIEU OF SOIL TEST RECOMMENDATIONS, USE ONE OF THE FOLLOWING SHOULDRS: 1. REFERRED - APPLY 2 TONS PER ACRE... 2. ACCEPTABLE - APPLY 2 TONS PER ACRE... SEEDING: FOR THE PERIOD MARCH 1 THROUGH APRIL 30 AND AUGUST 1 THROUGH OCTOBER 15... MULCHING: APPLY 1-1/2 TO 2 TONS PER ACRE... MAINTENANCE: INSPECT ALL SEEDED AREAS AND MAKE NEEDED REPAIRS, REPLACEMENTS AND RESEEDING.

PERMANENT SEEDING PREPARATIONS

- SEEDING PREPARATION: LOOSEN UPPER THREE INCHES OF SOIL BY RANING, DISING OR OTHER ACCEPTABLE MEANS BEFORE SEEDING... SOIL AMENDMENTS: IN LIEU OF SOIL TEST RECOMMENDATIONS, USE ONE OF THE FOLLOWING SHOULDRS: 1. REFERRED - APPLY 2 TONS PER ACRE... 2. ACCEPTABLE - APPLY 2 TONS PER ACRE... SEEDING: FOR THE PERIOD MARCH 1 THROUGH APRIL 30 AND AUGUST 1 THROUGH OCTOBER 15... MULCHING: APPLY 1-1/2 TO 2 TONS PER ACRE... MAINTENANCE: INSPECT ALL SEEDED AREAS AND MAKE NEEDED REPAIRS, REPLACEMENTS AND RESEEDING.

TEMPORARY SEEDING PREPARATIONS

- APPLY TO GRADED OR CLEARED AREAS LIKELY TO BE REDISTURBED... SEEDING PREPARATION: LOOSEN UPPER THREE INCHES OF SOIL BY RANING, DISING OR OTHER ACCEPTABLE MEANS BEFORE SEEDING... SOIL AMENDMENTS: APPLY 600 LBS PER ACRE... SEEDING: FOR PERIOD MARCH 1 THROUGH APRIL 30 AND FROM AUGUST 1 THROUGH NOVEMBER 15... MULCHING: APPLY 1-1/2 TO 2 TONS PER ACRE... NOTE: EROSION CONTROL MATTING SHALL BE PLACED IN SWALES WHERE DEEMED NECESSARY... NOTE: STOCKPILING WILL NOT BE PERMITTED ON-SITE... NOTE: A DOUBLE ROW OF SUPER SILT FENCE IS TO BE PLACED ALONG HANOVER ROAD AT THE DISCRETION OF THE SEDIMENT CONTROL INSPECTOR.

LEGEND

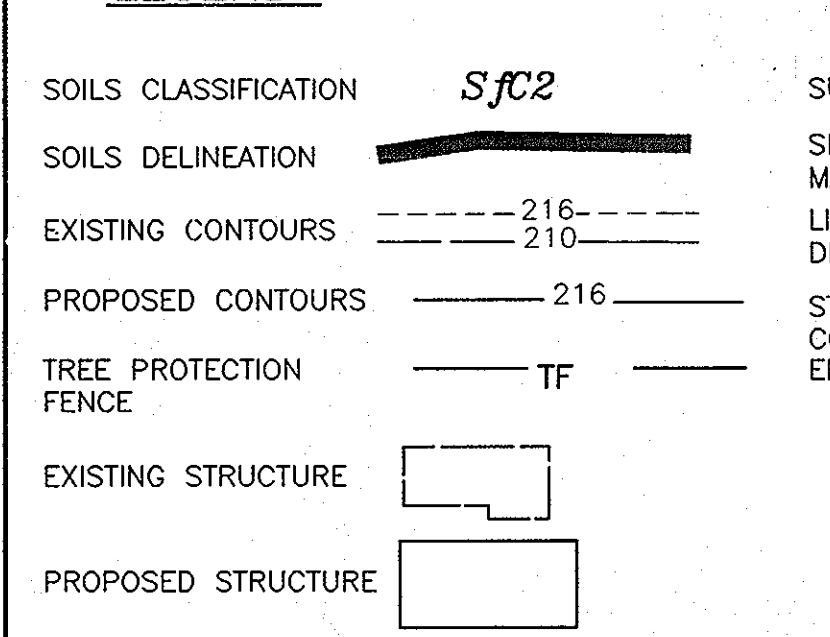

ENGINEER'S CERTIFICATE: I CERTIFY THAT THIS PLAN FOR SEDIMENT AND EROSION CONTROL... 12/11/2012

DEVELOPER'S CERTIFICATE: I/VE CERTIFY THAT ALL DEVELOPMENT AND CONSTRUCTION WILL BE DONE ACCORDING TO THIS PLAN FOR SEDIMENT AND EROSION CONTROL... 12/11/12

APPROVED: HOWARD COUNTY DEPARTMENT OF PLANNING AND ZONING: John K. Robertson 1/3/13

APPROVED: HOWARD COUNTY DEPARTMENT OF ENVIRONMENTAL AND PLANNING: [Signature] 1/15/13

APPROVED: HOWARD COUNTY DEPARTMENT OF ENVIRONMENTAL AND PLANNING: [Signature] 1/13/13

TOPSOIL SPECIFICATIONS

- 1. Topsoil salvaged from the existing site may be provided that it meets that standards as set forth in these specifications... 2. Topsoil Specifications - Soil to be used as topsoil must meet the following: a. Topsoil shall be a loam, sandy loam, clay loam, loamy sand... b. Topsoil must be free of plants or plant parts... c. When the subsoil is either highly oxidized or composed of heavy clays... 3. For sites having disturbed areas over 5 acres: 1. Place topsoil (if required) and apply soil amendments as specified... 4. For sites having disturbed areas over 5 acres: 1. On soil meeting topsoil specifications, obtain test results... a. pH for topsoil shall be between 6.0 and 7.5... b. Organic content or topsoil shall not be less than 1.5 percent by weight... 5. Topsoil having soluble salt content greater than 500 parts per million shall not be used... 6. No soil or silt shall be placed on soil which has been treated with soil chemicals... 7. Topsoil shall be placed in a layer not less than 4" thick... 8. Topsoil shall be uniformly distributed in a 4" - 8" layer... 9. Topsoil shall be placed where the topsoil or subsoil is in a frozen or muddy condition... 10. Alternative for Permanent Seeding - Instead of applying the full amounts of lime and commercial fertilizer... 11. Composted Sludge Material for use as a soil conditioner... a. Composted sludge shall be applied by or originate from a person... b. Composted sludge shall contain not less than 1 percent nitrogen... c. Composted sludge shall be applied at a rate of 1 ton/1,000 square feet... 12. Composted sludge shall be amended with a potassium fertilizer... References: Guidelines Specifications, Soil Preparation and Seeding, MD-VL, Pub. #1, Cooperative Extension Service, University of Maryland and Virginia Polytechnic Institute, Revised 1973.

SEQUENCE OF CONSTRUCTION

- NOTIFY SEDIMENT CONTROL DIVISION 48 HOURS PRIOR TO START OF CONSTRUCTION... DAY 1 - 1) OBTAIN GRADING PERMIT; 2) INSTALL SEDIMENT CONTROLS THAT ARE NOTED TO BE INSTALLED UNDER THIS OPTION; 3) EXCAVATE FOR FOUNDATION, ROUGH GRADE AND STABILIZE IN ACCORDANCE WITH TEMPORARY SEEDING NOTES... DAY 2-6 - 2) INSTALL SEDIMENT CONTROLS THAT ARE NOTED TO BE INSTALLED UNDER THIS OPTION; 3) EXCAVATE FOR FOUNDATION, ROUGH GRADE AND STABILIZE IN ACCORDANCE WITH TEMPORARY SEEDING NOTES... DAY 7-10** - 3) EXCAVATE FOR FOUNDATION, ROUGH GRADE AND STABILIZE IN ACCORDANCE WITH TEMPORARY SEEDING NOTES... DAY 11-80** - 4) CONSTRUCT HOUSE, BACKFILL AND CONSTRUCT DRIVEWAY... DAY 80-89** - 5) WITH THE APPROVAL OF THE HOWARD COUNTY SEDIMENT CONTROL INSPECTOR, REMOVE SEDIMENT CONTROL DEVICES AND STABILIZE ANY REMAINING DISTURBED AREAS... ** INDICATES SINGLE HOUSE CONSTRUCTION. REPEAT AS NECESSARY.

LEGEND

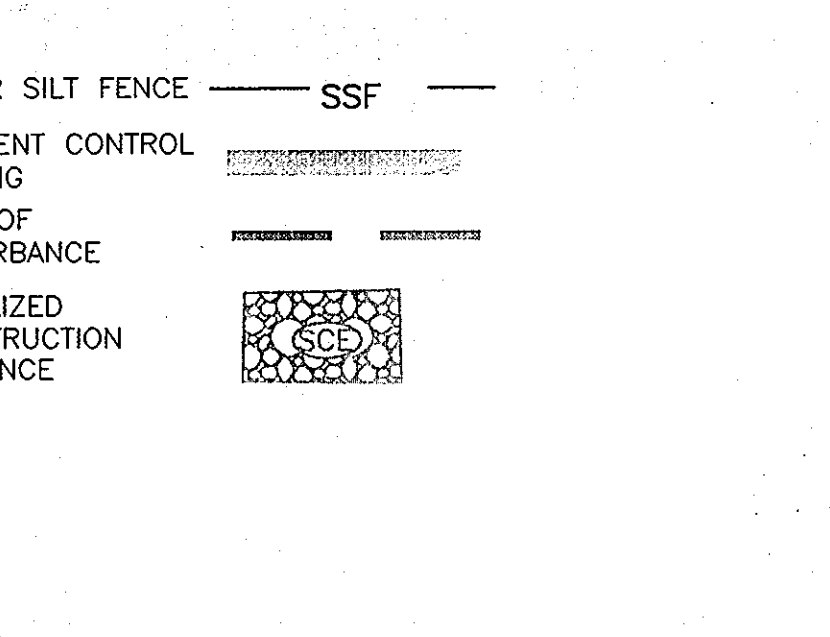

ENGINEER'S CERTIFICATE: I CERTIFY THAT THIS PLAN FOR SEDIMENT AND EROSION CONTROL... 12/11/2012

DEVELOPER'S CERTIFICATE: I/VE CERTIFY THAT ALL DEVELOPMENT AND CONSTRUCTION WILL BE DONE ACCORDING TO THIS PLAN FOR SEDIMENT AND EROSION CONTROL... 12/11/12

APPROVED: HOWARD COUNTY DEPARTMENT OF PLANNING AND ZONING: John K. Robertson 1/3/13

APPROVED: HOWARD COUNTY DEPARTMENT OF ENVIRONMENTAL AND PLANNING: [Signature] 1/15/13

APPROVED: HOWARD COUNTY DEPARTMENT OF ENVIRONMENTAL AND PLANNING: [Signature] 1/13/13

CONSTRUCTION SPECIFICATIONS

- These specifications are appropriate to all ponds within the scope of the Standard for pond construction MD-37B. All references to ASTM and AASHTO specifications apply to the most recent version... Site Preparation: Areas designated for borrow areas, embankment and structural works shall be cleared... Areas to be covered by the reservoir will be cleared of all trees, brush, logs, fences, rubbish and other objectionable material... Earth Fill: Material - The fill material shall be taken from approved disturbed borrow areas... Placement - Areas on which fill is to be placed shall be scooped prior to placement of fill... Composition - The movement of the hauling and spreading equipment over the fill shall be controlled so that the entire surface of each fill shall be traversed by not less than one... Cut/Off Trench - The cutoff trench shall be excavated to impervious material along or parallel to the embankment... Embankment Edge - There shall be a roller to the centerline of the embankment as shown on the plans... Structure Backfill: Structure backfill adjacent to pipes or structures shall be of the type and quality conforming to that specified in the existing fill material... Concrete: Concrete shall meet the requirements of Maryland Department of Transportation... Rock Riprap: Rock riprap shall meet the requirements of Maryland Department of Transportation... Care of Water during Construction: All work on permanent structures shall be carried out in areas free from water... Slope Protection: All borrow areas shall be graded to provide proper drainage... Erosion and Sediment Control: Construction operations will be carried out in such a manner that erosion will be controlled... Details: DETAIL E-1 SILT FENCE, DETAIL E-1 SUPER SILT FENCE, DETAIL C-3 SILT DIVERSION FENCE, DETAIL 24 - STABILIZED CONSTRUCTION ENTRANCE, DETAIL 30 - EROSION CONTROL MATTING, DETAIL 33 - SUPER SILT FENCE, DETAIL 30 - SUPER SILT FENCE.

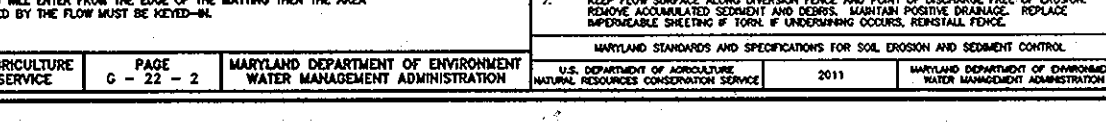
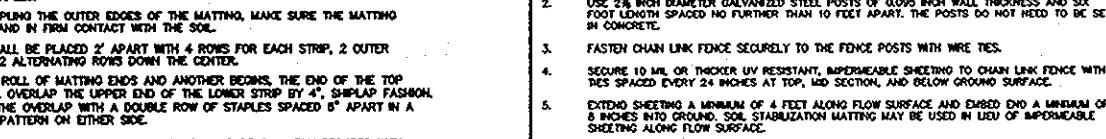
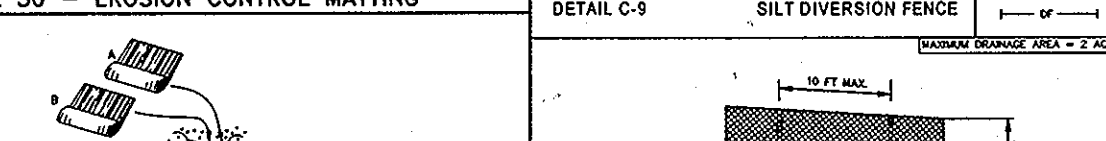

CONSTRUCTION SPECIFICATIONS

- These specifications are appropriate to all ponds within the scope of the Standard for pond construction MD-37B. All references to ASTM and AASHTO specifications apply to the most recent version... Structure Backfill: Structure backfill adjacent to pipes or structures shall be of the type and quality conforming to that specified in the existing fill material... Concrete: Concrete shall meet the requirements of Maryland Department of Transportation... Rock Riprap: Rock riprap shall meet the requirements of Maryland Department of Transportation... Care of Water during Construction: All work on permanent structures shall be carried out in areas free from water... Slope Protection: All borrow areas shall be graded to provide proper drainage... Erosion and Sediment Control: Construction operations will be carried out in such a manner that erosion will be controlled... Details: DETAIL E-1 SILT FENCE, DETAIL E-1 SUPER SILT FENCE, DETAIL C-3 SILT DIVERSION FENCE, DETAIL 24 - STABILIZED CONSTRUCTION ENTRANCE, DETAIL 30 - EROSION CONTROL MATTING, DETAIL 33 - SUPER SILT FENCE, DETAIL 30 - SUPER SILT FENCE.

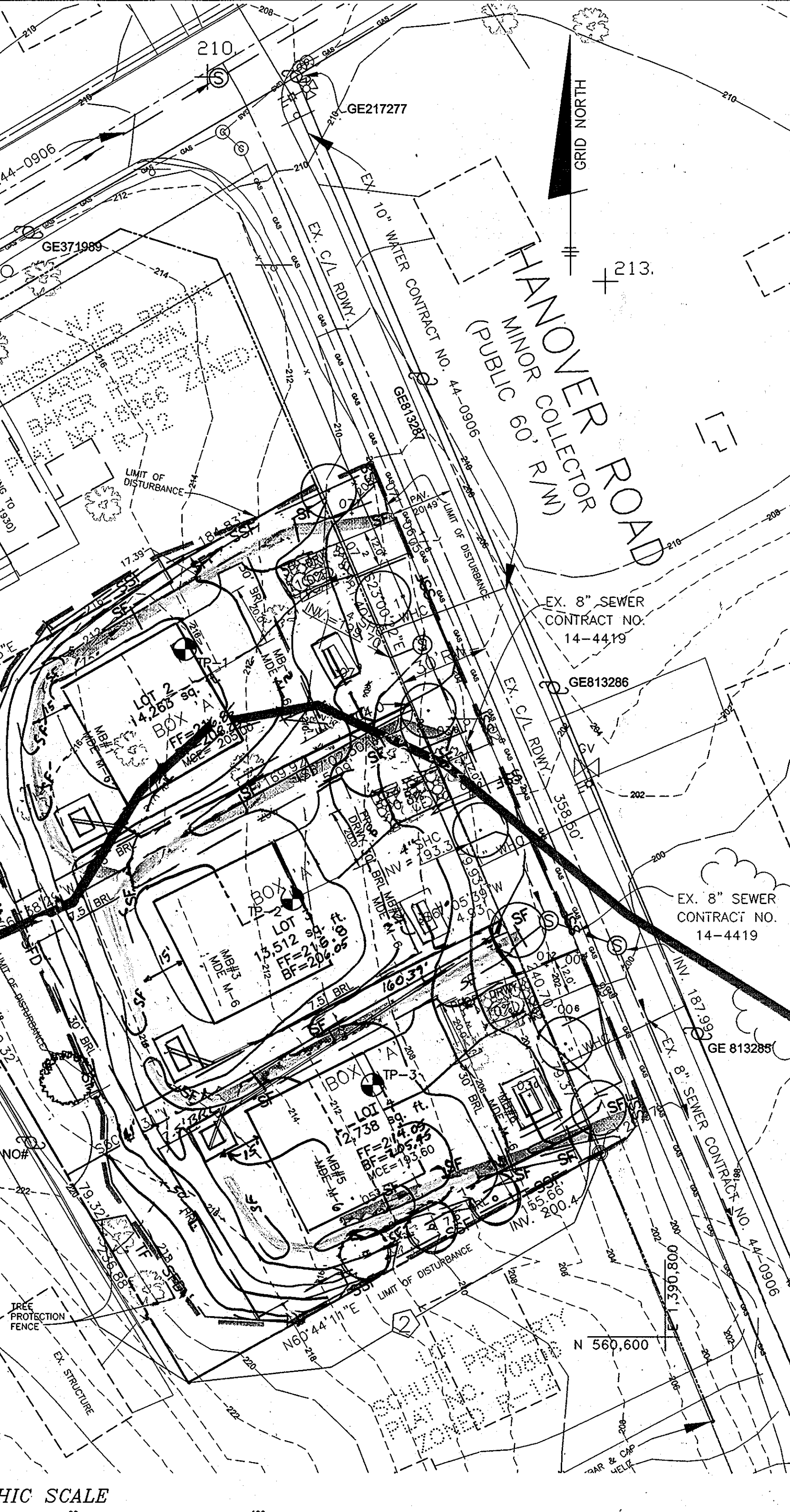
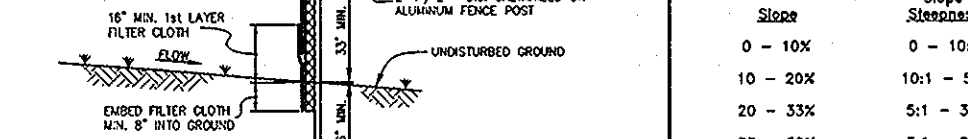
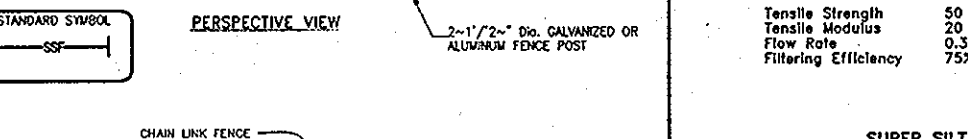
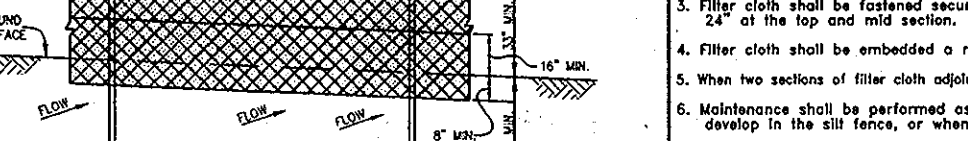
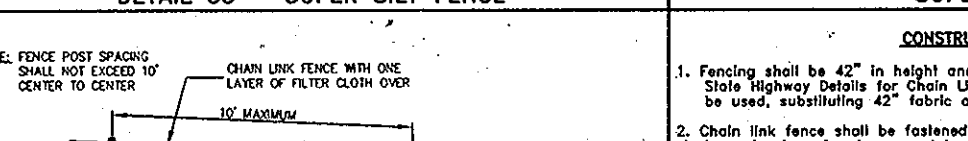
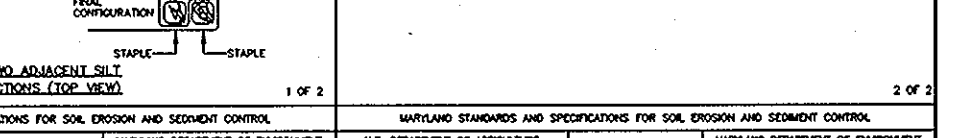
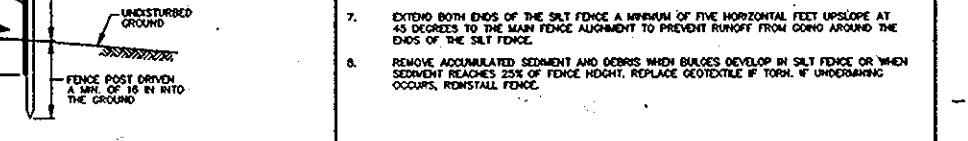
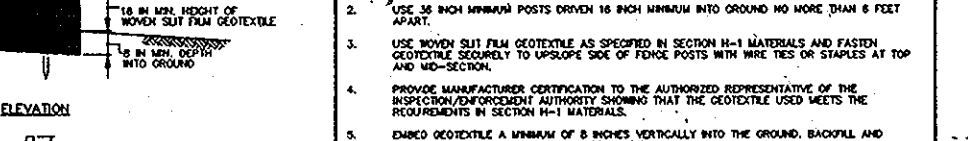

BENCHMARK ENGINEERING, INC. 8480 BALTIMORE NATIONAL PIKE SUITE 418, ELLICOTT CITY, MARYLAND 21043

OWNER: CHRISTOPHER L. BROWN, 4228 COLUMBIA ROAD, ELLICOTT CITY, MARYLAND 21042

PROJECT: BAKER PROPERTY, LOTS 2 THRU 4 - SINGLE FAMILY DETACHED DWELLINGS, PLAT NO. 21953; F-06-237; F-06-238

TITLE: SEDIMENT & EROSION CONTROL AND GRADING PLAN

DATE: JULY 2012, DECEMBER 2012, PROJECT NO. 1853, SCALE: AS SHOWN, DRAWING 2 OF 2

Professional Certificate: I hereby certify that these documents were prepared or approved by me, and that I am a duly licensed professional engineer under the laws of the State of Maryland... BENCHMARK ENGINEERING, INC. ENGINEERS & LAND SURVEYORS & PLANNERS