

TYPICAL DITCH SECTION
NOT TO SCALE

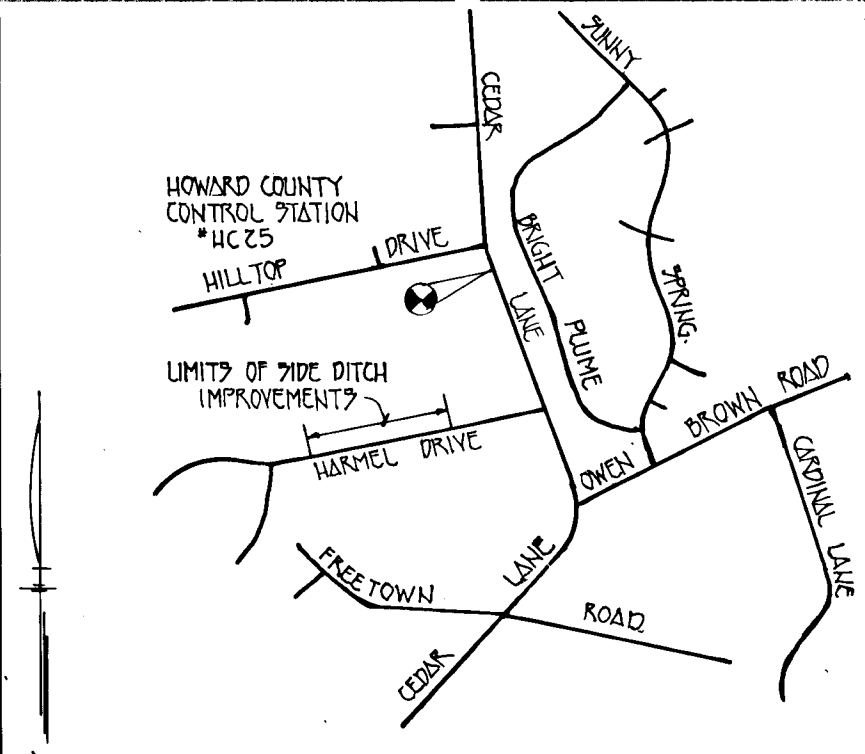
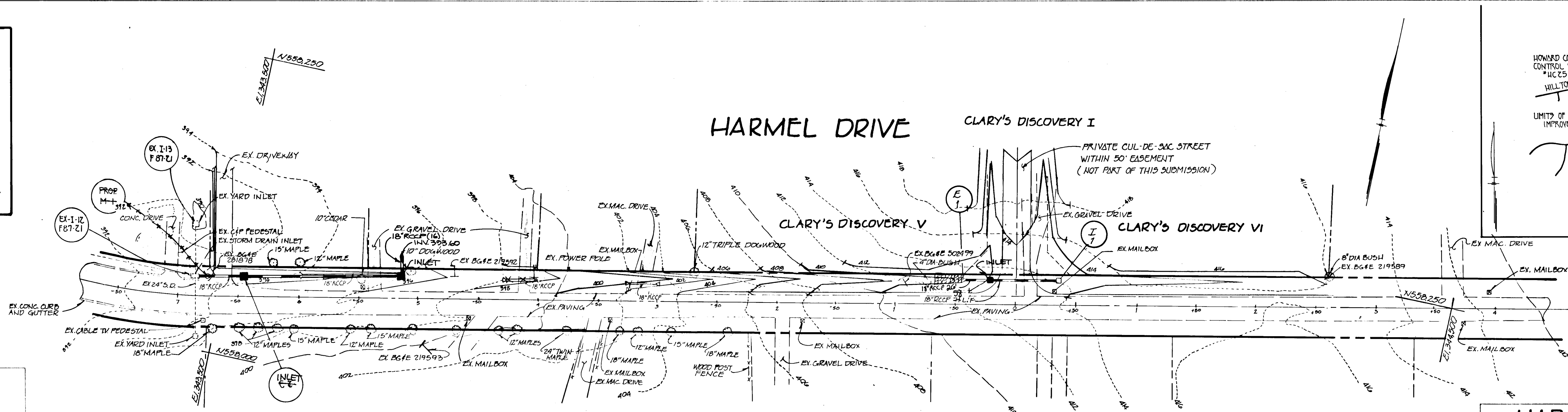

PLAN
BY: [Signature]
DATE: 7-14-95
NO.:

APPROVED
DEPARTMENT OF PUBLIC WORKS

Richard M. Deneke
7-14-95
CHIEF, BUREAU OF HIGHWAYS

APPROVED
DEPARTMENT OF PLANNING AND ZONING

Richard Blood
8/3/95
CHIEF, DIVISION OF PLANNING AND ZONING

APPROVED
DEPARTMENT OF PLANNING AND ZONING

Richard Blood
8/3/95
CHIEF, DIVISION OF PLANNING AND ZONING

LOCATION: HARMEL DRIVE
TAX MAP: 35 PARCEL No: 94 AND 95
ZONING: R-20 ELECTION DISTRICT No: 5

- NOTE:
- UNLESS OTHERWISE NOTED, ALL CONSTRUCTION IS TO BE IN ACCORDANCE WITH THE FOLLOWING:
 - A. HOWARD COUNTY STANDARD SPECIFICATIONS AND DETAILS FOR CONSTRUCTION.
 - B. MARYLAND STATE HIGHWAY ADMINISTRATION STANDARD SPECIFICATIONS FOR CONSTRUCTION AND MATERIALS, AS AMENDED.
 - C. SOIL CONSERVATION SERVICE 1994 STANDARD SPECIFICATIONS AND SPECIFICATIONS FOR SOIL EROSION AND SEDIMENT CONTROL.
 - THE CONTRACTOR SHALL NOTIFY THE DEPARTMENT OF PUBLIC WORKS BUREAU OF CONSTRUCTION INSPECTION AT 410-315-1070 AT LEAST (5) WORKING DAYS PRIOR TO THE START OF CONSTRUCTION.
 - THE CONTRACTOR SHALL NOTIFY 'MISS UTILITY' AT 1-800-257-7777 AT LEAST 48 HOURS PRIOR TO ANY EXCAVATION.
 - SITE DATA:
 - LOCATION: HARMEL DRIVE
 - TAX MAP: 35 PARCEL No: 94 AND 95
 - ZONING: R-20 ELECTION DISTRICT No: 5

PLAN
SCALE: 1"=50'

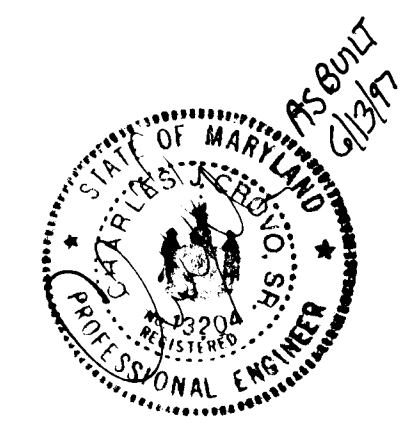

THE HORIZONTAL & VERTICAL CONTROL IS BASED ON THE FOLLOWING STATIONS:
 HC25 N56255.54 HC25CS N562145.41
 E 1344605.20 E1344564.50

HARMEL DRIVE
SIDE DITCH
IMPROVEMENTS PLAN AND PROFILE
CLARY'S DISCOVERY II

OWNER AND DEVELOPER
HARMEL, LLC
CLAYME MARK BEICH
10805 HICKORY RIDGE ROAD
COLUMBIA, MARYLAND 21044

SCALE AS SHOWN DATE: JUNE, 1995 DWG NO: 1 OF 2
DES: W.K.F. CHK: R. POOLE

FISHER COLLINS AND CARTER, INC.
CIVIL ENGINEERS AND LAND SURVEYORS
3711 BALTIMORE NAT. PIKE, SUITE 100, ELLICOTT CITY, MD 21042

1743

PROFILE
BY: [Signature]
DATE: 7/14/95
NO.:

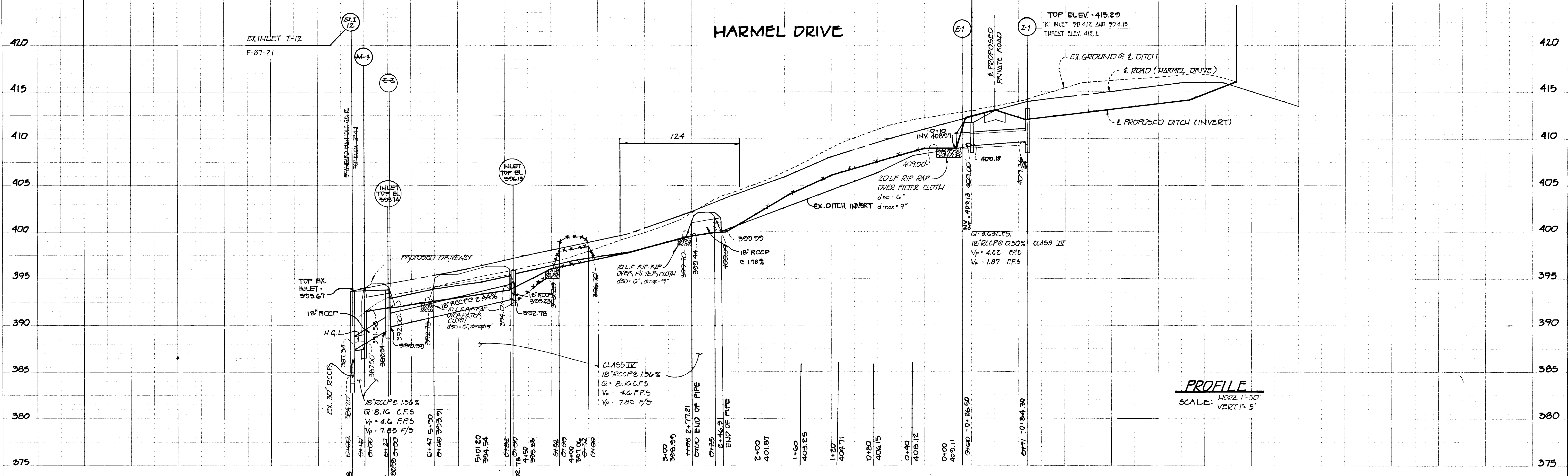

PROFILE
SCALE: HORIZ. 1"=50' VERT. 1"=5'

F-95-85 AS BUILT