

CENTERLINE CURVE DATA						
NAME & PC to PT.	RADIUS	DELTA	ARC	TAN.	CHORD	BEARING
TARKINGTON PLACE PC 3+21.55 to PT 4+28.87	220.00'	27°57'00"	107.32'	54.75'	106.26'	N67°31'30"W
TARKINGTON PLACE PC 5+28.26 to PT 6+35.04	215.00'	30°56'03"	116.08'	59.49'	114.67'	N69°01'02"W
TARKINGTON PLACE PC 9+63.62 to PT 10+47.89	30.00'	49°29'03"	78.27'	109.98'	57.89'	N09°44'32"W
TARKINGTON PLACE PC 11+51.09 to PT 12+36.51	160.00'	30°30'57"	85.22'	43.64'	84.21'	S09°44'32"E

CURB & GUTTER LEGEND	
Standard 7" C & G	—————
Standard 6" C & G	—————
Modified Comb. C & G	—————
Rev. Standard 7" C & G	—————
Rev. Standard 6" C & G	—————
Rev. Modified Comb. C & G	—————

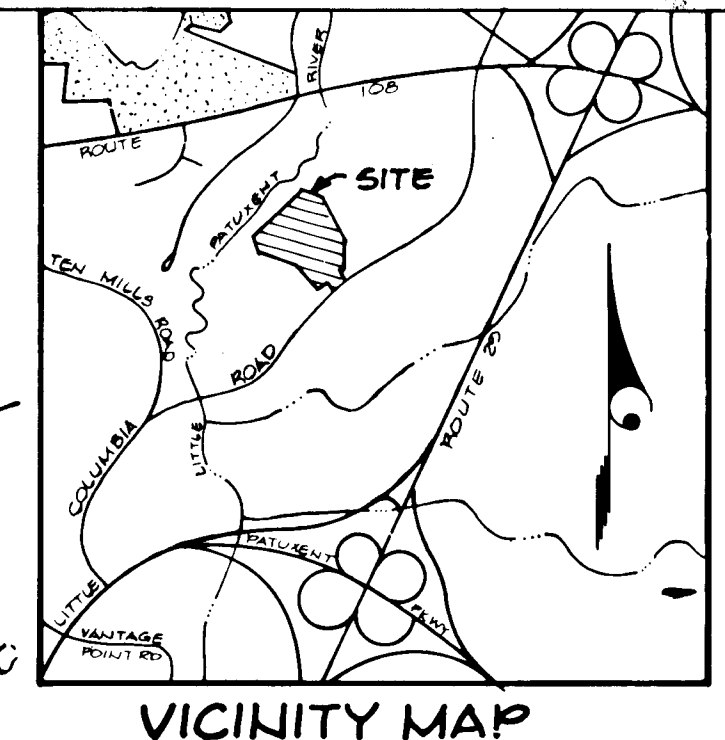

- ### GENERAL NOTES
- All work shall be done in accordance with HoCo Design Manual, Vol. IV, Stds. and Specs. and Details for Construction, 1999 Amendments.
  - Type of Storm Drainage refer to the standard details of HoCo & U.D.S.H.A.
  - Trench Compaction for Storm Drains within road or street right-of-way limits shall be in accordance with HoCo Design Manual, Vol. IV, Std. G.2(D).
  - Information concerning underground utilities was obtained from available records, but the Contractor must determine the exact location and elevation of mains by digging test pits, by hand, at all utility crossings well in advance of construction.
  - All utility companies shall be notified 24 hrs. in advance of construction.
  - All traffic services, parking and signing to be done in accordance with the Manual of Uniform Traffic Control Devices, 1984 Revised Edition.
  - Sag and Crest Vertical Curves were designed in accordance with the HoCo Design Manual, Vol. III.
  - Provide Conc. Sidewalk Ramps where shown on plan. See Detail Sheet #5.
  - Design Speed: 30 MPH Zoning: NT, SF (attached).
  - The Contractor or Developer shall contact the Construction Inspection Survey Division 24 hrs. in advance of commencement of work. 792-7272.
  - Stormwater Management is provided Off-site.
  - Street lights to be placed 2'-10" behind curb and in accordance with Howard County Design Manual Vol. III.
  - File Reference: F-86-26, FDP 191 A, WP-89-179, S-89-89, P-90-30 and FDP-191-A1 & F-91-35.

No.	REVISION	DATE
2	Deleted Pond No. 2, Revised street numbers	7/2/93
1	Lowered street grade, adjusted TC's, storm drainage grading accordingly.	11/20/91

**PLAN**  
SCALE: 1" = 50'

ROADWAY LIGHTING LEGEND	
○	150 Watt "Modern" Sodium Vapor Lamp post top fixture on a 14' bronze fiberglass pole.

### TARKINGTON PLACE (PUBLIC)

STREET TREE TABLE				
SYM.	TYPE	SIZE	QUANT.	REMARKS
(P)	Platanus Acer-Folia Bloodwood	24.3" Cal / 12' Ht.	41	-
(A)	Acer Rubrum Red Sunset Red Sunset Maple	"	25	-

- The Contractor shall verify location of underground utilities prior to digging. Location of trees may be adjusted slightly to meet field conditions.
- The location and type of trees shown are tentative and are used for bond purposes only. The final location and variety of trees may vary to accommodate field conditions and builders landscape program. Bond release is contingent upon Section 16.13, of the Howard County Subdivision Regulations as approved by the Office of Planning and Zoning.

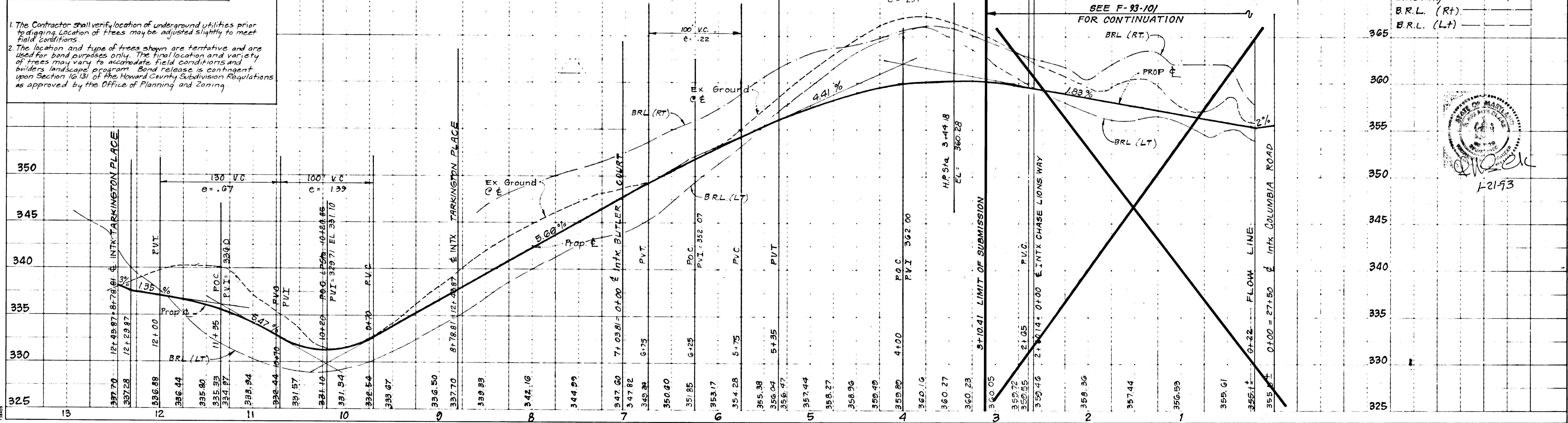

PROFILE LEGEND	
—	Profile Grade Line
- - -	Existing
—	B.R.L. (RT)
—	B.R.L. (LT)

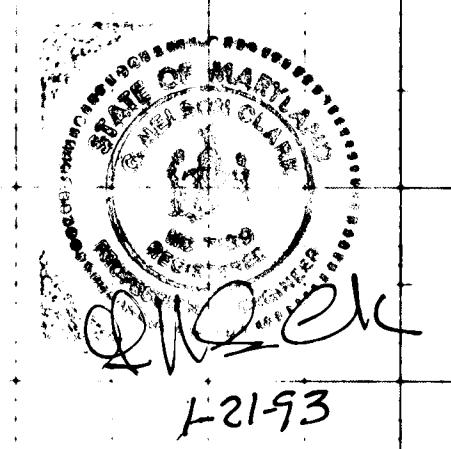

1159







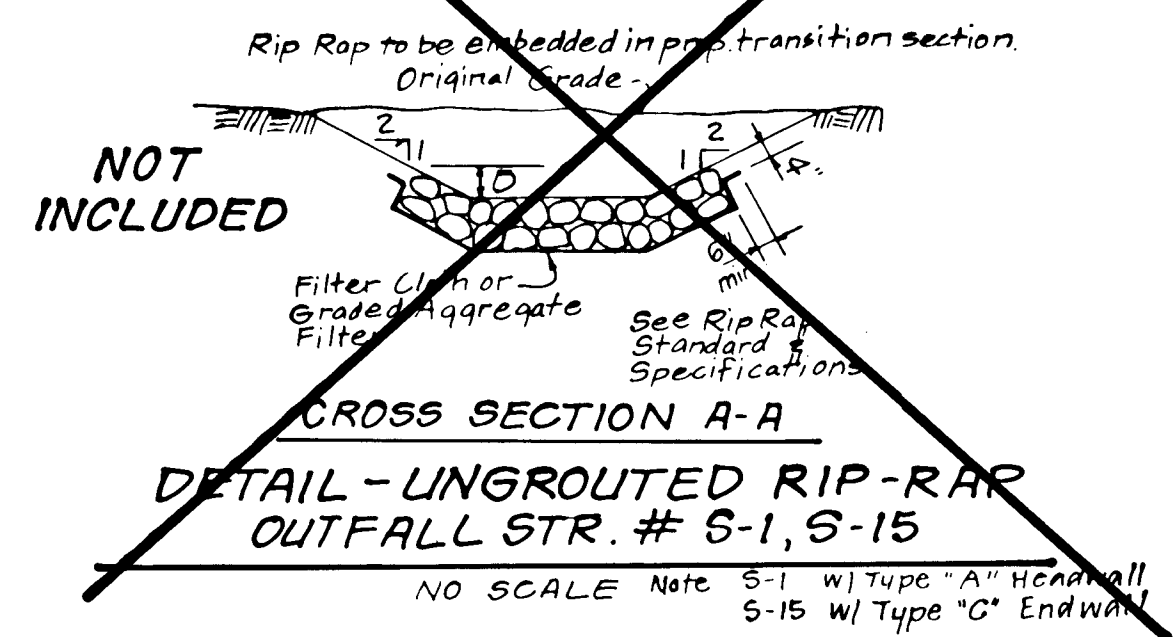
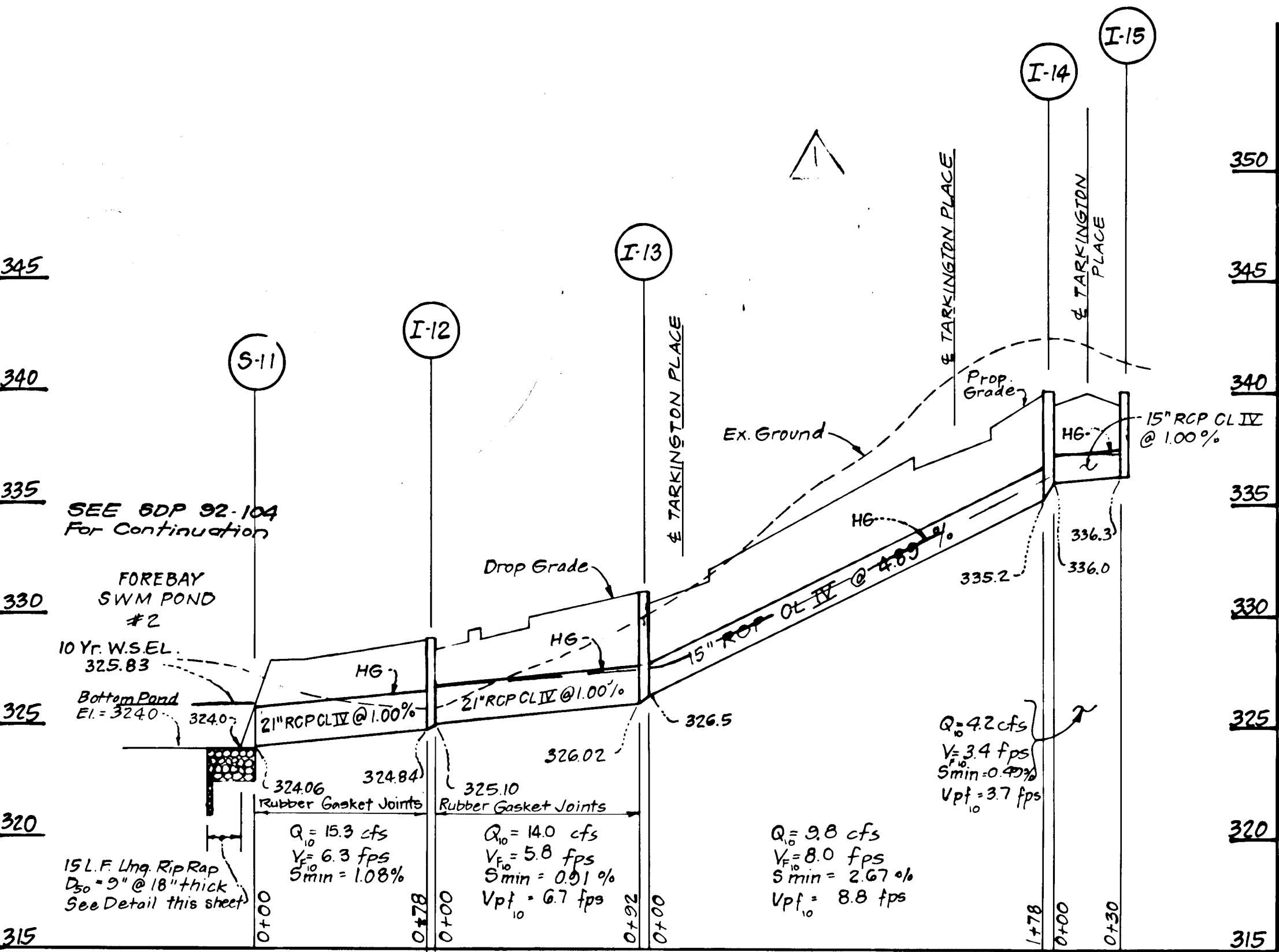
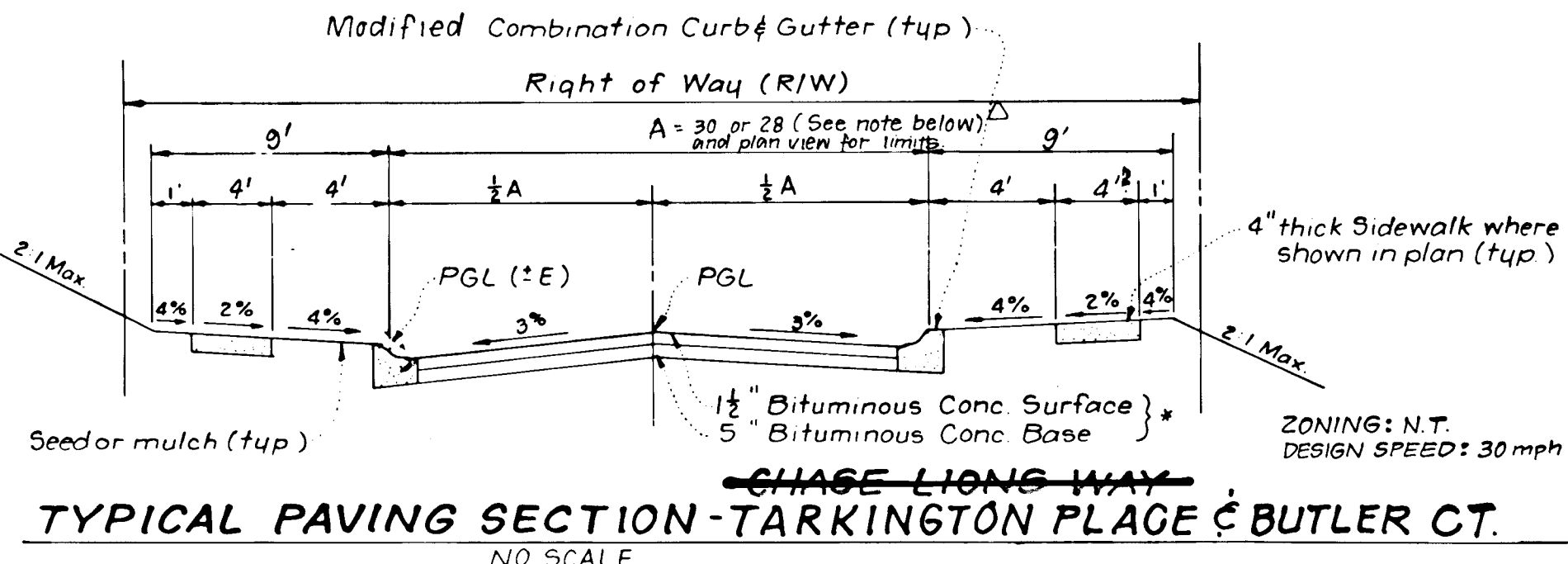
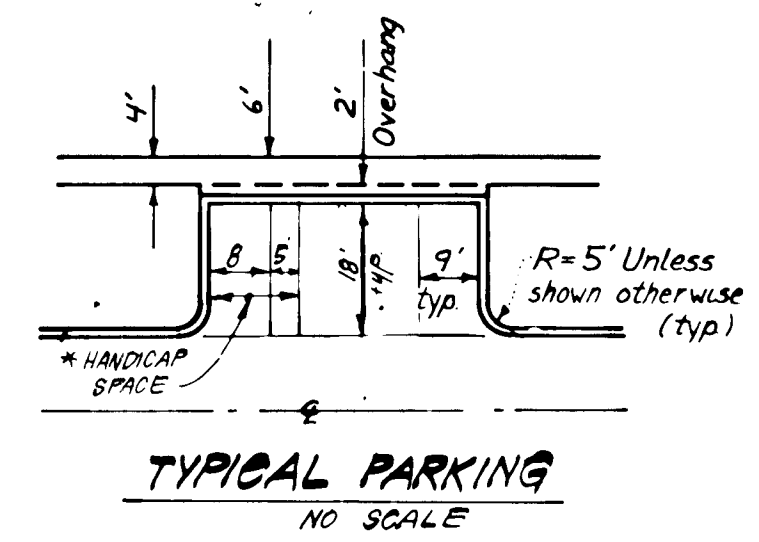
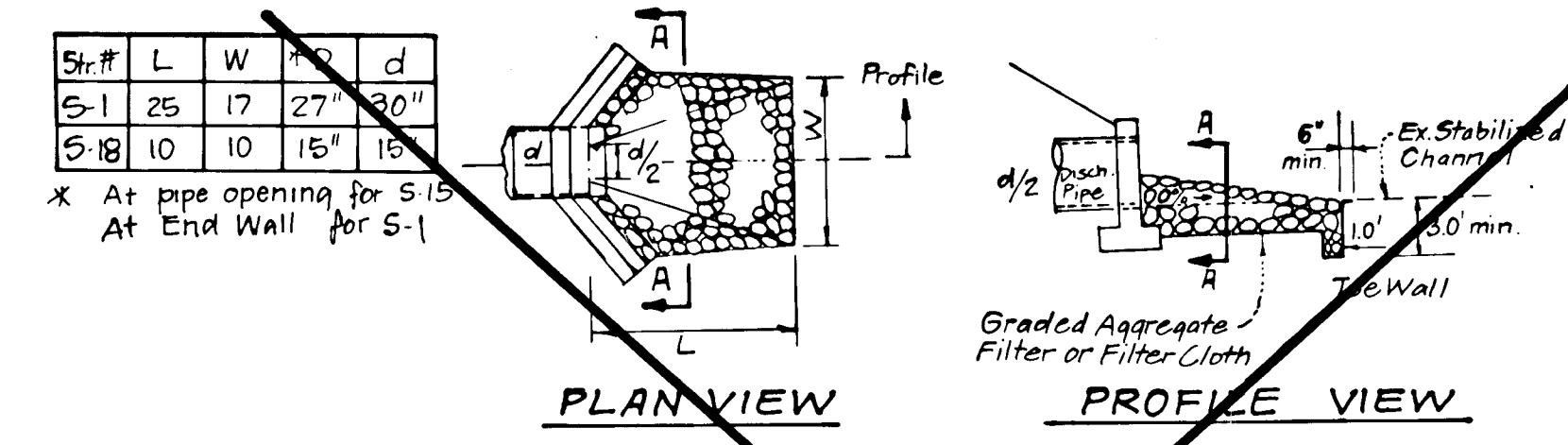
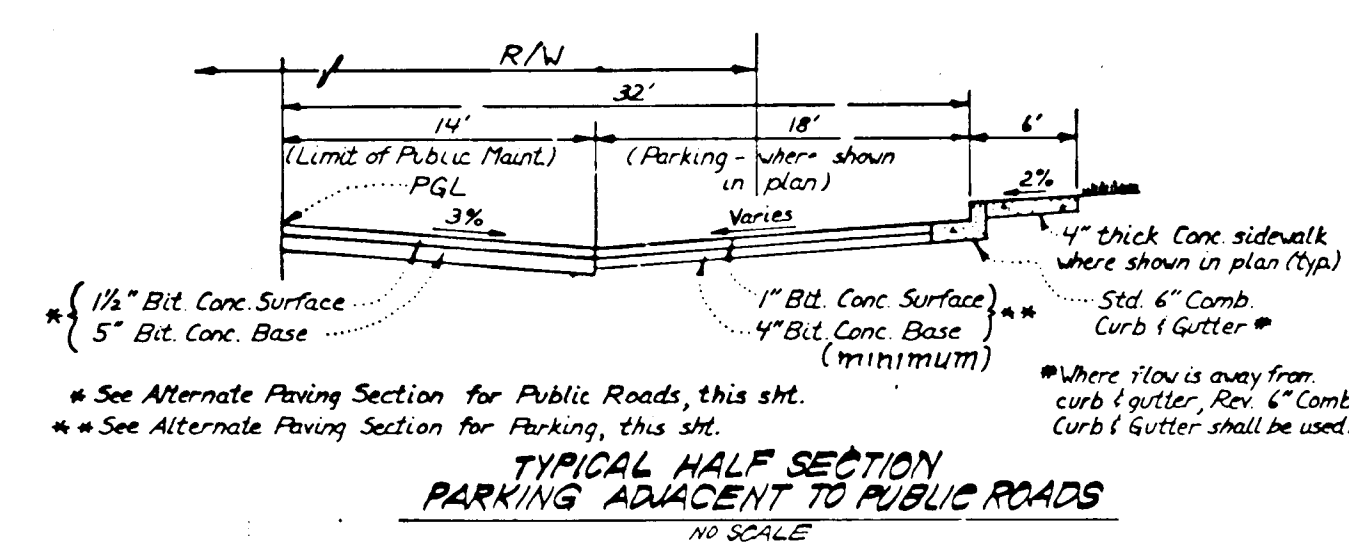

**PIPE SCHEDULE**

SIZE	TYPE	LENGTH
15"	RCP CL IV	208'
15"	RCP CL IV w/ Rubber Gasket Joints	61'
21"	RCP CL IV w/ Rubber Gasket Joints	170'
24"	RCP CL IV	174'
24"	RCP CL IV w/ Rubber Gasket Joints	238'
36"	RCP CL IV w/ Rubber Gasket Joints	95'
15"	RCP (ASTM A131) w/ Rubber Gasket Joints	42'

**STRUCTURE SCHEDULE**

Nº	TYPE	INV. IN	INV. OUT	TOP ELEVATION		REMARKS	LOCATION
				UPPER	LOWER		
S-1	Type "A" Headwall	320.00	320.00	324.00	324.00	Ho. Co. Std. Detail S.D.5.11	See Plan
SWM-2	Special Structure	-	321.00	327.33	(top slab)	See SHT #5 for SWM Details	See Plan
S-3	Concrete End Section 24" dia	324.11	324.00	-	-	Ho. Co. Std. Detail S.D.5.51	See Plan
I-4	A-5 Inlet Depressed	328.47	328.27	336.50	336.50	" " " " S.D.4.01	See Plan
I-5	A-5 Inlet w/Defl.	328.96	328.86	339.44	339.13	" " " " S.D.4.01	See Plan
M-6	Block Manhole	333.00	332.50	337.40	337.40	" " " " S.D.4.01	See Plan
I-7	A-10 Inlet	335.00	334.50	339.10	339.10	" " " " S.D.4.02	See Plan
S-11	Concrete End Section 24"	324.06	324.00	-	-	" " " " S.D.5.51	See Plan
I-12	A-5 Inlet Depressed	325.10	324.84	329.00	329.00	" " " " S.D.4.01	See Plan
I-13	A-10 Inlet	327.10	326.02	331.10	331.10	" " " " S.D.4.02	See Plan
I-14	A-10 Inlet	336.00	335.75	340.50	339.86	" " " " S.D.4.02	See Plan
I-15	A-10 Inlet w/Defl.	-	336.30	340.88	340.23	" " " " S.D.4.02	See Plan
S-16	Concrete End Section 24"	344.13	344.00	-	-	" " " " S.D.5.51	See Plan
SWM-17	Special Structure	-	345.00	350.33	350.33	See SHT #6 for SWM Details	See Plan
S-18	Type "C" Endwall 18"	350.00	350.00	352.00	352.00	" " " " S.D.5.21	See Plan
I-19	A-10 Inlet	351.44	351.11	355.95	355.65	" " " " S.D.4.02	See Plan
I-20	A-10 Inlet	352.25	351.85	356.85	356.65	" " " " S.D.4.02	See Plan
I-21	A-10 Inlet	-	356.75	360.33	360.33	" " " " S.D.4.11 w/ 15"	See Plan
I-22	A-10 Inlet	339.40	339.85	344.43	343.91	" " " " S.D.4.02	See Plan
I-23	A-10 Inlet	340.25	340.00	344.00	344.00	" " " " S.D.4.02	See Plan
I-24	A-10 Inlet Depressed	331.50	331.50	335.33	335.33	" " " " S.D.4.02	See Plan

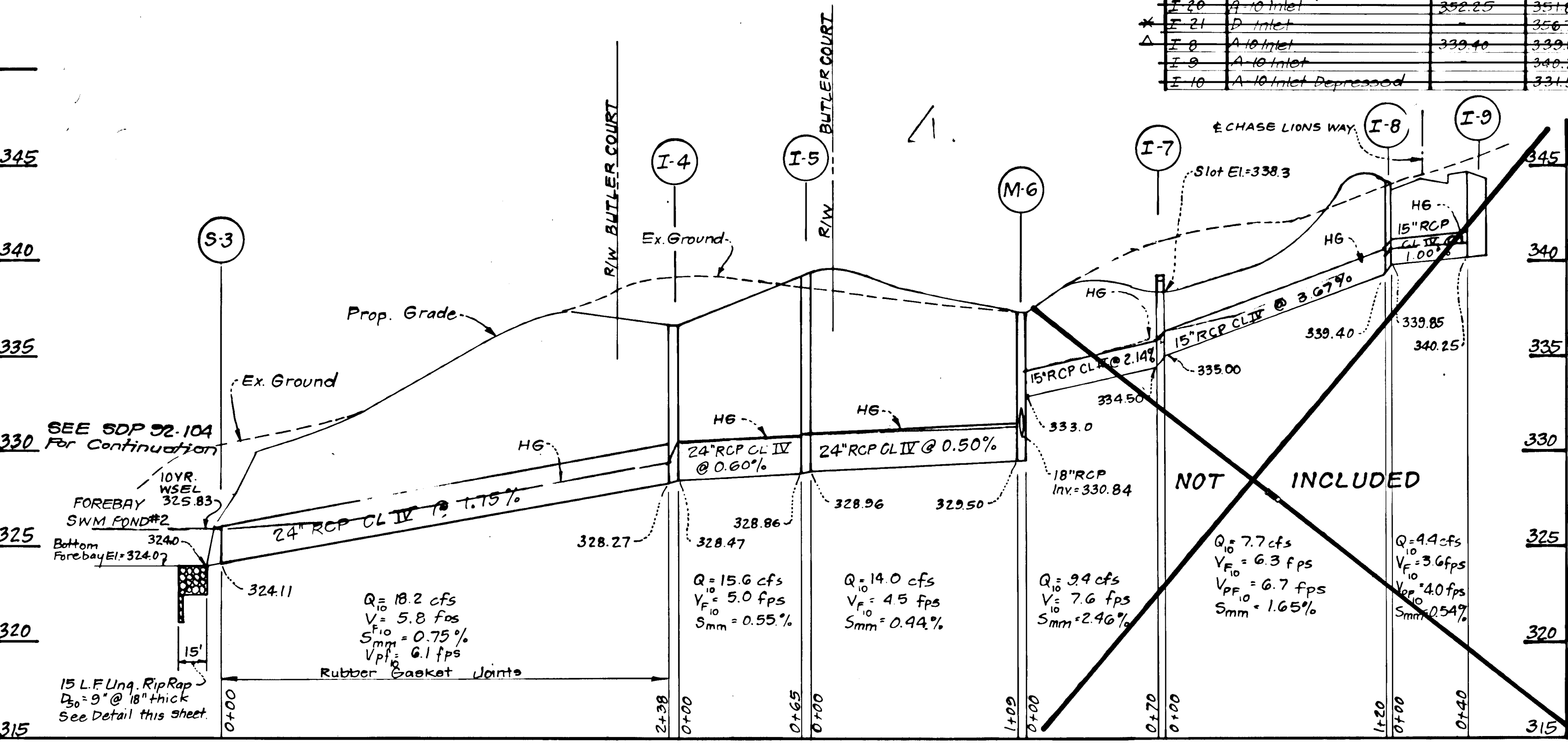
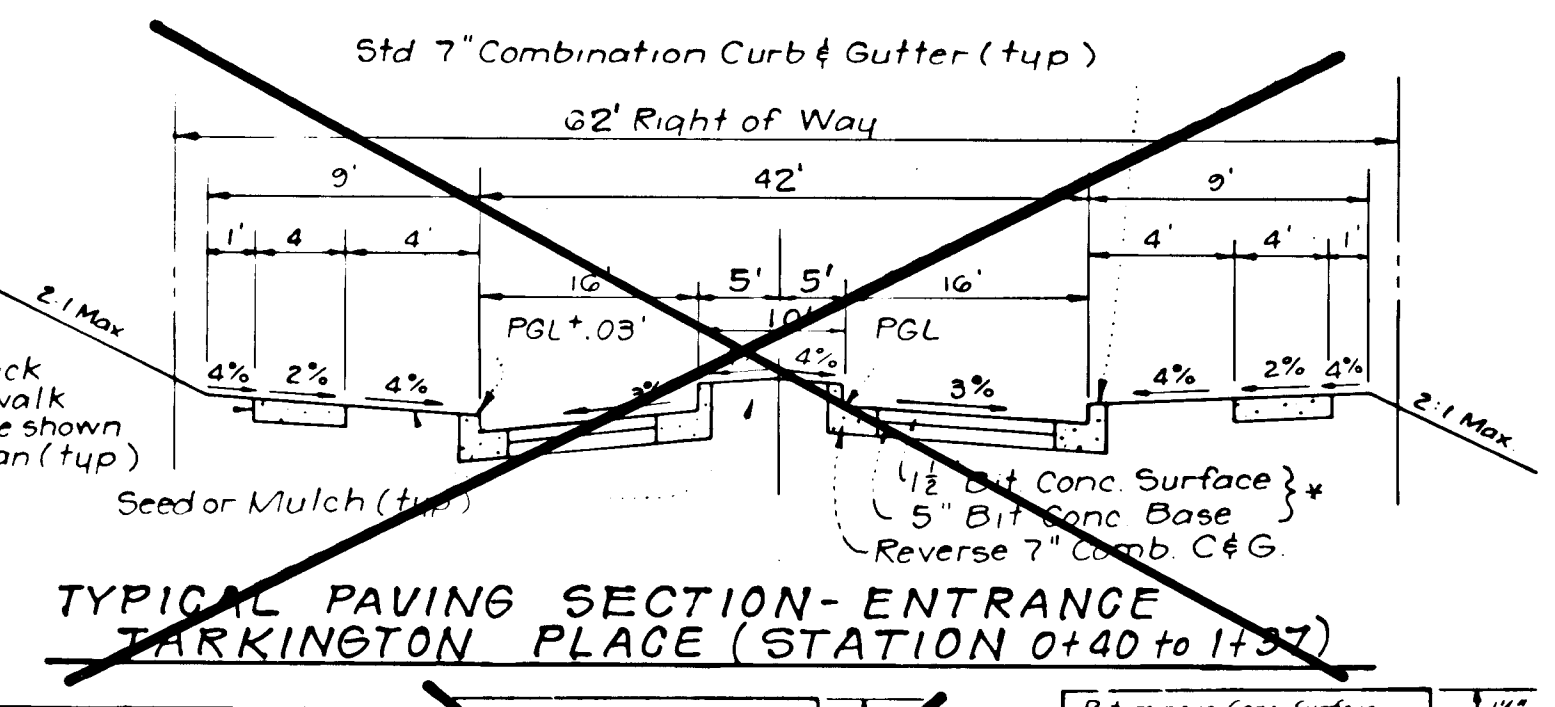
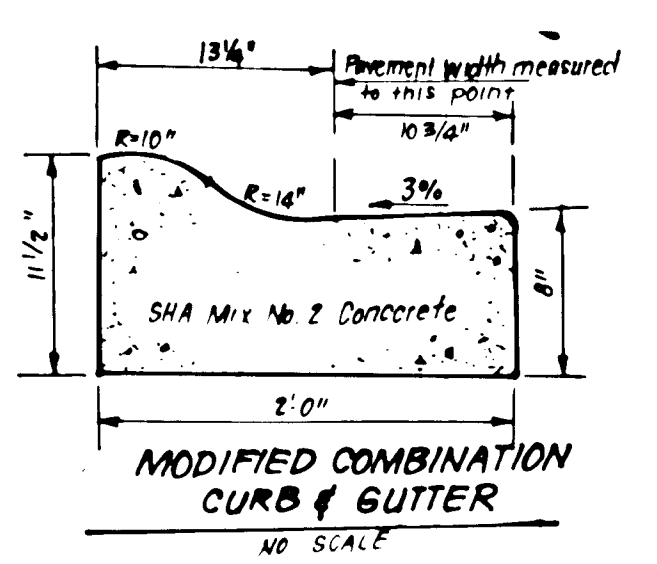
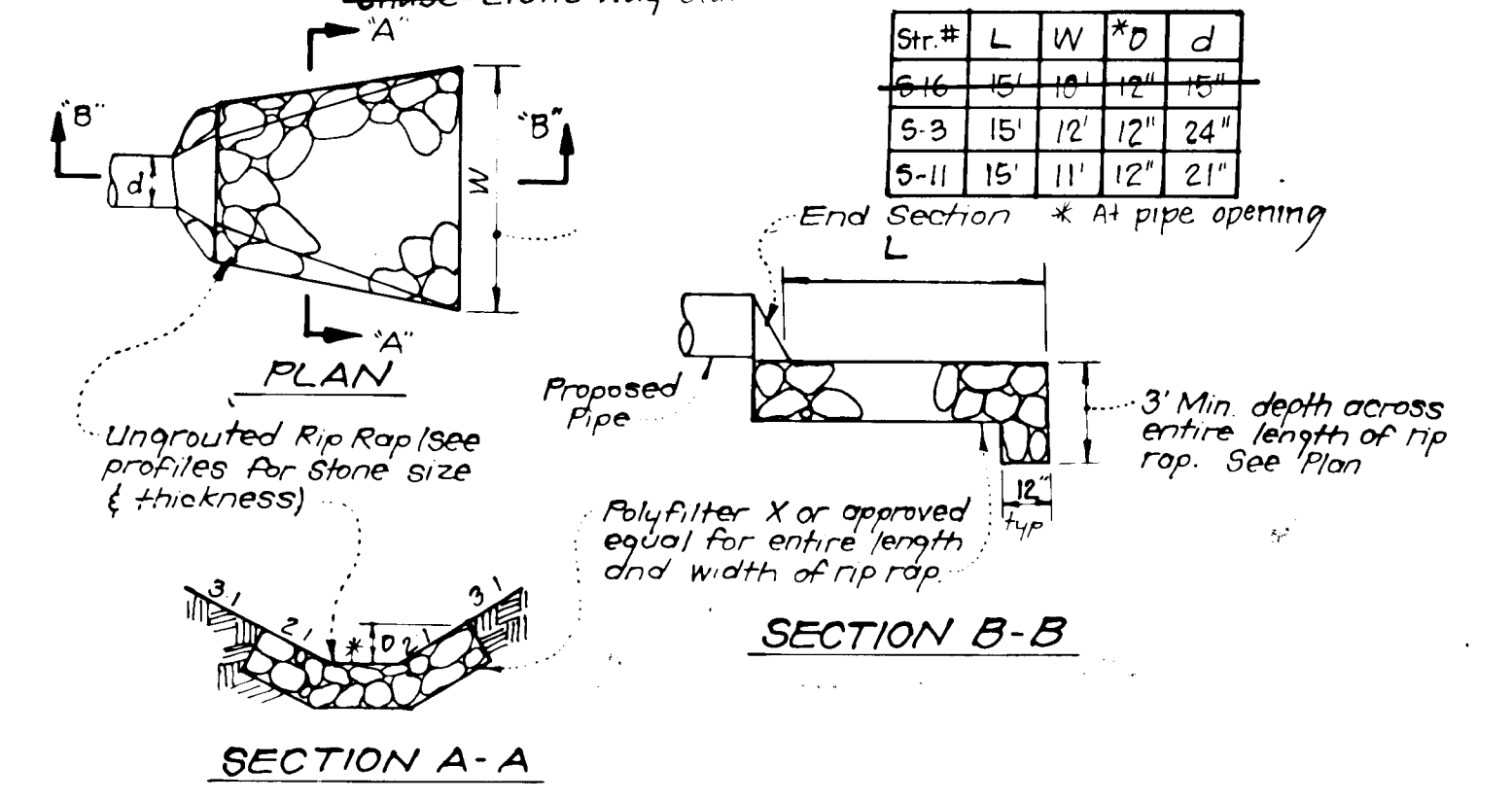
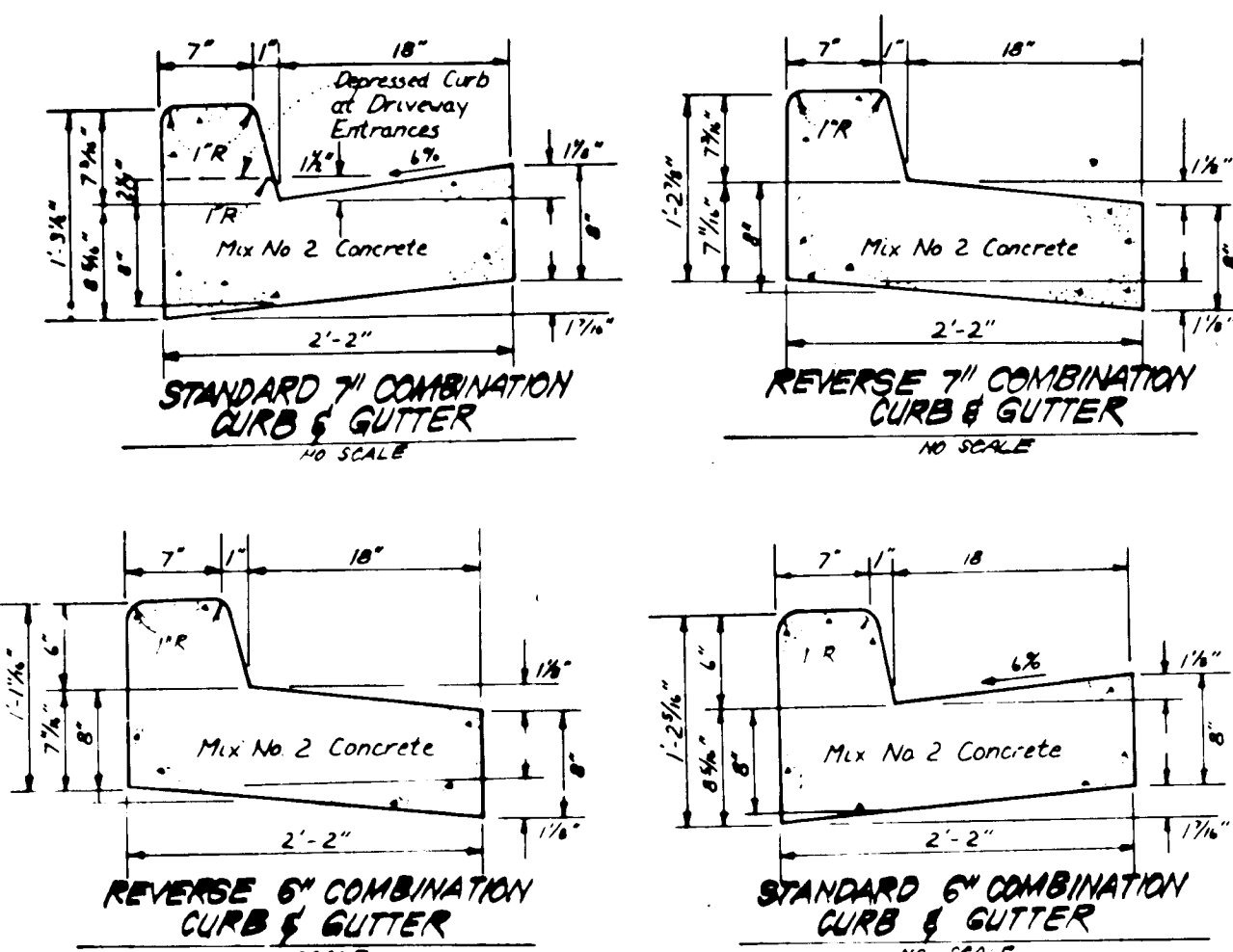

See Ho. Co. Std. Detail S.D. 4.83 for Inlet Deflectors  
X Flies small side  
O All inverts to be fully developed

Reviewed for HOWARD S.C.D.  
Name: *Howard S.C.D.*  
Date: 9/1/93  
U.S. Soil Conservation Service  
THIS DEVELOPMENT PLAN IS APPROVED FOR SOIL EROSION AND SEDIMENT CONTROL BY THE HOWARD SOIL CONSERVATION DISTRICT.  
James M. Hylton 9/1/93  
Approved



ENGINEERS CERTIFICATE  
I hereby certify that this plan for Erosion and Sediment Control represents a practical and workable plan based on my personal knowledge of the site conditions and that it was prepared in accordance with the requirements of the Howard Soil Conservation District.

*Nelson Clark*  
Date: 1-21-93

**ALTERNATE PAVING SECTION FOR PARKING AREAS (SECTION P-1)**

Bituminous Conc. Surface	1/2"	Bituminous Conc. Surface	1/2"	Bituminous Conc. Surface	1/2"
Bituminous Conc. Base	2"	Bituminous Conc. Base	2"	Bituminous Conc. Base	2"
Prime		Prime		Prime	
5" Crusher Run Base Course	5"	6" Crusher Run Base Course (Placed in 2 Courses)	6"	6" Crusher Run Base Course (Placed in 2 Courses)	6"
4" Dense Graded Stabilized Aggregate Base Course	4"	6" Dense Graded Stabilized Aggregate Base Course	6"	6" Dense Graded Stabilized Aggregate Base Course	6"

**ALTERNATE PAVING SECTION FOR MAJOR & MINOR COLLECTORS (SECTION P-3)**

**ALTERNATE PAVING SECTION FOR PUBLIC ROADS (SECTION P-2)**

2 Delete Pond #2, Revised sheet numbers  
1. Revise Storm Drain Profiles Str # M-6 thru # I-8, (vised structure schedule)

No.	REVISION	DATE
1	Revise Storm Drain Profiles Str # M-6 thru # I-8, (vised structure schedule)	11/20/91

APPROVED: HOWARD COUNTY DEPARTMENT OF PUBLIC WORKS  
*John D. ...*  
CHIEF, BUREAU OF HIGHWAYS  
DATE: 4/15/92

APPROVED: HOWARD COUNTY DEPARTMENT OF PLANNING & ZONING  
*R. Blood*  
CHIEF, DIVISION OF COMMUNITY PLANNING & LAND DEVELOPMENT  
DATE: 4/20/93

**CLARK • FINEROCK & SACKETT, INC.**  
ENGINEERS • PLANNERS • SURVEYORS  
1101 MINISTERS WAY • COLUMBIA, MD. 21046 • (410) 981-7500 • BALTO. • (410) 621-8800 • WASH.

DESIGNED	ROAD CONSTRUCTION PLANS	SCALE
D.G.T.	STORM DRAIN PROFILES & DETAILS	As Shown
DRAWN	<b>COLUMBIA</b>	DRAWING
V.L.M.	VILLAGE OF DORSEY'S SEARCH	3 OF 4
CHECKED	SECTION 3, AREA 1	JOB NO.
D.G.T.	5TH ELECTION DISTRICT	90-120
DATE	FOR: HOWARD RESEARCH & DEVELOPMENT CORPORATION	FILE NO.
8-10-90	18215 Little Patuxent Parkway	90-120-D
	Columbia, Maryland 21044	



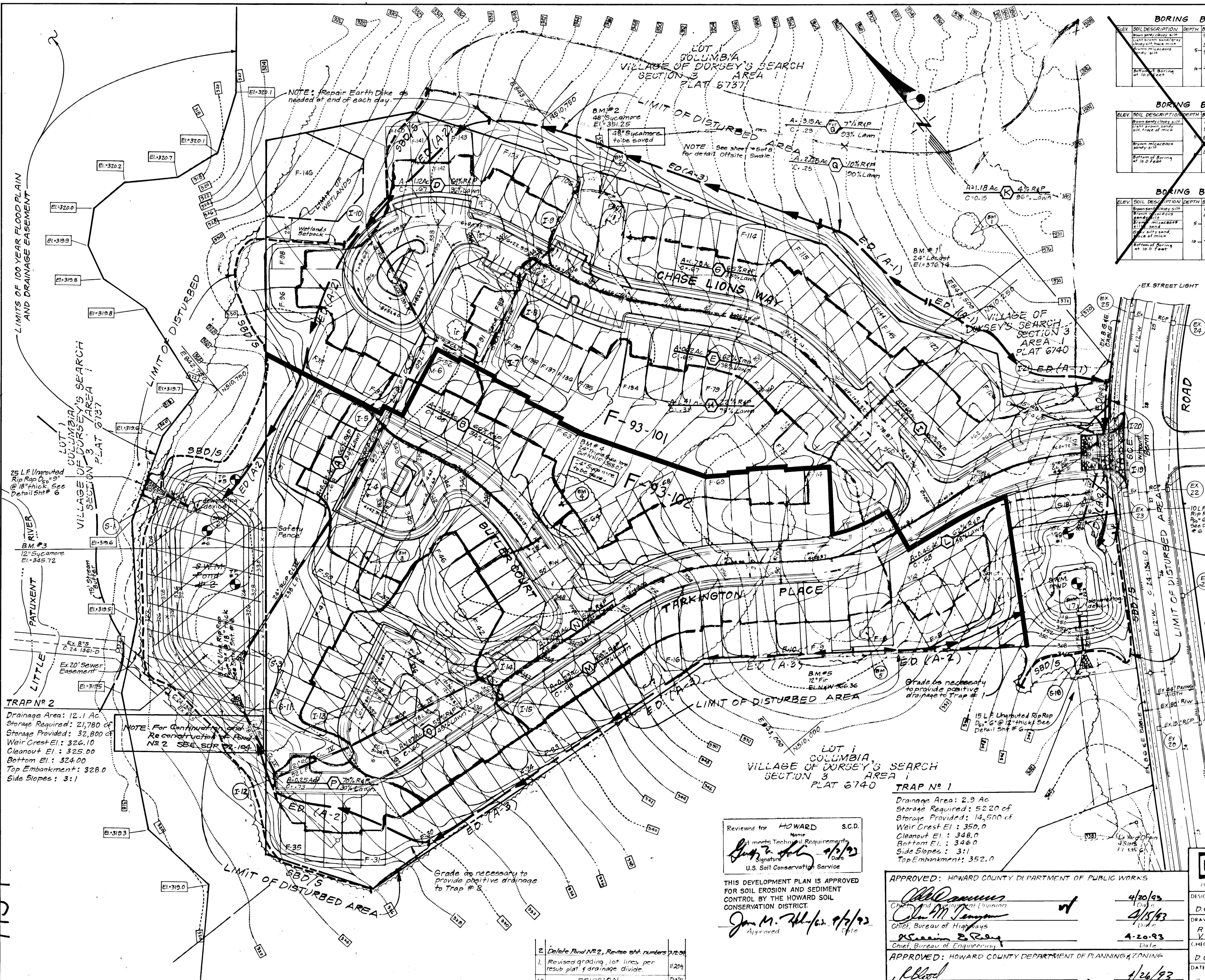

BORING B-1							BORING B-6						
ELEV	SOIL DESCRIPTION	DEPTH	BLOWS	NO	TYPE	REMARKS	ELEV	SOIL DESCRIPTION	DEPTH	BLOWS	NO	TYPE	REMARKS
5-4	Dark brown silty clay	3-4	1	1	DS	5' Topsoil	22-2	Dark brown silty clay	3-4	1	1	DS	
5-9	Brown micaceous silty sand	4-12	3	3	DS		5-7	Brown micaceous silty sand	4-12	3	3	DS	
5-18	Brown micaceous silty sand	12-15	3	3	DS		5-9	Brown micaceous silty sand	12-15	3	3	DS	
5-24	Brown micaceous silty sand	18-21	4	4	DS		5-15	Brown micaceous silty sand	18-21	4	4	DS	
5-30	Brown micaceous silty sand	24-27	4	4	DS		5-21	Brown micaceous silty sand	24-27	4	4	DS	
5-36	Brown micaceous silty sand	30-33	4	4	DS		5-27	Brown micaceous silty sand	30-33	4	4	DS	
5-42	Brown micaceous silty sand	36-39	4	4	DS		5-33	Brown micaceous silty sand	36-39	4	4	DS	
5-48	Brown micaceous silty sand	42-45	4	4	DS		5-39	Brown micaceous silty sand	42-45	4	4	DS	
5-54	Brown micaceous silty sand	48-51	4	4	DS		5-45	Brown micaceous silty sand	48-51	4	4	DS	
5-60	Brown micaceous silty sand	54-57	4	4	DS		5-51	Brown micaceous silty sand	54-57	4	4	DS	
5-66	Brown micaceous silty sand	60-63	4	4	DS		5-57	Brown micaceous silty sand	60-63	4	4	DS	
5-72	Brown micaceous silty sand	66-69	4	4	DS		5-63	Brown micaceous silty sand	66-69	4	4	DS	
5-78	Brown micaceous silty sand	72-75	4	4	DS		5-69	Brown micaceous silty sand	72-75	4	4	DS	
5-84	Brown micaceous silty sand	78-81	4	4	DS		5-75	Brown micaceous silty sand	78-81	4	4	DS	
5-90	Brown micaceous silty sand	84-87	4	4	DS		5-81	Brown micaceous silty sand	84-87	4	4	DS	
5-96	Brown micaceous silty sand	90-93	4	4	DS		5-87	Brown micaceous silty sand	90-93	4	4	DS	
5-102	Brown micaceous silty sand	96-99	4	4	DS		5-93	Brown micaceous silty sand	96-99	4	4	DS	
5-108	Brown micaceous silty sand	102-105	4	4	DS		5-99	Brown micaceous silty sand	102-105	4	4	DS	
5-114	Brown micaceous silty sand	108-111	4	4	DS		5-105	Brown micaceous silty sand	108-111	4	4	DS	
5-120	Brown micaceous silty sand	114-117	4	4	DS		5-111	Brown micaceous silty sand	114-117	4	4	DS	
5-126	Brown micaceous silty sand	120-123	4	4	DS		5-117	Brown micaceous silty sand	120-123	4	4	DS	
5-132	Brown micaceous silty sand	126-129	4	4	DS		5-123	Brown micaceous silty sand	126-129	4	4	DS	
5-138	Brown micaceous silty sand	132-135	4	4	DS		5-129	Brown micaceous silty sand	132-135	4	4	DS	
5-144	Brown micaceous silty sand	138-141	4	4	DS		5-135	Brown micaceous silty sand	138-141	4	4	DS	
5-150	Brown micaceous silty sand	144-147	4	4	DS		5-141	Brown micaceous silty sand	144-147	4	4	DS	
5-156	Brown micaceous silty sand	150-153	4	4	DS		5-147	Brown micaceous silty sand	150-153	4	4	DS	
5-162	Brown micaceous silty sand	156-159	4	4	DS		5-153	Brown micaceous silty sand	156-159	4	4	DS	
5-168	Brown micaceous silty sand	162-165	4	4	DS		5-159	Brown micaceous silty sand	162-165	4	4	DS	
5-174	Brown micaceous silty sand	168-171	4	4	DS		5-165	Brown micaceous silty sand	168-171	4	4	DS	
5-180	Brown micaceous silty sand	174-177	4	4	DS		5-171	Brown micaceous silty sand	174-177	4	4	DS	
5-186	Brown micaceous silty sand	180-183	4	4	DS		5-177	Brown micaceous silty sand	180-183	4	4	DS	
5-192	Brown micaceous silty sand	186-189	4	4	DS		5-183	Brown micaceous silty sand	186-189	4	4	DS	
5-198	Brown micaceous silty sand	192-195	4	4	DS		5-189	Brown micaceous silty sand	192-195	4	4	DS	
5-204	Brown micaceous silty sand	198-201	4	4	DS		5-195	Brown micaceous silty sand	198-201	4	4	DS	
5-210	Brown micaceous silty sand	204-207	4	4	DS		5-201	Brown micaceous silty sand	204-207	4	4	DS	
5-216	Brown micaceous silty sand	210-213	4	4	DS		5-207	Brown micaceous silty sand	210-213	4	4	DS	
5-222	Brown micaceous silty sand	216-219	4	4	DS		5-213	Brown micaceous silty sand	216-219	4	4	DS	
5-228	Brown micaceous silty sand	222-225	4	4	DS		5-219	Brown micaceous silty sand	222-225	4	4	DS	
5-234	Brown micaceous silty sand	228-231	4	4	DS		5-225	Brown micaceous silty sand	228-231	4	4	DS	
5-240	Brown micaceous silty sand	234-237	4	4	DS		5-231	Brown micaceous silty sand	234-237	4	4	DS	
5-246	Brown micaceous silty sand	240-243	4	4	DS		5-237	Brown micaceous silty sand	240-243	4	4	DS	
5-252	Brown micaceous silty sand	246-249	4	4	DS		5-243	Brown micaceous silty sand	246-249	4	4	DS	
5-258	Brown micaceous silty sand	252-255	4	4	DS		5-249	Brown micaceous silty sand	252-255	4	4	DS	
5-264	Brown micaceous silty sand	258-261	4	4	DS		5-255	Brown micaceous silty sand	258-261	4	4	DS	
5-270	Brown micaceous silty sand	264-267	4	4	DS		5-261	Brown micaceous silty sand	264-267	4	4	DS	
5-276	Brown micaceous silty sand	270-273	4	4	DS		5-267	Brown micaceous silty sand	270-273	4	4	DS	
5-282	Brown micaceous silty sand	276-279	4	4	DS		5-273	Brown micaceous silty sand	276-279	4	4	DS	
5-288	Brown micaceous silty sand	282-285	4	4	DS		5-279	Brown micaceous silty sand	282-285	4	4	DS	
5-294	Brown micaceous silty sand	288-291	4	4	DS		5-285	Brown micaceous silty sand	288-291	4	4	DS	
5-300	Brown micaceous silty sand	294-297	4	4	DS		5-291	Brown micaceous silty sand	294-297	4	4	DS	
5-306	Brown micaceous silty sand	300-303	4	4	DS		5-297	Brown micaceous silty sand	300-303	4	4	DS	
5-312	Brown micaceous silty sand	306-309	4	4	DS		5-303	Brown micaceous silty sand	306-309	4	4	DS	
5-318	Brown micaceous silty sand	312-315	4	4	DS		5-309	Brown micaceous silty sand	312-315	4	4	DS	
5-324	Brown micaceous silty sand	318-321	4	4	DS		5-315	Brown micaceous silty sand	318-321	4	4	DS	