

WETLAND PLANT ESTABLISHMENT

- Plant species required are normally unavailable from standard landscape nursery sources. The Contractor must make arrangements with competent wetlands restoration specialists to insure a supply of the required material.
- The Contractor and/or his subcontractor should be aware of the site design conditions and should take all prudent steps to insure that the plant material specified on the plans is acclimated to wetland conditions prior to delivery to the job site. If the plant material is available from sources where wetland conditions are duplicated at the nursery, the contractor should favor these sources as the supplier.
- Fertilizer for wetland trees and shrubs shall be a 21 gr. tightly compressed, long lasting slow release (2 year) planting tablet with a minimum guaranteed analysis of 20-10-5.
- Fertilizer for container grown material shall apply the following rates:
 1 gal. Container 1 ea. 21 gr. Tablets
 3 gal. Container 2 ea. 21 gr. Tablets
 5 gal. Container 3 ea. 21 gr. Tablets
 7 gal. Container 5 ea. 21 gr. Tablets
- B&B or Container Stock shall be positioned in the planting hole. Backfill halfway up the root ball. Place tablet (s) beside the root ball approximately 1 inch from the root tips. Do not place tablets in the bottom of the hole. Complete backfill, tamp and water.

PLANTING SCHEDULE

It is recommended that planting be done early in the Spring.

PLANTING MATERIAL

- Rootstock of wetland plant material shall be kept moist during the transport from the source to the job site and until planted.
- Plant material shall be planted in the soil provided with each planting pit excavated to a size sufficient to contain the entire root stock or root mass without cramping.

PEST CONTROL

- All planted oak trees shall be protected from gypsy moth damage by using gypsy moth repellent tape or other suitable means after planting.

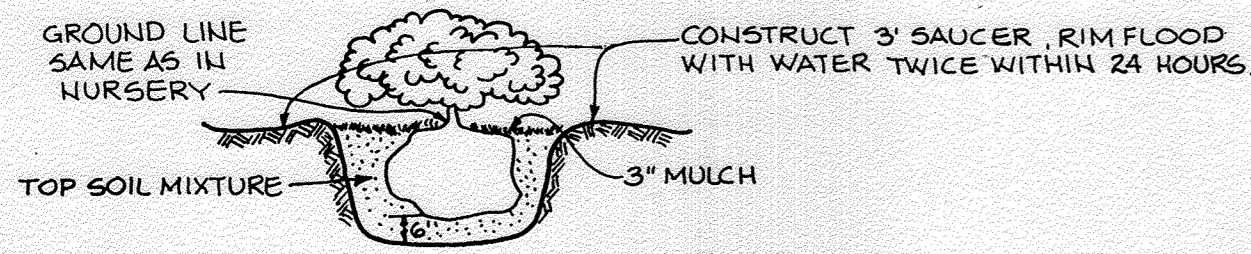

SHRUB PLANTING DETAIL
 NO SCALE

LEGEND

- PROPOSED EVERGREEN TREES
- PROPOSED DECIDUOUS TREES
- GVD PROPOSED SHRUBS QUANTITY & SPECIES
- APPROXIMATE POND SURFACE ELEVATION
- LIMIT OF PLANTING AREA (0.45) ACRES
- LIMIT OF EMERGENT PLANTING AREA
- EMERGENT SPECIES DIVISION LINE

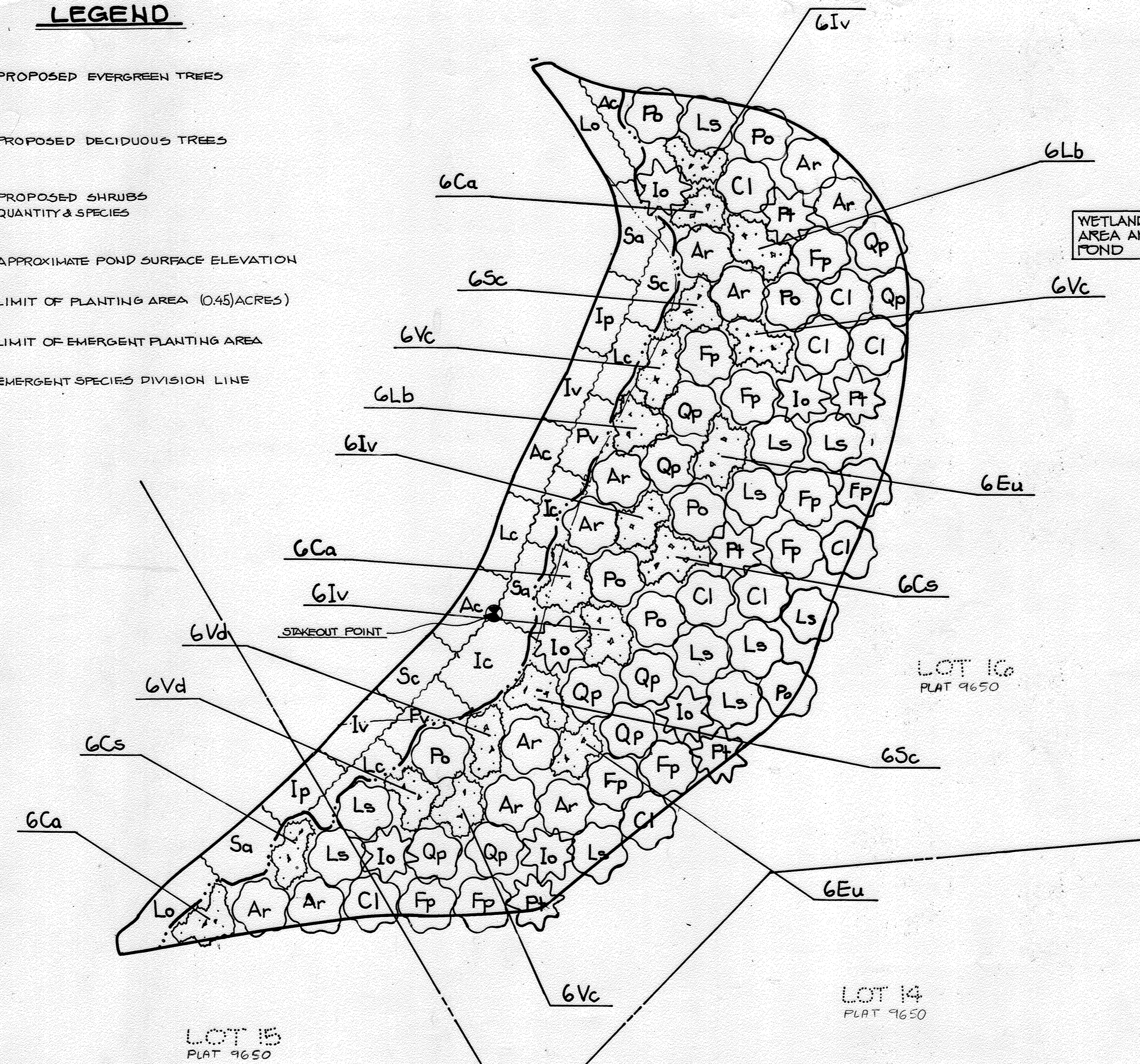

PLANTING PLAN

SCALE 1"=20'

Revision Note: On or about August 10, 2002, Capital Project entitled "DHW 1500th Street Coast Pond Repair Project" was awarded. Project replaced existing 24-inch B&B pipe and 24-inch storm pipe with new concrete rise structure with a 42-inch principal storm pipe, impervious pipe, 42-inch principal storm pipe, impervious pipe, clay core, and filter storm drain pipe, a 24-inch RCP storm drain pipe, headwall, endwall, and stone access road were installed in addition to a rip-rap lined plunge pool at the pond outfall.

PLANT LIST
 EMERGENTS

QTY.	SYMBOL	NAME	SIZE	REMARKS
100	Lo	LEERSIA ORYZOIDES Rice Cutgrass	Field Clump	Cont. 2' O.C.
80	Ic	IMPATIENS CAPENSIS Jewelweed	1 qt.	Cont. 2' O.C.
120	Sa	SCIRPUS AMERICANUS American Threesquare	1 qt.	Cont. 2' O.C.
120	Ac	ACORUS CALAMUS Sweet Flag	1 qt.	Cont. 2' O.C.
120	Lc	LOBELIA CARDINALIS Red Cardinal Flower	1 qt.	Cont. 2' O.C.
80	Pv	PANICUM VIRGATUM Switchgrass	1 qt.	Cont. 2' O.C.
80	Ip	IRIS PSEUDACORUS Yellow Water Iris	1 qt.	Cont. 2' O.C.
80	Iv	IRIS VERSICOLOR Blue Flag	1 qt.	Cont. 2' O.C.
80	Sc	SCIRPUS CYPERINUS Woolgrass	Field Clump	Cont. 2' O.C.

PLANT LIST
 SHRUBS

QTY.	SYMBOL	NAME	SIZE	REMARKS
18	Ca	CORNUS AMOMUM Silky Dogwood	36"-48" Ht.	B&B or Cont. 6' O.C.
12	Cs	CORNUS STOLINIFERA Red-Osier Dogwood	36"-48" Ht.	B&B or Cont. 6' O.C.
18	Iv	ILEX VERTICILLATA Winterberry	36"-48" Ht.	B&B or Cont. 6' O.C.
12	Sc	SAMBUCUS CANADENSIS Elderberry	36"-48" Ht.	B&B or Cont. 6' O.C.
12	Eu	ELAEAGNUS UMBELLATA Autumn Olive	36"-48" Ht.	B&B or Cont. 6' O.C.
18	Vc	VACCINIUM CORYMBOSUM Highbush Blueberry	36"-48" Ht.	B&B or Cont. 6' O.C.
12	Vd	VIBURNUM DENTATUM Arrowwood	36"-48" Ht.	B&B or Cont. 6' O.C.
12	Lb	LINDERA BENZOIN Spicebush	36"-48" Ht.	B&B or Cont. 6' O.C.

PLANT LIST
 TREES

QTY.	SYMBOL	NAME	SIZE	REMARKS
11	Ls	LIQUIDAMBAR STYRACIFLUA Sweet Gum	1/2 -2" Cal. 8-10'	B&B Full Head
10	Fp	FRAZINUS PENNSYLVANICA Green Ash	1/2 -2" Cal. 8-10'	B&B Full Head
11	Ar	ACER RUBRUM Red Maple	1/2 -2" Cal. 8-10'	B&B Full Head
10	Qp	QUERCUS PALUSTRIS Pin Oak	1/2 -2" Cal. 8-10'	B&B Full Head
8	Po	PLATANUS OCCIDENTALIS American Sycamore	1/2 -2" Cal. 8-10'	B&B Full Head
9	Cl	CARYA LACINOSA Shellbark Hickory	1/2 -2" Cal. 8-10'	B&B Full Head
6	Io	ILEX OPACA American Holly	1/2 -2" Cal. 6-8'	B&B Full Head
5	Pt	PINUS TAEDA Loblolly Pine	1/2 -2" Cal. 8-10'	B&B Full Shape

OWNER & DEVELOPER
 CARMAN ASSOCIATES
 P.O. BOX 122
 ELLICOTT CITY, MARYLAND 21043

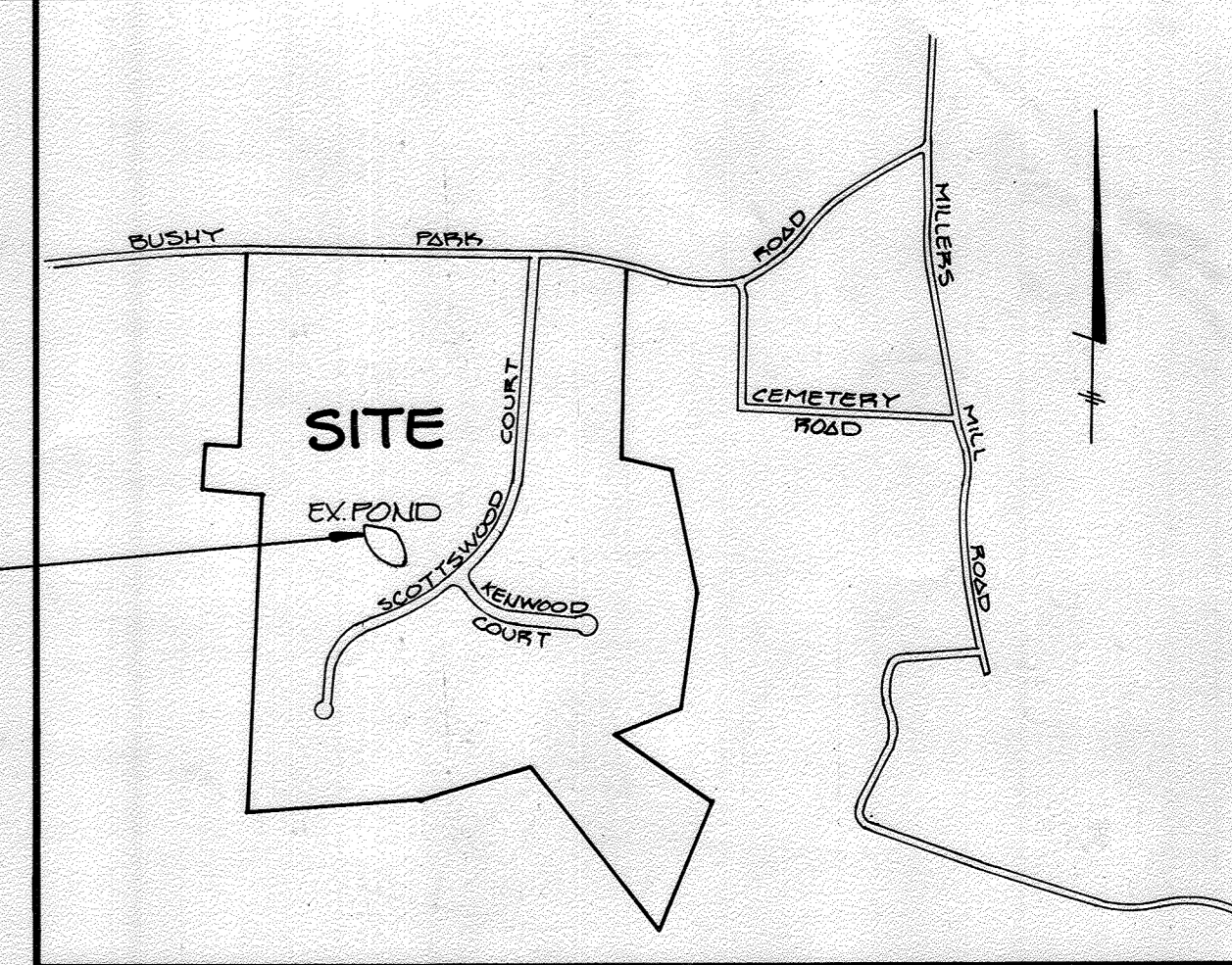

VICINITY MAP
 SCALE 1"=100'

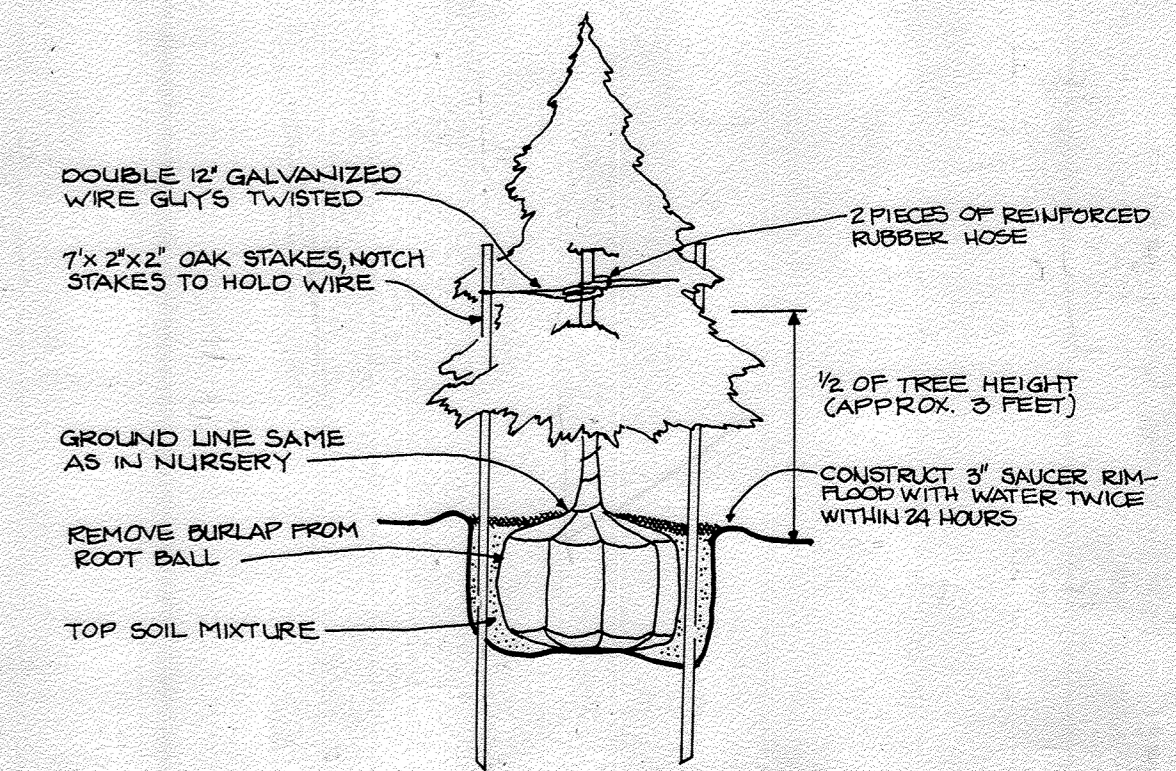

EVERGREEN PLANTING DETAIL
 NO SCALE

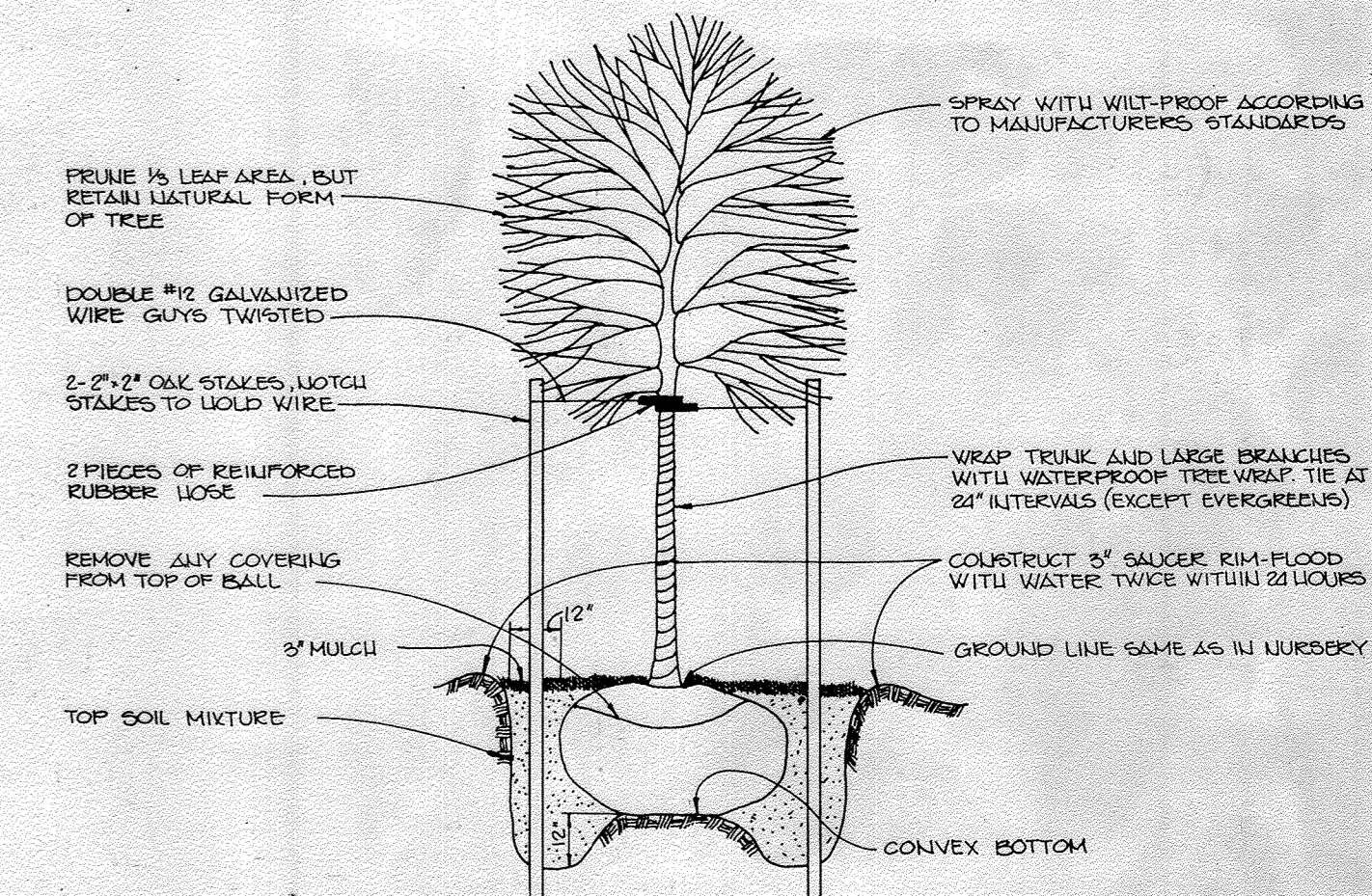

TREE PLANTING DETAIL
 NO SCALE

APPROVED: DEPT. OF PLANNING AND ZONING

 CHIEF, DIVISION COMMUNITY PLANNING AND LAND DEVELOPMENT
 DATE 11/30/92

FISHER, COLLINS & CARTER, INC.
 CIVIL ENGINEERING CONSULTANTS & LAND SURVEYORS
 971 BALTIMORE NATIONAL FIRE, SUITE 100
 ELLICOTT CITY, MARYLAND 21042
 (410) 461-2555



M.A. DIRCKS & CO., INC.
 • WETLANDS DELINEATION
 • PERMIT NEGOTIATION
 • MITIGATION
 • ENVIRONMENTAL ASSESSMENTS
 (301) 750-2058 MARY DIRCKS
 2986 PEBBLE BEACH DRIVE ELLICOTT CITY, MD. 21043 PRESIDENT
 DESIGNED BY R.B. WILDMAN & M.A. DIRCKS

MITIGATION FOND COUNTRY SPRINGS
 4TH ELECTION DISTRICT
 HOWARD COUNTY, MARYLAND
 DATE: NOVEMBER 21, 1991
 SUPPLEMENTAL INFORMATION SHEET 1 OF 2

1561

