

PLAN
SCALE: 1" = 50'

PLANT LIST

SYMBOL	QUANT	NAME	REMARKS
(Symbol: Circle with dot)	12	GLEDISTIA TRIACANTHOS INERMIS Thornless Honey Locust	2 1/4" Min Cal D & D Full Head
(Symbol: Circle with horizontal line)		PLATANUS ACERFOLIA London Planetree	
(Symbol: Circle with vertical line)		ACER RUBRUM Red Maple	
(Symbol: Circle with diagonal line)		EXISTING TREES INSTALLED UNDER PREVIOUS PLANS	

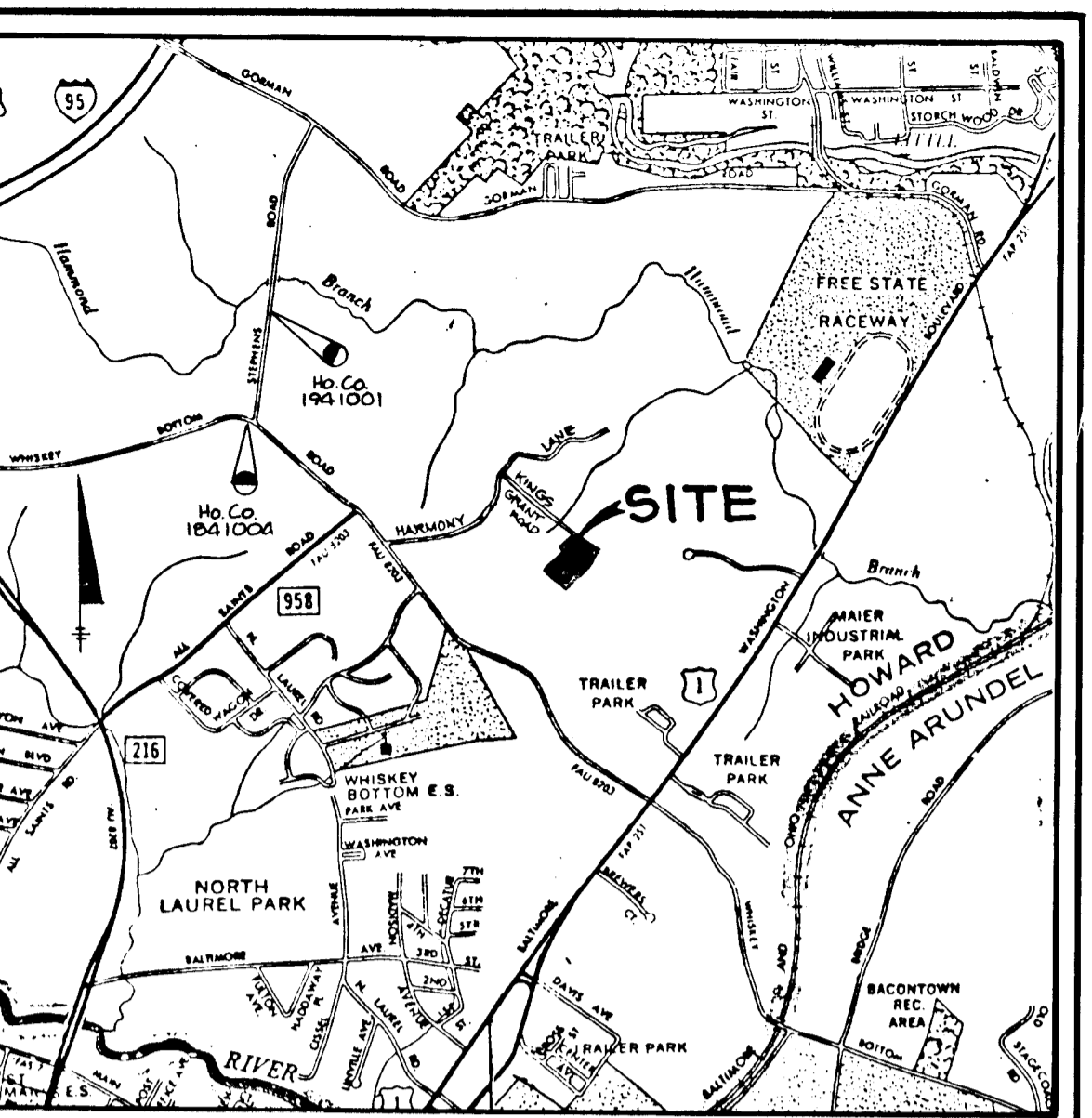

GENERAL NOTES

- ALL WORK SHALL BE PERFORMED IN ACCORDANCE WITH THE HOWARD COUNTY DESIGN MANUAL, VOLUME IV, STANDARD SPECIFICATIONS AND DETAILS FOR ROAD CONSTRUCTION.
- APPROXIMATE LOCATION OF EXISTING UTILITIES ARE SHOWN. THE CONTRACTOR SHALL TAKE ALL NECESSARY PRECAUTIONS TO PROTECT THE EXISTING UTILITIES AND MAINTAIN UNINTERRUPTED SERVICE. ANY DAMAGE INCURRED DUE TO CONTRACTOR'S OPERATIONS SHALL BE REPAIRED IMMEDIATELY AT THE CONTRACTOR'S EXPENSE.
- THE CONTRACTOR SHALL TEST PIT EXISTING UTILITIES, WHERE DIRECTED BY THE ENGINEER, A MINIMUM OF TWO WEEKS IN ADVANCE OF CONSTRUCTION OPERATIONS.
- CONTRACTOR TO NOTIFY THE FOLLOWING UTILITIES AT LEAST THREE DAYS BEFORE STARTING WORK SHOWN ON THESE DRAWINGS:

BELL TELEPHONE SYSTEM	393-3469
LONG DISTANCE CABLE DIVISION	393-3553 OR 3554
BALTIMORE GAS AND ELECTRIC	534-8000 EXT. 691
HOWARD COUNTY BUREAU OF UTILITIES	992-2366
HOWARD COUNTY CONSTRUCTION INSPECTION SURVEY DIVISION	992-2417/2418
- ALL STREET CURB RETURNS SHALL HAVE 25.0' RADII UNLESS OTHERWISE NOTED.
- INSTALLATION OF TRAFFIC CONTROL DEVICES, MARKING AND SIGNING SHALL BE IN ACCORDANCE WITH THE MANUAL OF UNIFORM TRAFFIC CONTROL DEVICES 1994 EDITION.
- DESIGNED TRAFFIC SPEED IN ACCORDANCE WITH THE AMERICAN ASSOCIATION OF STATE HIGHWAY OFFICIAL STANDARDS:
 - ALL LOCAL STREETS DESIGNED FOR 30 M.P.H.
- ALL ELEVATIONS SHOWN ARE BASED ON U.S.C. AND G.S. MEAN SEA LEVEL DATUM 1929.
- ALL FILL AREAS WITHIN ROADWAYS AND UNDER STRUCTURES TO BE COMPACTED TO A MINIMUM 95% OF MAXIMUM OBTAINABLE DENSITY DETERMINED BY MARSHALL PROCTOR.
- PROFILE STATIONS SHALL BE ADJUSTED AS NECESSARY TO CONFORM TO PLAN DIMENSIONS.
- SUBJECT PROPERTY ZONED R-SC PER B-2-85 COMPREHENSIVE ZONING PLAN.
- TOP TAKEN FROM HOWARD COUNTY AERIAL TOPO SUPPLEMENTED BY FIELD RUN TOPO.
- STORM WATER MANAGEMENT FOR THIS SITE IS PROVIDED UNDER KINGS WOODS SECTION 1, AREA 1 F-87-207.

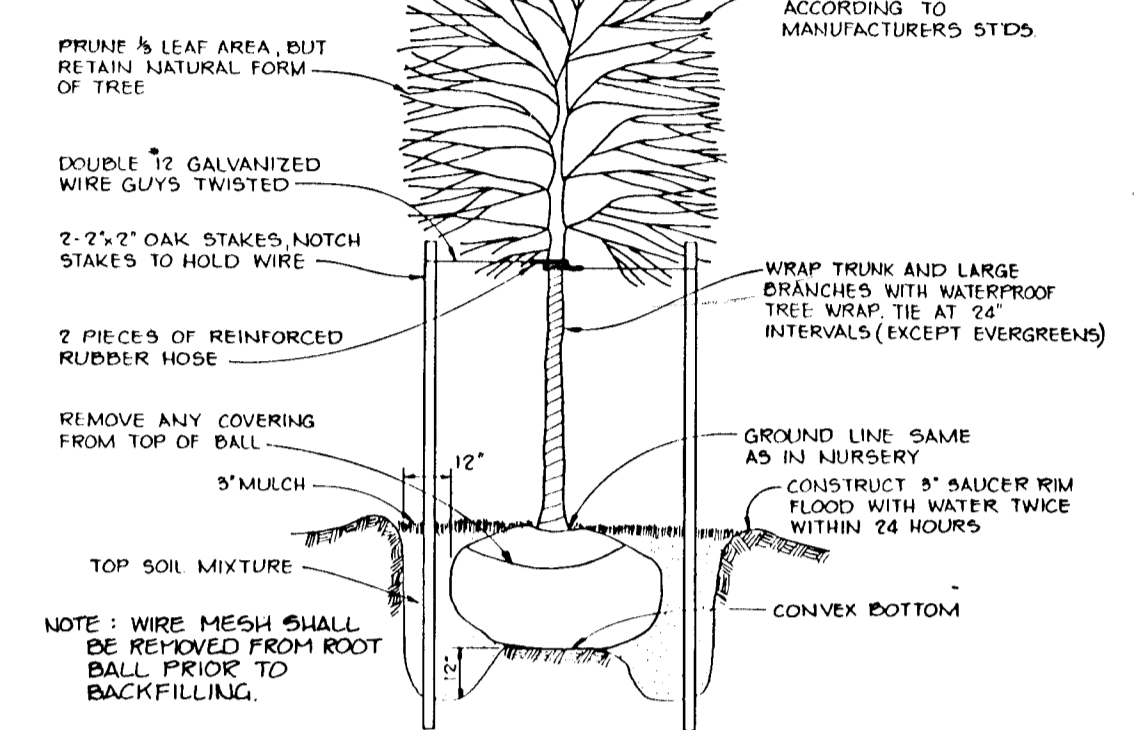

BENCH MARKS

- | | |
|--|--------------|
| Ho Co 1841004 | ELEV 295.92 |
| N 471079 018 | E 842657.878 |
| REBAR 6" SOUTH OF SOUTH EDGE OF WHISKEY BOTTOM ROAD NEAR THE INTERSECTION OF STEPHENS ROAD | |
| Ho Co 1941001 | ELEV 277.87 |
| N 472223.199 | E 843797.549 |
| REBAR 4" WEST OF WEST EDGE OF STEPHENS ROAD 3" BELOW SURFACE IN FRONT OF HOUSE NUMBER 8820 | |

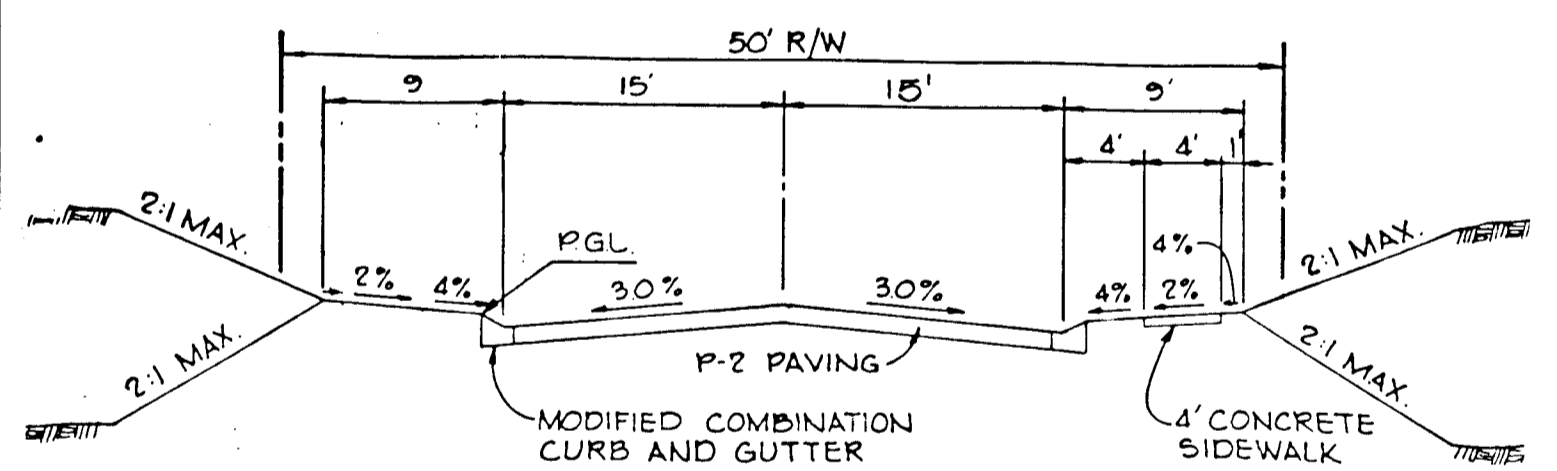

MODIFIED COMBINATION CURB AND GUTTER
4" CONCRETE SIDEWALK
P-2 PAVING
2% MAX
4%
30%
4%
2%
2% MAX

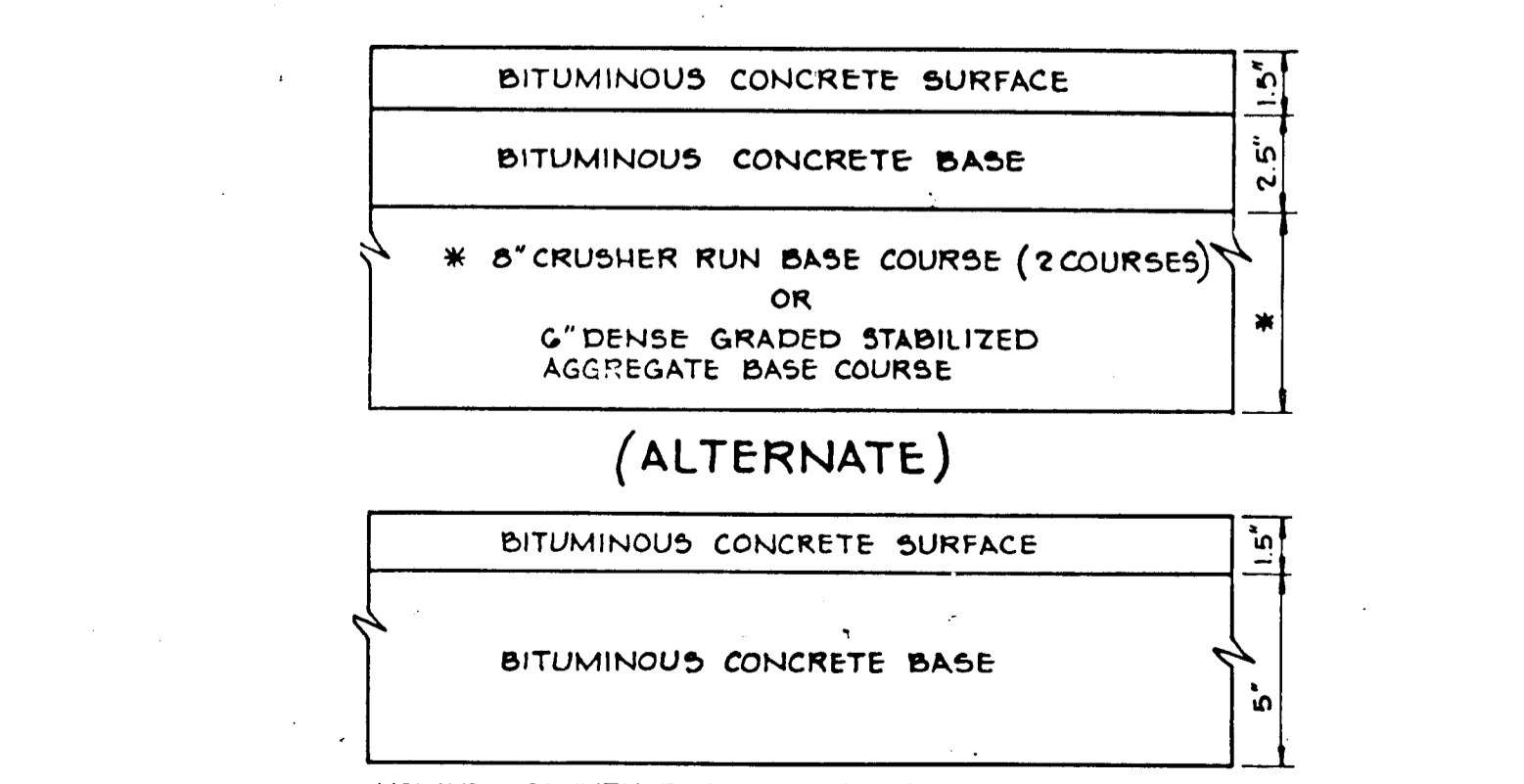

BITUMINOUS CONCRETE SURFACE 1.5"
BITUMINOUS CONCRETE BASE 2.5"
* 8" CRUSHER RUN BASE COURSE (2 COURSES) OR
6" DENSE GRADED STABILIZED AGGREGATE BASE COURSE
(ALTERNATE)
BITUMINOUS CONCRETE SURFACE 1.5"
BITUMINOUS CONCRETE BASE 5"

HOWARD COUNTY DESIGN MANUAL VOLUME IV STANDARD SPECIFICATIONS AND DETAILS FOR CONSTRUCTION (DRAWING R-201)

6 1/2" PAVING, P-2
NO SCALE
MANORWOOD ROAD

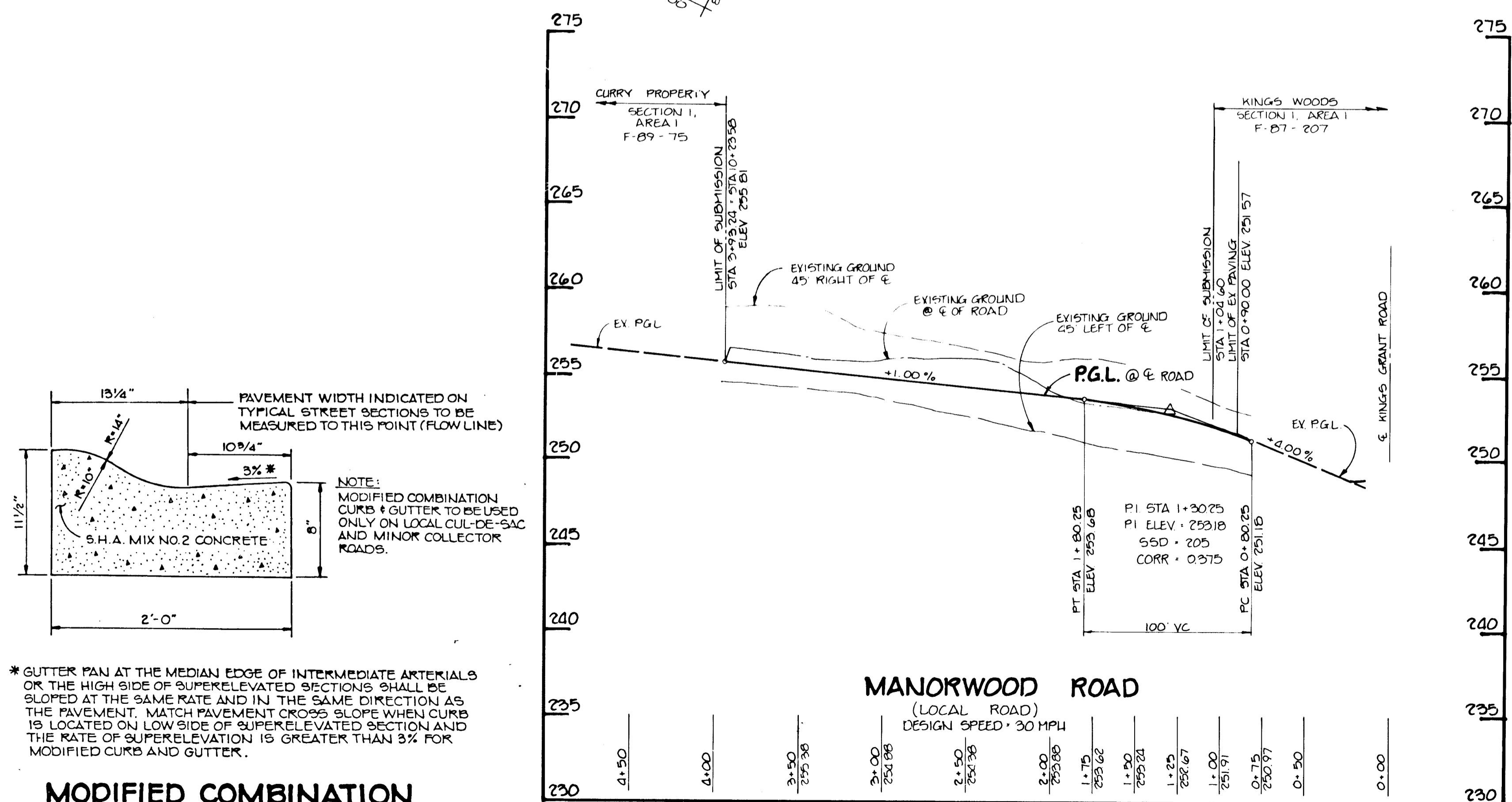

APPROVED: HOWARD COUNTY DEPARTMENT OF PUBLIC WORKS

James K. Tracy
CHIEF, LAND DEVELOPMENT DIVISION 5/10/89 DATE

William W. Whiteland
CHIEF, BUREAU OF HIGHWAYS 5/11/89 DATE

William W. Whiteland
CHIEF, BUREAU OF ENGINEERING 5-12-89 DATE

APPROVED: HOWARD COUNTY OFFICE OF PLANNING AND ZONING

James K. Tracy
CHIEF, DIVISION OF COMMUNITY PLANNING AND LAND DEVELOPMENT - DMTL 5/12/89 DATE

NO	DATE	REVISION

TRACY, SCHULTE & ASSOCIATES INC.
planning • architecture • engineering
8480 Baltimore National Pike • Ellicott City, Maryland 21043 • (301) 465-6105

James K. Tracy
REGISTERED PROFESSIONAL ENGINEER

OWNER/DEVELOPER: SECURITY DEVELOPMENT CORPORATION
PO BOX 417
ELICOTT CITY, MARYLAND 21043

PROJECT: **KINGS WOODS**
SECTION 1, AREA 4
(INCLUDES A RESUBDIVISION OF KINGS WOODS SECTION 1, AREA 1, LOTS 93 & 41)

LOCATION: F-87-142 TAX MAP NO 47
WP-89-42 PARCEL NO 6 775 & 781
S-87-28 6TH ELECTION DISTRICT
HOWARD COUNTY, MARYLAND

TITLE PLAN OF MANORWOOD ROAD, ROAD PROFILE, NOTES, DETAILS AND LANDSCAPE PLAN

DATE: JAN. 24, 1989 PROJECT NO: 0030
DES: D.A.H. DRN: JH SCALE: AS SHOWN DRAWING: 1 OF 2

- SEDIMENT CONTROL NOTES**
- 1) A NOTIFICATION 22 HOURS NOTICE MUST BE GIVEN TO THE HOWARD COUNTY OFFICE OF INSPECTIONS AND PERMITS PRIOR TO THE START OF ANY CONSTRUCTION (992-2437).
 - 2) ALL VEGETATIVE AND STRUCTURAL PRACTICES ARE TO BE INSTALLED ACCORDING TO THE PROVISIONS OF THIS PLAN AND ARE TO BE IN CONFORMANCE WITH THE 1983 MARYLAND STANDARDS AND SPECIFICATIONS FOR SOIL EROSION AND SEDIMENT CONTROL.
 - 3) FOLLOWING INITIAL SOIL DISTURBANCE OR REDISTURBANCE, PERMANENT OR TEMPORARY STABILIZATION SHALL BE COMPLETED WITHIN: a) 7 CALENDAR DAYS FOR ALL PERIMETER SEDIMENT CONTROL STRUCTURES, DIKES, PERIMETER SLOPES AND ALL SLOPES GREATER THAN 3:1, b) 14 DAYS AS TO ALL OTHER DISTURBED OR GRADED AREAS ON THE PROJECT SITE.
 - 4) ALL SEDIMENT TRAPS/BASINS SHOWN MUST BE FENCED AND WARNING SIGNS POSTED AROUND THEIR PERIMETER IN ACCORDANCE WITH VOL. 1, CHAPTER 12, OF THE HOWARD COUNTY DESIGN MANUAL, STORM DRAINAGE.
 - 5) ALL DISTURBED AREAS MUST BE STABILIZED WITHIN THE TIME PERIOD SPECIFIED ABOVE IN ACCORDANCE WITH THE 1983 MARYLAND STANDARDS AND SPECIFICATIONS FOR SOIL EROSION AND SEDIMENT CONTROL FOR PERMANENT SEEDINGS (Sec. 51) SOD (Sec. 54), TEMPORARY SEEDING (Sec. 50) MULCHING (Sec. 52). TEMPORARY STABILIZATION WITH MULCH ALONE CAN ONLY BE DONE WHEN RECOMMENDED SEEDING DATES DO NOT ALLOW FOR PROPER GERMINATION AND ESTABLISHMENT OF GRASSES.
 - 6) ALL SEDIMENT CONTROL STRUCTURES ARE TO REMAIN IN PLACE AND ARE TO BE MAINTAINED IN OPERATIVE CONDITION UNTIL PERMISSION FOR THEIR REMOVAL HAS BEEN OBTAINED FROM THE HOWARD COUNTY SEDIMENT CONTROL INSPECTOR.
 - 7) SITE ANALYSIS:

TOTAL AREA OF SITE	2.6 ACRES
AREA DISTURBED	0.977 ACRES
AREA TO BE ROOFED OR PAVED	0.205 ACRES
AREA TO BE VEGETATIVELY STABILIZED	0.712 ACRES
TOTAL CUT	950 CU. YDS.
TOTAL FILL	81 CU. YDS.
OFFSITE WASTE/BORROW AREA LOCATION	N/A
 - 8) ANY SEDIMENT CONTROL PRACTICE WHICH IS DISTURBED BY GRADING ACTIVITY FOR PLACEMENT OF UTILITIES MUST BE REPAIRED ON THE SAME DAY OF DISTURBANCE.
 - 9) ADDITIONAL SEDIMENT CONTROLS MUST BE PROVIDED, IF DEEMED NECESSARY BY THE HOWARD COUNTY DPW SEDIMENT CONTROL INSPECTOR.
 - 10) ALL SEDIMENT TRAPS SHOWN MUST BE FENCED AND WARNING SIGNS POSTED AROUND THEIR PERIMETER IN ACCORDANCE WITH VOL. 1, CHAPTER 12, OF THE HOWARD COUNTY DESIGN MANUAL, STORM DRAINAGE.

PERMANENT SEEDBED PREPARATION

SEEDBED PREPARATION: LOOSEN UPPER THREE INCHES OF SOIL BY RAKING, DISCING OR OTHER ACCEPTABLE MEANS BEFORE SEEDING, IF NOT PREVIOUSLY LOOSENED.

- SOIL AMENDMENTS: IN LIEU OF SOIL TEST RECOMMENDATIONS, USE ONE OF THE FOLLOWING SCHEDULES:
- 1) PREFERRED - APPLY 2 TONS PER ACRE DOLOMITIC LIMESTONE (92 lbs/1000 sq ft) AND 600 lbs per acre 10-10-10 FERTILIZER (14 lbs/1000 sq ft) BEFORE SEEDING. HARROW OR DISC INTO UPPER THREE INCHES OF SOIL. AT TIME OF SEEDING, APPLY 400 LBS PER ACRE 30-0-0 UREAFORM FERTILIZER (9 lbs/1000 sq ft)
 - 2) ACCEPTABLE - APPLY 2 TONS PER ACRE DOLOMITIC LIMESTONE (92 lbs/1000 sq ft) AND 1000 LBS PER ACRE 10-10-10 FERTILIZER (23 lbs/1000 sq ft) BEFORE SEEDING. HARROW OR DISC INTO UPPER THREE INCHES OF SOIL.

SEEDING: FOR THE PERIODS MARCH 1 THRU APRIL 30 AND AUGUST 1 THRU OCTOBER 15, SEED WITH 60 LBS PER ACRE (1.4 lbs/1000 sq ft) OF KENTUCKY 31 TALL FESCUE. FOR THE PERIOD MAY 1 THRU JULY 31, SEED WITH 60 LBS OF KENTUCKY 31 TALL FESCUE PER ACRE AND 2 LBS PER ACRE (.05 lbs/1000 sq ft) OF KEEPING LOVEGRASS. DURING THE PERIOD OF OCTOBER 16 THRU FEBRUARY 28, PROTECT SITE BY: OPTION (1) 2 TONS PER ACRE OF WELL ANCHORED STRAW MULCH AND SEED AS SOON AS POSSIBLE IN THE SPRING. OPTION (2) USE SOD. OPTION (3) SEED WITH 60 LBS PER ACRE OF KENTUCKY 31 TALL FESCUE AND MULCH WITH 2 TONS PER ACRE OF WELL ANCHORED STRAW.

MULCHING: APPLY 1-1/2 TO 2 TONS PER ACRE (70 TO 90 lbs/1000 sq ft) OF UNROOTED SMALL GRAIN STRAW IMMEDIATELY AFTER SEEDING. ANCHOR MULCH IMMEDIATELY AFTER APPLICATION USING MULCH ANCHORING TOOL OR 210 GALLONS PER ACRE (5 gal/1000 sq ft) OF EMULSIFIED ASPHALT ON FLAT AREAS, ON SLOPES 8 FEET OR HIGHER, USE 348 GALLONS PER ACRE (8 gal/1000 sq ft) FOR ANCHORING.

MAINTENANCE: INSPECT ALL SEEDBED AREAS AND MAKE NEEDED REPAIRS, REPLACEMENTS AND RESEEDINGS.

TEMPORARY SEEDBED PREPARATION

APPLY TO GRADED OR CLEARED AREAS LIKELY TO BE REDISTURBED WHERE A SHORT-TERM VEGETATIVE COVER IS NEEDED.

SEEDBED PREPARATION: LOOSEN UPPER THREE INCHES OF SOIL BY RAKING, DISCING OR OTHER ACCEPTABLE MEANS BEFORE SEEDING, IF NOT PREVIOUSLY LOOSENED.

SOIL AMENDMENTS: APPLY 600 LBS PER ACRE 10-10-10 FERTILIZER (14 lbs/1000 sq ft).

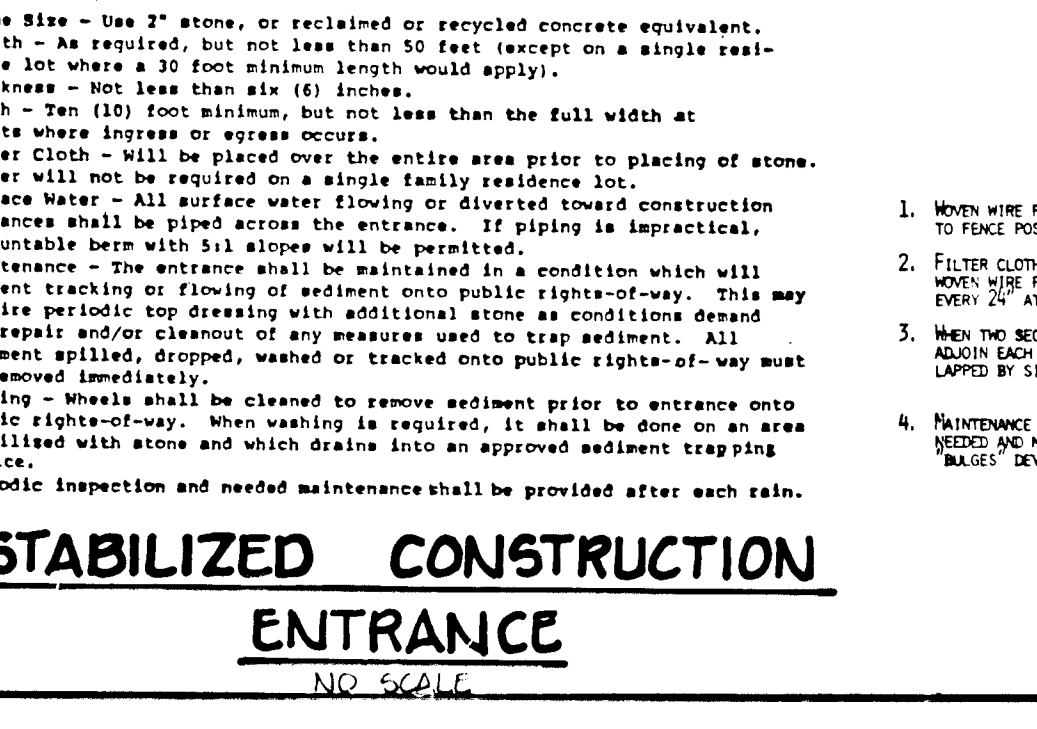
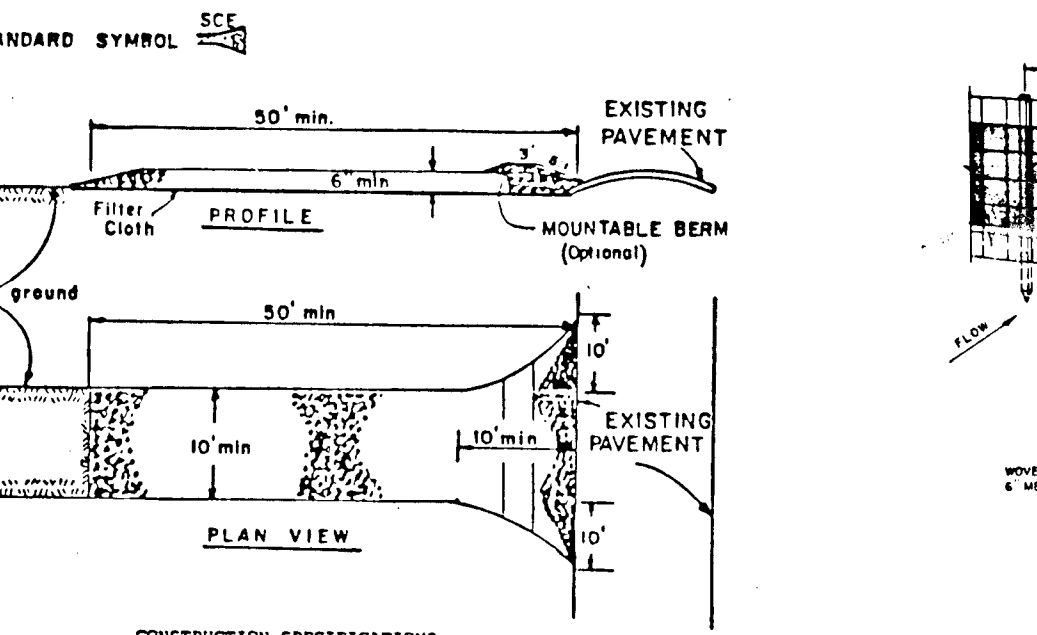

STABILIZED CONSTRUCTION ENTRANCE
NO SCALE

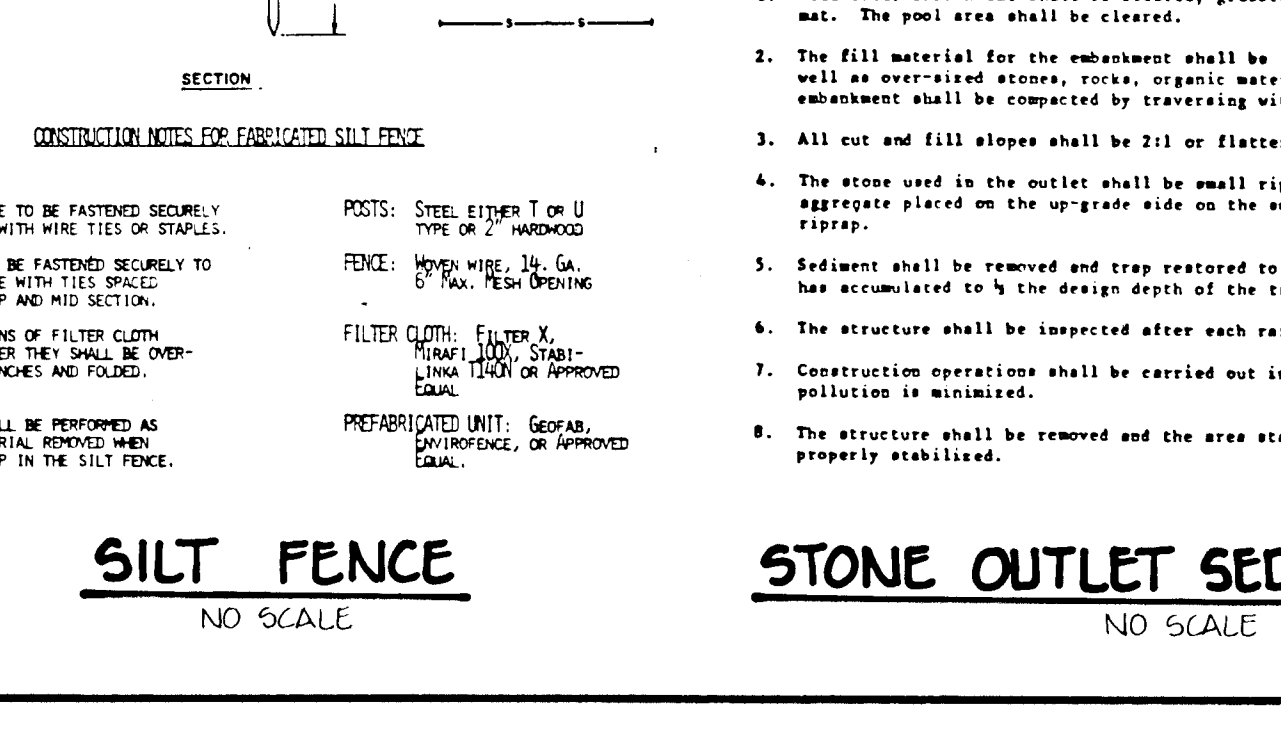
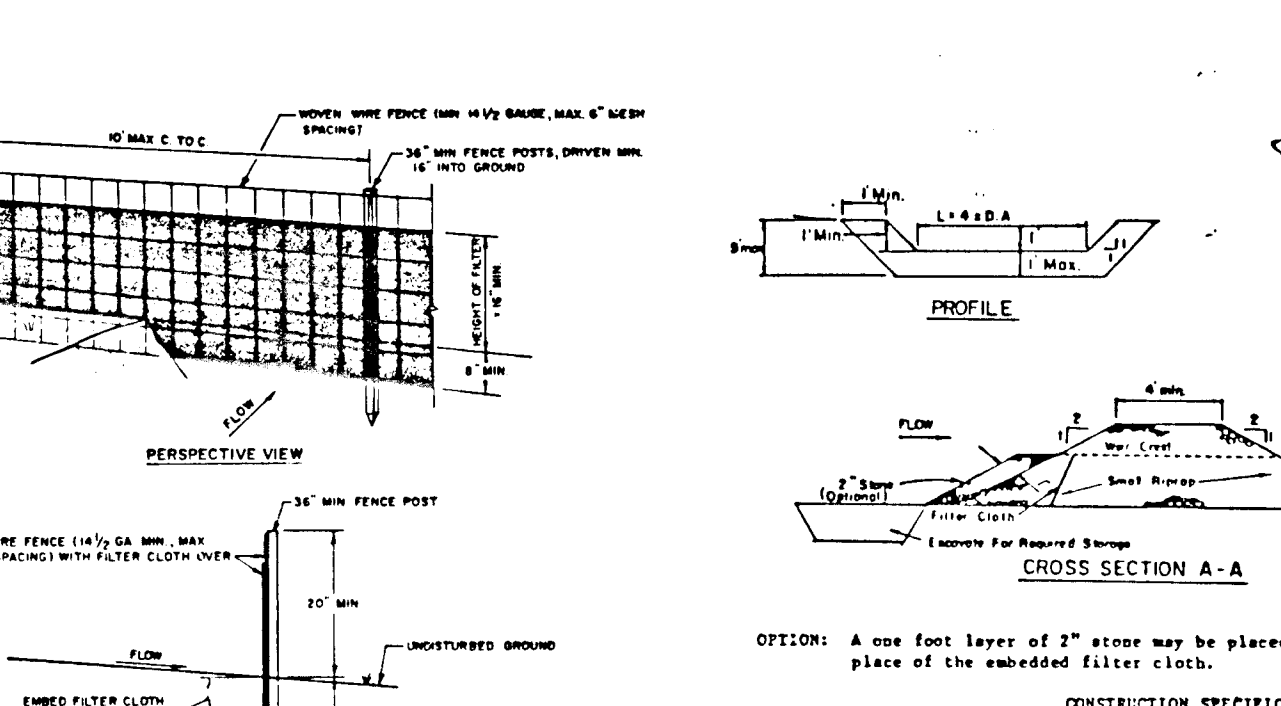
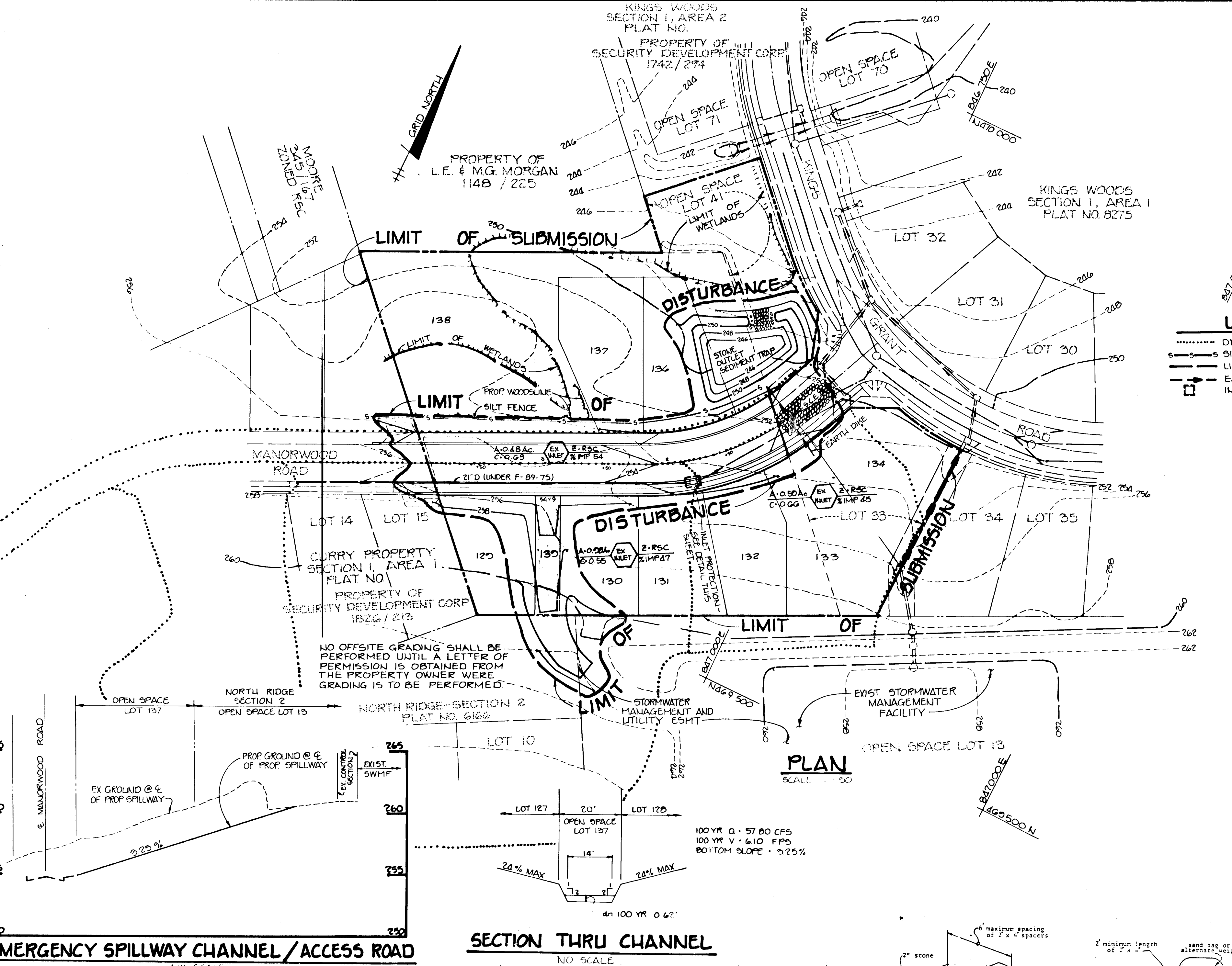

STONE OUTLET SEDIMENT TRAP
NO SCALE

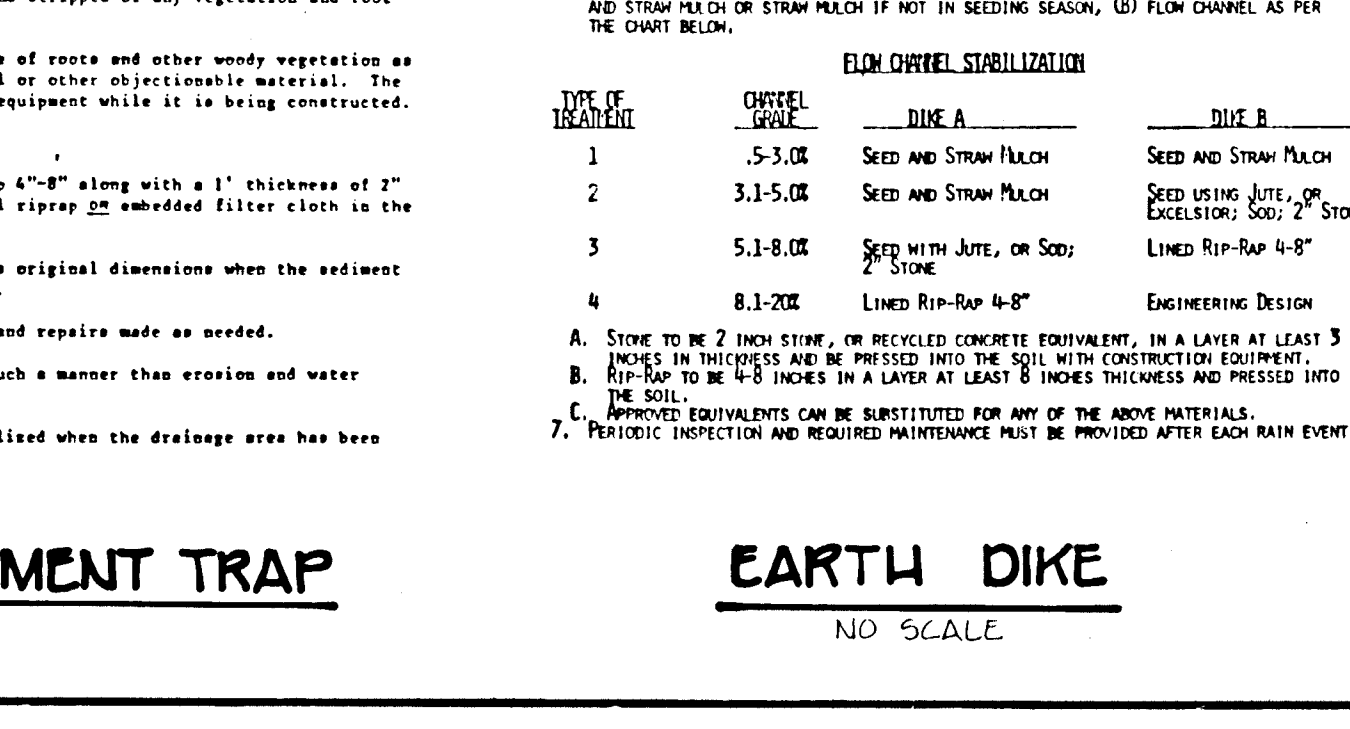
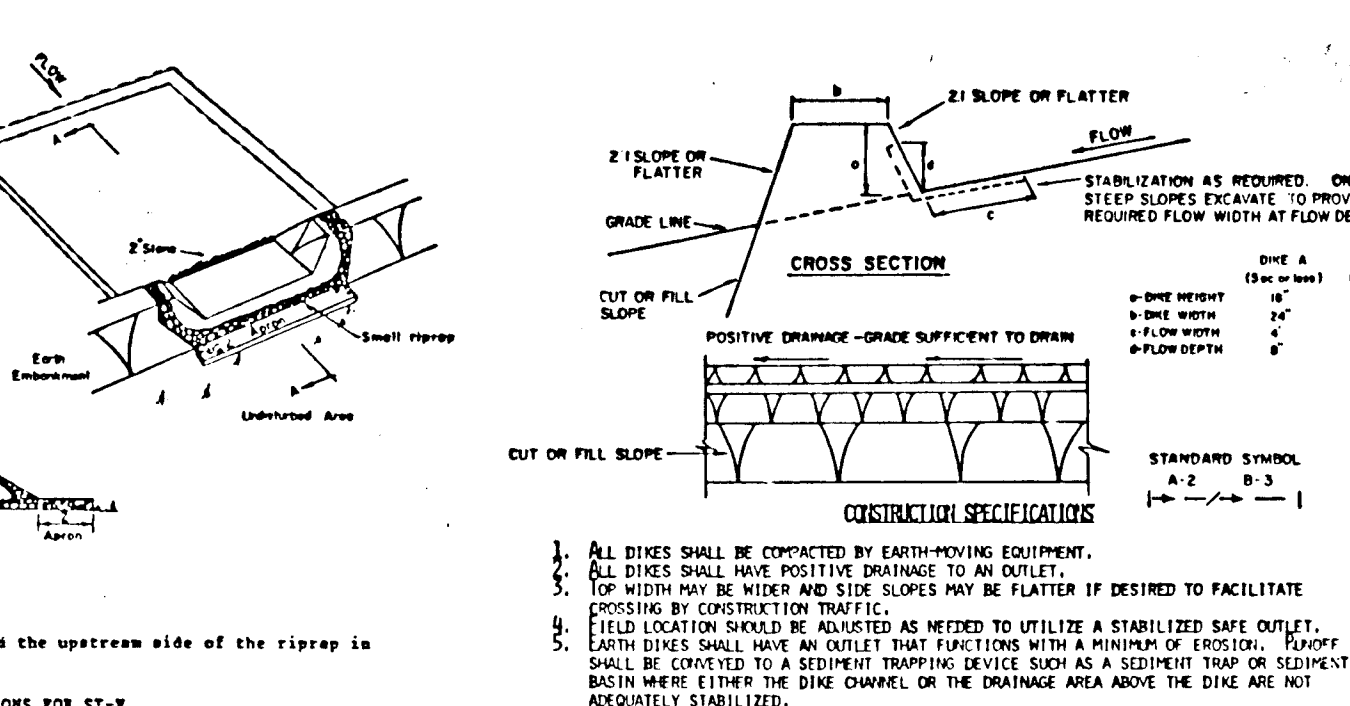

EARTH DIKE
NO SCALE

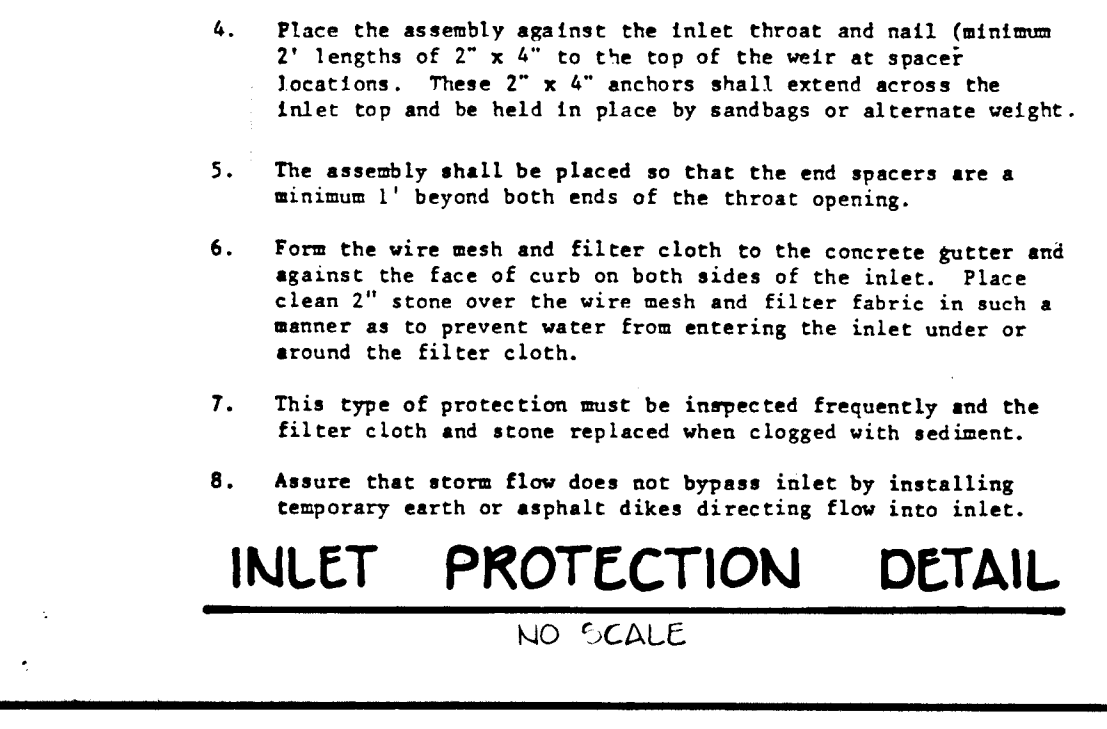
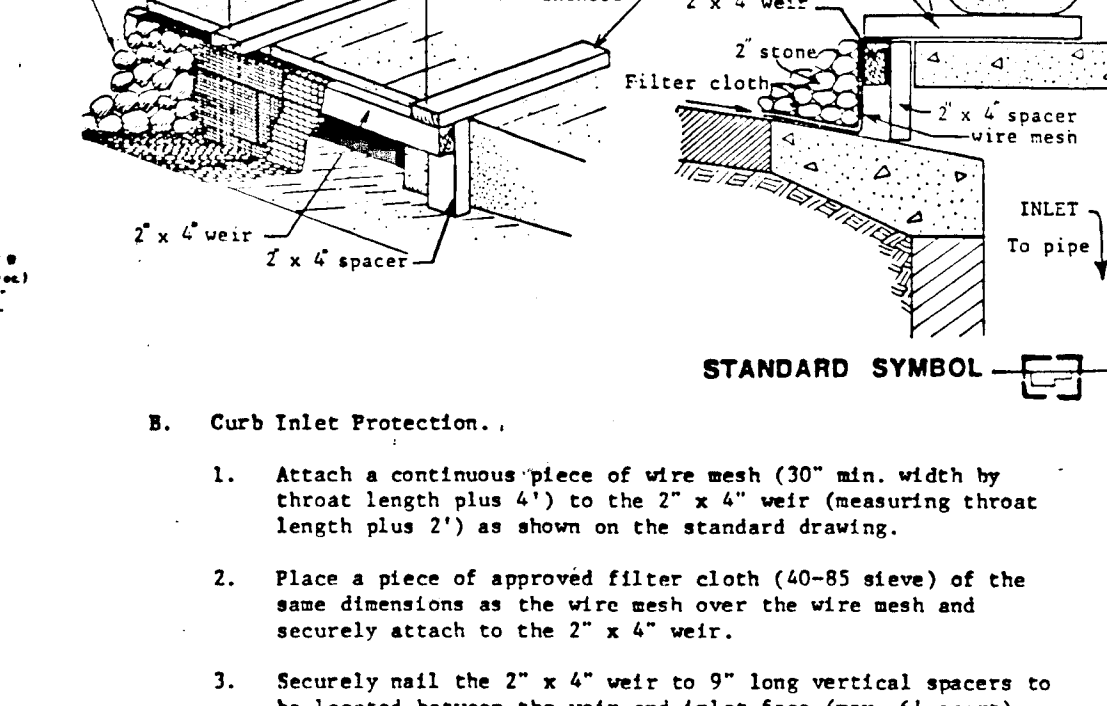

INLET PROTECTION DETAIL
NO SCALE

SEQUENCE OF CONSTRUCTION

DAY 1	1. OBTAIN A GRADING PERMIT.
DAY 2-4	2. INSTALL STABILIZED CONSTRUCTION ENTRANCE, SEDIMENT TRAP AND ALL OTHER SEDIMENT CONTROL DEVICES.
DAY 5-7	3. CLEAR AND GRUB AREA OF DISTURBANCE.
DAY 8-12	4. GRADE DISTURBED AREA AND STABILIZE IN ACCORDANCE WITH TEMPORARY SEEDBED NOTES.
DAY 13-15	5. INSTALL CURB AND GUTTER AND PAVING AND STABILIZE IN ACCORDANCE WITH PERMANENT SEEDBED NOTES.
DAY 16-21	7. UPON APPROVAL OF HOWARD COUNTY DEPARTMENT OF PUBLIC WORKS, SEDIMENT CONTROL INSPECTOR, REMOVE REMAINING SEDIMENT CONTROL DEVICES AND STABILIZE REMAINING DISTURBED AREAS IN ACCORDANCE WITH PERMANENT SEEDBED NOTES.

LEGEND

- DRAINAGE AREA DIVISION
- - - SILT FENCE
- LIMIT OF DISTURBANCE
- EARTH DIKE
- INLET PROTECTION

NOTE: GRADING INDICATED WITHIN THE BUILDABLE LOTS IS TEMPORARY FOR THE PURPOSE OF ROAD CONSTRUCTION AND INSTALLATION OF SEDIMENT TRAPS. THE FINAL SITE GRADING FOR THE LOTS WILL BE SHOWN IN COMPLIANCE WITH THE MINIMUM RSC ZONING LOT SIZE REQUIREMENT ON THE SITE DEVELOPMENT PLAN.

BY THE DEVELOPER:
"I/WE CERTIFY THAT ALL DEVELOPMENT AND CONSTRUCTION WILL BE DONE ACCORDING TO THIS PLAN, AND THAT ANY RESPONSIBLE PERSONNEL INVOLVED IN THE CONSTRUCTION PROJECT WILL HAVE A CERTIFICATE OF ATTENDANCE AT A DEPARTMENT OF NATURAL RESOURCES APPROVED TRAINING PROGRAM FOR THE CONTROL OF SEDIMENT AND EROSION BEFORE BEGINNING THE PROJECT. I ALSO AUTHORIZE PERIODIC ON-SITE INSPECTION BY THE HOWARD SOIL CONSERVATION DISTRICT."
James R. Moley, Jr.
DEVELOPER: JAMES R. MOLEY, JR.
SECURITY DEVELOPMENT CORPORATION - PRESIDENT
3-27-89 DATE

BY THE ENGINEER:
"I CERTIFY THAT THIS PLAN FOR EROSION AND SEDIMENT CONTROL REPRESENTS A PRACTICAL AND WORKABLE PLAN BASED ON MY PERSONAL KNOWLEDGE OF THE SITE CONDITIONS AND THAT IT WAS PREPARED IN ACCORDANCE WITH THE REQUIREMENTS OF THE HOWARD SOIL CONSERVATION DISTRICT."
James K. Tracy, P.E.
ENGINEER: JAMES K. TRACY, P.E.
3-27-89 DATE

REVIEWED FOR HOWARD SOIL CONSERVATION DISTRICT AND MEETS TECHNICAL REQUIREMENTS
James M. Helms
U.S. SOIL CONSERVATION SERVICE
4/3/89 DATE

THIS DEVELOPMENT PLAN IS APPROVED FOR SOIL EROSION AND SEDIMENT CONTROL BY THE HOWARD SOIL CONSERVATION DISTRICT
John H. Robinson
HOWARD S.C.D.
4/3/89 DATE

APPROVED: HOWARD COUNTY DEPARTMENT OF PUBLIC WORKS
James M. Helms
CHIEF, LAND DEVELOPMENT DIVISION
5/10/89 DATE
Shawellee W. Weiland
CHIEF, BUREAU OF HIGHWAYS
5/11/89 DATE
William S. Reid
CHIEF, BUREAU OF ENGINEERING
5-12-89 DATE

APPROVED: HOWARD COUNTY OFFICE OF PLANNING AND ZONING
James M. Helms
CHIEF, DIVISION OF COMMUNITY PLANNING AND LAND DEVELOPMENT - DATE LMS

NO	DATE	REVISION

TRACY, SCHULTE & ASSOCIATES INC.
planning • architecture • engineering
8480 Baltimore National Pike • Ellicott City, Maryland 21043 • (301) 465-6105

OWNER / DEVELOPER	PROJECT
SECURITY DEVELOPMENT CORPORATION PO BOX 417 ELICOTT CITY, MARYLAND 21043	KINGS WOODS SECTION 1, AREA 4 (INCLUDES A REDIVISION OF KINGS WOODS SECTION 1, AREA 1 LOTS 29-31)
	LOCATION: F-89-149 WP-89-42 S-89-28 TAX MAP NO. 47 PARCEL NOS 775 & 781 6TH ELECTION DISTRICT HOWARD COUNTY, MARYLAND
	TITLE: GRADING AND SEDIMENT CONTROL PLAN, NOTES AND DETAILS AND DRAINAGE AREA MAP
DATE: JAN 24, 1989	PROJECT NO: 0030
DES O&M: DRN JH	SCALE: AS SHOWN DRAWING: 2 OF 2

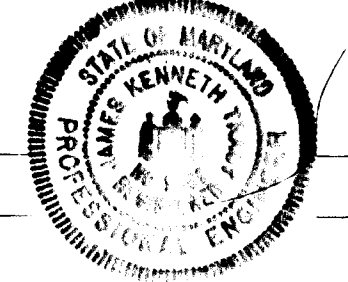

James K. Tracy