

**OWNER**  
T.E. Wimsatt Construction & Associates  
8401 Murphy Road  
Laurel, Maryland 20707  
(301) 490-3666  
(301) 953-2456 D.C. Metro  
ATTN: Mr. Patrick Cremer

**DEVELOPER**  
Land Design & Development, Inc.  
8307 Main Street  
Ellicott City, Maryland 21043  
(301) 461-4800  
ATTN: Mr. Donald R. Reuser, Jr.  
General Partner

**ENGINEER**  
Mildenberg, Mochi & Associates, Inc.  
3300 North Ridge Road  
Ellicott City, Maryland 21043  
(301) 461-0078  
(301) 621-5768 D.C. Metro  
ATTN: Mr. Robert M. Mochi, P.E.

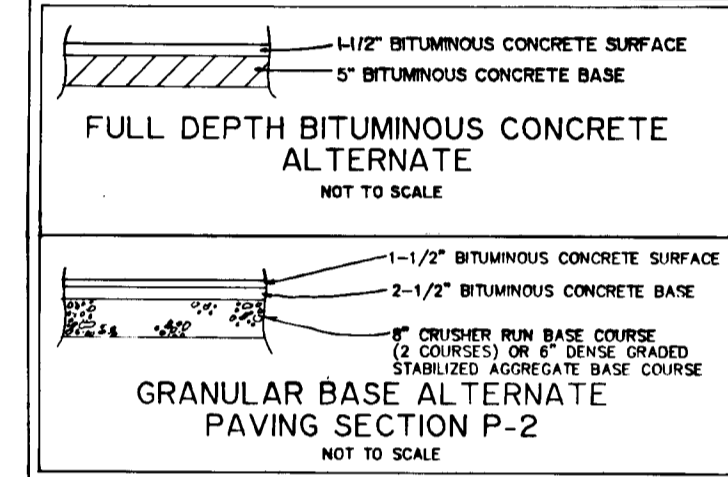
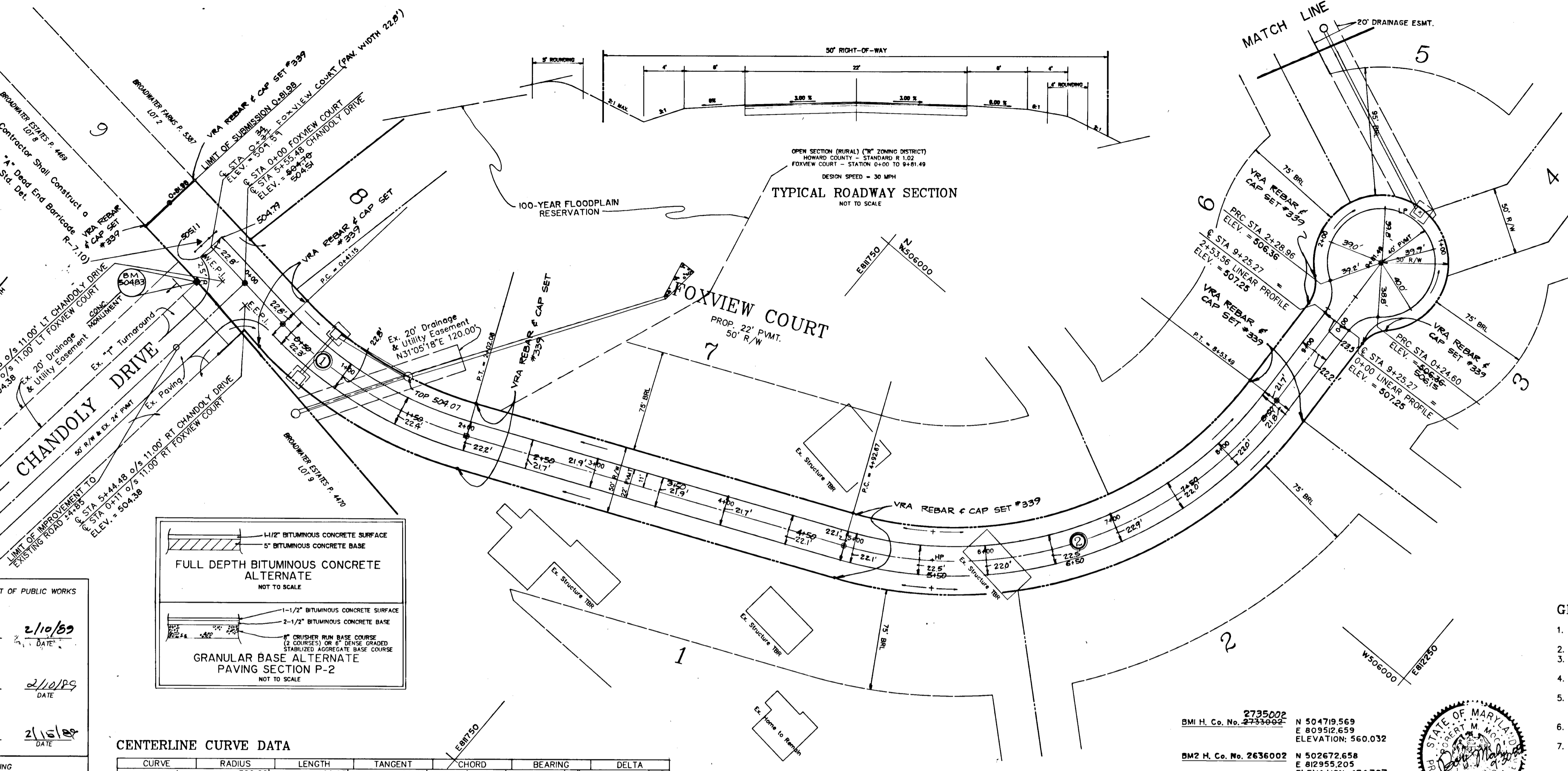

**CENTERLINE CURVE DATA**

CURVE	RADIUS	LENGTH	TANGENT	CHORD	BEARING	DELTA
1	300.00'	160.93'	82.45'	159.01'	S13°39'05"E	30°44'09"
2	300.00'	360.82'	205.84'	339.46'	S63°28'30"E	68°54'42"

**APPROVED:** HOWARD COUNTY DEPARTMENT OF PUBLIC WORKS

*Patrick Cremer* 2/10/89  
DATE

*G.W. Weiland* 2/10/89  
DATE

*Robert M. Mochi* 2/10/89  
DATE

**APPROVED:** OFFICE OF PLANNING AND ZONING

*Mark L. Robel* 2-22-89  
DATE

- GENERAL NOTES**
- All work shall be done in accordance with Howard County Standards, Specifications and Details for Construction.
  - All utility companies must be notified in advance of any construction.
  - Storm drainage trenches within road rights-of-way shall be backfilled and compacted in accordance with the Howard County Road Code.
  - Any damage to public rights-of-way or paving will be corrected at the Contractor's expense.
  - Contractor to notify the Howard County Inspection and Survey Division at least three days before starting work shown on these drawings. (Telephone: (301) 792-7272)
  - All traffic control devices shall be installed in accordance with the Manual of Uniform Traffic Control Devices, 1984 Revised Edition.
  - Location of existing utilities shall be verified by the contractor prior to starting any work shown on these drawings. Any damage to existing utilities will be corrected at the Contractor's expense.
  - To be removed - TBR.
  - WP 89-17 requesting a waiver from providing the required right-of-way financing, Section 12.13.7.3 of the Howard County Subdivision and Land Development Regulations was approved by the Planning Director on September 15, 1988.

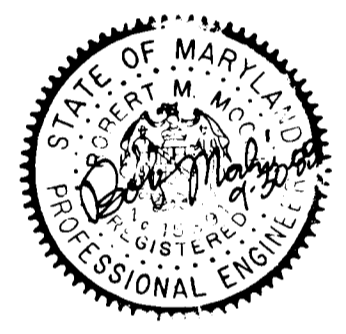
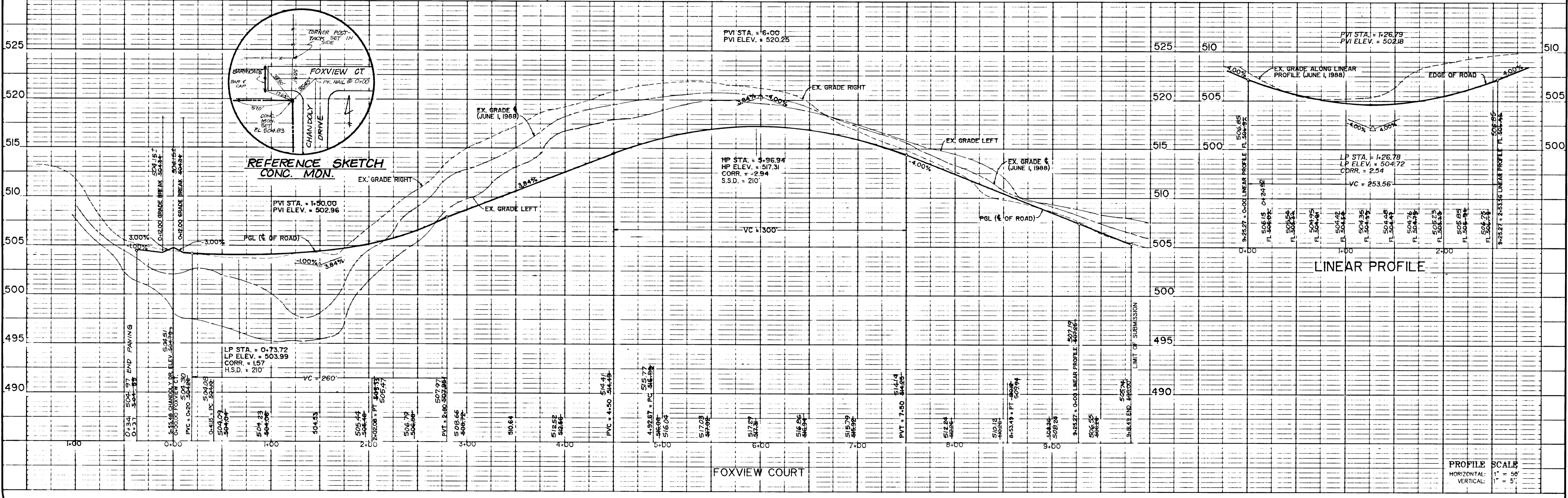

AS-BUILT SURVEY CERTIFIED BY  
MARK L. ROBEL, MD. P.L.S. No.  
339, ON 12-4-89

Project	date	8/88
Illustration	1/27/89	KAM
Scale	10/03/88	KAM
Revisions	10/03/88	KAM
Revisions		

Revised Per. 3rd Step Memo	date	
Submitted to Howard Co.		
description		
revisions		

LOTS 1-9  
**FOXVIEW MANOR SUBDIVISION**  
ELECTION DISTRICT No. 5  
HOWARD COUNTY, MARYLAND

**FOXVIEW COURT PLAN AND PROFILE**

**MILDENBERG, MOCHI & ASSOCIATES, INC.**  
ENGINEERS - PLANNERS  
3300 North Ridge Road, Suite 235, Ellicott City, Maryland 21043-3350  
(301) 461-0078 D.C. Metro (301) 621-5768



Project	88021-00	Date	8/88
Illustration	LSM/KAM	Engineering	KAM
Scale	1" = 50'	Approval	RMM

Revised	1	Date	11/20/89
Submitted to	Howard Co.	Submitted by	LSM/KAM
Submitted to	Howard Co.	Submitted by	LSM/KAM
Revisions		Description	
0			

LOTS 1 - 9  
**FOXVIEW MANOR SUBDIVISION**  
 ELECTION DISTRICT No. 5  
 HOWARD COUNTY, MARYLAND  
**STORM DRAIN PROFILES AND DETAILS**

**MILBERG, ROCH & ASSOCIATES, INC.**  
 ENGINEERS, ARCHITECTS, PLANNERS  
 3300 North Rockville Road, Suite 202, Gaithersburg, MD 20878  
 (301) 461-0078 D.C. Metro (202) 621-5786



**DRAINAGE AREA MAP**  
SCALE: 1" = 200'

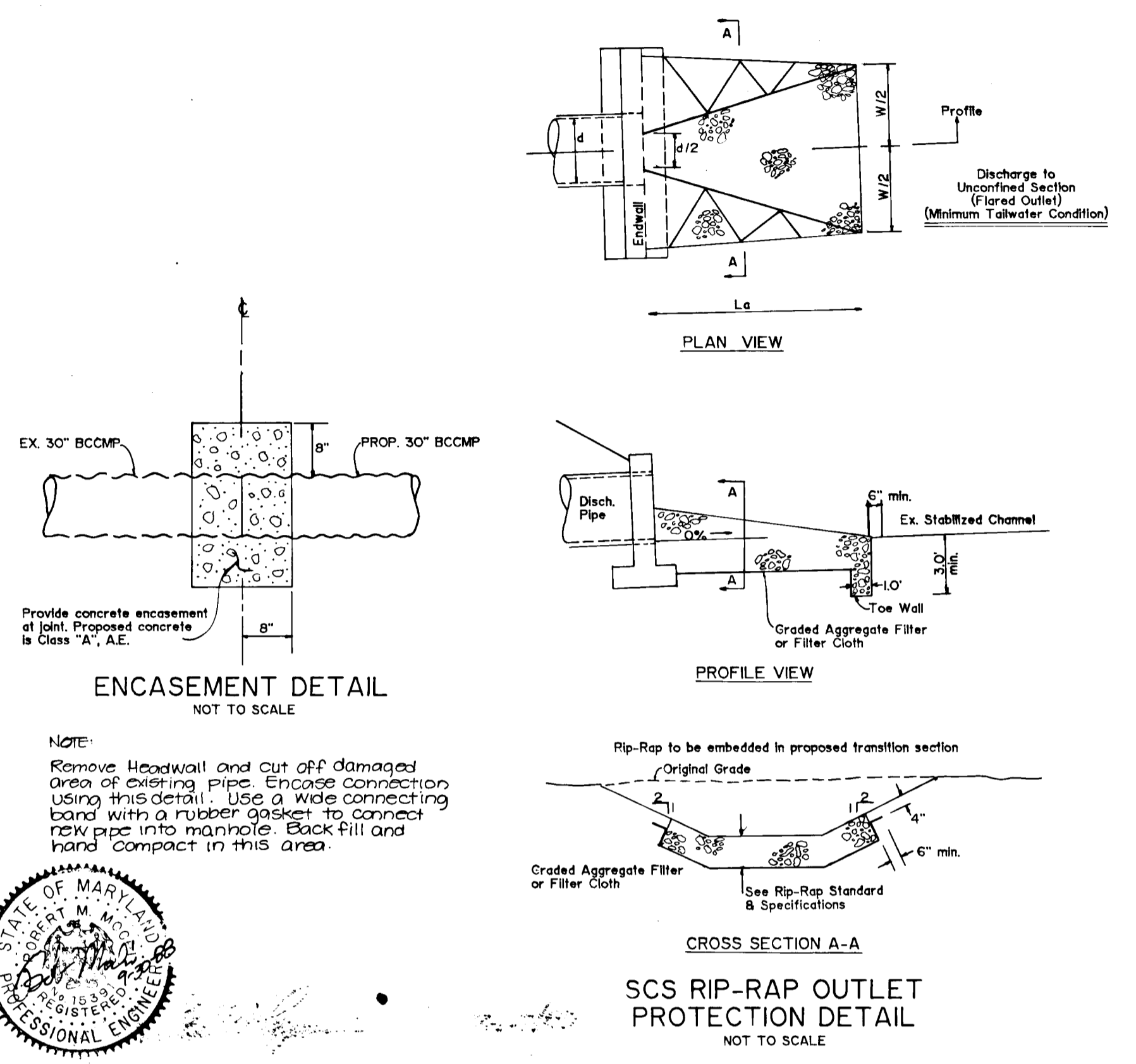

**SCS RIP-RAP OUTLET PROTECTION DETAIL**  
NOT TO SCALE

APPROVED: HOWARD COUNTY DEPARTMENT OF PUBLIC WORKS

*Frank J. Seaman* 2/10/89  
 CHIEF, LAND DEVELOPMENT DIVISION

*David Weiland* 2/10/89  
 CHIEF, BUREAU OF HIGHWAYS

*William J. Riley* 2/14/89  
 CHIEF, BUREAU OF ENGINEERING

APPROVED: OFFICE OF PLANNING AND ZONING

*Paul J. Langley* 2-28-89  
 CHIEF, DIVISION OF COMMUNITY PLANNING AND LAND DEVELOPMENT

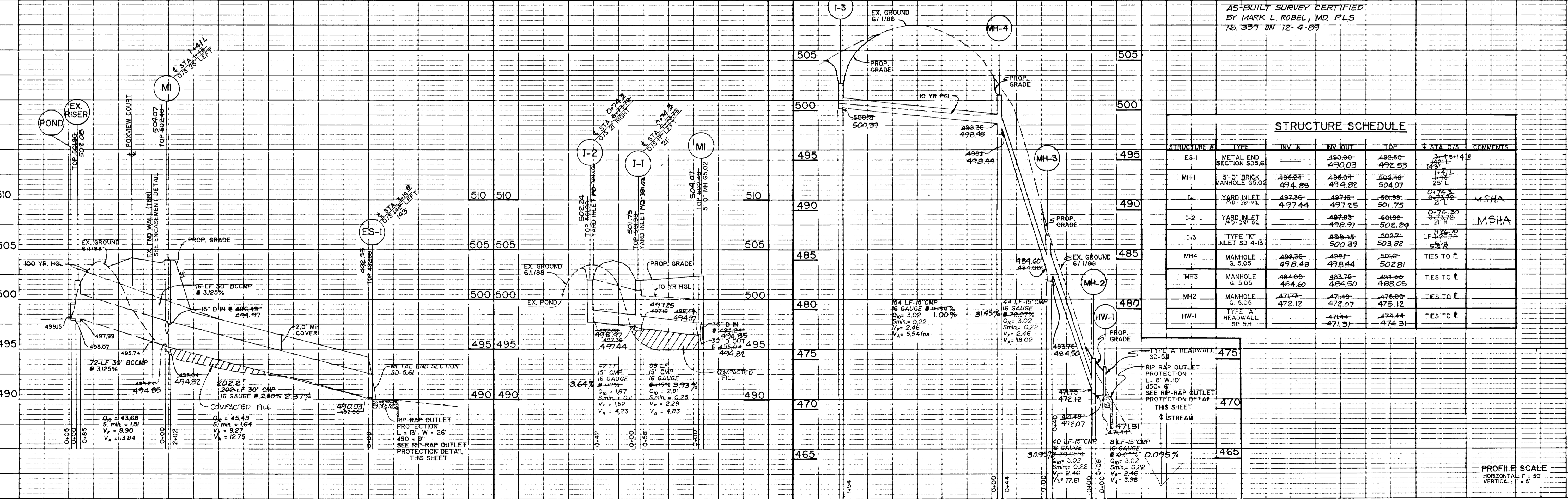
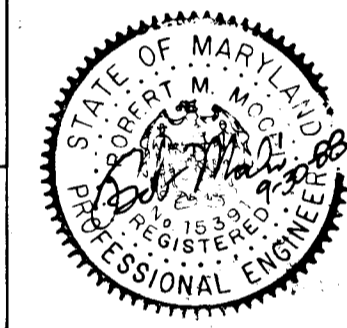

1432



OWNER  
T.E. Winslett Construction & Associates  
8401 Murphy Road  
Laurel, Maryland 20707  
(301) 490-3666  
(301) 953-2456  
ATTN: Mr. Patrick Creamer

DEVELOPER  
Land Design & Development, Inc.  
8307 Main Street  
Ellicott City, Maryland 21043  
(301) 461-4600  
ATTN: Mr. Donald R. Reuser, Jr.  
General Partner

ENGINEER  
Mildenberg, Mochi & Associates, Inc.  
3300 North Ridge Road  
Ellicott City, Maryland 21043  
(301) 461-0078  
(301) 621-5368 D.C. Metro  
ATTN: Mr. Robert M. Mochi, P.E.

BM H Co. No. 2733002 N 50479560 E 80852450 ELEVATION: 560.092  
BM Z H Co. No. 2036002 N 50227265 E 842955205 ELEVATION: 424.707

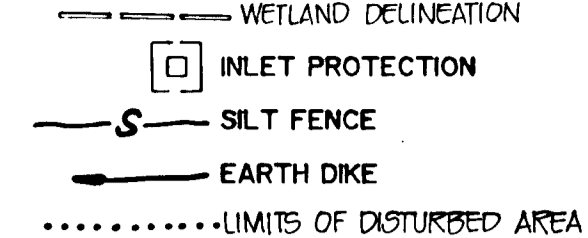

NOTE: TEMPORARILY DIVERT RUNOFF FROM I-1 AND I-2 INTO TRAP #1 UNTIL ROAD CONSTRUCTION IS STABILIZED.

TEMPORARY SEDIMENT TRAP #1  
DRAINAGE AREA = 1.42 ACRES  
STORAGE REQUIRED = 250 cu ft  
BOTTOM DIMENSIONS = 15' x 35'  
DEPTH = 3 ft  
BOTTOM ELEVATION = 487  
SIDE SLOPE = 2:1  
CREST ELEVATION = 491  
WEIR LENGTH = 6.0 ft  
STORAGE PROVIDED = 200 cu ft  
TYPE = ST-V

TEMPORARY SEDIMENT TRAP #2  
DRAINAGE AREA = 0.84 ACRES  
STORAGE REQUIRED = 152 cu ft  
BOTTOM DIMENSIONS = 15' x 20'  
DEPTH = 3 ft  
BOTTOM ELEVATION = 500  
SIDE SLOPE = 2:1  
CREST ELEVATION = 504  
WEIR LENGTH = 4.0 ft  
STORAGE PROVIDED = 150 cu ft  
TYPE = ST-V

NOTE: TEMPORARILY DIVERT RUNOFF TO I-3 INTO TRAP #2 UNTIL ROAD CONSTRUCTION IS STABILIZED.

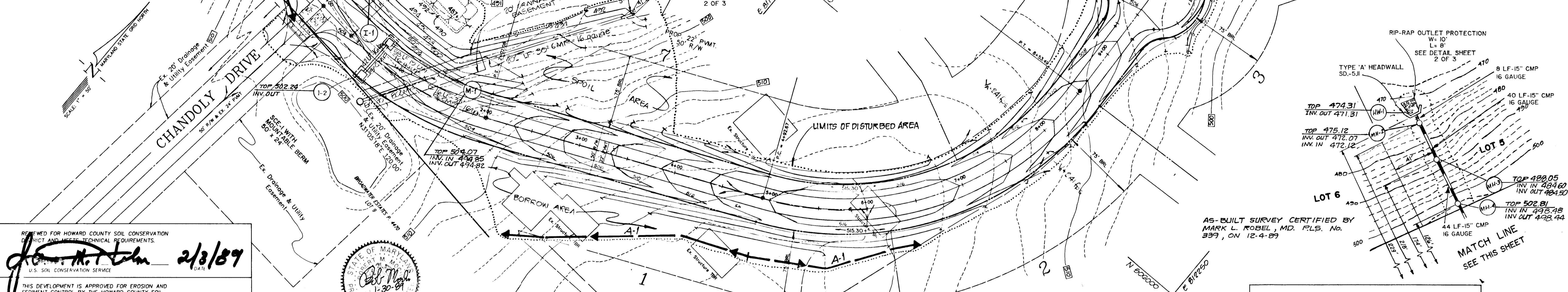

AS-BUILT SURVEY CERTIFIED BY  
MARK L. PROBEL, MD. PLS. No. 3397, ON 12-4-89

REVIEWED FOR HOWARD COUNTY SOIL CONSERVATION DISTRICT AND METEOROLOGICAL REQUIREMENTS.  
*John A. Johnson* 2/3/89  
U.S. SOIL CONSERVATION SERVICE

THIS DEVELOPMENT IS APPROVED FOR EROSION AND SEDIMENT CONTROL BY THE HOWARD COUNTY SOIL CONSERVATION DISTRICT.  
*John R. Robinson* 2/1/89  
HOWARD COUNTY SOIL CONSERVATION DISTRICT

PLAN SCALE  
SCALE: 1" = 50'

APPROVED: HOWARD COUNTY DEPARTMENT OF PUBLIC WORKS  
*William S. Reay* 2/15/89  
CHIEF, BUREAU OF ENGINEERING

APPROVED: HOWARD COUNTY DEPARTMENT OF PUBLIC WORKS  
*Charles W. Johnson* 2/10/89  
CHIEF, LAND DEVELOPMENT DIVISION

APPROVED: OFFICE OF PLANNING AND ZONING  
*Mark S. Langley* 2-26-89  
CHIEF, DIVISION OF COMMUNITY PLANNING AND LAND DEVELOPMENT

APPROVED: HOWARD COUNTY DEPARTMENT OF PUBLIC WORKS  
*St. W. Weiland Per. T.O.* 2/10/89  
CHIEF, BUREAU OF HIGHWAYS

ENGINEER'S CERTIFICATE  
I hereby certify that this plan for erosion and sediment control represents a practical and workable plan based on my personal knowledge of the site conditions and that it was prepared in accordance with the requirements of the Howard County Soil Conservation District.  
*Robert M. Mochi* 1-30-89  
Robert M. Mochi, P.E.

TEMPORARY SEEDING NOTES  
Apply to graded or cleared areas likely to be redistributed where a short-term vegetative cover is needed.  
Seedbed Preparation: Loosen upper three inches of soil by raking, discing or other acceptable means before seeding. (If not previously loosened).  
Soil Amendments: Apply 600 lbs per acre 10-10-10 fertilizer (14 lbs/1000 sf).  
Seeding: For periods March 1 through April 30 and from August 15 through November 15, seed with 2-1/2 bushels per acre of annual rye (3.2 lbs/1000 sf). For the period May 1 through August 14, seed with 3 lbs per acre of Weeping Lovegrass (0.07 lbs/1000 sf). For the period November 16 through February 28, protect site by applying 2 tons per acre of well anchored straw mulch and seed as soon as possible in the spring, or use sod.  
Mulching: Apply 1-1/2 to 2 tons per acre (70 to 90 lbs/1000 sf) of unrotted small grain straw immediately after seeding. Anchor mulch immediately after application using mulch anchoring tool or 218 gallons per acre (5 gal/1000 sf) of emulsified asphalt on flat areas. On slopes 8 feet or higher, use 348 gallons per acre (8 gal/1000 sf) for anchoring.  
Refer to the 1983 Maryland Standards and Specifications for Soil Erosion and Sediment Control for rate and methods not covered.

DEVELOPER'S CERTIFICATE  
I/We certify that all development and construction will be done in accordance with this plan of development and plan for erosion and sediment control and that all responsible personnel involved in the construction of this project will have a certificate of attendance at a Department of Natural Resources approved training program for the control of sediment and erosion before beginning the site preparation or construction activities. This certificate of attendance will be maintained on file at the Howard County Soil Conservation District or their authorized agents, as are deemed necessary.  
*Patrick Creamer* 1-30-89  
Signature of Developer

PERMANENT SEEDING NOTES  
Apply to graded or cleared area not subject to immediate further disturbance where a permanent long-lived vegetative cover is needed.  
Seedbed Preparation: Loosen upper three inches of soil by raking, discing or other acceptable means before seeding. (If not previously loosened).  
Soil Amendments: In lieu of soil test recommendations, use the following schedules:  
1) Preferred - Apply 2 tons per acre dolomitic limestone (92 lbs/1000 sf) and 600 lbs per acre 10-10-10 fertilizer (14 lbs/1000 sf) before seeding. Harrow or disc into upper three inches of soil. At time of seeding, apply 400 lbs per acre 30-0-0 ureaform fertilizer (9 lbs/1000 sf).  
2) Acceptable - Apply 2 tons per acre dolomitic limestone (92 lbs/1000 sf) and 1000 lbs per acre 10-10-10 fertilizer (23 lbs/1000 sf) before seeding. Harrow or disc into upper three inches of soil.  
Seeding: For the periods March 1 through April 30 and August 1 through October 15, seed with 60 lbs per acre (1.4 lbs/1000 sf) of Kentucky 31 Tall Fescue. For the period May 1 through July 31, seed with 60 lbs Kentucky 31 Tall Fescue and 2 lbs per acre (0.05 lbs/1000 sf) of Weeping Lovegrass. During the period of October 16 through February 28, protect site by Option 1) 2 tons per acre of well anchored straw mulch and seed as soon as possible in the spring. Option 2) use sod. Option 3) seed with 60 lbs/acre Kentucky 31 Tall Fescue and mulch with 2 tons/acre well anchored straw.  
Mulching: Apply 1-1/2 to 2 tons per acre (70 to 90 lbs/1000 sf) of unrotted small grain straw immediately after seeding. Anchor mulch immediately after application using mulch anchoring tool or 218 gallons per acre (5 gal/1000 sf) of emulsified asphalt on flat areas. On slopes 8 feet or higher, use 348 gallons per acre (8 gal/1000 sf) for anchoring.  
Maintenance: Inspect all seeded areas and make needed repairs, replacements and reseedings.

SEDIMENT CONTROL NOTES  
1. A minimum of 24 hours notice must be given to the Howard County Office of Inspections and Permits prior to the start of any construction. (892-2437).  
2. All vegetative and structural practices are to be installed according to the provisions of this plan and are to be in conformance with the 1983 Maryland Standards and Specifications for Soil Erosion and Sediment Control.  
3. Following initial soil disturbances or redistribution, permanent or temporary stabilization shall be completed within: a) 7 calendar days for all perimeter sediment control structures, dikes, perimeter slopes and all slopes greater than 3:1; b) 14 calendar days to all other disturbed or graded areas on the project site.  
4. All disturbed areas must be stabilized within the time period specified above in accordance with the 1983 Maryland Standards and Specifications for Soil Erosion and Sediment Control and Permanent Seedings (Sec. 51) Sod (Sec. 54), Temporary Seeding (Sec. 50) and Mulching (Sec. 52). Temporary stabilization with mulch alone can only be done when recommended seeding dates do not allow for proper germination and establishment of grasses.  
5. All sediment control structures are to remain in place and are to be maintained in operative condition until permission for their removal has been obtained from the Howard County Sediment Control Inspector.  
6. Site Analysis: NOTE: Quantities & Estimates shown are for sediment control purposes only. Contractor shall prepare Area to be disturbed: 134 AC. His own quantity estimates to his satisfaction. Area to be seeded or paved: 134 AC. Area to be vegetatively stabilized: 022 AC. Total Cut: 5,803 CY. Total Fill: 4,850 CY. Off-Site Waste/Borrow Area Location shown on Plan: 022 AC.  
7. Any sediment control practice which is disturbed by grading activity for placement of utilities must be repaired on the same day of disturbance. Additional sediment controls must be provided, if deemed necessary by the Howard County DPW Sediment Control Inspector.  
8. Remove vegetative cover and top soil from existing fill, scarify old fill with teeth on dozer or loader. As new fill comes up tie into existing fill at least 6".

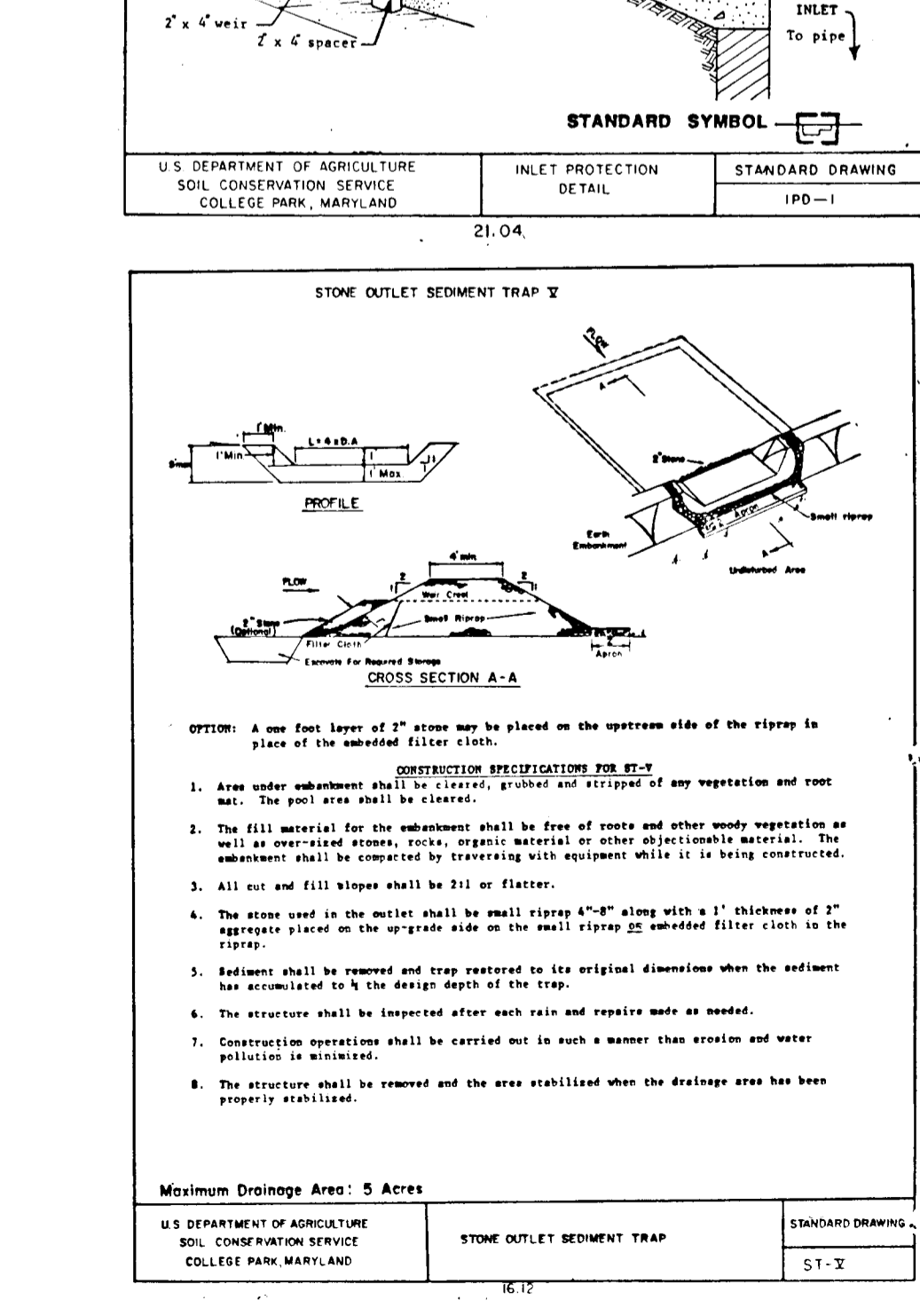
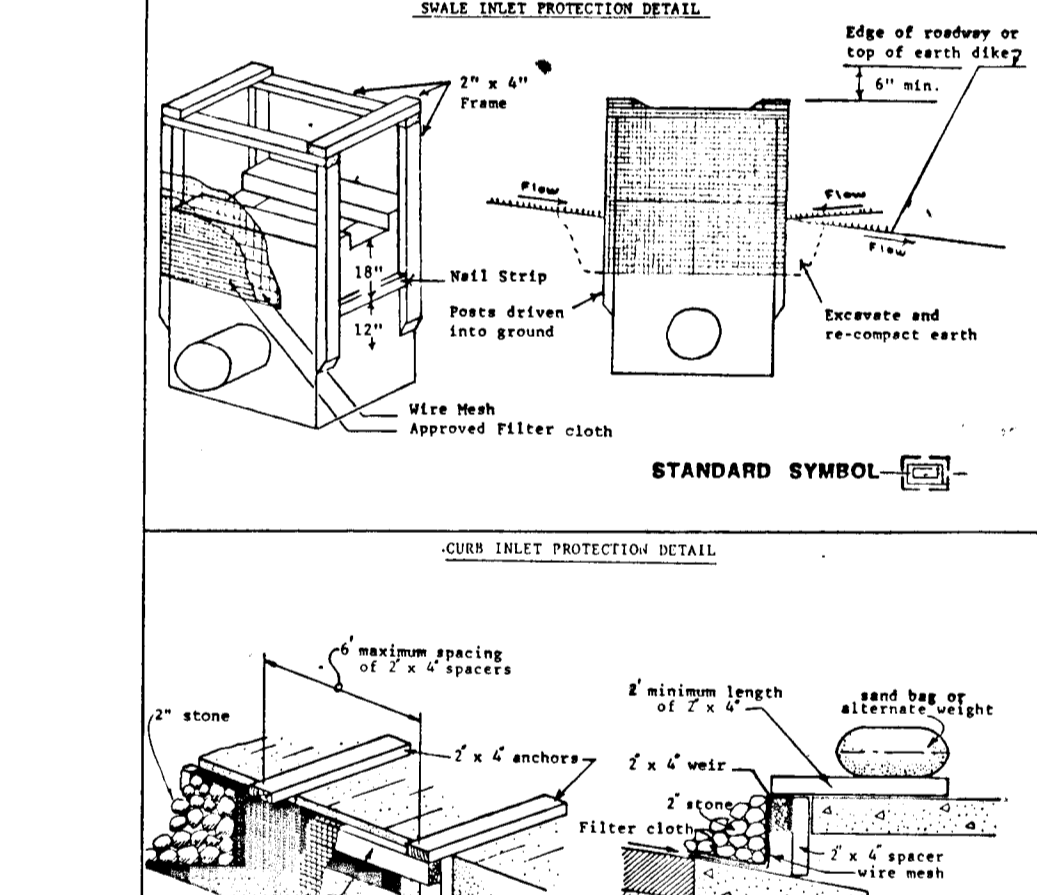
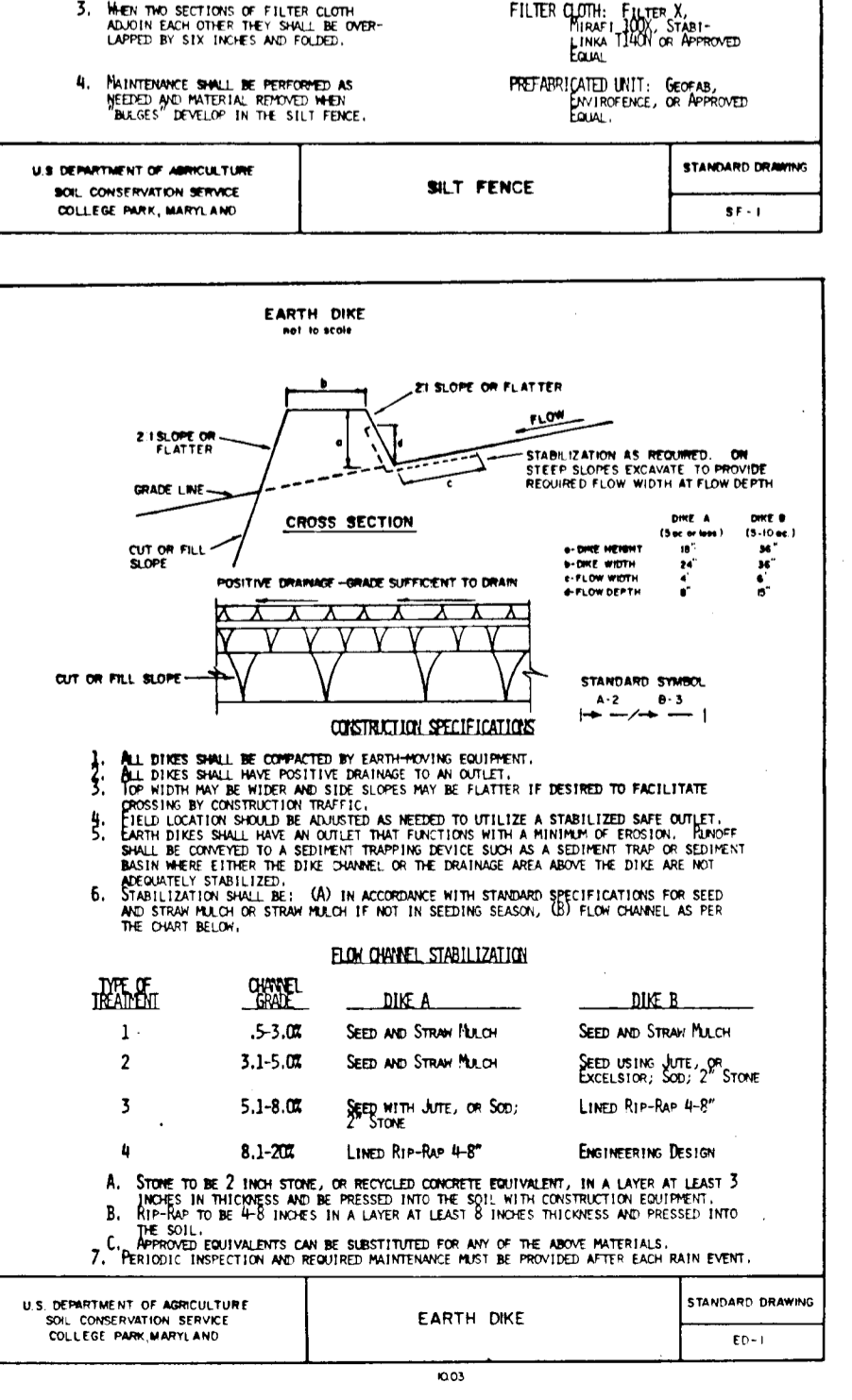
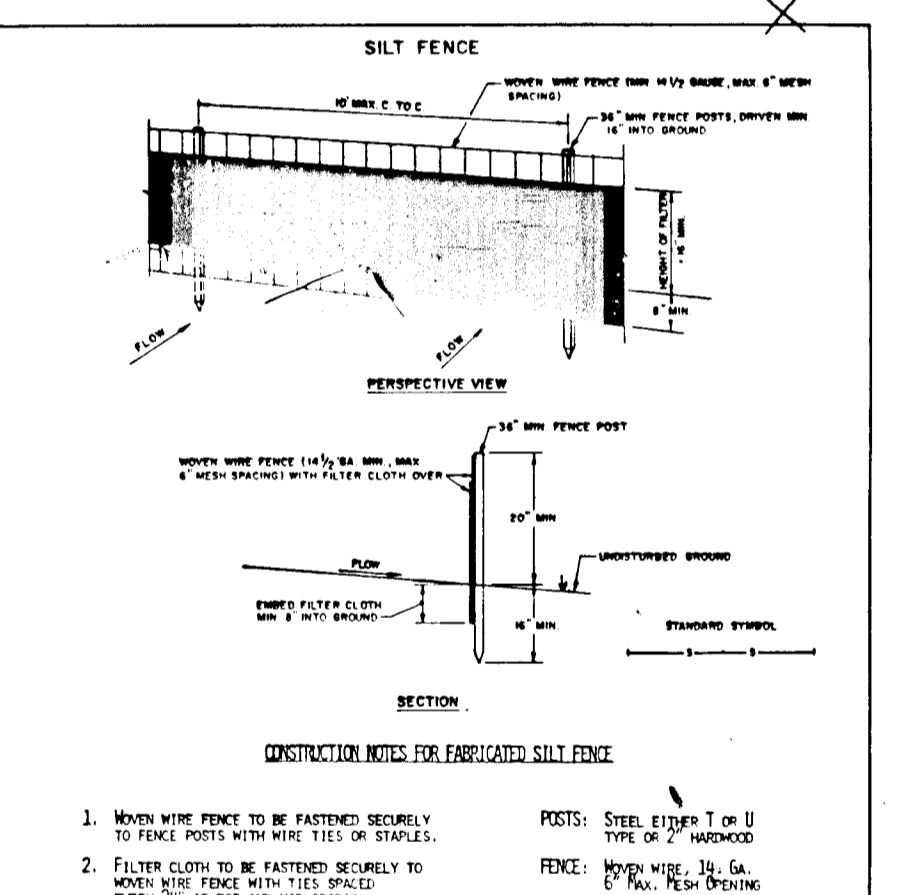
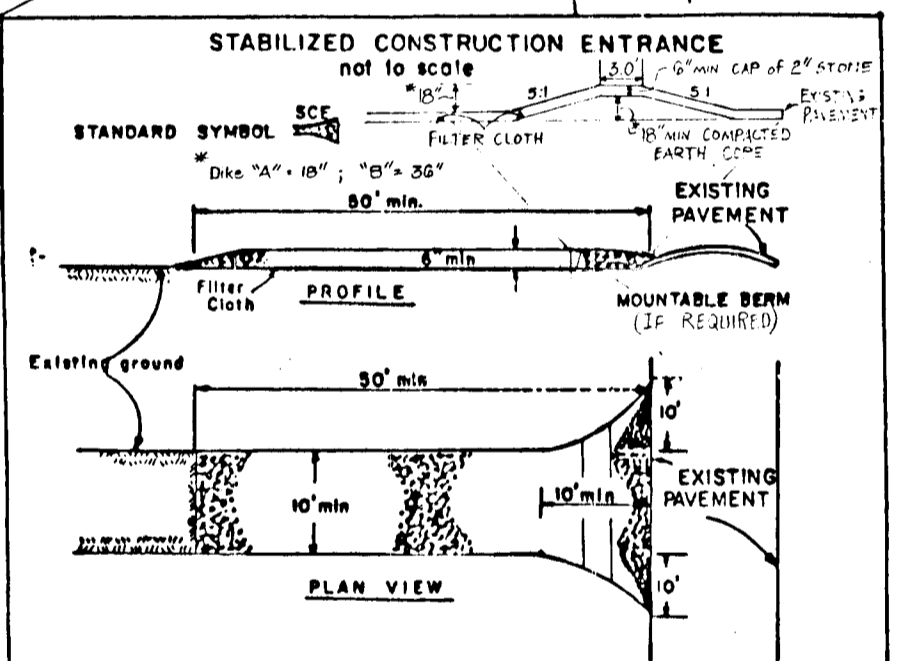

SEQUENCE OF CONSTRUCTION

1. Obtain grading permit.
2. Construct Stabilized Construction Entrance with mountable berm.
3. Construct Stone Outlet Traps and stabilize with temporary seeding.
4. Construct Silt Fences and Earth Dikes. Stabilize Earth Dikes with temporary seeding.
5. Construct Storm Drain Systems as shown on plan. Place Straw Bale Dikes or Silt Fences down-drain of daily construction activities before commencing work.
6. Construct Inlet Protection devices and 6" layer of 2" stone or disturbed areas indicated upstream of inlets.
7. Grade roads, construct paving, and stabilize shoulders, ditch areas and side slopes with permanent seed and mulch. Stabilized Construction Entrance may be removed with approval of Sediment Control Inspector to facilitate paving activities.
8. All sediment shall be removed from sediment traps when cleanout elevations have been reached.
9. Inspect all sediment control devices daily and after each rainfall. Repair as necessary.
10. When all contributing areas to sediment control devices have been permanently stabilized, remove sediment control devices, grade area disturbed, and provide permanent seed and mulch.

Project	Date	By	For
88021-00	8/88	Engineering	KAM
		Illustration	KAM
		LSW/KAM	KAM
		Scale	1" = 50'
		Approval	RMM

Revised	By	Date	Description	Revisions
1	JUL 85	12/7/85	REVISED PER JULY 85 PERM	
2		12/7/85	SUBMITTED TO HOWARD COUNTY	
3		12/03/88	SUBMITTED TO HOWARD COUNTY	

LOTS 1 - 9  
FOXVIEW MANOR SUBDIVISION  
ELECTION DISTRICT NO. 5  
HOWARD COUNTY, MARYLAND  
GRADING & SEDIMENT CONTROL PLAN & DETAILS

MILDENBERG, MOCHI & ASSOCIATES, INC.  
ENGINEERS - ARCHITECTS - SURVEYORS - PLANNERS  
3300 North Ridge Road, Suite 205, Ellicott City, Maryland 21043-1350  
(301) 461-0078



# PERMANENT SEEDING NOTES

Apply to graded or cleared areas not subject to immediate further disturbance where a permanent, long-lived vegetative cover is needed.

**Seedbed Preparation:** Loosen upper three inches of soil by raking, discing, or other acceptable means before seeding, IF NOT PREVIOUSLY LOOSENEED.

**Soil Amendments:** Use on the following schedules:

- 1) Preferred - Apply 2 tons per acre dolomitic limestone (92 lbs./1000 sq.ft.) and 400 lbs. per acre 10-10-10 fertilizer (14 lbs./1000 sq.ft.) before seeding. Narrow or disc into upper three inches of soil. At time of seeding, apply 400 lbs. per acre 30-0-0 ureaform fertilizer (9 lbs./1000 sq.ft.)
- 2) Acceptable - Apply 2 tons per acre dolomitic limestone (92 lbs./1000 sq.ft.) and 1000 lbs. per acre 10-10-10 fertilizer (21 lbs./1000 sq.ft.) before seeding. Narrow or disc into upper three inches of soil.

**Seeding:** For the periods March 1 thru April 30 and August 1 thru October 15, seed with 50 lbs. per acre (1.4 lbs./1000 sq.ft.) of Kentucky 31 Tall Fescue. For the period May 1 thru July 31, seed with 60 lbs. of Kentucky 31 Tall Fescue per acre and 2 lbs per acre (.05 lbs./1000 sq.ft.) of weeping lovegrass. During the period of October 16 thru February 28, protect site by: Option 1 - 7 tons per acre of well-anchored straw mulch, and seed as soon as possible in the spring. Option 2 - Use seed. Option 3 - Seed with 60 lbs. per acre Kentucky 31 Tall Fescue, and mulch with 2 tons per acre well-anchored straw.

**Mulching:** Apply 1 1/2 to 2 tons per acre (70 to 90 lbs./1000 sq.ft.) of unrotted small grain straw immediately after seeding. Anchor mulch immediately after application using mulch anchoring tool or 216 gallons per acre (5 gal./1000 sq.ft.) of emulsified asphalt on flat areas. On slopes 8 feet or higher, use 346 gal. per acre (8 gal./1000 sq.ft.) for an "rings".

**Maintenance:** Inspect all seeded areas, and make needed repairs, replacements, and reseedings.

# TEMPORARY SEEDING NOTES

Apply to graded or cleared areas likely to be redisturbed where a short-term vegetative cover is needed.

**Seedbed Preparation:** Loosen upper three inches of soil by raking, discing, or other acceptable means before seeding, IF NOT PREVIOUSLY LOOSENEED.

**Soil Amendments:** Apply 600 lbs. per acre 10-10-10 fertilizer (14 lbs./1000 sq.ft.)

**Seeding:** For periods March 1 thru April 30 and from August 15 thru November 15, seed with 25 lbs. per acre of annual rye (3.7 lbs./1000 sq.ft.). For the period May 1 thru August 14, seed with 3 lbs. per acre of weeping lovegrass (.07 lbs./1000 sq.ft.). For the period November 16 thru February 28, protect site by applying 2 tons per acre of well-anchored straw mulch, and seed as soon as possible in the spring, or use seed.

**Mulching:** Apply 1 1/2 to 2 tons per acre (70 to 90 lbs./1000 sq.ft.) of unrotted small grain straw immediately after seeding. Anchor mulch immediately after application using mulch anchoring tool or 216 gal. per acre (5 gal./1000 sq.ft.) of emulsified asphalt on flat areas. On slopes 8 feet or higher, use 346 gal. per acre (8 gal./1000 sq.ft.) for anchoring.

Refer to the 1983 MARYLAND STANDARDS AND SPECIFICATIONS FOR SOIL EROSION AND SEDIMENT CONTROL for methods not covered.

By the Developer:

"I, the undersigned, certify that all development and construction will be done according to this plan, and that any responsible personnel involved in the construction project will have a Certificate of Attendance at a Department of Natural Resources Approved Training Program for the Control of Sediment and Erosion before beginning the project. I ALSO AUTHORIZE PERIODIC ON-SITE INSPECTION BY THE HOWARD SOIL CONSERVATION DISTRICT."

Signature of Developer: Michael D. Carroll  
Date: 11-27-87

By the Engineer:

"I certify that this plan for erosion and sediment control represents a practical and workable plan based on my personal knowledge of the site conditions and that it was prepared in accordance with the requirements of the Howard Soil Conservation District."

Signature of Engineer: John J. Schindler  
Date: 1/24/88

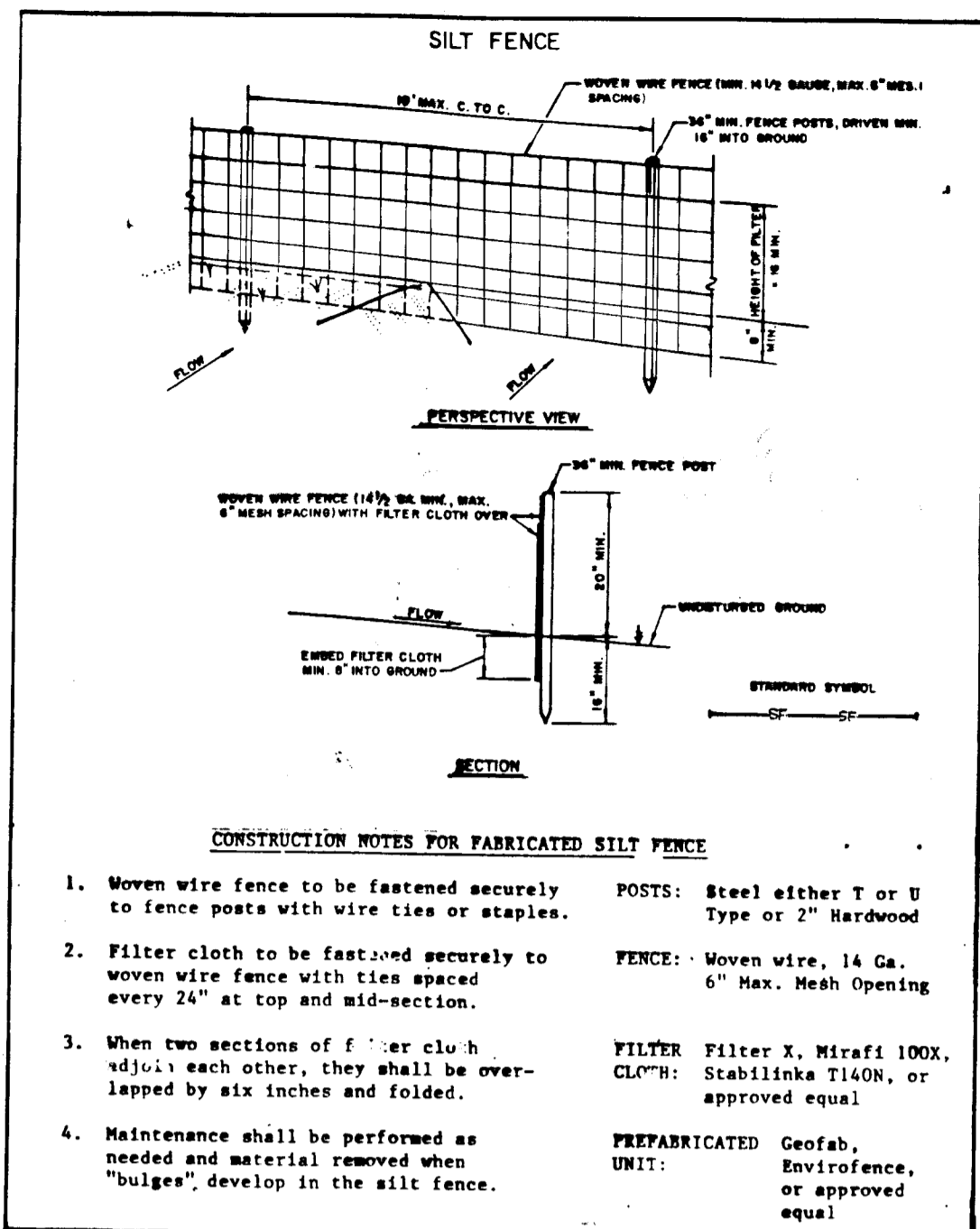

### CONSTRUCTION NOTES FOR FABRICATED SILT FENCE

1. Woven wire fence to be fastened securely to fence posts with wire ties or staples.
  2. Filter cloth to be fastened securely to woven wire fence with ties spaced every 24" at top and mid-section.
  3. When two sections of filter cloth adjoin each other, they shall be overlapped by six inches and folded.
  4. Maintenance shall be performed as needed and material removed when "bulges" develop in the silt fence.
- POSTS: Steel either T or U Type or 2" Hardwood  
FENCE: Woven wire, 14 Ga. 6" Max. Mesh Opening  
FILTER: Filter X, Mirafix 100X, Cloths: Stabliska T140N, or approved equal  
PREPARED: Geofab, Envirofence, or approved equal

# SILT FENCE DETAIL

# SEDIMENT CONTROL NOTES

1. A minimum of 24 hours notice must be given to the Howard County Office of Inspection and Permits prior to the start of any construction (1983-24337).
2. All vegetative and structural practices are to be installed according to the provisions of this plan and are to be in conformance with the 1983 MARYLAND STANDARDS AND SPECIFICATIONS FOR SOIL EROSION AND SEDIMENT CONTROL.
3. Following initial soil disturbance or redistribution, permanent or temporary stabilization shall be completed within: (a) 7 calendar days for all perimeter sediment control structures, dikes, perimeter slopes, and all slopes greater than 3:1; (b) 14 days as to all other disturbed or graded areas on the project site.
4. All sediment traps/basins shown must be fenced and warning signs posted around their perimeter in accordance with Vol. 1 Chapter 12, of the HOWARD COUNTY SIGN MANUAL, Storm.
5. All disturbed areas must be stabilized within the time period specified above in accordance with the 1983 MARYLAND STANDARDS AND SPECIFICATIONS FOR SOIL EROSION AND SEDIMENT CONTROL for permanent seeding (Sec. 51), and (Sec. 56), temporary seeding (Sec. 50), and mulching (Sec. 52). Temporary stabilization with mulch along can only be done when recommended seeding dates do not allow proper germination and establishment of grasses.
6. All sediment control structures are to remain in place and are to be maintained in operative condition until permission for their removal has been obtained from the Howard County Sediment Control Inspector.
7. Site Analysis:
 

Total area of site	0.24 acres
Area disturbed	0.23 acres
Area to be roofed or paved	0.06 acres
Area to be vegetatively stabilized	0.18 acres
Total cut	0.18 cu.yds.
Total fill	481.0 cu.yds.
Office waste/borrow area location	TO BE DETERMINED
8. Any sediment control practice which is disturbed by grading activity for placement of utilities must be repaired on the same day of disturbance.
9. Additional sediment controls must be provided, if deemed necessary by the Howard County DPM Sediment Control Inspector.
10. On all sites with disturbed areas in excess of 2 acres, approval of the inspection agency shall be requested upon completion of installation of perimeter erosion and sediment controls, but before proceeding with any other earth disturbance or grading. Other building or grading inspection approvals may not be authorized until this initial approval by the inspection agency is made.
11. On all sites with disturbed areas in excess of 2 acres, approval of the inspection agency shall be requested upon completion of installation of perimeter erosion and sediment controls, but before proceeding with any other earth disturbance or grading. Other building or grading inspection approvals may not be authorized until this initial approval by the inspection agency is made.

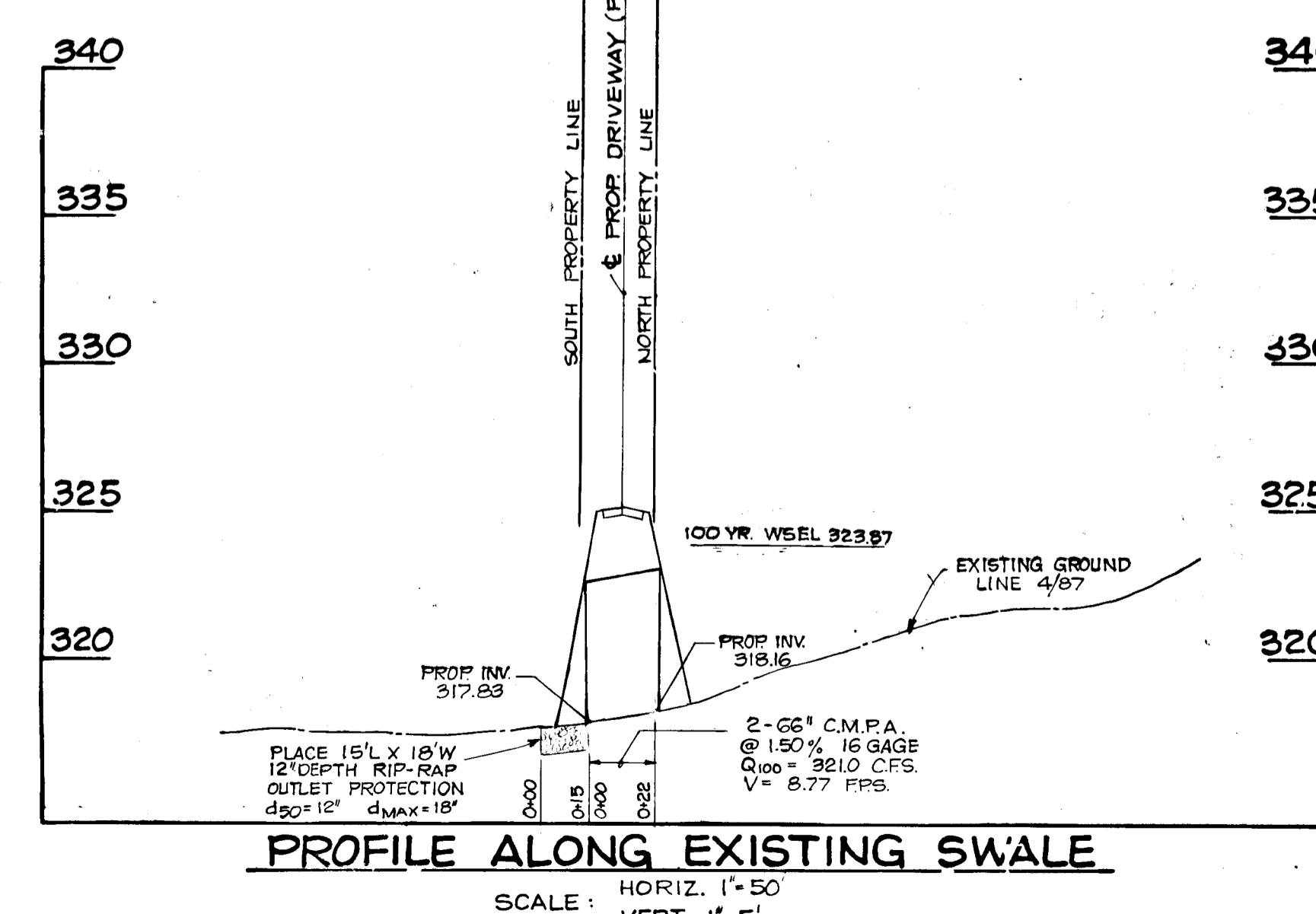
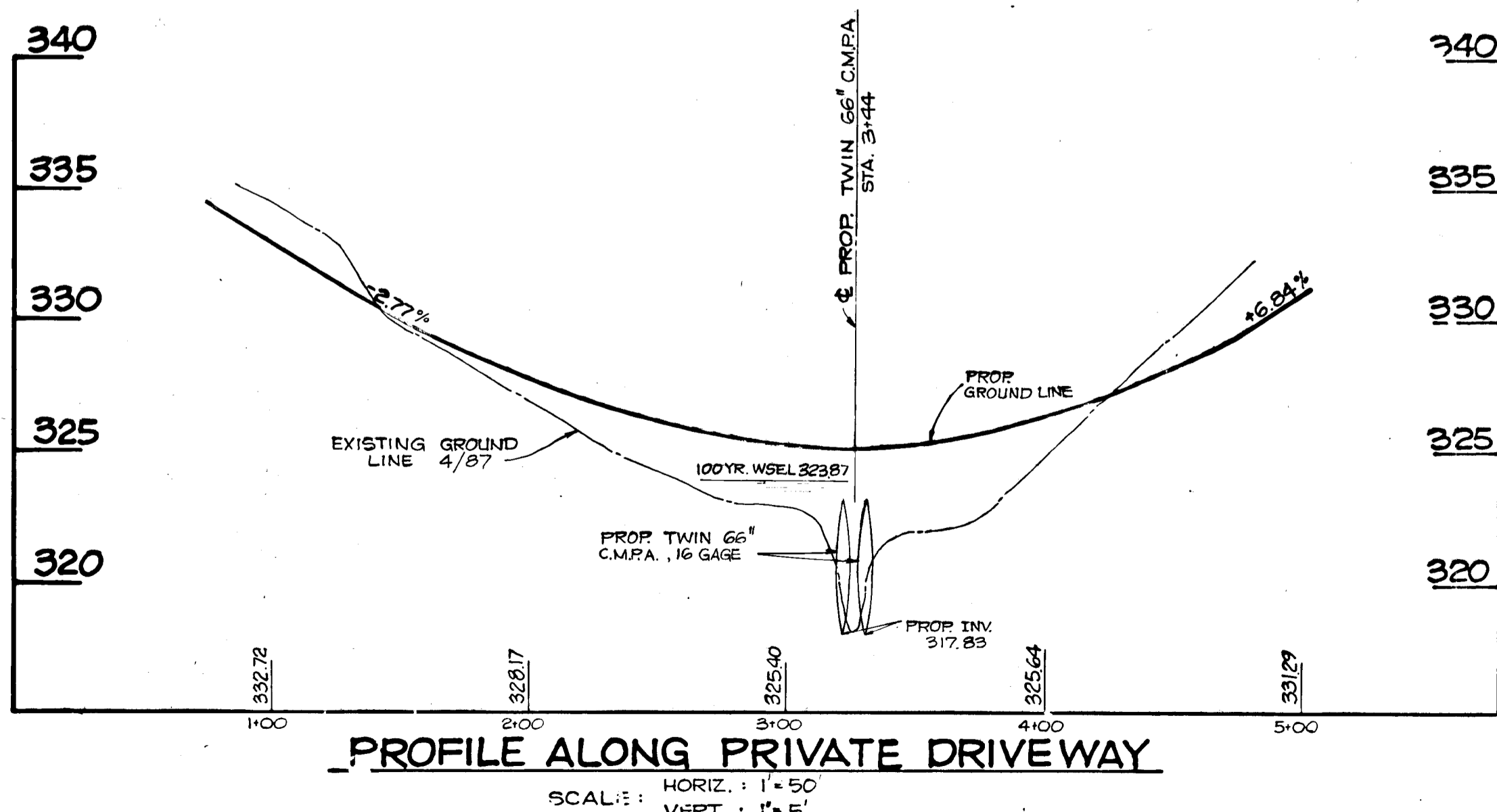

STA. 3+44  
CONSTRUCT TWIN 66" C.M.P.A. 22LF IN EXISTING STREAM CHANNEL PLACE 12" MEDIUM RIP-RAP (UNGRROUTED) SHA. SPECS. SEC. 818 12" DEPTH X 18" WIDTH X 15' LENGTH AT OUTLET CHANNEL PLACE FILTER FABRIC - POLY FILTER X OR APPROVED EQUAL UNDER ENTIRE RIP-RAP SECTION.

RIVERS CORPORATE PARK SECTION 1 AREA 2 OPEN SPACE - LOT 1 PLAT 6017

PLAN SCALE: 1"=50'

CONTRACTOR TO TAKE EXTREME CAUTION TO PROTECT SURROUNDING BEDDING CONDITIONS. BACKFILL MATERIAL TO MEET SHA. TYPE 3 BORROW SPECIFICATIONS OR EQUIVALENT.

NOTE: DISTURBED AREA LESS THAN 5000 SQ. FT. IN THE EVENT DURING THE DEVELOPMENT OF LOT 1 DISTURBANCE WILL EXCEED 5000 SQ. FT. STORM WATER MANAGEMENT WILL BE REQUIRED.

THIS DEVELOPMENT PLAN IS APPROVED FOR SOIL EROSION AND SEDIMENT CONTROL BY THE HOWARD SOIL CONSERVATION DISTRICT.

Reviewed for HOWARD S.C.D. and meets Technical Requirements.

U.S. Soil Conservation Service

Signature of Howard S.C.D. representative

Date: 2-4-88

# SEQUENCE OF CONSTRUCTION

1. OBTAIN THE REQUIRED GRADING PERMIT. 0.5 DAYS
2. INSTALL SEDIMENT CONTROL MEASURES IN ACCORDANCE WITH APPROVED PLAN. 1 DAY
3. CLEAR SITE AS NECESSARY AND ROUGH GRADE ROAD. 1 DAY
4. INSTALL STORM DRAIN AND RELATED FACILITIES; FINE GRADE AND SURFACE ROAD. 3 DAYS
5. VEGETATIVELY STABILIZE ALL DISTURBED AREAS. 2 DAYS
6. AFTER APPROVAL FROM THE INSPECTOR, REMOVE ALL SEDIMENT CONTROL MEASURES AND STABILIZE AREAS AS REQUIRED. 0.5 DAYS

DESIGN DATA				
AREA	ACRES	C	100	Q100
A	20.41	0.84		126 c.f.s.
B	45.50	0.84		195 c.f.s.

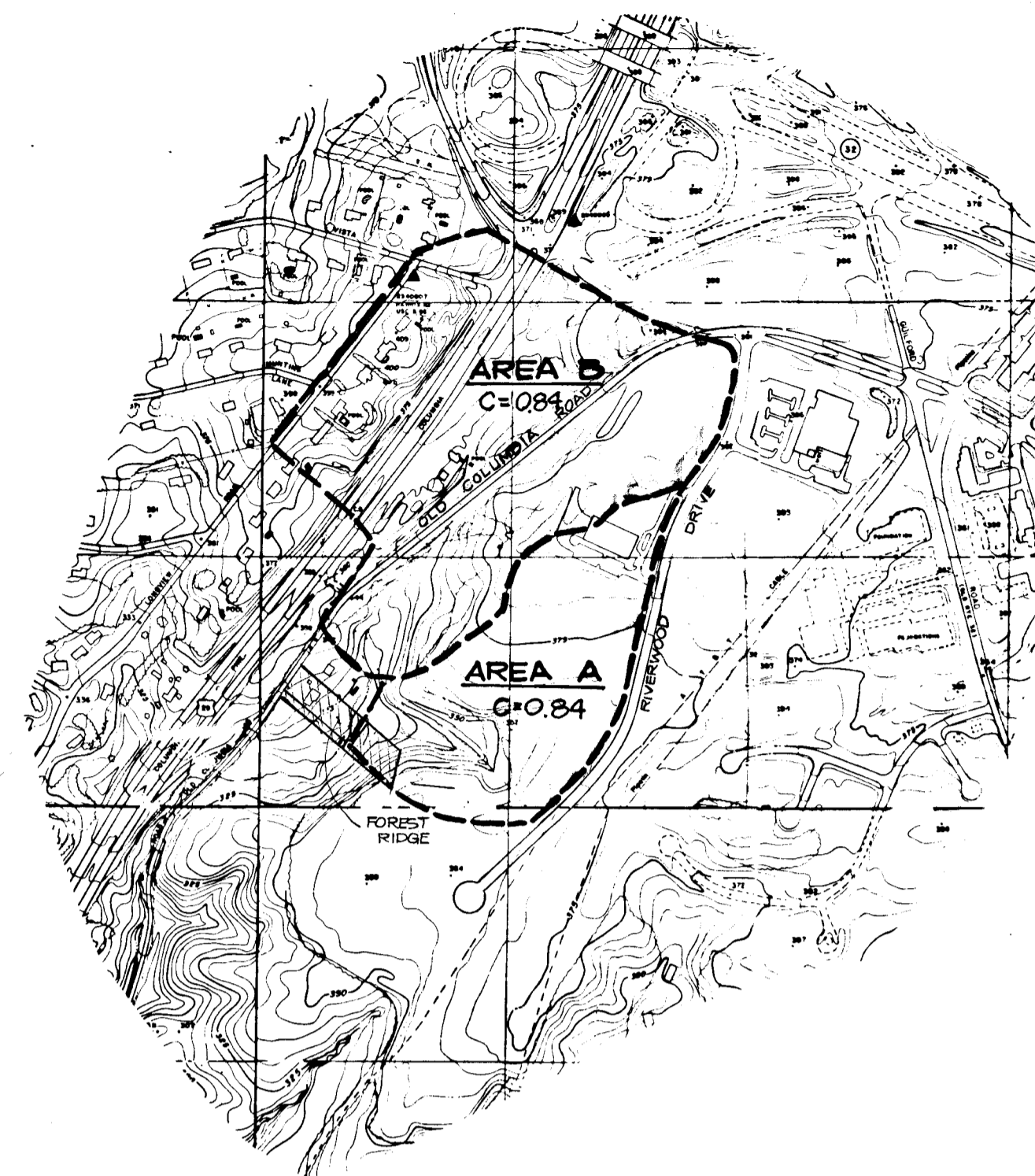

# DRAINAGE AREA MAP

SCALE: 1"=600'

# OUTLET CHANNEL

NOT TO SCALE

# BENCHMARK

BM # MM 24 ELEV. 350.96  
RR SPIKE IN BASE OF POWER POLE  
C&P #1, B&E #387093, APPROX. AT  
STA. 13+60, 20' ± RIGHT OF BASELINE.

APPROVED: HOWARD COUNTY DEPARTMENT OF PUBLIC WORKS

Signature: William H. ... DATE: 2/17/88  
CHIEF, LAND DEVELOPMENT DIVISION  
Signature: Granville W. ... DATE: 3/8/88  
CHIEF, BUREAU OF HIGHWAYS  
Signature: ... DATE: 3-8-88  
CHIEF, BUREAU OF ENGINEERING

APPROVED: OFFICE OF PLANNING AND ZONING

Signature: ... DATE: 3/11/88  
CHIEF, DIVISION OF COMMUNITY PLANNING AND LAND DEVELOPMENT

OWNER: RICHARD I THOMAS  
7089 OLD COLUMBIA RD.  
COLUMBIA, MD. 21044  
TELEPHONE: 301-531-5984

ENGINEER: HUDKINS ASSOCIATES INC.  
SUITE 231, HARPERS CHOICE VIL. CTR.  
COLUMBIA, MD. 21044  
TELEPHONE: 301-730-9060

# FOREST RIDGE CULVERT CROSSING PRIVATE DRIVEWAY LOT 1

PARCEL 311 TAX MAP #1 ZONED R 20  
6TH ELECTION DISTRICT HOWARD COUNTY, MD.  
OCTOBER 26, 1987 SCALE: AS SHOWN