

SHEET INDEX	
SHEET NO.	DESCRIPTION
1 OF 5	TITLE SHEET
2 OF 5	ROAD PLAN & PROFILE, WILD WING WAY, WOOD STAFF WAY
3 OF 5	DRAINAGE AREA MAP, DETAILS, STORM DRAIN PROFILES
4 OF 5	SEDIMENT CONTROL PLAN
5 OF 5	SEDIMENT CONTROL DETAILS

COLUMBIA

HOWARD COUNTY, MARYLAND

6 ELECTION DISTRICT

VILLAGE OF LONGREACH SEC. 1 AREA 11

ROAD CONSTRUCTION PLANS

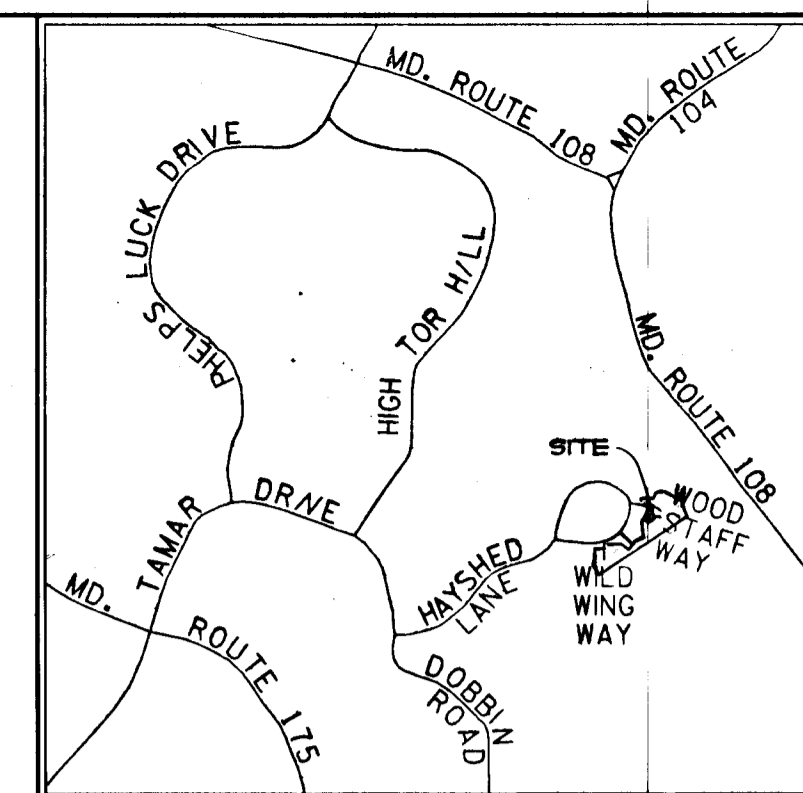

VICINITY MAP
SCALE: 1"=2000'

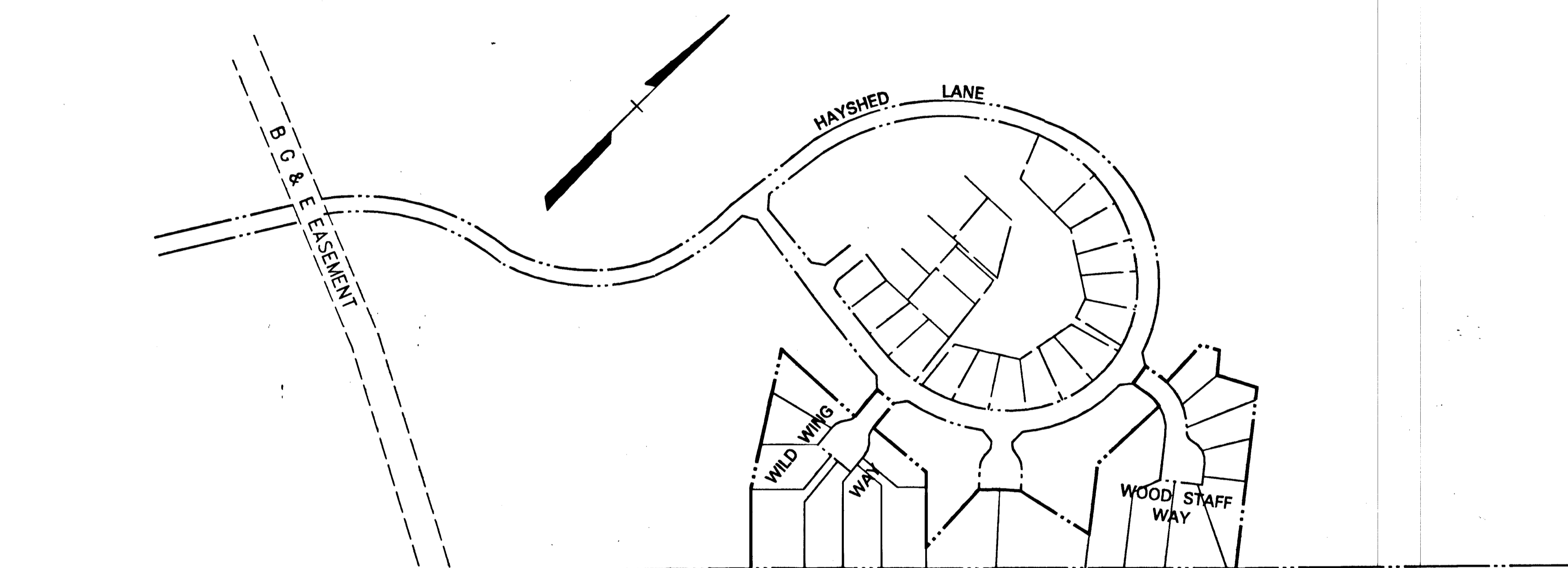

SUSQUEHANNA TRANSMISSION R/W

KEY PLAN

SCALE: 1" = 200'

AS-BUILT

G. Scott Shanabegger
G. SCOTT SHANABEGGER
PROFESSIONAL L.S.# 10847

[Signature]
DATE



SHANABEGGER & LANE
8726 TOWN & COUNTRY BLVD.
SUITE 107
ELLCOTT CITY, MARYLAND 21043

APPROVED HOWARD COUNTY DEPT. OF PUBLIC WORKS

[Signature] 10/25/88
CHIEF, BUREAU OF HIGHWAYS DATE

[Signature] 10/26/88
CHIEF, BUREAU OF ENGINEERING DATE

[Signature] 10/26/88
CHIEF, LAND DEVELOPMENT DIVISION DATE

OFFICE OF PLANNING AND ZONING

[Signature] 11-2-88
CHIEF DIV. OF COMM. PLANNING AND LAND DEVEL. DATE

Date	No.	Revision Description

COLUMBIA, MD.
6TH ELECTION DISTRICT
HOWARD COUNTY, MARYLAND

OWNER /DEVELOPER
THE HOWARD RESEARCH
AND DEVELOPMENT LAND COMPANY

DAFT McCUNE WALKER, INC.
LAND PLANNING CONSULTANTS
LANDSCAPE ARCHITECTS
ENGINEERS SURVEYORS
200 EAST PENNSYLVANIA AVENUE
TOWSON, MD. 21284
TELEPHONE: 301-296-3333

AREA VILLAGE OF LONGREACH
SECTION 1 AREA 11
6TH ELECTION DISTRICT HOWARD CO., MARYLAND

TITLE SHEET

Des By J.D.C	Scale	Proj. No. 88014
Drn By D.M.A	Date	1 OF 5
Chk By J.W.R	Approved	

4-22-88
Date

[Signature]
Professional Engr. No. 10551



100

HAYSHED ROAD

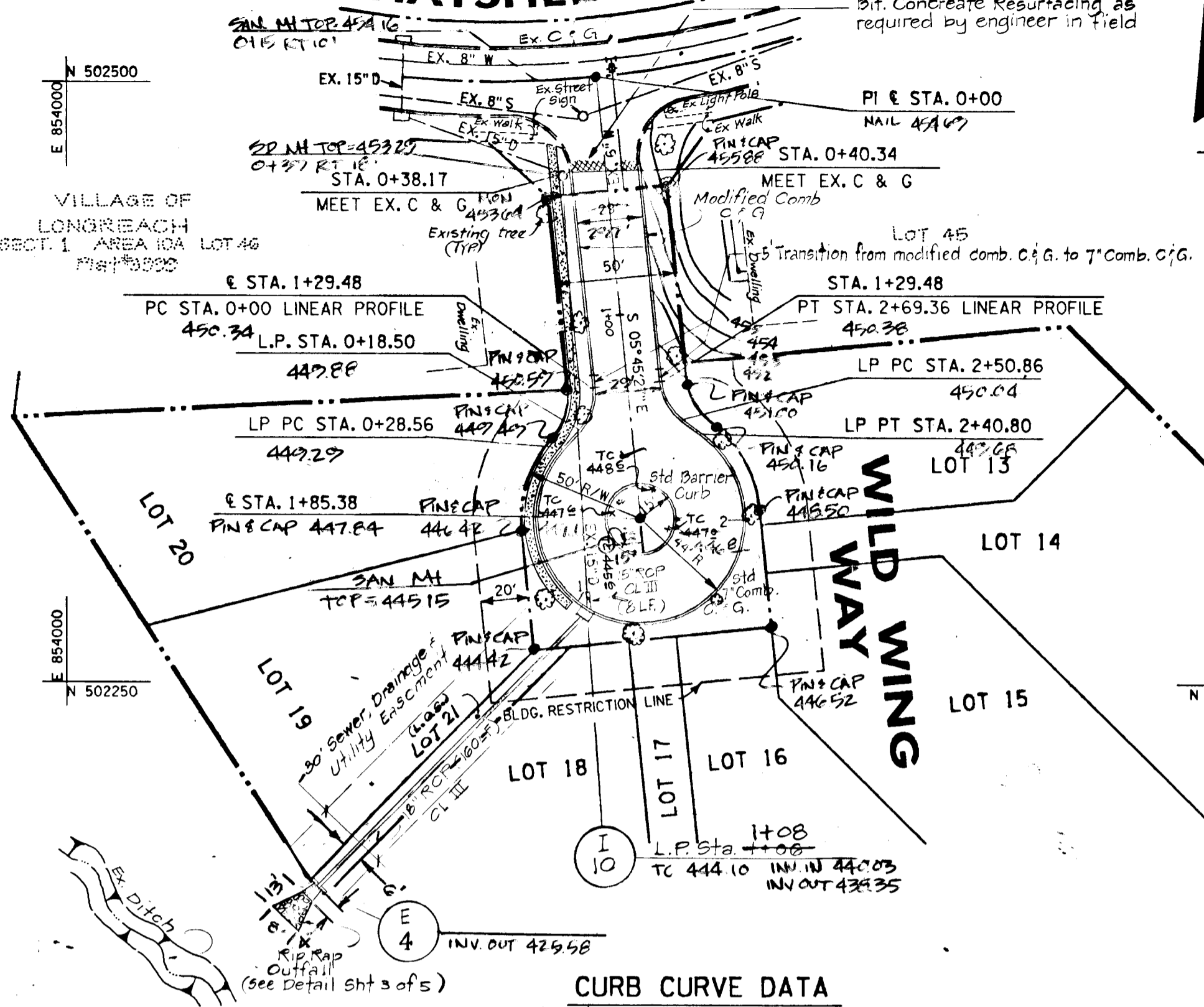

STRUCTURE SCHEDULE

Structure Number	Type	Inv. In	Inv. Out	Top Elev	Remarks
I-10	A-5	427.50	427.50	444.10	Std Detail 4.01
E-4	SHALLOW CONC. EXP. SECTION	427.50	427.50	444.10	Std -- 3.51
M-1	SHALLOW CONC. EXP. SECTION	427.50	427.50	444.10	Std -- 5.05
E-6A	SHALLOW CONC. EXP. SECTION	427.50	427.50	444.10	Std -- 5.51

Note: The location, type and number of trees shown on this plan are the minimum required and are used for bond purposes only. The final location and variety of trees may vary to accommodate field condition and builders' landscape program. Bond release is contingent upon Sect. 16.131 of the Howard County Subdivision and Land Development Regulations as approved by Office of Planning and Zoning.

* Note: Existing right curb return to be removed as necessary to achieve smooth tie to existing C.G. Existing handicap ramp to be rebuilt if required.

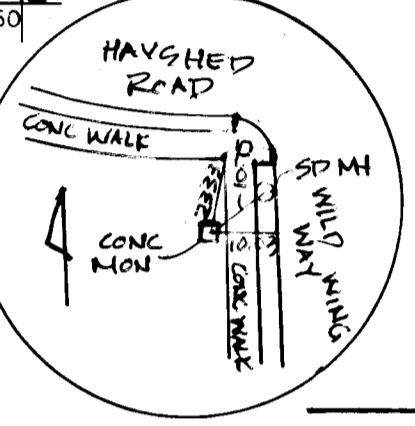

CURB CURVE DATA

LP STA. 0+00 TO LP STA. 0+18.50	LP STA. 0+28.56 TO LP STA. 2+40.80	LP STA. 2+50.86 TO LP STA. 2+69.36
Δ = 48°11'23"	Δ = 27°22'46"	Δ = 48°11'23"
R = 22.00'	R = 44.00'	R = 22.00'
L = 18.50'	L = 212.24'	L = 18.50'
T = 9.84'	T = 39.36'	T = 9.84'
CHD. = S 18°20'14" W 17.96'	CHD. = N 84°14'33" E 58.67'	CHD. = N 29°51'09" W 17.96'

LP PRC STA. 0+00 TO LP PT STA. 0+08.47	LP PC STA. 0+19.83 TO LP PRC STA. 0+58.30	LP PRC STA. 0+58.30 TO LP PT STA. 2+59.16	LP PC STA. 2+65.52 TO LP PT STA. 2+99.23
Δ = 04°23'26"	Δ = 11°01'15"	Δ = 261°32'59"	Δ = 57°04'14"
R = 110.50'	R = 200.00'	R = 44.00'	R = 139.50'
L = 8.47'	L = 38.47'	L = 200.86'	L = 138.95'
T = 4.24'	T = 19.29'	L = 44.00'	L = 138.95'
CHD. = S 40°41'08" E 8.47'	CHD. = S 32°58'47" E 38.41'	CHD. = N 21°45'21" E 66.64'	CHD. = N 71°24'58" W 133.28'

€ CURVE DATA

Δ = 61°27'40"
R = 125.00'
L = 134.09'
T = 14.31'
CHD. = S 69°13'15" E 127.75'

General Notes

- All work shall be performed in accordance with the Howard County Design Manual, Volumes I, II & IV.
- Approximate location of existing utilities are shown. The completeness or accuracy of such is not guaranteed. The contractor shall take all necessary precautions to protect the existing utilities and maintain uninterrupted service.
- The contractor shall test pit existing utilities, where directed by the engineer, a minimum of two weeks in advance of construction operations.

AS BUILT



Bench Marks

- B.M. #2643005 - Elev. 438.059
Description: Located on transmission lines 100' S.W. of D.G. & E. Tower #12 & 12E which are second pair of D.G. & E. Towers S.W. of Rte. #108
- B.M. #2643006 - Elev. 437.401
Description: Located on transmission lines 782' N.E. of Dabbin Road on a rise between D.G. & E. Tower #M & ME, Near supply yard.

Note: Contractor to meet existing A-5 Inlet for line and grade.

4-22-88 Date

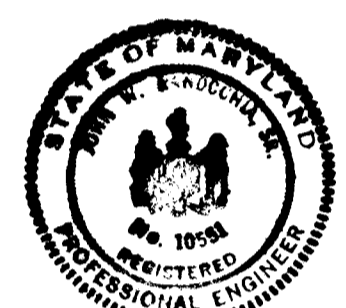

SEE VICINITY MAP SHEET 2 OF 3

APPROVED HOWARD COUNTY DEPT. OF PUBLIC WORKS
Lawrence W. Weiland 1/25/88 DATE
 CHIEF, BUREAU OF HIGHWAYS
W. C. ... 10-26-88 DATE
 CHIEF, BUREAU OF ENGINEERING
Paul J. ... 10/24/89 DATE
 CHIEF, LAND DEVELOPMENT DIVISION

OFFICE OF PLANNING AND ZONING
Marsha J. ... 11-3-88 DATE
 CHIEF DIV. OF COMM. PLANNING AND LAND DEVEL.

Date	No.	Revision Description

COLUMBIA, MD.
 6TH ELECTION DISTRICT
 HOWARD COUNTY, MARYLAND

OWNER /DEVELOPER
 THE HOWARD RESEARCH
 AND DEVELOPMENT LAND COMPANY



DAFT McCUNE WALKER, INC.
 LAND PLANNING CONSULTANTS
 LANDSCAPE ARCHITECTS
 ENGINEERS - SURVEYORS
 200 EAST PENNSYLVANIA AVENUE
 TOWSON, MD. 21284
 TELEPHONE: 301-296-3333

AREA VILLAGE OF LONGREACH
 SECTION 1 AREA 11
 6TH ELECTION DISTRICT HOWARD CO., MARYLAND

TITLE ROAD PLAN AND PROFILE
 WILD WING WAY WOOD STAFF WAY

Des By J.D.C Scale 1" = 50' Proj. No. 88014
 Drn By D.M.A Date 4-22-88
 Chk By J.W.R Approved 2 OF 5

WILD WING WAY

WOOD STAFF WAY

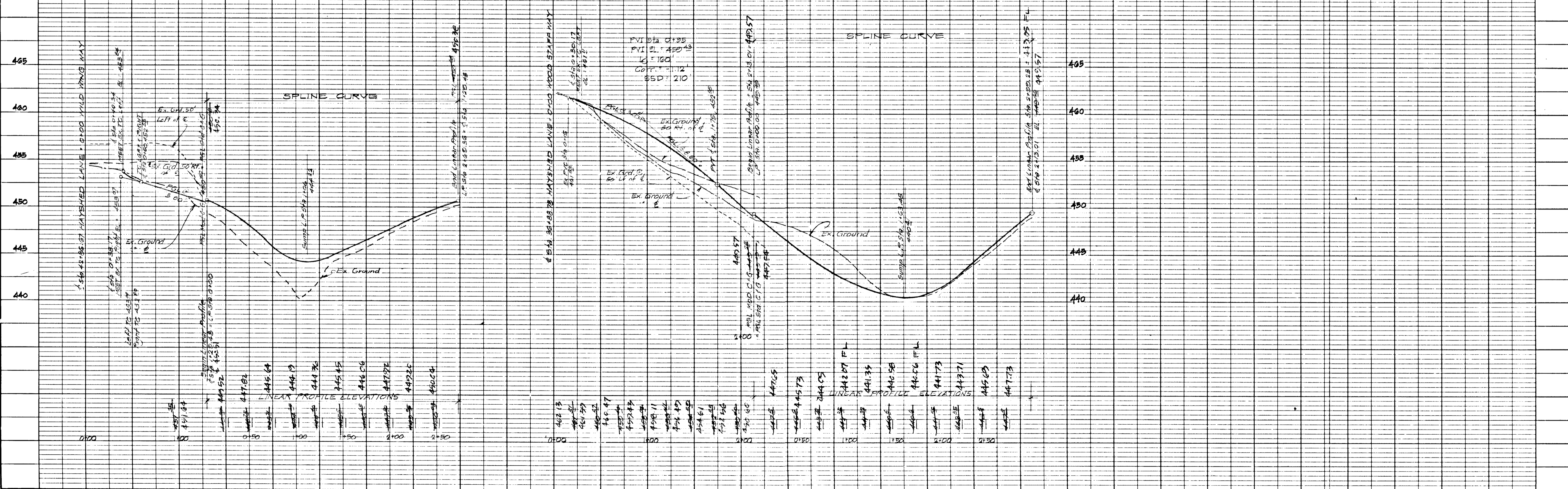

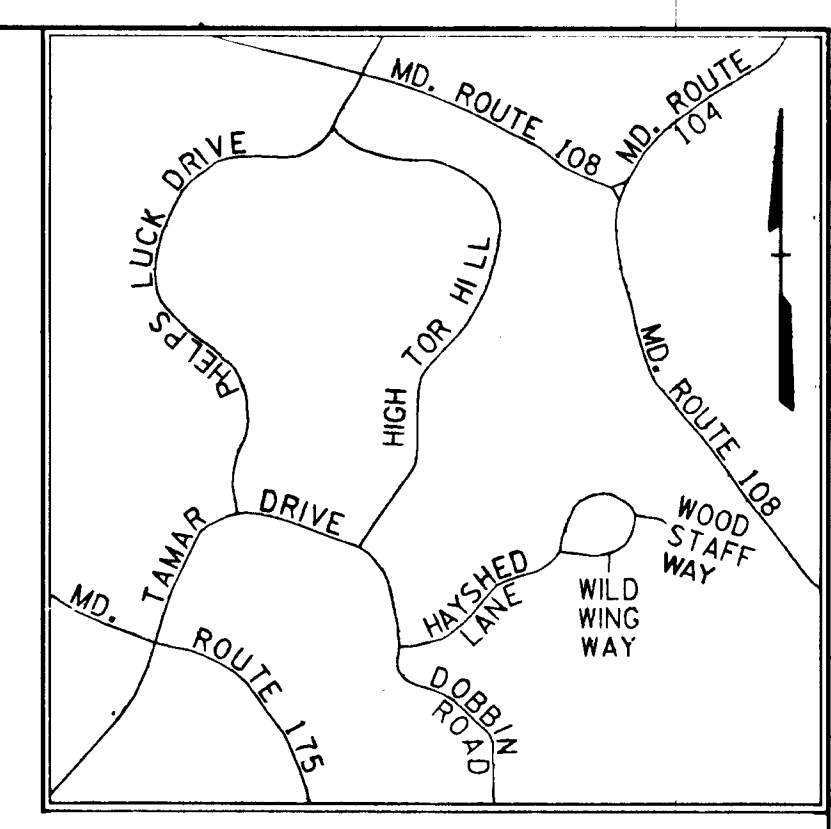
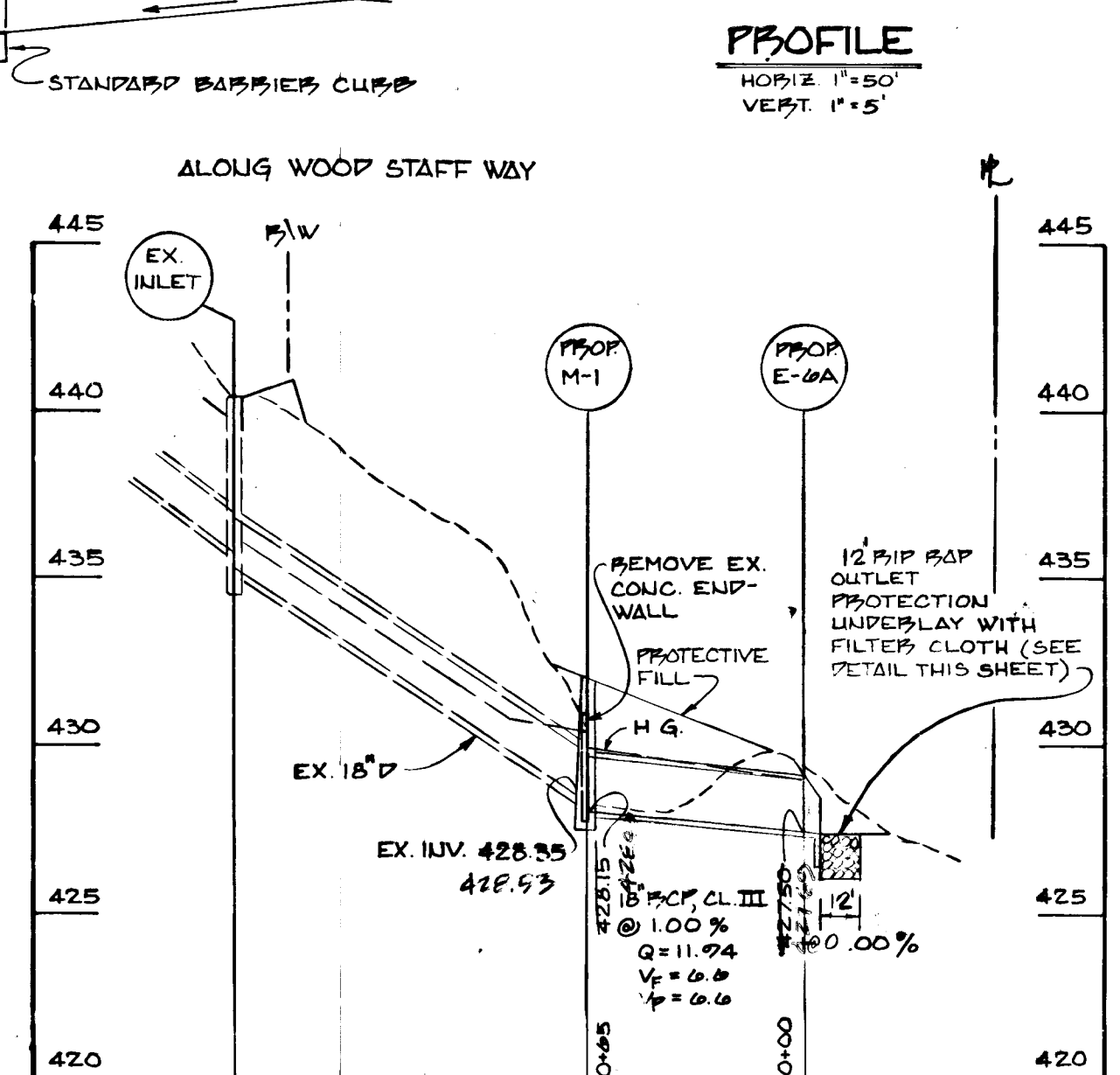
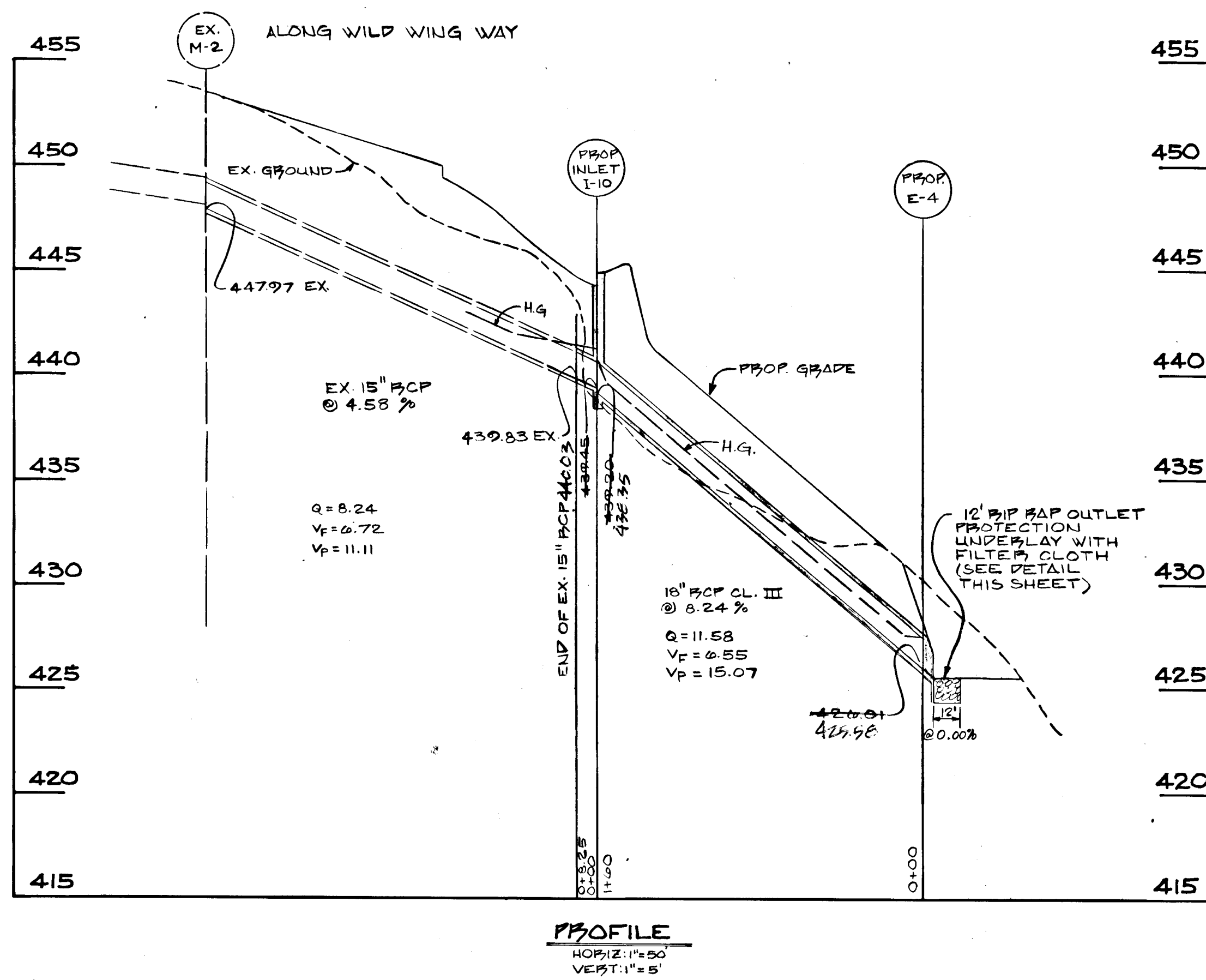
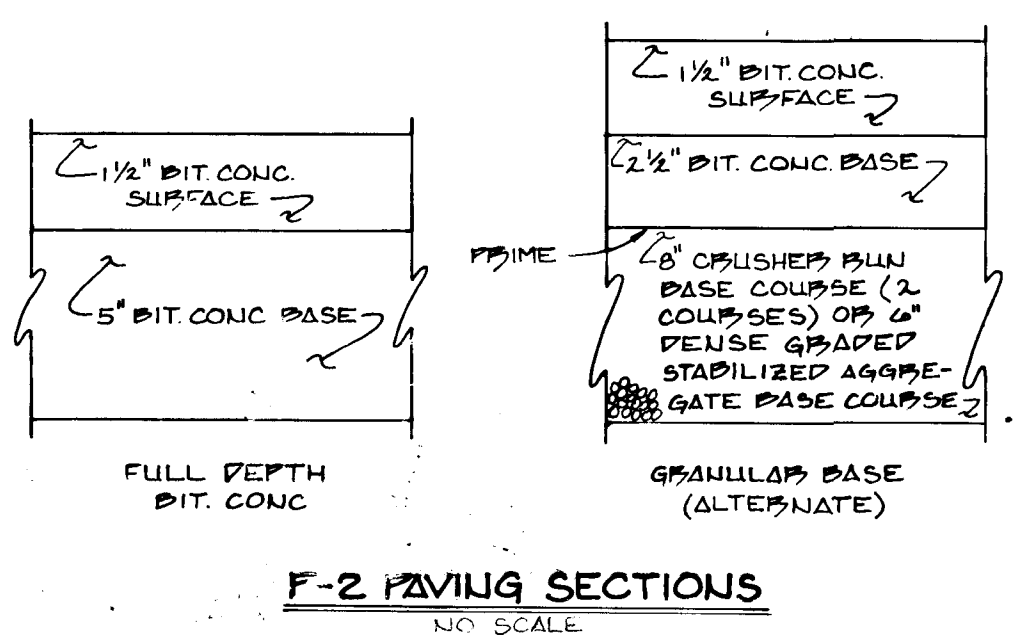
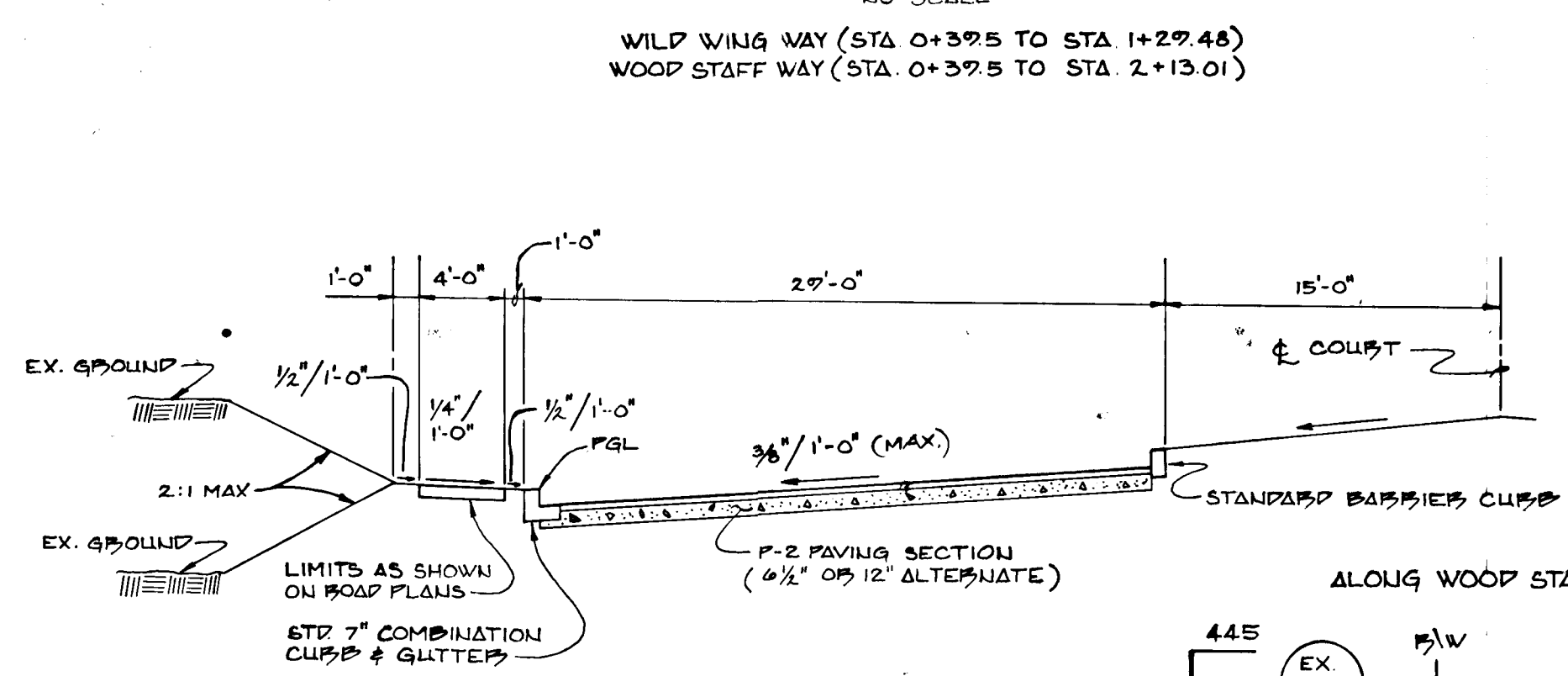
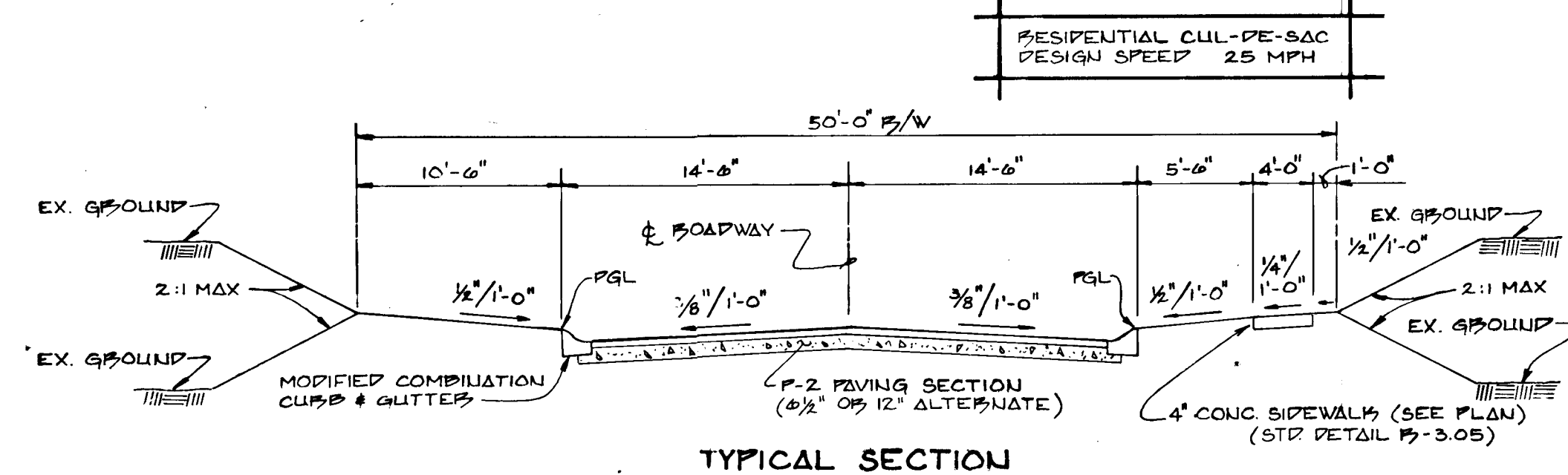
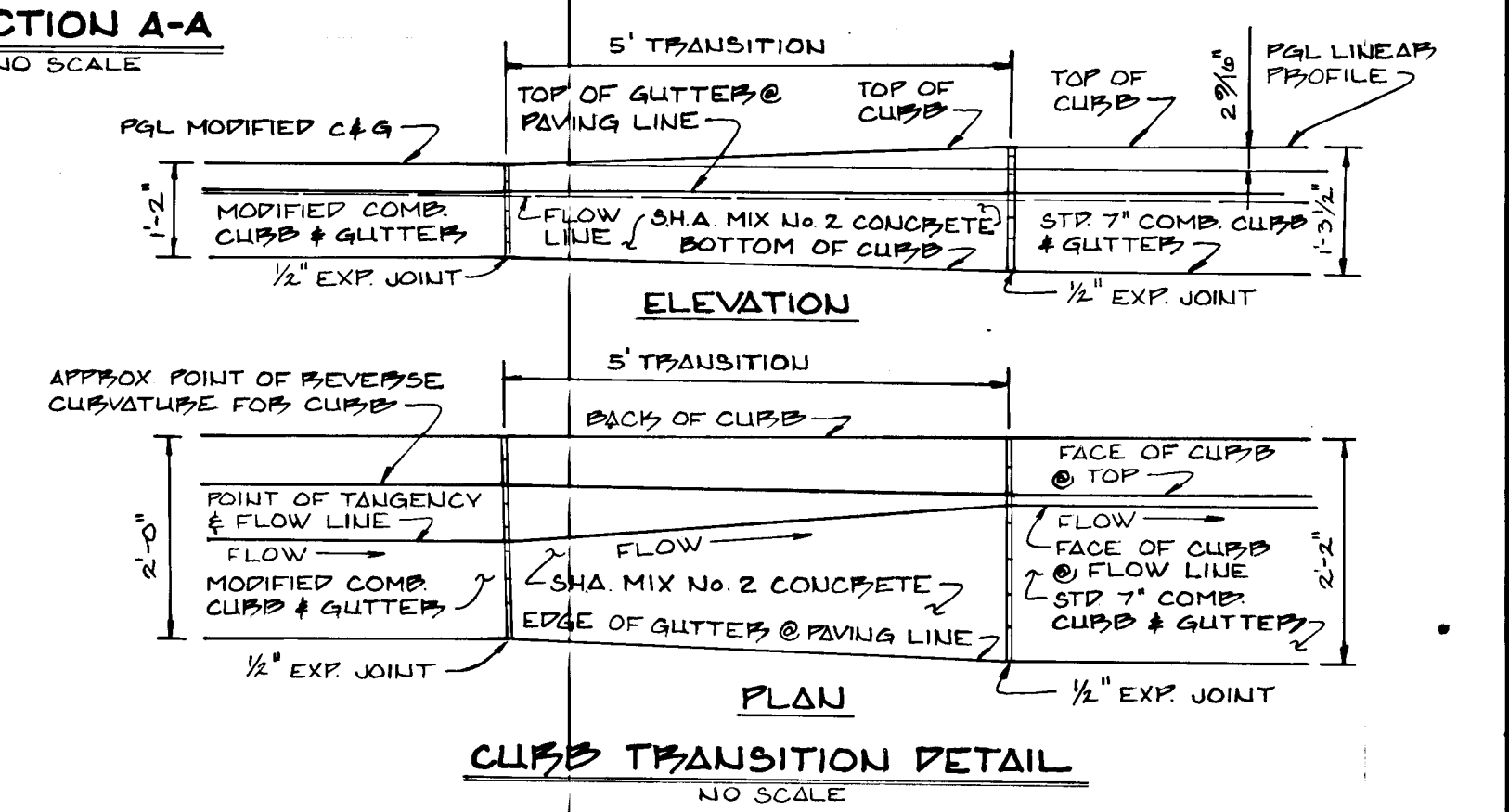
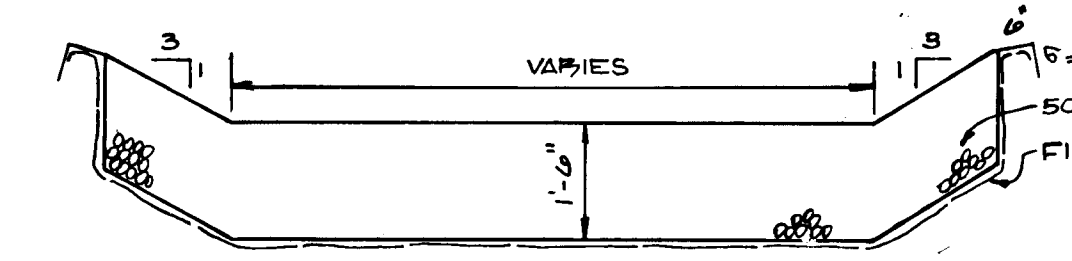
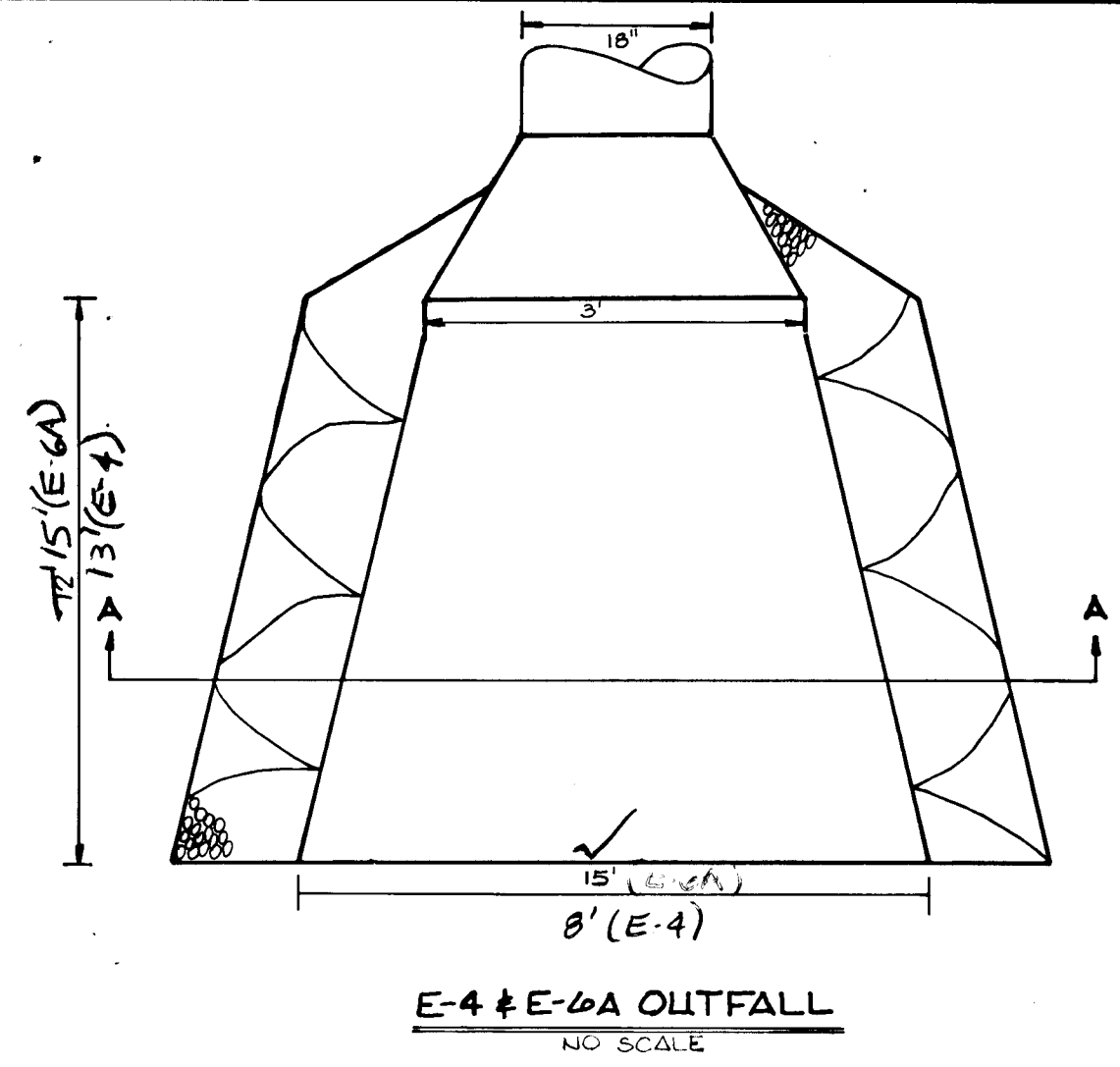
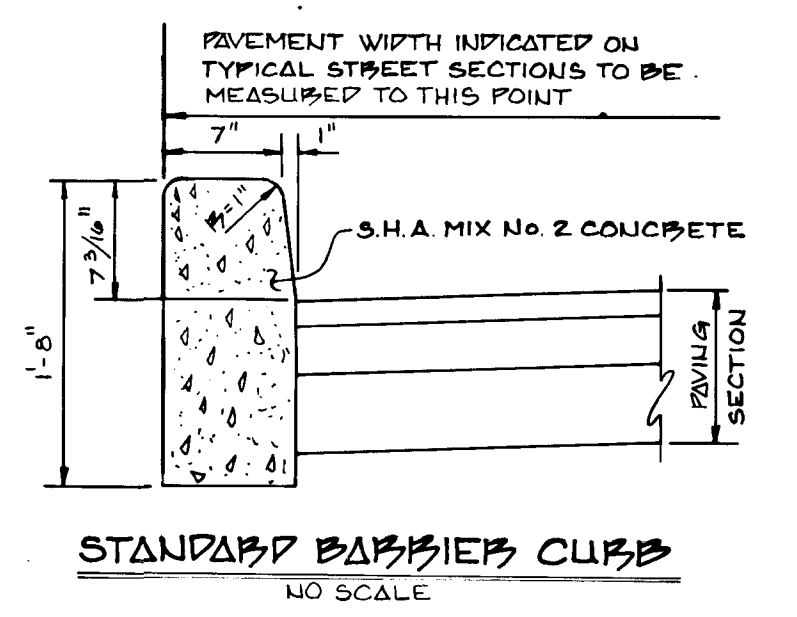
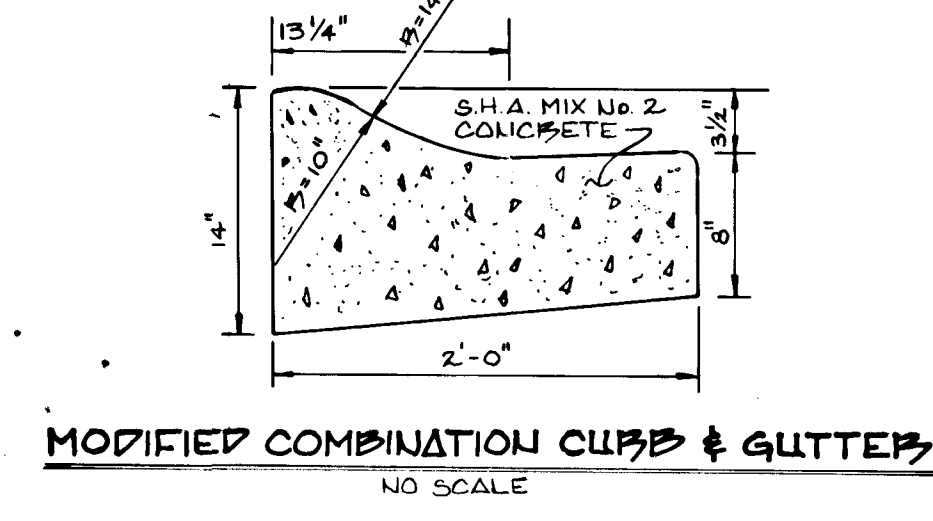
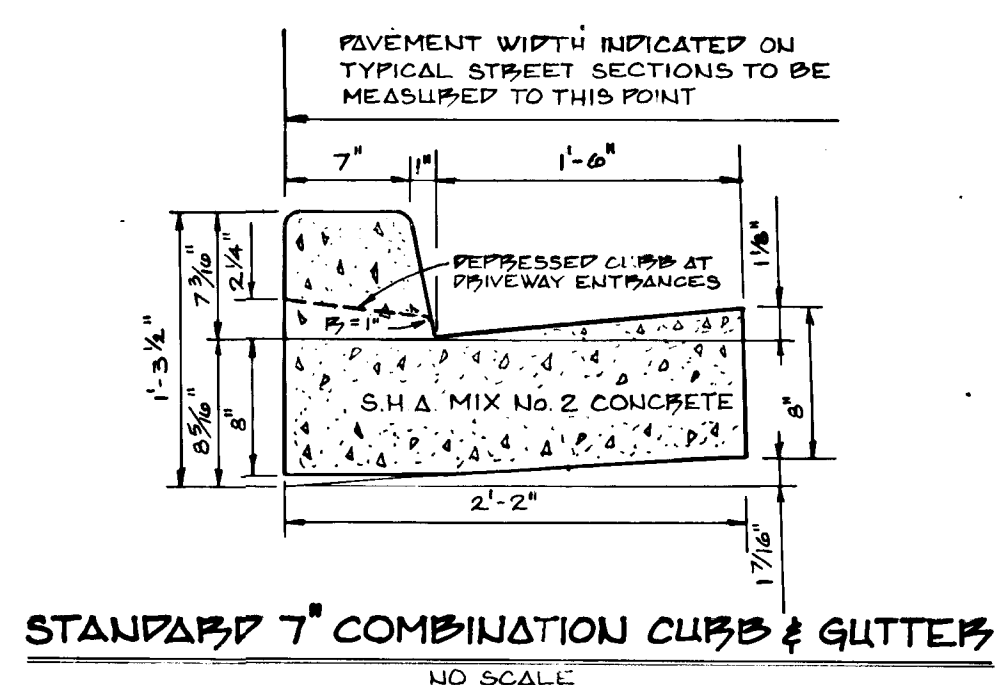
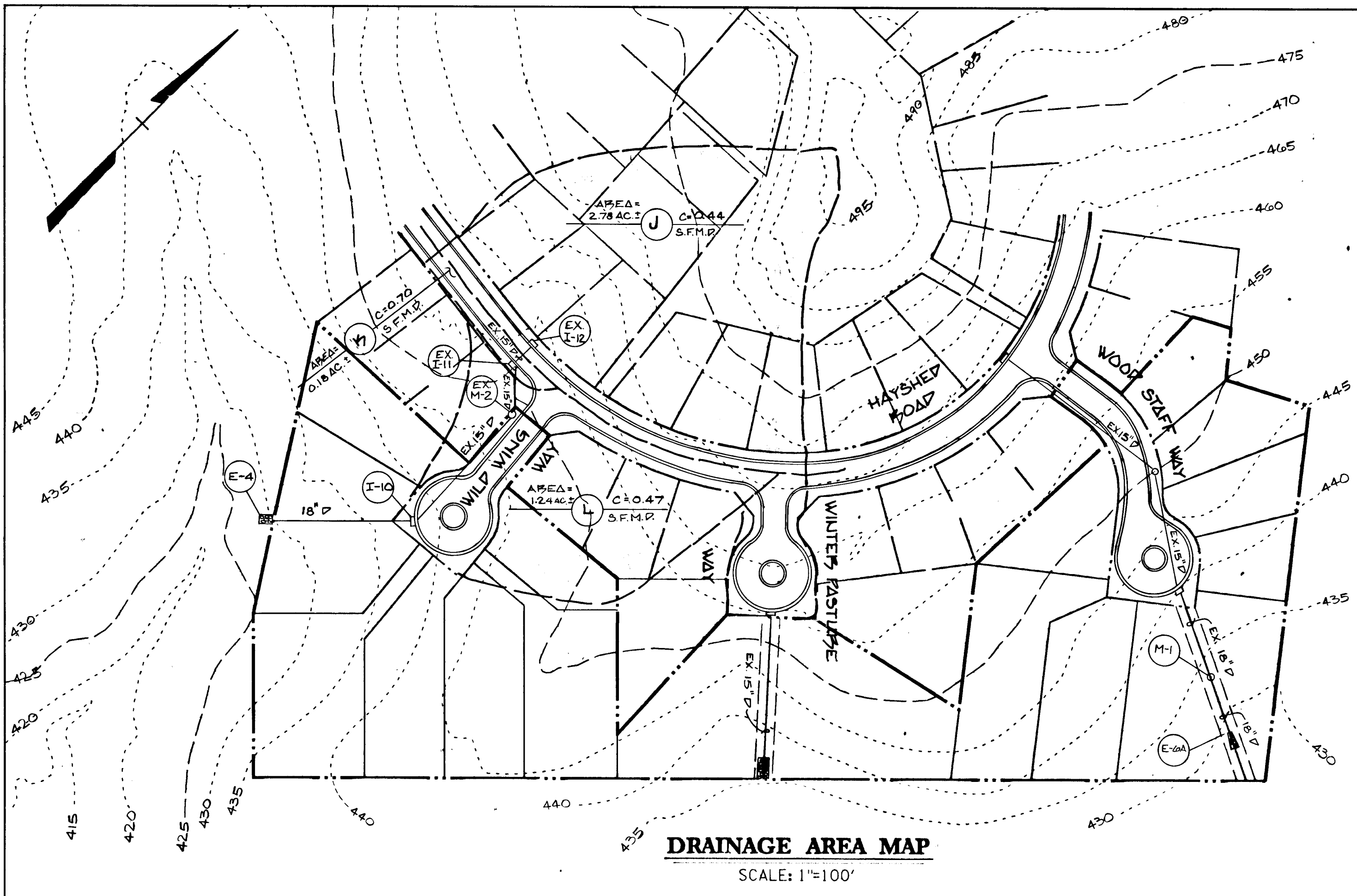

AS-BUILT
G. SCOTT SHANAFER, P.E.
PROFESSIONAL LAND SURVEYOR
LICENSE # 10847

SHANAFER & JANE
876 TOWN & COUNTRY BLVD.
SUITE 107
ELLCOTT CITY, MARYLAND 21043

APPROVED HOWARD COUNTY DEPT. OF PUBLIC WORKS	
<i>Janville W. Weiland</i> CHIEF, BUREAU OF HIGHWAYS	10/25/88 DATE
<i>William D. Ray</i> CHIEF, BUREAU OF ENGINEERING	10-24-88 DATE
<i>Donald L. Seaman</i> CHIEF, LAND DEVELOPMENT DIVISION	10/26/88 DATE
OFFICE OF PLANNING AND ZONING	
<i>Frank J. DeLong</i> CHIEF DIV. OF COMM. PLANNING AND LAND DEVL.	11-2-88 DATE

Date No. Revision Description

COLUMBIA, MD.
6TH ELECTION DISTRICT
HOWARD COUNTY, MARYLAND

OWNER /DEVELOPER
THE HOWARD RESEARCH
AND DEVELOPMENT LAND COMPANY

DAFT McCUNE WALKER, INC.
LAND PLANNING CONSULTANTS
LANDSCAPE ARCHITECTS
ENGINEERS SURVEYORS
200 EAST PENNSYLVANIA AVENUE
TOWSON, MD. 21204
TELEPHONE: 301-296-3333

AREA VILLAGE OF LONGREACH
SECTION 1 AREA 11
6TH ELECTION DISTRICT HOWARD CO., MARYLAND

TITLE DRAINAGE AREA MAP, DETAILS,
STORM DRAIN PROFILES

Des By J.D.C.	Scale 1" = 50'	Proj. No. 88074
Drn By F.N.C.	Date 4-22-88	
Chk By J.W.R.	Approved	3 OF 5

4-22-88
Date

W. L. Seaman
Professional Engr. No. 10551

TRAP SPECIFICATION TABLE

Trap Number	#1	#2
Trap Type	ST-V	ST-V
Existing Drainage Area	1.80	0.74
Proposed Drainage Area	1.80	0.74
Storage Required	CY 3240	1332
Storage Provided	CY 3920	2000
Top Embankment Elevation	440	439
Crest Elevation	439	437
Existing Ground Elevation	430	430
Cleanout Elevation	433.5	433.5
Bottom Elevation	433	431
Outlet Width (b)	8'	4'
a	-	-
Bottom Dimension	23'x23'	15'x15'
Trap Depth	5'	5'
Trap Sidelopes	1:1	1:1
Barrel Diameter	-	-
Riser Diameter	-	-

SEDIMENT CONTROL NOTES

- A minimum of 24 hours notice must be given to the Howard County Office of Inspections and Permits prior to the start of any construction (997-2437)
- All vegetative and structural practices are to be installed according to the provisions of this plan and are to be in conformance with the 1983 HAWKLAND STANDARDS AND SPECIFICATIONS FOR SOIL EROSION AND SEDIMENT CONTROL.
- Following initial soil disturbance or re-disturbance, permanent or temporary stabilization shall be completed within: a) 7 calendar days for all perimeter sediment control structures, dikes, perimeter slopes and all slopes greater than 3:1, b) 14 days as to all other disturbed or graded areas on the project site.
- All sediment traps/basins shown must be fenced and warning signs posted around their perimeter in accordance with Vol. 1, Chapter 12, of the HOWARD COUNTY DESIGN MANUAL, Storm Drainage.
- All disturbed areas must be stabilized within the time period specified above in accordance with the 1983 HAWKLAND STANDARDS AND SPECIFICATIONS FOR SOIL EROSION AND SEDIMENT CONTROL. For permanent seeding and mulching (Sec. 32), Temporary stabilization with mulch alone may only be done when recommended seeding rates do not allow for proper germination and establishment of grasses.
- All sediment control structures are to remain in place and are to be maintained in operative condition until permission for their removal has been obtained from the Howard County Sediment Control Inspector.
- Site Analysis:

Total Area of Site	8.10 acres
Area to be seeded or mowed	0.75 acres
Area to be vegetatively stabilized	0.10 acres
Total Cut	800 Cu. Yds
Total Fill	800 Cu. Yds
Off-site waste/borrow area location	NA
- Any sediment control practice which is disturbed by traffic activity for placement of utilities must be reinstated the same day of disturbance.
- Additional sediment controls must be provided, if deemed necessary by the Howard County IPM sediment control inspector.

VILLAGE OF LONGREACH
SECTION 1, AREA 10A
PLAT 3997

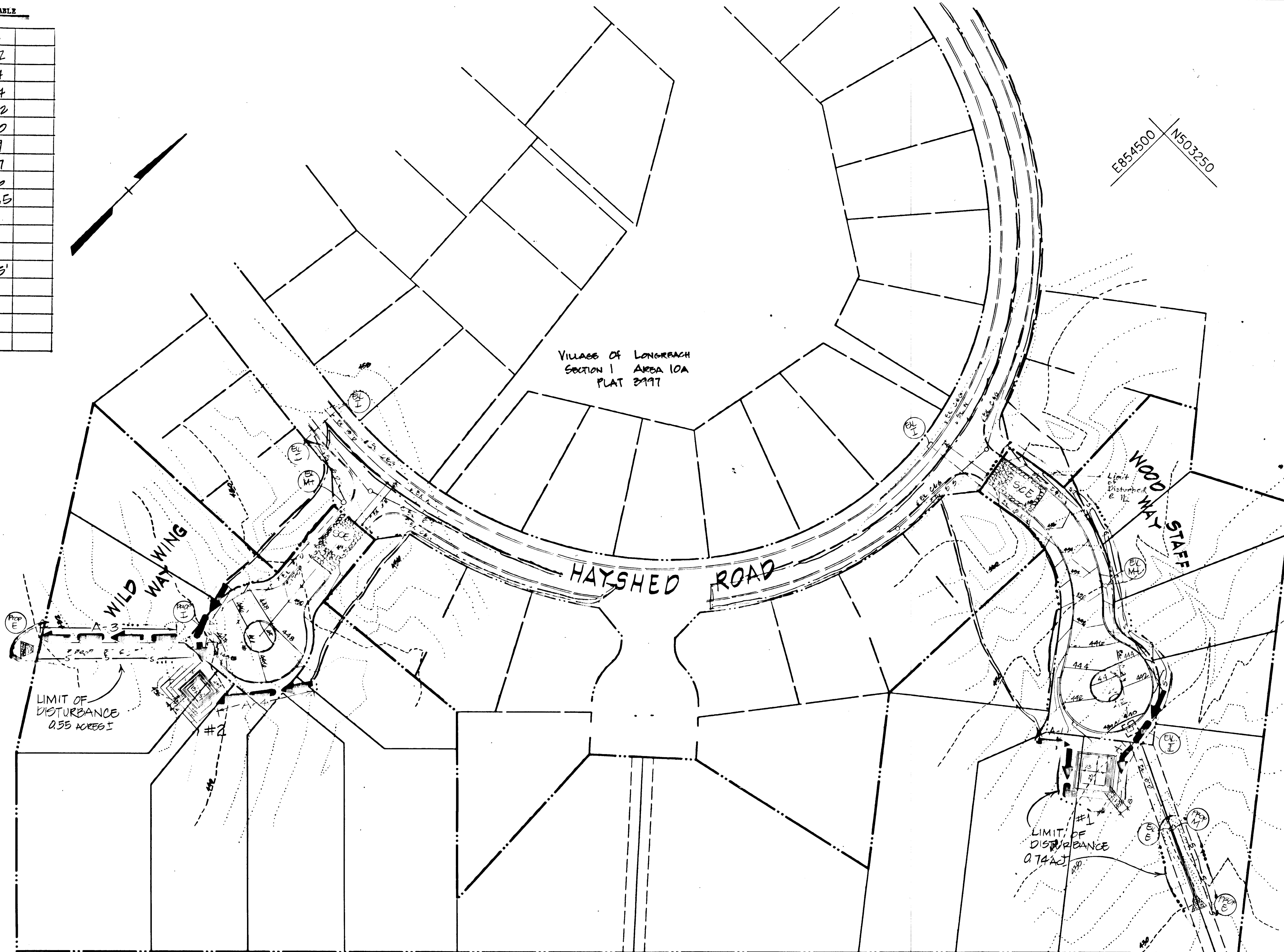

LIMIT OF DISTURBANCE
0.55 ACRES ±

LIMIT OF DISTURBANCE
0.74 ACRES ±

SECOBHAMMA TRANSMISSION COMPANY OF Md.
BM, JR. 144/494, BM, JR. 143/46

SEDIMENT AND EROSION CONTROL PLAN

SCALE: 1"=50'

LEGEND

- EXISTING GROUND - - - - -
- PROPOSED GRADE - - - - -
- EXISTING AREA - - - - -
- PROPOSED AREA - - - - -
- EARTH DIKE - - - - -
- SILT FENCE - - - - -
- STABILIZED CONSTRUCTION ENTRANCE - - - - -
- INLET PROTECTION - - - - -
- LIMIT OF DISTURBANCE - - - - -

NOTE:

ALL VEGETATIVE AND STRUCTURAL PRACTICES ARE TO BE INSTALLED ACCORDING TO THE PROVISIONS OF THIS PLAN AND ARE TO BE IN CONFORMANCE WITH THE "STANDARDS AND SPECIFICATIONS FOR SOIL EROSION AND SEDIMENT CONTROL IN DEVELOPING AREAS, DATED 1/15 OF LATER REVISIONS"

CERTIFICATION BY THE ENGINEER:

I CERTIFY THAT THIS PLAN FOR EROSION AND SEDIMENT CONTROL REPRESENTS A PRACTICAL AND WORKABLE PLAN BASED ON MY PERSONAL KNOWLEDGE OF THE SITE CONDITIONS AND THAT IT WAS PREPARED IN ACCORDANCE WITH THE REQUIREMENTS OF THE HOWARD SOIL CONSERVATION DISTRICT.

[Signature]
DATE 10/11/88

CERTIFICATION BY THE DEVELOPER:

I/WE CERTIFY THAT ALL DEVELOPMENT AND CONSTRUCTION WILL BE DONE ACCORDING TO THIS PLAN, AND THAT ANY RESPONSIBLE PERSONNEL INVOLVED IN THE CONSTRUCTION PROJECT WILL HAVE A CERTIFICATE OF ATTENDANCE AT A DEPARTMENT OF NATURAL RESOURCES APPROVED TRAINING PROGRAM FOR THE CONTROL OF SEDIMENT AND EROSION BEFORE BEGINNING THE PROJECT. I ALSO AUTHORIZE PERIODIC ON-SITE INSPECTION BY THE HOWARD SOIL CONSERVATION DISTRICT.

[Signature]
DATE 10/11/88

REVIEWED FOR HOWARD S.C.D. AND MEETS TECHNICAL REQUIREMENTS.

[Signature] 10/12/88
U.S. SOIL CONSERVATION SERVICE - DATE

THIS DEVELOPMENT PLAN IS APPROVED FOR SOIL EROSION AND SEDIMENT CONTROL BY THE HOWARD SOIL CONSERVATION DISTRICT.

[Signature] 10/11/88
HOWARD S.C.D. - DATE

Date	No.	Revision Description
10/25/88		APPROVED HOWARD COUNTY DEPT. OF PUBLIC WORKS G. W. WELLS, CHIEF, BUREAU OF HIGHWAYS
10-26-88		D. P. PERRY, CHIEF, BUREAU OF ENGINEERING
10/29/88		J. M. JENSEN, CHIEF, LAND DEVELOPMENT DIVISION
11-2-88		M. J. JENSEN, CHIEF DIV. OF COMM. PLANNING AND LAND DEVEL.

COLUMBIA, MD.
6TH ELECTION DISTRICT
HOWARD COUNTY, MARYLAND

OWNER / DEVELOPER
THE HOWARD RESEARCH
AND DEVELOPMENT LAND COMPANY

DAFT McCUNE WALKER, INC.
LAND PLANNING CONSULTANTS
LANDSCAPE ARCHITECTS
ENGINEERS SURVEYORS
200 EAST PENNSYLVANIA AVENUE
TOWSON, MD. 21204
TELEPHONE: 301-296-3333

AREA	VILLAGE OF LONGREACH
SECTION	SECTION 1
AREA	AREA 11
6TH ELECTION DISTRICT	HOWARD CO., MARYLAND
TITLE	SEDIMENT AND EROSION CONTROL PLAN
Des By	J.D.C.
Scale	1"=50'
Proj. No.	88014
Drn By	D.M.A.
Date	7-6-88
Chk By	J.W.R.
Approved	
4 OF 5	

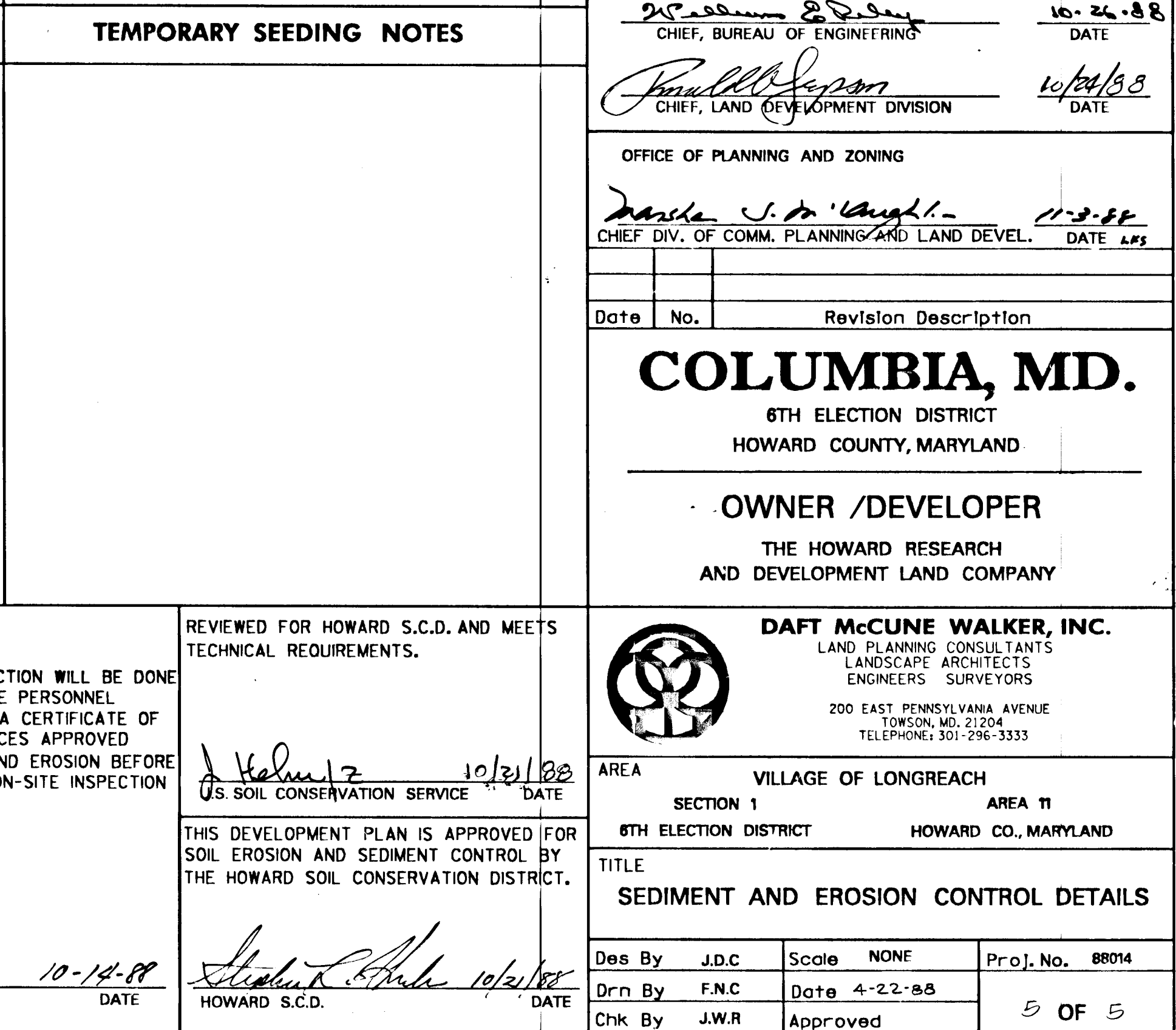
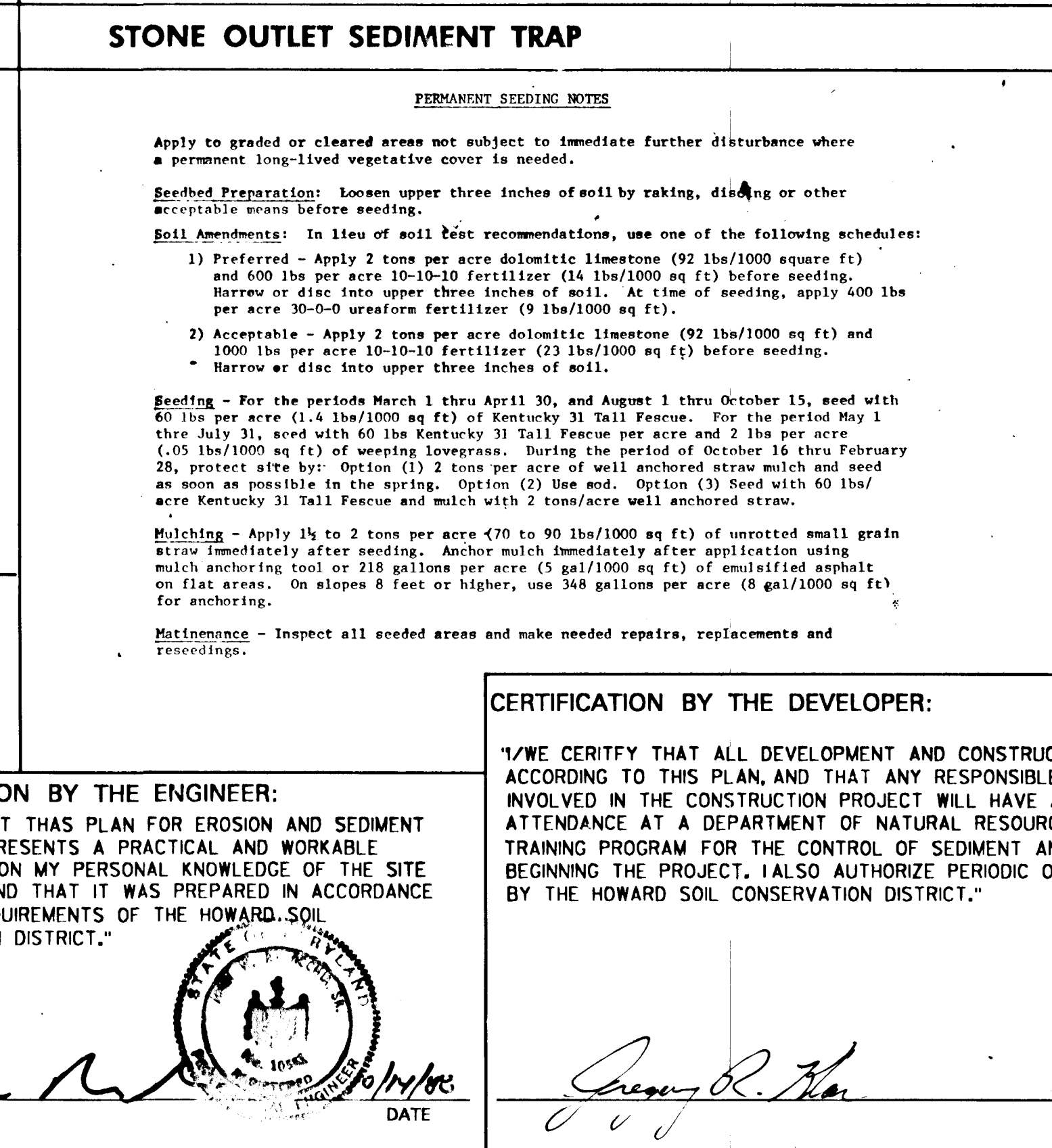
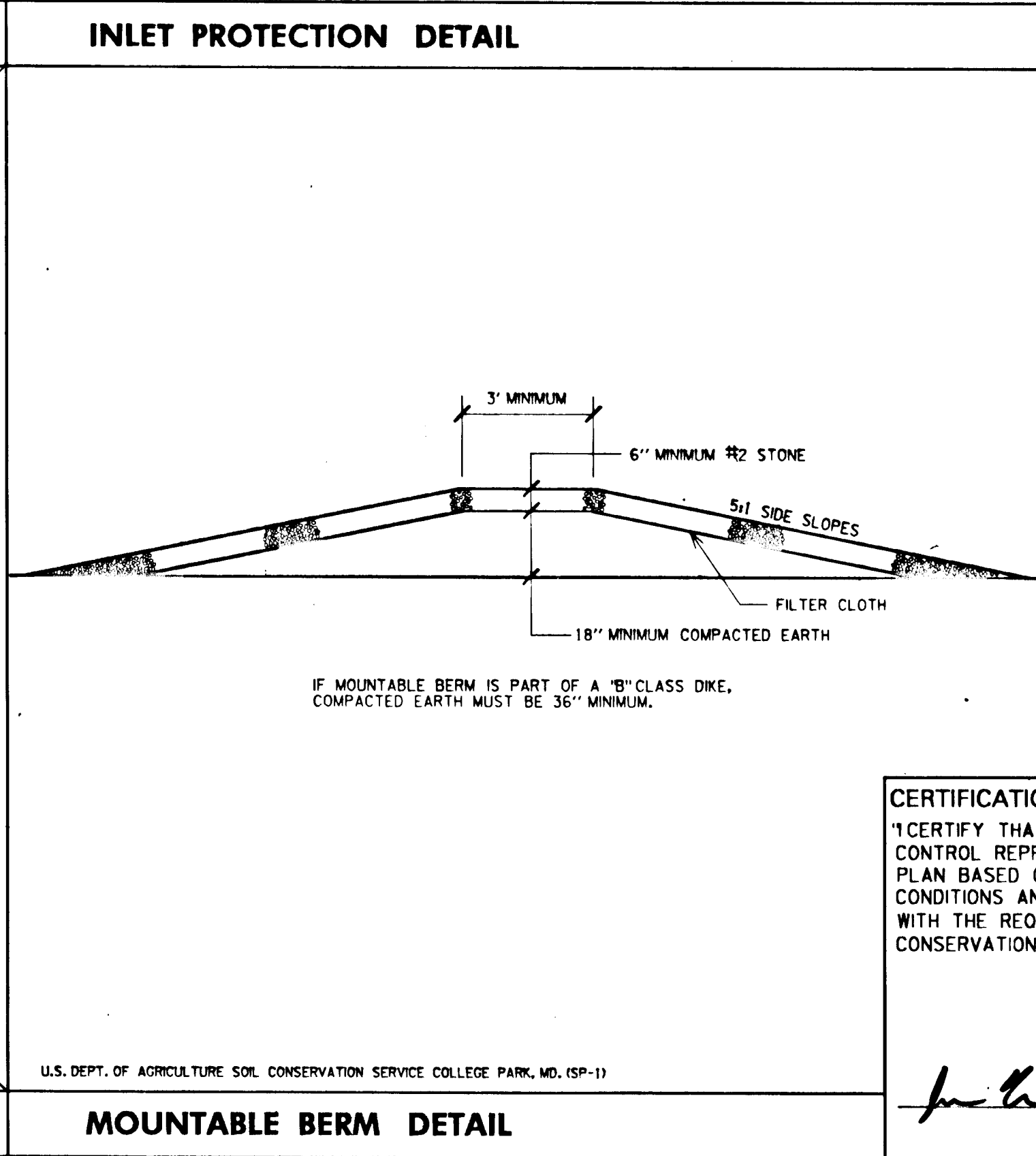
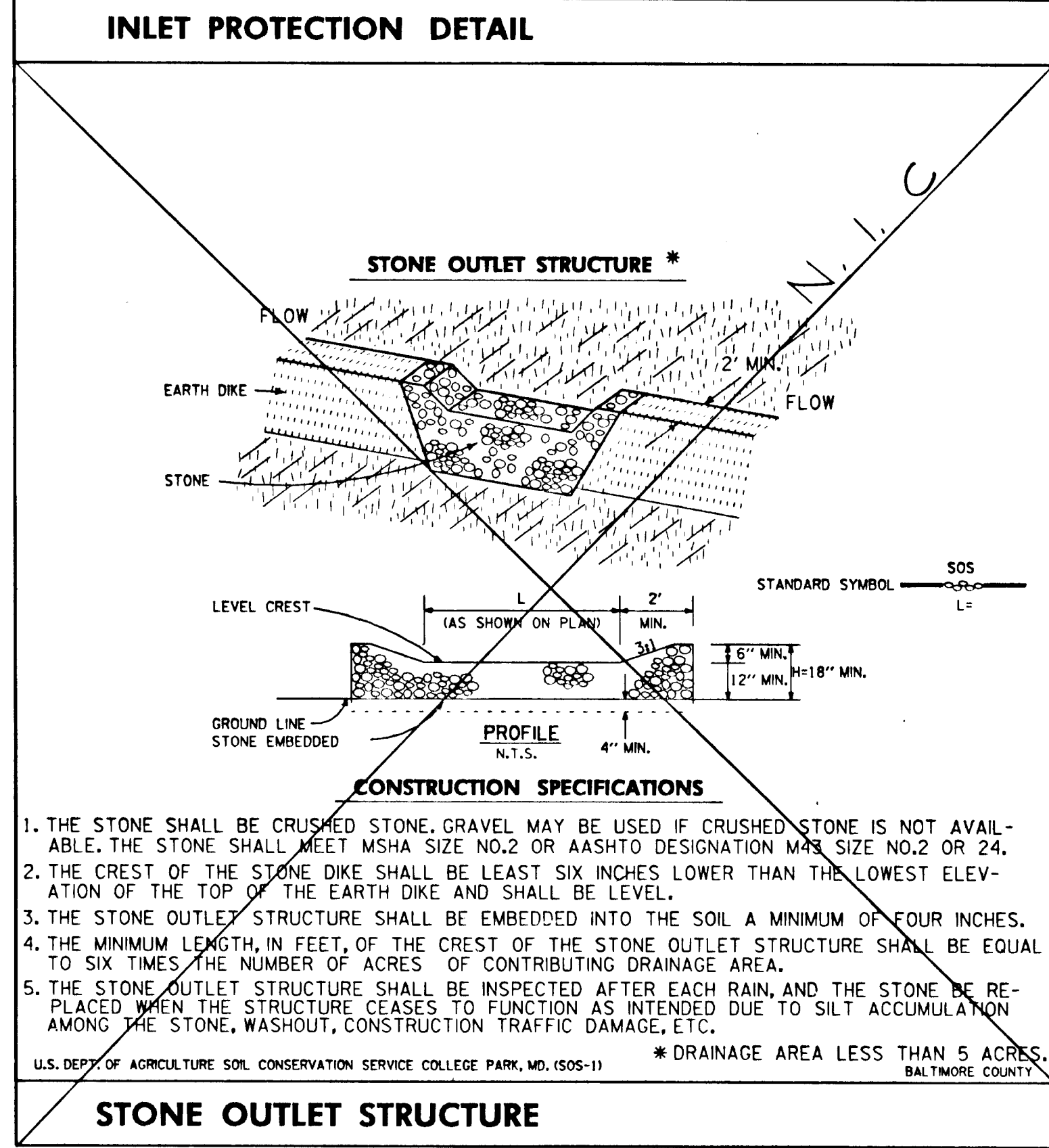
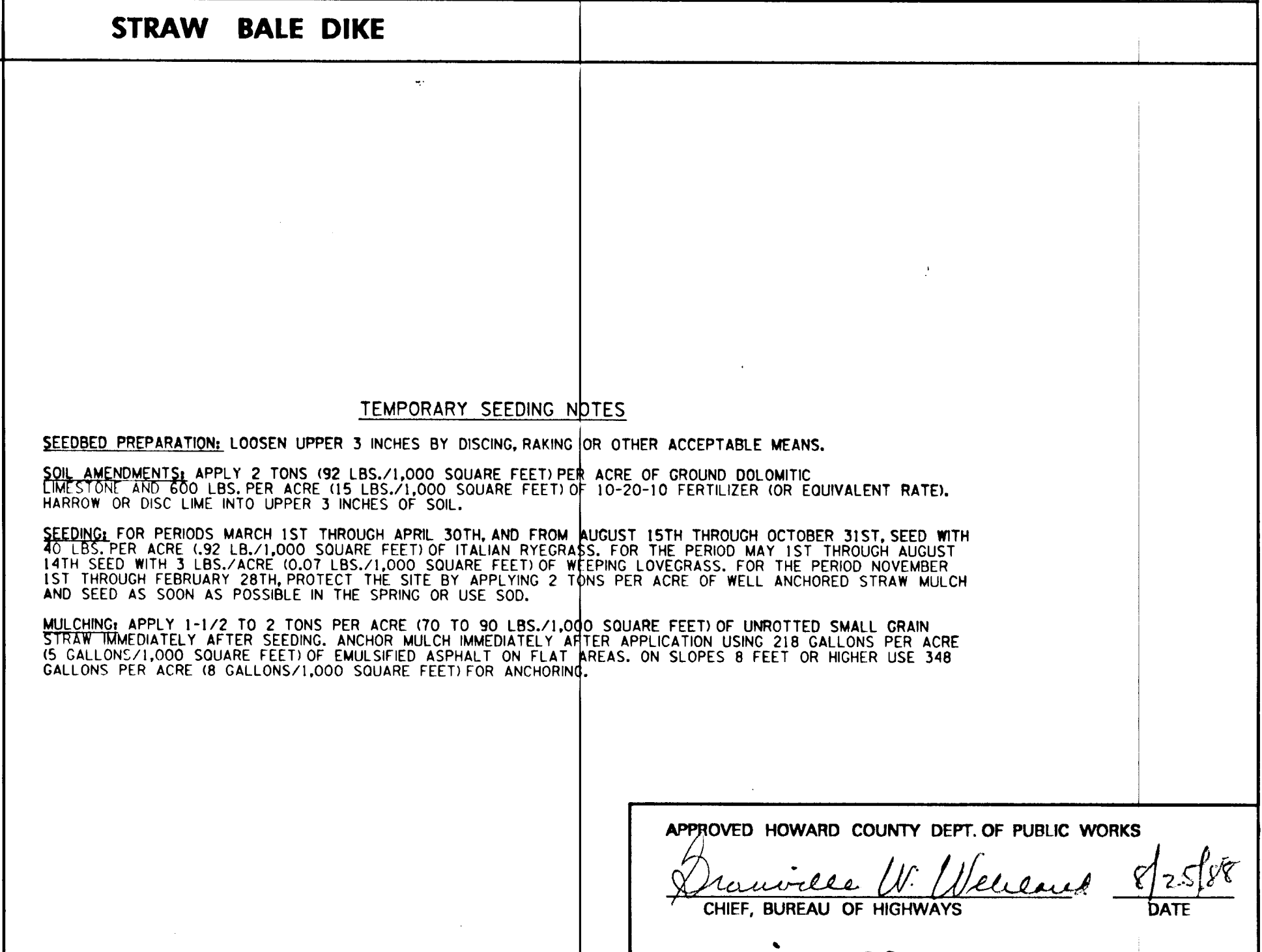
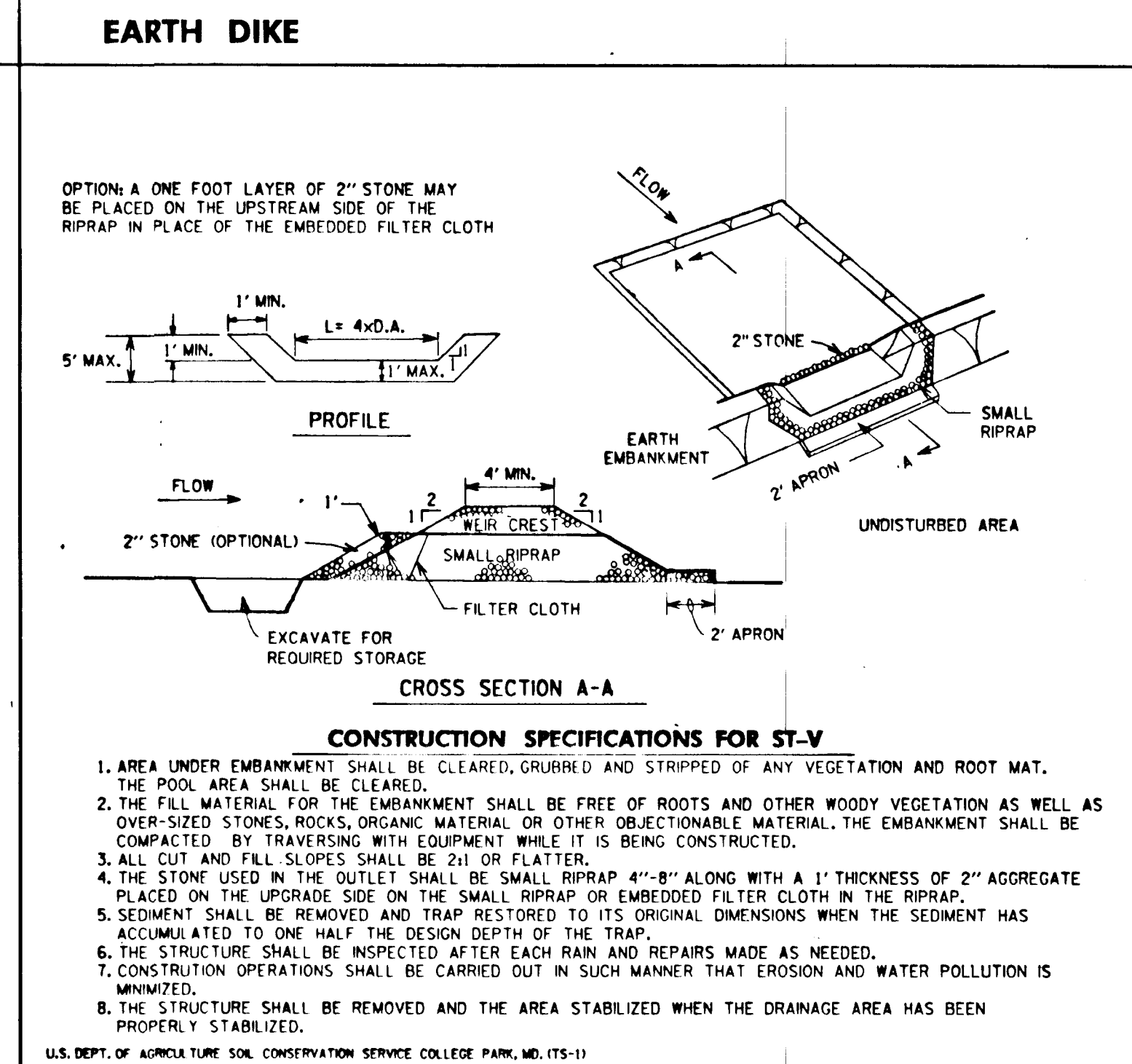
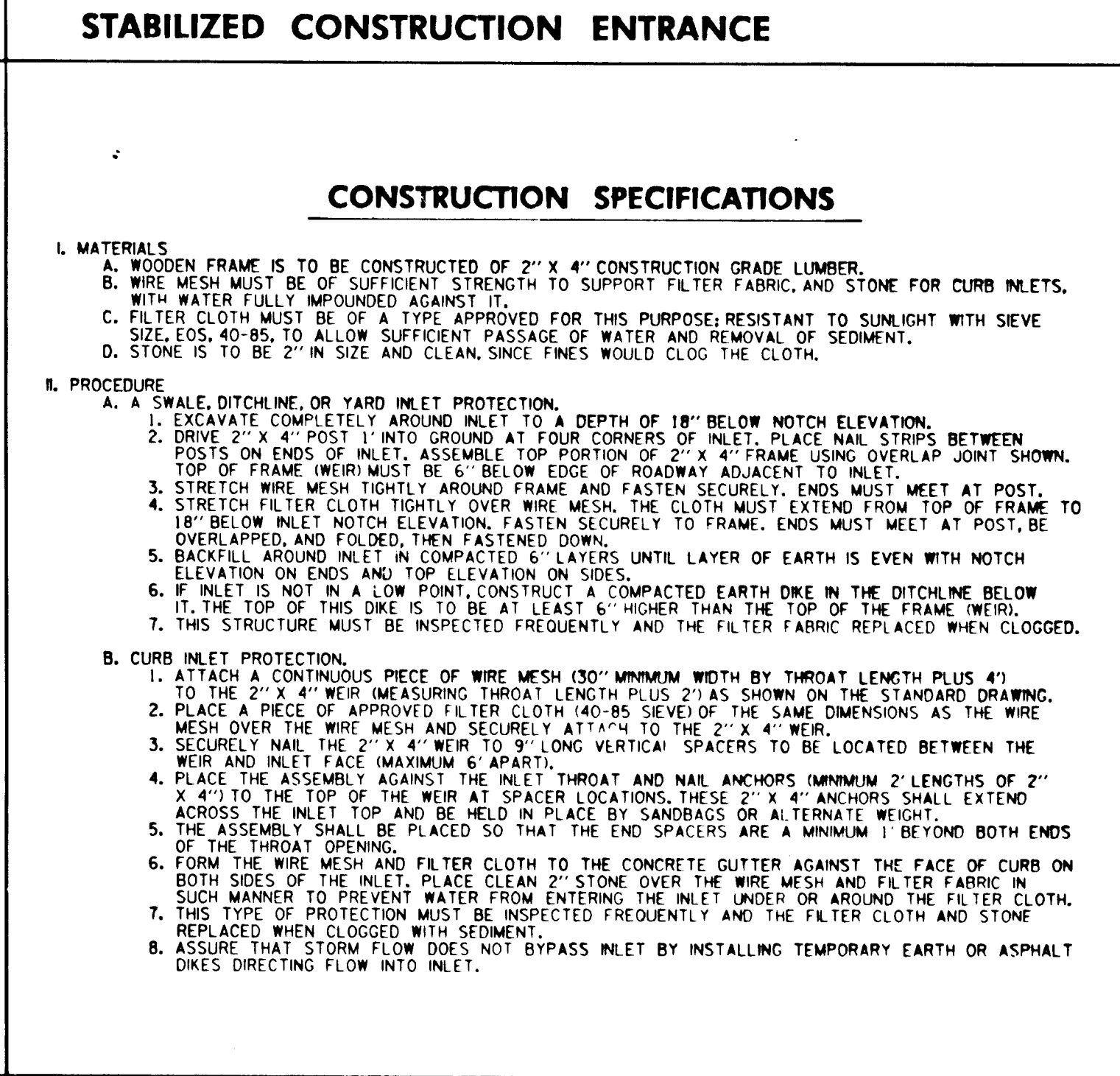
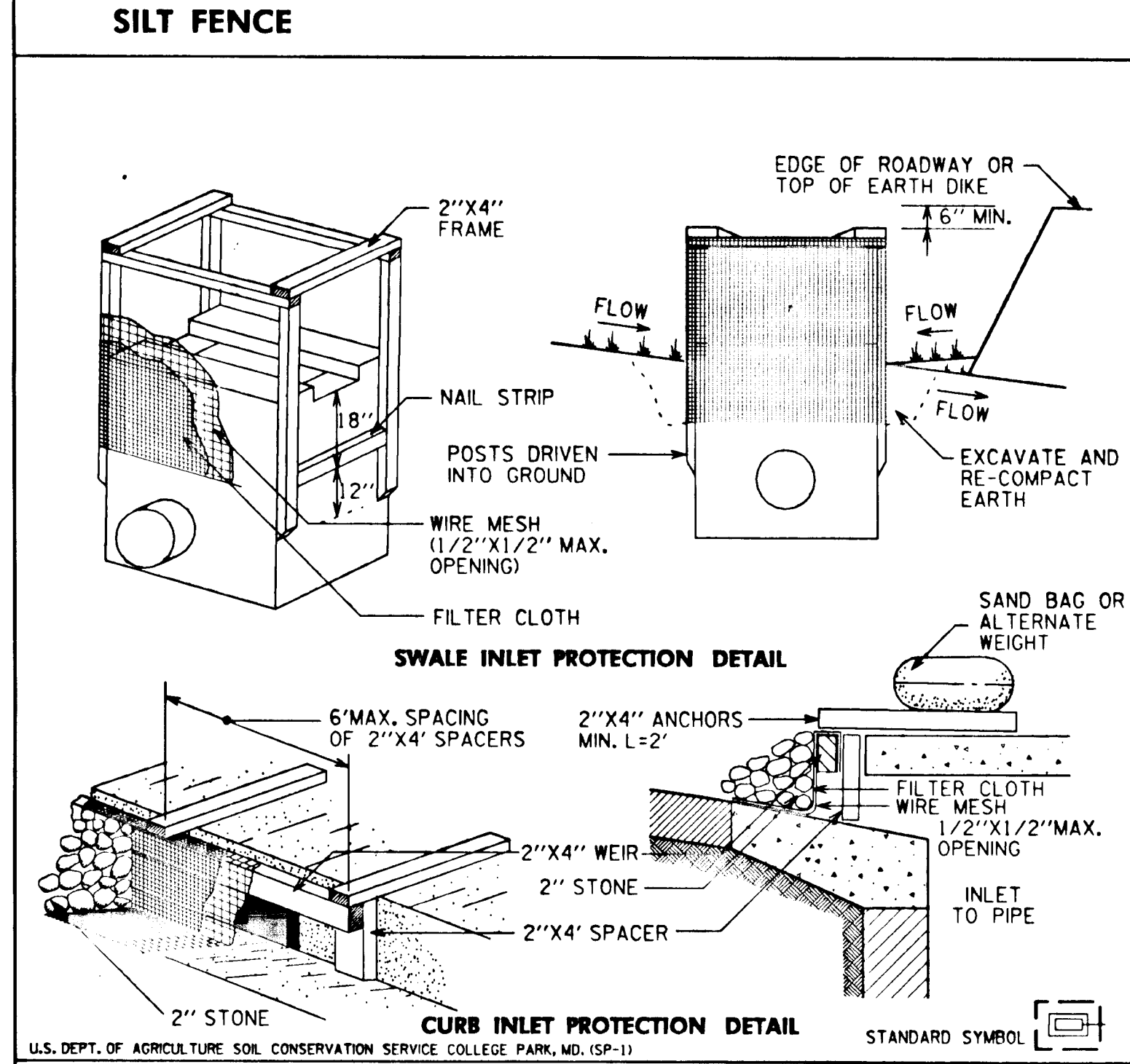
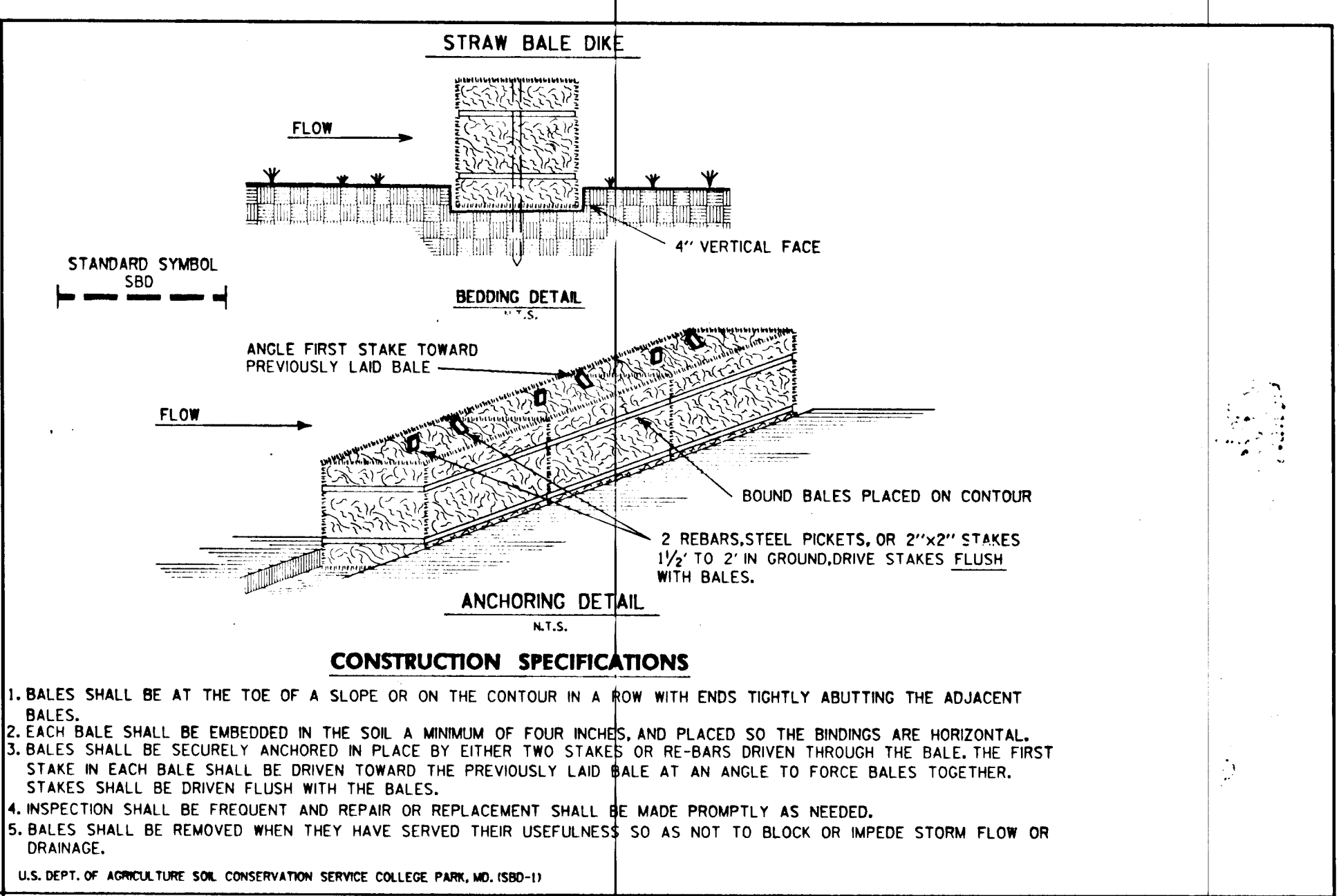
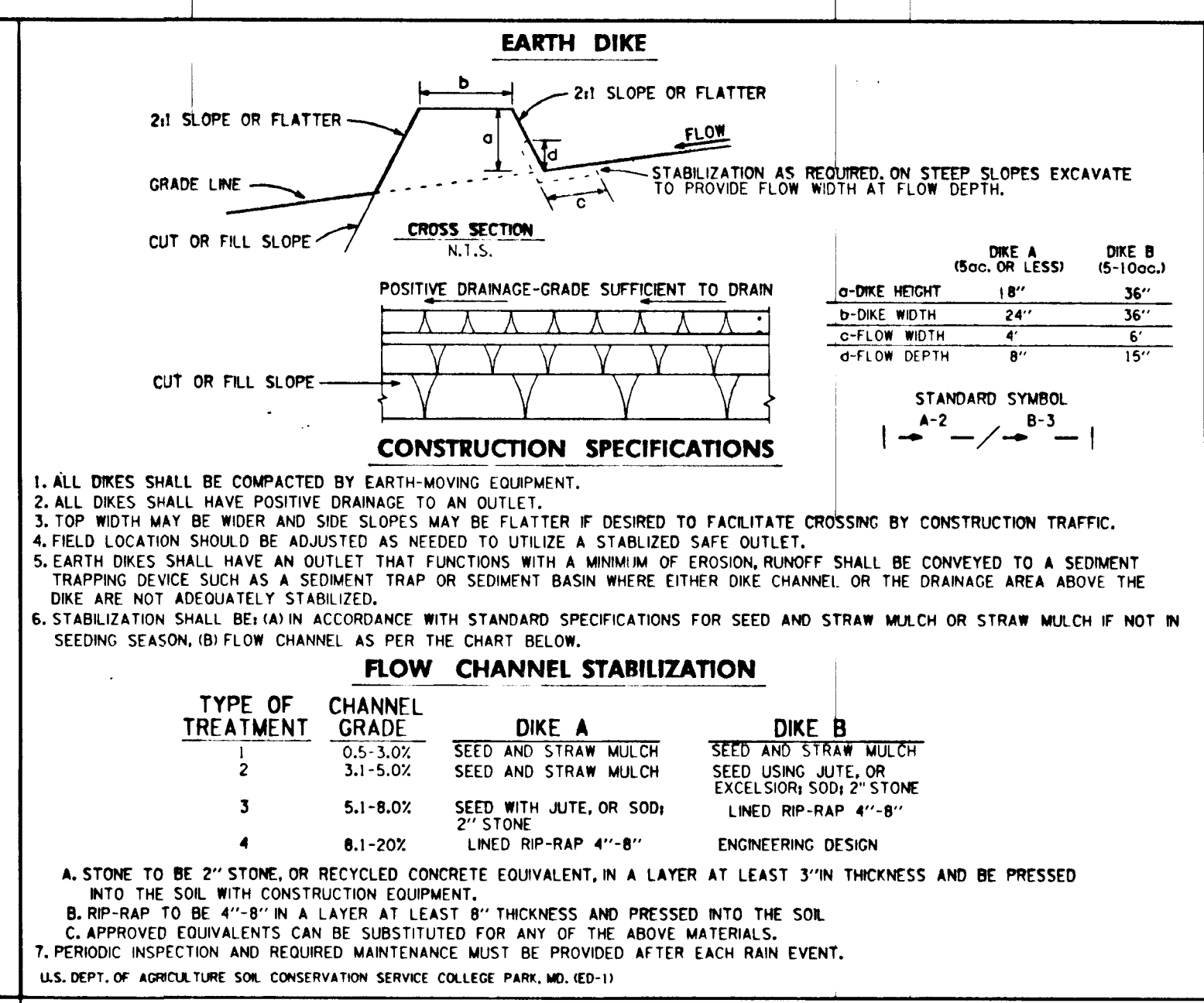
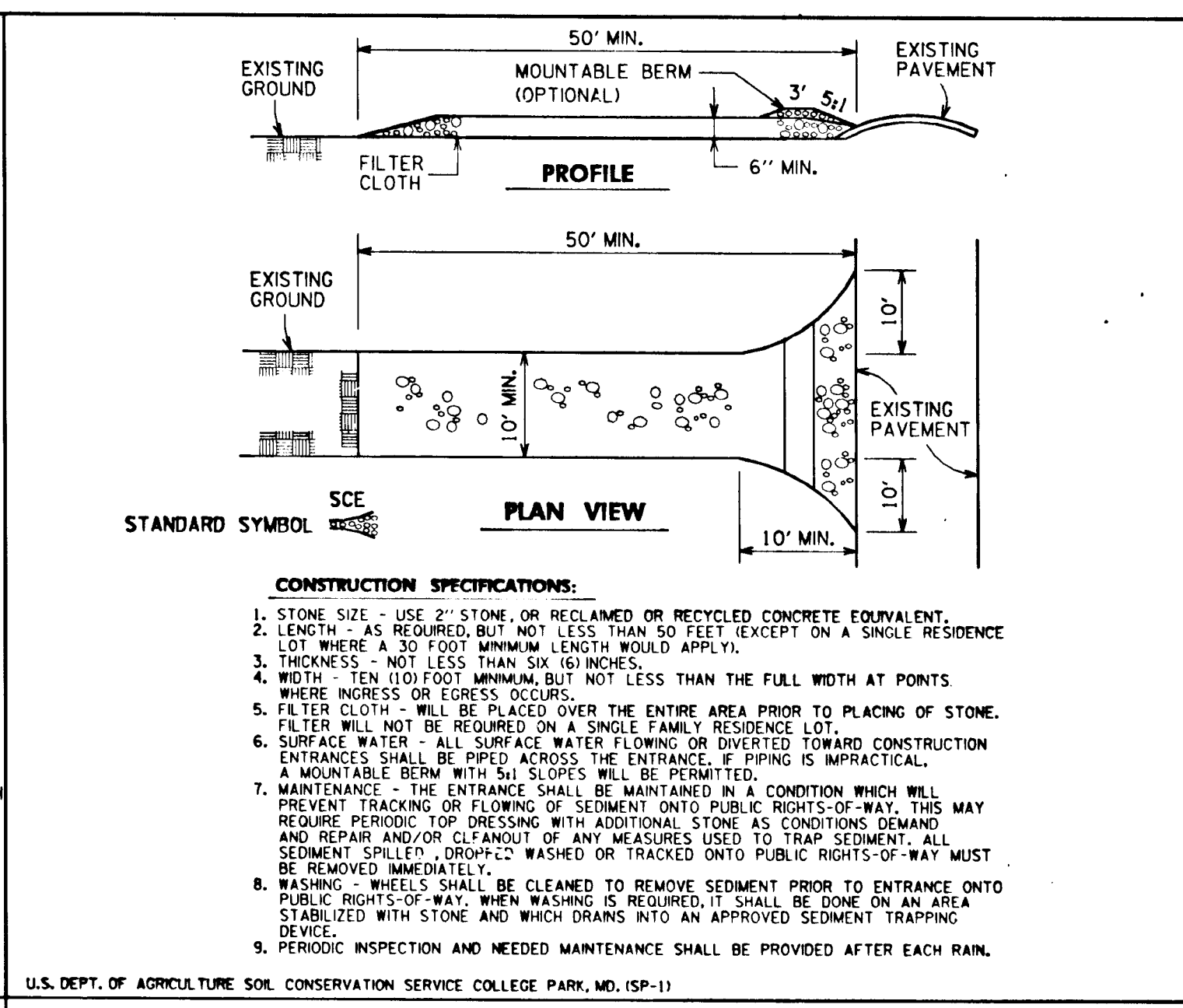
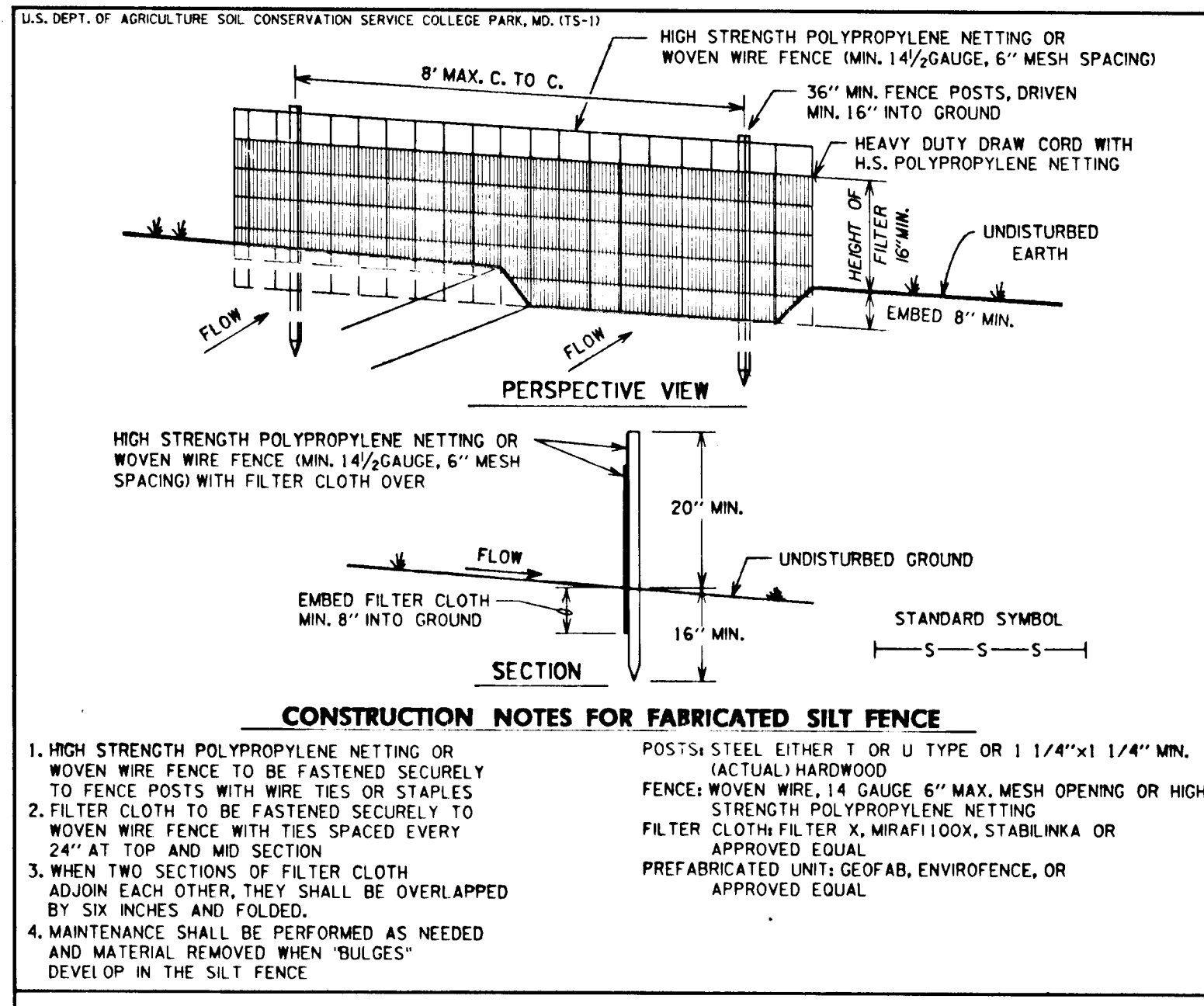

COLUMBIA, MD.
6TH ELECTION DISTRICT
HOWARD COUNTY, MARYLAND

OWNER / DEVELOPER
THE HOWARD RESEARCH
AND DEVELOPMENT LAND COMPANY

REVIEWED FOR HOWARD S.C.D. AND MEETS TECHNICAL REQUIREMENTS.

J. Helms 10/21/88
US SOIL CONSERVATION SERVICE DATE

THIS DEVELOPMENT PLAN IS APPROVED FOR SOIL EROSION AND SEDIMENT CONTROL BY THE HOWARD SOIL CONSERVATION DISTRICT.

Robert A. Helms 10/21/88
HOWARD S.C.D. DATE

100