

DATE	DESCRIPTION	BY
10/90	SWALE SEDIMENT TRAPS & CULVERTS FOR LOTS 1, 4, 5 & 8 ADD E.U.M.	

- NOTES:
- FOR GENERAL NOTES SEE DWG. 2 OF 3.
 - STATIONING SHOWN ON THIS DRAWING IS SURVEY BASELINE STATIONING ALONG EX. & ROAD.
 - FOR DRIVEWAY GRADING SEE DETAIL ON DWG. 2 OF 3.
 - FOR SEDIMENT CONTROL NOTES & DETAILS SEE DWG. 2 OF 3.
 - DRIVEWAY CULVERTS SHOWN REFLECT INDIVIDUAL DRIVE FOR COMMON DRIVE SHORTEN PIPE AS REQUIRED. DRIVEWAY CULVERTS FOR LOTS 1, 4, 5 & 8 MAY BE RELOCATED WHEN DRIVEWAY LOCATION IS ESTABLISHED.

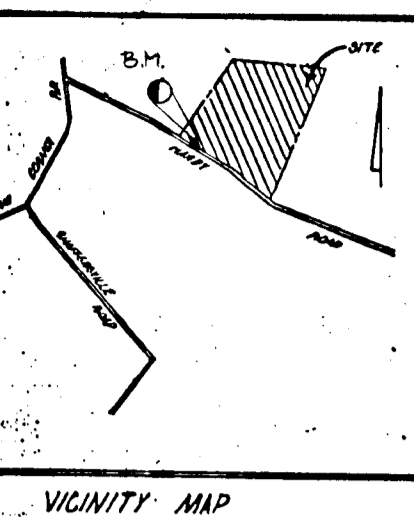
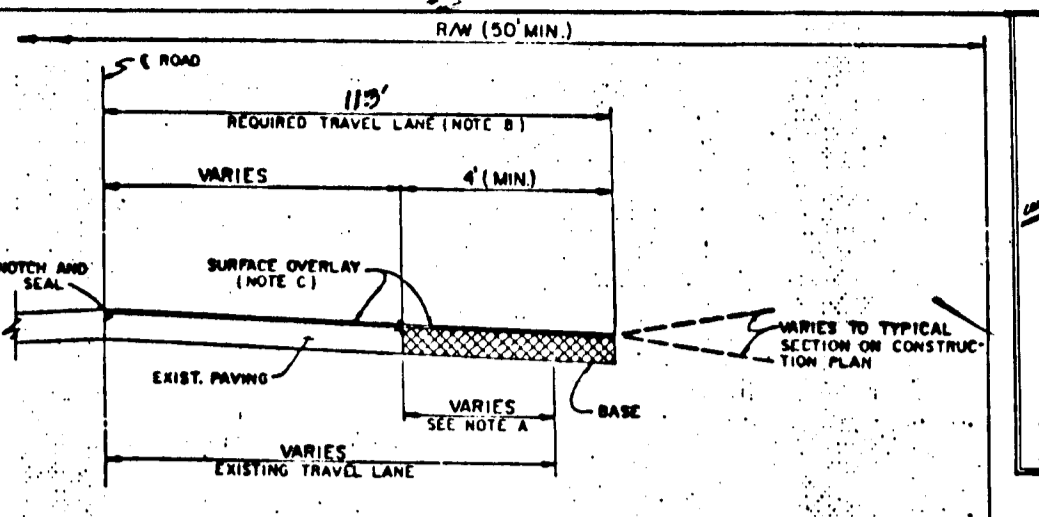

- 1 PROFILE GRADE LIVE (P.L.),
 2 TYPE OF CURB (ARIES 18" HIGH CURB OR ADD. 20" H. 2" R.I. 1
 3 4" CONCRETE SIDEWALK AS REQUIRED BY SUB-DIVISION. REIN. 4" X 6"
 4 1" INDICATES 2" TOPSOIL, SEED AND MULCH.
 5 GUARDRAIL WHERE REQUIRED BY THE DESIGN MANUAL.
 6 DITCH CROSS SECTION SLOPE MUST BE FLATTENED TO PROVIDE A SHOULDER AT OR NEAR THE CREST OF VERTICAL CURVES WHERE QUANTITY OF SHALE FLOW IS SMALL, AS APPROVED BY DPW.

BENCH MARK:
 HO. CO. STA. 3828002
 3/4" IRON BAR
 ELEV. = 787.853
 N 550741.245
 E 763406.413

NOTE: CMP CROSS DRAINS @ ALL DRIVEWAY CUTS.
 (± DITCH AVG 9.6' FROM EDGE PAVING)

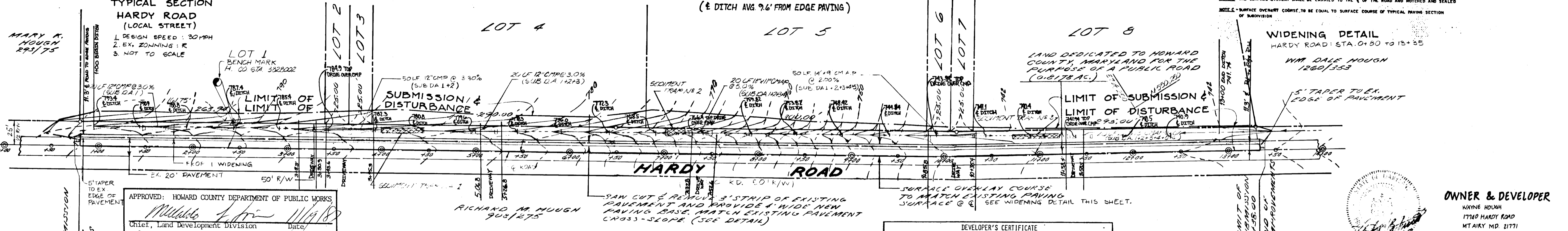

APPROVED: HOWARD COUNTY DEPARTMENT OF PUBLIC WORKS
 Chief, Land Development Division
 Date: 11/18/87

APPROVED: HOWARD COUNTY DEPARTMENT OF PUBLIC WORKS
 Chief, Bureau of Engineering
 Date: 11-24-87

APPROVED OFFICE OF PLANNING AND ZONING
 Chief, Division of Land Development and Zoning Administration
 Date: 11-9-87

REVIEWED FOR HOWARD S.C.D. AND MEETS TECHNICAL REQUIREMENTS.
 U.S. SOIL CONSERVATION SERVICE
 DATE: 11-9-87

THIS DEVELOPMENT IS APPROVED SOIL EROSION AND SEDIMENT CONTROL BY THE HOWARD SOIL CONSERVATION DISTRICT.
 SOIL CONSERVATION DISTRICT
 DATE: 11/9/87

DEVELOPER'S CERTIFICATE
 I CERTIFY THAT ALL DEVELOPMENT AND CONSTRUCTION WILL BE DONE ACCORDING TO THIS PLAN OF DEVELOPMENT AND PLAN FOR EROSION AND SEDIMENT CONTROL AND THAT ALL RESPONSIBLE PERSONNEL INVOLVED IN THE CONSTRUCTION PROJECT WILL HAVE A CERTIFICATE OF ATTENDANCE AT A DEPARTMENT OF NATURAL RESOURCES APPROVED TRAINING PROGRAM FOR THE CONTROL OF SEDIMENT AND EROSION BEFORE BEGINNING THE PROJECT. I ALSO AUTHORIZE PERIODIC ON-SITE INSPECTIONS BY THE HOWARD SOIL CONSERVATION DISTRICT OR THEIR AUTHORIZED AGENTS, AS ARE DEEMED NECESSARY.
 DATE: 9-27-87

ENGINEER'S CERTIFICATE
 I CERTIFY THAT THIS PLAN FOR EROSION AND SEDIMENT CONTROL REPRESENTS A PRACTICAL AND WORKABLE PLAN BASED ON PERSONAL KNOWLEDGE OF THE SITE CONDITIONS AND THAT IT WAS PREPARED IN ACCORDANCE WITH THE REQUIREMENTS OF THE HOWARD SOIL CONSERVATION DISTRICT.
 DATE: 9-27-87

TITLE: ROAD CONSTRUCTION PLAN			
PROJECT: LAURAND LOTS 1-8			
LOCATION: TAX MAP 7, PAR. 391 5-87-85			
4TH ELECTION DISTRICT HOWARD CO. MD.			
SCALE: AS SHOWN	DESIGNED BY: E.B.A.	DRAWN BY: BWS	CHECKED BY: L.B.
FIELD BOOK: 31	PAGE NO.: 10-114	JOB NO.: 86426	DATE: SEP. 1987
			DRAWING NO.: 1 OF 3

OWNER & DEVELOPER
 WAYNE HOUGH
 17188 HARDY ROAD
 MT AIRY, MD. 21771

boender associates inc.
 consulting engineers
 land surveyors
 land planners
 COURTHOUSE SQUARE
 3565 ELLICOTT MILLS DRIVE
 ELLICOTT CITY, MD. 21043
 (301) 465-7777

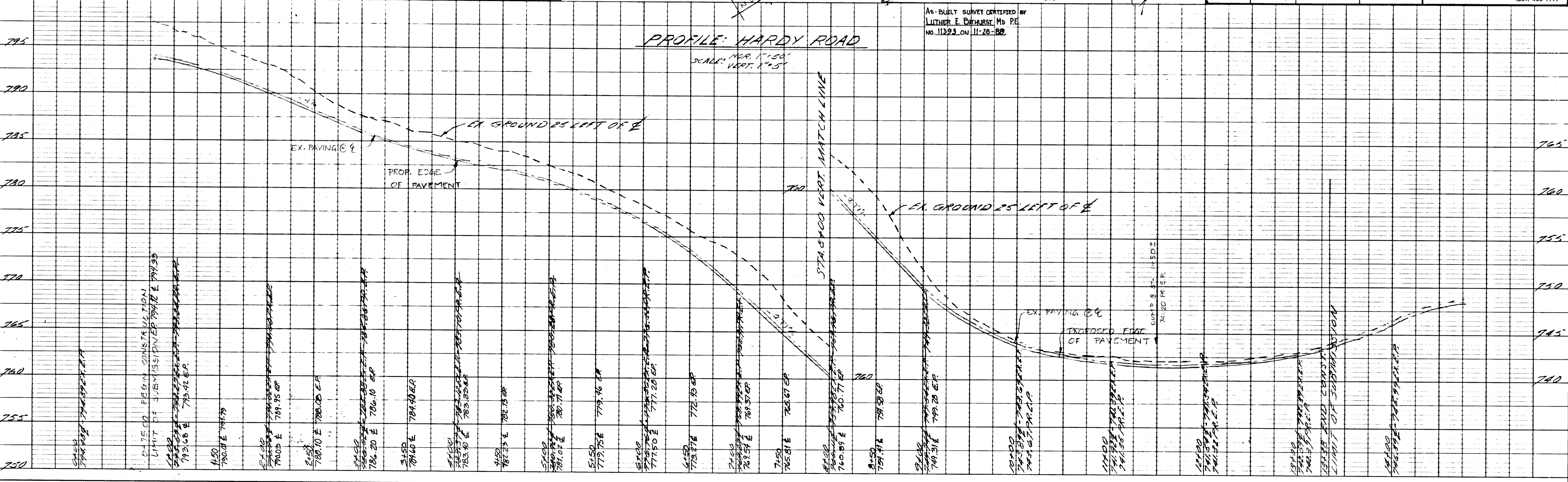

AS-BUILT SURVEY CERTIFIED BY
 LUTHER E. DEHARST, MD. P.E.
 No. 11292 on 11-28-88

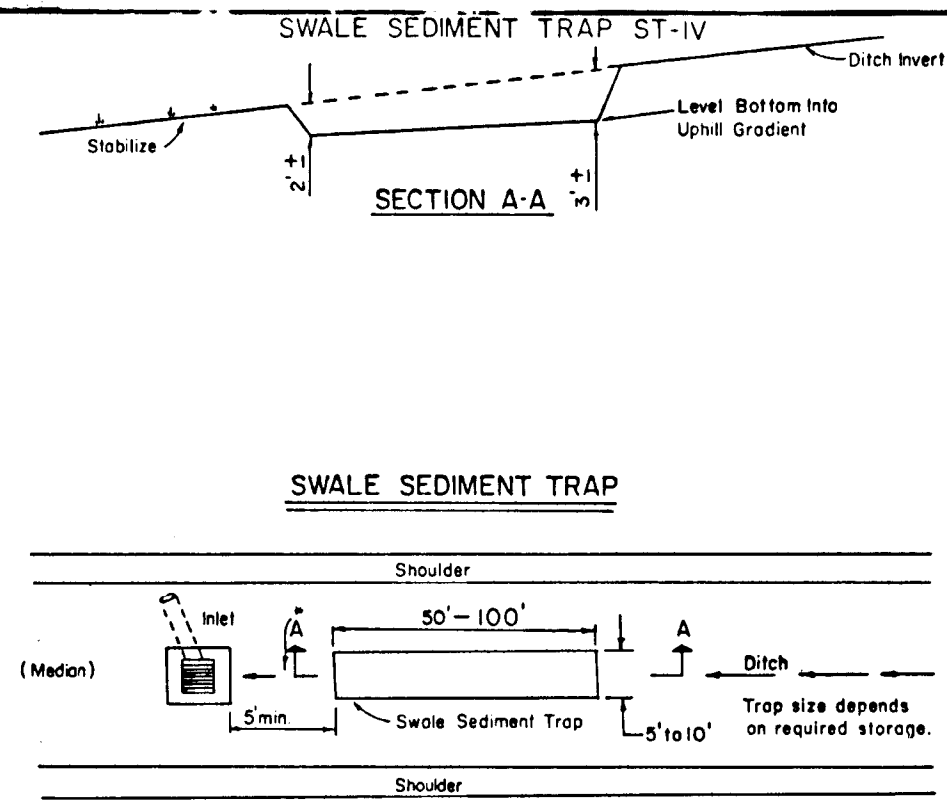

CONSTRUCTION SPECIFICATION FOR ST-IV

- The swale sediment trap shall be constructed in accordance with the dimensions provided on the design drawings or sized to provide the minimum storage necessary 1800 cubic feet of storage for each acre of drainage area.
- Sediment shall be removed and trap restored to its original dimensions when the sediment has accumulated to 1/2 the design depth of the trap. Removed sediment shall be deposited in a suitable area and in such a manner that it will not erode.
- The structure shall be inspected after each rain and repairs made as needed.
- Construction operations shall be carried out in such a manner that erosion and water pollution shall be minimized.
- The sediment trap shall be removed and area stabilized when the contributory drainage area has been properly stabilized.
- The swale sediment trap will be properly backfilled and the swale or ditch reconstructed.

Maximum Drainage Area: 2 Acres

PERMANENT SEEDING NOTES

Apply to graded or cleared areas not subject to immediate further disturbance where a permanent long-lived vegetative cover is needed.

Soil Amendment: Loosen upper three inches of soil by raking, discing or other acceptable means before seeding.

Soil Amendments: In lieu of soil test recommendations, use one of the following schedules:

- Preferred - Apply 2 tons per acre dolomitic limestone (92 lbs/1000 square ft) and 800 lbs per acre 10-10-10 fertilizer (14 lbs/1000 sq ft) before seeding. Harrow or disc into upper three inches of soil. At time of seeding, apply 400 lbs per acre 30-0-0 ureaform fertilizer (9 lbs/1000 sq ft).
- Acceptable - Apply 2 tons per acre dolomitic limestone (92 lbs/1000 sq ft) and 1000 lbs per acre 10-10-10 fertilizer (23 lbs/1000 sq ft) before seeding. Harrow or disc into upper three inches of soil.

Seeding: For the periods March 1 thru April 30, and August 1 thru October 15, seed with 60 lbs per acre (1.5 lbs/1000 sq ft) of Kentucky 33 Tall Fescue. For the period May 1 thru July 31, seed with 60 lbs Kentucky 33 Tall Fescue per acre and 2 lbs per acre (0.5 lbs/1000 sq ft) of vernal ryegrass. During the period of October 16 thru February 28, protect site by: Option (1) 2 tons per acre of well anchored straw mulch and seed as soon as possible in the spring. Option (2) Use sod. Option (3) Seed with 60 lbs/acre Kentucky 33 Tall Fescue and mulch with 2 tons/acre well anchored straw.

Mulching: Apply 1 1/2 to 2 tons per acre (30 to 90 lbs/1000 sq ft) of unwritten small grain straw immediately after seeding. Anchor mulch immediately after application using mulch anchoring tool or 218 gallons per acre (5 gal/1000 sq ft) of emulsified asphalt on flat areas. On slopes 8 feet or higher, use 348 gallons per acre (8 gal/1000 sq ft) for anchoring.

Maintenance: Inspect all seeded areas and make needed repairs, replacements and reseedings.

TEMPORARY SEEDING NOTES

Apply to graded or cleared areas likely to be redisturbed where a short-term vegetative cover is needed.

Soil Amendment: Loosen upper three inches of soil by raking, discing or other acceptable means before seeding.

Soil Amendments: Apply 600 lbs per acre 10-10-10 fertilizer (14 lbs/1000 sq ft)

Seeding: For periods March 1 thru April 30 and from August 15 thru November 15, seed with 75 bushel per acre of annual rye (3.7 lbs/1000 sq ft). For the period May 1 thru August 14, seed with 3 lbs per acre of vernal ryegrass (0.7 lbs/1000 sq ft). For the period November 16 thru February 28, protect site by applying 2 tons per acre of well anchored straw mulch and seed as soon as possible in the spring, or use sod.

Mulching: Apply 1 1/2 to 2 tons per acre (30 to 90 lbs/1000 sq ft) of unwritten small grain straw immediately after seeding. Anchor mulch immediately after application using mulch anchoring tool or 218 gal per acre (5 gal/1000 sq ft) of emulsified asphalt on flat areas. On slopes 8 ft or higher, use 348 gal per acre (8 gal/1000 sq ft) for anchoring.

Refer to the 1983 HOWARD STANDARDS AND SPECIFICATIONS FOR SOIL EROSION AND SEDIMENT CONTROL for rate and methods not covered.

SEDIMENT CONTROL NOTES

- A minimum of 24 hours notice must be given to the Howard County Office of Inspection and Permit prior to the start of any construction. (992-7237).
- All vegetative and structural practices are to be installed according to the provisions of this plan and are to be in conformance with the 1983 HOWARD STANDARDS AND SPECIFICATIONS FOR SOIL EROSION AND SEDIMENT CONTROL.
- Following initial soil disturbance or construction, permanent or temporary stabilization shall be completed within: a) 7 calendar days for all perimeter sediment control structures, ditches, perimeter slopes and all slopes greater than 3:1; b) 14 days on all other disturbed or graded areas on the project site.
- All sediment traps/basins shown must be fenced and warning signs posted around their perimeter in accordance with Vol. 1, Chapter 12, of the HOWARD COUNTY DESIGN MANUAL, Storm Drainage.
- All disturbed areas must be stabilized within the time period specified above in accordance with the 1983 HOWARD STANDARDS AND SPECIFICATIONS FOR SOIL EROSION AND SEDIMENT CONTROL for permanent seedings (Sec. 51) and (Sec. 54) temporary seedings (Sec. 50) and mulching (Sec. 52). Temporary stabilization with mulch alone can only be done when recommended seeding data do not allow for proper germination and establishment of grasses.
- All sediment control structures are to remain in place and are to be maintained in operating condition until permission for their removal has been obtained from the Howard County Sediment Control Inspector.
- Site Analysis:

Total Area of Site	34.82 acres
Area Disturbed	7.85 acres
Area to be seeded or paved	7.85 acres
Area to be vegetatively stabilized	7.85 acres
Total Cut	2.7 Cu.Yds.
Total Fill	2.7 Cu.Yds.
Off-site water/borrow area location	
- Any sediment control practice which is disturbed by grading activity for placement of utilities must be repaired on the same day of disturbance.
- Additional sediment controls must be provided, if deemed necessary by the Howard County SWM sediment control inspector.
- On all sites with disturbed areas in excess of 2 acres, approval of the inspection agency shall be requested upon completion of installation of perimeter erosion and sediment controls, but before proceeding with any other earth disturbance or grading. Other building or grading inspection approvals may not be authorized until this initial approval by the inspection agency is made.

SEQUENCE OF CONSTRUCTION

- OBTAIN GRADING PERMIT.
- NOTIFY MISSISSIPPI UTILITY @ 559-0100 48 HOURS PRIOR TO BEGINNING. NOTIFY THE HOWARD CO. BUREAU OF LICENCE, INSPECTIONS AND PERMITS AND THE CONSTRUCTION INSPECTION/SURVEYS DIVISION @ (301) 792-7272 AT LEAST 24 HOURS PRIOR TO BEGINNING CONSTRUCTION.
- REMOVE GRADE DITCH, INSTALL SWALE SEDIMENT TRAPS.
- INSTALL DRAINAGE CURBS.
- SAW CUT & REMOVE 3' STRIP OF EXISTING PAVEMENT. CONSTRUCT A STRIP OF NEW PAVEMENT.
- FINE GRADE SHOULDER, DITCH AND VEGETATIVELY STABILIZE ALL DISTURBED AREAS.
- WITH THE GRADING INSPECTOR'S APPROVAL REMOVE SWALE SEDIMENT TRAPS & STABILIZE ANY REMAINING DISTURBED AREAS.

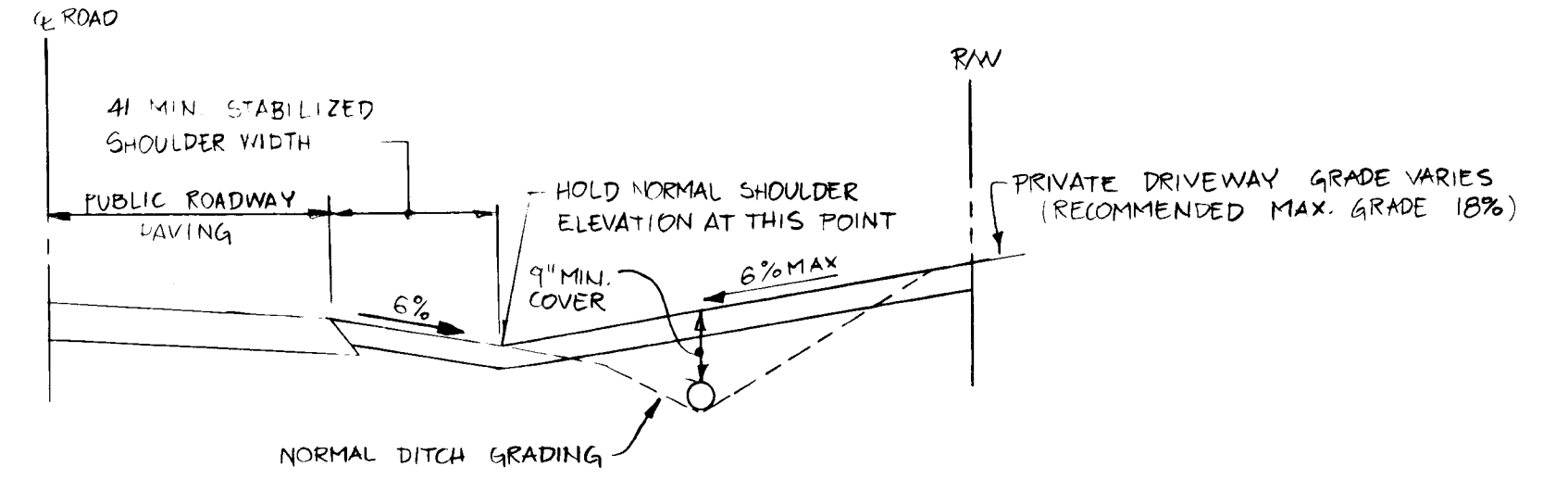

DRIVEWAY GRADING DETAIL

NOT TO SCALE

NOTES:
1. DRIVEWAY MUST BE PAVED FROM EDGE OF PUBLIC ROAD TO RIGHT OF WAY LINE USING STANDARD PAVING SECTION P-1.

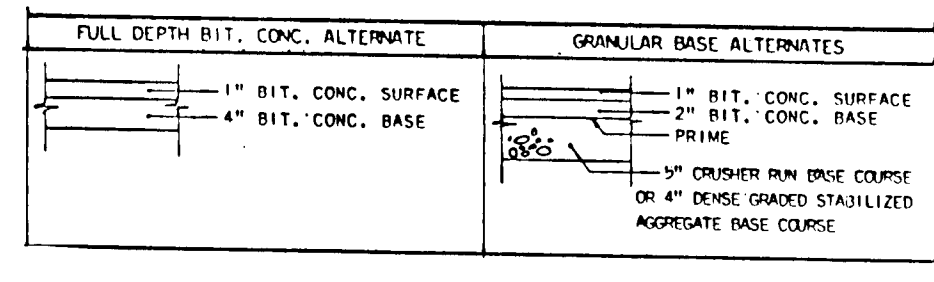

PAVING SECTION 'P-1'

SEDIMENT TRAP SCHEDULE

TRAP NO.	TIME OF TRAP	DRAINAGE AREA (ACRES)	STORAGE PROVIDED (CFS)	STORAGE PROVIDED (CF)	TRAP SIZE (W x L)	STORAGE DEPTH	BOTTOM ELEV.
1	SWALE ST-IV	0.24	432 CF	450 CF	5 x 45	2'	779.0
2	SWALE ST-IV	0.17	306 CF	320 CF	8 x 20	2'	704.0
3	SWALE ST-IV	0.26	468 CF	500 CF	5 x 50	2'	739.5

GENERAL NOTES

- ALL WORK SHALL BE PERFORMED IN ACCORDANCE WITH THE HOWARD COUNTY DESIGN MANUAL, VOL. IV, I.E., STANDARD SPECIFICATIONS AND DETAILS FOR CONSTRUCTION.
- APPROXIMATE LOCATION OF EXISTING UTILITIES ARE SHOWN. THE CONTRACTOR SHALL TAKE ALL NECESSARY PRECAUTIONS TO PROTECT THE EXISTING UTILITIES AND MAINTAIN UNINTERRUPTED SERVICE. ANY DAMAGE INCURRED DUE TO CONTRACTOR'S OPERATION SHALL BE REPAIRED IMMEDIATELY AT THE CONTRACTOR'S EXPENSE.
- THE CONTRACTOR SHALL TEST PIT FOR EXISTING UTILITIES AT LEAST FIVE (5) DAYS PRIOR TO STARTING WORK SHOWN ON THESE DRAWINGS.
- CONTRACTOR SHALL NOTIFY THE FOLLOWING UTILITIES AT LEAST FIVE (5) DAY PRIOR TO BEGINNING WORK SHOWN ON THESE DRAWINGS:

MISS UTILITY	559-0100
BELL TELEPHONE SYSTEM	292-3649
LONG DISTANCE CABLE DIVISION	392-3553/3554
BALTIMORE GAS & ELECTRIC COMPANY	539-8000
HOWARD COUNTY BUREAU OF UTILITIES	992-2366
HOWARD COUNTY CONSTRUCTION/INSPECTION SURVEY DIVISION (24 HOURS NOTICE PRIOR OF COMMENCEMENT OF WORK)	792-7272
- STORM DRAIN TRENCHES WITHIN ROAD RIGHTS-OF-WAY SHALL BE BACKFILLED AND COMPACTED IN ACCORDANCE WITH HOWARD COUNTY DESIGN MANUAL, VOL. IV, I.E., STANDARD SPECIFICATIONS AND DETAILS FOR CONSTRUCTION.
- INSTALLATION OF TRAFFIC CONTROL DEVICES, MARKING, AND SIGNING SHALL BE IN ACCORDANCE WITH THE MANUAL OF UNIFORM TRAFFIC CONTROL DEVICES, 1978 EDITION (REVISED).
- PIPE SHALL NOT BE INSTALLED BY CONTRACTOR UNTIL THE LENGTH CALLED FOR AT EACH STATION HAS BEEN APPROVED BY THE ENGINEER IN THE FIELD.
- DESIGNED TRAFFIC SPEED IN ACCORDANCE WITH THE AMERICAN ASSOCIATION OF STATE HIGHWAY OFFICIAL STANDARDS. (LOCAL RURAL ROAD) DESIGN SPEED = 30 MPH.
- ALL ELEVATIONS SHOWN ARE BASED ON U.S.C. AND G.S. MEAN SEA LEVEL DATUM, 1929.
- ALL FILL AREAS WITHIN ROADWAYS AND/OR UNDER STRUCTURES TO BE COMPACTED TO A MINIMUM 95% COMPACTION.
- ALL PIPE ELEVATIONS SHOWN ARE INVERT ELEVATIONS.
- PROFILE STATIONS SHALL BE ADJUSTED AS NECESSARY TO CONFORM TO PLAN DIMENSIONS.
- SUBJECT PROPERTY ZONED R PER 08-02-85 COMPREHENSIVE ZONING PLAN.
- TOP SOIL SHOWN HEREON AS FIELD RUN BY BOENDER ASSOCIATES ON MAY 1987.
- NO PIPE SHALL BE LAID IN PLACE UNTIL LINES OF EXCAVATION HAVE BEEN BROUGHT TO WITHIN SIX (6) INCHES OF FINISHED GRADE ELEVATIONS.
- ALL STORM DRAIN PIPE BEDDING SHALL BE CLASS #8 AS SHOWN IN FIG. 11.4 OF THE HOWARD COUNTY DESIGN MANUAL, VOL. IV, UNLESS OTHERWISE NOTED.

APPROVED: HOWARD COUNTY DEPARTMENT OF PUBLIC WORKS

Michael A. Lee 11-9-87
Chief, Land Development Division Date

Ramona W. Wehner 11/20/87
Chief, Bureau of Highways Date

William E. Pines 11-24-87
Chief, Bureau of Engineering Date

APPROVED: OFFICE OF PLANNING AND ZONING

John M. Muehman 11-9-87
Chief, Division of Land Development and Zoning Administration Date

REVIEWED FOR HOWARD S.C.D. AND MEETS TECHNICAL REQUIREMENTS.

James M. Nelson 11-9-87
U.S. SOIL CONSERVATION SERVICE DATE

THIS DEVELOPMENT IS APPROVED SOIL EROSION AND SEDIMENT CONTROL BY THE HOWARD SOIL CONSERVATION DISTRICT.

Stephanie Nelson 11/9/87
SOIL CONSERVATION DISTRICT DATE

DEVELOPER'S CERTIFICATE

"I/WE CERTIFY THAT ALL DEVELOPMENT AND/OR CONSTRUCTION WILL BE DONE ACCORDING TO THESE PLANS, AND THAT ANY RESPONSIBLE PERSONNEL INVOLVED IN THE CONSTRUCTION PROJECT WILL HAVE A CERTIFICATE OF ATTENDANCE AT A DEPARTMENT OF NATURAL RESOURCES APPROVED TRAINING PROGRAM FOR THE CONTROL OF SEDIMENT AND EROSION BEFORE BEGINNING THE PROJECT. I WILL PROVIDE THE HOWARD SOIL CONSERVATION DISTRICT WITH AN "AS-BUILT" PLAN OF THE POND WITHIN 30 DAYS OF COMPLETION. I ALSO AUTHORIZE PERIODIC ON-SITE INSPECTION BY THE HOWARD SOIL CONSERVATION DISTRICT."

Wanda Hoag 11-9-87
DEVELOPER DATE

ENGINEER'S CERTIFICATE

"I CERTIFY THAT THIS PLAN FOR POND CONSTRUCTION, EROSION AND SEDIMENT CONTROL REPRESENTS A PRACTICAL AND WORKABLE PLAN BASED ON MY PERSONAL KNOWLEDGE OF THE SITE CONDITIONS. THIS PLAN WAS PREPARED IN ACCORDANCE WITH THE REQUIREMENTS OF THE HOWARD SOIL CONSERVATION DISTRICT. I HAVE NOTIFIED THE DEVELOPER THAT HE MUST PROVIDE THE HOWARD SOIL CONSERVATION DISTRICT WITH AN "AS-BUILT" PLAN OF THE POND WITHIN 30 DAYS OF COMPLETION."

Stephanie Nelson 11-9-87
ENGINEER DATE

DATE	DESCRIPTION	BY

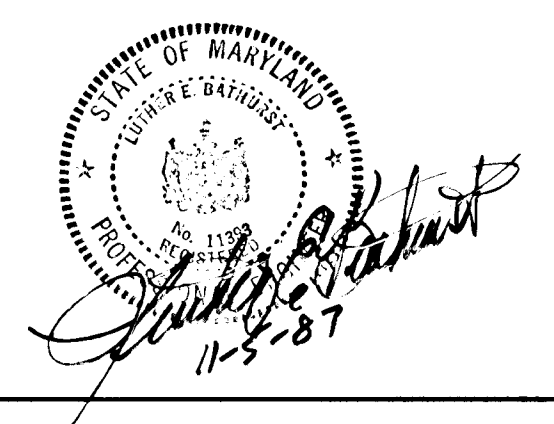

TITLE: DETAILS

PROJECT: LAURAND LOTS 1-8

LOCATION: 14500 W. TAYLOR ST. L. 97.4E

4TH ELECTION DISTRICT HOWARD CO. MD.

SCALE: DESIGNED BY: EWA DRAWN BY: EWA CHECKED BY: EWA DATE: 11/9/87

FIELD BOOK: PAGE NO.: JOB NO.: 86476 DRAWING NO.: 2 OF 2

boender associates inc.
consulting engineers
land planners
land surveyors

COURTHOUSE SQUARE
3565 ELLICOTT MILLS DRIVE
ELLICOTT CITY, MD. 21043
13011 465-7777

COORDINATE SCHEDULE		
NUMBER	NORTH	EAST
1	551686 7020	764078 2310
2	551578 7137	764928 5652
3	550136 8545	764316 6763
4	550305 0134	764041 1245
5	550395 2354	763703 3037
6	550504 6019	763737 9188
7	55084 8603	763262 3809
8	551731 2775	763865 0725
9	55060 1988	764326 3828
10	550835 7477	763276 1183

6 Central Stations 3818001 43828002

MARY H. HOUGH
2.93/75

RICHARD M. HOUGH
0.63/85

Note:-
This 100 Yr. Floodplain has been submitted and approved under "Country View" F-87-124

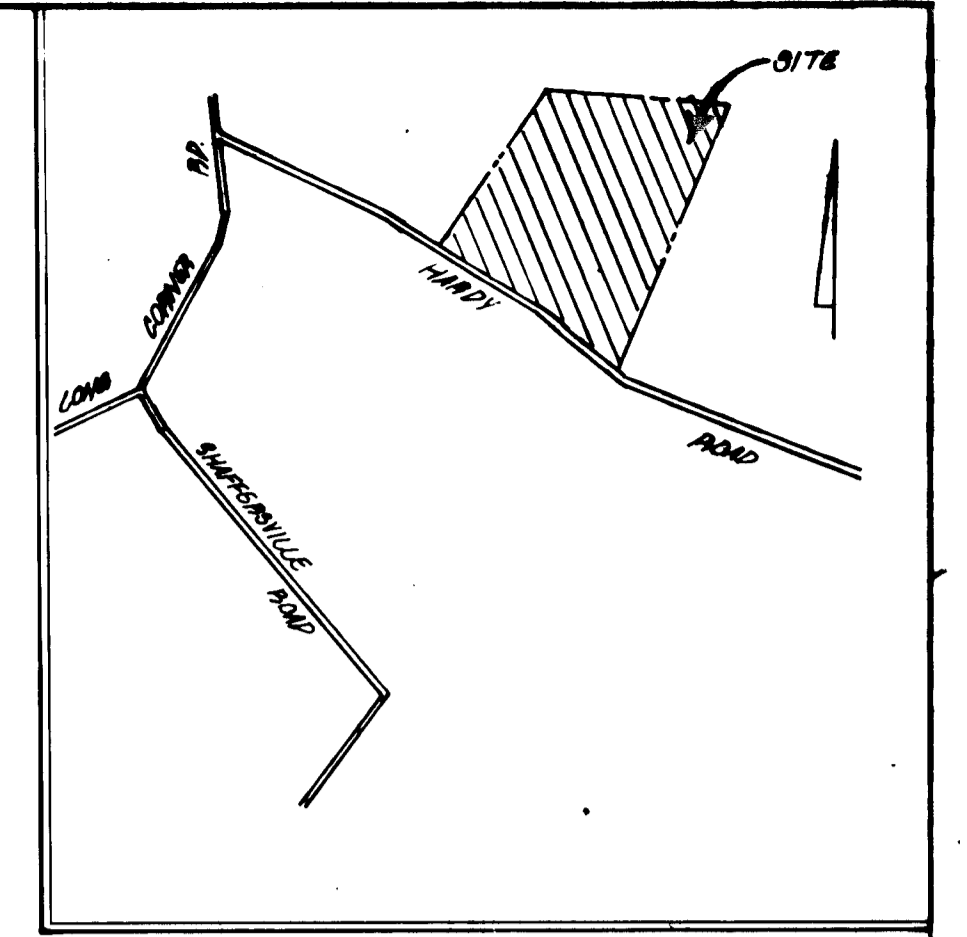

VICINITY MAP
SCALE: 1"=600'

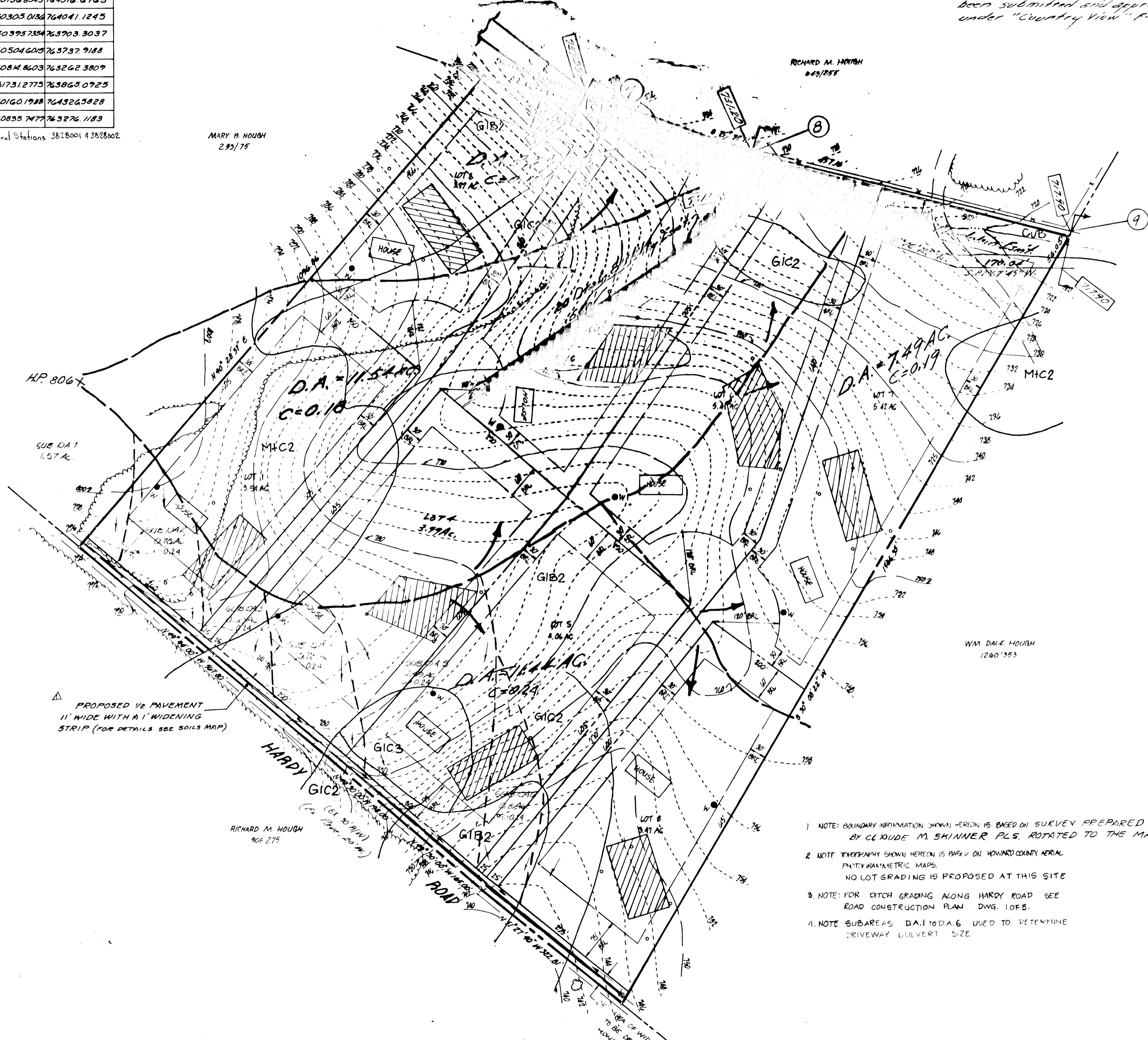

GENERAL NOTES

- 1) TAX MAP 7 PARCEL 391
- 2) DEED REFERENCE: 643/253
- 3) EX ZONING: R
- 4) TOTAL AREA OF SITE: 34.382 AC.
- 5) AREA OF LOTS: 33.14
- 6) AREA OF ROAD DEDICATION: 0.712 AC.
- 7) TOTAL NO. OF LOTS: 8
- 8) PRIVATE WATER AND PRIVATE SEWAGE SYSTEMS TO BE UTILIZED.
- 9) TOTAL AREA OF OPEN SPACE: NONE
- 10) MINIMUM LOT SIZE: 3.00 AC.
- 11) TOTAL AREA OF FLOODPLAIN: 1.2576 AC.
- 12) SEDIMENT CONTROL MEASURES TO BE PROVIDED ON FINAL ROAD CONSTRUCTION PLANS.
- 13) COMMON DRIVEWAYS SHALL CONFORM TO THE REQUEST OF THE MD CO. FIRE DEPT.

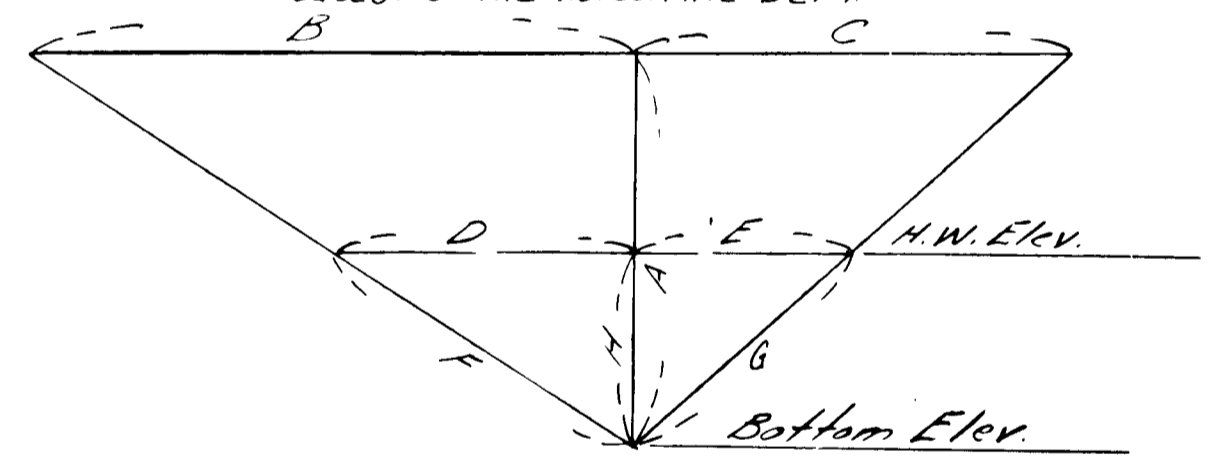

TYPICAL CROSS SECTION FOR 100 YR. FLOODPLAIN (Approved under F-87-124)
(No SCALE)

CROSS SECT	A	B	C	H	Q	vel.
7	4.41'	50'	48'	1.47'	106.1	7.01
8	5.08'	140'	115'	1.20'	173.5	4.78
9	3.48'	91'	94'	1.38'	247.0	4.88

- 1) NOTE: BOUNDARY INFORMATION SHOWN HEREIN IS BASED ON SURVEY PREPARED BY CLAUDE M. SHANNON PLS. ROTATED TO THE MARYLAND STATE PLANE COOR. SYSTEM
- 2) NOTE: TOPOGRAPHY SHOWN HEREIN IS BASED ON HOWARD COUNTY AERIAL PHOTOGRAMMETRIC MAPS. NO LOT GRADING IS PROPOSED AT THIS SITE
- 3) NOTE: FOR DITCH GRADING ALONG HARDY ROAD SEE ROAD CONSTRUCTION PLAN DWG. 106B.
- 4) NOTE: SUBAREAS D.A.1 TO D.A.6 USED TO DETERMINE DRIVEWAY CULVERT SIZE

APPROVED: HOWARD COUNTY DEPARTMENT OF PUBLIC WORKS
 Director, Land Development Division
 Director, Bureau of Highways
 Director, Bureau of Engineering

DEVELOPER'S CERTIFICATE
 "I HEREBY CERTIFY THAT ALL DEVELOPMENT AND/OR CONSTRUCTION WILL BE DONE ACCORDING TO THESE PLANS, AND THAT ANY RESPONSIBLE PERSONNEL INVOLVED IN THE CONSTRUCTION PROJECT WILL HAVE A CERTIFICATE OF ATTENDANCE AT A DEPARTMENT OF NATURAL RESOURCES APPROVED TRAINING PROGRAM FOR THE CONTROL OF SEDIMENT AND EROSION BEFORE BEGINNING THE PROJECT. I WILL PROVIDE THE HOWARD SOIL CONSERVATION DISTRICT WITH AN "AS-BUILT" PLAN OF THE POND WITHIN 30 DAYS OF COMPLETION. I ALSO AUTHORIZE PERIODIC ON-SITE INSPECTION BY THE HOWARD SOIL CONSERVATION DISTRICT."
 ENGINEER'S CERTIFICATE
 "I CERTIFY THAT THIS PLAN FOR POND CONSTRUCTION, EROSION AND SEDIMENT CONTROL REPRESENTS A PRACTICAL AND WORKABLE PLAN BASED ON MY PERSONAL KNOWLEDGE OF THE SITE CONDITIONS. THIS PLAN WAS PREPARED IN ACCORDANCE WITH THE REQUIREMENTS OF THE HOWARD SOIL CONSERVATION DISTRICT. I HAVE NOTIFIED THE DEVELOPER THAT HE MUST PROVIDE THE HOWARD SOIL CONSERVATION DISTRICT WITH AN "AS-BUILT" PLAN OF THE POND WITHIN 30 DAYS OF COMPLETION."

OWNER & DEVELOPER
 WAYNE HOUGH
 17740 HARDY ROAD
 MT AIRY, MD. 21771

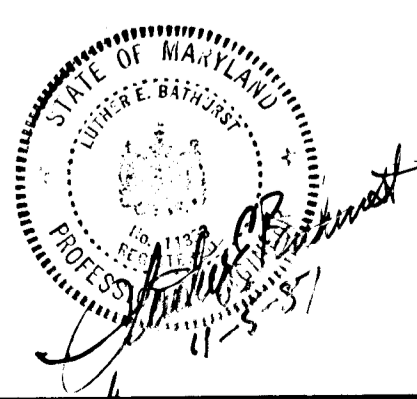

PROJECT: DRAINAGE AREA MAP
 PROJECT: LAURAND
 LOCATION: TAX MAP 7 PARCEL 391 S-87-45
 4 TH ELECTION DISTRICT HOWARD CO. MD.
 DESIGNED BY: DA UCO
 DRAWN BY: UCO
 CHECKED BY: D.A.
 DATE: NOV, 1986
 FIELD BOOK: PAGE NO. JOB NO. DRAWING NO.:
 80420 5 OF 3

boender associates inc.
 consulting engineers
 land surveyors
 land planners
 COURTHOUSE SQUARE
 3565 ELLICOTT MILLS DRIVE
 ELLICOTT CITY, MD. 21043
 (301) 465-7777

DATE	DESCRIPTION	BY
10/30	SUB D.A. FOR CULVERTS ADDED	E.U.A.

1338

AS-BUILT 11-28-88 F-88-66