

GENERAL NOTES

- PIPE LENGTHS AND LOCATIONS ARE TO BE DEFINITELY DETERMINED IN THE FIELD BEFORE ORDERING.
- ALL STORM DRAINS SHALL BE CONSTRUCTED IN ACCORDANCE WITH THE LATEST EDITION OF THE MARYLAND DEPARTMENT OF TRANSPORTATION STANDARD SPECIFICATIONS FOR CONSTRUCTION AND MATERIALS.
- TYPES OF STRUCTURES REFER TO THE MARYLAND STATE HIGHWAY STANDARD STORM DRAINAGE DETAILS UNLESS OTHERWISE NOTED.
- INFORMATION CONCERNING UNDERGROUND UTILITIES WAS OBTAINED FROM AVAILABLE RECORDS, BUT THE CONTRACTOR MUST DETERMINE THE EXACT LOCATION AND ELEVATIONS OF THE MAINS BY DIGGING TEST PITS BY HAND AT ALL UTILITY CROSSINGS, WELL IN ADVANCE OF TRENCHING. IF CLEARANCE IS LESS THAN SHOWN ON THIS PLAN OR TWELVE (12) INCHES WHICHEVER IS LESS, CONTACT THE STORM DRAIN SECTION OF HOWARD COUNTY DEPARTMENT OF PUBLIC WORKS BEFORE PROCEEDING WITH CONSTRUCTION.
- ALL COORDINATES BASED ON THE MARYLAND STATE GRID SYSTEM.

BENCH MARKS

- B.M. 1 = TOP I.P.F. = 419.25
- B.M. 2 = TOP I.P.F. = 408.51
- B.M. 4 = N & C TOP OF CURB = 410.46

EX. MH	TOP	INV.
1	425.7	421.2

NO.	CURVE			DATA		
	RADIUS	ARC	TAN.	C. B.	C. DIST.	
A	1079.5'	328.81'	165.69'	17° 27' 07"	N 40° 59' 39" E	327.54'
B	840.0'	110.35'	55.25'	07° 31' 36"	S 47° 21' 2" E	110.27'
C	460.0'	546.94'	311.00'	68° 07' 29"	S 17° 03' 28" E	515.29'

STRUCTURE SCHEDULE						
NO.	DESCRIPTION	LOCATION	INV. IN	INV. OUT	TOP	REMARKS
M-1	STD. SHALLOW MH	SEE PLAN	418.6	418.4	423.8	MD. STD. 383.00
C-1	CONC. END SECTION	SEE PLAN	417.0	416.8	-	MD. STD. 368.01

APPROVED: HOWARD COUNTY OFFICE OF PLANNING AND ZONING
[Signature] 11-18-87
 CHIEF, DIVISION OF LAND DEVELOPMENT AND ZONING ADMINISTRATION

APPROVED: HOWARD COUNTY DEPARTMENT OF PUBLIC WORKS
[Signature] 11/18/87
 Chief, Land Development Division
[Signature] 11/12/87
 Chief, Bureau of Highways
 Date 11/10/87

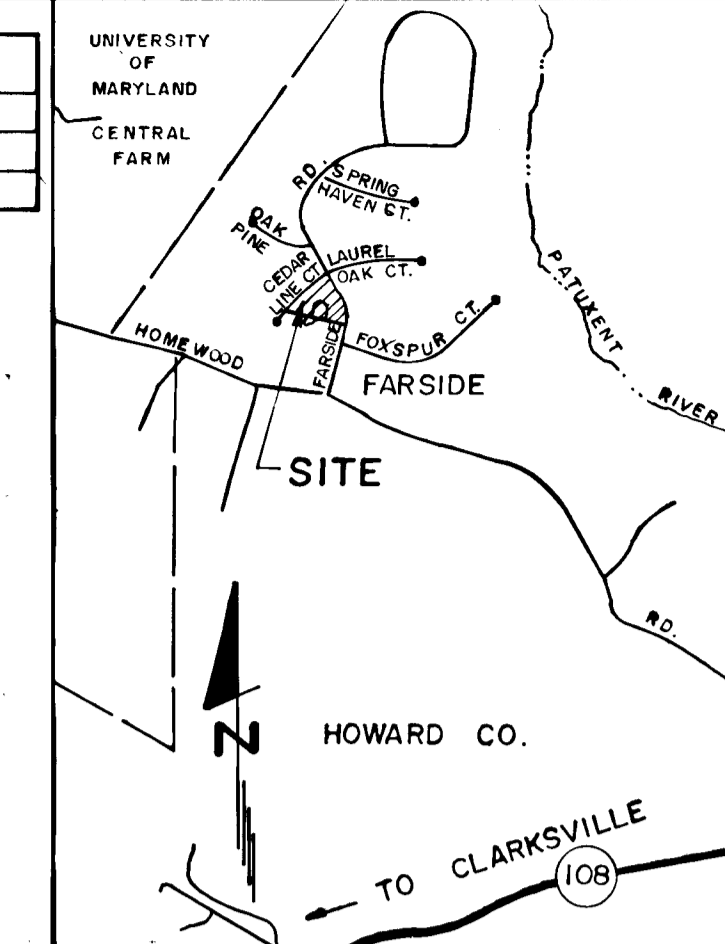

VICINITY MAP
SCALE: 1" = 2000'

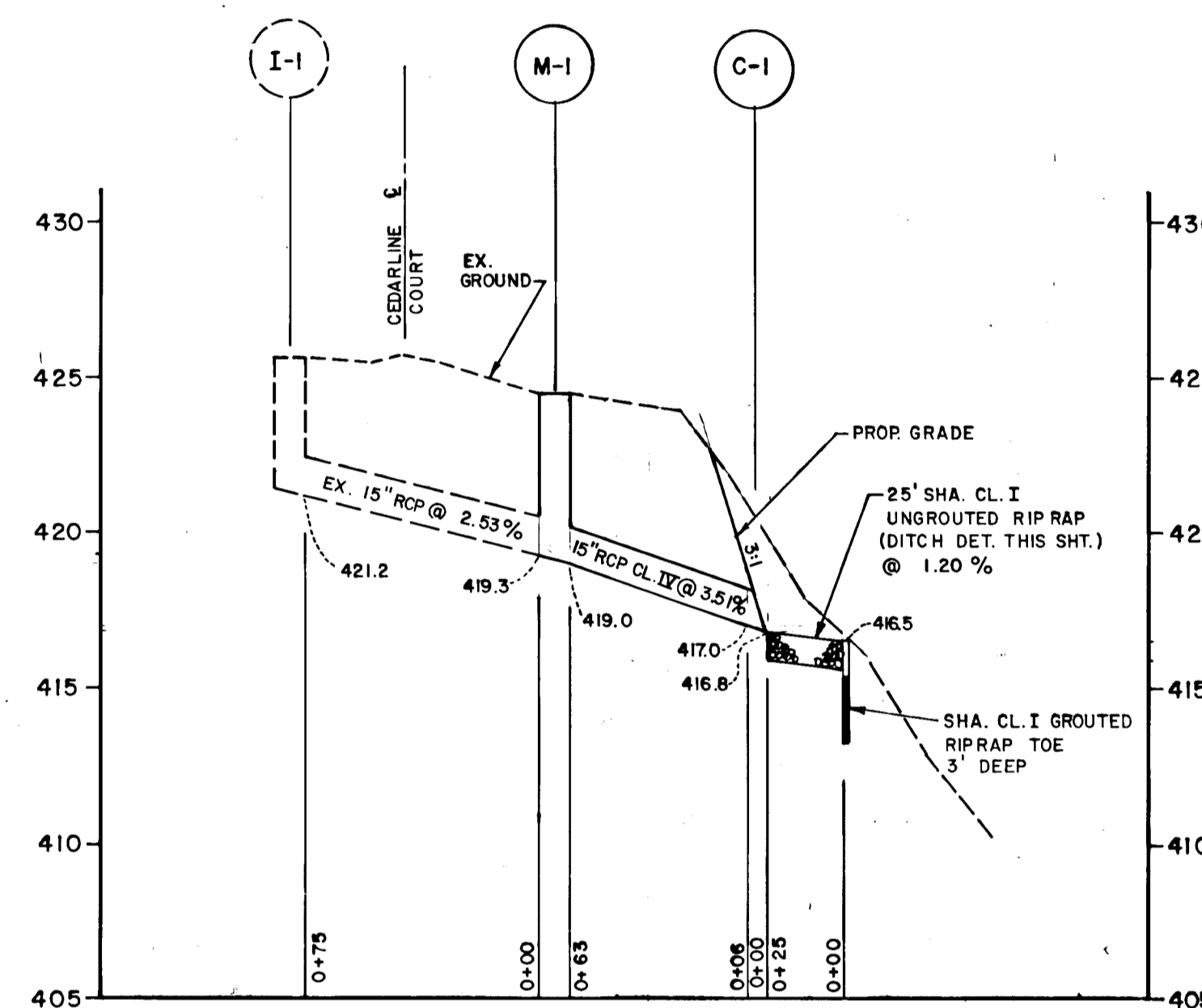
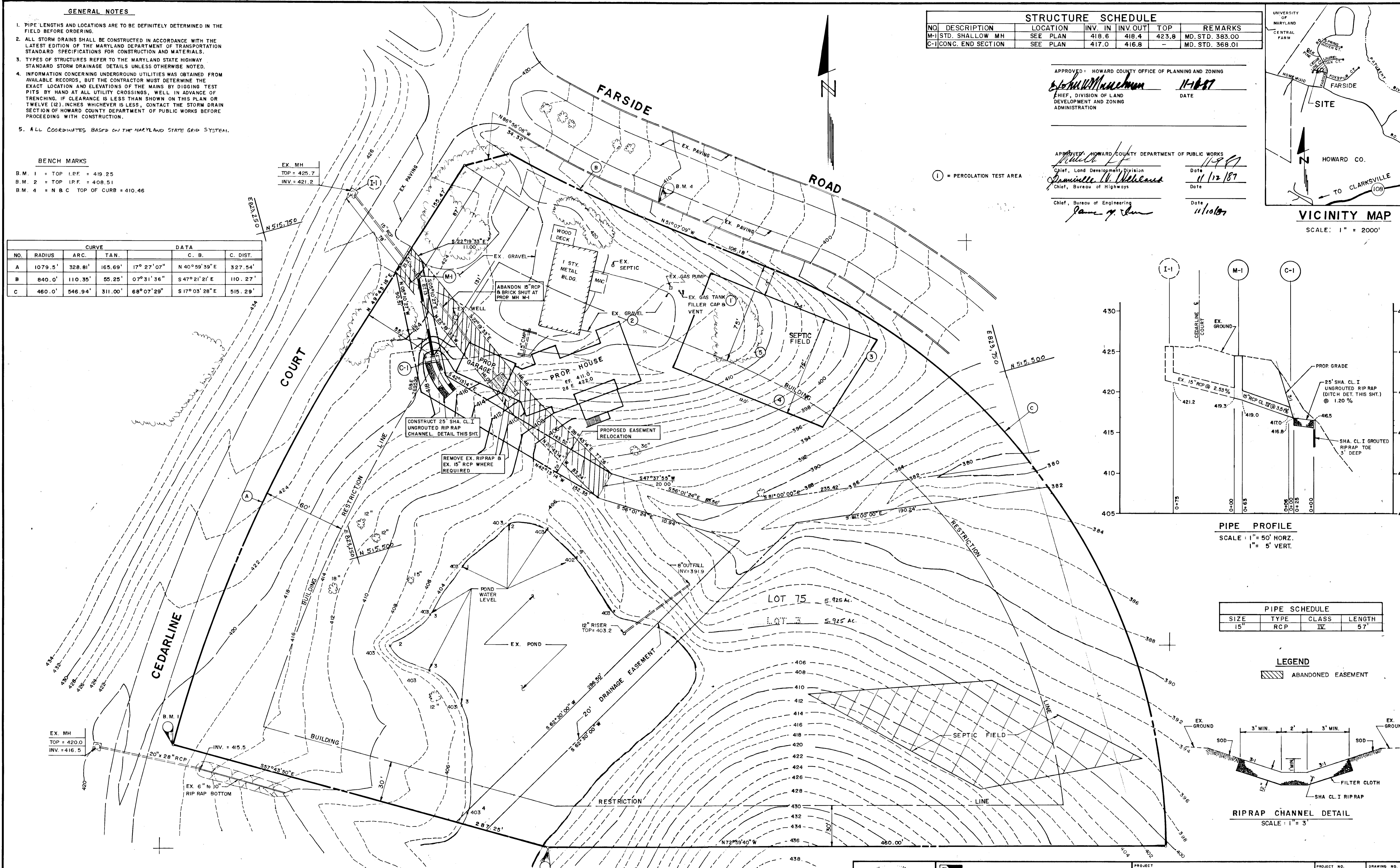

PIPE PROFILE
SCALE: 1" = 50' HORIZ.
1" = 5' VERT.

PIPE SCHEDULE			
SIZE	TYPE	CLASS	LENGTH
15"	RCP	IV	57'

LEGEND
 ABANDONED EASEMENT

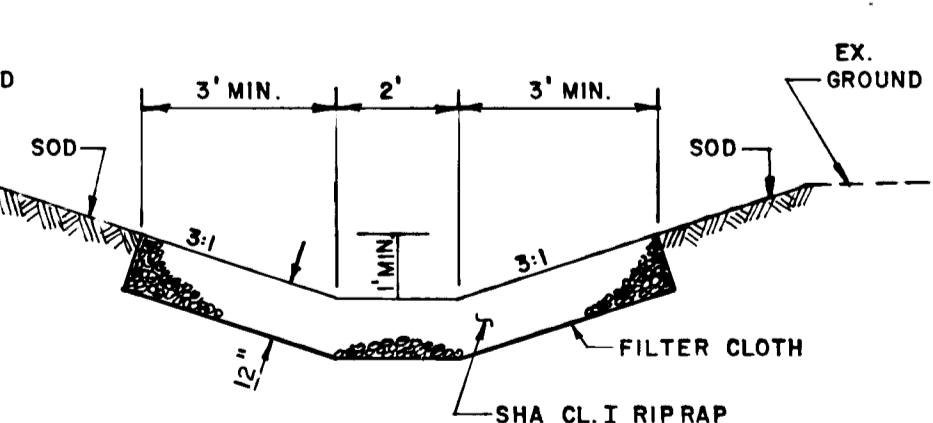

RIPRAP CHANNEL DETAIL
SCALE: 1" = 3'

REVISIONS			
DATE	BY	DESCRIPTION	
10/26/87	WK	CHORD BEARING	

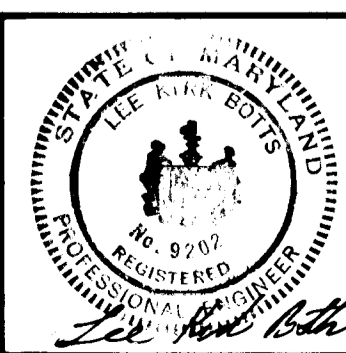

PROGRESSIVE ENGINEERING CONSULTANTS
 14333 LAUREL-BOWIE ROAD, SUITE 108
 LAUREL, MARYLAND 20708
 (301) 621-1050 (Wash.), (301) 792-8632 (Balt.)

FARSIDE POND
 RESIDENCE OF
 MR. & MRS. DAVID K. CUMMINGS
 11673 FARSIDE ROAD
 ELLICOTT CITY, MD. 21043
 (301) 490-6400

PROJECT NO.	86-123	DRAWING NO.	1 OF 1 SHEETS
SCALE	1" = 30'		
DATE	11/86		
DRAWN BY	TAN		
CHECKED BY	LKB		

792

F-88-59