

CURB CUTTER LEGEND

Std. 7" Comb. C of G	—
Rev. 7" Comb. C of G	—
Std. 6" Comb. C of G	—
Rev. 6" Comb. C of G	—
SHA Type A C of G	—

where indicated

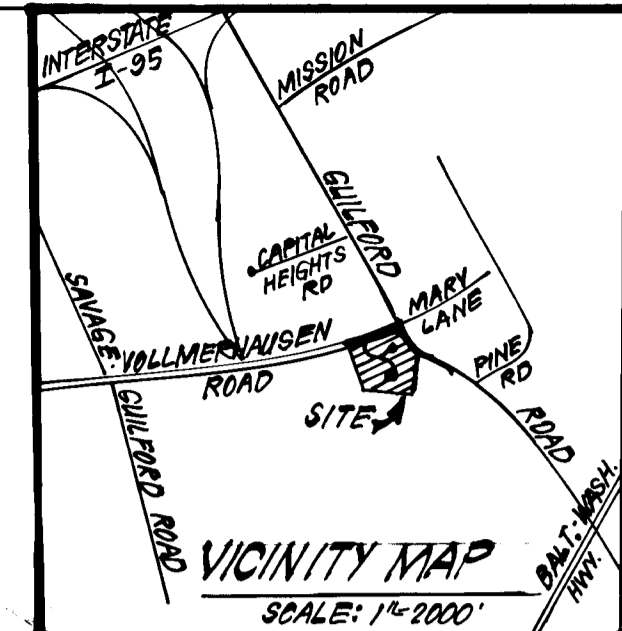

- GENERAL NOTES:**
- All storm drain and paving shall be constructed in accordance with the latest details and specifications of Howard County & Md SHA.
 - Types of Storm Drain structures refer to the Standard Details of Howard County & Maryland State Highway Administration.
 - Trench Compaction for storm drains, within Road or Street rights of way limits shall be in accordance with Howard Co. Design Manual Vol. II (Class 10" Trench Bedding to be used for all Storm Drains except where shown otherwise).
 - Information concerning underground utilities was obtained from available records, but the contractor must determine the exact location and elevation of the mains by digging, test pits, by hand, at all utility crossings, well in advance of construction.
 - All utility companies shall be notified 24 hrs in advance of construction.
 - All traffic control services, parking, and signing to be done in accordance with the "Manual of Uniform Traffic Control Devices," 1971 Edition.
 - Sag and Crest Vertical curves were designed in accordance with "A Policy on Geometric Design of Rural Highways," 1965, by AASHTO.
 - Provide Concrete Sidewalk ramps, to be Std. Type A, R.4.01 where shown in plan.
 - Design speeds 30 mph, 50' R/W zoning: RSA 35 mph, 80' R/W.
 - EL-1905* Indicates 100 yr Flood Plain Elevation.
 - The contractor or developer shall contact the Construction Inspection/Survey Division 24 hrs. in advance of commencement of work at 702-7272.

APPROVED: DEPARTMENT OF PUBLIC WORKS:
K. Edman & Sons 10/23/84
 Chief, Bureau of Engineering
 APPROVED: HOWARD COUNTY OFFICE OF PLANNING AND ZONING
James F. Dyer 10-19-84
 Chief, Division of Land Development & Zoning Administration

CLARK · FINEFROCK & SACKETT
 ENGINEERS · PLANNERS · SURVEYORS
 11315 LOCKWOOD DRIVE SILVER SPRING, MARYLAND 20904 (301) 593-3400

DESIGNED	ROAD CONSTRUCTION PLANS	SCALE
DRAWN	WILLOWOOD WAY	AS SHOWN
KIW	AND VOLLMERHAUSEN RD, GUILFORD ROAD (MD. RTE #32)	DRAWING
CHECKED	ASPENWOOD	10FG
DATE	SECTION 2	JOB NO.
7-23-84	6TH ELECTION DISTRICT	84-046
	HONARD COUNTY, MARYLAND	FILE NO.
	FOR: CAPITAL HOMES, INC.	84-046-D
	Suite 200, 6500 Rock Spring Dr.	
	The Bedford Bldg, Bethesda, Md. 20834	

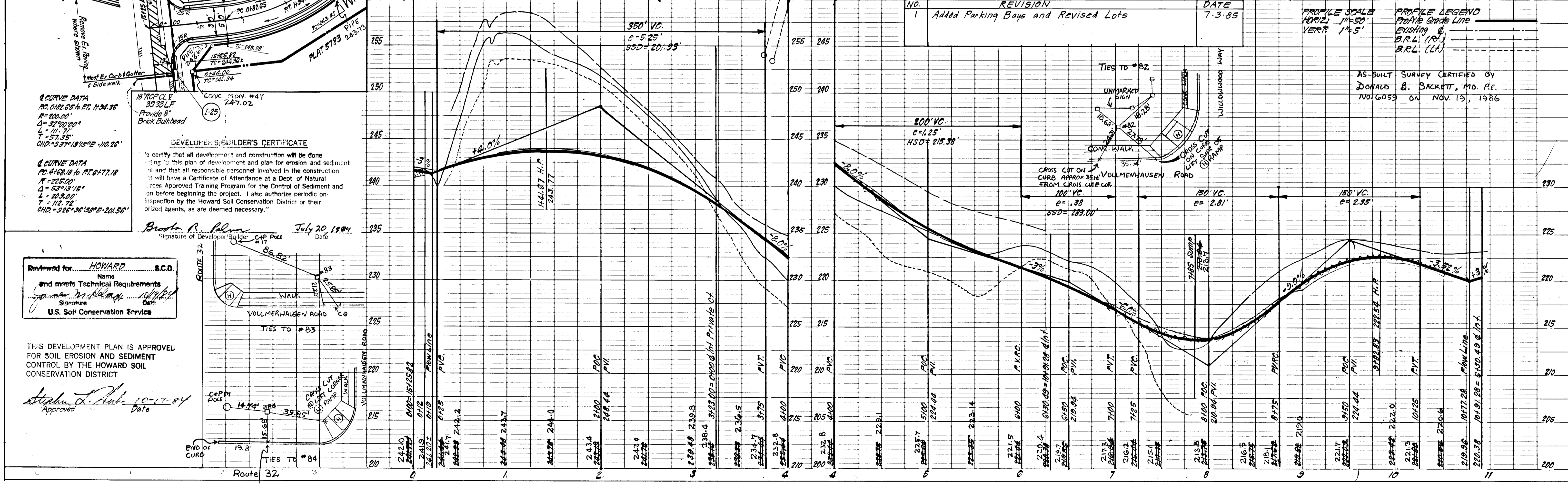

DEVELOPER'S/BUILDER'S CERTIFICATE

I certify that all development and construction will be done in accordance with this plan of development and plan for erosion and sediment control and that all responsible personnel involved in the construction of this project will have a Certificate of Attendance at a Dept. of Natural Resources Approved Training Program for the Control of Sediment and on before beginning the project. I also authorize periodic on-site inspection by the Howard Soil Conservation District or their authorized agents, as are deemed necessary.

Brooks R. Palmer July 20, 1984
 Signature of Developer/Builder C&P Pole Date

Reviewed for: **HOWARD S.C.D.**
 Name
 and meets Technical Requirements
W. S. Sackett 10/19/84
 Signature Date
 U.S. Soil Conservation Service

THIS DEVELOPMENT PLAN IS APPROVED FOR SOIL EROSION AND SEDIMENT CONTROL BY THE HOWARD SOIL CONSERVATION DISTRICT.

Stephen L. Paul 10-17-84
 Approved Date

#1025

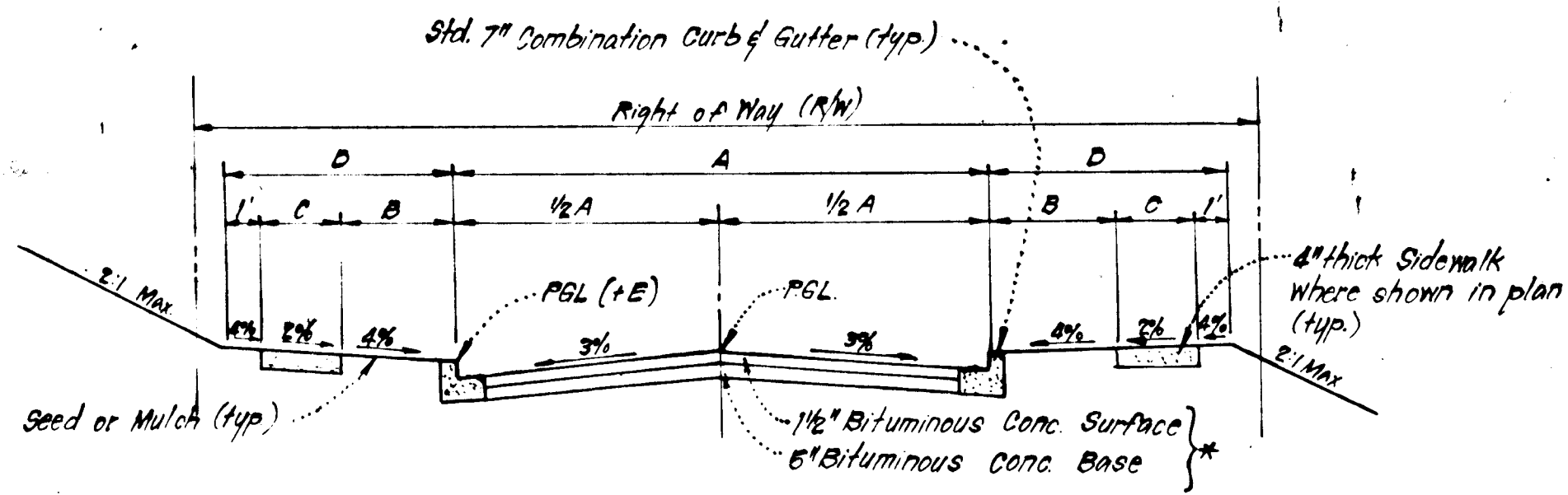

STREET NAME & STATION	TYPE OF TRAFFIC	A	B	C	D	R/W	ZONING	DESIGN SPEED	E
Willowwood Way Sta. 0+00 to 1-23	LOCAL	30'	4'	4'	0'	50'	RSA	30 mph	10
Willowwood Way Sta. 3-23 to 8-34.25	CUL-de-SAC	28'	4'	4'	0'	50'	RSA	30 mph	14

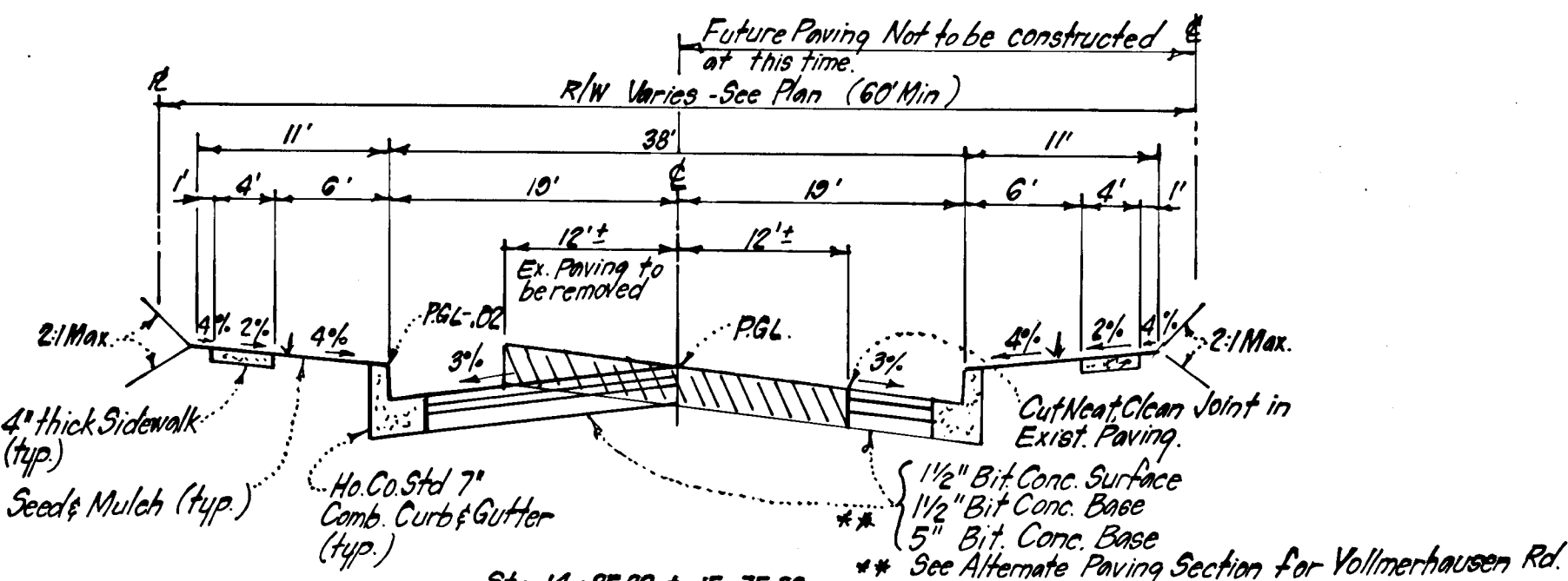

TYPICAL PAVING SECTION - VOLLMERHAUSEN ROAD

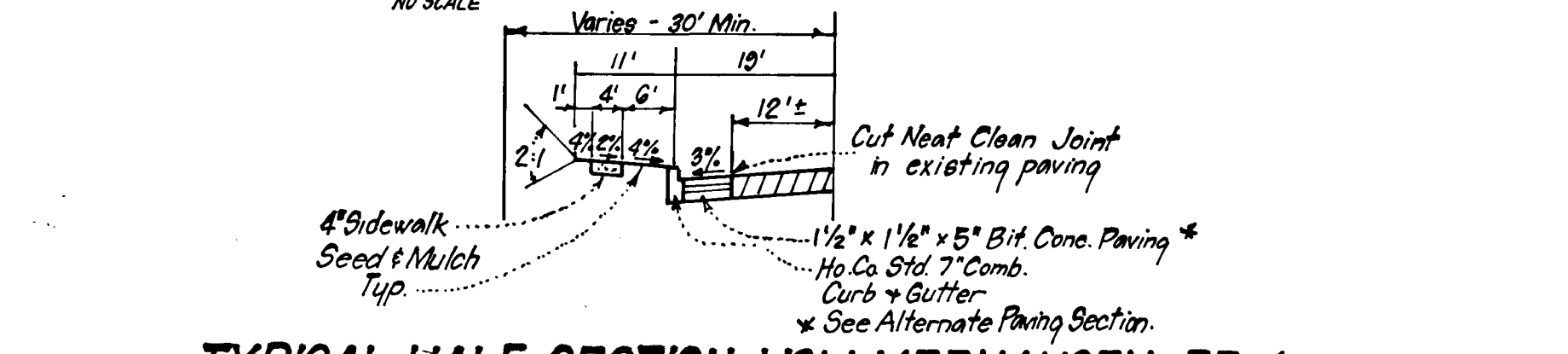

TYPICAL HALF SECTION - VOLLMERHAUSEN RD. (Sta. 10+50 to 14+85.82)

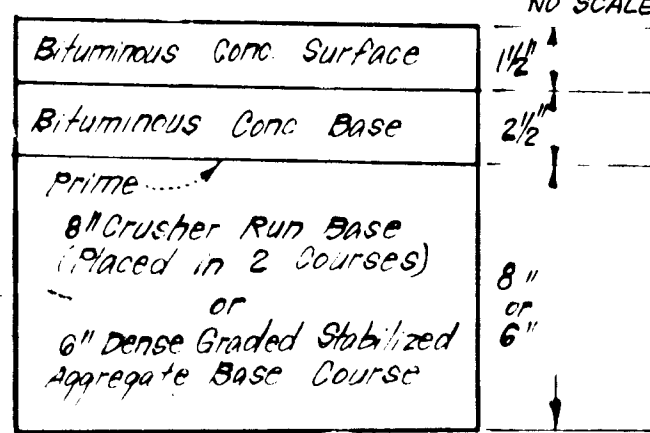

ALTERNATE PAVING SECTION FOR PUBLIC ROADS

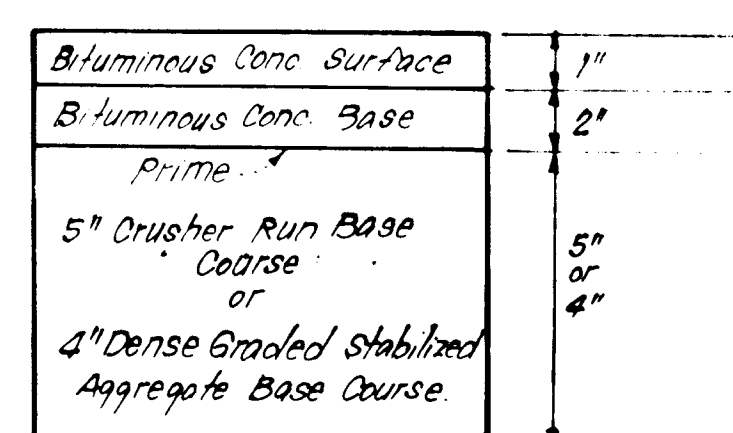

ALTERNATE PAVING SECTION FOR PARKING AREAS

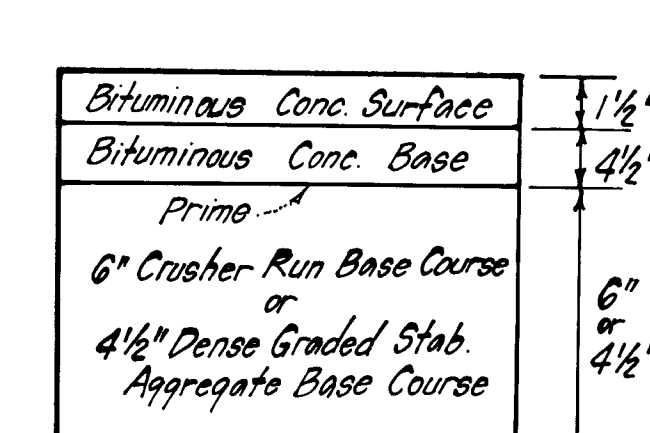

ALTERNATE PAVING SECTION VOLLMERHAUSEN ROAD

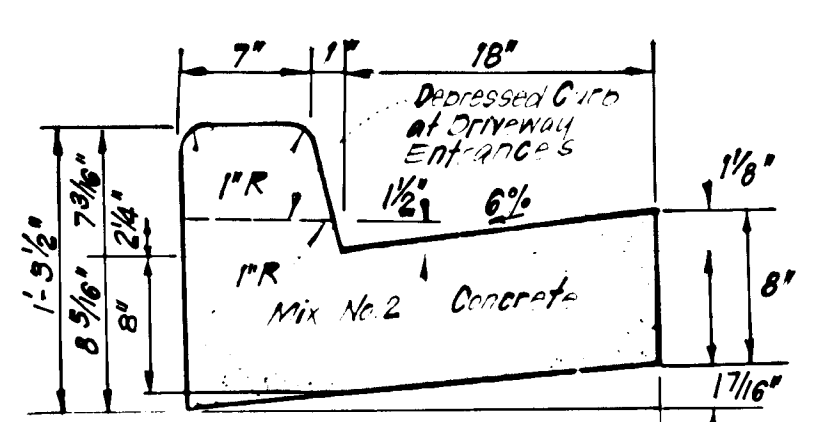

STANDARD 7\"/>

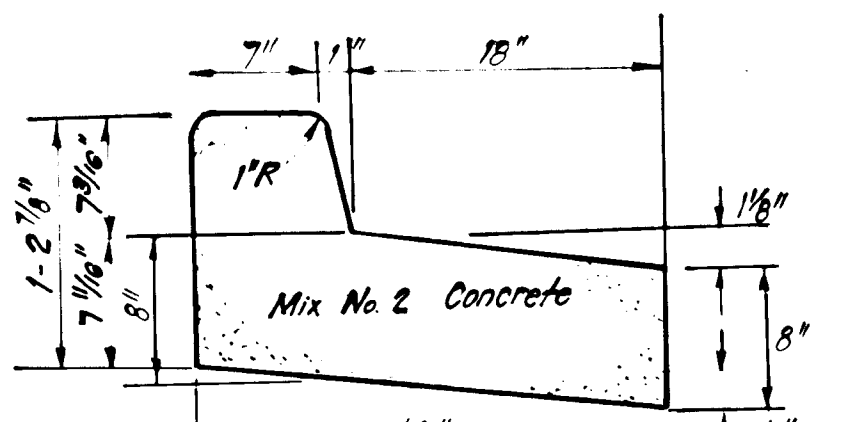

REVERSE 7\"/>

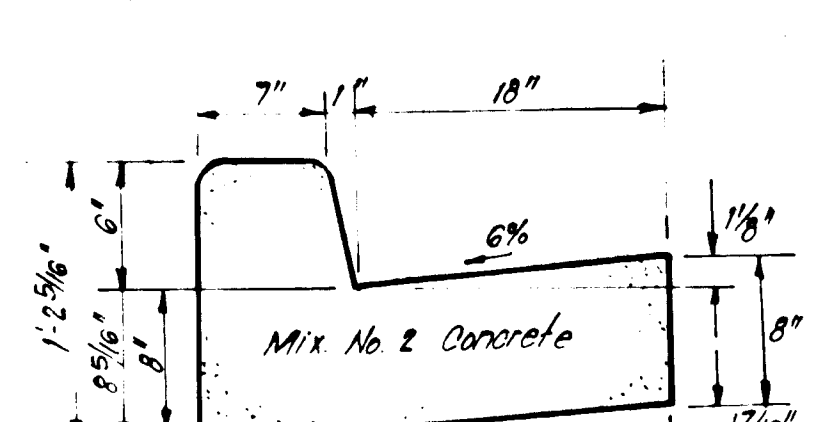

STANDARD 6\"/>

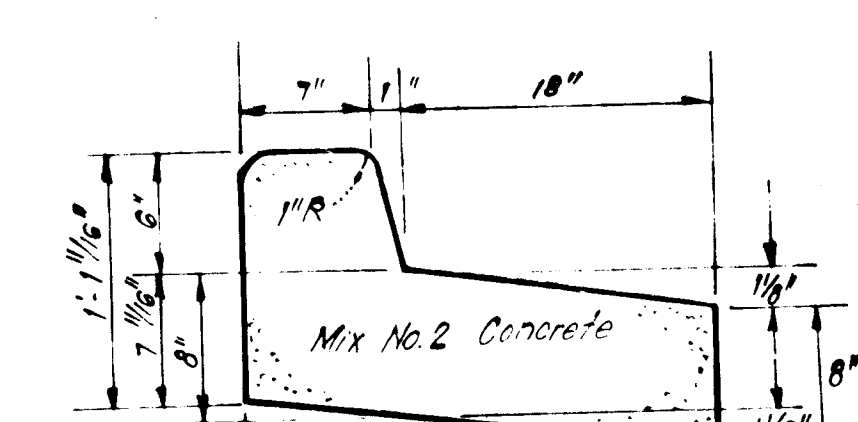

REVERSE 6\"/>

#1025

No SCALE

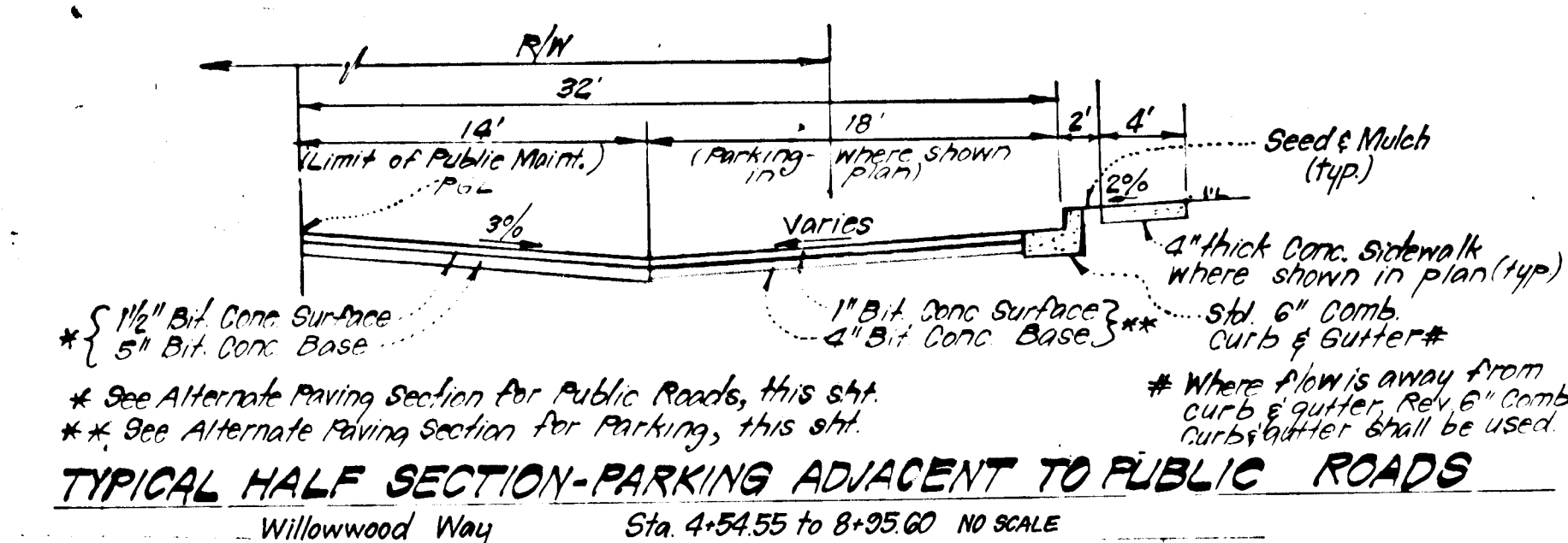

TYPICAL HALF SECTION - PARKING ADJACENT TO PUBLIC ROADS

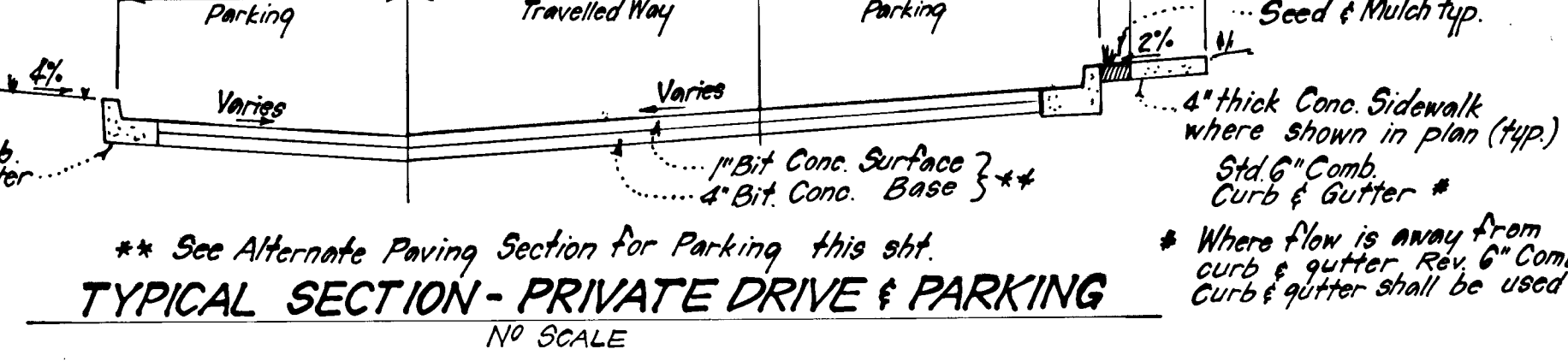

TYPICAL SECTION - PRIVATE DRIVE & PARKING

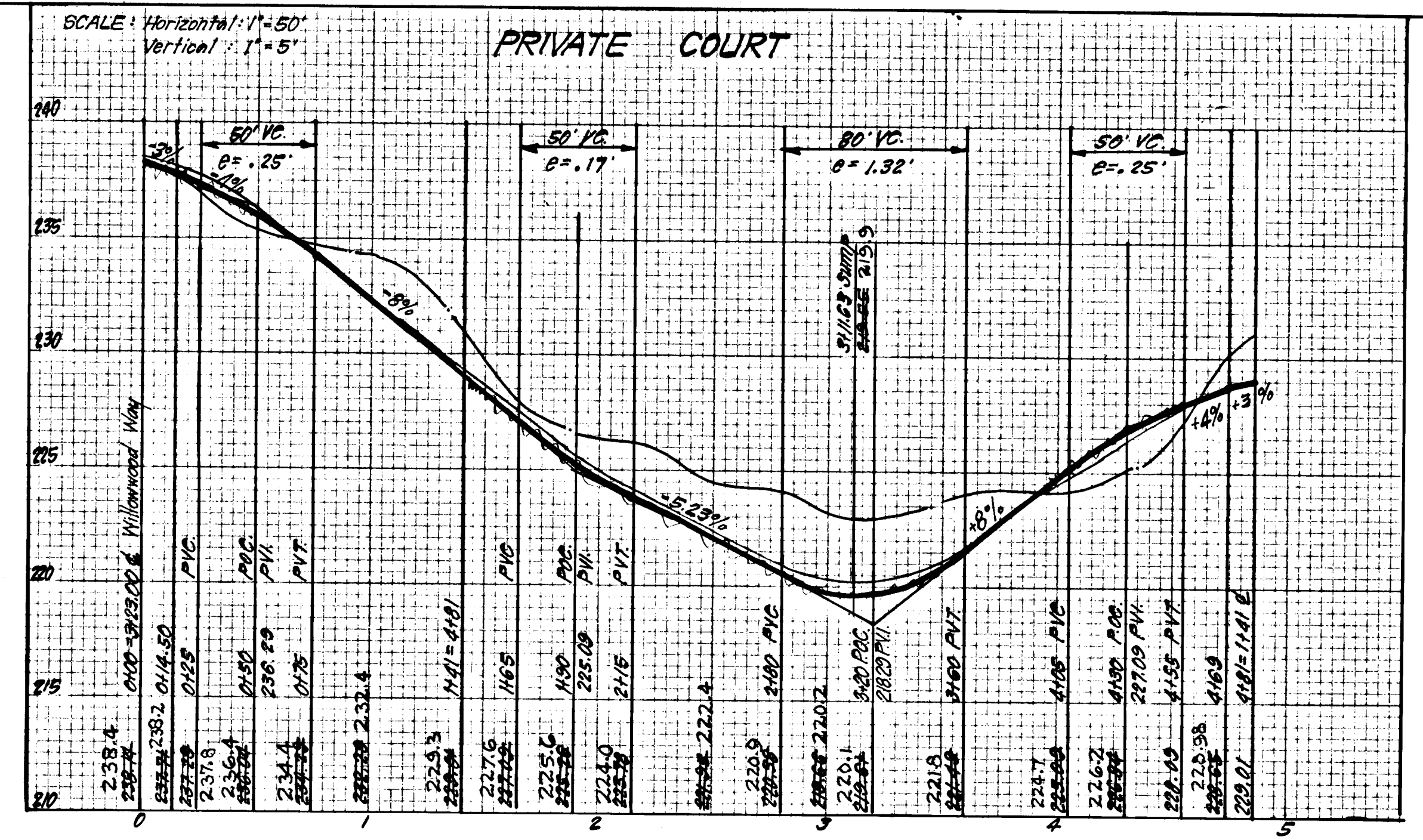

AS-BUILT SURVEY CERTIFIED BY DONALD B. SACKETT, P.E. NO. 6059 ON NOV. 19, 1986

Reviewed for: HOWARD S.C.D. Name: and meets Technical Requirements Signature: Date: U.S. Soil Conservation Service

THIS DEVELOPMENT PLAN IS APPROVED FOR SOIL EROSION AND SEDIMENT CONTROL BY THE HOWARD SOIL CONSERVATION DISTRICT.

Approved: Louis F. Down Date: 10-17-84

No SCALE

No SCALE

TYPICAL PARKING

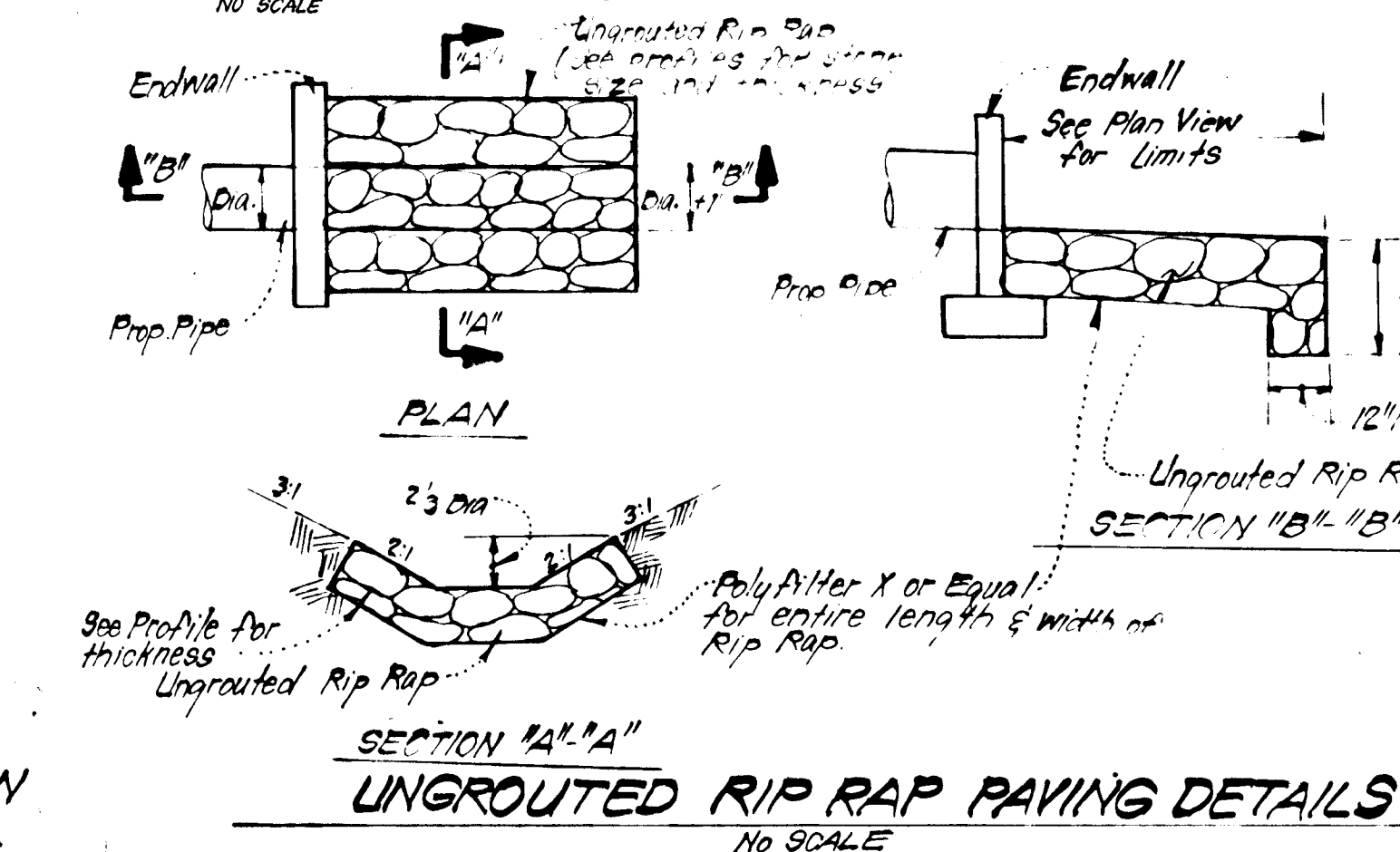

SECTION 14\"/>

DEVELOPER'S/BUILDER'S CERTIFICATE

"I/We certify that all development and construction will be done according to this plan of development and plan for erosion and sediment control and that all responsible personnel involved in the construction project will have a Certificate of Attendance at a Dept. of Natural Resources Approved Training Program for the Control of Sediment and Erosion before beginning the project. I also authorize periodic on-site inspection by the Howard Soil Conservation District of their authorized agents, as are deemed necessary."

Signature of Developer/Builder: Date: 7-20-84

ENGINEER'S CERTIFICATE

I hereby certify that this plan for Erosion and Sediment Control represents a practical and workable plan based on my personal knowledge of the site conditions and that it was prepared in accordance with the requirements of the Howard Soil Conservation District.

Signature: G. NELSON CLARK Date: 7-24-84

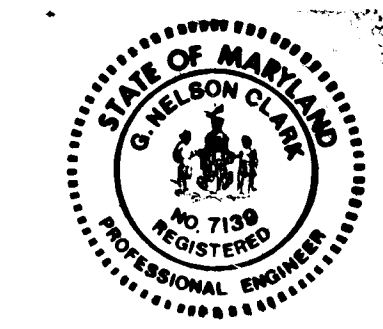

APPROVED: Department of Public Works

Signature: Louis F. Down Date: 10-17-84
Signature: G. Nelson Clark Date: 7-24-84

CLARK · FINEFROCK & SACKETT
ENGINEERS · PLANNERS · SURVEYORS
11314 LOCKWOOD DRIVE SILVER SPRING, MARYLAND 20904 (301) 593-1410

DESIGNED: JLS
DRAWN: BAF
CHECKED: JLS
DATE: 7-23-84

ROAD CONSTRUCTION AND PAVING DETAILS

ASPENWOOD

SECTION 2
6TH ELECTION DISTRICT
HOWARD COUNTY, MARYLAND

SCALE: As Shown
DRAWING: 2 of 6
JOB NO.: 84-046
FILE NO.: 84-046 D

STRUCTURE SCHEDULE							
NO.	TYPE	INV. IN'	INV. OUT'	TOP ELEVATION		REMARKS	LOCATION
				UPPER	LOWER		
I-16	A-10 Inlet w/ deflectors	-	217.80	221.76	221.42	Ho. Co. Std. S.D. 4.02 W=2'6"	@ Inlet Sta. 5+20.57 14' RT
S-20	"C" Endwall	196.85	196.85	-	-	Ho. Co. Std. S.D. 5.21 Dia. 24"	See Plan
M-21	Shallow Brick Manhole	205.17	210.60	-	-	Ho. Co. Std. G.505 48" Sq.	See Plan
I-22	A-10 Inlet	214.00	219.00	219.28	-	Ho. Co. Std. S.D. 4.02 W=2'6"	See Plan
I-23	A-10 Inlet w/ deflectors	217.80	217.80	216.30	216.30	Ho. Co. Std. S.D. 4.02 W=2'6"	@ Inlet Sta. 11+09 Voll Rd. 19' LT
M-24	Shallow Brick Manhole	224.40	228.49	228.49	-	Ho. Co. Std. G.505 48" Sq.	@ Str. Sta. 12+95.50 Voll Rd. 14' RT
I-25	A-10 Inlet w/ deflectors	240.83	245.46	244.00	245.04	Ho. Co. Std. S.D. 4.02 W=2'6"	@ Inlet Sta. 15+79 Voll Rd. 19' LT

△ All inlets to be fully developed
 * See Ho. Co. Std. S.D. 4.83 for Inlet deflectors

PIPE SCHEDULE		
SIZE	TYPE	LENGTH
15"	RCP CL V	377.35 LF
18"	RCP CL V	494.33 LF
24"	RCP CL V	212 LF
24"	RCP CL II	102 LF

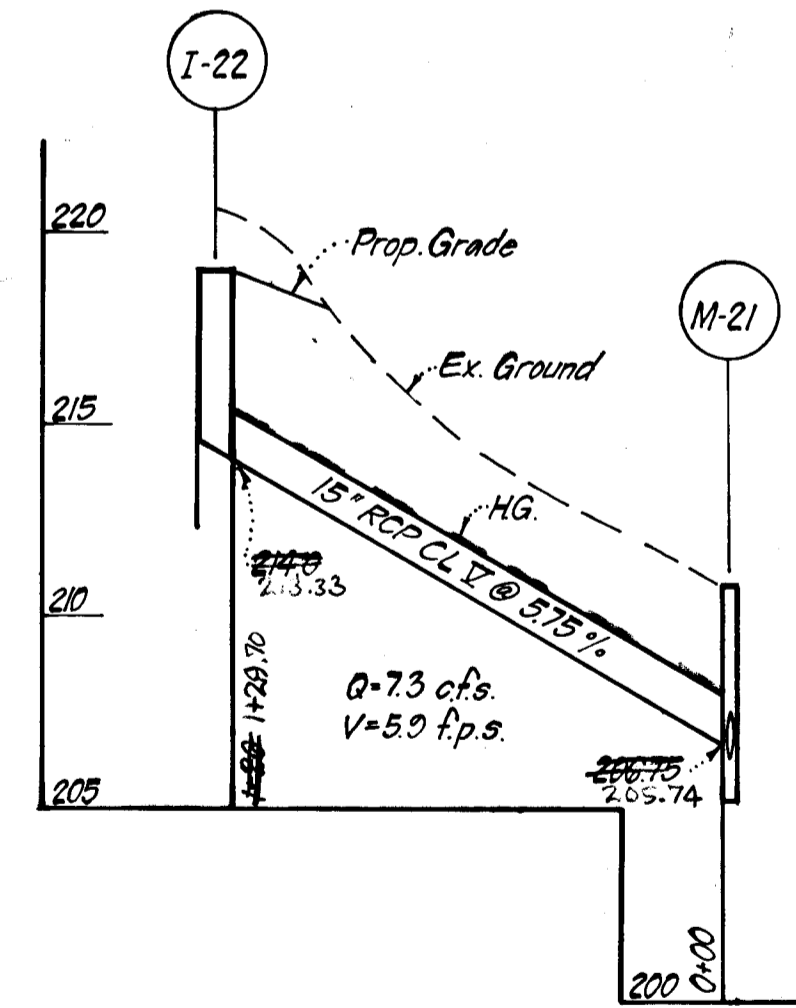
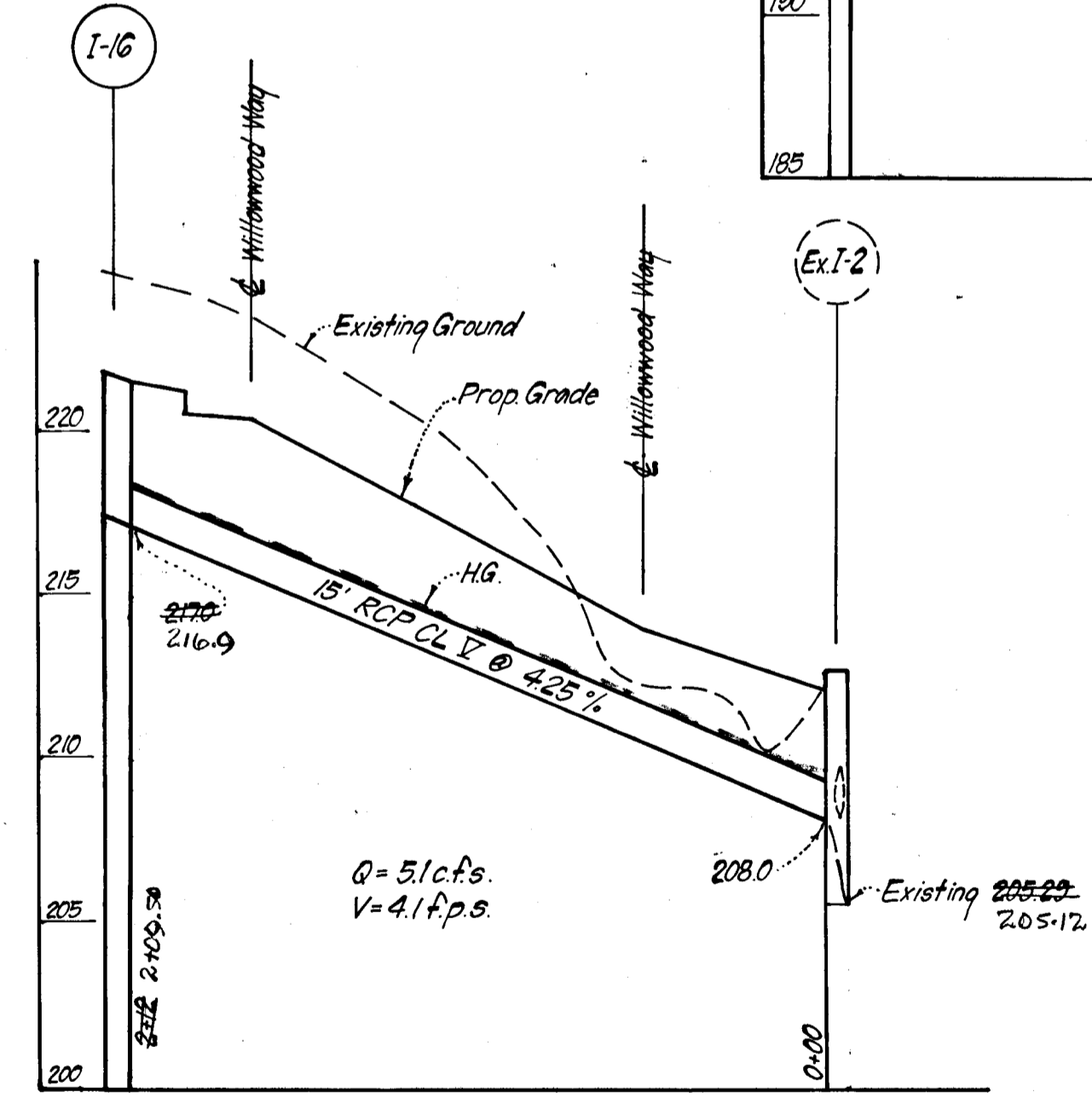
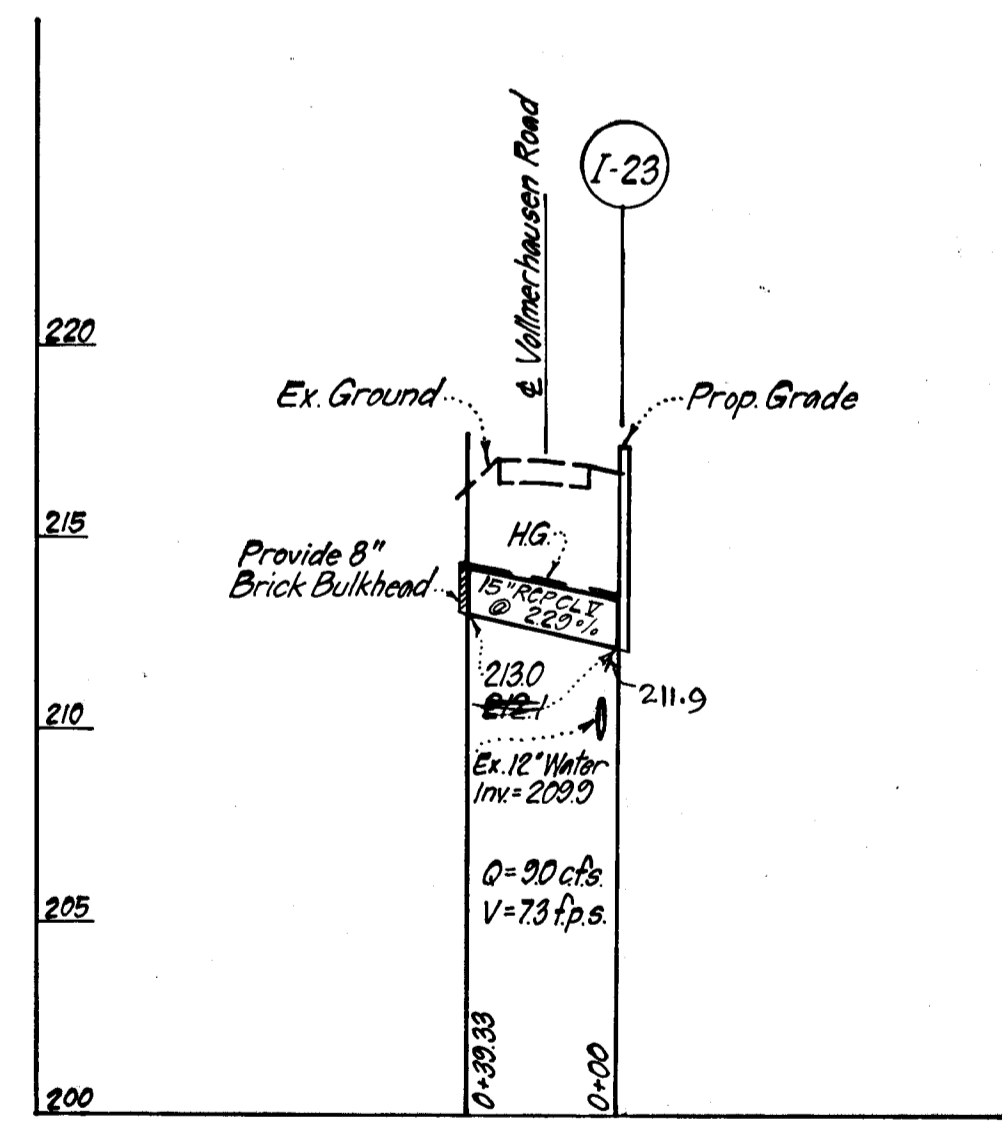
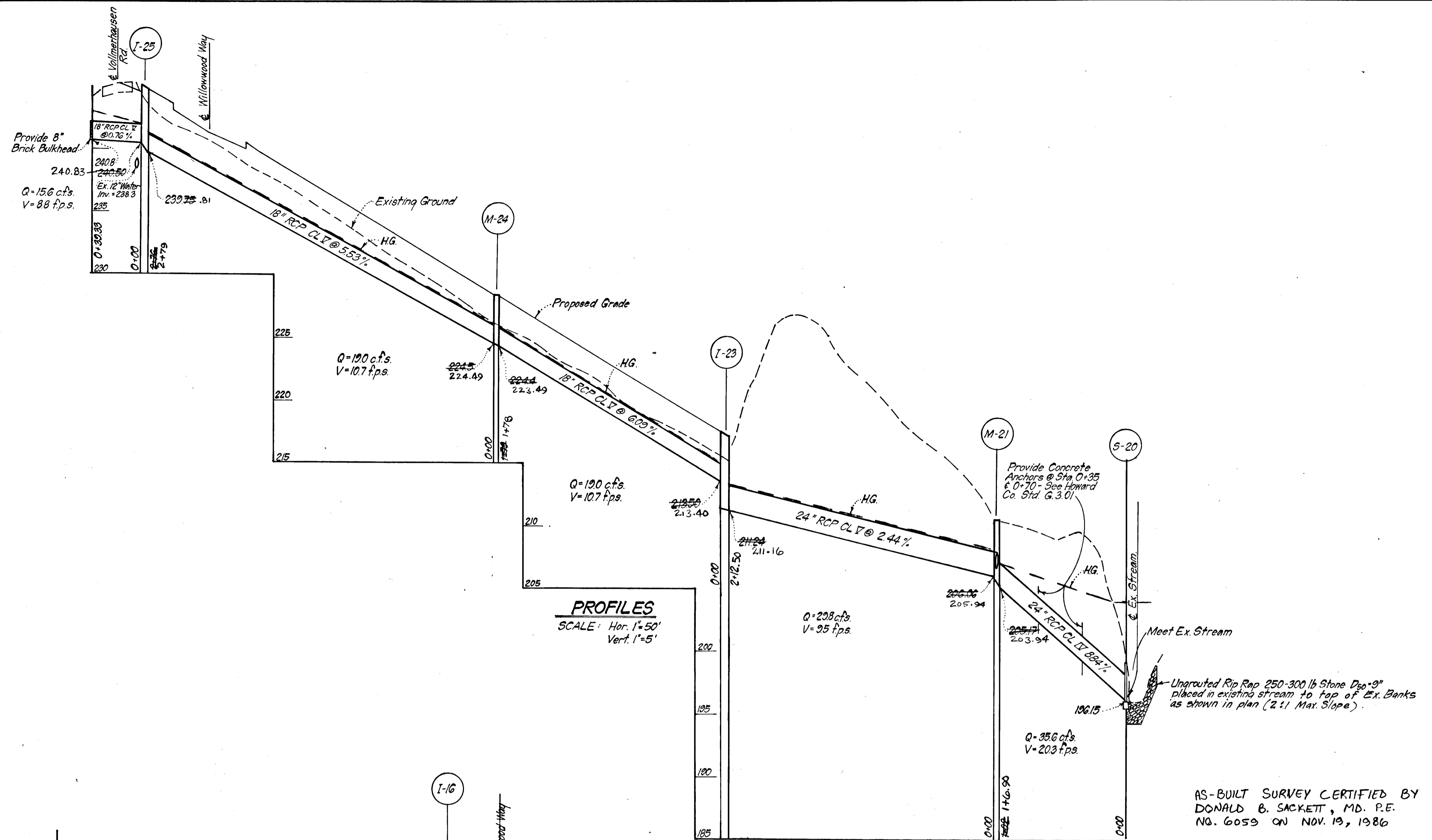

ENGINEER'S CERTIFICATE
 I hereby certify that this plan for Erosion and Sediment Control represents a practical and workable plan based on my personal knowledge of the site conditions and that it was prepared in accordance with the requirements of the Howard Soil Conservation District.
 Date: 7-24-84
 Signature: G. Nelson Clark
 G. Nelson Clark
 Registered Professional Engineer

Reviewed for: HOWARD S.C.D.
 Name
 and meets Technical Requirements
 Signature: [Signature] Date: [Date]
 U.S. Soil Conservation Service

DEVELOPER'S/BUILDER'S CERTIFICATE
 "I/We certify that all development and construction will be done according to this plan of development and plan for erosion and sediment control and that all responsible personnel involved in the construction project will have a Certificate of Attendance at a Dept. of Natural Resources Approved Training Program for the Control of Sediment and Erosion before beginning the project. I also authorize periodic on-site inspection by the Howard Soil Conservation District or their authorized agents, as are deemed necessary."
 Signature of Developer/Builder: Brooks R. Blum Date: July 20, 1984

THIS DEVELOPMENT PLAN IS APPROVED FOR SOIL EROSION AND SEDIMENT CONTROL BY THE HOWARD SOIL CONSERVATION DISTRICT.
 Approved: Stephen L. July Date: 10-17-84

NO.	REVISION	Date	APPROVED: DEPARTMENT OF PUBLIC WORKS:
1.	Revised Rip Rap @ Str. S-20	1-7-85	<u>[Signature]</u> 10/23/84 Chief, Bureau of Engineering APPROVED: HOWARD COUNTY OFFICE OF PLANNING AND ZONING <u>[Signature]</u> 10-19-84 Chief, Division of Land Development & Zoning Administration

CLARK · FINEFROCK & SACKETT
 ENGINEERS · PLANNERS · SURVEYORS
 11315 LOCKWOOD DRIVE • SILVER SPRING, MARYLAND 20904 • (301) 593-3400

DESIGNED: JLS
 DRAWN: BAF
 CHECKED: JLS
 DATE: July 23, 1984

SCALE: As Shown
 DRAWING: 3 of 6
 JOB NO.: 84-046
 FILE NO.: 84-046

ASPENWOOD
 SECTION 2
 6TH ELECTION DISTRICT
 HOWARD COUNTY, MARYLAND

FOR: CAPITAL HOMES, INC.
 Suite 200 6500 Rock Spring Dr.
 The Bedford Bldg. Bethesda, Md. 20834

#1025

Note: Immediate Stabilization required for all grading along Guilford Rd. & Vollmerhausen Rd.

NOTE: See Previously Approved Preliminary Drainage Study for continuation. (P-84-40)

NOTE: See Previously Approved Road Construction Plans P-84-41 for continuation.

- CONSTRUCTION SEQUENCE: (For work in stream)**
1. Install stone berms and 24" CMP as shown.
 2. Excavate for pipe, endwall and Rip Rap.
 3. Construct pipe, endwall and Rip Rap. (Note: If Sediment laden water ponds between stone berms, water to be pumped out by that it drains to sediment Trap #1 if required by the Inspector.)
 4. Remove stone berms and 24" CMP after construction in stream is completed and stabilized.

TRAP #1 (SOST)
 DA = 35 Ac.
 Storage Required = 3.5 x 1800 = 6300 c.f.
 Storage Provided = 6300 c.f.
 Depth = 4'
 Top of Stone Crest = 206.0
 Bottom Elevation = 202.0
 Bottom Dimension = 55' x 17'
 Cleanout Elevation = 204.0

RIPRAP OUTLET TRAP #2
 DA = 12.4 Ac.
 Storage Required = 12.4 x 1800 = 22,320 c.f.
 Storage Provided = 22,344 c.f.
 Depth = 4'
 Weir Elevation = 195.0
 Bottom Elevation = 189.0
 Bottom Dimension = See Plan
 Cleanout Elevation = 191.0
 a = 20'
 b = 15.0'

TRAP #3 (SOST)
 DA = 0.7 Ac.
 Storage Required = 0.7 x 1800 = 1260 c.f.
 Storage Provided = 1260 c.f.
 Depth = 3'
 Top Stone Elevation = 208 ft.
 Bottom Elevation = 205 ft.
 Bottom Dimension = 8' x 22'
 Cleanout Elevation = 206.5

CONSTRUCTION SEQUENCE:

1. Install Sediment & Erosion Control Measures, and temp pipe from Ex. I-2 to Sed. Trap #2.
2. Block off Ex. 18" RCP Pipe from Ex. I-2 to Rip-Rap outlet.
3. Remove Ex. Perimeter Dike and Ex. Sediment Trap as noted.
4. Clear and rough grade site.
5. Construct Storm Drainage and install S.F.I.P.
6. Construct Utilities.
7. Fine grade and construct paving.
8. Stabilize all other disturbed areas onsite in accordance with standards and specifications.
9. Upon approval of the Sediment Control Inspector, remove sediment and erosion control measures and stabilize.

LEGEND:

1. Contour Interval 2ft
2. Existing Contour
3. Proposed Contour
4. Direction of Drainage
5. Perimeter Dike (PD)
6. Stone Filter Inlet Protection (SFIP)
7. Interceptor Swale (IS)
8. Straw Bale Dike or Gill Fence

NOTE: Ex. Perimeter Dike is to be removed after Sediment Trap #2 is constructed.

NOTE: Ex. Sediment Trap is to be removed after Sediment Trap #2 is constructed.

No	REVISION	DATE
1.	Added SBD's, stone berms, 24" CMP and construction sequence.	1-7-85
2.	Added Parking Bays & revised grading and Lots	7-3-85
3.	REVISE DRAINAGE AREA FOR CONVERSION OF M-5 TO YARD INLET'S	2-19-92

APPROVED: DEPARTMENT OF PUBLIC WORKS:
[Signature] 10/23/84 Date

APPROVED: HOWARD COUNTY OFFICE OF PLANNING AND ZONING:
[Signature] 10-19-84 Date

CLARK · FINEFROCK & SACKETT ENGINEERS · PLANNERS · SURVEYORS 11315 LOCKWOOD DRIVE SILVER SPRING, MARYLAND 20904 (301) 593 3400		
DESIGNED	JLS	DRAINAGE AREA MAP AND SEDIMENT CONTROL PLAN WILLOWWOOD WAY, VOLLMERHAUSEN RD, & GUILFORD RD. (MDRTE #32)
DRAWN	BAF KIV	SCALE 1" = 50'
CHECKED	JLS	DRAWING 40F6
DATE	7-23-84	JOB NO. 84-046
		FILE NO. 84-046-D

DEVELOPER'S/BUILDER'S CERTIFICATE

"I/We certify that all development and construction will be done according to this plan of development and plan for erosion and sediment control and that all responsible personnel involved in the construction project will have a Certificate of Attendance at a Dept. of Natural Resources Approved Training Program for the Control of Sediment and Erosion before beginning the project. I also authorize periodic on site inspection by the Howard Soil Conservation District or their authorized agents, as are deemed necessary."

[Signature] **Barbara R. Palmer** July 20 1984 Date
 Signature of Developer/Builder

ENGINEER'S CERTIFICATE

I hereby certify that this plan for Erosion and Sediment Control represents a practical and workable plan based on my personal knowledge of the site conditions and that it was prepared in accordance with the requirements of the Howard Soil Conservation District.

7-24-84 *[Signature]* G. NELSON CLARK
 DATE



Reviewed for: **HOWARD S.C.D.**
 Name
 and meets Technical Requirements
[Signature]
 Signature Date
 U.S. Soil Conservation Service

THIS DEVELOPMENT PLAN IS APPROVED FOR SOIL EROSION AND SEDIMENT CONTROL BY THE HOWARD SOIL CONSERVATION DISTRICT.

[Signature] 10-17-84
 Approved Date

1025

GENERAL NOTES

- Grading Permits shall be obtained prior to installation of Sediment Control & Grading.
- All Sediment and Erosion Control Measures will be installed and stabilized according to this plan prior to any other grading, clearing or disturbance of the existing surface of the site. See note #6 for stabilization except that the seed mixture will be annual rye applied at a rate of 1.4 lbs/1000 sf.
- Notify the Bureau of Inspections and Permits at least 24 hours before starting any work.
- All Sediment Control Practices to conform to the "Standards and Specifications for Soil Erosion and Sediment Control in Developing Areas" and shall be adjusted to meet actual field conditions.
- Stabilization of Disturbed ground to be done as soon after construction as possible.
- All disturbed areas to be stabilized in accordance with the following Specifications:
 - Seed - certified 85% germination applied at the rate of 3 lbs/1000 sf. Mixture - 40% Kentucky Blue, 20% chewing Fescue, 20% Kentucky 31 and 20% annual rye.
 - Fertilizer - 10-10-10 applied at a rate of 23 lbs/1000 sf. Ground Agricultural Lime or Dolomitic Lime applied at a rate of 90 lbs/1000 sf.
 - Mulch - Weed free grain straw applied at a rate of 70-90 lbs/1000 sf. Mulch shall be secured to the ground by any approved method i.e.; asphalt tacks, chemical binder etc.
 - All Sod used shall be Maryland State Certified.
- All Structural Sediment Control Measures are to remain in place until permission for their removal has been obtained from the Bureau of Inspections and Permits.
- On-Site Inspection and Maintenance of all Sediment Control Measures including clean out of Sediment Traps and Dikes, and proper establishment of all planned vegetative measures will be the responsibility of the developer or his representative on the site, on a continuing day to day basis.
- It will be the developer's responsibility to provide additional Sediment & Erosion Control Devices to protect stabilized areas during construction.
- The Contractor shall keep all public roads free of sediment deposits left from traffic leaving construction site.
- Approval of this plan is conditional upon the approval of Sediment Control Plan for the off-site waste or borrow area prior to the import of any borrow or export of waste to or from this site.
- All pipes to be blocked at the end of each day. See detail this sheet.
- Total Amount of Straw Bales or Silt Fence shown = 20 LF.
- SITE ANALYSIS:

A. Total Area:	9.747	Acres.
B. Area to be Roofed:	0.000	Acres.
C. Area to be Paved:	1.560	Acres.
D. Area to be Seeded:	2.843	Acres.
E. Area Undisturbed:	5.344	Acres.
- Following initial soil disturbance or redisturbance, permanent or temporary stabilization shall be completed within: (a) 7 calendar days as to the surface of all perimeter controls, dikes, swales, ditches, perimeter slopes, and all slopes greater than 3:1; and (b) 14 days as to all other disturbed or graded areas on the project site.
- All Sediment Traps shown must be fenced and warning signs posted around their perimeter in accordance with Vol. 1, Chap. 12, of the Howard County Design Manual for Storm Drainage.

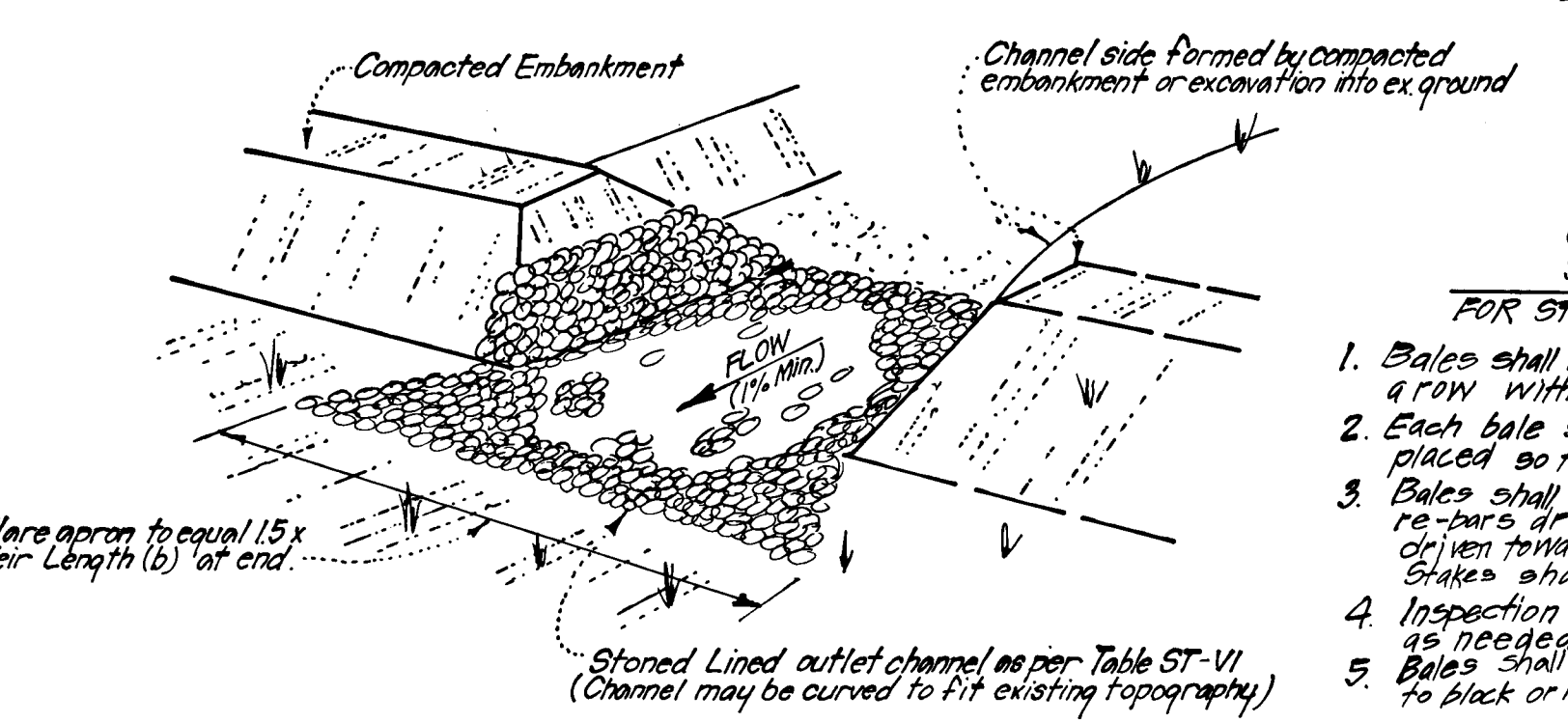
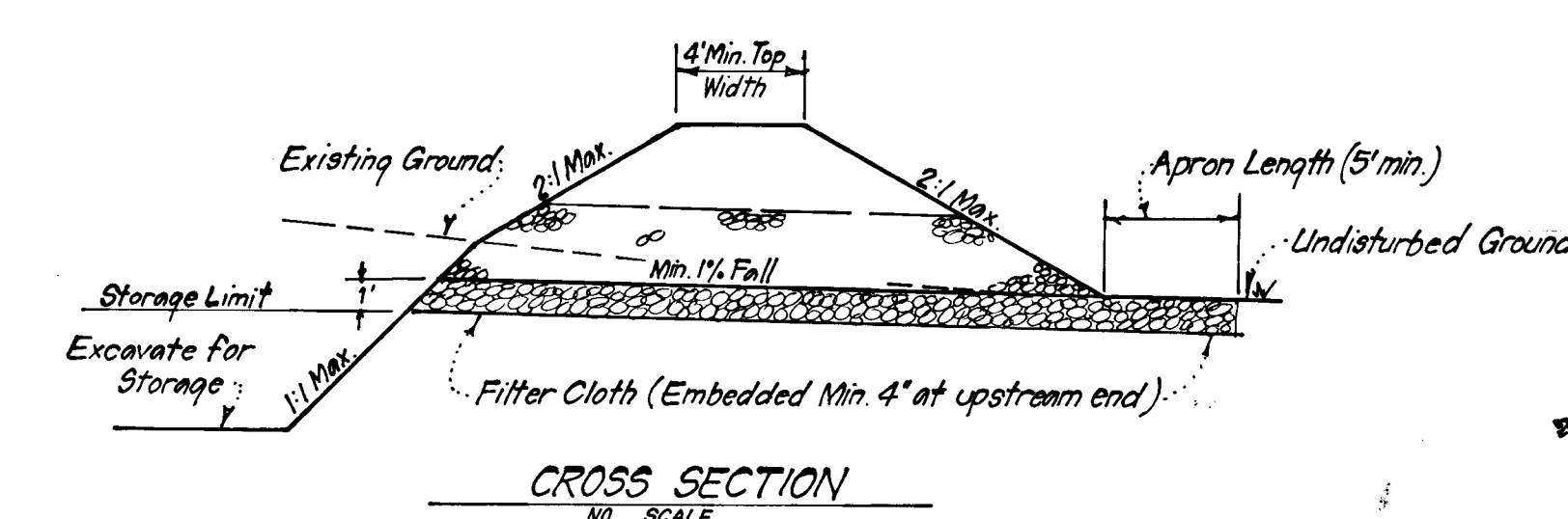
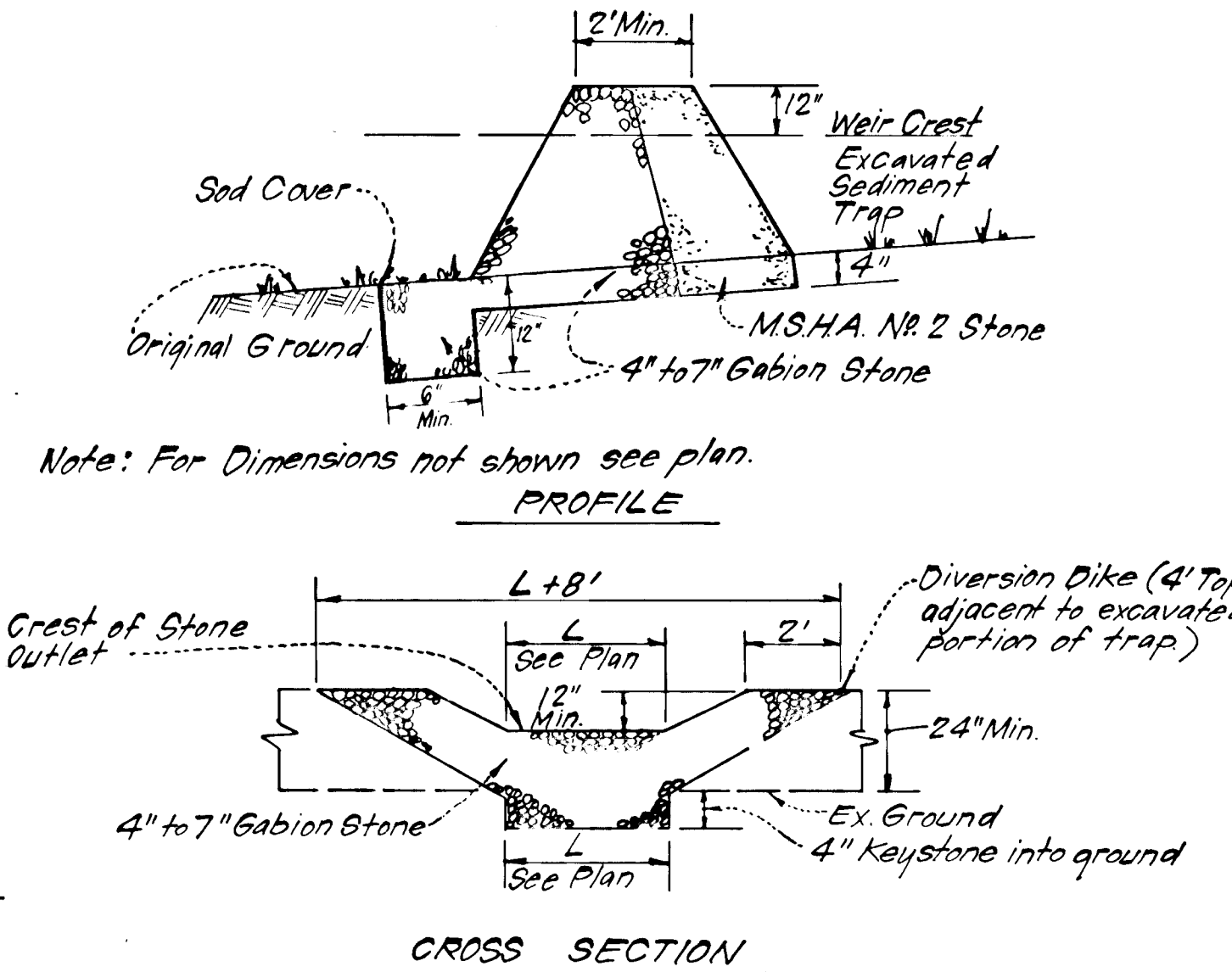
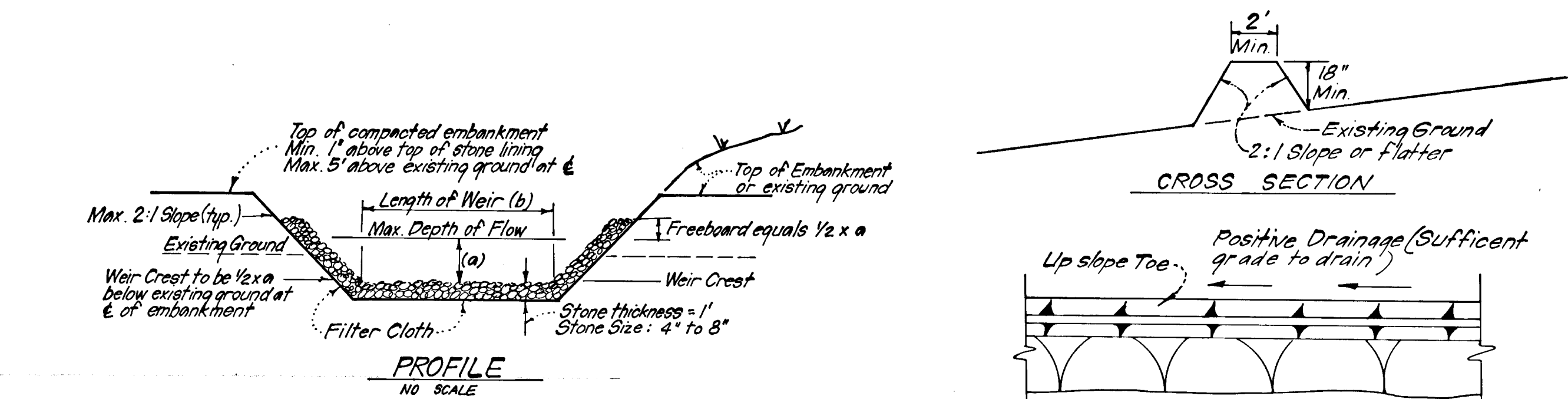

RIPRAP OUTLET SEDIMENT TRAP
NO SCALE

Reviewed for: **HOWARD S.C.D.**
Name: **Howard Soil Conservation District**
Signature: **[Signature]**
U.S. Soil Conservation Service

THIS DEVELOPMENT PLAN IS APPROVED FOR SOIL EROSION AND SEDIMENT CONTROL BY THE HOWARD SOIL CONSERVATION DISTRICT.

Approved: **[Signature]** 10-17-84
Date

APPROVED: FOR PUBLIC WATER AND PUBLIC SEWERAGE SYSTEMS. HOWARD COUNTY HEALTH DEPARTMENT	DATE
COUNTY HEALTH OFFICER	DATE
APPROVED: HOWARD COUNTY OFFICE OF PLANNING & ZONING	DATE
PLANNING DIRECTOR	DATE
CHIEF DIVISION OF LAND DEVELOPMENT AND ZONING ADMINISTRATION	DATE
APPROVED: FOR PUBLIC WATER AND PUBLIC SEWERAGE, STORM DRAINAGE SYSTEMS AND PUBLIC ROADS HOWARD COUNTY DEPARTMENT OF PUBLIC WORKS	DATE
DIRECTOR	DATE
CHIEF BUREAU OF ENGINEERING	DATE

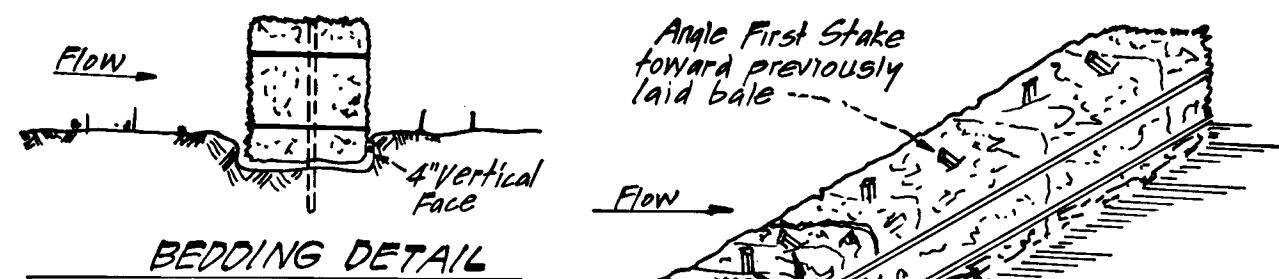

CONSTRUCTION SPECIFICATIONS FOR STRAW BALE DIKE

- Bales shall be placed at the toe of a slope or on the contour and in a row with ends tightly abutting the adjacent bales.
- Each bale shall be embedded in the soil a minimum of (4) inches, and placed so the bindings are horizontal.
- Bales shall be securely anchored in place by either two stakes or re-bars driven through the bale. The first stake in each bale shall be driven toward the previously laid bale, at an angle to force the bales together. Stakes shall be driven flush with the bale.
- Inspection shall be frequent and repair replacement shall be made promptly as needed.
- Bales shall be removed when they have served their usefulness so as not to block or impede storm flow or drainage.

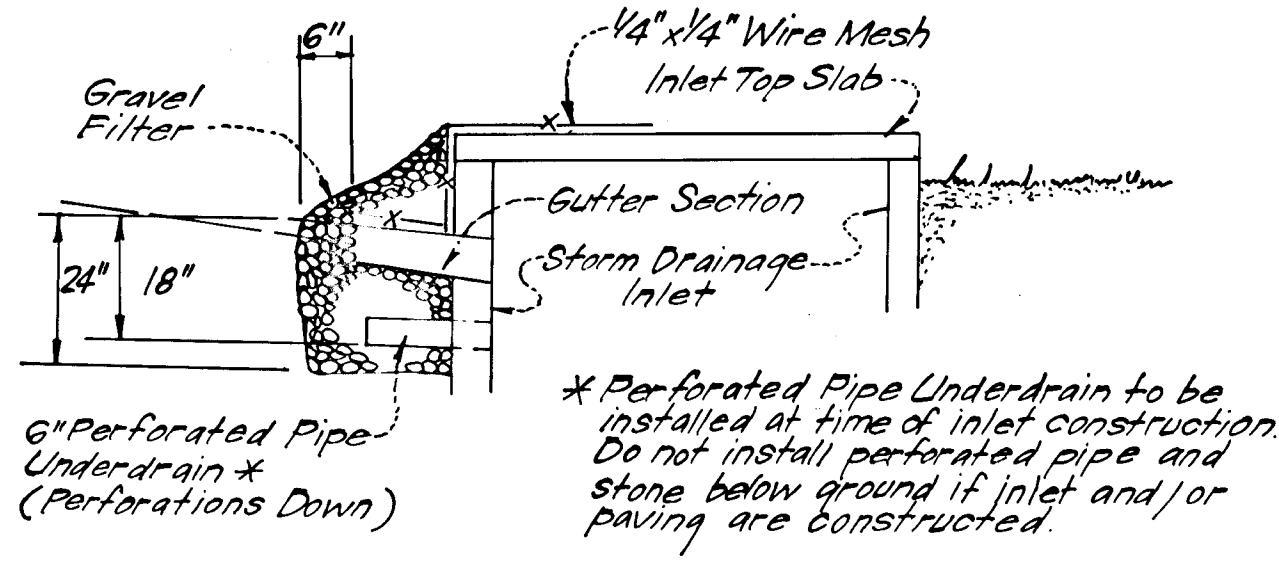
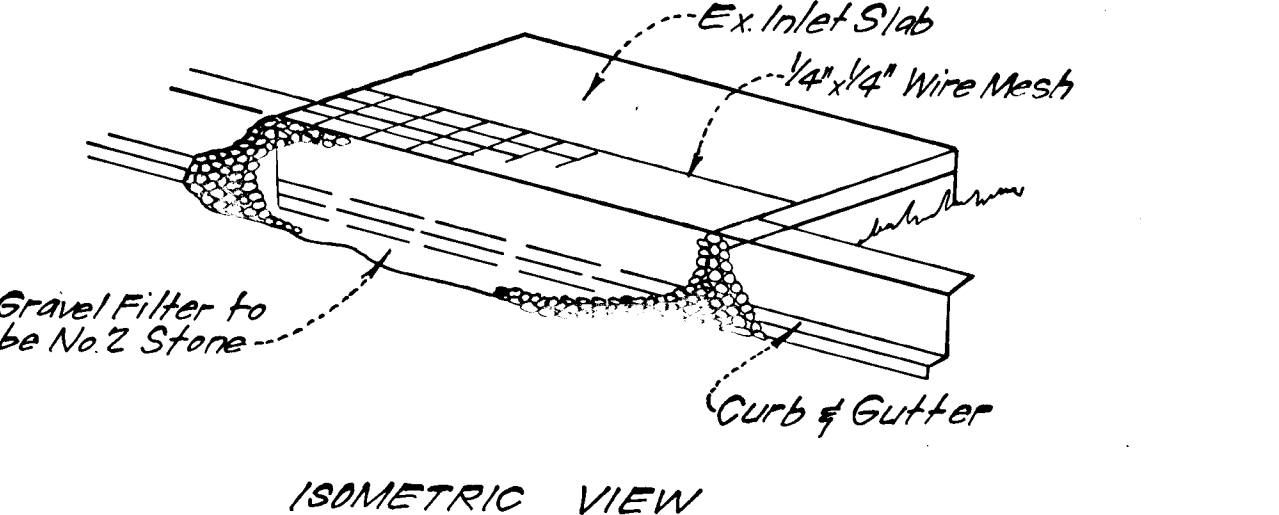

STONE FILTER INLET PROTECTION (S.F.I.P.)
NO SCALE

- Notes:
- Sediment Trap to be cleaned out when sediment reaches a level of 1 foot below crest of stone outlet.
 - Bottom of Sediment Trap to be level and constructed to the dimensions shown on plan.
 - Stone Outlet to be constructed through diversion dike adjacent to excavated trap.

DETAILS OF STONE FILTER OUTLET FOR STONE OUTLET SEDIMENT TRAP (S.O.S.T.)
NO SCALE

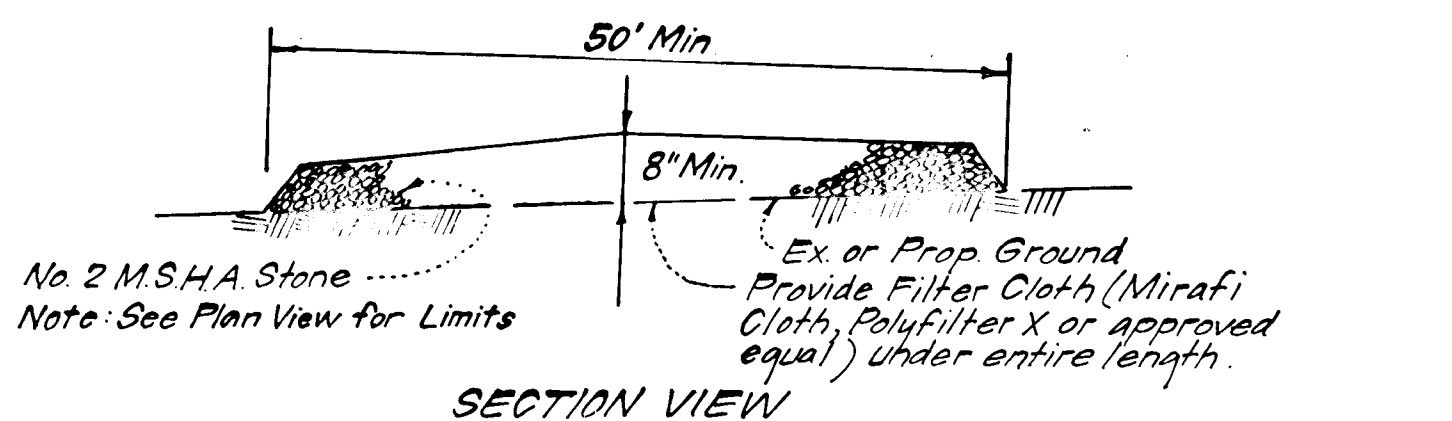

STABILIZED CONSTRUCTION ENTRANCE
NO SCALE

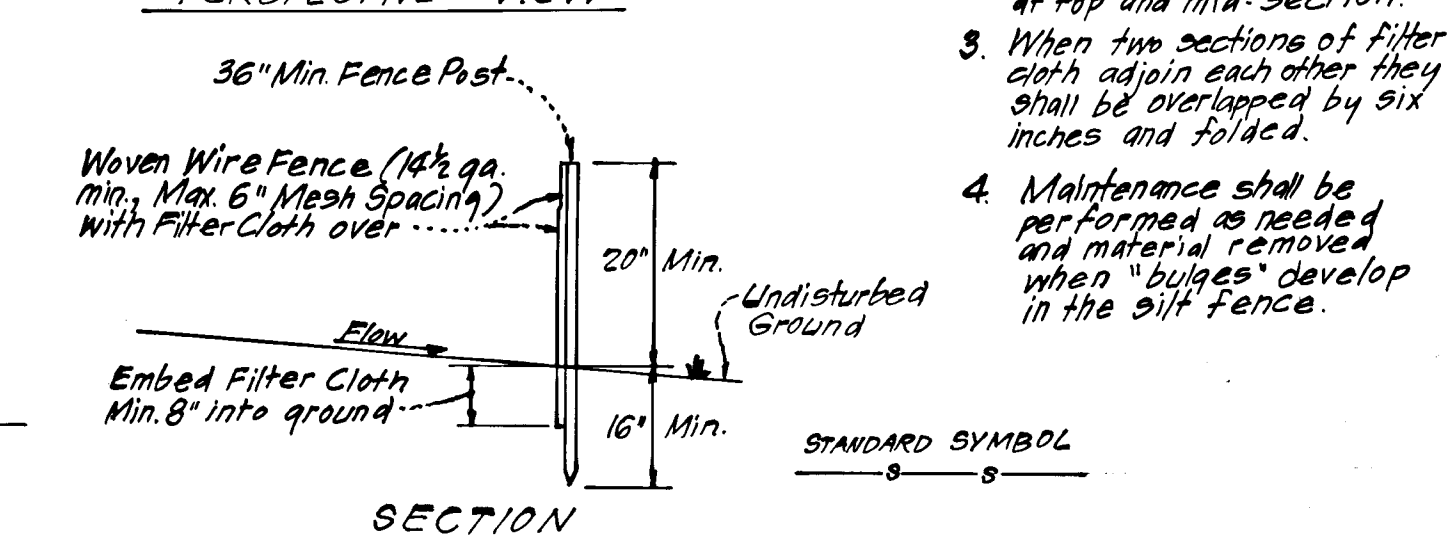
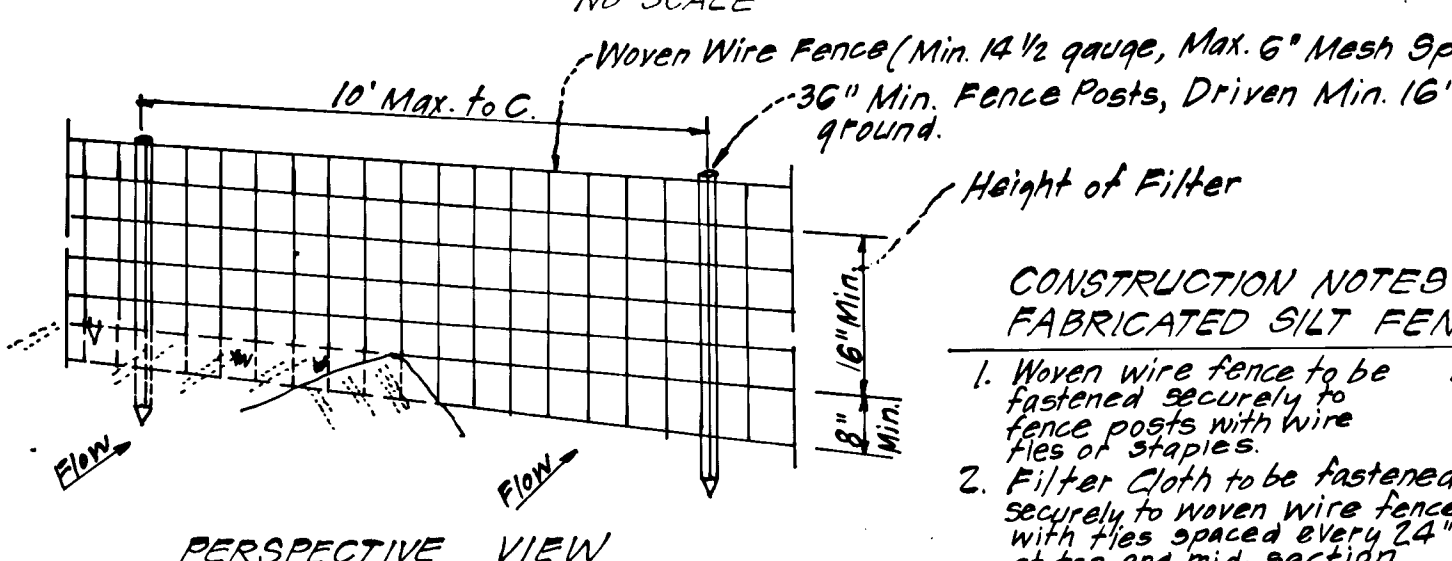

SILT FENCE DETAIL
No Scale

DEVELOPER'S/BUILDERS CERTIFICATE

"I/We certify that all development and construction will be done according to this plan of development and plan for erosion and sediment control and that all responsible personnel involved in the construction project will have a Certificate of Attendance at a Dept. of Natural Resources Approved Training Program for the Control of Sediment and Erosion before beginning the project. I also authorize periodic on-site inspection by the Howard Soil Conservation District or their authorized agents, as are deemed necessary."

Signature of Developer/Builder: **[Signature]** Date: **July 20, 1984**

ENGINEER'S CERTIFICATE

"I hereby certify that this plan for Erosion and Sediment Control represents a practical and workable plan based on my personal knowledge of the site conditions and that it was prepared in accordance with the requirements of the Howard Soil Conservation District."

Date: **7-23-84** Signature: **[Signature]**
G. NELSON CLARK

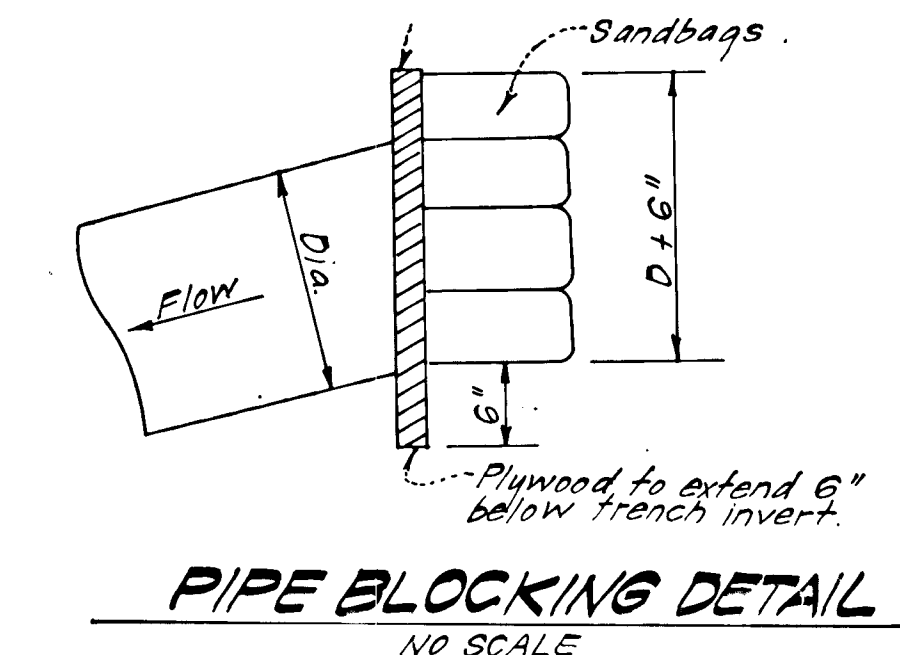
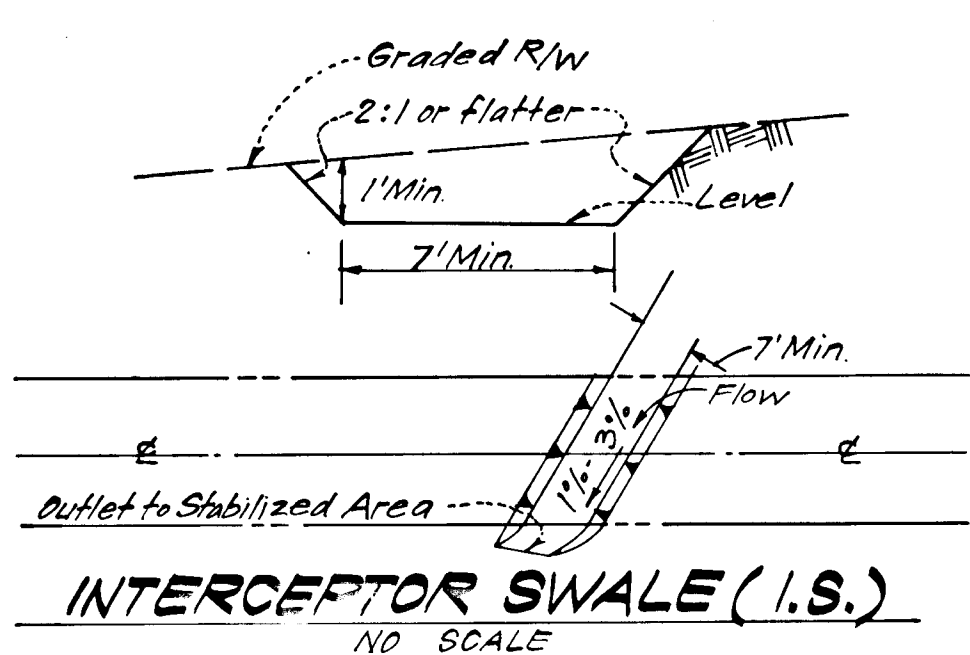

NO.	REVISION	DATE
1	Added Straw Bale Dike and Silt Fence Details.	1-7-85

APPROVED: DEPARTMENT OF PUBLIC WORKS
 Chief, Bureau of Engineering: **[Signature]** Date: **10/23/84**
 APPROVED: HOWARD COUNTY OFFICE OF PLANNING & ZONING
 ACTING Chief, Division of Land Development and Zoning Administration: **[Signature]** Date: **10-19-84**

CLARK · FINEFROCK & SACKETT
 ENGINEERS · PLANNERS · SURVEYORS
 11315 LOCKWOOD DRIVE • SILVER SPRING, MARYLAND 20904 • (301) 593-3400

DESIGNED: **SEDIMENT & EROSION CONTROL PLAN**
 DRAWN: **DETAIL SHEET**
 CHECKED: **ASPENWOOD**
 DATE: **SECTION 2**
 FOR: **6TH ELECTION DISTRICT**
 CAPITAL HOMES, INC.
 Suite 200, 6500 Rock Spring Dr.
 The Bedford, Blg. Bethesda, Md. 20834

SCALE: **As Shown**
 DRAWING: **5 of 6**
 JOB NO.: **84-046**
 FILE NO.: **84-046-D**

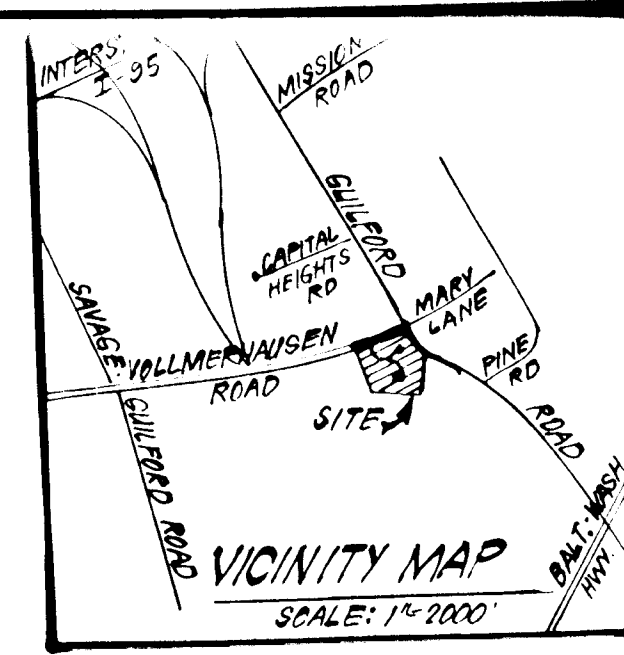

Note: Remove Ex. Inlet to a Manhole. Remove Concrete Ditch and grate and raise structure top to El. 214.34.

20' Transition from SHA Type A Curb & gutter to Ho. Co. Std. 7" Curb & gutter. Provide 8" Brick Bulkhead.

NOTE: Test pits to be dug by hand to locate Ex. 12" W. at all crossings.

NOTE: Ex. 12" to be adjusted as necessary to meet proposed grade.

11 Sedi plan conc with in

PLAN SCALE: 1"=50'

PLANT SCHEDULE

KEY	PLANT NAME	SIZE	QUANT	REMARKS
⊙	QUERCUS PALUSTRIS PIN OAK	2 1/2 CAL. MIN.	30	B & B HEAVY HEADS
⊙	QUERCUS RUBRA NORTHERN RED OAK		20	
⊙	ZELKOVA SERR. "VILLAGE GREEN" VILLAGE GREEN ZELKOVA		9	

NOTE:
Contractor shall verify location of underground utilities prior to digging.
Final locations of trees may be adjusted slightly to accommodate field conditions.
Planting procedures shall comply with "Landscape Specifications for Baltimore-Washington Metropolitan Areas."
Substitutions to the above species may be permitted, provided that the planting is in accordance with the street tree & landscape requirements as specified in Section 10.131 of the Howard County Subdivision Regulations.

APPROVED: DEPARTMENT OF PUBLIC WORKS:
Kenneth E. Reid 10/23/84
Chief, Bureau of Engineering
APPROVED: HOWARD COUNTY OFFICE OF PLANNING AND ZONING
Lois F. Dwyer 10-19-84
Acting Chief, Division of Land Development & Zoning Administration

CLARK • FINEFROCK & SACKETT
ENGINEERS • PLANNERS • SURVEYORS
11315 GLENWOOD DRIVE SILVER SPRING, MARYLAND 20904

DESIGNED: J.B.C.
DRAWN: BAF, KIW
CHECKED: J.B.C.
DATE: 7-20-84

LANDSCAPE PLANTING PLAN
STREET TREES FOR VOLLMERHAUSEN ROAD AND COTTONWOOD WAY
ASPENWOOD
SECTION 2
6TH ELECTION DISTRICT
HOWARD COUNTY, MARYLAND
FOR: CAPITAL HOMES, INC.
Suite 200, 6500 Rock Spring Dr.
The Bedford Bldg, Bethesda, Md. 20834

SCALE: 1"=50'
DRAWING: 6 of 6
JOB NO: 84-046
FILE NO: 84-046D

NO.	REVISION	DATE
1	Revised Parking Bays and Lots.	7-3-85

Wijford H. Thier
7-23-84

52015