

DEPARTMENT OF PUBLIC WORKS  
 9113184  
 Chief - Bureau of Engineering  
 DIVISION OF LAND DEVELOPMENT AND ZONING ADMIN.  
 9-7-84  
 Data

ENGINEERS NOTE  
 I certify that this plan for Erosion and Sediment represents a workable plan based on my personal knowledge of the site conditions and that it was prepared in accordance with the requirements of the Howard Soil Conservation District  
 J. Clark  
 J. E. Clark  
 8-24-84

PLAN OF DEVELOPMENT NOTE  
 I certify that all development and/or construction will be done according to this plan of development and plan for erosion and sediment control and I also authorize periodic on site inspection by the Howard Soil Conservation District or their authorized agents as deemed necessary. (See Note 5)  
 D. M. Elliott  
 Developer  
 8-24-84  
 Date

SOIL CONSERVATION DISTRICT NOTE  
 THIS DEVELOPMENT PLAN IS APPROVED FOR SOIL EROSION AND SEDIMENT CONTROL BY THE HOWARD SOIL CONSERVATION DISTRICT.  
 R. W. Zahn  
 HOWARD S.C.D.  
 9-5-84  
 DATE

Reviewed for Howard County S.C.D. and meets technical requirements.  
 J. K. H. / U.S. Soil Conservation Service.  
 9-5-84  
 Date

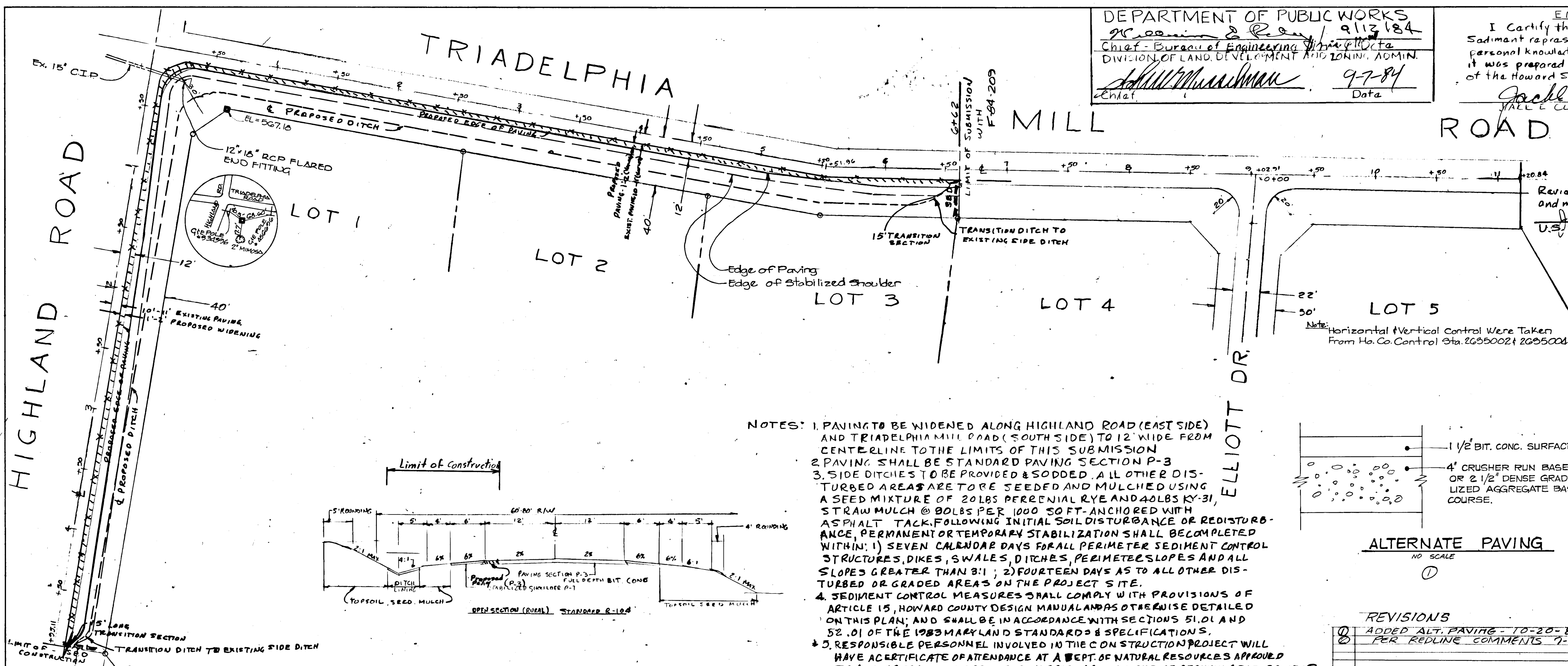

NOTES: 1. PAVING TO BE WIDENED ALONG HIGHLAND ROAD (EAST SIDE) AND TRIADELPHIA MILL ROAD (SOUTH SIDE) TO 12' WIDE FROM CENTERLINE TO THE LIMITS OF THIS SUBMISSION  
 2. PAVING SHALL BE STANDARD PAVING SECTION P-3  
 3. SIDE DITCHES TO BE PROVIDED & SODDED. ALL OTHER DISTURBED AREAS ARE TO BE SEEDED AND MULCHED USING A SEED MIXTURE OF 20LBS PERENNIAL RYE AND 40LBS KY-31, STRAW MULCH @ 90LBS PER 1000 SQ. FT. ANCHORED WITH ASPHALT TACK. FOLLOWING INITIAL SOIL DISTURBANCE OR REDISTURBANCE, PERMANENT OR TEMPORARY STABILIZATION SHALL BE COMPLETED WITHIN: 1) SEVEN CALENDAR DAYS FOR ALL PERIMETER SEDIMENT CONTROL STRUCTURES, DIKES, SWALES, DITCHES, PERIMETER SLOPES AND ALL SLOPES GREATER THAN 3:1; 2) FOURTEEN DAYS AS TO ALL OTHER DISTURBED OR GRADED AREAS ON THE PROJECT SITE.  
 4. SEDIMENT CONTROL MEASURES SHALL COMPLY WITH PROVISIONS OF ARTICLE 15, HOWARD COUNTY DESIGN MANUAL AND AS OTHERWISE DETAILED ON THIS PLAN; AND SHALL BE IN ACCORDANCE WITH SECTIONS 51.01 AND 52.01 OF THE 1983 MARYLAND STANDARDS & SPECIFICATIONS.  
 \* 5. RESPONSIBLE PERSONNEL INVOLVED IN THE CONSTRUCTION PROJECT WILL HAVE A CERTIFICATE OF ATTENDANCE AT A DEPT. OF NATURAL RESOURCES APPROVED TRAINING PROGRAM FOR SEDIMENT AND EROSION CONTROL BEFORE BEGINNING THE PROJECT.

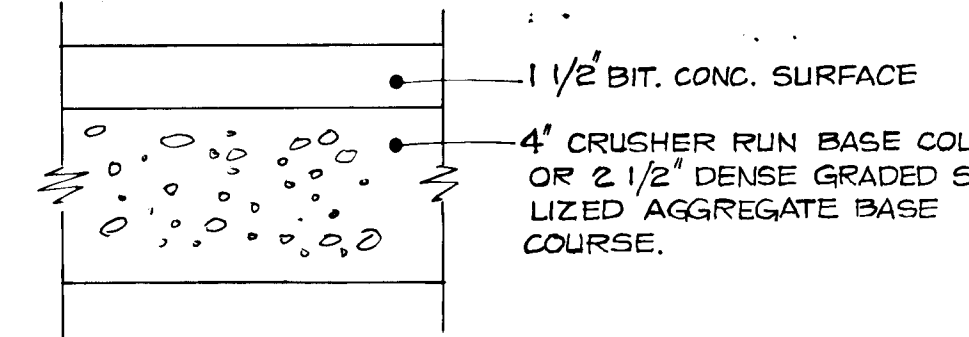

ALTERNATE PAVING  
 NO SCALE  
 ①

REVISIONS  
 ① ADDED ALT. PAVING - 10-20-84  
 ② PER REDLINE COMMENTS 9-8-84

Owner: DAVID ELLIOTT  
 6581 COLUMBIA PIKE  
 COLUMBIA, MD 21046  
 227-5833

Prepared by  
 THE J. E. CLARK CO.  
 P.O. Box 147  
 Laurel, Md. 20707

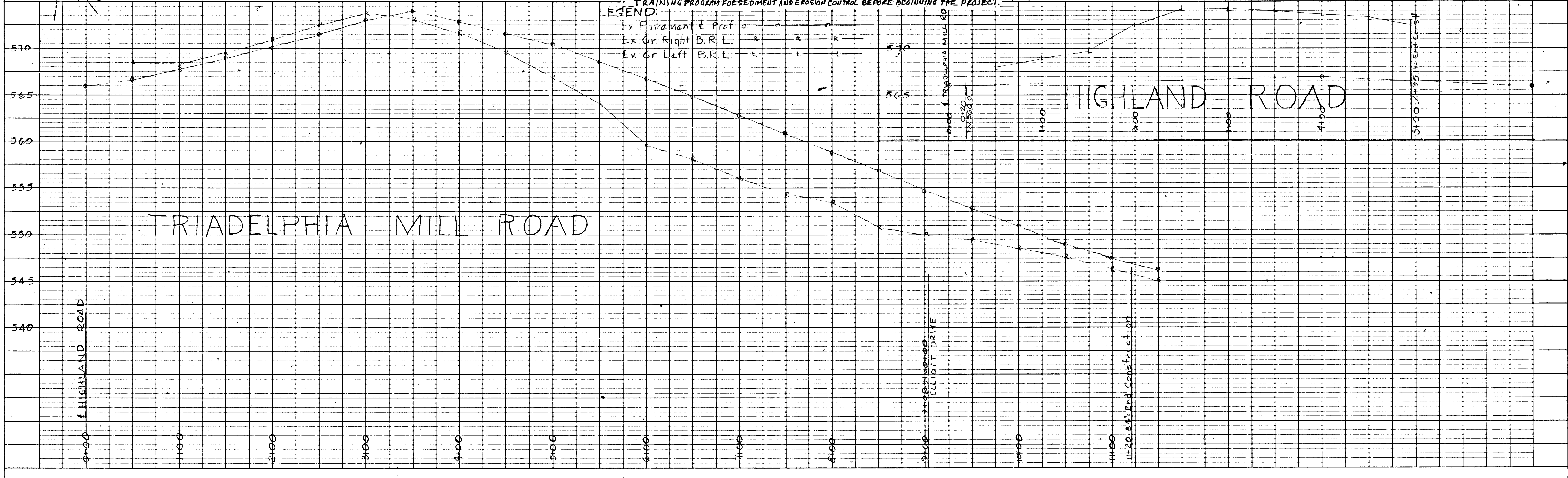
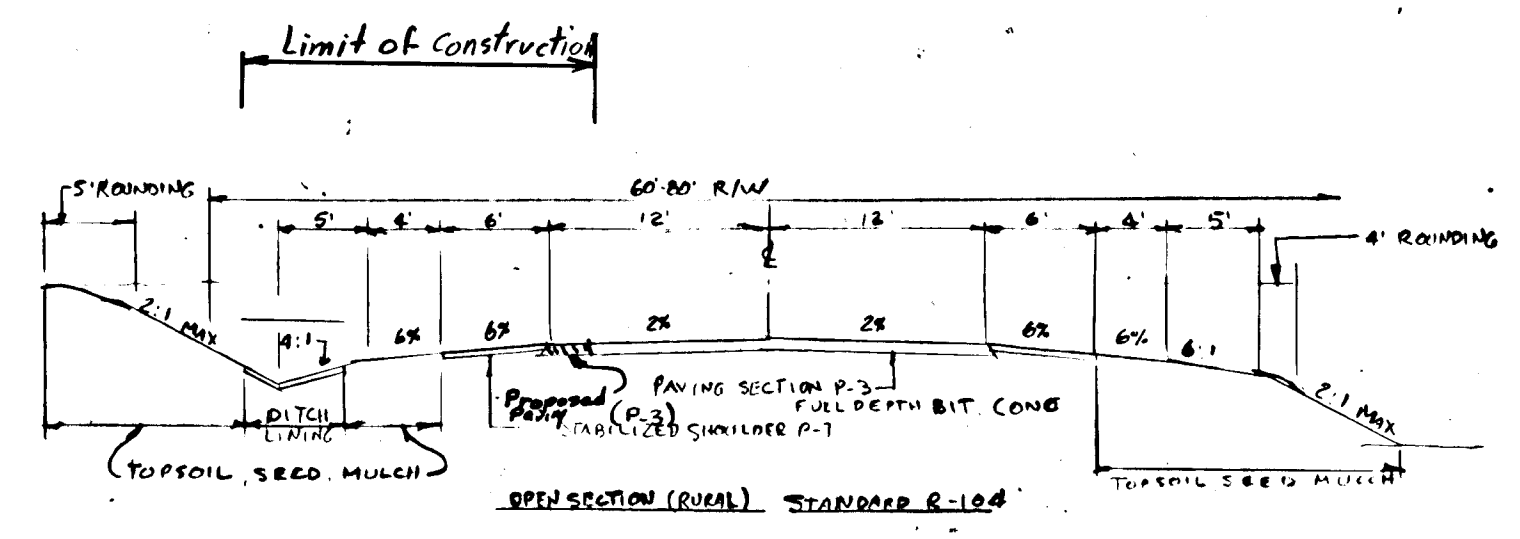

PLAN  
 SHEET NO. 1  
 DATE: 9-7-84  
 BY: J. E. Clark  
 CHECKED: J. E. Clark  
 NO. OF WAY CHECKED: 1

PROFILE  
 SHEET NO. 1  
 DATE: 9-7-84  
 BY: J. E. Clark  
 CHECKED: J. E. Clark  
 NO. OF VERT. CURVES CHECKED: 1