

DATE	
BY	
SAVED	
NOTED	
PLANNING	
ENGINEERING	
CONSTRUCTION	
NO. OF WAY CHECKED	
NO.	

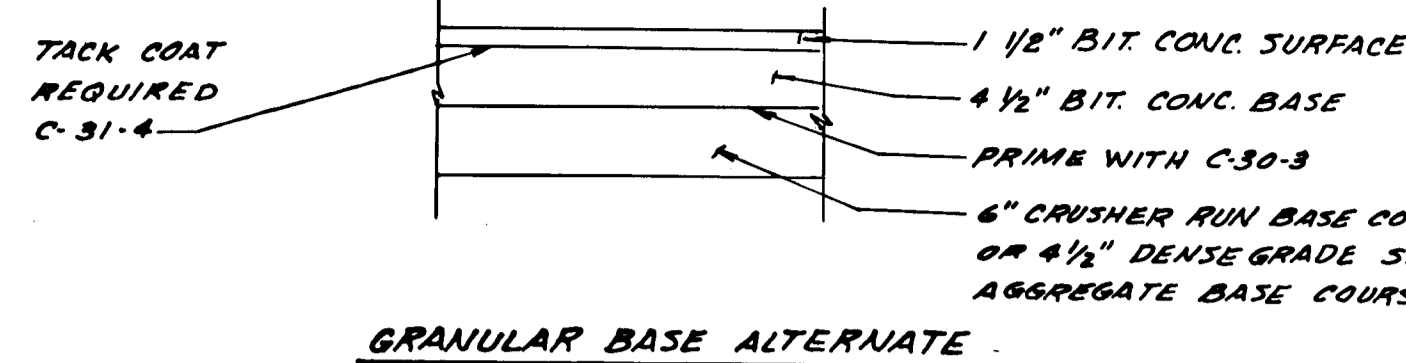

GRANULAR BASE ALTERNATE

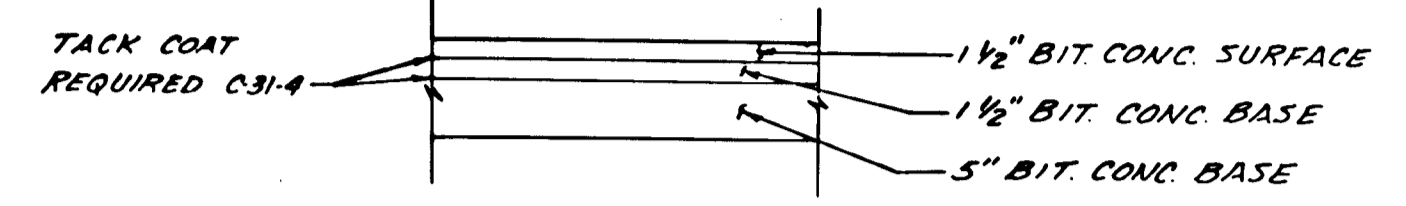

FULL DEPTH BIT. CONC. ALTERNATE

PAVING SECTIONS
NOT TO SCALE

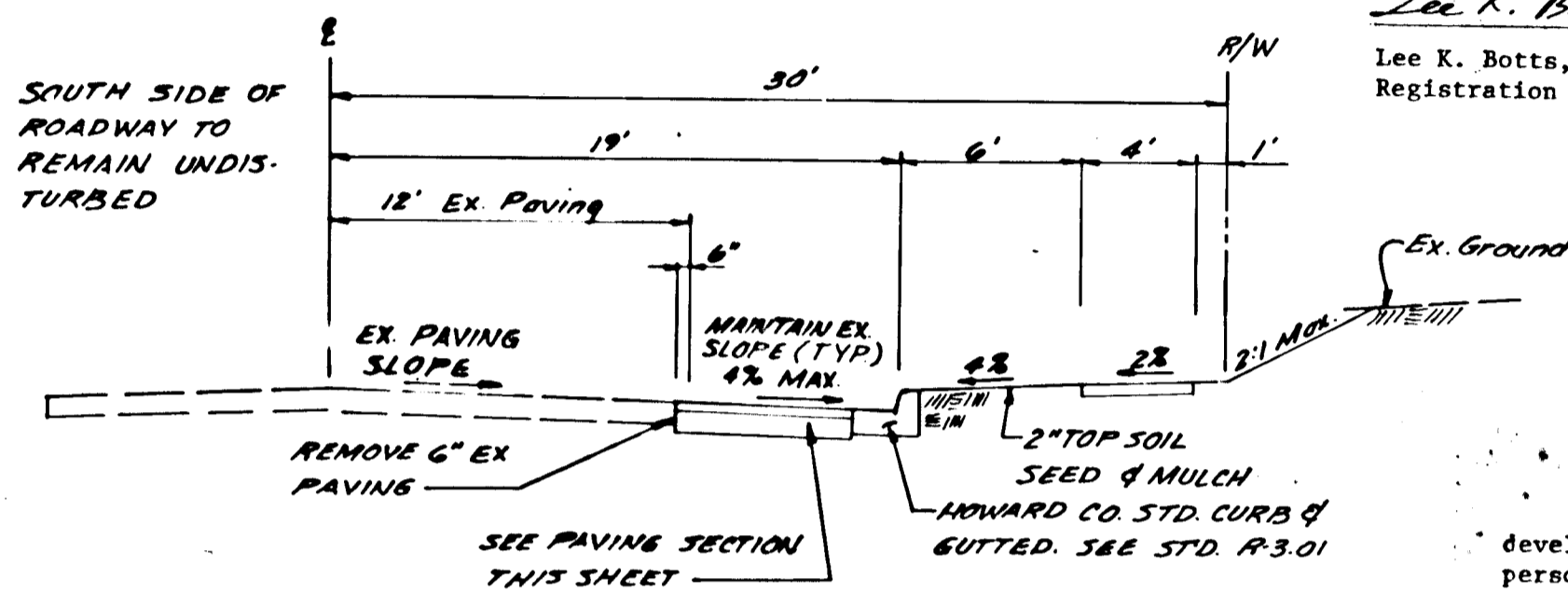

TYPICAL SECTION - N. LAUREL ROAD
NOT TO SCALE

Note
For Detail of Straw Bale Dike and Stabilized Construction Entrance, See Sections 13.01 & 14.01 of the Standards & Specifications for Soil Erosion and Sediment Control in Developing Areas

CUT AND FILL CERTIFICATION
I hereby certify that the estimated total amount of excavation and fill as shown on these plans have been computed to 174 cubic yards of excavation, 0 cubic yards of fill and the total area to be disturbed on these plans has been determined to be 4,240 square feet.

Lee K. Botts
Lee K. Botts, P.E.
Registration No. 9202
Date 2-13-84

OWNERS/DEVELOPERS CERTIFICATION
I/We hereby certify that all clearing, grading, construction and/or development will be done pursuant to this plan and that any responsible personnel involved in the construction project will have a certificate of attendance at a Department of Natural Resources approved training program for the control of sediment and erosion before beginning the project. I also authorize periodic on-site inspection by the Howard County Soil Conservation District or their authorized agents as deemed necessary.

Owner/Developer (Name and Title) Date
Purchaser 2-13-84

ENGINEER'S CERTIFICATION
I certify that this plan for erosion and sediment control represents a practical and workable plan based on my personal knowledge of the site conditions and that it was prepared in accordance with the requirements of the Howard County Soil Conservation District.

Lee K. Botts
Lee K. Botts, P.E.
Registration No. 9202
Date 2-13-84

OWNER
ROBERT L. CLAY
9325 ALL SAINTS ROAD
LAUREL MARYLAND 20707

DEVELOPER
ANDY ZUSI
137 BOWIE ROAD
LAUREL, MARYLAND 20707
(301) 725-8000

PAVING & SEDIMENT CONTROL PLAN
N. LAUREL ROAD WIDENING
CLAY PROPERTY

6TH ELECTION DISTRICT
HOWARD COUNTY, MARYLAND
Prepared By
PROGRESSIVE ENGINEERING CONSULTANTS
14333 LAUREL BOWIE RD. SUITE 108
LAUREL, MARYLAND 20708
(301) 792-8632

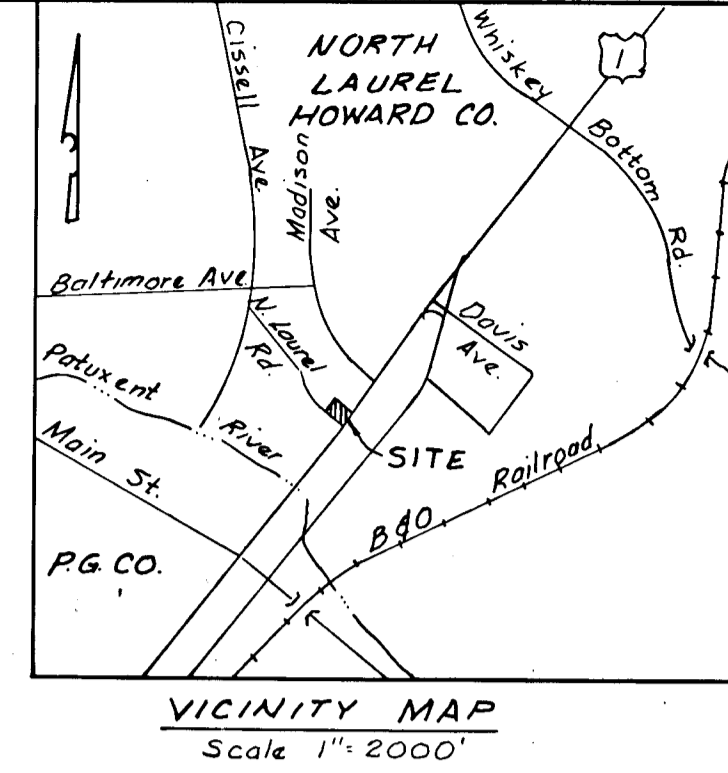

DATE	
BY	
SAVED	
NOTED	
PLANNING	
ENGINEERING	
CONSTRUCTION	
NO. OF WAY CHECKED	
NO.	

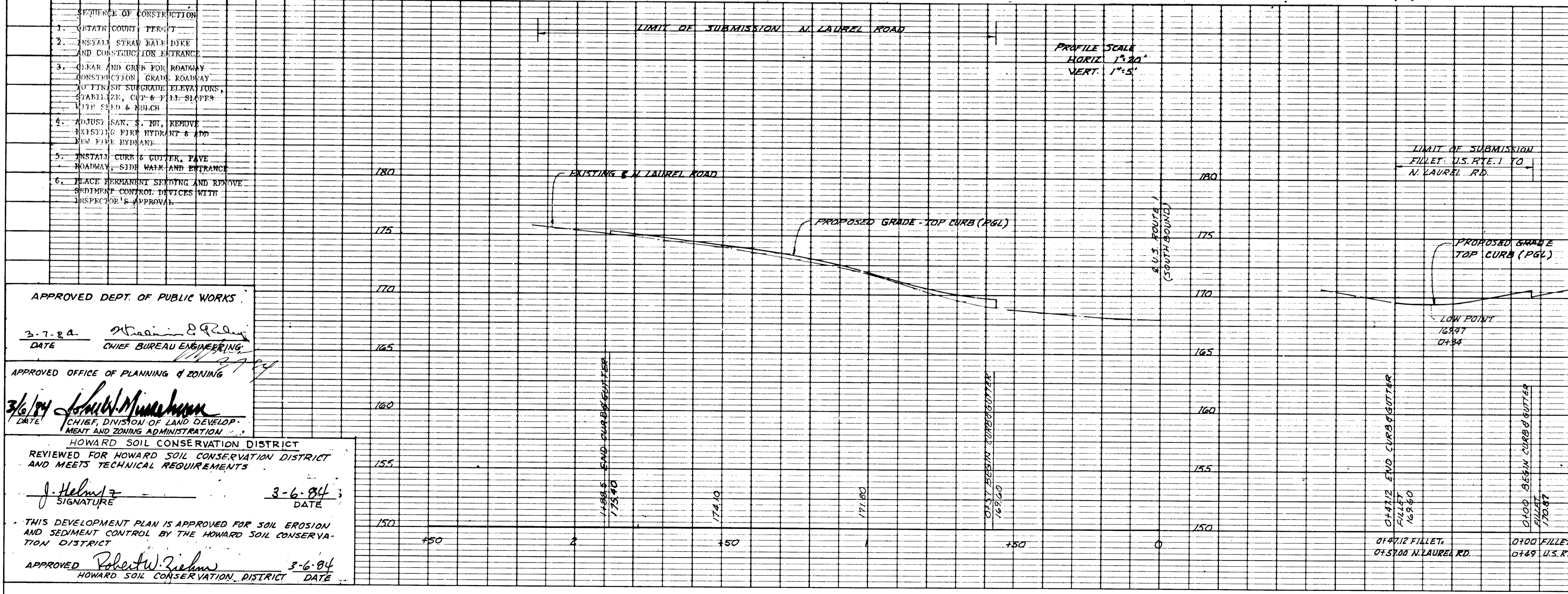

- General Notes
- Property Bearings and Bench Marks are in Howard County Datum.
 - All construction shall be in accordance with the Howard County Road Construction Code and Standard Specifications.
 - Information concerning underground utilities was obtained from available records, contractor to verify size and location of all utilities.
 - Elevations shown herein are based on the Howard County vertical control datum.
 - Standard drawing numbers referenced herein are taken from the "Standard Specifications and Details".
 - Storm water management will be submitted at site plan submission.

- SEDIMENT CONTROL NOTES
- All erosion control measures are to be constructed and maintained in accordance with applicable published "Standards and Specifications for Soil Erosion and Sediment Control in Developing Areas".
 - All sediment control measures to be adjusted to meet field conditions at the time of construction and be constructed prior to any grading or disturbance of existing surface material.
 - Periodic inspection and maintenance of all sediment control structures must be provided to insure intended purpose is accomplished.
 - All disturbed areas will be stabilized immediately following final grading in accordance with USFS-ACS Standards and Specifications for critical area stabilization as found in "Standards and Specifications for Soil Erosion in Developing Areas" for permanent seeding (sec. 1).
 - All points of construction ingress and egress will be protected to prevent tracking of mud on to public ways.

APPROVED DEPT. OF PUBLIC WORKS
3-7-84
DATE
CHIEF BUREAU ENGINEERING

APPROVED OFFICE OF PLANNING & ZONING
3/6/84
DATE
CHIEF DIVISION OF LAND DEVELOPMENT AND ZONING ADMINISTRATION

HOWARD SOIL CONSERVATION DISTRICT
REVIEWED FOR HOWARD SOIL CONSERVATION DISTRICT AND MEETS TECHNICAL REQUIREMENTS
J. Helms
SIGNATURE
3-6-84
DATE

THIS DEVELOPMENT PLAN IS APPROVED FOR SOIL EROSION AND SEDIMENT CONTROL BY THE HOWARD SOIL CONSERVATION DISTRICT
APPROVED Robert W. Zichman
HOWARD SOIL CONSERVATION DISTRICT
DATE 3-6-84