

W. O. Patten
 CHIEF, BUREAU OF ENGINEERING

10-24-79
 DATE

OFFICE OF PLANNING AND ZONING

John W. Madson
 CHIEF, DIVISION OF LAND DEVELOPMENT

10-19-77
 DATE

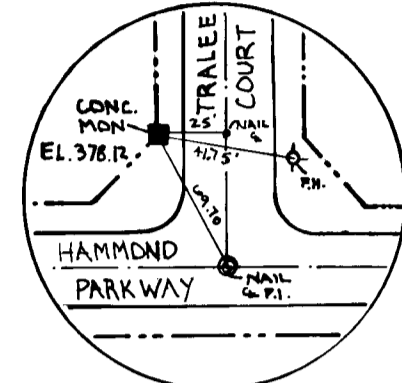

CONC. MDN. LOCATION
 ELEV. 378.12
 NO SCALE

AS-BUILT SURVEY DATA
 BY WALTER PARK MD REG. P.L.S. NO 5534
 SIGNED, SEALED & DATED 1/25/82

DATE	
BY	
PLANNED	
DESIGNED	
CHECKED	
DATE	

DATE	
BY	
PLANNED	
DESIGNED	
CHECKED	
DATE	

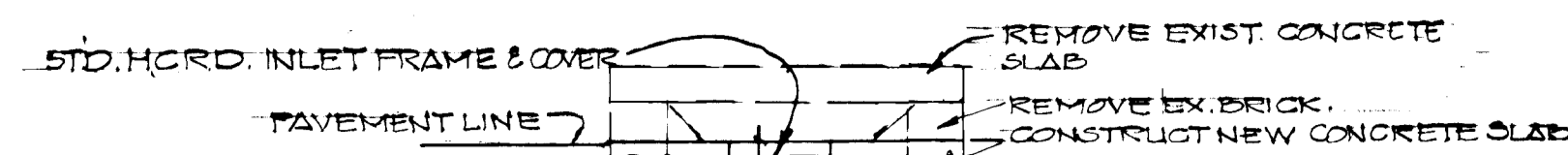

SECTION
 EX. INLET HAMMOND PKWY
 NO SCALE

CLEARING & GRADING ARTICLE C-1
 SUBGRADE ARTICLE C-2
 BASE COURSE ART. C-23
 SURFACE COURSE ART. C-31

BITUMINOUS CONCRETE SURFACE (BAND C-3) 1 1/2" BAND C-3
 BITUMINOUS CONCRETE BASE (GRAVEL MIX) 5" (GRAVEL MIX)

A TACK COAT IS REQUIRED IN ACCORDANCE WITH SECTION C-1-4 OF THE HOWARD COUNTY ROAD CONSTRUCTION CODE AND SPECIFICATIONS.

ASE WILL BE PRIMED IN ACCORDANCE WITH SECTION C-30-3 OF THE HOWARD COUNTY ROAD CONSTRUCTION CODE AND SPECIFICATIONS.

TO BE CONSTRUCTED IN ACCORDANCE WITH THE HOWARD COUNTY ROAD CONSTRUCTION CODE AND SPECIFICATIONS.

TYPICAL PAVING SECTION
 NO SCALE

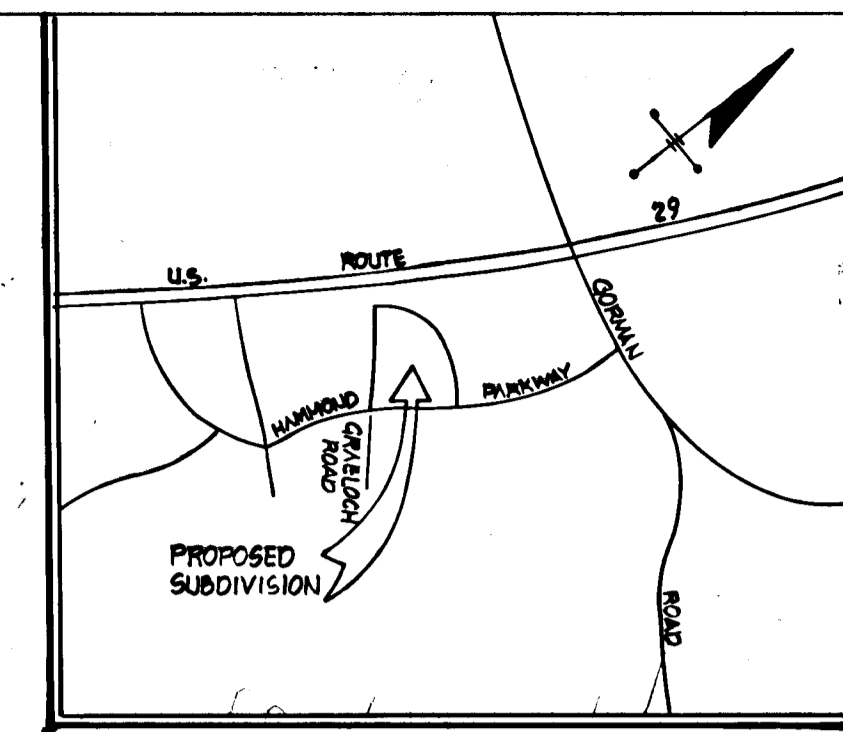

VICINITY MAP
 SCALE: 1" = 1200'

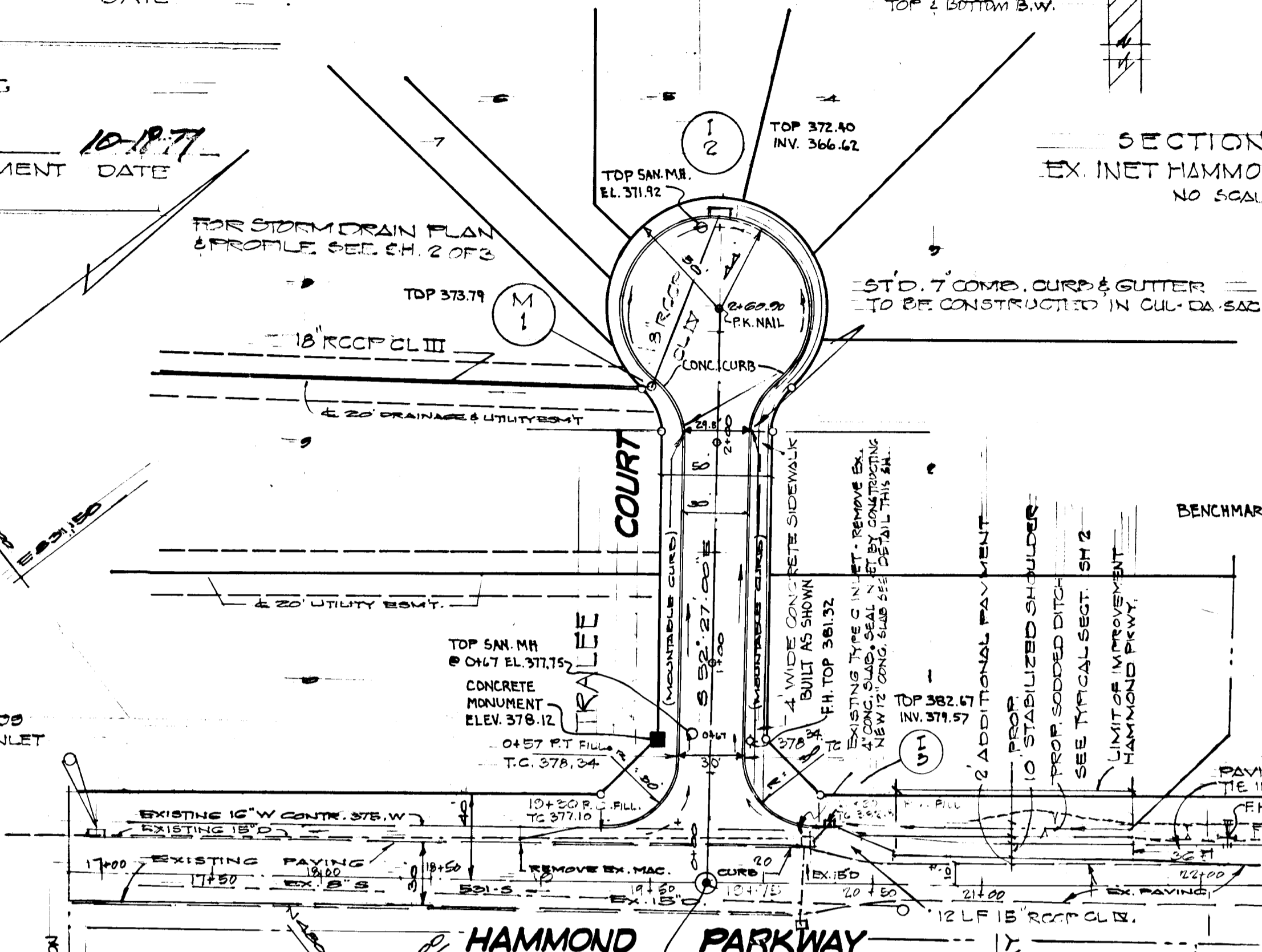

PLAN
 SCALE: 1" = 40'

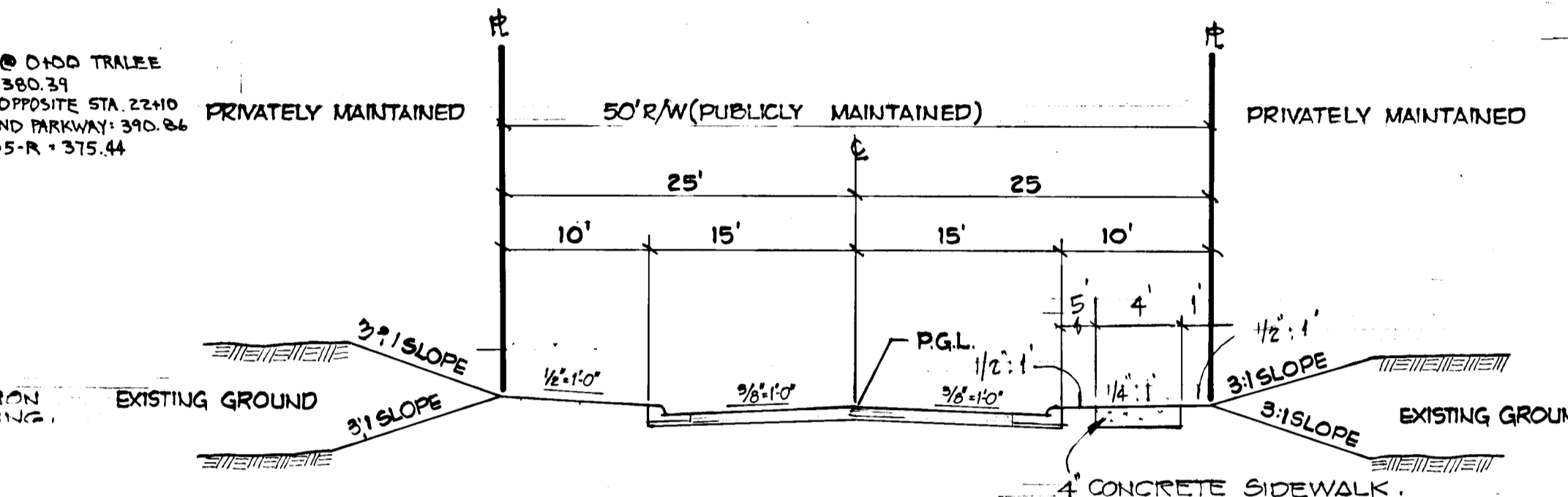

TYPICAL SECTION
 NO SCALE

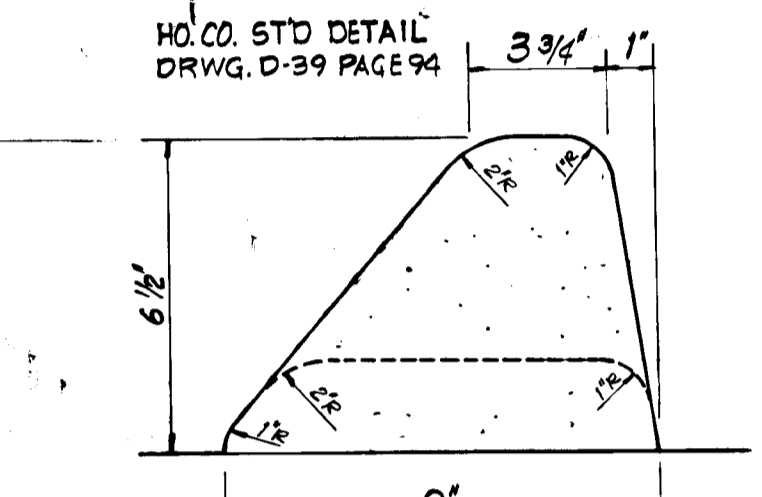

MOUNTABLE CURB
 NO SCALE

NOTE: CONTRACTOR TO DIRECT SIDE DITCH TO FLOW LINE 1-3 UNDER THE DIRECTION OF THE ENGINEER IN THE FIELD.

COUNTY COURT STAT. 0+00 TO STAT. 2+00.00
 SEE HO. CO. RD. CONSTR. CODE & STD. SPEC. DRWG. D-17 PAGE 72
 COUNTY COURT TRAFFIC WAY: RESIDENTIAL (LOCAL)
 ZONING CLASSIFICATION: R-20
 DESIGN SPEED: 25 MPH.

NO.	TYPE	INV. IN	INV. OUT	TOP PL.	REMARKS
1-3	STD CURB & INLET	379.57	382.67	382.67	SEE HO. CO. STD DETAILS - DRWG. 04 & PAGE 119-3

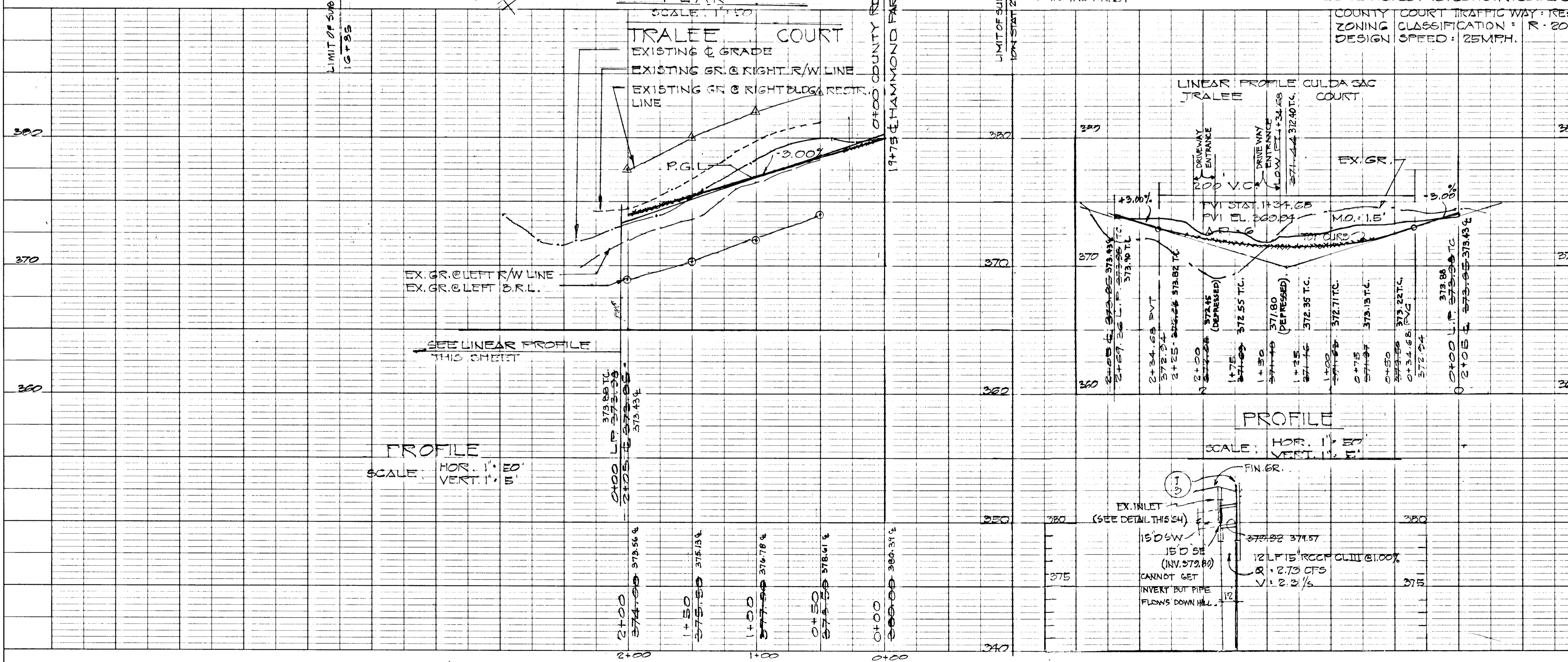

PROFILE
 SCALE: HOR. 1" = 40' VERT. 1" = 5'

OWNER: HOWARD RESEARCH AND DEVELOPMENT CORP.
 LITTLE PATENT PARKWAY
 COLUMBIA MD. 21044
 882-6000
 CONTRACT BUYER/DEVELOPER
 AARON COLLING
 12655 LIME KILN ROAD
 FULTON MD 20759
 280-6647

ROAD CONSTRUCTION PLAN
 TRALEE COURT
 STATION 0+00 TO STATION 2+05
 HAMMOND WOODS
 6TH ELECT. DISTR.
 SCALE: AS SHOWN
 HO. CO. MD.
 JULY 25, 1979

ENGINEERS
 LAND DEVELOPMENT CONSULTANTS
 HOOKINS ASSOCIATES
 SUITE 231 JACOB SQUARE
 COLUMBIA MD. 21044
 266-6543 / 730-3060

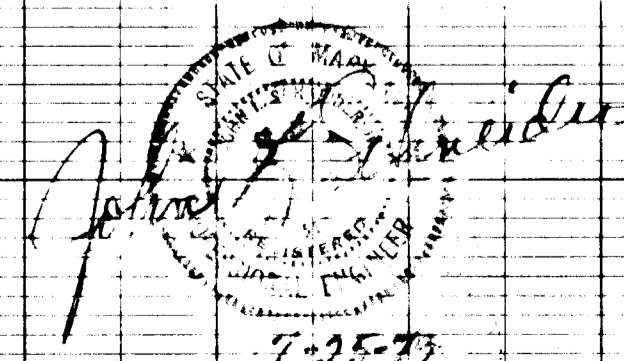

W.O. Patten
CHIEF, BUREAU OF ENGINEERING

10-24-79
DATE

OFFICE OF PLANNING AND ZONING

John Masserman
CHIEF, DIVISION OF LAND DEVELOPMENT

10-19-79
DATE

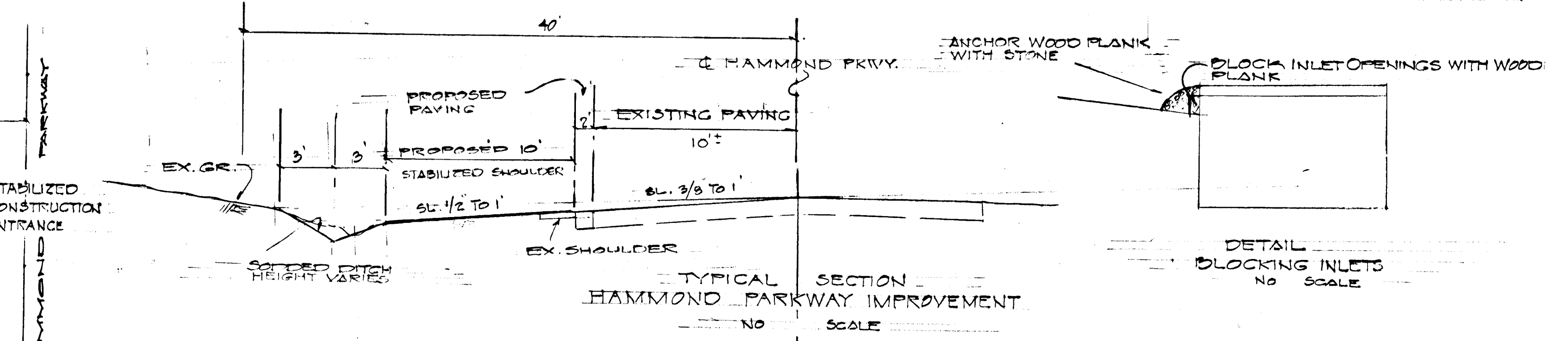
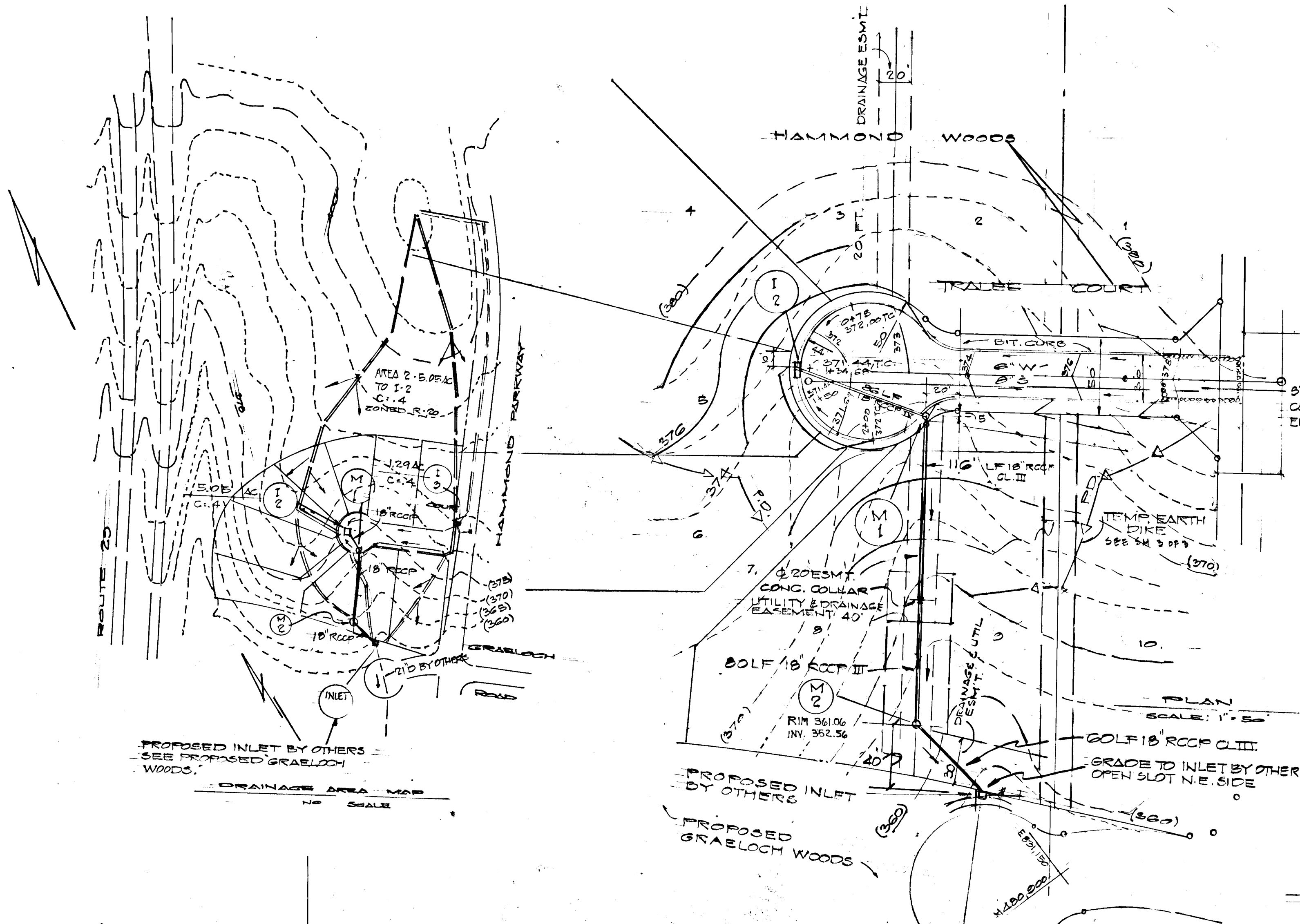

BITUMINOUS CONC. SURFACE	1 1/2" BAND C-3
BITUMINOUS CONC. BASE	5" GRAVEL MIX

CLEARING & GRADING	ARTICLE C-11
SUB GRADE	C-2
BASE COURSE	C-3B
SURFACE COURSE	C-31

TO BE CONSTRUCTED IN ACCORDANCE WITH THE HOWARD CO. ROAD CONSTRUCTION CODE AND SPECIFICATIONS DRWG. D-5 PAGE 60

HAMMOND PARKWAY IMPROVEMENT
NO SCALE

ENGINEERS CERTIFICATE: I HEREBY CERTIFY THAT THIS PLAN FOR EROSION AND SEDIMENT CONTROL REPRESENTS A PRACTICAL & WORKABLE PLAN BASED ON MY PERSONAL KNOWLEDGE OF THE SITE CONDITIONS AND THAT IT WAS PREPARED IN ACCORDANCE WITH THE REQUIREMENTS OF THE HOWARD SOIL CONSERVATION SOIL CONSERVATION DISTRICT.

John L. Schneider
JOHN L. SCHNEIDER P.E., MD. 7517
7-26-79
DATE

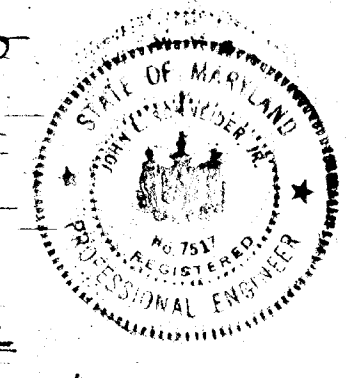

DEVELOPERS CERTIFICATE: I HEREBY CERTIFY THAT ALL DEVELOPMENT AND/OR CONSTRUCTION WILL BE DONE ACCORDING TO THIS PLAN OF DEVELOPMENT AND PLAN FOR EROSION & SEDIMENT CONTROL. WE AUTHORIZE PERIODIC ON-SITE INSPECTION BY THE HO. CO. SOIL CONSERVATION DISTRICT OR THEIR AUTHORIZED AGENTS AS ARE DEEMED NECESSARY. DEVIATION FROM THIS PLAN WILL NOT BE MADE UNLESS AUTHORIZED BY THE HO. CO. SOIL CONSERVATION DISTRICT.

Walter E. Woodruff
WALTER E. WOODRUFF P.E.
7-26-79
DATE

REVIEWED FOR HOWARD SOIL CONSERVATION DISTRICT AND MEETS TECHNICAL REQUIREMENTS

James M. Helin
JAMES M. HELIN
10-9-79
DATE

THIS DEVELOPMENT PLAN IS APPROVED FOR SOIL EROSION AND SEDIMENT CONTROL BY THE HOWARD SOIL CONSERVATION DISTRICT.

Robert W. Zecher
ROBERT W. ZECHER
10/9/79
DATE

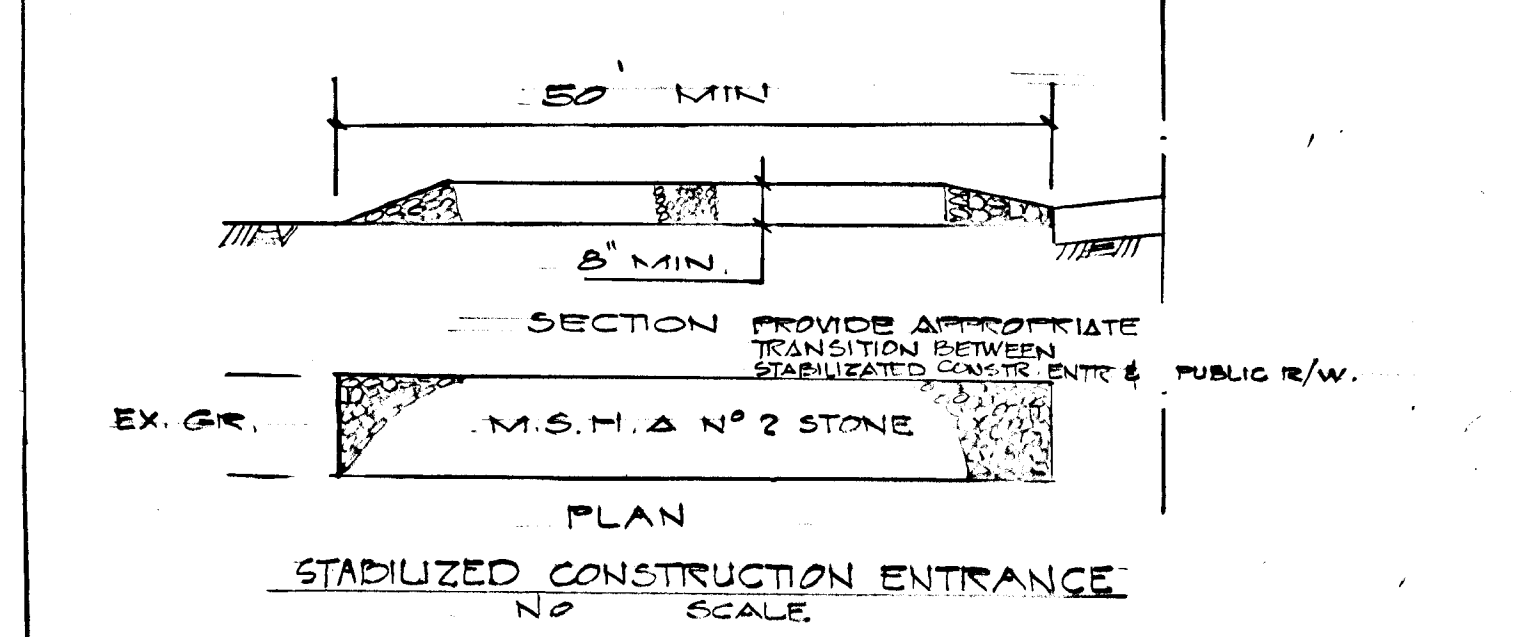

STORM DRAIN ALIGNMENT & SEDIMENT CONTROL MEASURES
PLAN SCALE: 1" = 50'

AS-BUILT SURVEY DATA BY WALTER PARK P.D. REG. P.L.S. NO. 5589, SIGNED, SEALED & DATED JAN 25, 1982

NO.	TYPE	INV. IN	INV. OUT	TOP EL.	REMARKS
M-2	HO. CO. STD. MANHOLE	352.40	352.20	352.20	SEE HO. CO. STD. DETAILS DRWG. D-103 P. 158
I-2	HO. CO. STD. CLASS 8-10 INLET	352.42	352.42	352.42	SEE HO. CO. STD. DETAILS DRWG. D-104 PAGE 119-A
M-1	HO. CO. STD. MANHOLE	352.50	352.61	352.45	SEE HO. CO. STD. DETAILS DRWG. D-103 PAGE 158

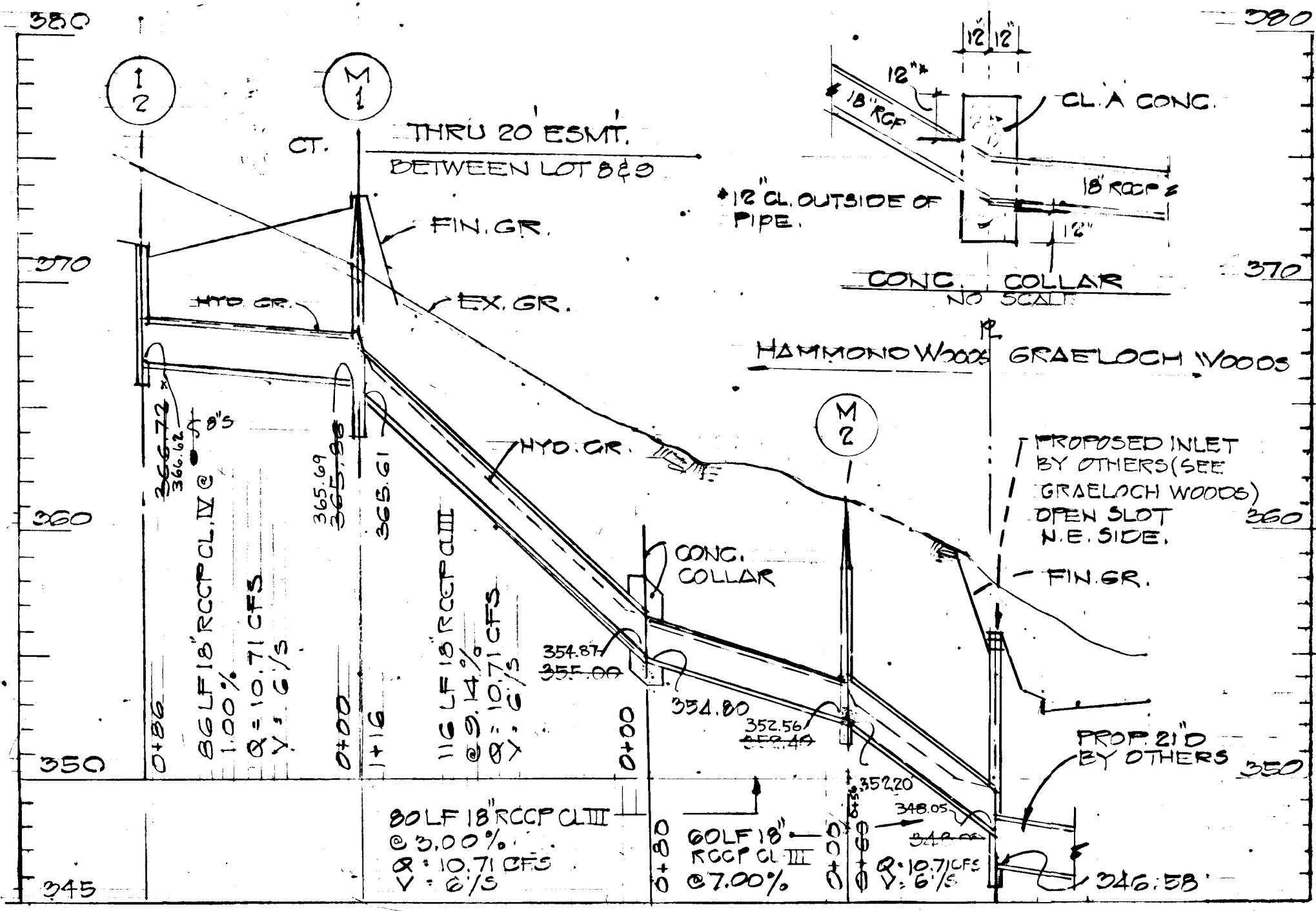

- SEDIMENT CONTROL NOTES:
1. OBTAIN GRADING PERMIT.
 2. THE HO. CO. BUREAU OF LICENSE & INSPECTION (EPCOMT) SHALL BE GIVEN 24 HRS NOTICE PRIOR TO ANY GRADING.
 3. ALL SEDIMENT CONTROL MEASURES SHOWN ON THIS PLAN UNLESS OTHERWISE SPECIFIED SHALL BE INSTALLED IN ACCORDANCE WITH NOTE B.
 4. ALL SLOPES SHALL BE MAX. 3:1
 5. FOLLOWING THE STABILIZATION OF ALL AREAS TO BE UPGRADDED THE AREA OF SEDIMENT CONTROL MEASURES MAY BE REMOVED & GRADED TO THE FINAL GRADES SHOWN AND STABILIZED IMMEDIATELY.
 6. IN THE EVENT OF EXCESS MATERIAL, EXCESS MATERIAL SHALL BE STOCKPILED WITH A MAX. SLOPE OF 3:1 IN AN AREA WHICH HAS BEEN CLEARED ON-SITE. STOCKPILED MATERIAL SHALL BE STABILIZED IN ACCORDANCE WITH NOTE #8.
 7. SEDIMENT CONTROL MEASURES SHALL NOT BE REMOVED UNTIL APPROVAL IS OBTAINED FROM THE HO. CO. BUREAU OF PERMITS, LICENSE, & INSPECTIONS
 8. PERMANENT STABILIZATION.
 - APPLY: 2000 LBS PER AC. OF FULVERIZED DOLOMITIC LIMESTONE
 - 700 LBS PER AC. OF 0-20-0 SUPER PHOSPHATE
 - 1000 LBS PER AC. OF 10-10-10 FERTILIZER
 - SEED: 95 LBS PER AC. OF KENTUCKY 31 TALL FESCUE & 25 LBS PER AC. OF ANNUAL RYE GRASS.
- NOTE: SEED BETWEEN MAR. 1 - MAY 1 OR AUG. 1 - OCT. 1 ONLY. MULCH: 2 TONS PER AC. OF UNWEATHERED WHEATSTRAW. 1/2" DOWN MULCH WITH 480 GAL PER AC. OF LIQUID ASPHALT

NOTE: THE OWNER SHALL BE RESPONSIBLE FOR THE RELOCATION OF ALL UTILITIES DISTURBED DURING THE IMPROVEMENT OF HAMMOND PARKWAY.

- SEDIMENT CONTROL NOTES:
1. INSTALL ALL SEDIMENT CONTROL MEASURES.
 2. BLOCK ALL INLETS DURING GRADING OPERATION. (SEE DETAIL THIS SH.)
 3. BLOCK INLET I-2 UNTIL STORM WATER MANAGEMENT CHAMBER IS COMPLETED IN PLACE.
 4. CONSTRUCTION SEQUENCE.
 - A. INSTALL SEDIMENT CONTROL MEASURES - 1 WEEK
 - B. ROUGH GRADE - 2 WK.
 - C. INSTALL UTILITIES - 3 WK.
 - D. FINAL GRADES - 1 WK.
 - E. PAVING - 1 WK.
 5. AREA TO BE RE-VEGETATED.
 - A. AREA OF SITE - 6.2 AC.
 - B. DISTURBED AREA 2.00 AC.
 - C. AREA TO BE RE-VEG. - 1.3 AC.

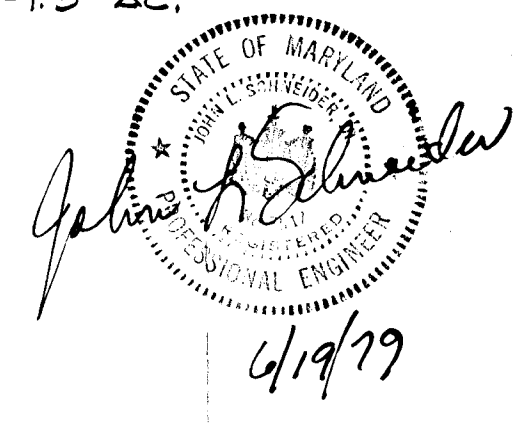

HAMMOND WOODS DETAILS

6TH. DIST. HO. CO. MD. SCALE: AS SHOWN JUNE 12, 1973

ENGINEERS: LAND DEVELOPMENT CONSULTANTS
HUPKINS & ASSOC.
SUITE 231 JOSEPH ST.
COLUMBIA MD 21044-730-8060

REVISION BOX	DESCRIPTION	REVISED
REV. NO. 1	DESCRIPTION	REVISED STORM DRAIN SYSTEM - OCT. 29/81

