

DATE: _____ BY: _____
 SURVEYED: _____
 NOTE BOOK: _____
 NO. _____

DATE: _____ BY: _____
 SURVEYED: _____
 NOTE BOOK: _____
 NO. _____

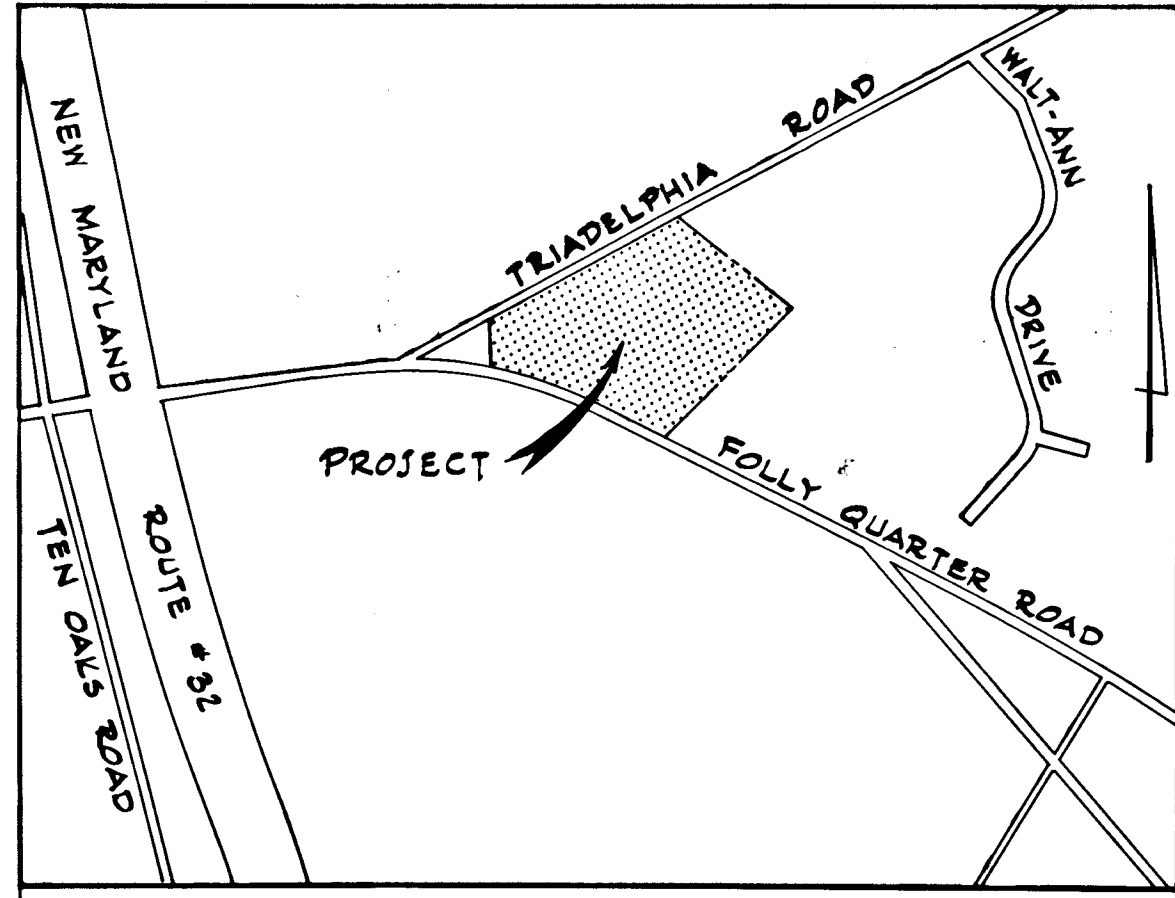

VICINITY MAP
 SCALE: 1" = 800'

DEVELOPER'S CERTIFICATE
 I certify that all development and/or construction will be done according to this plan of development and plan for Erosion and Sediment Control, and I also authorize periodic on-site inspection by the Howard Soil Conservation District or their authorized agents, as are deemed necessary. Deviation from this plan will not be made unless authorized by the Howard Soil Conservation District.
Arthur Newton 6/1/74

ENGINEER'S CERTIFICATE
 I certify that this plan for Erosion and Sediment Control represents a practical and workable plan based on my personal knowledge of the site conditions and that it was prepared in accordance with the requirements of the Howard Soil Conservation District.
James M. Helms 6/1/74
 Signature of Engineer Date

Reviewed for Howard County Soil Conservation District and meets Technical Requirements.
James M. Helms 10-9-74
 U.S. Soil Conservation Service Date

This development plan is approved for Soil Erosion and Sediment Control by the Howard Soil Conservation District.
 APPROVED: *Robert W. Ziehm* 10-9-74
 District Coordinator Date
 Howard Soil Conservation District

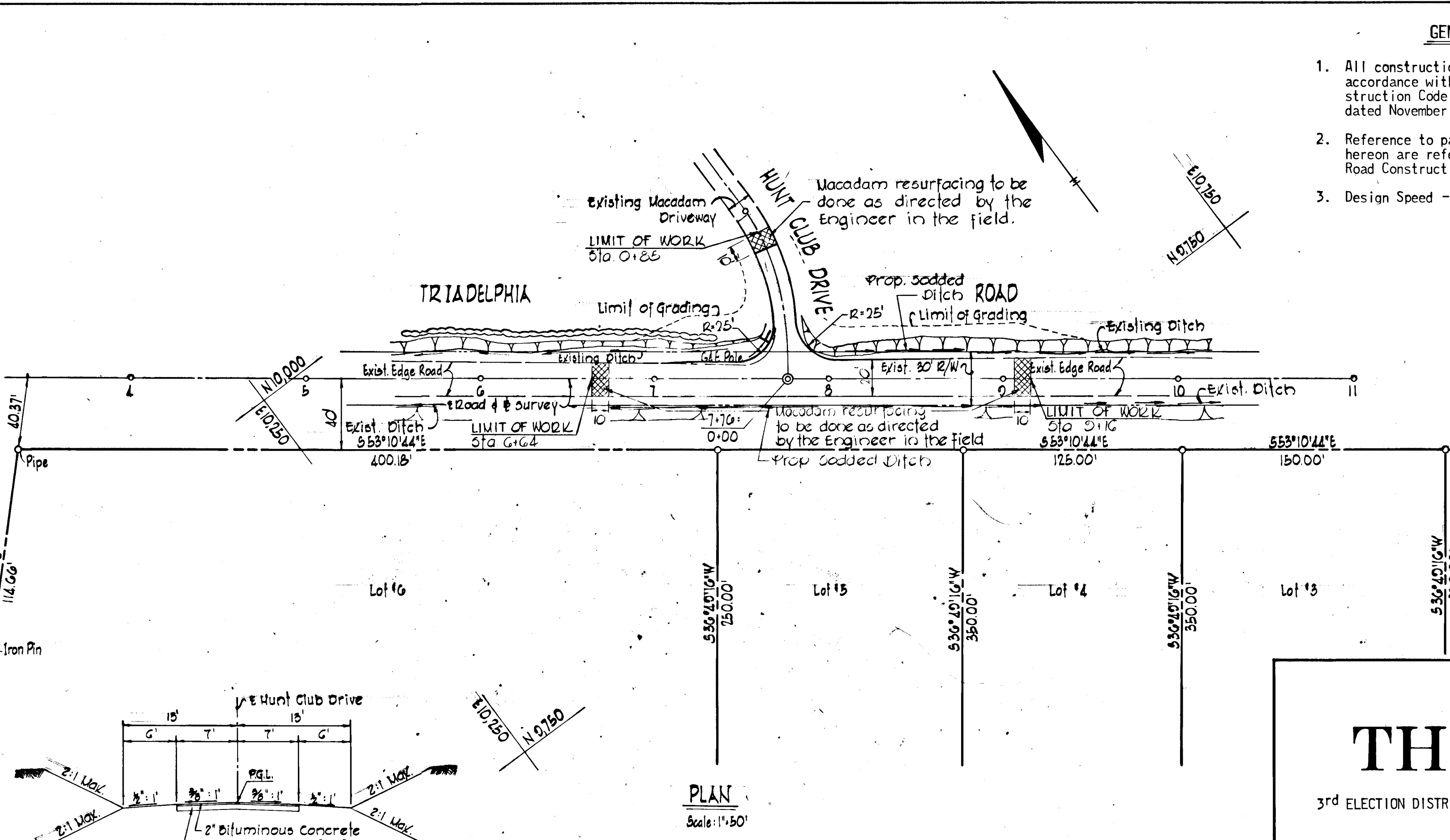
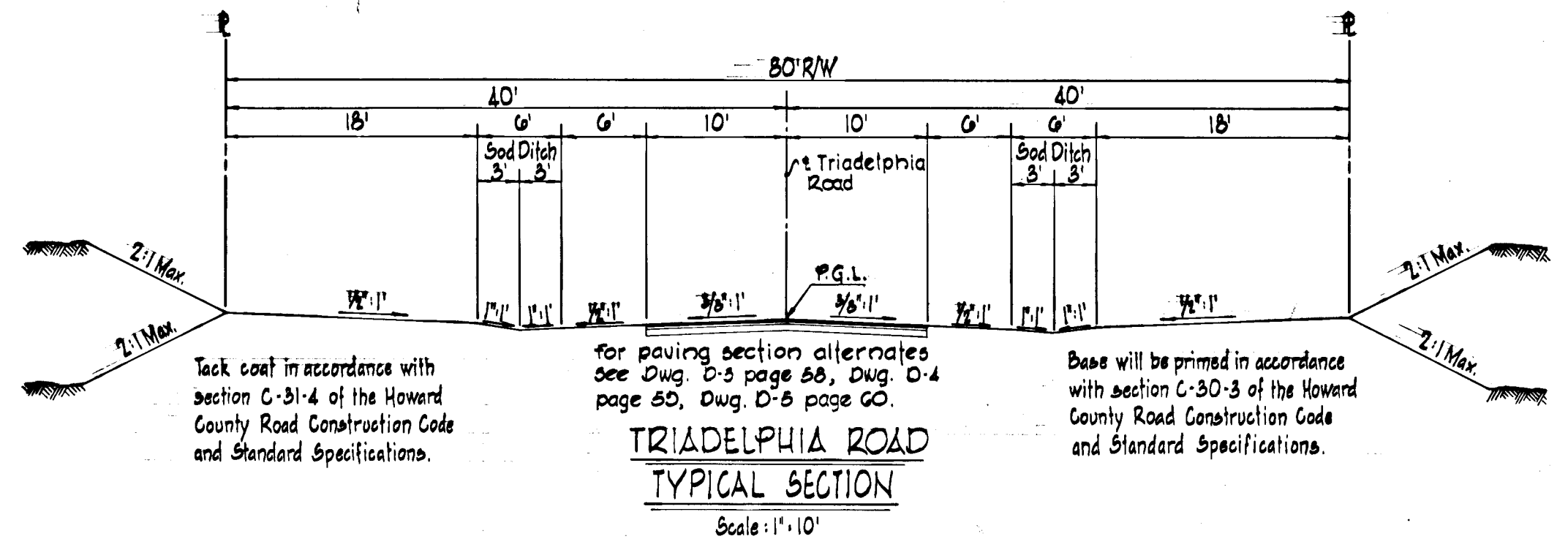

PLAN
 Scale: 1" = 50'

- GENERAL NOTES**
- All construction shown hereon shall be in accordance with the Howard County Road Construction Code and Standard Specifications dated November 27, 1962 and revised August, 1967.
 - Reference to page and drawing numbers shown hereon are referred to the above mentioned Road Construction Code and Standard Specifications.
 - Design Speed - 35 miles per hour.

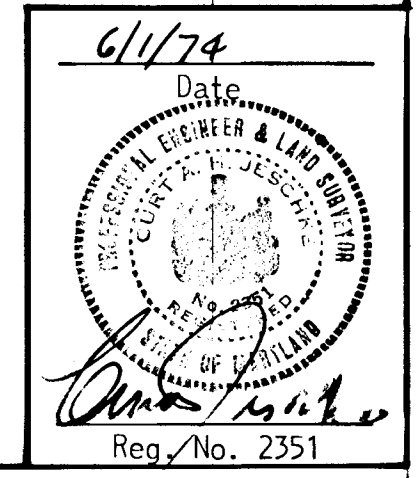

Designed by: *J. O'Hara*
 Drafted by: *B.D. Burton*
 Checked by: *R.B. Carter*

PURDUM & JESCHKE
 CONSULTING ENGINEERS &
 LAND SURVEYORS
 1023 N. Calvert Street
 Baltimore, Maryland 21202

OWNER & DEVELOPER
 TRIADELPHIA CENTER
 1318 Malbay Drive
 Lutherville, Maryland 21093

PLAN AND PROFILE
 TRIADELPHIA ROAD
THE CORNERS
 3rd ELECTION DISTRICT
 Sheet 1 of 1
 HOWARD COUNTY, MARYLAND
 SCALE: As Shown

J. M. Helms 10/16/74
 Chief, Bureau of Highways Date

R. A. Carson 10/14/74
 Chief, Division of Land Development and Transportation Planning Date

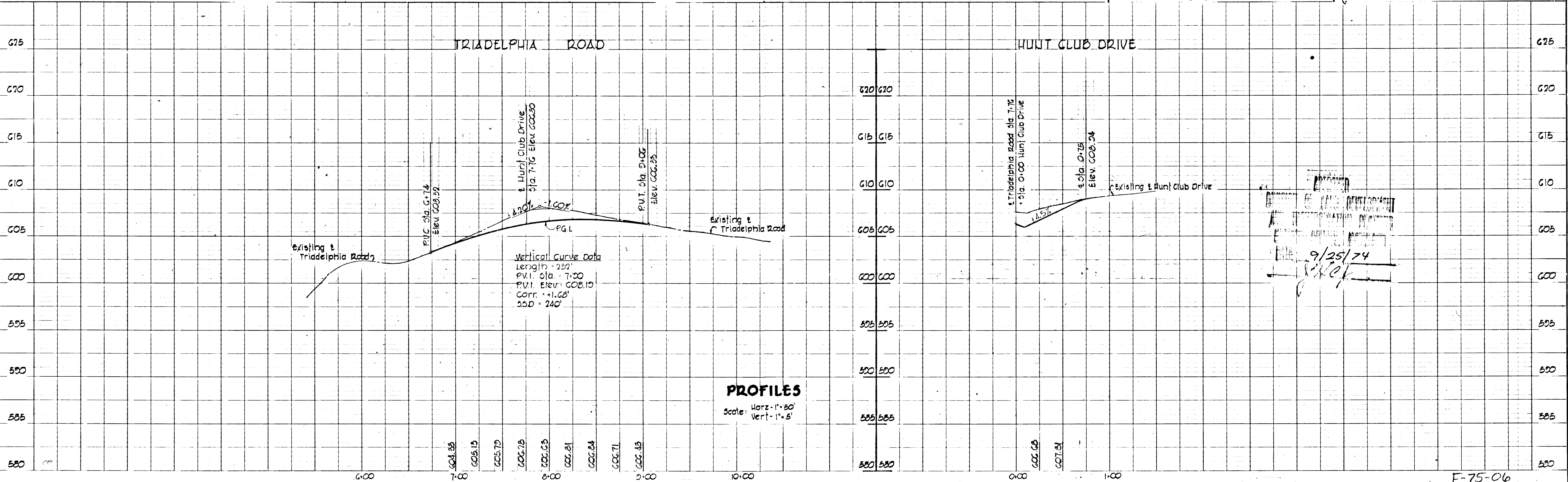

9/25/74
[Signature]