

COLUMBIA

ELECTION DISTRICT 6

SNOWDEN RIVER PARKWAY

HOWARD RESEARCH & DEVELOPMENT CORP.
HOWARD COUNTY, MARYLAND

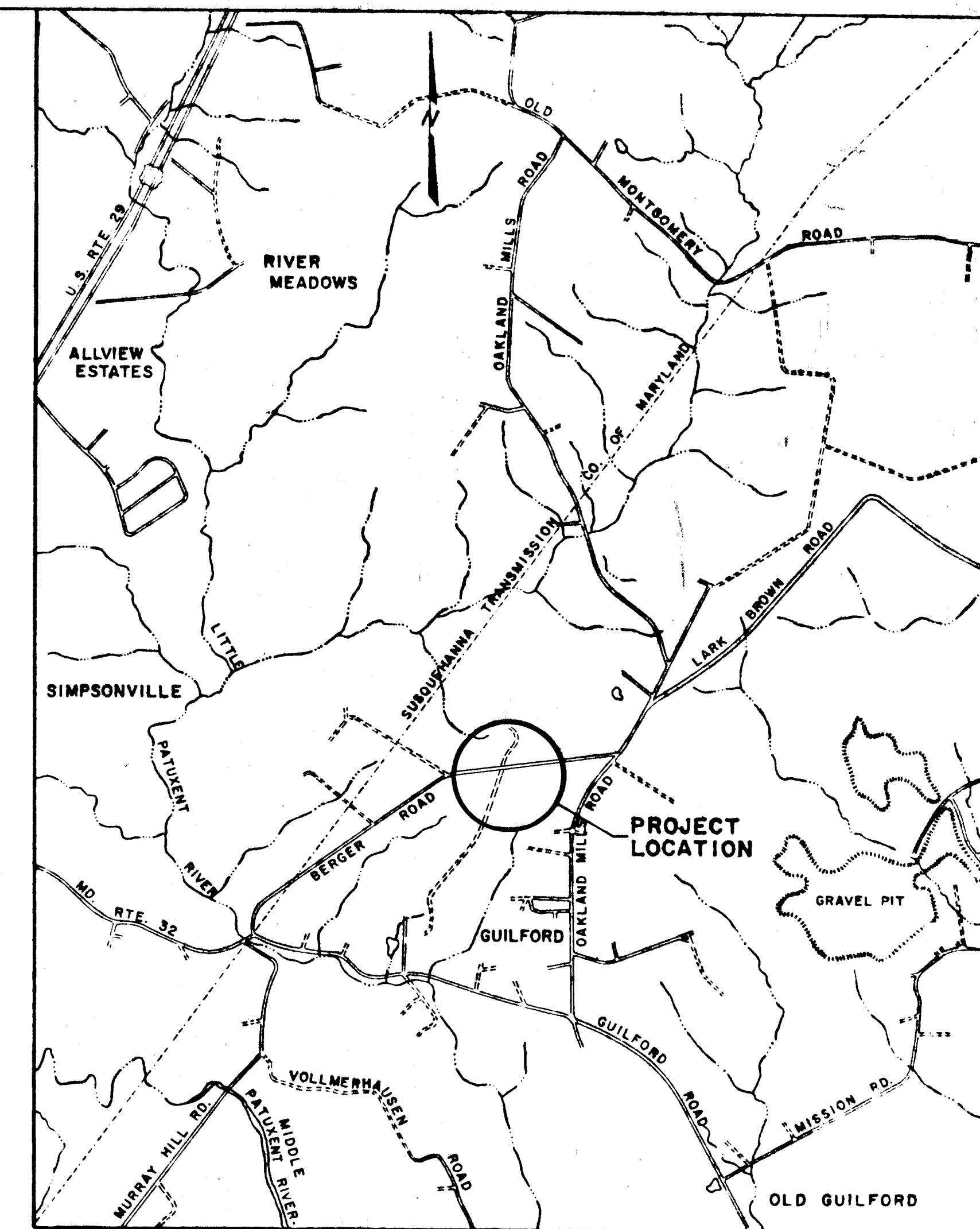

VICINITY MAP
SCALE: 1" = 2000'

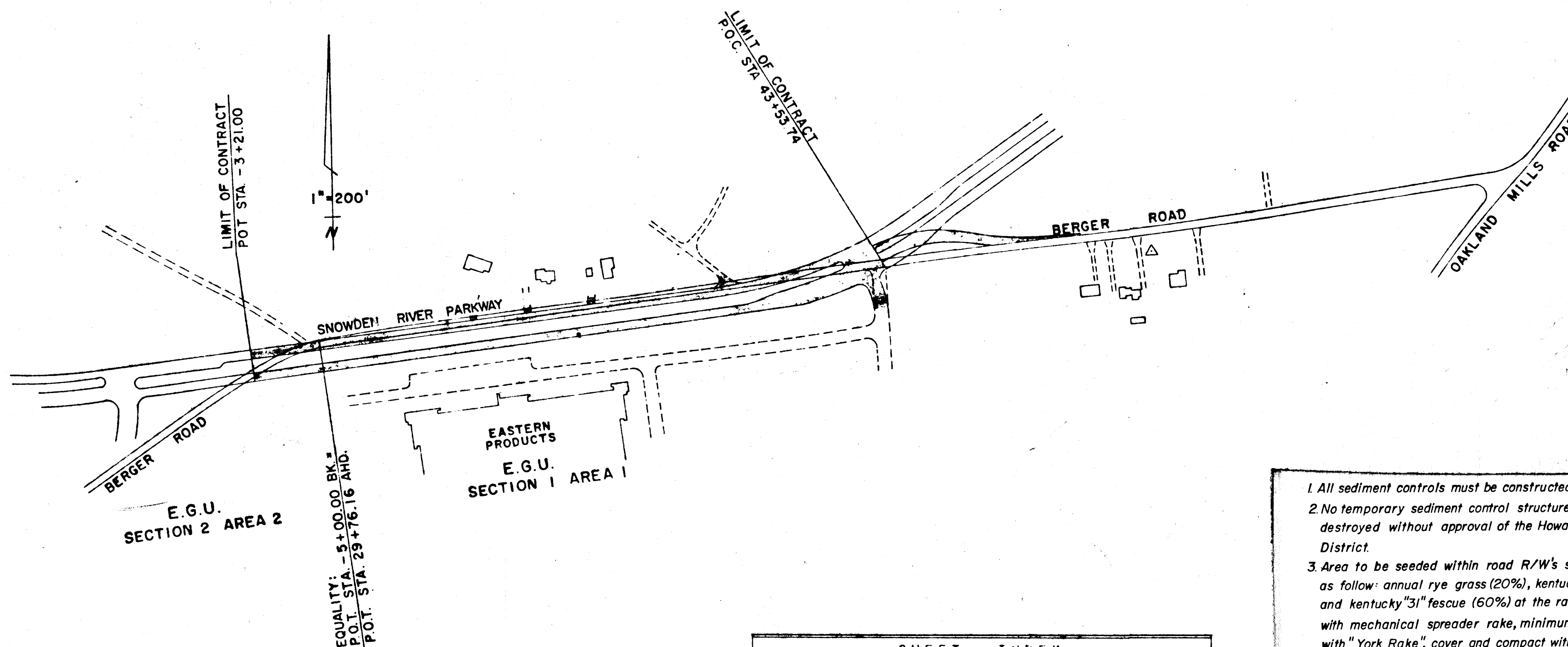

GENERAL NOTES

- APPROXIMATE LOCATION OF EXISTING UTILITIES ARE SHOWN. THE CONTRACTOR SHALL TAKE ALL NECESSARY PRECAUTION TO PROTECT THE EXISTING UTILITIES AND TO MAINTAIN UNINTERRUPTED SERVICE. ANY DAMAGE INCURRED DUE TO CONTRACTOR'S OPERATIONS SHALL BE REPAIRED IMMEDIATELY AT THE CONTRACTOR'S EXPENSE.
- THE CONTRACTOR SHALL TEST PIT EXISTING UTILITIES WHERE DIRECTED BY THE ENGINEER, A MINIMUM OF TWO WEEKS IN ADVANCE OF CONSTRUCTION OPERATIONS.
- FOR ALL DETAILS NOT SHOWN ON DRAWINGS SEE HOWARD COUNTY ROAD CONSTR. CODE AND STD. SPECS.
- TREES ARE TO BE PROTECTED AGAINST DAMAGE TO THE MAXIMUM EXTENT REASONABLE TREES WHICH ARE TO REMAIN IN STREETS AND OTHER RIGHTS OF WAY WILL BE MARKED BY THE ENGINEER PRIOR TO COMMENCING OF CONSTRUCTION OPERATIONS.
- DEVELOPER WILL PLACE ROADS TO SUBGRADE FOR THE FULL WIDTH OF THE RIGHT OF WAY BEFORE INSTALLATIONS OF UTILITIES.
- THE DEVELOPER SHALL ACCOMPLISH ALL GRADING WITHIN EASEMENT AREAS WHERE UTILITIES ARE TO BE INSTALLED BEFORE NOTICE TO PROCEED WILL BE ISSUED.
- CONTRACTOR TO NOTIFY THE FOLLOWING UTILITIES AT LEAST THREE DAYS BEFORE STARTING WORK SHOWN ON THIS/ THESE DRAWINGS:
BELL TELEPHONE SYSTEM 393 - 3649 HOWARD SOIL CONSERVATION
LONG DISTANCE CABLE DIVISION 393 - 3553 OR 3554 CONSERVATION
BALTIMORE GAS & ELECTRIC CO. 539 - 8000 EXT. 691 DISTRICT - 465-3120
- ALL DETAILS ARE FROM THE "ROAD CONSTRUCTION CODE AND STANDARD SPECIFICATIONS" ISSUED OR APPROVED BY THE COUNTY COMMISSIONERS AND THE HOWARD COUNTY ROAD DEPARTMENT.
- ALL ROADS ARE DESIGNED FOR 50 M.P.H. TRAFFIC SPEED IN ACCORDANCE WITH THE AMERICAN ASSOCIATION OF STATE HIGHWAY OFFICIAL STANDARDS.
- ALL ELEVATIONS SHOWN ARE BASED ON U.S.C. AND G.S. MEAN SEA LEVEL DATUM 1929.

- All sediment controls must be constructed prior to any grading.
- No temporary sediment control structure may be removed or destroyed without approval of the Howard Soil Conservation District.
- Area to be seeded within road R/W's shall use a seed mixture as follow: annual rye grass (20%), kentucky blue grass (20%) and kentucky "31" fescue (60%) at the rate of 200#/A. Sow with mechanical spreader rake, minimum of two (2) passes with "York Rake", cover and compact with cultipacker. Surface preparation to include ground limestone over topsoil surface area at the rate of 1% T/A (60#/1000²) commercial fertilizer (5-10-10) at the rate of 3/4 T/A (35#/1000²) and super-phosphate at the rate of 600#/A (15#/1000²).
- Immediately after grading topsoil will be replaced & all disturbed areas not to be paved will be stabilized according to note # 3.

SHEET INDEX	
SHEET	DESCRIPTION
1.	TITLE SHEET & VICINITY MAP
2.	DRAINAGE AREA MAP & DETAILS
3.	TYPICAL CROSS-SECTIONS & DETAILS
4.	TRANSITION SCHEDULE & DETAILS
5.	SNOWDEN RIVER PARKWAY - STA. 29+76.16 TO STA. 40+50
6.	SNOWDEN RIVER PARKWAY - STA. 40+50 TO STA. 43+53.74

TRAFFIC
ADT = 12,000

CERTIFICATION BY THE DEVELOPER:
"I certify that all development and/or construction will be done according to this plan of development and plan of silt and sediment control."
(Seal) *Ronald W. Goodwin* Signature Date 5/18/71
"This development plan is approved for soil erosion and sediment control by the Howard Soil Conservation District."
Reviewed *Howard W. Dittus* Date 5-18-71
Dist. Conservation
Approved *Howard W. Dittus* Date 5-18-71
Howard Soil Conservation District

- This is not an As-Built
- Refer to Road Construction Drawing
- with Approval Date of 9-24-71.

DEPARTMENT OF PUBLIC WORKS
S. M. McLeod 12/18/70
CHIEF, BUREAU OF HIGHWAYS DATE

OFFICE OF PLANNING AND ZONING
J. H. Clowry 5-18-71
CHIEF DATE

DIVISION OF LAND DEVELOPMENT & TRANSPORTATION PLANNING
GREEN ASSOCIATES, INC.
CONSULTING ENGINEERS
1130 N. CHARLES ST.
BALTIMORE, MARYLAND

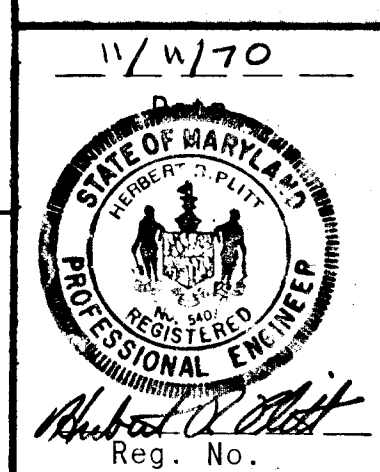

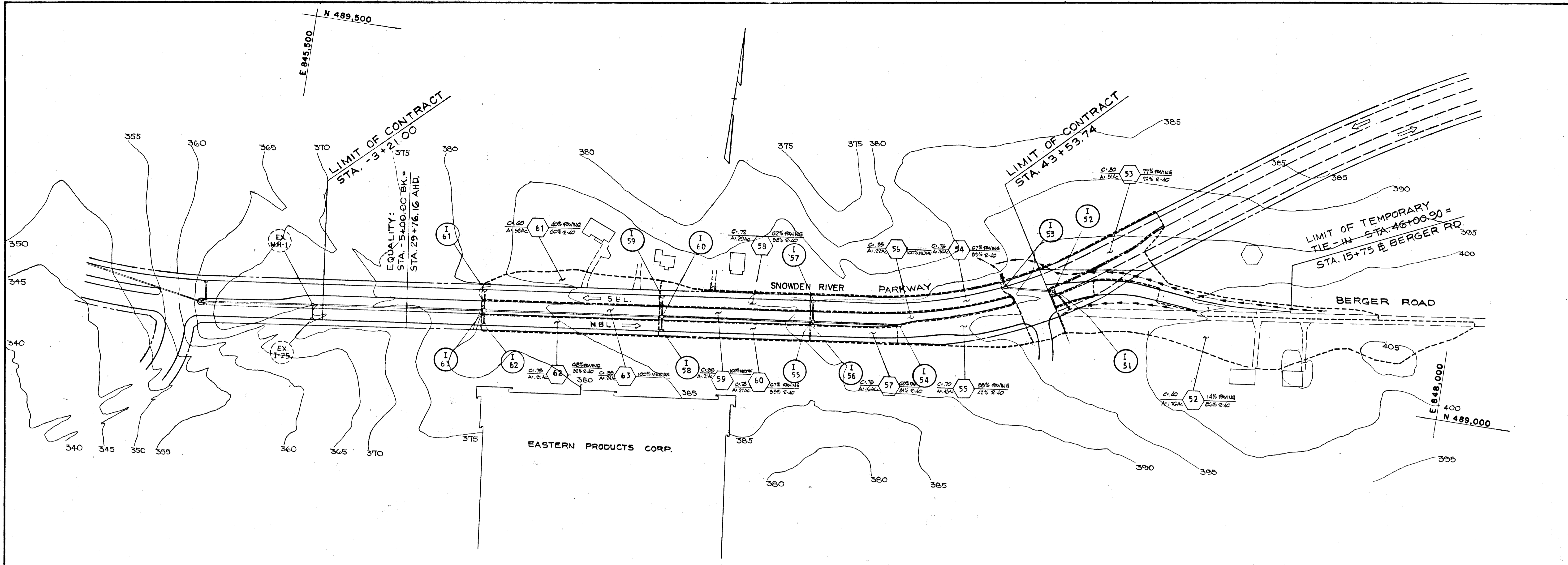

DRAINAGE AREA MAP

SCALE: 1" = 100'

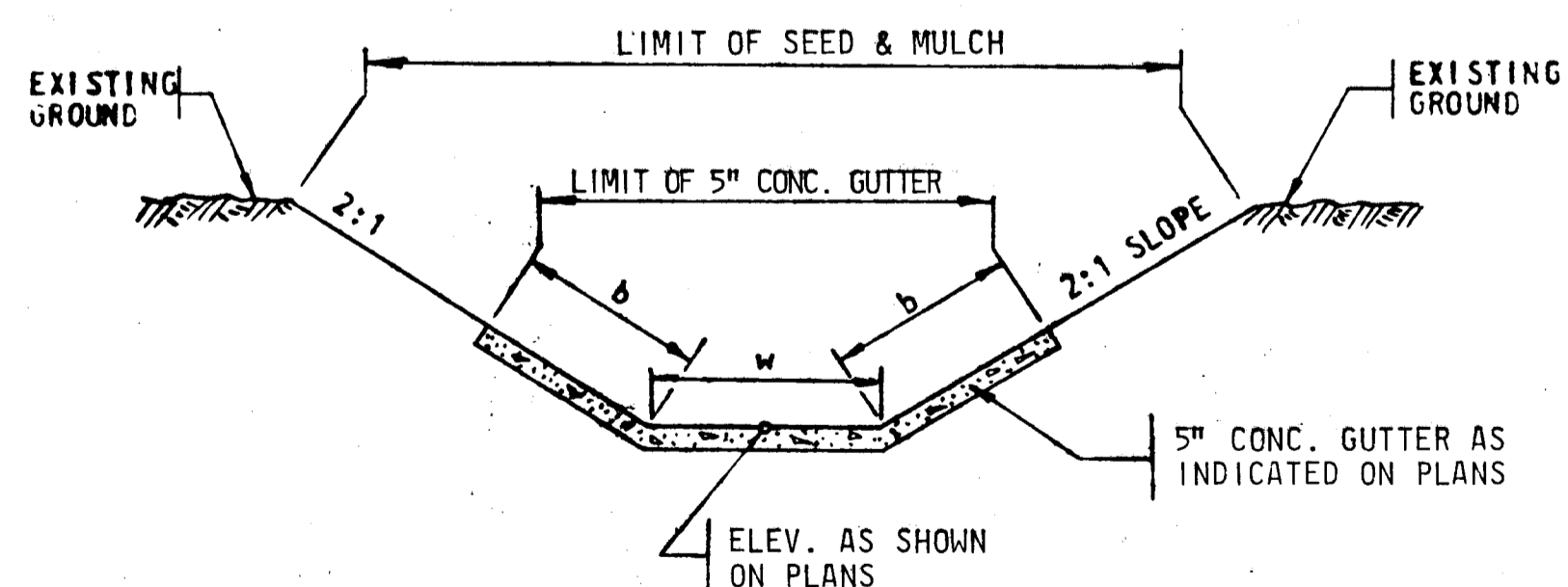

'a' DIMENSION IS SHOWN ON PLAN
'b' DIMENSION IS 2'-0" UNLESS SHOWN OTHERWISE ON PLAN.
SEED & MULCH ALL SLOPES NOT OTHERWISE TREATED.

INLET & OUTLET DITCH DETAIL

NOT TO SCALE

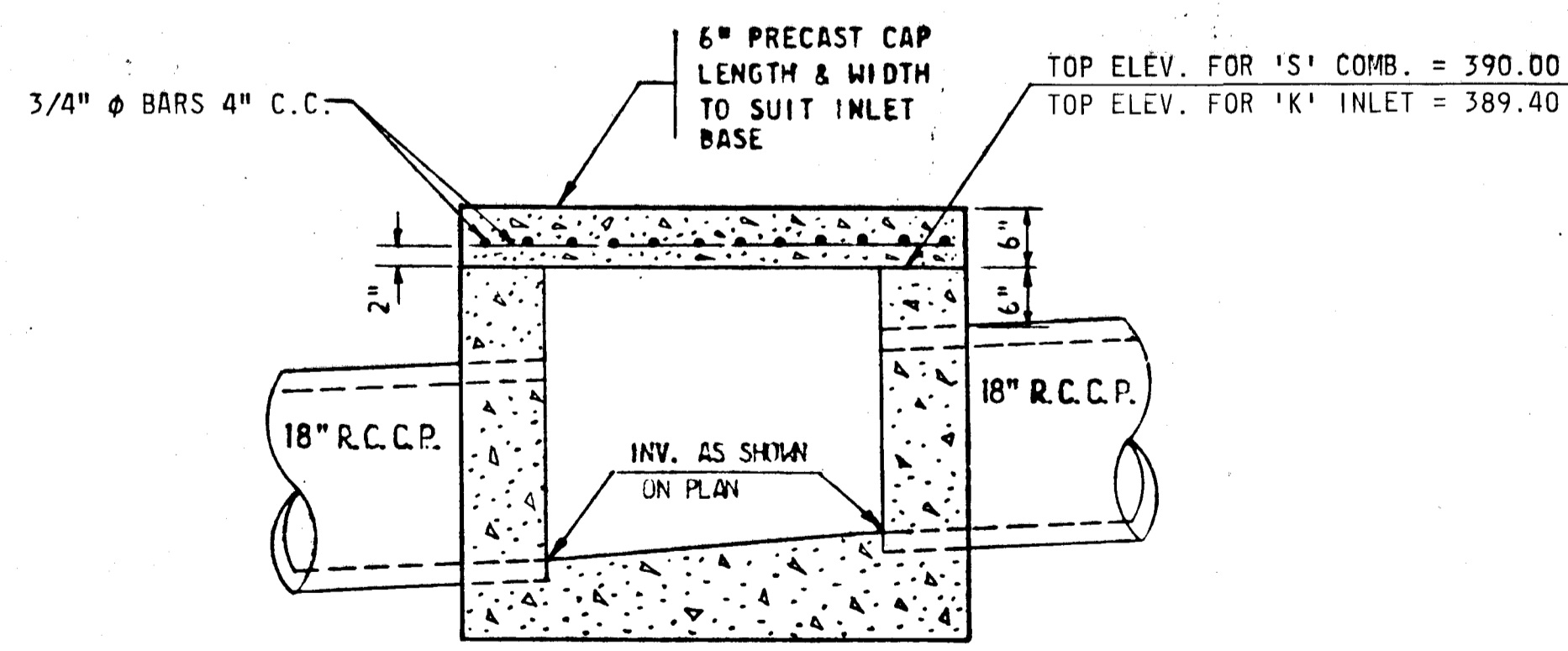

CAPPING DETAIL

STANDARD 'S' INLET (STA. 43+69)
STANDARD TYPE 'K' INLET (STA. 43+63)

DIMENSIONS OF INLETS SEE HOWARD COUNTY STANDARDS DRAWINGS D-93, PAGE 148 & DRAWING D-102, PAGE 157

NOT TO SCALE

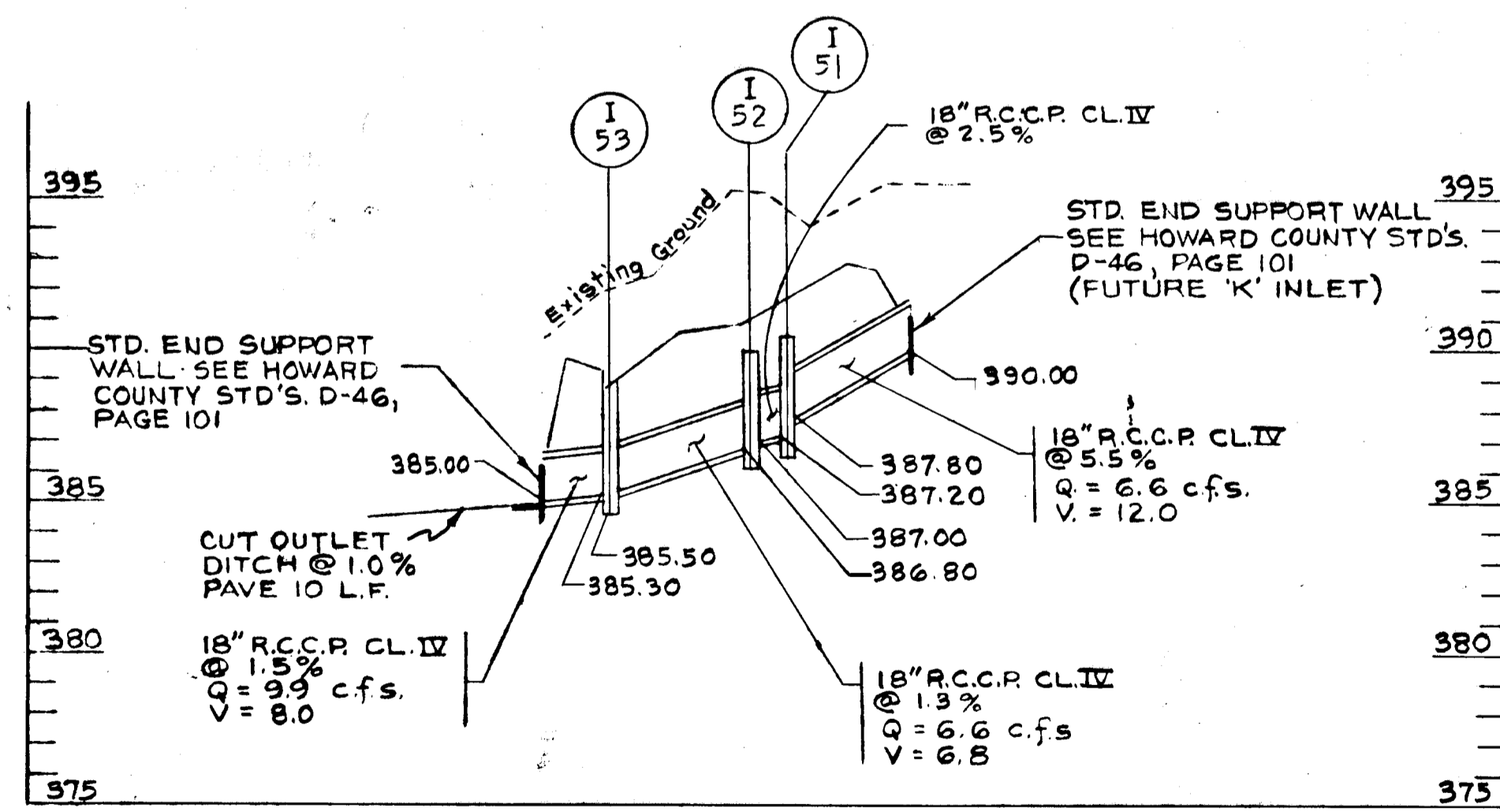

PROFILE

SCALE: HORIZ: 1" = 50', VERT: 1" = 5'

APPROVED
OFFICE OF PLANNING AND ZONING OF HOWARD COUNTY
DATE: 5-18-71
J. Neel

Rev Date	Rev No	Revision Description
COLUMBIA		
M A R Y L A N D 5th ELECTION DISTRICT HOWARD COUNTY OWNER AND DEVELOPER HOWARD RESEARCH AND DEVELOPMENT CORP. THE VILLAGE OF CROSS KEYS - BALTIMORE, MARYLAND 21207		
PROJECT AREA: E.G.U. SUBDIVISION; SECTION 1 AREA 1 & 2		
PROJECT TITLE: SNOWDEN RIVER PARKWAY DRAINAGE AREA MAP & DETAILS		
Des By: J.H.F., S.G.C.	Scale: AS SHOWN	Dwg No: 2 OF 6
Drn By: W.T.G.	Date: 5/13/69	C.C.F. No
Chk By:	Approved:	

DEPARTMENT OF PUBLIC WORKS
B. W. Wehland
CHIEF, BUREAU OF HIGHWAYS
DATE: 12/18/70

OFFICE OF PLANNING AND ZONING
CHIEF ENGINEER, DIVISION OF LAND DEVELOPMENT
DATE

GREEN ASSOCIATES, INC.
CONSULTING ENGINEERS
BALTIMORE, MARYLAND

F71-30C & F71-31C

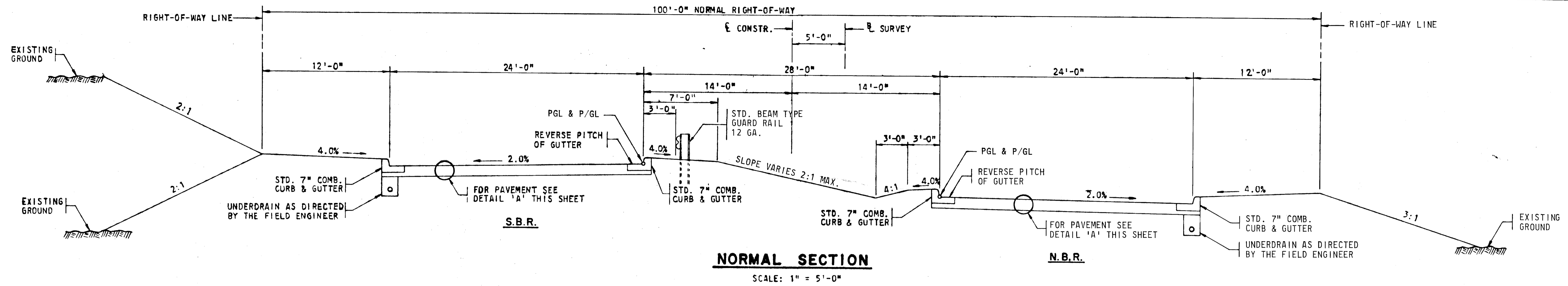

NORMAL SECTION
SCALE: 1" = 5'-0"

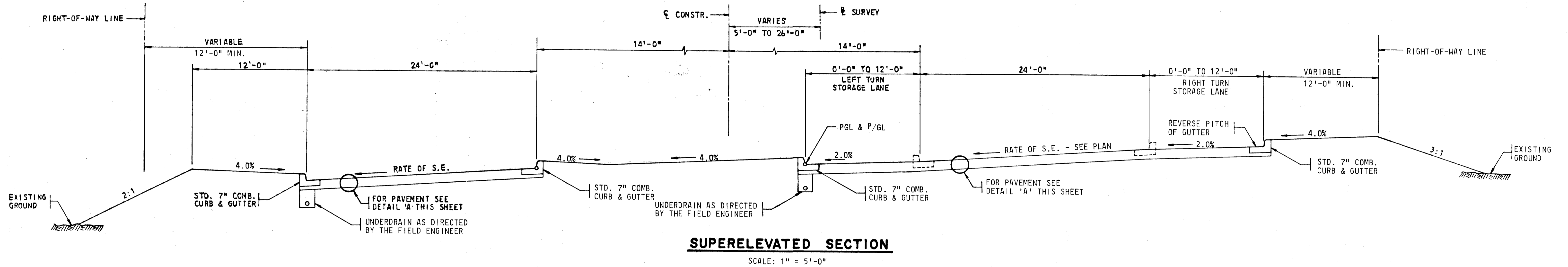

SUPERELEVATED SECTION
SCALE: 1" = 5'-0"

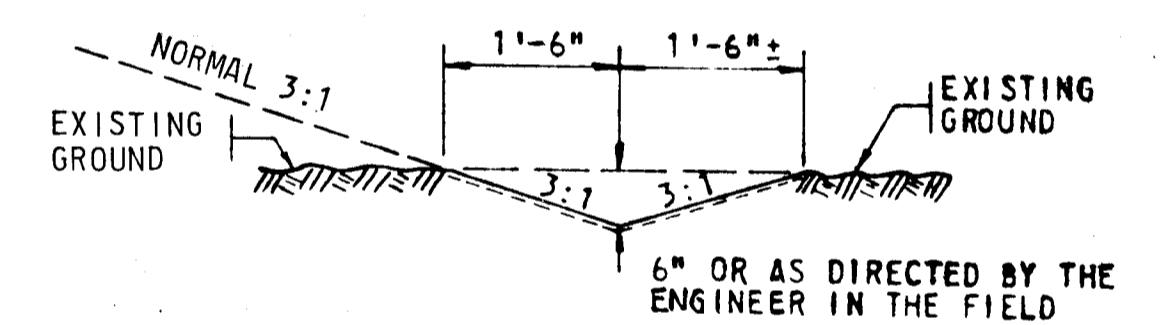

CONSTRUCT SODDED SWALE
RT.- STA. 30+60 TO STA. 41+40
NOT TO SCALE

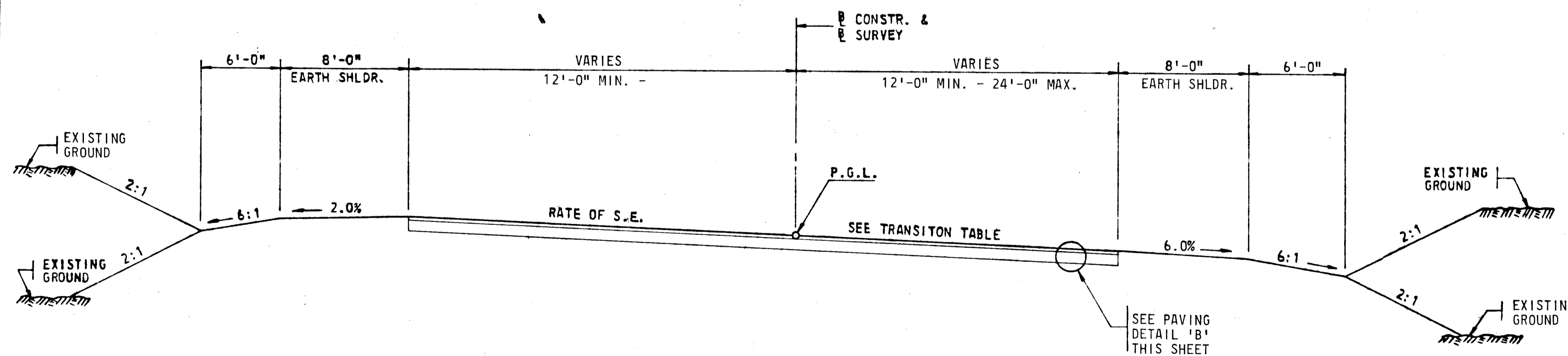

TEMPORARY CONNECTION
BERGER ROAD
STA. 43+60 TO STA. 49+
SCALE: 1" = 5'

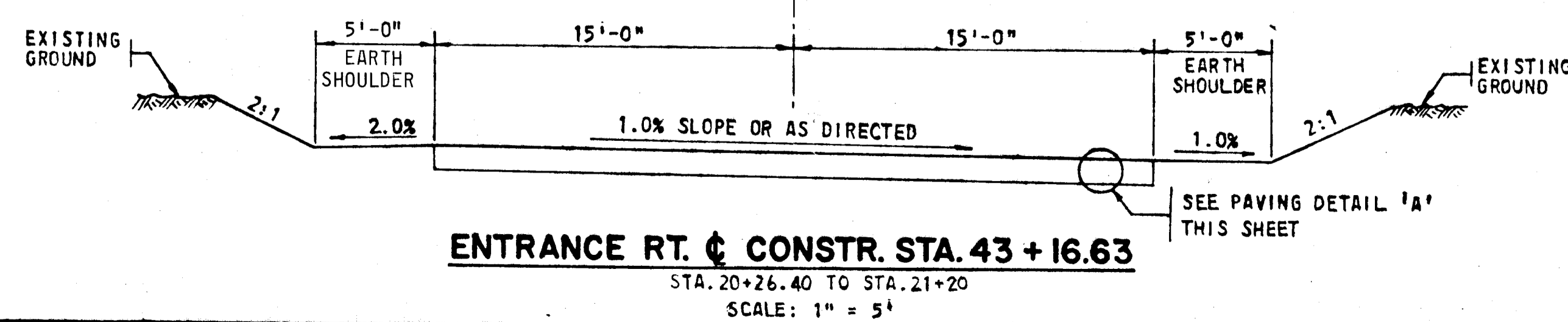

ENTRANCE RT. C CONSTR. STA. 43+16.63
STA. 20+26.40 TO STA. 21+20
SCALE: 1" = 5'

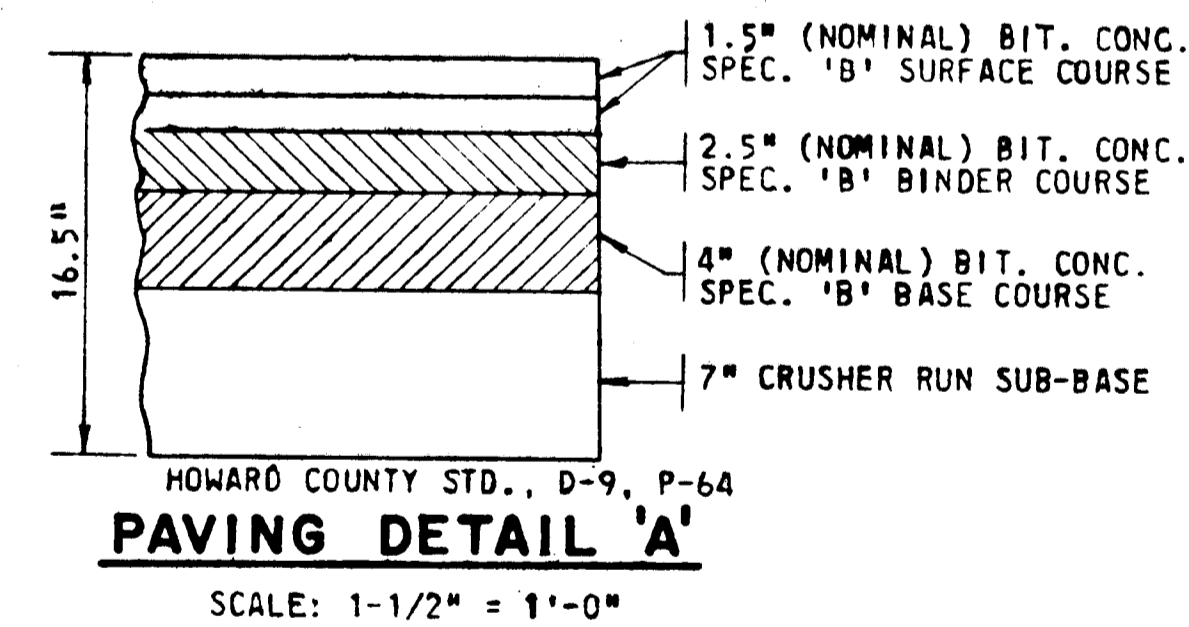

PAVING DETAIL 'A'
SCALE: 1-1/2" = 1'-0"

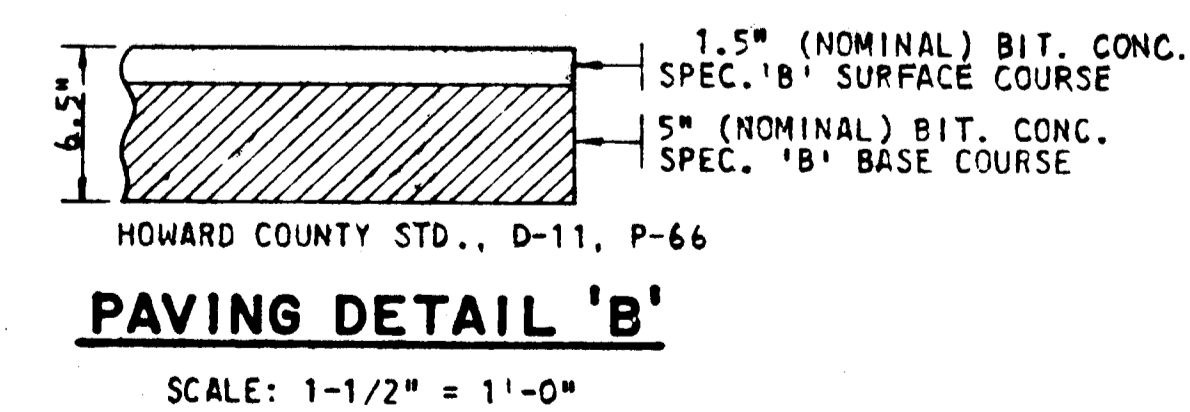

PAVING DETAIL 'B'
SCALE: 1-1/2" = 1'-0"

APPROVED
OFFICE OF PLANNING
AND ZONING OF
HOWARD COUNTY
DATE: 5-18-71
J.R.C.

DEPARTMENT OF PUBLIC WORKS
S. N. McLeod 12/18/70
CHIEF, BUREAU OF HIGHWAYS DATE
OFFICE OF PLANNING AND ZONING
CHIEF ENGINEER, DIVISION OF LAND DEVELOPMENT DATE

GREEN ASSOCIATES, INC.
CONSULTING ENGINEERS
BALTIMORE, MARYLAND

Rev. Date	Rev. No.	Revision Description
COLUMBIA		
M A R Y L A N D H I T C H E L I O N D I S T R I C T H O W A R D C O U N T Y OWNER AND DEVELOPER		
HOWARD RESEARCH AND DEVELOPMENT CORP. THE VILLAGE OF CROSS KEYS, BALTIMORE, MARYLAND 21230		
PROJECT AREA	E. G. U. SUBDIVISION SECTION 1 AREA 1 & 2	
PROJECT TITLE	SNOWDEN RIVER PARKWAY TYPICAL CROSS-SECTION & DETAILS	
Des. By	J. H. F.	Scale AS SHOWN
Drn. By	W. T. G.	Date 5/13/69
Chk. By	Approved	Eng. No. 3 OF 6 C.C.R. No.

F 71-30C & F 71-31C

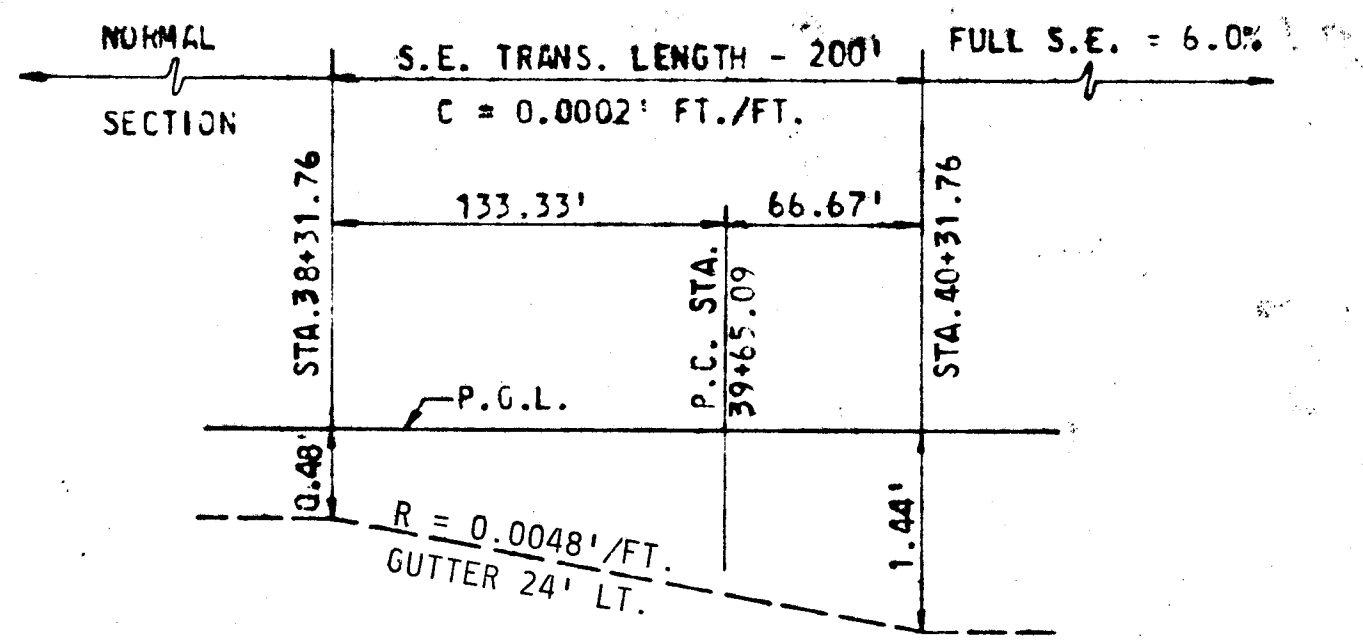

SOUTHBOUND LANE

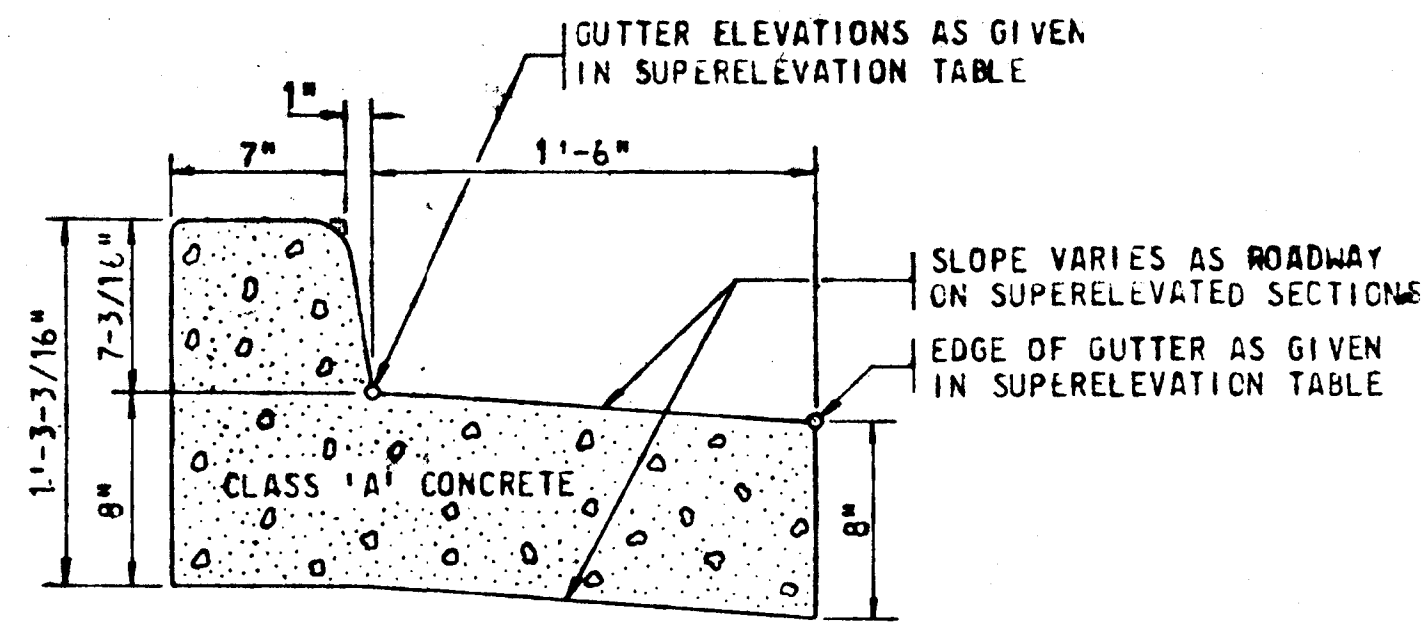

MODIFIED 7" COMBINATION CURB & GUTTER

SCALE: 1-1/2" = 1'-0"

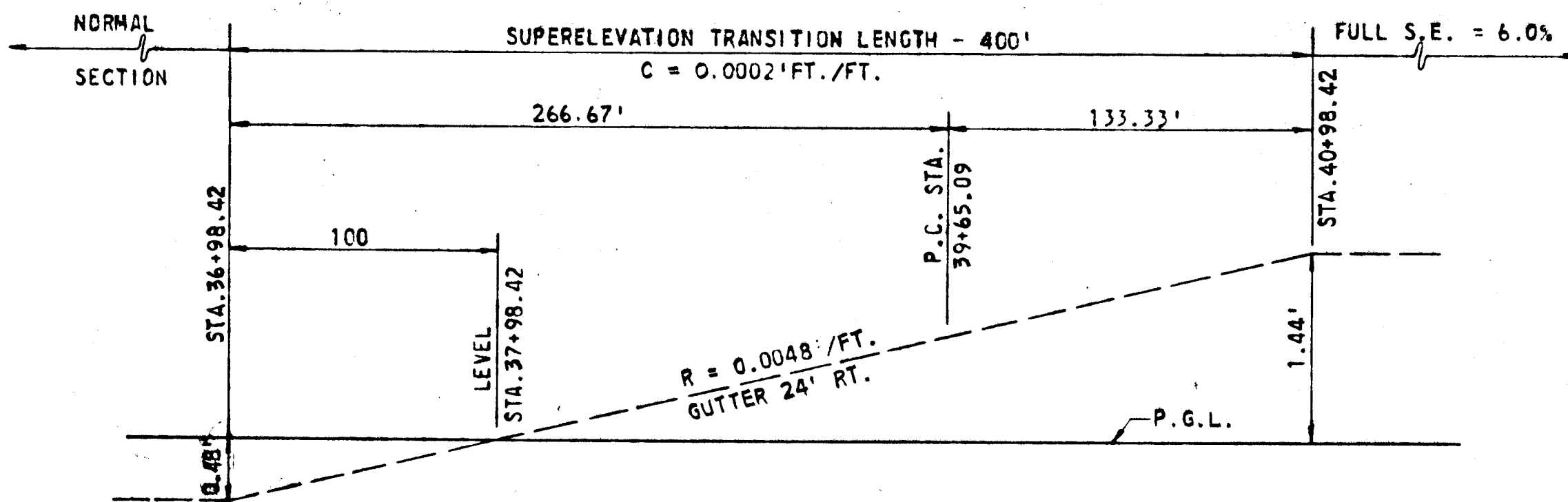

NORTHBOUND LANE

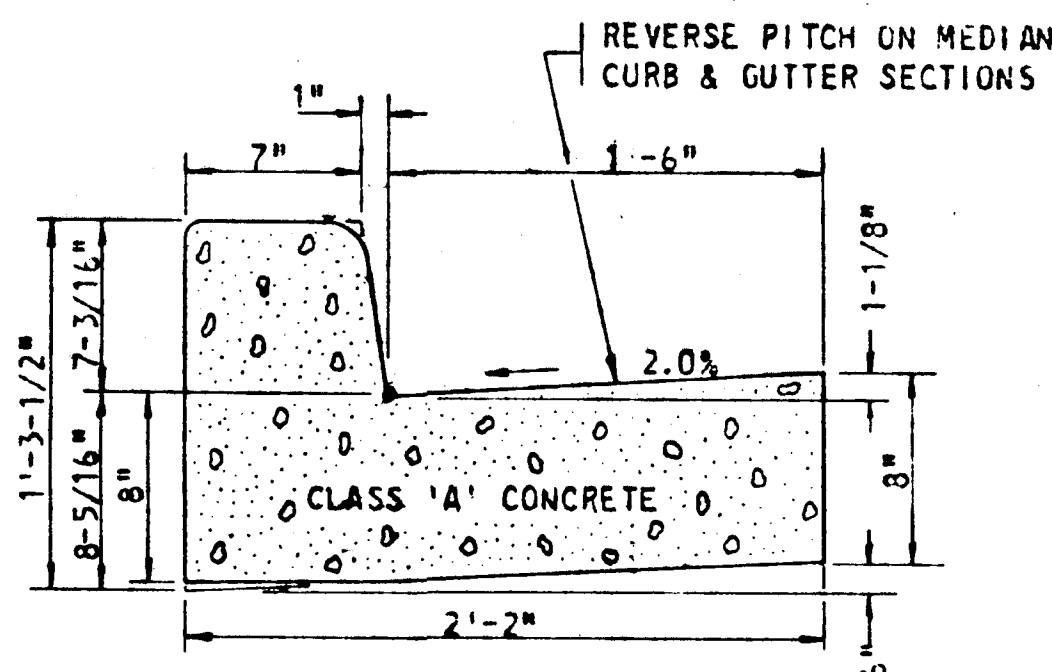

STANDARD 7" COMBINATION CURB & GUTTER

SCALE: 1-1/2" = 1'-0"

METHOD OF SUPERELEVATION TRANSITION

TRANSITION SCHEDULE

SOUTHBOUND LANE						NORTHBOUND LANE														
24' TRAFFIC LANE						12' DECELERATION LANE					24' TRAFFIC LANE					12' DECELERATION LANE				
24' LT. GUTTER	RT. EDGE GUTTER	SLOPE	LT. EDGE GUTTER	P.C.L. ELEV.	STATION	LEFT GUTTER	RT. EDGE GUTTER	SLOPE	DIST. LT. P.C.L.	STATION	P.C.L. ELEV.	RT. EDGE GUTTER	SLOPE	LT. EDGE GUTTER	24' RT. GUTTER	DIST. RT. GUTTER	SLOPE	LT. EDGE GUTTER	RIGHT GUTTER	
387.14	387.17	-2.00%	387.59	387.62	38+31.76					36+98.42	381.73	381.70	-2.00%	381.28	381.25					
387.16	387.20	-2.96%	387.70	387.73	38+50					37+00	381.75	381.72	-1.97%	381.31	381.28					
387.19	387.24	-2.86%	387.84	387.88	38+75					37+25	382.12	382.10	-1.47%	381.79	381.77					
387.22	387.27	-3.36%	387.98	388.03	39+00					37+50	382.49	382.48	-0.97%	382.27	382.26					
387.25	387.31	-3.86%	388.12	388.18	39+25					37+75	382.86	382.85	-0.47%	382.76	382.75					
387.28	387.35	-4.36%	388.27	388.33	39+50					37+98.42	383.21	383.21	0.00%	383.21	383.21					
387.30	387.37	-4.66%	388.35	388.42	39+65.09					38+00	383.21	383.23	+0.03%	383.24	383.24					
387.31	387.39	-4.86%	388.41	388.48	39+75					38+25	383.60	383.61	+0.53%	383.72	383.73					
387.34	387.42	-5.36%	388.55	388.63	40+00					38+50	383.97	383.99	+1.03%	384.20	384.22					
387.37	387.46	-5.86%	388.69	388.78	40+25					38+75	384.34	384.36	+1.53%	384.69	384.71					
387.39	387.47	-6.00%	388.73	388.82	40+31.76					39+00	384.71	384.74	+2.03%	385.17	385.20					
										39+25	385.08	385.12	+2.53%	385.65	385.69					
										39+50	385.45	385.50	+3.03%	386.13	386.18					
										39+65.09	385.67	385.72	+3.33%	386.42	386.47					
										39+75	385.82	385.87	+3.53%	386.62	386.67					
										39+76.51	385.84	385.89	+3.56%	386.65	386.70					
										40+00	386.19	-	+4.03%	387.10	387.16					
										40+25	386.56	-	+4.53%	387.58	387.65					
										40+50	386.93	-	+5.03%	388.06	388.14					
										40+75	387.30	-	+5.53%	388.55	388.63					
										40+98.42	387.65	-	+6.00%	389.00	389.09					

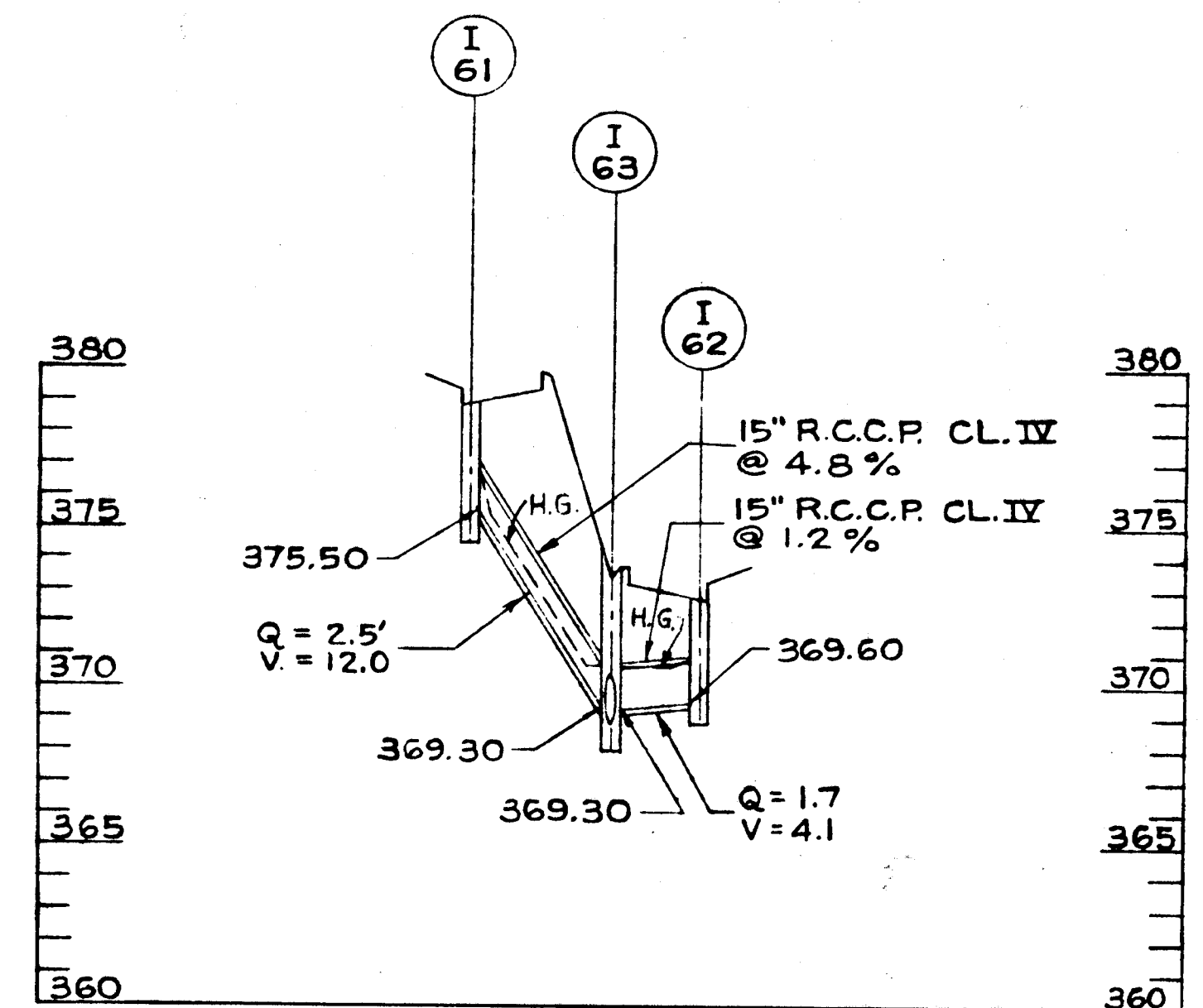

PROFILE
SCALE: HORZ. 1" = 50'
VERT. 1" = 5'

APPROVED
OFFICE OF PLANNING
AND ZONING OF
HOWARD COUNTY
DATE: 5-18-71
J. H. F.

TEMPORARY CONNECTION TO BERGER ROAD															
LT. EDGE ELEV.	DIST. LT. OF P.C.L.	SLOPE	STATION	P.C.L. ELEV.	SLOPE	DIST. RT. OF P.C.L.	RT. EDGE ELEV.	LT. EDGE ELEV.	DIST. LT. OF P.C.L.	SLOPE	STATION	P.C.L. ELEV.	SLOPE	DIST. RT. OF P.C.L.	RT. EDGE ELEV.
390.75	28.00	-1.36%	43+53.74	391.13	+6.00%	24.00	392.57	395.88	12.00	+2.00%	45+50	395.64	-2.00%	14.25	395.36
390.78	27.70	-1.36%	43+55	391.16	+5.92%	24.00	392.58	395.97	12.00	+1.75%	45+54.98	395.76	-1.75%	14.00	395.52
391.31	23.05	-1.36%	43+75	391.62	+4.72%	23.00	392.71	396.31	12.00	+0.75%	45+75	396.22	-0.75%	13.00	396.12
391.64	20.10	-1.36%	43+87.55	391.91	+3.74%	22.37	392.75	396.56	12.00	0.00%	45+90	396.56	0.00%	12.25	396.56
391.95	17.35	-1.36%	44+00	392.19	+2.99%	21.75	392.84	396.65	12.00	-0.25%	45+95	396.68	+0.25%	12.00	396.71
392.59	13.50	-1.36%	44+25	392.77	+1.49%	20.50	393.08	396.73	12.00	-0.50%	46+00	396.79	+0.50%	12.00	396.85
392.66	13.20	-1.36%	44+28.07	392.84	+1.36%	20.35	393.12	397.16	12.00	-1.75%	46+25	397.37	+1.75%	12.00	397.58
393.34	12.00	-0.04%	44+50	393.34	+0.04%	19.25	393.35	397.58	12.00	-3.00%	46+50	397.94	+3.00%	12.00	398.30
393.36	12.00	0.00%	44+50.74	393.36	0.00%	19.21	393.36	397.63	12.00	-3.17%	46+53.36	398.02	+3.17%	12.00	398.40
394.08	12.00	+1.34%	44+75	393.92	-1.34%	18.00	393.68	397.75	12.00	-3.50%	46+60	398.17	+3.50%	12.00	398.59
394.44	12.00	+2.00%	44+87.07	394.20	-2.00%	17.35	393.85	398.10	12.00	-3.50%	46+75	398.52	+3.50%	12.00	398.94
394.73	12.00	+2.00%	45+00	394.49	-2.00%	16.75	394.16	398.67	12.00	-3.50%	47+00	399.09			
395.31	12.00	+2.00%	45+25	395.07	-2.00%	15.50	394.76								

DEPARTMENT OF PUBLIC WORKS
B. W. McKeand 12/18/70
CHIEF, BUREAU OF HIGHWAYS DATE
OFFICE OF PLANNING AND ZONING
CHIEF ENGINEER, DIVISION OF LAND DEVELOPMENT DATE

GREEN ASSOCIATES, INC.
CONSULTING ENGINEERS
BALTIMORE, MARYLAND

Rev. Date	Rev. No.	Revision Description
COLUMBIA		
M A R Y L A N D		
6TH ELECTION DISTRICT HOWARD COUNTY		
HOWARD RESEARCH AND DEVELOPMENT CORP. <small>THE VILLAGE OF CROSS KEY - BALTIMORE, MARYLAND 21210</small>		
PROJECT AREA E.G.U. SUBDIVISION SECTION 1 AREA 1 & 2		
PROJECT TITLE SNOWDEN RIVER PARKWAY TRANSITION TABLE & DETAILS		
Des. By	J. H. F.	Scale AS SHOWN
App. By	J. B. D.	Date 5/13/69
Drawn By		Dwg. No. 4 OF 6
Checked By		CCF No.
Approved		

STD. BEAM TYPE GUARD RAIL-12GA.(903 L.F.)
 FOR DETAILS SEE HOWARD COUNTY
 STD. SPECIFICATIONS D-44, PAGE 99
 STA. 29+76.16 TO STA. 37+00 LT. ϕ CONSTR.
 STA. -3+21 TO STA. -5+00 LT.

ϕ CONTR.
 $\Delta = 29^{\circ}-34'-30''$
 $D = 6^{\circ}-00'-00''$
 $R = 954.43'$
 $T = 252.08'$
 $L = 492.92'$
 $E = 32.71'$
 $S.E. = 6.0\%$

STRUCTURE SCHEDULE			
NO.	TYPE	INV. OUT	TOP ELEV.
I-54	DBL.'S' COMB.	383.00	387.07
I-55	"K" W/GRATE	380.00	SET IN FIELD
I-56	'S' COMB.	380.50	384.62
I-57	DBL.'S' COMB.	383.70	387.74
I-58	DBL.'S' COMB.	375.00	379.21
I-59	DBL.'S' COMB.	382.00	385.58
I-60	"K" W/GRATE	374.50	SET IN FIELD
I-61	DBL.'S' COMB.	375.50	379.39
I-62	DBL.'S' COMB.	369.60	373.69
I-63	"K" W/GRATE	368.70	SET IN FIELD
I-25	DBL.'S' COMB.	364.49	367.99
M-1	STD. M.H.	363.49	SET IN FIELD

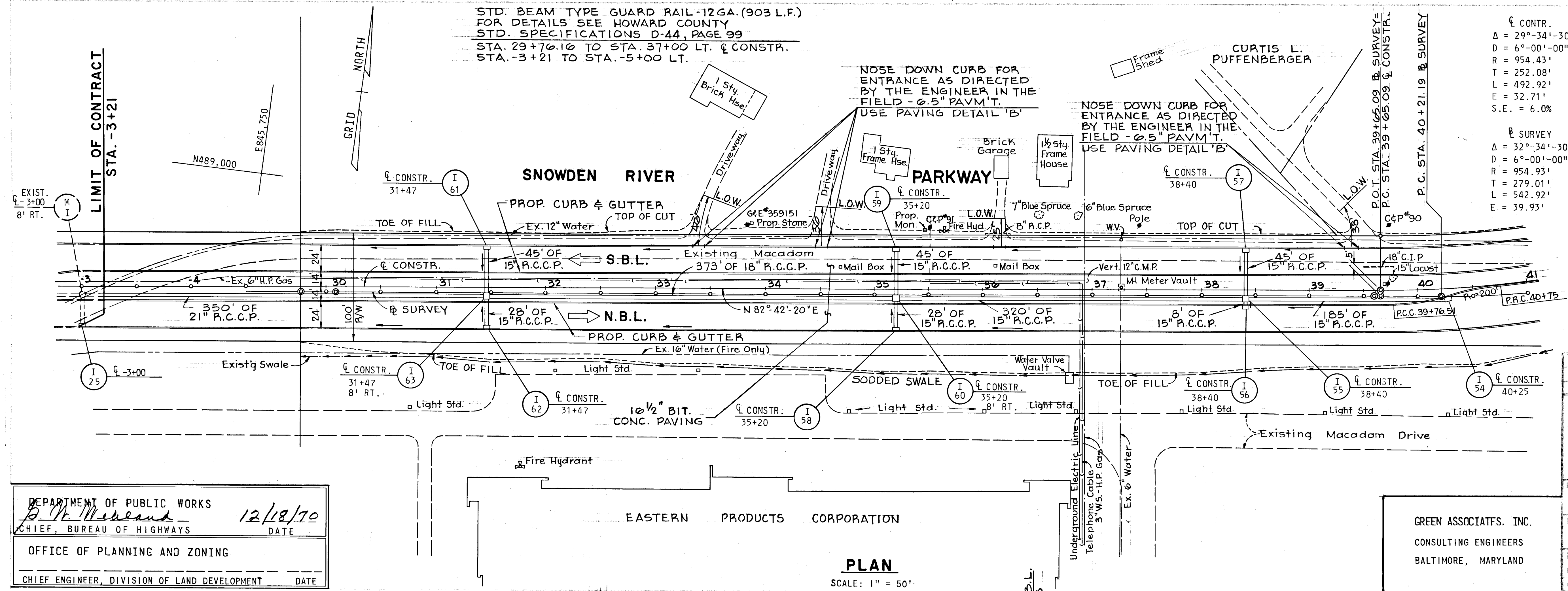

DEPARTMENT OF PUBLIC WORKS
 CHIEF, BUREAU OF HIGHWAYS
 OFFICE OF PLANNING AND ZONING
 CHIEF ENGINEER, DIVISION OF LAND DEVELOPMENT

12/18/70
 DATE

COLUMBIA
 MARYLAND
 6TH ELECTION DISTRICT HOWARD COUNTY
 HOWARD RESEARCH AND DEVELOPMENT CORP.
 THE VILLAGE OF CROSS CREEK, BALTIMORE, MARYLAND 21286

PROJECT AREA: E.G.U. SUBDIVISION SECTION 1 AREA 1 & 2
 PROJECT TITLE: SNOWDEN RIVER PARKWAY PLAN AND PROFILE

Des. By: J.H.F. & G.C. Scale: AS SHOWN
 Dir. By: J.B.D. Date: _____
 Chk. By: _____ Approved: _____

Sheet No. 5 OF 6
 C.C.F. No. _____

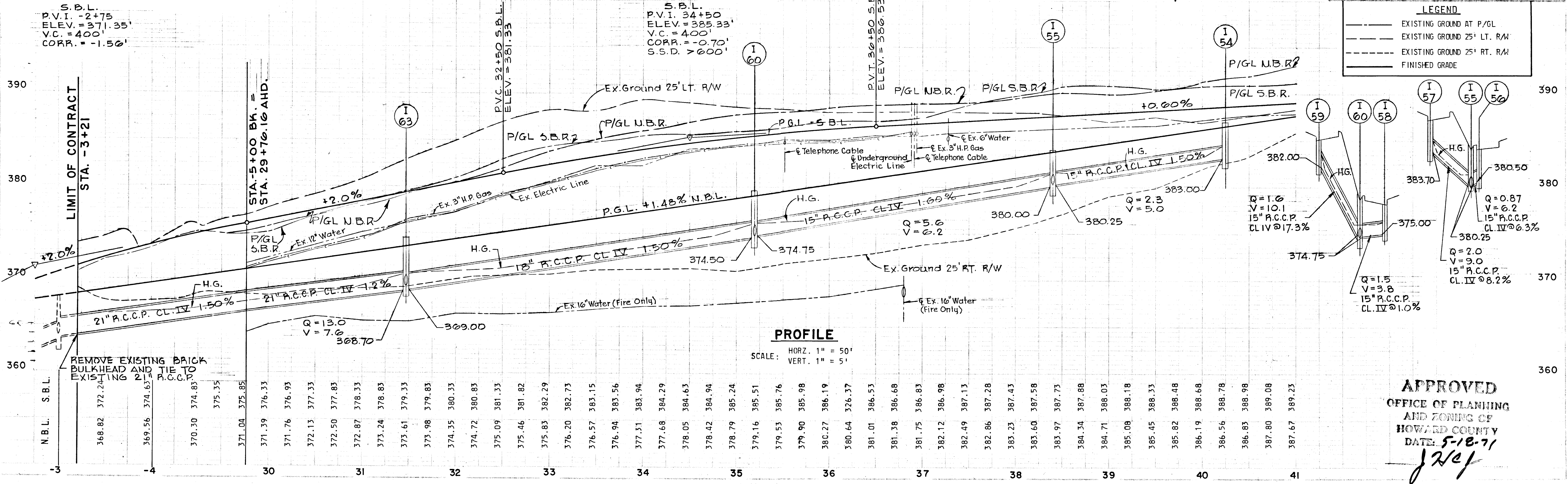

LEGEND

- EXISTING GROUND AT P/GL
- - - EXISTING GROUND 25' LT. R/W
- - - EXISTING GROUND 25' RT. R/W
- FINISHED GRADE

APPROVED
 OFFICE OF PLANNING
 AND ZONING OF
 HOWARD COUNTY
 DATE: 5-18-71
 J.H.F.
 F71-30C & F71-31C

STRUCTURE SCHEDULE			
NO.	TYPE	INV. OUT	TOP ELEV.
I-51	DBL.'S' COMB.	387.20	* 390.50
I-52	"K" INLET	386.80	* 390.00
I-53	DBL.'S' COMB.	385.30	389.40

*FOR DETAILS OF CAPPING SEE SHEET NO. 2

Rev. Date	Rev. No.	Revision Description

COLUMBIA
 MARYLAND
 6TH ELECTION DISTRICT HOWARD COUNTY
 HOWARD RESEARCH AND DEVELOPMENT CORP.
 THE VILLAGE OF CROSS KEYS, BALTIMORE, MARYLAND 21210

PROJECT AREA: E.G.U. SUBDIVISION SECTION 1 AREA 1 & 2
 PROJECT TITLE: SNOWDEN RIVER PARKWAY PLAN AND PROFILE

Des. By: J.H.F. & G.C. Scale: AS SHOWN Draw No: 6 OF 6
 Dir. By: W.T.G. & J.B.D. Date: 5/13/69 C.C.F. No.
 CA: By: Approved:

LEGEND

- EXISTING GROUND AT P/6L
- EXISTING GROUND 25' LT. R/W
- EXISTING GROUND 25' RT. R/W
- FINISHED GRADE

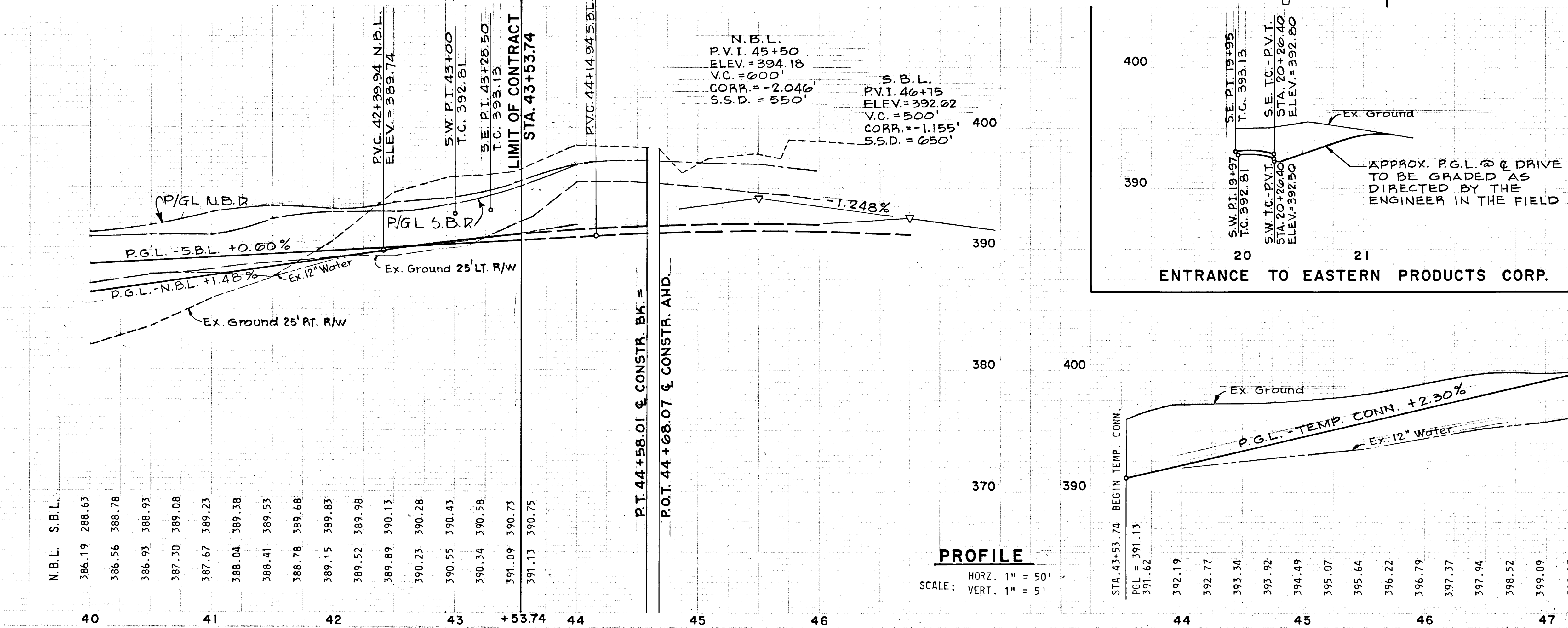
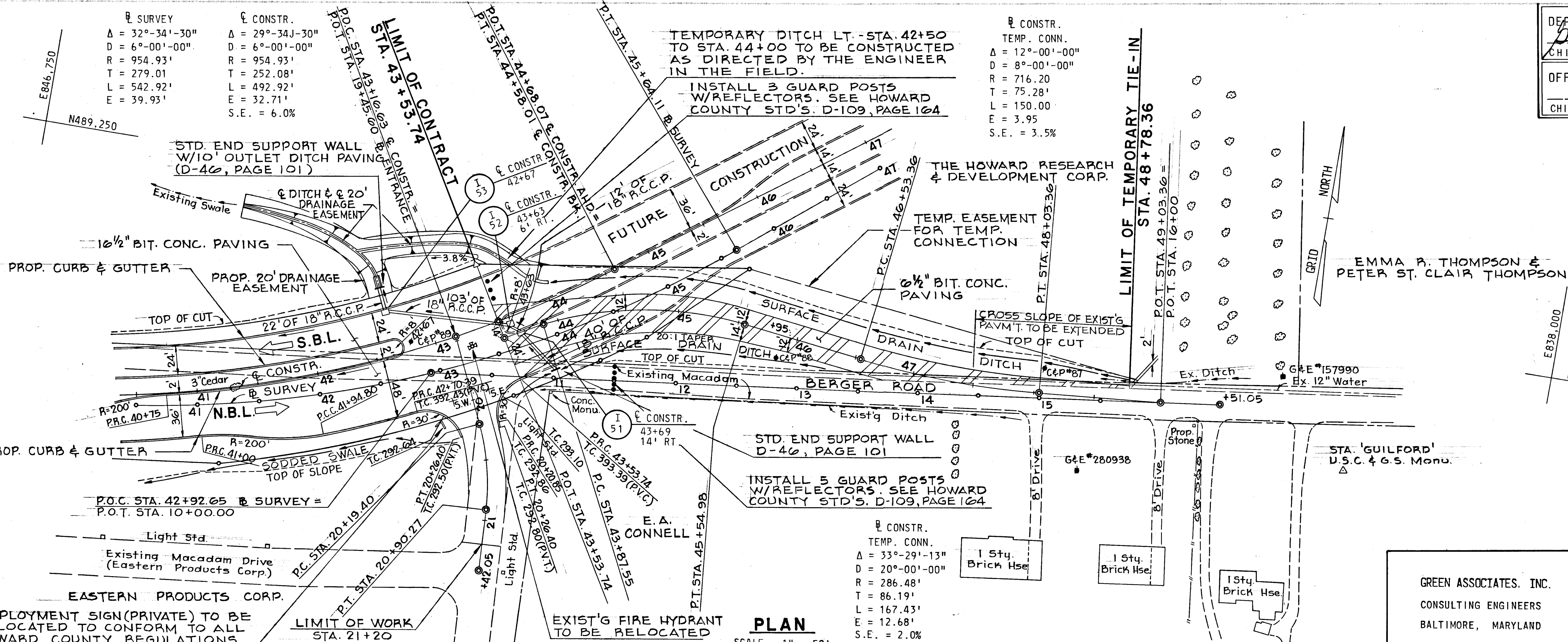

APPROVED
 OFFICE OF PLANNING AND ZONING OF HOWARD COUNTY
 DATE: 5/13/69
J. Weiland