

**GENERAL NOTES**

- Seeding for all disturbed areas (Per Acre)  
 Ryegrass - 2 Bu. Winter Oats - 3 Bu.  
 Lime - 2 tons agricultural ground limestone/ac.  
 Fertilizer - 500-800 lbs. 10-10-10 or 10-20-10/ac.
- All swales, interceptor berms, drainage ditches, etc. to be sodded and pegged.

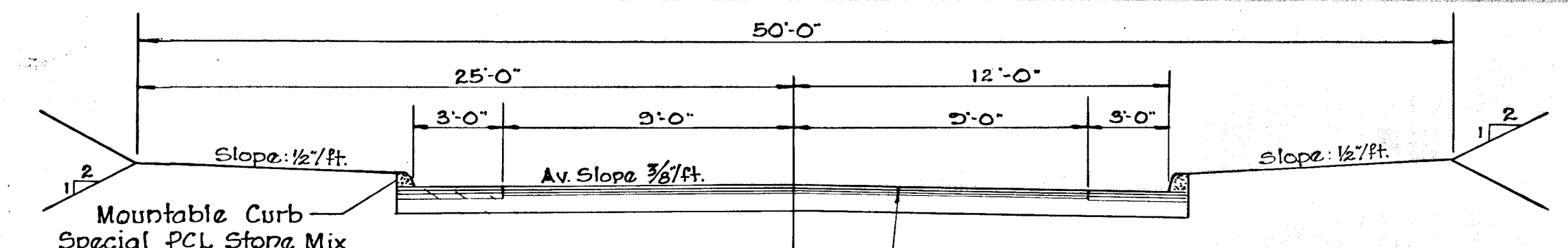
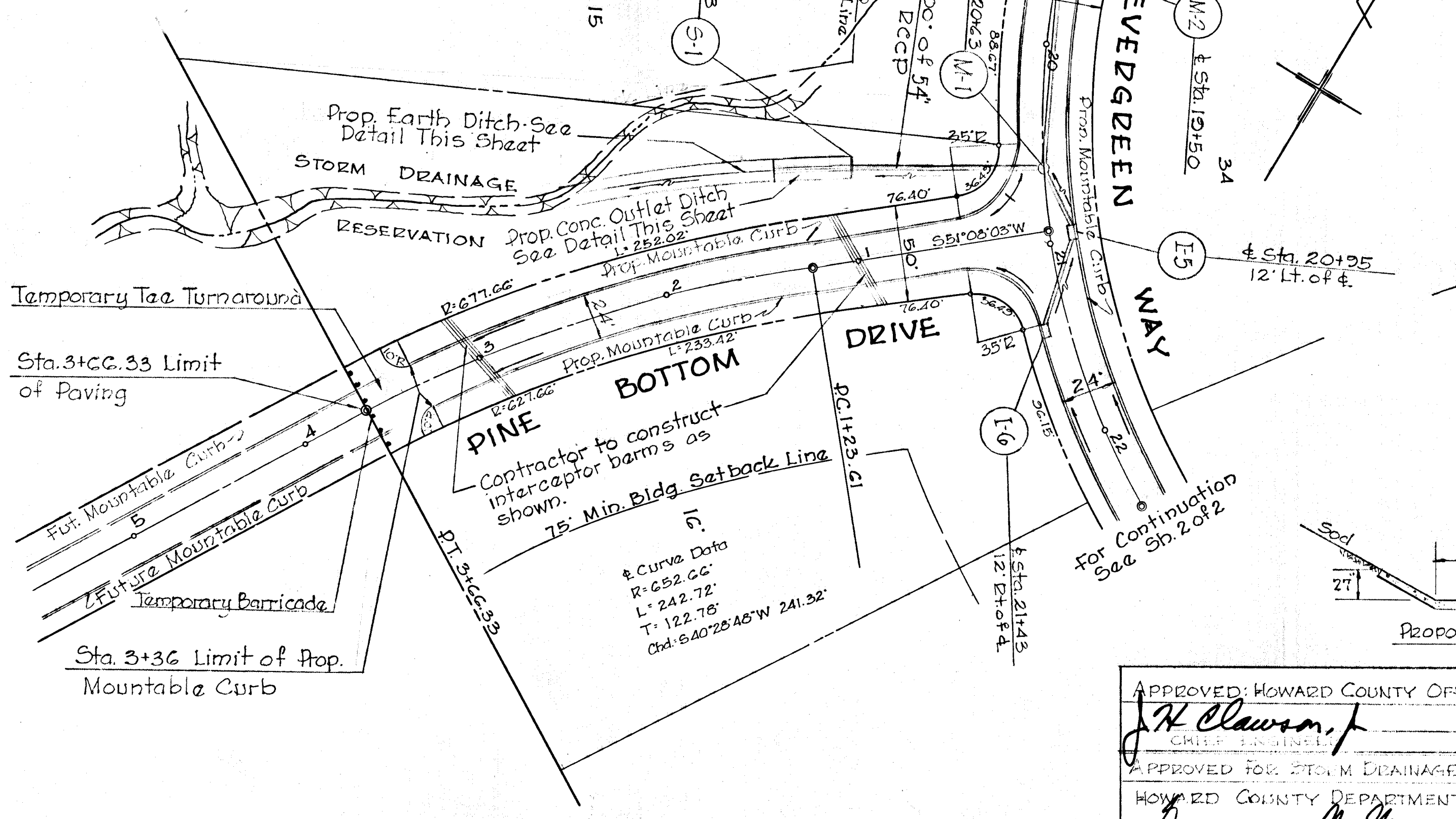

Typical paving section shall conform to alternates D-3-4-5, pages 58, 59 & 60 and typical cross section D-16, page 71 of Howard County Specs.

**TYPICAL SECTION**  
SCALE: 1"=5'

NO	INLET TYPE	SCHEDULE	Inv. In.	Inv. Out	Top E.L.
I-1	5' Comb.		408.08	413.18	
I-2	Dbl. 5' Comb.		408.08	413.18	
I-3	"		410.38	414.74	
I-4	"		410.04	409.54	414.74
I-5	"		410.05	409.80	416.34
I-6	"		-	414.48	418.80

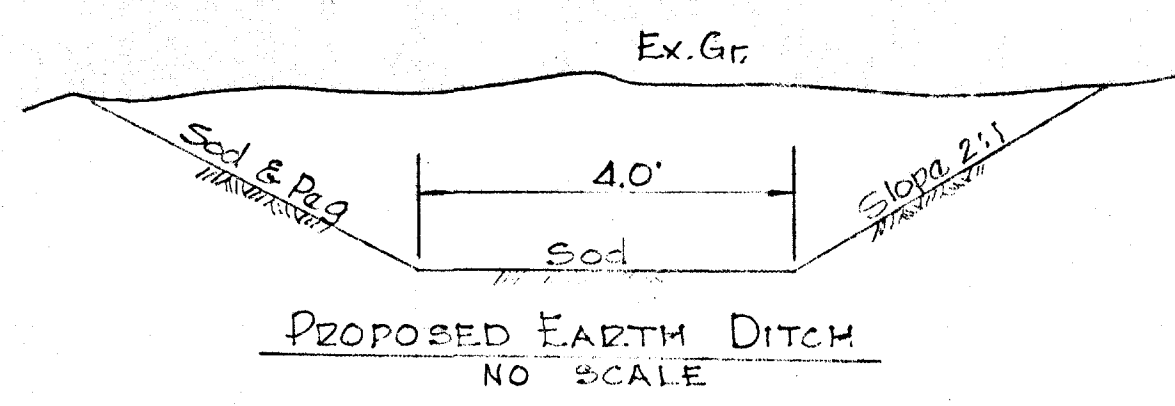
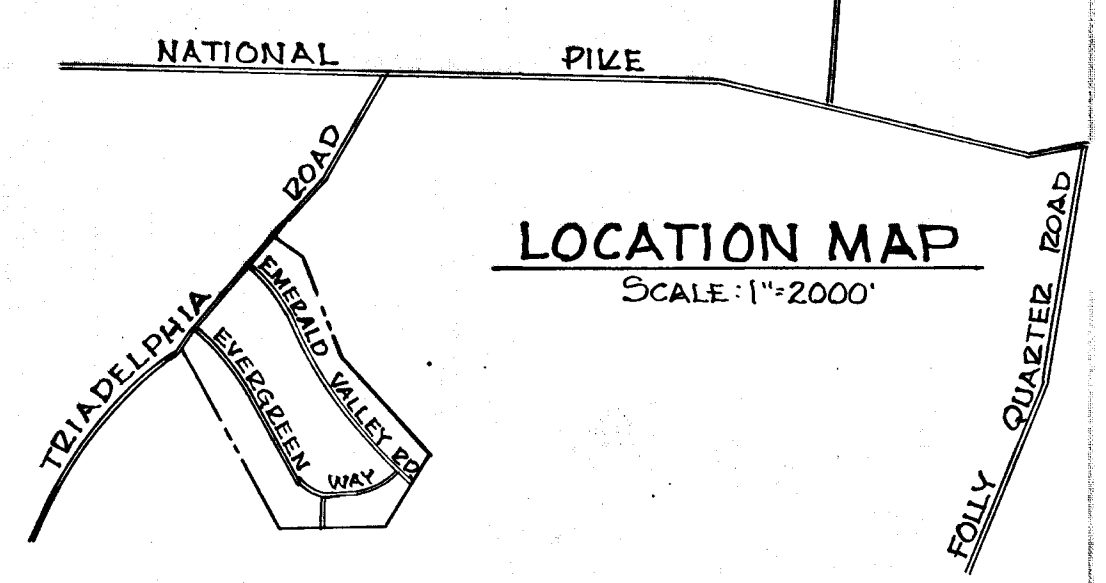

PROPOSED EARTH DITCH  
NO SCALE

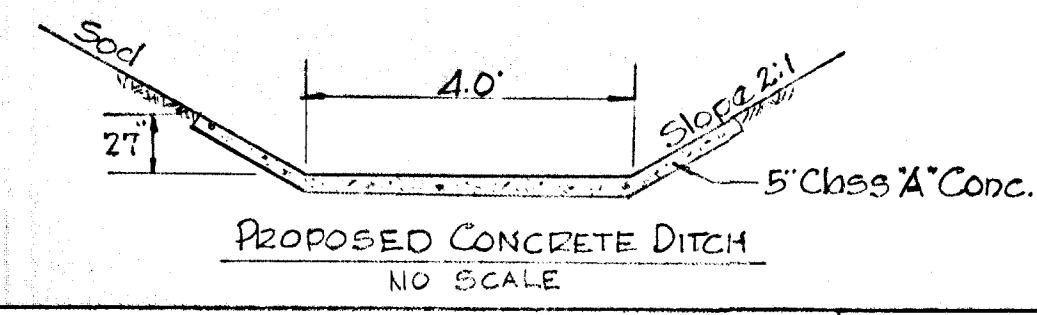

PROPOSED CONCRETE DITCH  
NO SCALE

APPROVED: HOWARD COUNTY OFFICE OF PLANNING & ZONING  
*J.H. Clawson* 10-2-69  
 CHIEF ENGINEER  
 APPROVED FOR STORM DRAINAGE SYSTEM & PUBLIC ROADS  
 HOWARD COUNTY DEPARTMENT OF PUBLIC WORKS  
*Drewelle M. Weiland* 10-8-69  
 CHIEF BUREAU OF HIGHWAYS

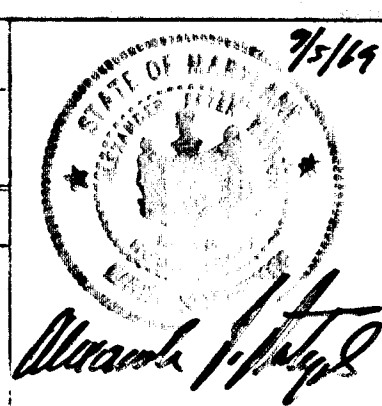

OWNER AND DEVELOPER  
**HUDSON CONSTRUCTION COMPANY**  
 8957 CHAPEL AVENUE BALTO., MD. 21214

APR ASSOCIATES  
 LAND SURVEYORS  
 3320 ROSALIE AVENUE BALTO., MD. 21234

ROAD PLAN, STORM DRAINS & PROFILES  
**PINE BOTTOM DRIVE**  
 HOWARD COUNTY, MARYLAND THIRD ELEC. DIST.  
 SCALES: PLAN 1"=50' PROFILES 1"=50'  
**EVERGREEN VALLEY ESTATES**

