

PLAN  
SCALE: 1" = 50'

APPROVED: HOWARD COUNTY PLANNING COMM.  
*J. H. Clawson* 10/7/68  
 Chief Engineer Date  
 APPROVED: HOWARD COUNTY ROADS DEPT.  
*Samuel N. Nichol* 10-7-68  
 Roads Superintendent Date  
 APPROVED: HOWARD COUNTY METRO. COMM.  
*W. O. P. West* 10-7-68  
 Chief Engineer Date

OWNER & DEVELOPER  
 The Chamberles Company  
 2620 Frederick Road  
 Catonsville, Maryland

29 JULY 1968  
 Date

PURDUM & JESCHKE  
 ENGINEERS AND SURVEYORS  
 24 PARK AVE  
 ELLICOTT CITY, MARYLAND

PLAN AND PROFILE: MAPLEWOOD DRIVE

**"ALLENFORD"**

SECTION THREE  
 SECOND ELECTION DISTRICT HOWARD COUNTY, MD.  
 29 JULY 1968 SHEET 1 OF 3 SCALE: AS SHOWN  
 Rev. 28, August 1968

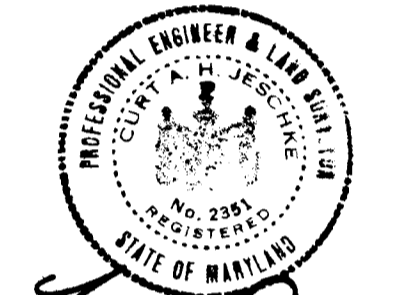

Reg No 2351

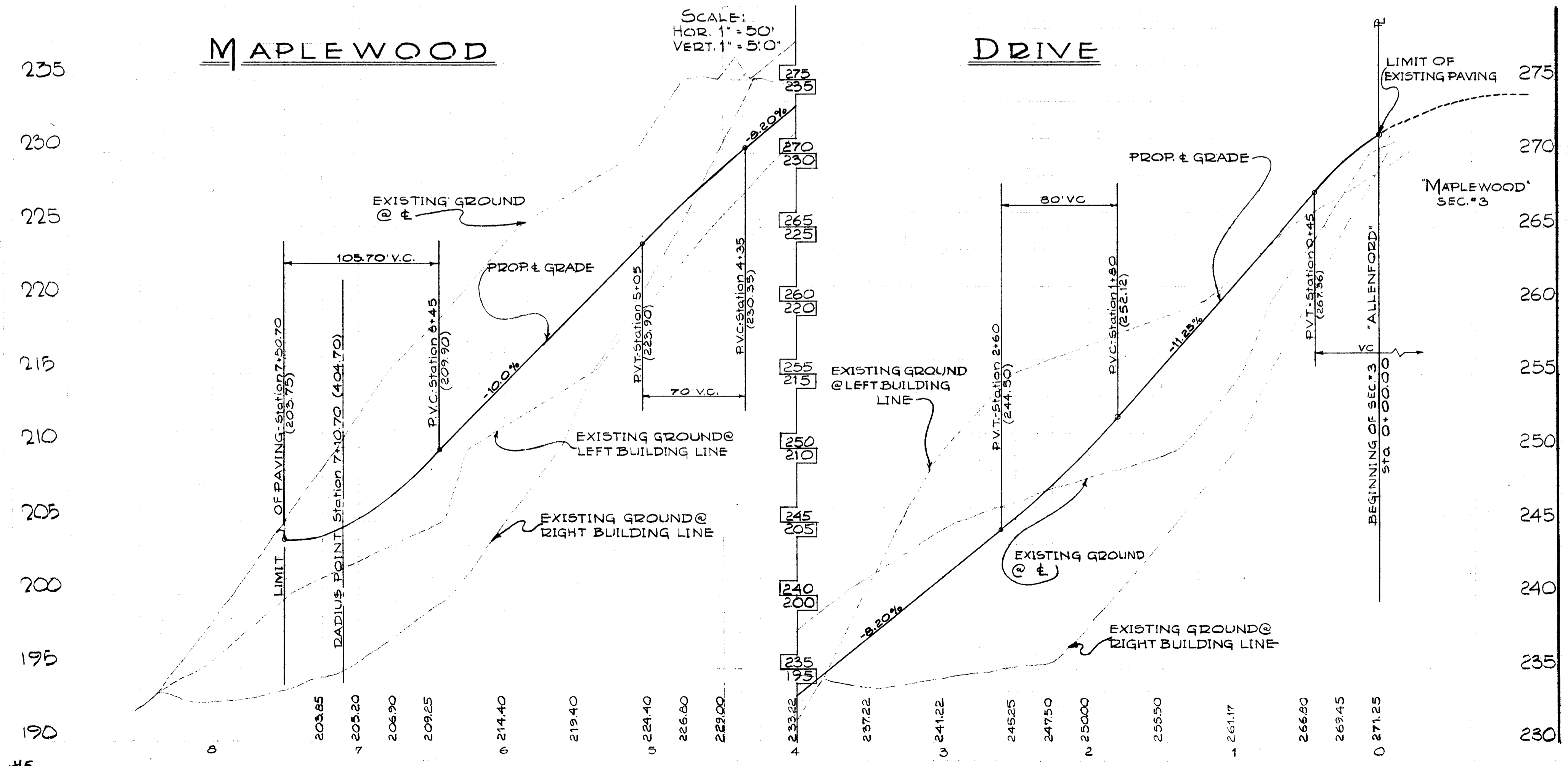



GENERAL NOTES

- 1) For details of Standard Manhole, see drawing D-103, page 153 of the Howard County Road Code & Specifications.
- 2) For details of End Support Wall, see drawing D-46, page 101, of the above mention Spec.
- 3) For details of Junction Box, see drawing D-109, page 163 of the above mention Spec.
- 4) For details of type 'C' Endwall, see drawing D-52, page 107, of the above mention Spec.
- 5) For details of type 'G' Endwall, see drawing D-61, page 116, of the above mention Spec.
- 6) For details of Double 'E' Combination & type 'A' Inlet, see attached sheet.

APPROVED: HOWARD COUNTY PLANNING COMM. **PURDUM**  
 Chief Engineer *John Clausen* Date **10/2/68**  
 APPROVED: HOWARD COUNTY ROADS DEPT. **JESCHKE**  
 Roads Superintendent *Lawrence H. Heiland* Date **10-7-68** ENGINEERS &  
 LAND SURVEYORS  
 APPROVED: HOWARD COUNTY METROPOLITAN COMM. **ELICOTT CITY,**  
 Chief Engineer *W. O. Falout* Date **10-7-68** **MARYLAND**

OWNED & DEVELOPER **July 31, 1968**  
 THE CHAMBERLEA COMPANY DATE  
 2620 FREDERICK ROAD  
 CATONSVILLE, MARYLAND

STORM DRAIN AND DETAIL SHEET  
 SECTION N<sup>o</sup> 3  
**"ALLENFORD"**

SECOND ELECTION DISTRICT - HOWARD COUNTY, MARYLAND  
 JULY 31, 1968 SCALE: AS SHOWN  
 (Pipe Rev. 9-27-68) SHEET 3 OF 3

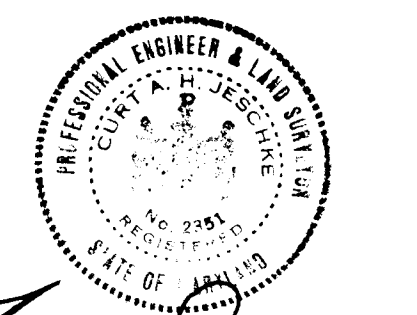

*Lawrence H. Jeschke*  
 REG. NO. 2351

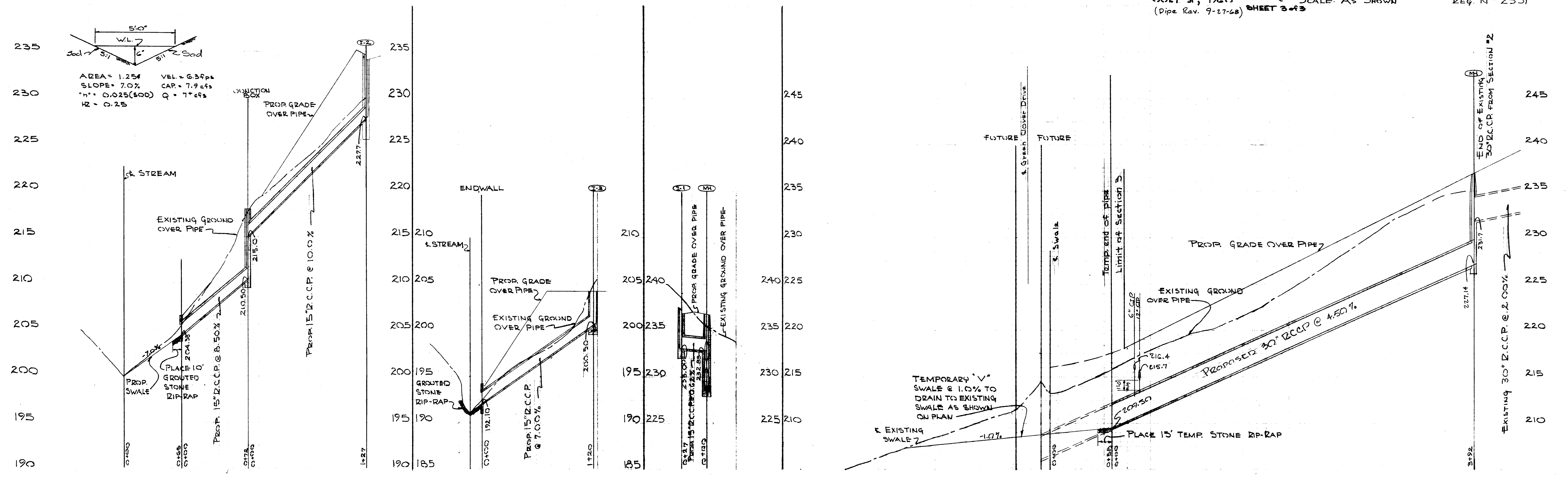

RP177 #5