

DESIGNED H.G. CHARLES D. GRACE
 DRAWN H.G. Charles Grace
 CHECKED C.S. 3-29-66 1216
 PLANING COMMISSION APPROVED H. Clawson
 F-6-66
 ROADS DEPARTMENT APPROVED Lawrence H. Redland
 DATE May 6, 1966
 METROPOLITAN COMMISSION APPROVED W.O. Silbert
 DATE 5-19-66
 SECTION 1 TOWN & COUNTRY WEST
 TOWN AND COUNTRY BOULEVARD
 2ND ELECTION DISTRICT
 SECTION 1 TOWN & COUNTRY WEST
 SCALE: 1" = 50' HORIZ. 1" = 50' VERT.

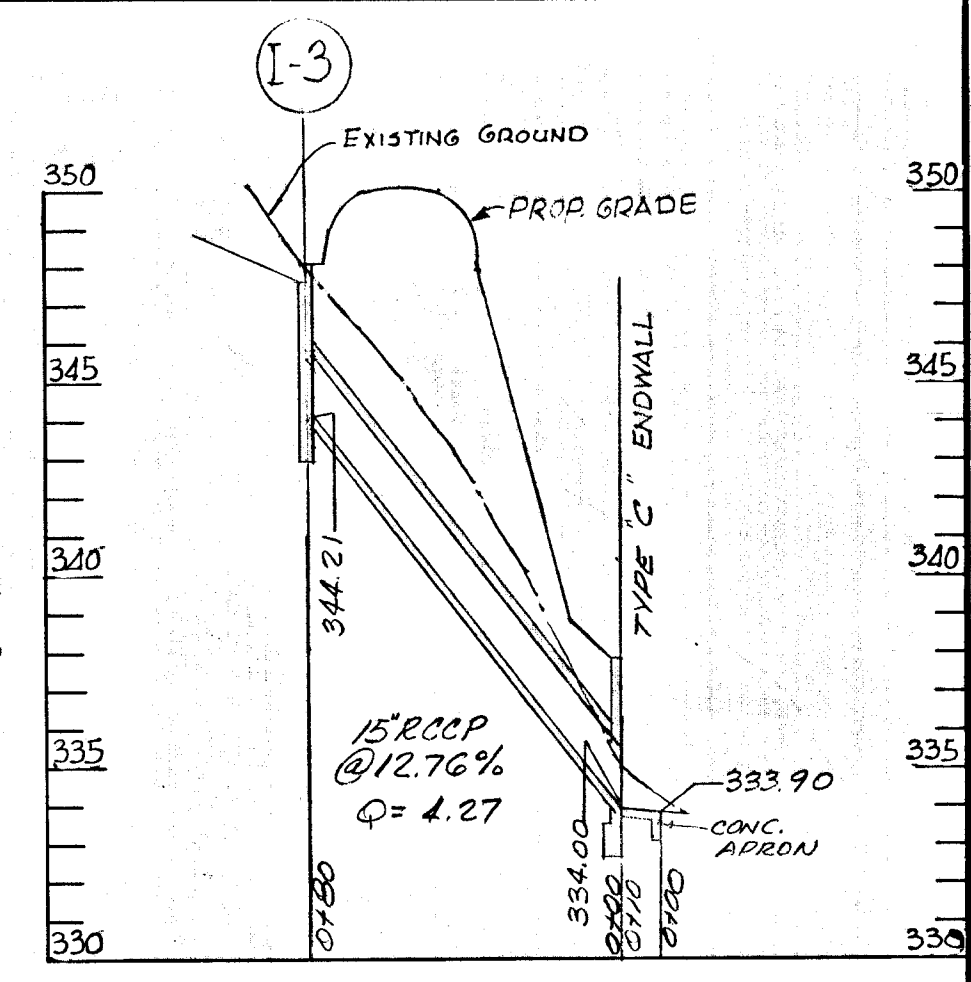
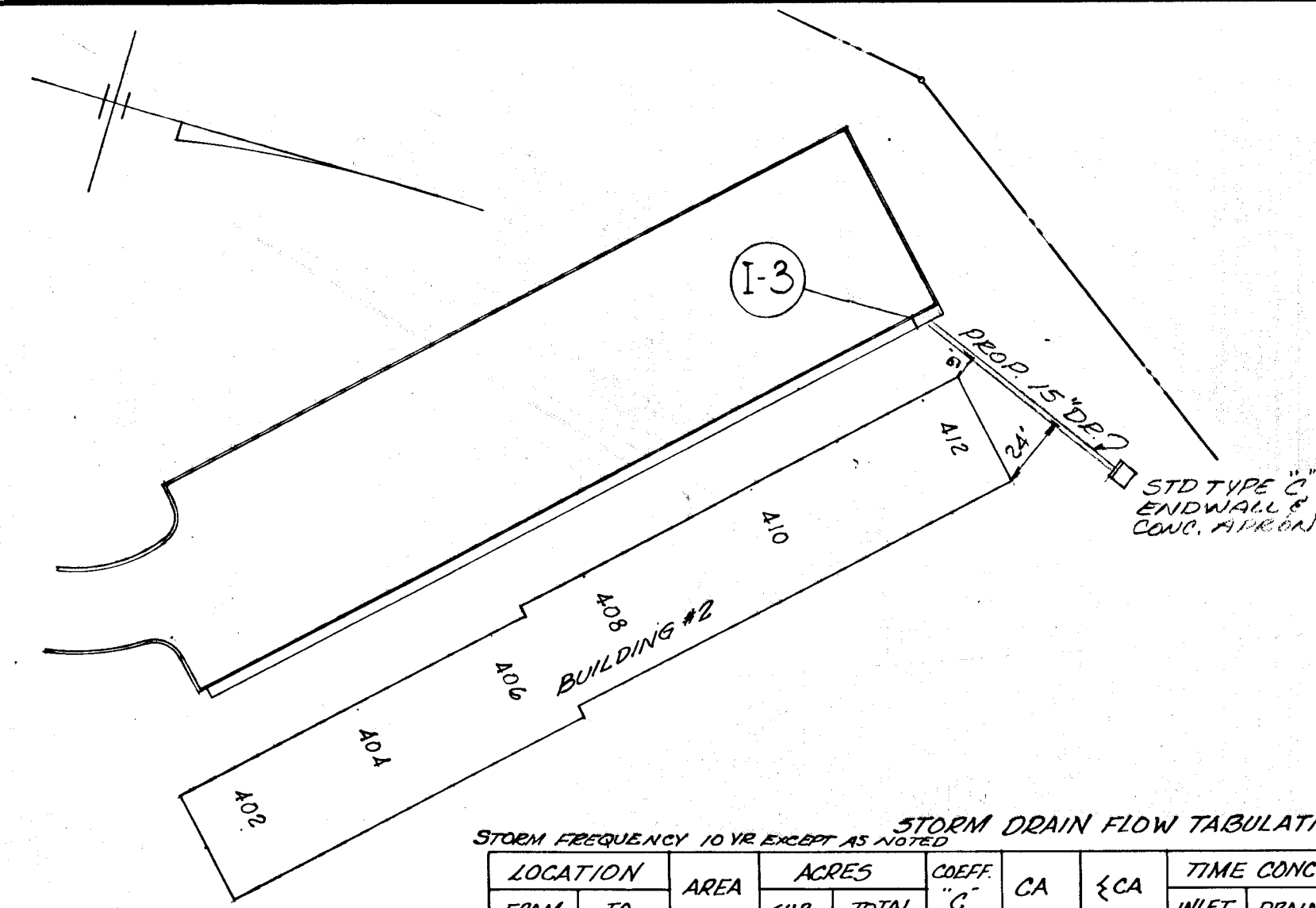
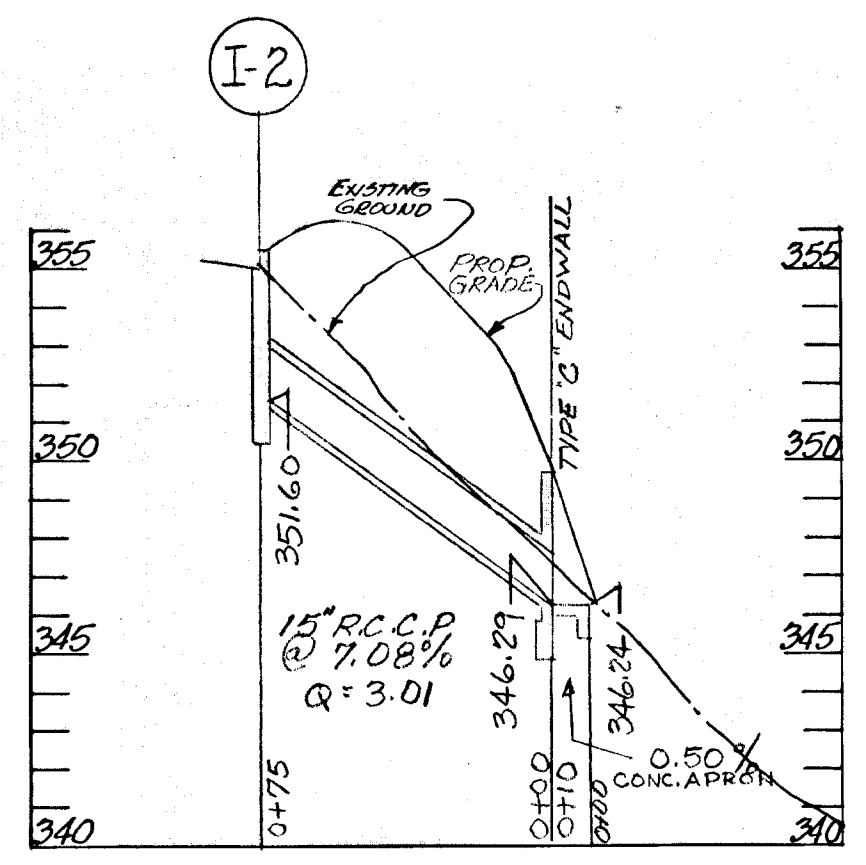
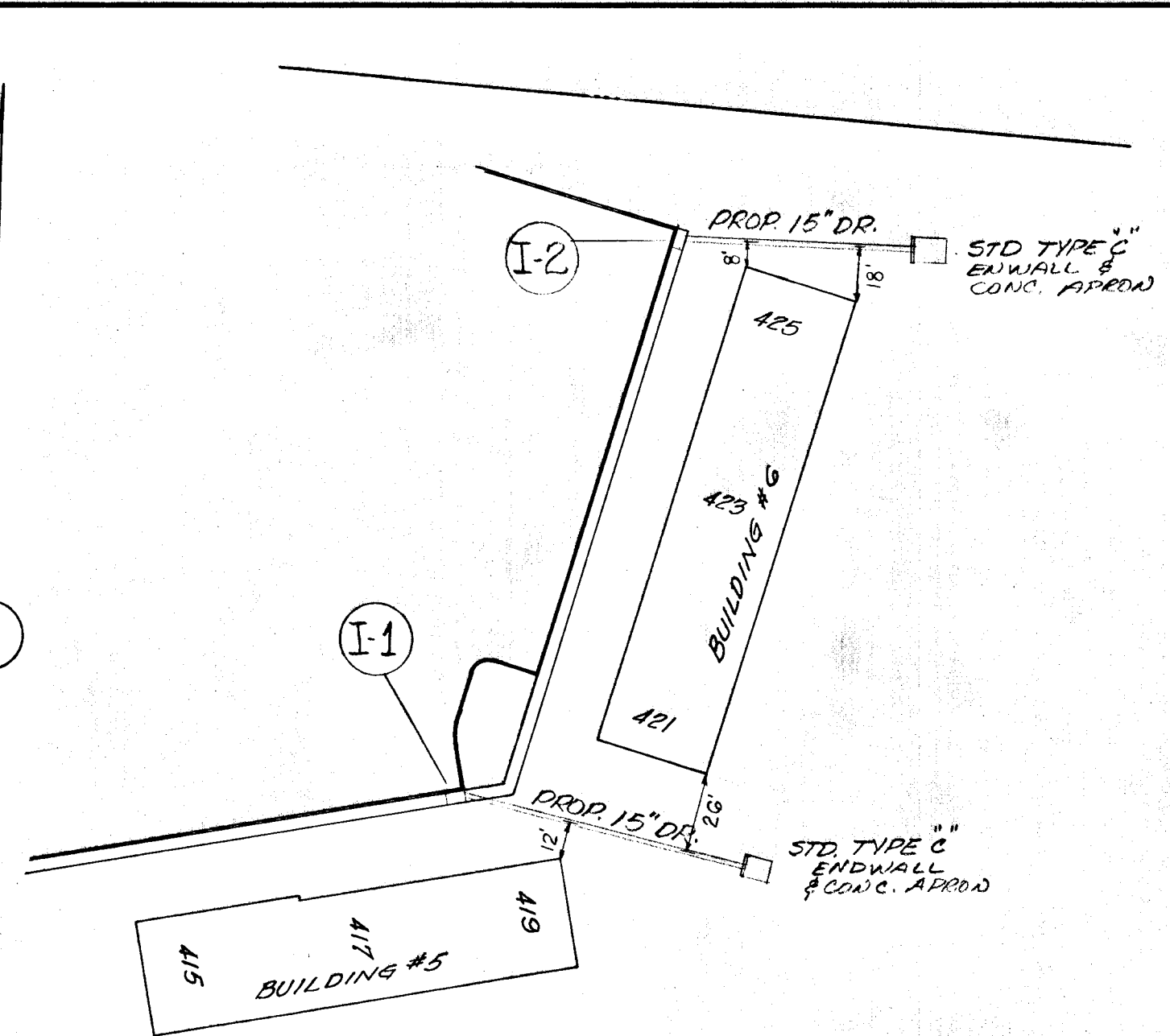

PLAN - SCALE 1"=50'

PROFILES: HOR. 1"=50'
VERT. 1"=5'

NOTE: SEE GRADING PLAN TITLED "TOWN & COUNTRY - WEST" SHOWING AN OVERALL LOCATION OF ALL INLETS.

STORM DRAIN FLOW TABULATION FORM

LOCATION	AREA	ACRES		COEFF. "C"	CA	Q CA	TIME CONC. MIN.			INTEN. "I"	Q.C.I.A. C.F.S.	PIPE 15" Ø 0.013			REMARKS
		SUB	TOTAL				INLET	DRAIN	TOTAL			SIZE	SLOPE	VEL.	
I-1	A	1.44	0.40	0.69	5.0	7.0	4.83	15"	0.24	3.8	7.5'				
I-2	B	0.64	0.67	0.43	5.0	7.0	3.01	15"	0.21	2.4	7.5'				
I-3	C	0.87	0.70	0.61	5.0	7.0	4.27	15"	0.43	3.4					

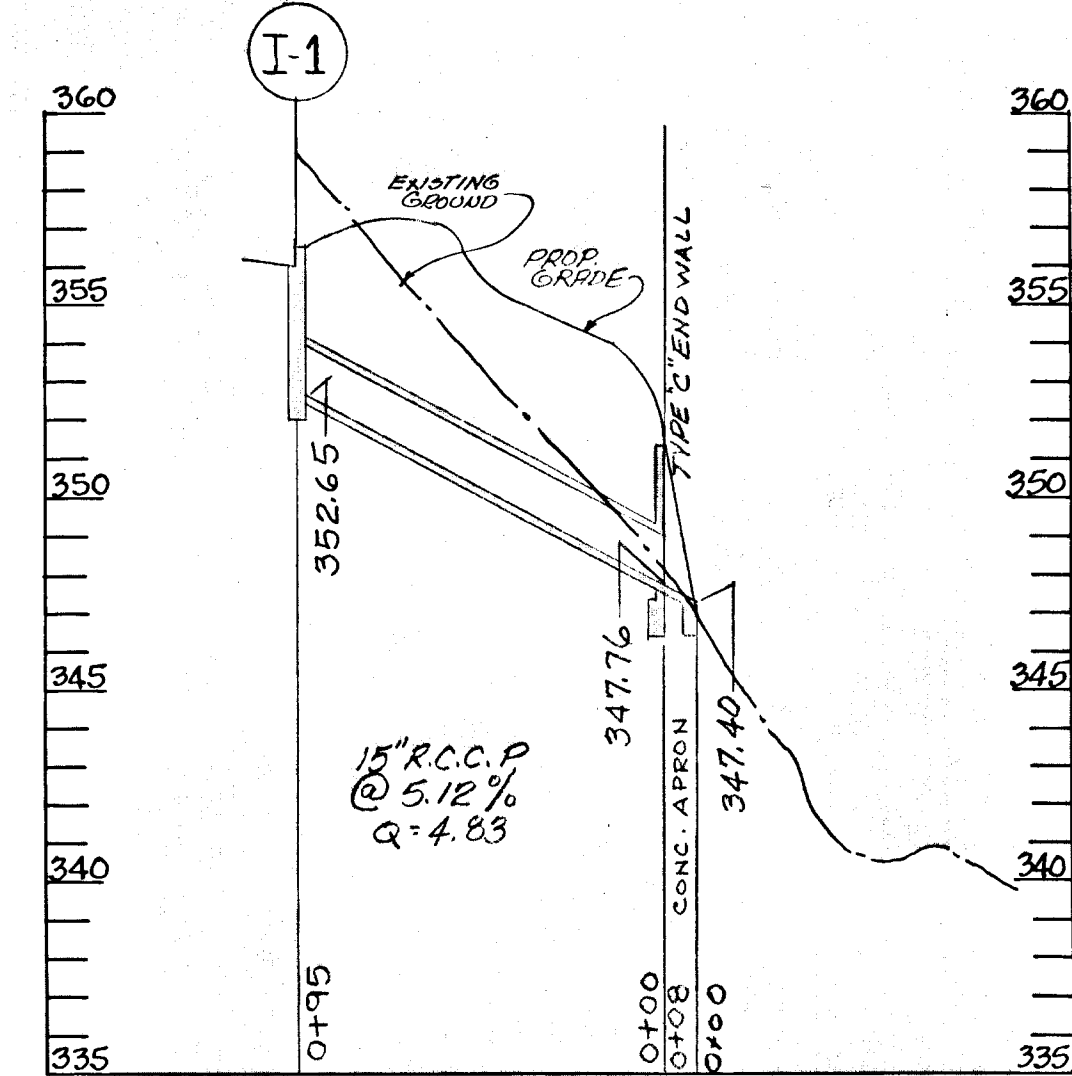

SECTION - 1
TOWN & COUNTRY - WEST

OWNER
TOWN & COUNTRY - WEST INC.
1300 FIRST NATIONAL BANK BLDG.
BALTO. & MD.

INLET SCHEDULE

N ^o	TYPE	ACRES	I	Q	INWOUT	RAPELEY
1	E-COMB	1.44	7.00	0.40	4.83	352.65 356.50
2	E-COMB	0.64	7.00	0.67	3.01	341.60 355.50
3	E-COMB	0.87	7.00	0.70	4.27	344.21 348.20

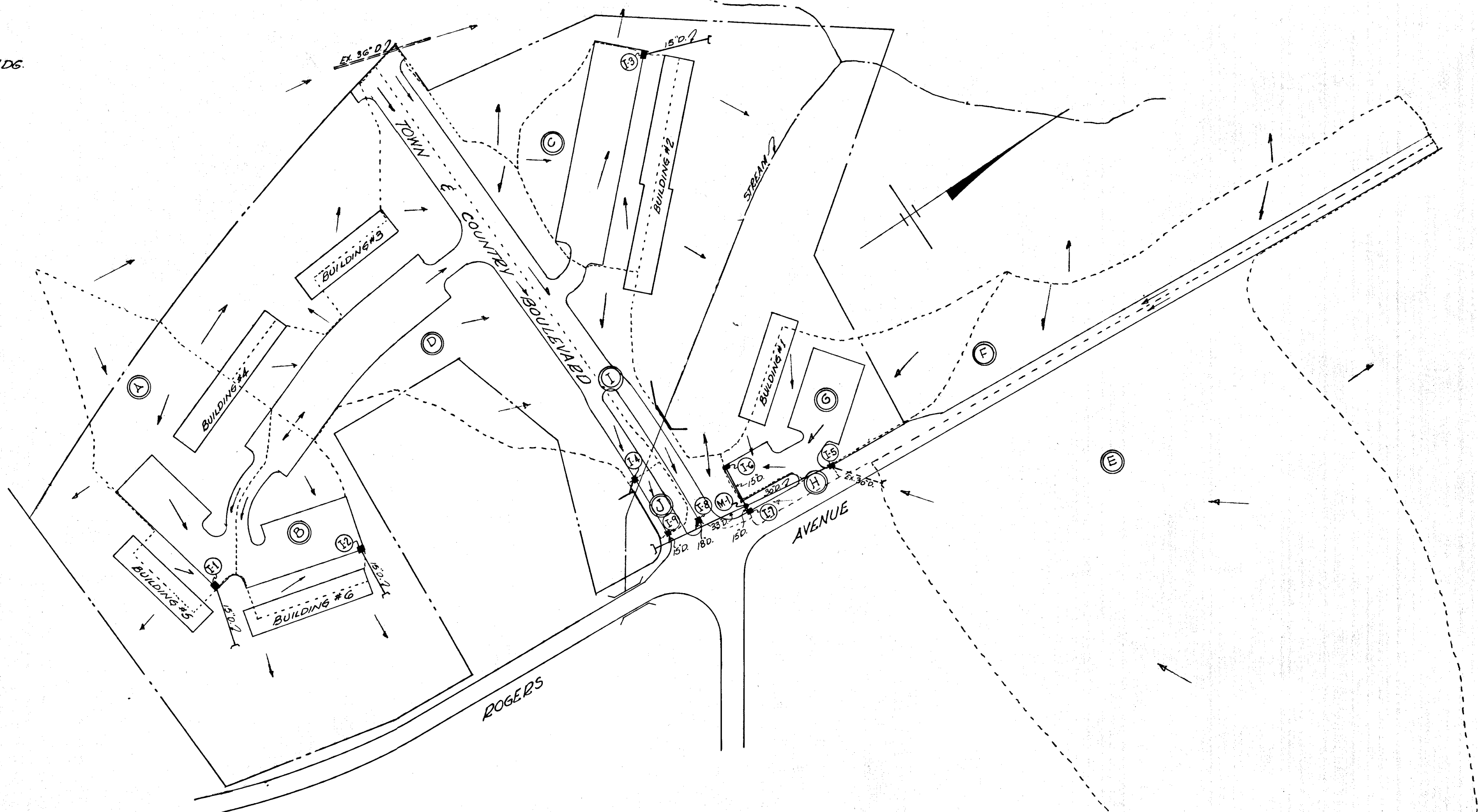

DRAINAGE AREA MAP
SCALE: 1"=100'

APPROVED
PLANNING COMMISSION
OF HOWARD COUNTY

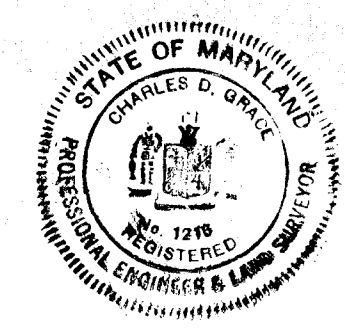

ROAD PERMIT AND GRADES

PERMIT REQUESTED: _____
 PERMIT NUMBER: _____
 GRADE ESTABLISHED: _____
 PROFILE NUMBER: _____

DATE: _____ RIGHT OF WAY REF: _____

ENGINEER: Charles D. Grace
 REG. NO. 1216
 DATE: 3-8-66

DESIGNED: R.G.
 DRAWN: H.G.
 CHECKED: C.S.
 DATE: 5-6-66

PLANNING COMMISSION

APPROVED: J. H. Clawson Jr.
 DATE: 5-6-66

ROADS DEPARTMENT

APPROVED: Frankelle H. Kirkland
 DATE: May 6, 1966

METROPOLITAN COMM.

APPROVED: W. O. F. about
 DATE: 5-17-66

HOWARD COUNTY DEPARTMENT OF PUBLIC WORKS

BUREAU OF ENGINEERING

SECTION - 1
TOWN & COUNTRY - WEST

STORM DRAINS
PARKING LOTS

2ND ELECTION DIST.

SCALE AS SHOWN

KEY SHEET _____ SHEET NO. 2 OF 2

POSITION SHEET _____ J.O. _____ FILE: _____

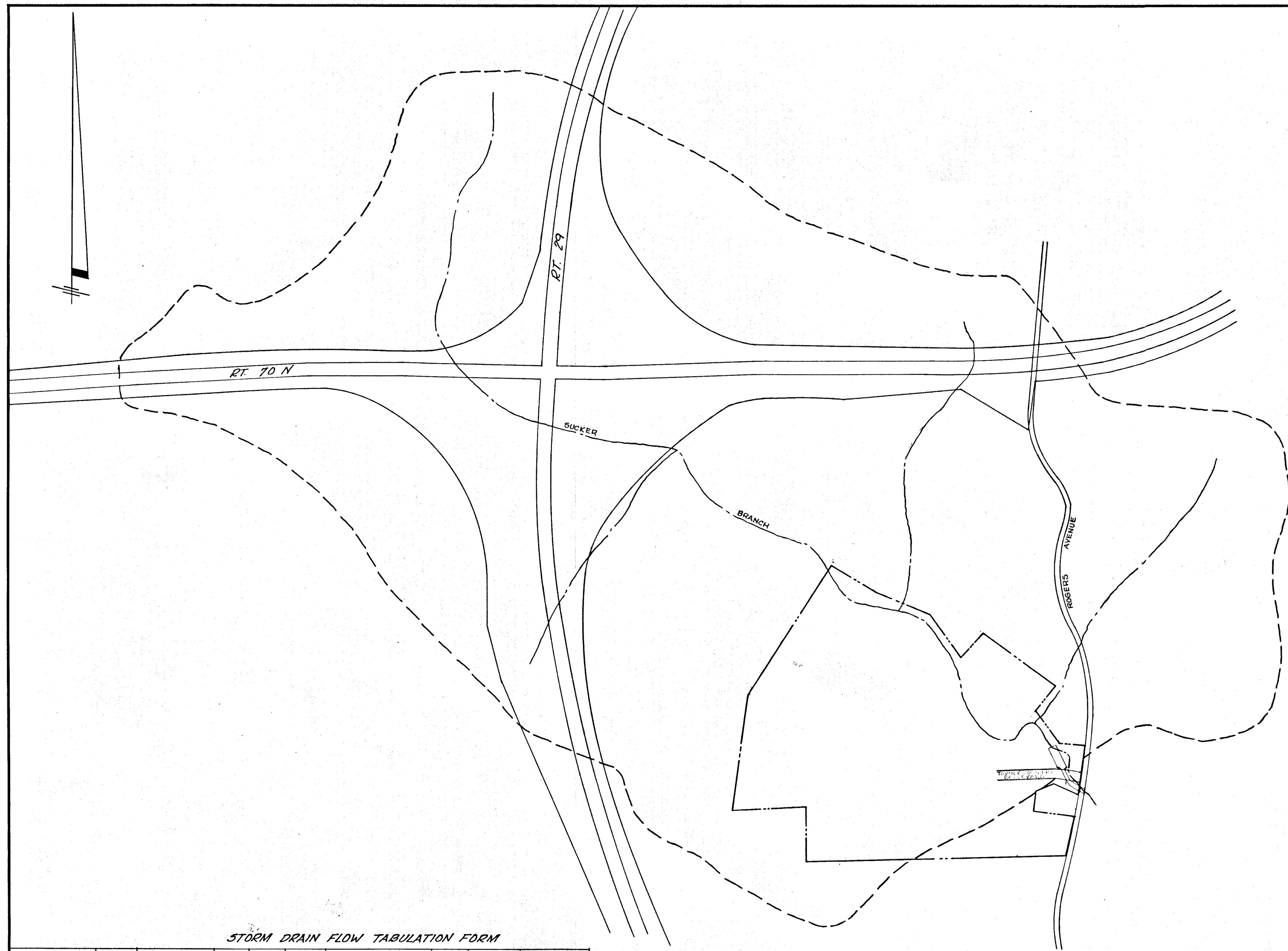

STORM DRAIN FLOW TABULATION FORM

LOCATION FROM TO	AREA	ACRES SUB TOTAL	COEFF. C	CA	{CA	TIME CONC. MIN INLET DRAIN TOTAL	INTEN. I	Q. C/A C.F.S.	REMARKS
	909		0.39			30.2	5.15	1820	50 YEAR
	909		0.39			30.2	5.75	1929	10 YEAR

APPROVED
PLANNING COMMISSION
OF HOWARD COUNTY

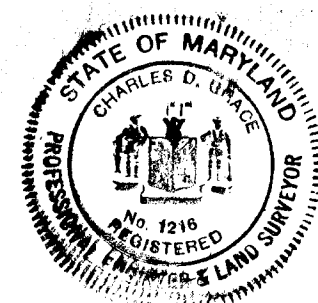

ROAD PERMIT AND GRADES		DATE
PERMIT REQUESTED		
PERMIT NUMBER		
GRADE ESTABLISHED		
PROFILE NUMBER		
WATER ENGINEER	DIRECTOR OF PUBLIC WORKS	
ENGINEER	PLANNING COMMISSION	ROADS DEPARTMENT
REG. NO. 1216	APPROVED	APPROVED
DESIGNED	DATE 5-6-66	DATE May 6, 1966
DRAWN		
CHECKED		

METROPOLITAN COMM.	HOWARD COUNTY	DEPARTMENT OF PUBLIC WORKS	BUREAU OF ENGINEERING	SCALE
APPROVED				1" = 600'
STORM DRAINS				KEY SHEET
DRAINAGE AREA MAP				SHEET NO. 1
SECTION 1				J.O.
TOWN & COUNTRY - WEST				POSITION SHEET
2ND ELECTION DIST.				OF 1
				FILE:

DATE	REVISION	BY
DRAWING COMPLETED		