

DEVELOPER'S/BUILDER'S CERTIFICATE
 I/We certify that the landscaping shown on this plan will be done according to the plan, Section 16.124 of the Howard County Subdivision and Land Development Regulations and the Landscape Manual. I/We further certify that upon completion a letter of Landscape Installation, accompanied by an executed one year guarantee of plant materials, will be submitted to the Department of Planning and Zoning.

Name: R. Kumar Date: 5/13/08
 NameLEB Corporation
 c/o PCA Group
 6851 Oak Hall Lane
 Suite 300
 Columbia, MD 21045
 PREPARED BY: KENNETH R. KINSEY
 STATE OF MARYLAND
 REGISTERED LANDSCAPE ARCHITECT
 LICENSE REGISTRATION NO. 405
 NAME: [Signature] DATE: 4/28/08

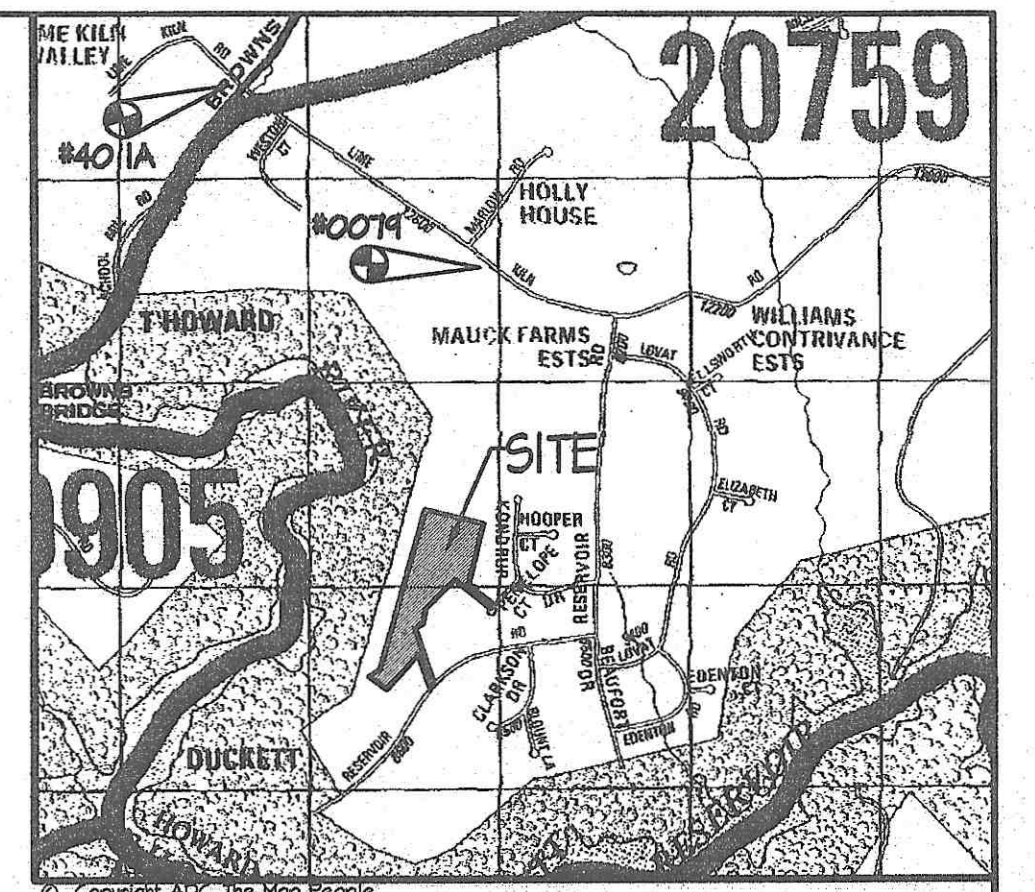

VICINITY MAP 1"=2000'

BENCHMARKS:

HCO #401A	N 541,725.71	E 1325,316.04	ELEV. 394.470
DISC SET ON TOP OF A 3" DEEP COLUMN			
HCO #007H	N 540,070.91	E 1321,102.16	ELEV. 426.221
DISC SET ON TOP OF A 3" DEEP COLUMN			

SCHEDULE A PERIMETER LANDSCAPE EDGE

CATEGORY	ADJACENT TO PERIMETER PROPERTIES
LANDSCAPE TYPE	A
LINEAR FEET OF ROADWAY FRONTAGE / PERIMETER	576
CREDIT FOR EXISTING VEGETATION (YES, NO, LINEAR FEET) (DESCRIBE BELOW IF NEEDED)	YES*
CREDIT FOR WALL, FENCE, OR BERM (YES, NO, LINEAR FEET) (DESCRIBE BELOW IF NEEDED)	NO
NUMBER OF PLANTS REQUIRED	
SHADE TREES	4
EVERGREEN TREES	0
SHRUBS	0
NUMBER OF PLANTS PROVIDED	
SHADE TREES	3
EVERGREEN TREES	12
OTHER TREES (21 SUBSTITUTION)	0
SHRUBS (10:1 SUBSTITUTION)	0
(DESCRIBE PLANT SUBSTITUTION CREDITS BELOW IF NEEDED)	

* Existing forest along the edge of the site covers 1051 LF.

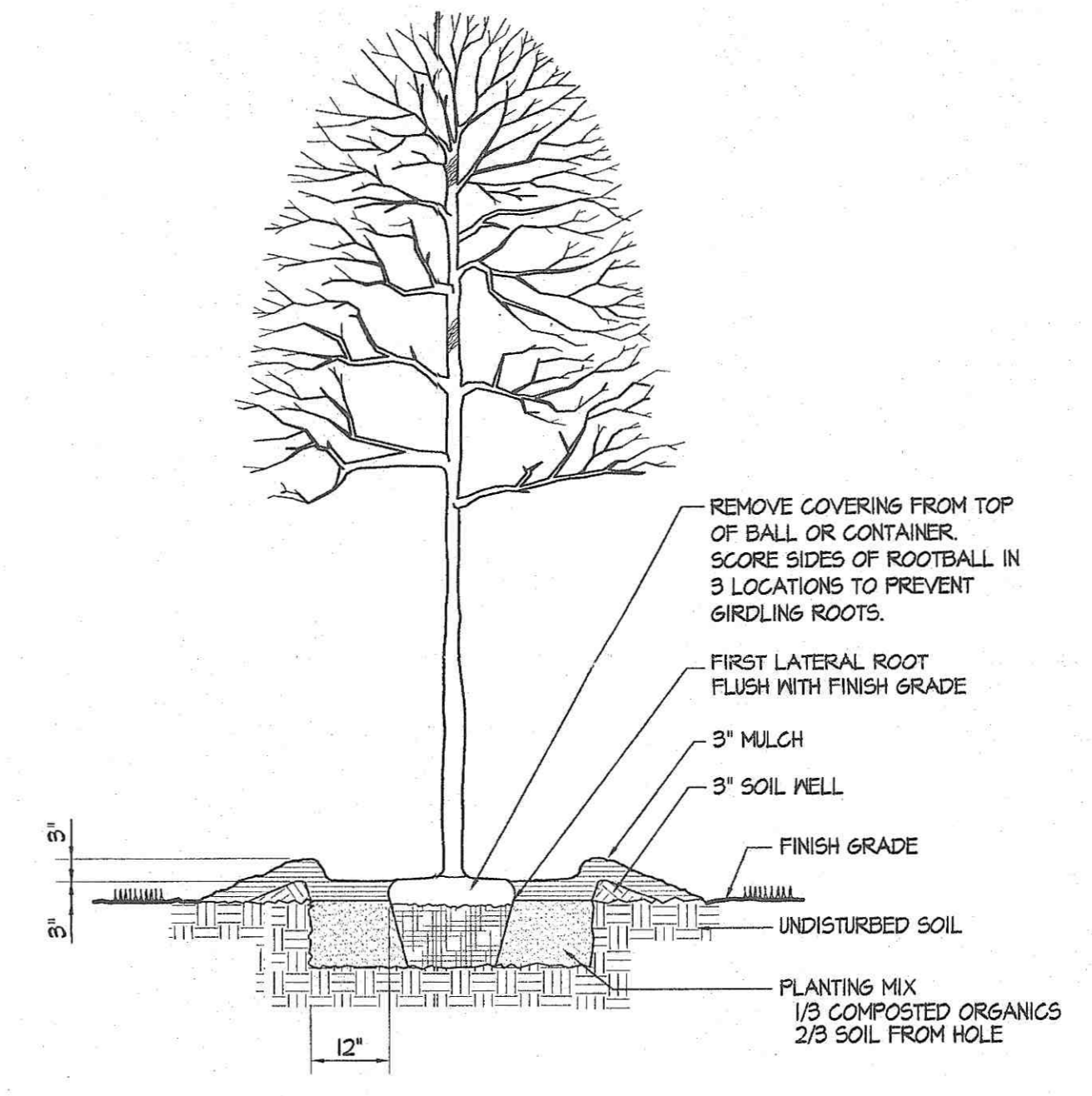

DECIDUOUS TREE DETAIL
N.T.S.

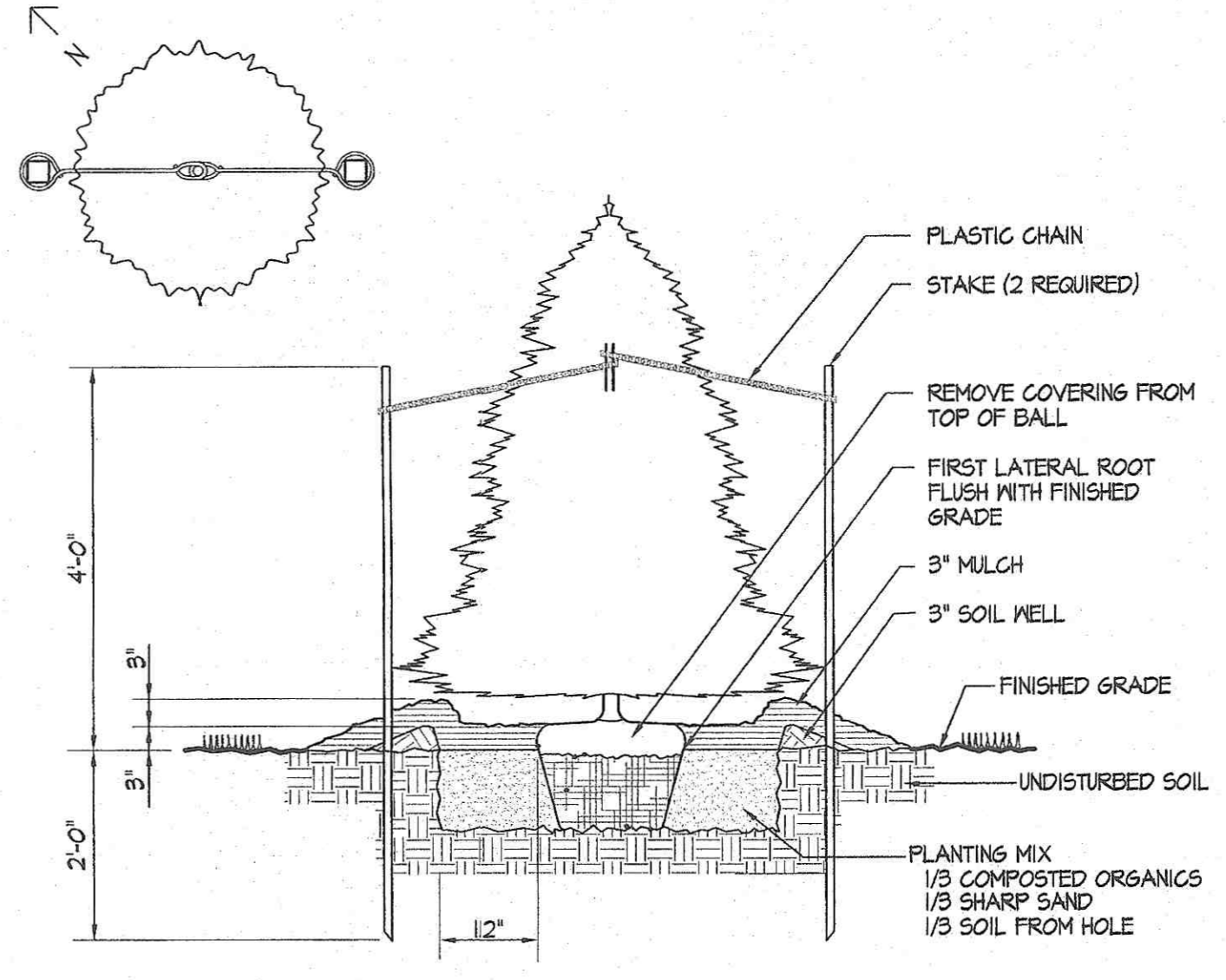

EVERGREEN TREE DETAIL
N.T.S.

PLAN
SCALE: 1" = 30'

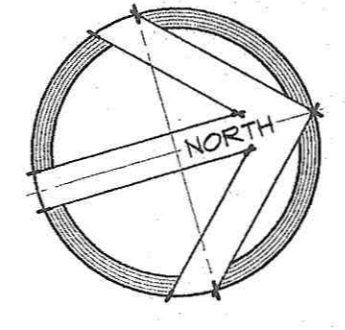

NOTES:
 1. LANDSCAPE SURETY IN THE AMOUNT OF \$2,700.00 FOR 3 SHADE TREES AND 12 EVERGREENS LOCATED ALONG THE USE-IN-COMMON ACCESS EASEMENT SITUATED ON LOT 3 OF THE MCFARLAND PROPERTY SHALL BE PROVIDED UNDER THE GRADING PERMIT. LANDSCAPING SHALL BE PROVIDED AS SHOWN ON THIS CERTIFIED LANDSCAPE PLAN FOR FOT-106.
 2. ALL PARCELS SHOWN ON THIS PLAN AND REFERENCED IN THE TITLE BLOCK ARE OWNED BY NAMELEB CORPORATION.

LEGEND

	PROPERTY LINE
	EXISTING CONTOURS
	PROPOSED CONTOURS
	EXISTING ROADS
	PROPOSED ROADS
	EXISTING WETLANDS
	SOILS LINE
	EXISTING STREAM
	EXISTING STREAM BUFFER
	PROPOSED SEPTIC RESERVE AREA

PLANTING SCHEDULE

KEY	BOTANICAL NAME	COMMON NAME	SIZE	SPACING	QTY	COMMENTS
SHADE TREES						
QR	QUERCUS RUPEA	RED OAK	2 1/2"-3" CAL.	AS SHOWN	3	
EVERGREEN TREES						
TC	TSUGA CANADENSIS	EASTERN HEMLOCK	8'-10' HT.	AS SHOWN	12	

OWNERS: NAMELEB Corporation c/o PCA Group 6851 Oak Hall Lane Suite 300 Columbia, MD 21045
 Gordon Vander Brug, Trustee c/o PCA Group 6851 Oak Hall Lane Columbia, MD 21045

LOTS 16-18 OF BEAUFORT ESTATES, SEC. 1
 F-48-54/PLAT 1314
LOTS 2-4 OF BEAUFORT ESTATES
 F-40-54/PLAT 4616
AND LOT 3 OF MCFARLAND PROPERTY
 F-16-58/PLAT 3666

8548 NW RESERVOIR ROAD
 FULTON, MD 20754

Landscape Plan

REVISIONS

Approved Landscape Plan
 File Copy to Not Remove
 FOT-106
 6-09-08

SITE RESOURCES
 Incorporated
 Comprehensive Land Planning & Site Design Services
 14307 Invertonville Pike • Phoenix, Maryland 21151
 (410) 683-3388 • fax (410) 683-3389

DRAWN BY: KRM CONTRACT NO.:
 DESIGNED BY: KRM SCALE: AS SHOWN
 CHECKED BY: RLR/KRK SRI PROJECT NO: 05038.A
 DATE: Apr. 28, 2008 SHEET