

**GENERAL NOTES**

- COURSES AND COORDINATES ARE BASED ON THE MARYLAND STATE COORDINATE SYSTEM (NO 03/91) AND ARE DERIVED FROM THE FOLLOWING JOHNS HOPKINS UNIVERSITY CONTROL STATIONS:
 

STATION	NORTH	EAST
HOPKINS	544026.5300	1340205.3542
41E	544026.0093	1339217.4436
G12	550256.5002	1342326.2642
G7	549107.0328	1341025.0530
G0	549476.7005	1341170.4345
- THE BOUNDARY SHOWN HEREON IS BASED ON A FIELD RUN MONUMENTED BOUNDARY SURVEY PERFORMED ON OR ABOUT MAY 1, 2000 BY GREGORY KING, WHITMAN, REQUARDT AND ASSOCIATES, LLP WITHOUT THE BENEFIT OF A CURRENT TITLE REPORT. INFORMATION SHOWN ON THE SURVEY IS BASED ON AVAILABLE PUBLIC INFORMATION AND INFORMATION PROVIDED BY JOHNS HOPKINS UNIVERSITY.
- OWNERSHIP: JOHNS HOPKINS UNIVERSITY (SEE BELOW)
- THE INFORMATION PROVIDED AND OBTAINED INDICATES THAT TITLE TO THE SUBJECT PROPERTY IS VESTED IN THE FOLLOWING DEEDS:
 

BEING ALL OF THE FOLLOWING DEEDS:

DEED DATED OCTOBER 9, 1952 AND RECORDED AMONG THE LAND RECORDS OF HOWARD COUNTY, MARYLAND IN LIBER M.W.B. 237, FOLIO 451, WHICH WAS CONVEYED BY GEORGE WOLFF, EVA WOLFF AND M. JEAN DAVIDSON TO THE JOHNS HOPKINS UNIVERSITY.

BEING PART OF THE FOLLOWING DEEDS:

DEED DATED JULY 30, 1962 AND RECORDED AMONG THE LAND RECORDS OF HOWARD COUNTY, MARYLAND IN LIBER M.W.B. 234, FOLIO 304, WHICH WAS CONVEYED BY RAYMOND D. MOORE AND ELIZABETH A. MOORE TO THE JOHNS HOPKINS UNIVERSITY.

DEED DATED JULY 31, 1952 AND RECORDED AMONG THE LAND RECORDS OF HOWARD COUNTY, MARYLAND IN LIBER M.W.B. 234, FOLIO 336, WHICH WAS CONVEYED BY HOWARD E. WESSEL, DOROTHY L. WESSEL, ROLAND F. WESSEL AND DOROTHY E. WESSEL TO THE JOHNS HOPKINS UNIVERSITY.

DEED DATED NOVEMBER 24, 1953 AND RECORDED AMONG THE LAND RECORDS OF HOWARD COUNTY, MARYLAND IN LIBER M.W.B. 250, FOLIO 283, WHICH WAS CONVEYED BY JEAN M. DAVIDSON, GEORGE WOLFF AND EVA WOLFF TO THE JOHNS HOPKINS UNIVERSITY.

DEED DATED APRIL 8, 1963 AND RECORDED AMONG THE LAND RECORDS OF HOWARD COUNTY, MARYLAND IN LIBER 390, FOLIO 244, WHICH WAS CONVEYED BY MILDRED B. PRICE, JAMES N. PRICE AND MILDRED B. PRICE, EXECUTRIX OF THE ESTATE OF SCOTT F. BROWN TO THE JOHNS HOPKINS UNIVERSITY.

DEED DATED MAY 31, 1963 AND RECORDED AMONG THE LAND RECORDS OF HOWARD COUNTY, MARYLAND IN LIBER 400, FOLIO 825, WHICH WAS CONVEYED BY HERBERT W. WESSEL AND GERTRUDE L. WESSEL TO JOHNS HOPKINS UNIVERSITY.
- SUBJECT PROPERTY IS ZONED PEC. (PLANNED EMPLOYMENT CENTER)
- ALL AREAS SHOWN ON THIS PLAN ARE +/-, MORE OR LESS.
- THE FLOODPLAIN RESERVATION SHOWN HEREON IS BASED ON THE NATIONAL FLOOD INSURANCE FLOOD INSURANCE RATE MAP FOR HOWARD COUNTY, MARYLAND COMMUNITY-PANEL NUMBER 240014 0039 B, REVISED DECEMBER 4, 1986.
- THE FOREST CONSERVATION EASEMENT AREA HAS BEEN ESTABLISHED TO FULFILL THE REQUIREMENTS OF SECTION 6-1200 OF THE HOWARD COUNTY CODE AND FOREST CONSERVATION ACT. NO CLEARING, GRADING OR CONSTRUCTION IS PERMITTED WITHIN THE FOREST CONSERVATION EASEMENT; HOWEVER, FOREST MANAGEMENT PRACTICES AS DEFINED IN THE DEED OF FOREST CONSERVATION EASEMENT ARE ALLOWED.
- FOREST CONSERVATION OBLIGATIONS ASSOCIATED WITH THIS PROJECT HAVE BEEN FULFILLED BY RETENTION OF 86,922 ACRES, MORE OR LESS, OF FOREST IN FIVE FOREST CONSERVATION EASEMENTS.
- NO CLEARING, GRADING OR CONSTRUCTION IS PERMITTED WITHIN THE FOREST CONSERVATION AREAS EXCEPT FOR THE WORK ASSOCIATED WITH APPROVED CONSTRUCTION PLANS. ALL FOREST TO REMAIN WITHIN THE AREAS SHOWN AS FOREST CONSERVATION EASEMENT AREA MEET THE MINIMUM REQUIREMENTS OF THE FOREST CONSERVATION ACT.
- A WETLAND STUDY WAS PROVIDED BY RICHARD PIAS & ASSOCIATES, INC. IN JUNE 1999 AND APPROVED BY THE CORPS OF ENGINEERS SEPTEMBER 10, 1999.
- JOHNS HOPKINS UNIVERSITY (THE OWNER) RESERVES UNTO ITSELF, ITS SUCCESSORS AND ASSIGNS, THE FOREST CONSERVATION EASEMENT AS SHOWN ON THIS EXHIBIT AS "FOREST CONSERVATION EASEMENT AREA" ANY AND ALL CONVEYANCES OF THE PROPERTY AS SHOWN ON THIS PLAN SHALL BE SUBJECT TO THE EASEMENT HEREIN RESERVED, WHETHER OR NOT EXPRESSLY DELIVERED IN THE DEED(S) CONVEYING SAID LOT(S). THE OWNER SHALL EXECUTE AND DELIVER A DEED OF FOREST CONSERVATION EASEMENT TO HOWARD COUNTY WITH A METES AND BOUNDS DESCRIPTION OF THE FOREST CONSERVATION AREA. UPON COMPLETION OF THE OWNERS OBLIGATIONS UNDER THE FOREST CONSERVATION AND MAINTENANCE AGREEMENT EXECUTED BY THE OWNER AND THE COUNTY, AND THE RELEASE OF THE OWNERS SURETY POSTED WITH SAID AGREEMENT, THE COUNTY SHALL ACCEPT THE EASEMENT AND RECORD THE DEED OF FOREST CONSERVATION EASEMENT IN THE LAND RECORDS OF HOWARD COUNTY, MARYLAND.
- THIS EXHIBIT IS INTENDED TO SUPPLEMENT INFORMATION PROVIDED ON A PREVIOUSLY SUBMITTED FOREST STAND DELINEATION PLAN - THIS EXHIBIT REFLECTS THE GEOGRAPHIC RELATIONSHIP BETWEEN THE FOREST CONSERVATION EASEMENT AREAS INTENDING TO BE RECORDED WITH THE LIMITS OF DISTURBANCE ASSOCIATED WITH EXISTING DEVELOPMENT. THE PLANIMETRICS SHOWN HEREON ARE BASED UPON AN AERIAL SURVEY AND IS INTENDED AS REFERENCE ONLY.
- FOREST CONSERVATION SURETY IN THE AMOUNT OF 780,906 DOLLARS HAS BEEN POSTED FOR THE 87,340 ACRES OF FOREST CONSERVATION RETENTION EASEMENT.

**TABULATION**

A. Total tract area ..... 369,567 357,967  
 B. Area within 100 year floodplain ..... 21,406  
 C. Net tract area ..... 338,161 336,561

LAND USE CATEGORY: (from table 3.2.1, page 40, Manual)  
 Input the number "1" under the appropriate land use zoning, and limit to only one entry.

ARA	HDR	IDA	HR	MPD	CA
0	0	1	0	0	0

D. Afforestation Threshold ..... 15% x D = 50,497 50,494  
 E. Conservation Threshold ..... 20% x D = 67,913 67,312

EXISTING FOREST COVER:

F. Existing forest cover ..... 165,350  
 G. Area of forest above afforestation threshold ..... 114,475 114,666  
 H. Area of forest above conservation threshold ..... 97,514 98,050

BREAK EVEN POINT:

I. Forest retention above threshold with no mitigation ..... 67,340 66,920  
 J. Clearing permitted without mitigation ..... 70,010 70,430

PROPOSED FOREST CLEARING:

K. Total area of forest to be cleared ..... 70,010 75,946  
 L. Total area of forest to be retained ..... 67,340 69,404

PLANTING REQUIREMENTS:

M. Reforestation for clearing above conservation threshold ..... 19,563 18,99  
 N. Reforestation for clearing below conservation threshold ..... 0.00  
 O. Credit for retention above conservation threshold ..... 19,564 22.08  
 P. Total reforestation required ..... 0.00  
 Q. Total afforestation required ..... 0.00  
 R. Total reforestation and afforestation required ..... 0.00

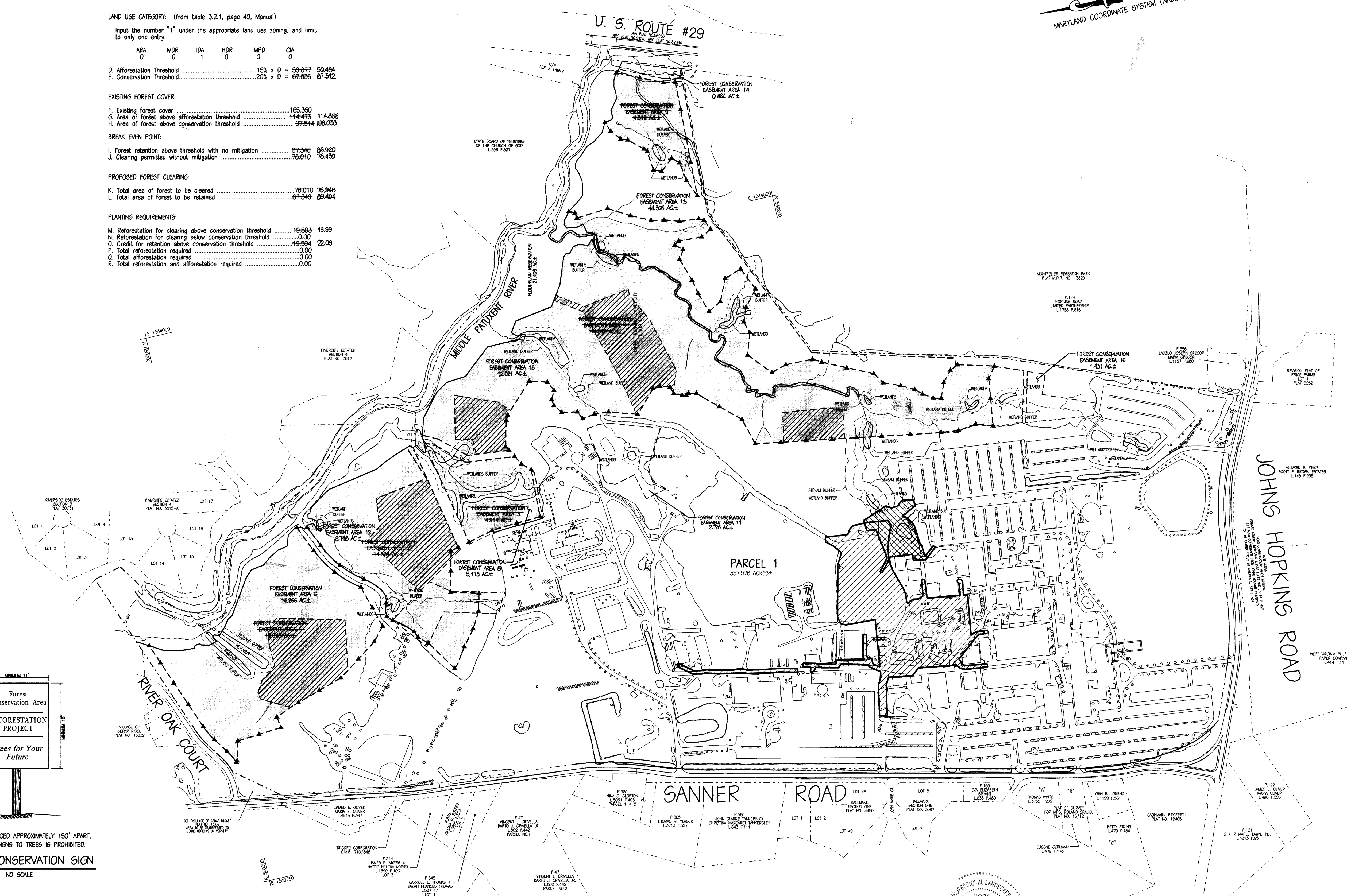
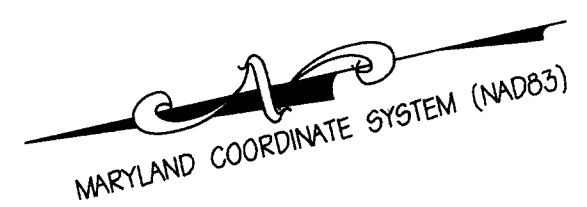

**LEGEND**

- Forest Conservation Area
- REFORESTATION PROJECT
- Trees for Your Future
- FOREST CONSERVATION EASEMENT
- BASIN 'A' - LIMIT OF DISTURBANCE
- SITE UTILITIES - LIMIT OF DISTURBANCE
- EXISTING STREAM
- EXISTING WOODS/FOREST
- APPROXIMATE LOCATION OF FOREST CONSERVATION SIGN
- WETLANDS (TYP.)
- WETLAND BUFFER (TYP. 25')

**FOREST CONSERVATION SIGN**

NO SCALE

- NOTES:**
- SIGNS TO BE PLACED APPROXIMATELY 150' APART.
  - ATTACHMENT OF SIGNS TO TREES IS PROHIBITED.

APPROVED: DEPARTMENT OF PLANNING AND ZONING  
 CHIEF, DEVELOPMENT ENGINEERING DIVISION: *[Signature]* DATE: 5/17/02  
 CHIEF, DIVISION OF LAND DEVELOPMENT: *[Signature]* DATE: 5/29/02  
 DIRECTOR: N/A DATE: X

*[Signature]*  
 HERBERT PALM  
 MARYLAND REGISTERED LANDSCAPE ARCHITECT NO. 2036  
 WHITMAN, REQUARDT & ASSOCIATES, LLP  
 DATE: 26 April 02

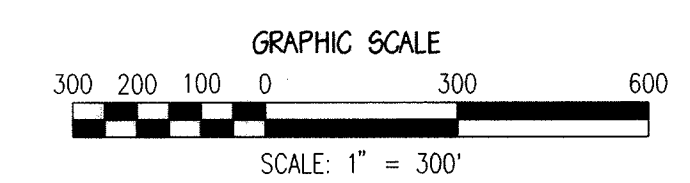

**WR&A**  
 Whitman, Requardt and Associates, LLP  
 Engineers and Planners  
 801 South Caroline Street  
 Baltimore, Maryland 21231  
 (410) 235-3450

DES:	2/20/07	FCE ADJUSTED TO REFLECT CHANGES TO F-02-40	1	MGB	OK		
DRN:	C. RUZICKA						
CHK:	H. PALM						
DATE:	4/26/02	DATE	REVISIONS AND RECORD OF ISSUE	NO.	BY	CR	APP

APPLIED PHYSICS LABORATORY  
 THE JOHNS HOPKINS UNIVERSITY  
**FOREST STAND PLAT**  
 TAX MAP 41 PARCEL 123  
 ELECTION DISTRICT NO. 5  
 HOWARD COUNTY, MARYLAND

SCALE AS SHOWN  
 SHEET FS-1  
 SHEET 24 OF 24

F-02-40