

PROPERTY COORDINATES			CURVE TABULATION CHART				
#	NORTH	EAST	DELTA	ARC	RADIUS	TAN	CHORD BEARING
1	500859.149	860651.599	A	21° 04' 49"	757.87	2059.86	383.27 N 85° 54' 38" W 753.60
2	500059.448	860612.247	B	10° 31' 27"	323.25	1759.86	585° 41' 16" W 322.80

WETLAND		
No.	BEARING	DIST.
1	N 09° 50' 51" W	231.04
2	S 55° 06' 27" E	24.06
3	S 09° 39' 31" E	170.57
4	S 08° 15' 07" W	45.49
5	N 54° 22' 20" W	24.76
6	N 74° 58' 48" E	31.45
7	S 24° 20' 19" W	24.79

TRAVERSE COORDINATES

14	499942.9577	860115.4305
15	500045.1745	859902.4501
16	500239.5905	859908.9377
17	500551.4520	859872.9054
18	500799.7512	859854.0421
101	501080.0142	859872.2716
102	501088.8988	859999.8970
103	501202.8734	860184.1510
104	501498.5408	860170.4809
105	501195.4172	860494.3691
106	500074.8195	860590.5287
107	500042.1371	860154.0799

WETLAND COORDINATES		
#	NORTH	EAST
A	500005.497	859977.610
B	500391.503	860330.049

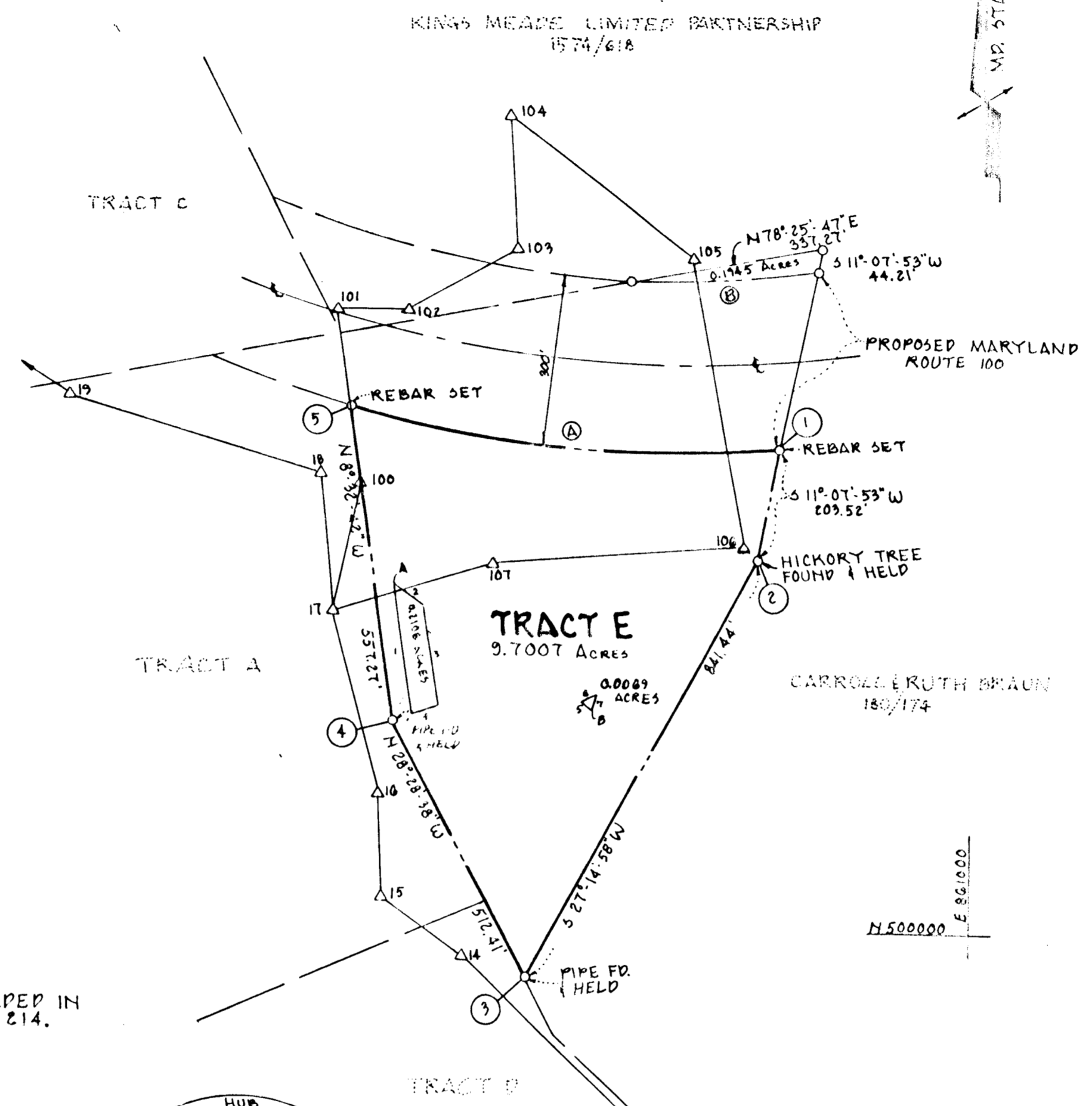
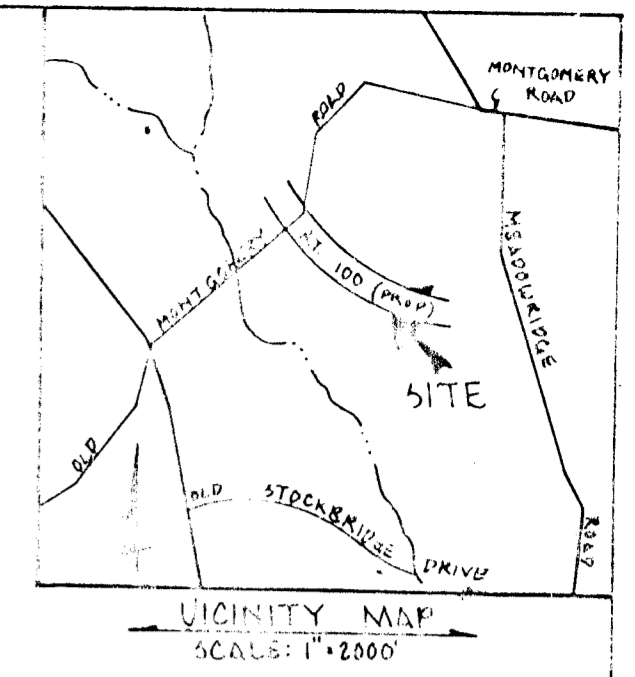

NOTE: FIELD NOTES ARE RECORDED IN HOWARD COUNTY FIELDBOOK 214.

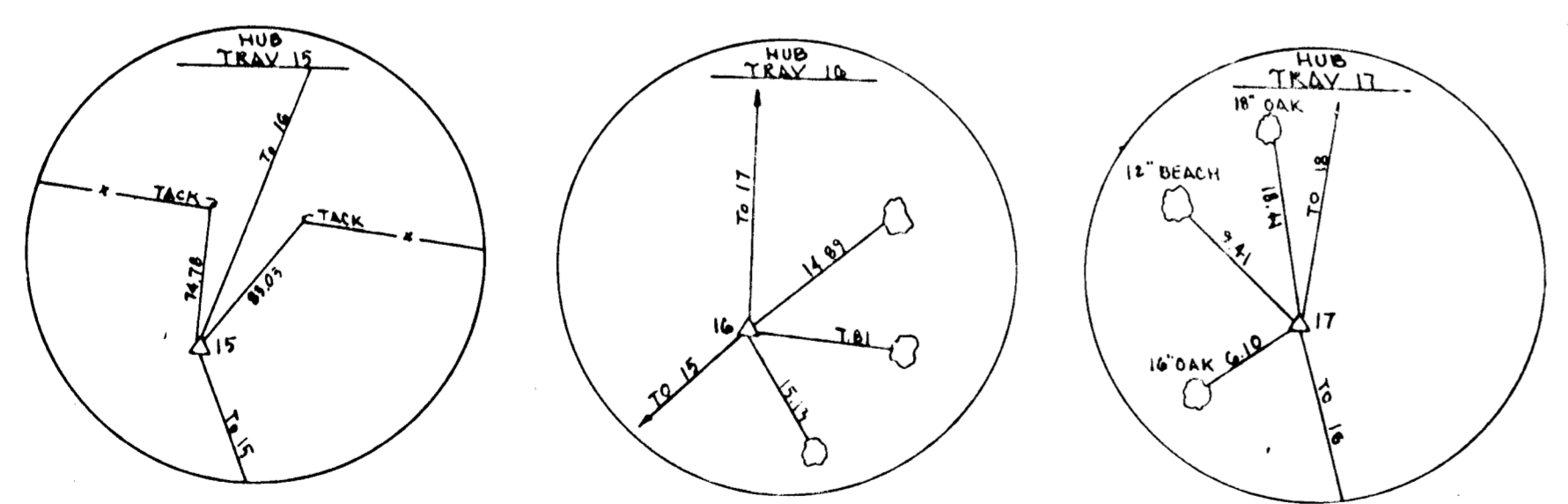

NOTE: COORDINATES ARE BASED ON HOWARD COUNTY CONTROL STATIONS
 2043003: N 500381.998 E 857494.372
 2014001: N 501413.376 E 859200.041

LEGEND	
○	PROPERTY LINE
△	TRAVERSE LINE
---	CENTERLINE OF MD. ROUTE 100 (PROPOSED)

COMPUTED BY: PAUL S. EWELL
 DRAWN BY: PAUL S. EWELL
 CHECKED BY: JOHN C. MELLEMA SR.

REVISIONS

APPROVED: BUREAU OF ENGINEERING	DATE: 11-20-91
<i>William E. Ray</i> CHIEF - BUREAU OF ENGINEERING	
APPROVED: LAND ACQUISITION	DATE: 10/1/91
<i>James P. H. [Signature]</i> CHIEF LAND ACQUISITION	

PREPARED BY:
JOHN C. MELLEMA SR., INC.
 LAND SURVEYORS
 6100 BALTIMORE NATL. PIKE - BALTO., MD. 21228 T44-8880

HOWARD COUNTY, MARYLAND
 DEPARTMENT OF PUBLIC WORKS
 FEE SIMPLE ACQUISITION

RIGHT OF WAY PROJECT: "STATE OF MARYLAND"
 PROJECT NO: C-0210
 DATE: FEBRUARY, 1990
 SCALE: 1" = 200'
 SHEET 4 OF 4
 PLAT NO: C-0210-3

DIRECTOR DEPARTMENT OF PUBLIC WORKS

PROPERTY COORDINATES		CURVE TABULATION CHART					
1	N501934.644 E859206.220	DELTA	ARC	RADIUS	TAN	CHORD	BEARING
2	N500994.929 E859051.907	A	18° 22' 21"	660.52	2017.86	333.12	158° 54' 01" E 657.69'
3	N500903.950 E859207.019						
TRANSVERSE COORDINATES							
18	N500793.751 E859854.042						
20	N501020.029 E859257.442						
21	N501772.503 E859015.529						

NOTE: FIELD NOTES ARE RECORDED IN HOWARD COUNTY FIELD BOOK 21A.

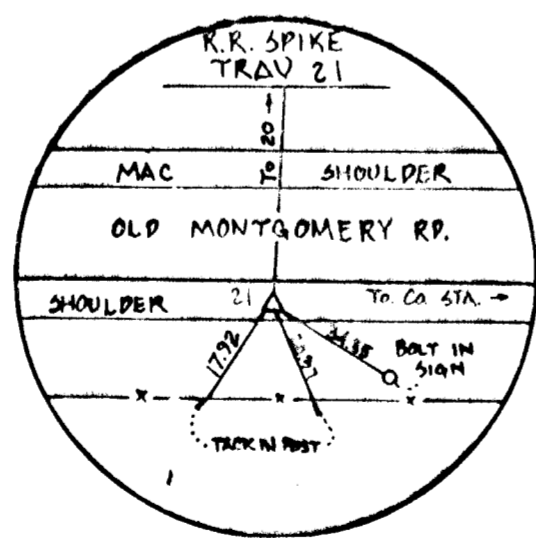
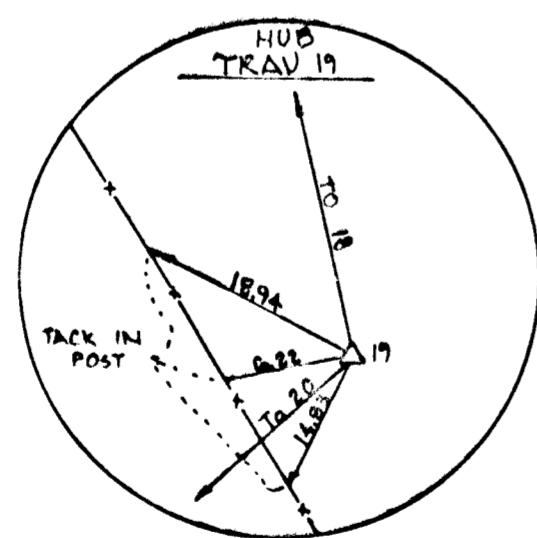
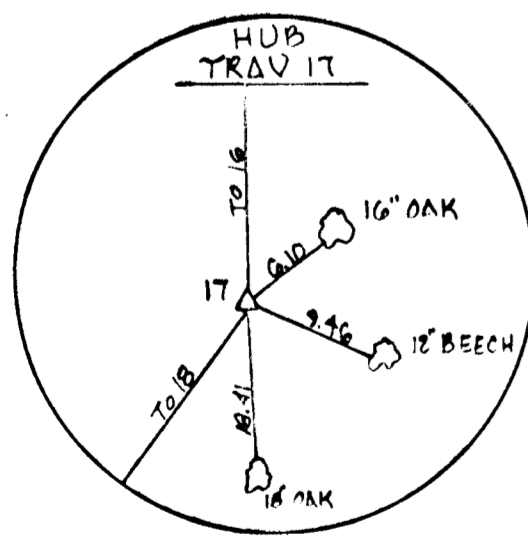
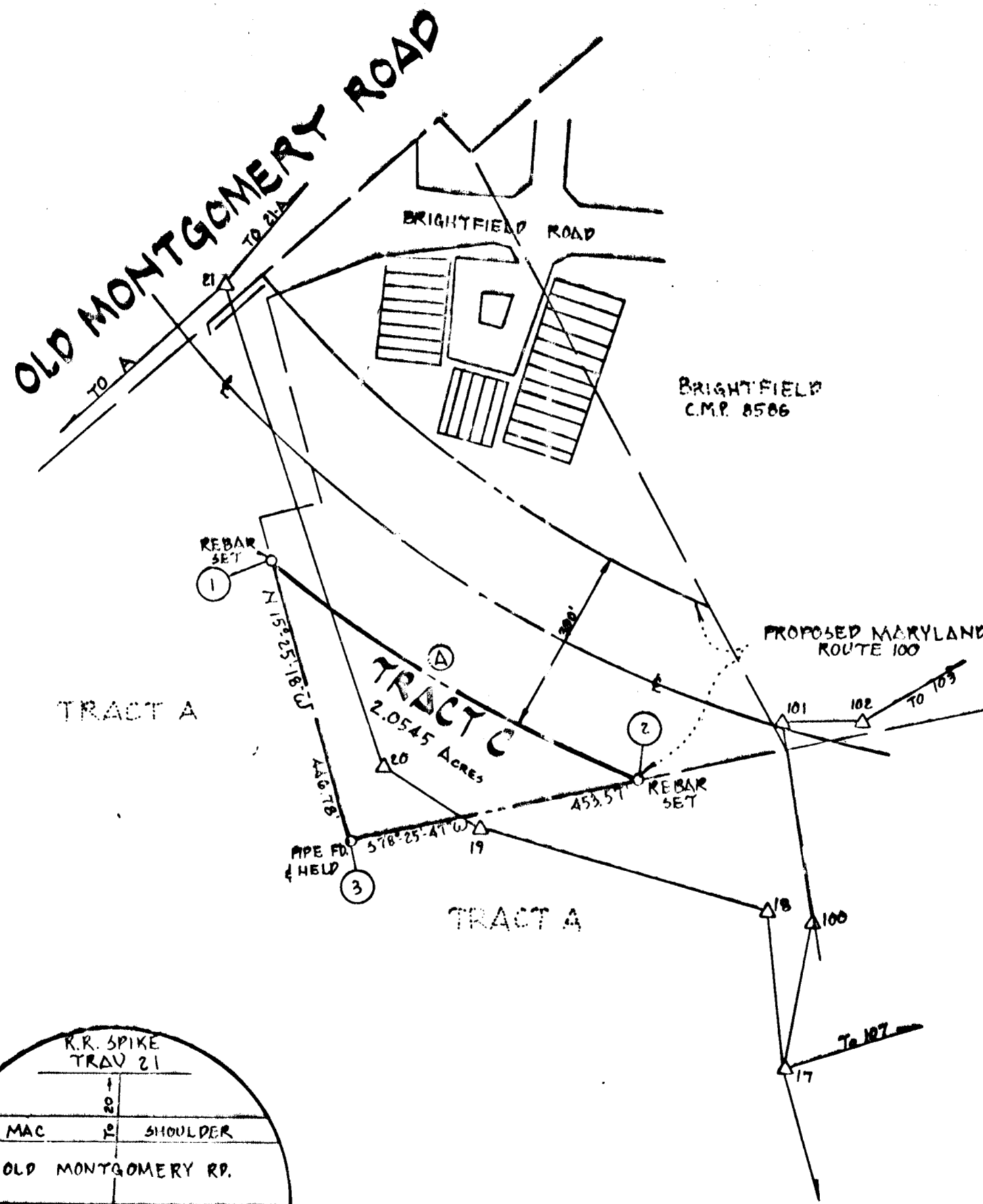
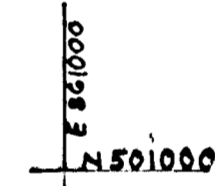
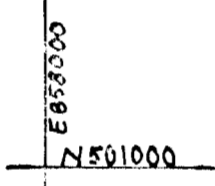
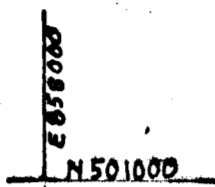
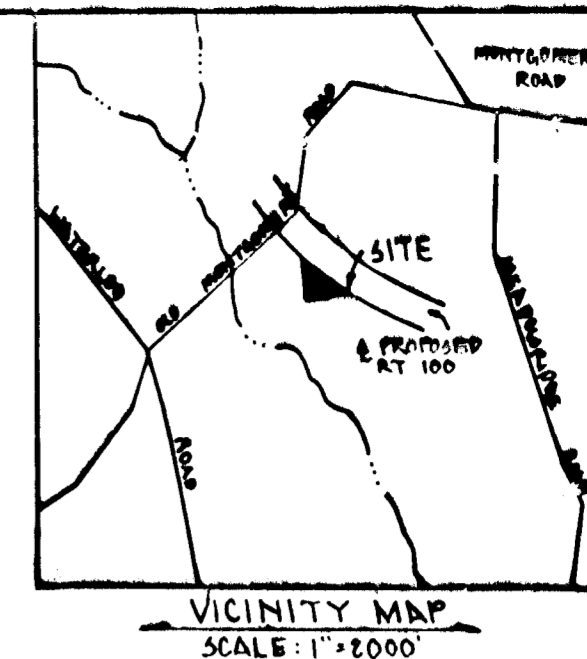

NOTE: COORDINATES ARE BASED ON HOWARD COUNTY CONTROL STATIONS
 2643009: N 500981.938 E 857494.372
 2644001: N 501913.896 E 859206.641



PREPARED BY:
JOHN C. MELLEMA SR., INC.
 LAND SURVEYORS
 6100 BALTIMORE NATL. PIKE. BALTO., MD. 21228 744-8680

HOWARD COUNTY, MARYLAND
 DEPARTMENT OF PUBLIC WORKS
 BUREAU OF ENGINEERING
 FEE SIMPLE ACQUISITION

RIGHT OF WAY PROJECT: "STATE OF MARYLAND"
 PROJECT NO: C-0210
 DATE: FEBRUARY, 1990
 Director: *James M. Lee* ulz61a
 DIRECTOR - DEPARTMENT OF PUBLIC WORKS

SCALE: 1" = 200'
 SHEET 2 OF 4

PLAT NO: C-2210-4

LEGEND
 ○ --- ○ PROPERTY LINE
 △ --- △ TRAVERSE LINE
 + --- + CENTERLINE OF MD. ROUTE 100 (PROPOSED)

COMPUTED BY: PAUL S. EWELL
 DRAWN BY: PAUL S. EWELL
 CHECKED BY: JOHN C. MELLEMA SR.

REVISIONS

APPROVED: BUREAU OF ENGINEERING
William E. [Signature] 11-26-90
 CHIEF - BUREAU OF ENGINEERING DATE

APPROVED: LAND ACQUISITION
James D. [Signature] 10-17-89
 CHIEF - LAND ACQUISITION DATE