

6291

COORDINATE TABLE					
NO.	NORTH	EAST	NO.	NORTH	EAST
1	530070.13	850855.43	11	529399.84	850735.08
2	530103.75	850741.95	12	529570.26	850594.03
3	530054.87	850853.52	13	529778.93	850298.94
4	530021.32	850759.02	14	530016.50	850631.55
5	530019.68	850715.76	15	530014.98	850591.58
6	529801.76	850821.79			
7	529835.96	850668.29			
8	529617.07	850778.70			
9	529514.29	850768.60			
10	529433.43	850744.92			

BON SECOURS HOSPITAL
601/498

TC-WEST/GREENVIEW COMPANY
951/497

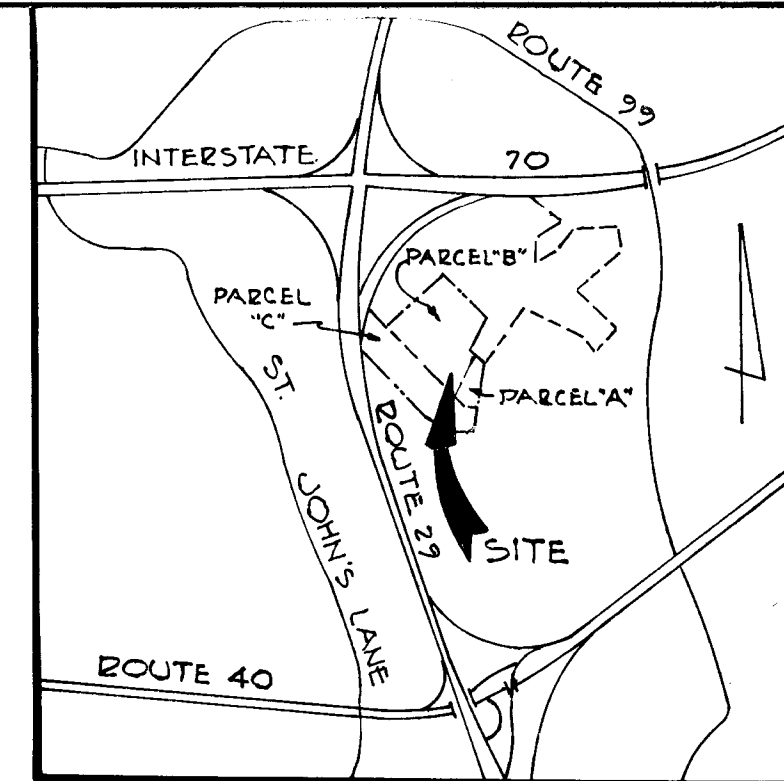

VICINITY MAP
SCALE: 1" = 2640'

THE UNDERSIGNED OWNERS OF THE PROPERTY SHOWN ON THIS PLAT GRANT UNTO HOWARD COUNTY, MARYLAND, ITS SUCCESSORS AND ASSIGNS, THE RIGHT TO LAY, CONSTRUCT AND MAINTAIN SEWERS, DRAINS, WATER PIPES AND OTHER MUNICIPAL UTILITIES AND SERVICES IN AND THROUGH THE SPECIFIC EASEMENT AREAS SHOWN HEREON, TO THE END THAT THE SPECIFIC LOT SHALL BE THEREBY BURDENED WITH THE EASEMENTS SHOWN HEREON, AND IT IS AGREED THAT NO BUILDINGS OR SIMILAR STRUCTURES OF ANY KIND SHALL BE ERECTED, ON, OR OVER THE SAID EASEMENT AREAS BY THE GRANTEE, ITS SUCCESSORS AND ASSIGNS, OR HOWARD COUNTY, MARYLAND. THE RIGHT TO USE ADDITIONAL STRIPS OR PARCELS OF LAND ADJACENT, CONTIGUOUS, CONCENTRIC AND PARALLEL TO ALL EASEMENT AREAS AS SHOWN ON THE PLAT ARE HEREBY GRANTED UNTO HOWARD COUNTY, MARYLAND DURING THE PERIOD OF ORIGINAL CONSTRUCTION ONLY.

BON SECOURS HOSPITAL INCORPORATED

(By) *Sister Theophane Kingellafer*, President
MEDICAL AND PHYSIOLOGICAL FACULTY OF THE STATE OF MARYLAND

(By) *John Sargeant*

PARCEL "B"
BON SECOURS HOWARD COUNTY
HEALTH PARK
A SUBDIVISION OF PART OF THE
PROPERTY OF
BON SECOURS HOSPITAL
PLAT BOOK 4379

PARCEL "C"
BON SECOURS HOWARD COUNTY
HEALTH PARK
A SUBDIVISION OF PART OF THE
PROPERTY OF
BON SECOURS HOSPITAL
PLAT BOOK 4379

FRED A. KAISER &
MARY D. KAISER
394/123

STATE DEPT. OF ASSESSMENTS & TAXATION
HOWARD COUNTY

EASEMENTS APPROVED AND
ACCEPTED BY HOWARD COUNTY
DEPARTMENT OF PUBLIC WORKS.

Bonnie Lee KP
RECEIVED BY
7/35/85 PLAT

(By) *William B. King* 10-16-80
CONTACT 849-D-W-45

PROFESSIONAL LAND SURVEYOR
(By) *William J. Kaschke* #575
PURDUM & JESCHKE
1023 N. CALVERT ST.
BALTIMORE, MARYLAND 21202

PLAT FOR GRANT OF EASEMENTS FOR
SEWER, DRAINAGE AND UTILITIES
BON SECOURS HOWARD COUNTY HEALTH PARK
2ND ELECTION DISTRICT
OCTOBER 8, 1980
HOWARD COUNTY, MARYLAND
SCALE: 1" = 100'

ROUTE
NO. 29

THE 25TH SEC.