

COORDINATE TABLE

Table with columns: POINT, NORTH, EAST. Lists coordinate points for various locations.

PRELIMINARY PLAN

MT. HEBRON
SECTION 23 - PHASES II AND III
LOTS 27 - 71

MINIMUM LOTS SIZE CHART. Table with columns: LOT NO., GROSS AREA, PIPSTEM AREA, REMAINING AREA, 100 YEAR FLOODPLAIN, 25% SLOPES, MINIMUM LOT SIZE.

* DENOTES LOTS THAT DO NOT MEET 25% STEEP SLOPE REGULATIONS AS PER HOWARD COUNTY STANDARDS.

- GENERAL NOTES: 1. THE PROJECT IS IN CONFORMANCE WITH THE LATEST HOWARD COUNTY STANDARDS UNLESS APPROVED OTHERWISE. 2. THIS PROJECT IS ZONED R-20 AND LOCATED WITHIN THE METROPOLITAN DISTRICT. SUBJECT PROPERTY IS SHOWN ON TAX MAP 17, PARCEL 37. 3. PROJECT BACKGROUND: a) LOCATION: APPROXIMATELY 5,200 FEET NORTH OF ROUTE 99 AND 5,000 FEET WEST OF THE INTERSECTION OF ROUTE 29 AND MARYLAND ROUTE 99. b) ZONING: R-20 c) ELECTION DISTRICT: SECOND d) TOTAL TRACT AREA: 47.75 AC e) NO. OF PROPOSED LOTS: 45 f) NO. OF BUILDABLE LOTS: 42 g) NO. OF OPEN SPACE LOTS: 3 h) PREVIOUSLY APPROVED PLAN: SKETCH PLAN 594-24, SECTION 23, PHASE I, LOTS 1 - 8; F95-167, PHASE I LOTS 9-26 P96-12. 4. TOPOGRAPHIC SURVEY PREPARED BY PHOTO SCIENCE, INC. 7840 AIRPACK ROAD, GATHERSBURG, MD. 20878 DATED JANUARY 27, 1990. 5. BOUNDARY PREPARED BY FISHER, COLLINS AND CARTER, INC. ON OR ABOUT MARCH 1994. 6. HORIZONTAL AND VERTICAL DATUM BASED ON HOWARD COUNTY CONTROL COORDINATES BASED ON NAD 83 MARYLAND COORDINATE SYSTEM AS PROJECTED BY HOWARD COUNTY GEODETIC CONTROL STATIONS No. 17-EA AND 17-EB: 17-EA N 180994.8413 (meters) (NOT WITHIN VICINITY MAP LIMITS) E 413227.8949 (meters) 17-EB N 181805.5677 (meters) (NOT WITHIN VICINITY MAP LIMITS) E 413722.4 (meters) 7. PUBLIC WATER AND SEWER TO BE UTILIZED. WATER CONTRACT No. 14-338-0 SEWER CONTRACT No. 4-388-0. DRAINAGE AREA IS THE PATAPUSCO WATERSHED. (NOTE: WATER & SEWER CONTRACT NUMBERS WILL BECOME AVAILABLE WITH THE NEXT SUBMISSION OF SECTION 23 PHASE I PRELIMINARY PLAN) 8. A.P.F.O. TRAFFIC STUDY PREPARED BY STREET TRAFFIC STUDIES INC. ON JANUARY 31, 1994. IT WAS APPROVED ON MARCH 30, 1994 BY HOWARD COUNTY. (REFERENCES 5-94-24) 9. WETLANDS ANALYSIS PREPARED BY M. A. DIRKS AND CO., INC. ON MARCH 1994 AND APPROVED MARCH 30, 1994 BY HOWARD COUNTY. (REFERENCES 5-94-24) 10. DENSITY TABULATION: a) TOTAL AREA OF BUILDABLE LOTS = 16.36 AC b) TOTAL AREA OF OPEN SPACE LOTS = 28.60 AC c) TOTAL AREA OF ROADWAY = 2.49 AC d) TOTAL AREA OF SUBDIVISION = 47.75 AC 11. STREET TREES ARE REQUIRED IN THIS SUBDIVISION AND WILL BE PROVIDED WITHIN 10' TREE MAINTENANCE EASEMENTS. LOCATION OF THE TREES, PLANTING DETAILS AND SPECIFICATIONS WILL BE PROVIDED AT FINAL PLANS. 12. OPEN SPACE CALCULATIONS: PHASE I (LOTS 1 - 8) OPEN SPACE REQUIRED = 9.576 AC. x 30% = 2.873 AC. PHASE I (LOTS 1 - 8) OPEN SPACE PROVIDED = 6.302 AC. PHASE I (LOTS 9 - 26) OPEN SPACE REQUIRED = 9.500 AC. x 30% = 2.850 AC. PHASE I (LOTS 9 - 26) OPEN SPACE PROVIDED = 0.371 AC. (LOT 26) PHASE I (LOTS 1 - 26) REQUIRED = 2.873 AC. + 2.876 AC. = 5.749 AC. PHASE I (LOTS 1 - 26) PROVIDED = 6.302 AC. + 0.371 AC. = 6.673 AC. PHASE II AND PHASE III (LOTS 1 - 45) REQUIRED = 47.75 AC x 30% = 14.33 AC. PHASE II AND PHASE III PROVIDED = 25.60 AC. 13. STORMWATER MANAGEMENT WAS PROVIDED IN SECTION 23 PHASE I UNDER F95-167. 14. STORM DRAINS WERE DESIGNED AND SUBMITTED IN SECTION 23 PHASE I UNDER F95-167. 15. MINIMUM SPACING BETWEEN STREET TREES AND STREET LIGHTS IS 20'.

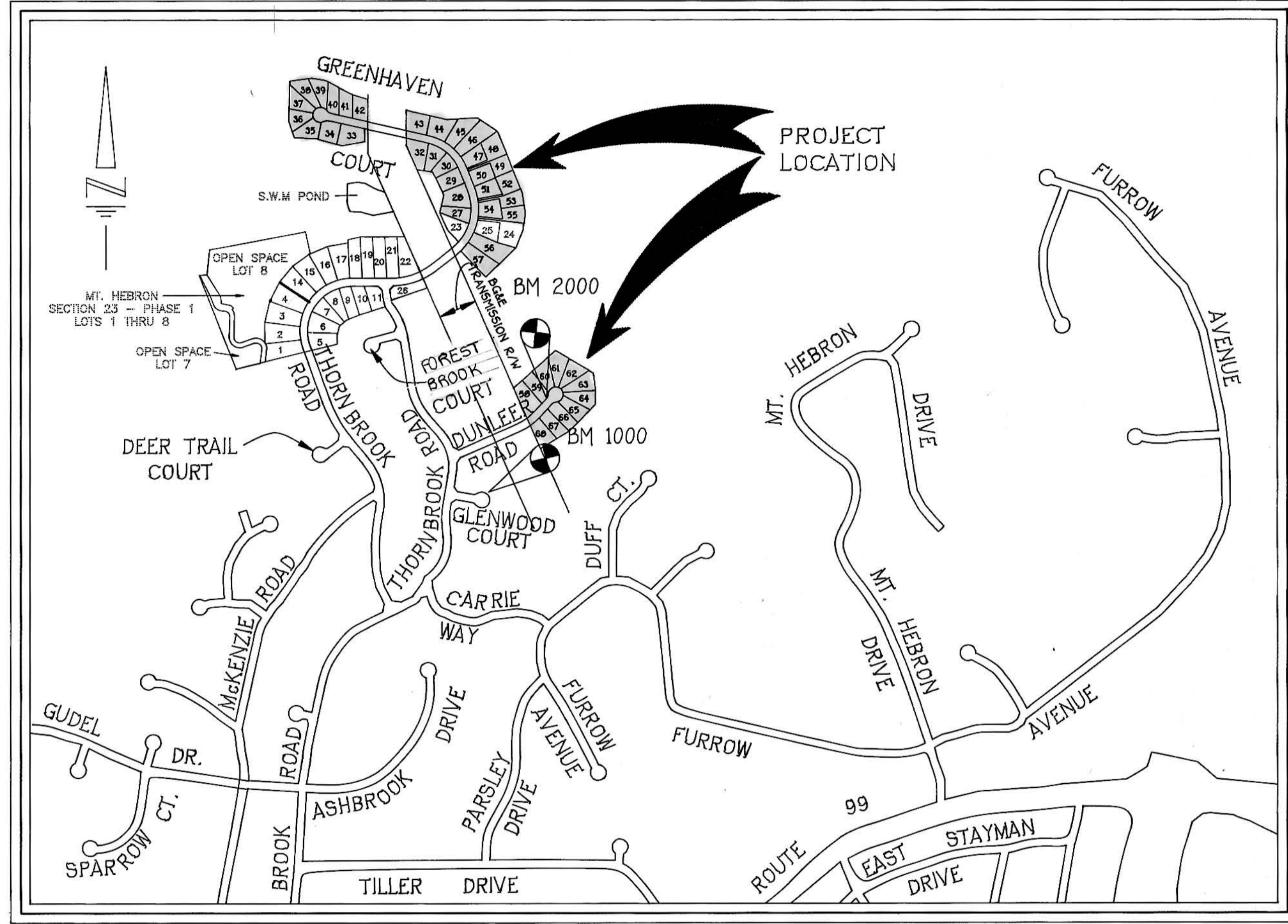

VICINITY MAP SCALE: 1" = 600'

SECOND ELECTION DISTRICT
HOWARD COUNTY, MARYLAND

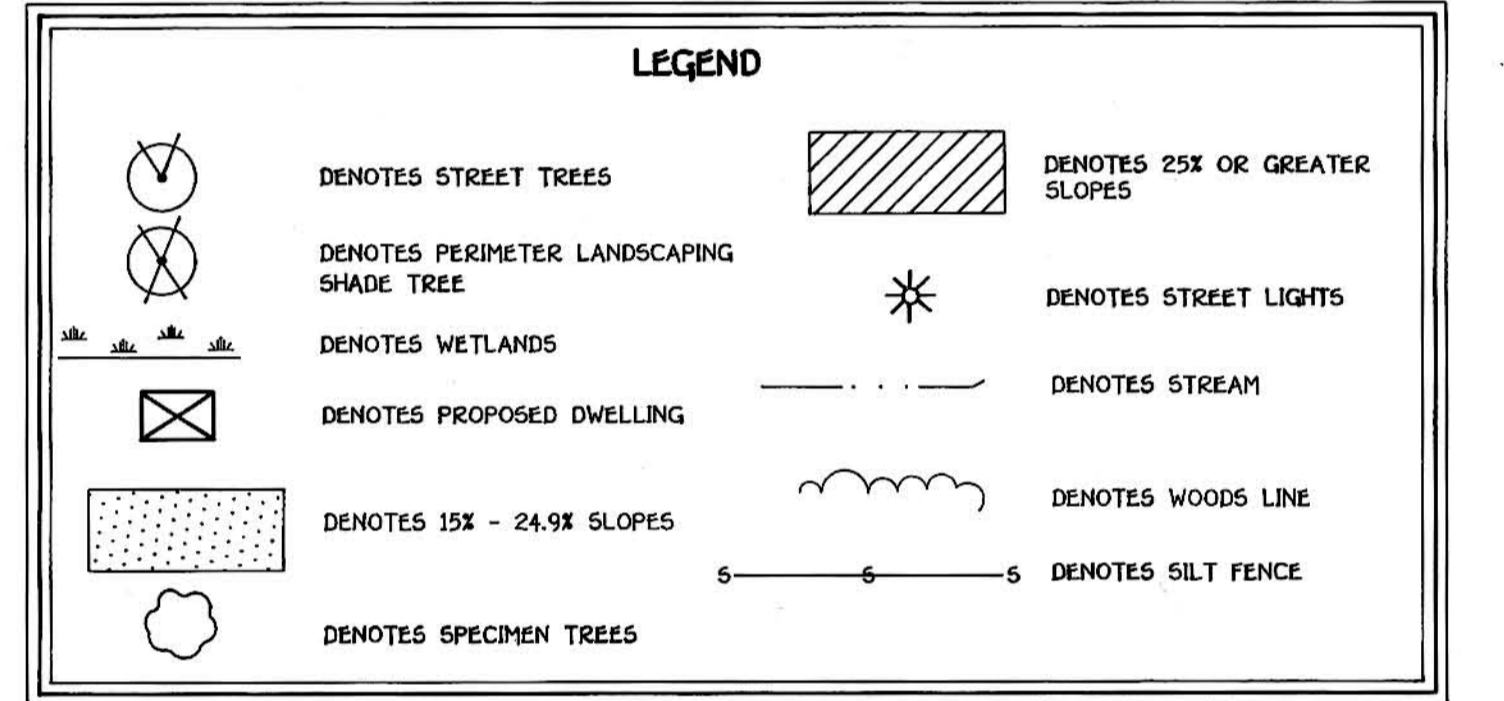

BENCH MARKS

- BM. 1000 ELEV. +107.81 REAR SET 27' SOUTHEAST OF LINEAR PROFILE STATION 1+55 GREENWOOD COURT ON LOT 45 BM. 2000 ELEV. +423.62 REAR SET 9' N. OF & STATION 2+00 DUNLEER ROAD ON LOT 59 (SHOWN ON VICINITY MAP)

SHEET INDEX table with columns: No., DESCRIPTION. Lists sheet numbers and their corresponding descriptions.

U.S. EQUIVALENT COORDINATE TABLE

Table with columns: POINT, NORTH, EAST. Lists U.S. equivalent coordinate points.

METRIC COORDINATE TABLE

Table with columns: POINT, NORTH, EAST. Lists metric coordinate points.

Table with columns: Specimen, Species, DBH, Condition. Lists tree specimens and their details.

SCHEDULE A: PERIMETER LANDSCAPE EDGE

Table with columns: CATEGORY, ADJACENT TO ROADWAYS, ADJACENT TO PERIMETER PROPERTIES. Lists landscape requirements for different categories.

STREET LIGHT CHART table with columns: DWG. No., STREET NAME, STATION, OFF-SET, FIXTURE/POLE TYPE, COMMENTS. Lists street lighting specifications.

FISHER, COLLINS & CARTER, INC. CIVIL ENGINEERING CONSULTANTS & LAND SURVEYORS

OWNER/DEVELOPER: MT. HEBRON, INC. MR. H. JONES BAKER, JR. 2106 MT. HEBRON DRIVE ELLICOTT CITY, MARYLAND, 21042

TENTATIVELY APPROVED DEPT. OF PLANNING AND ZONING OF HOWARD COUNTY. PLANNING DIRECTOR DATE: 6/21/90. CHARLES J. CROVO, SR. DATE: 3/14/90

COMMENTS: 1) 100% CREDIT IS REQUESTED FOR EXISTING VEGETATION TO REMAIN ALONG PERIMETERS P1P2, P3, P5, P7, & P8. 2) ALL PLANTING FROM P-4 & P-5 WILL BE CLUSTERED IN AREAS ADJACENT TO LOTS 32, 33, 42, 43, 57, 58 & 60. (NOTE: THE DEVELOPER WILL BE RESPONSIBLE FOR THE INSTALLATION OF ALL LANDSCAPE PLANTINGS IN CONJUNCTION WITH THE ROAD CONSTRUCTION PLANS.)

PRELIMINARY PLAN MT. HEBRON SECTION 23 - PHASE II AND III LOTS 27 - 71 SECOND ELECTION DISTRICT HOWARD COUNTY, MARYLAND DATE: DECEMBER 30, 1995

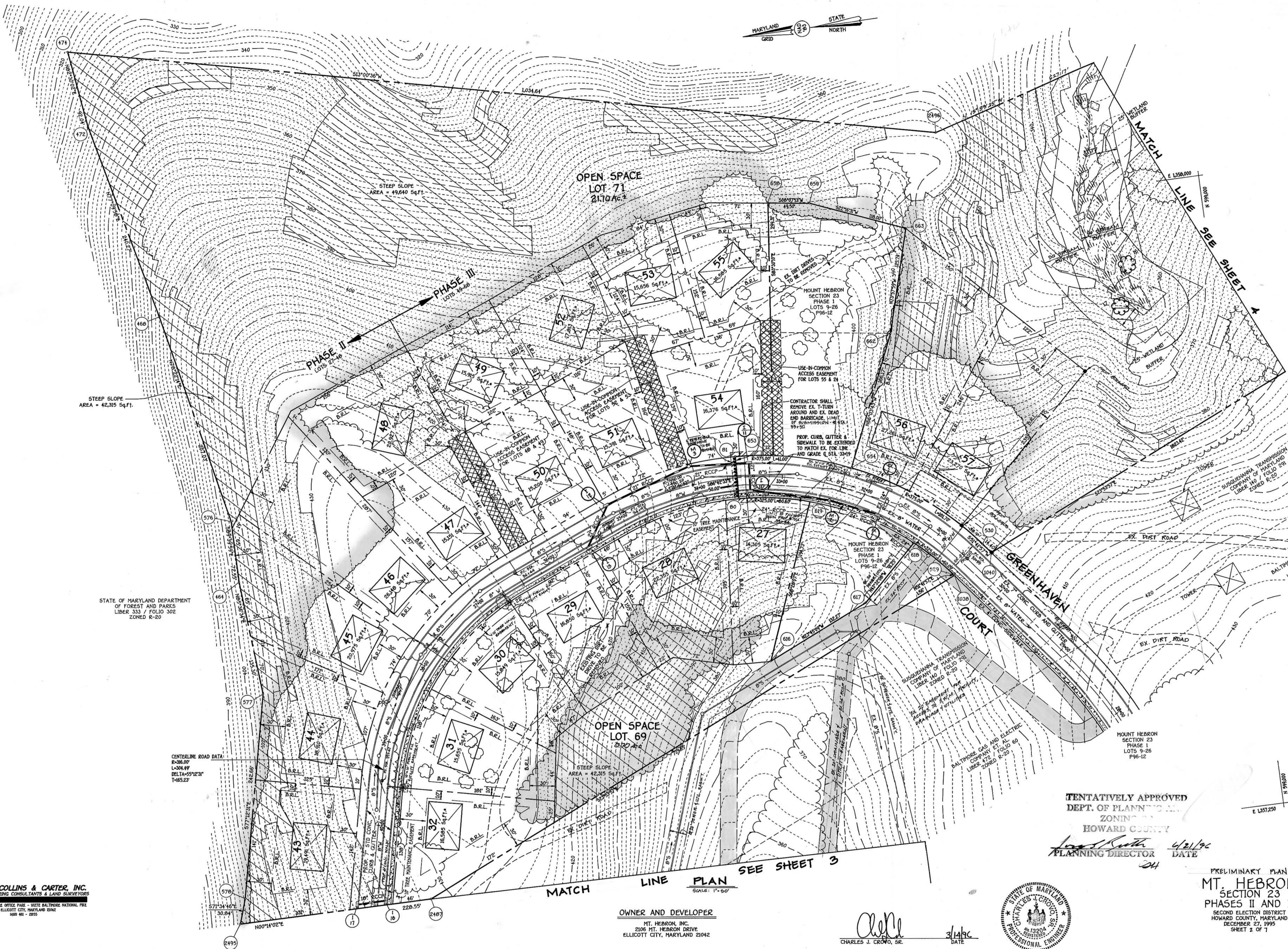
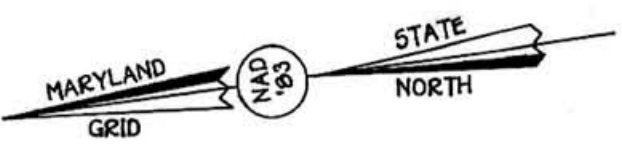

STEEP SLOPE AREA = 42,315 Sq.Ft.

STEEP SLOPE AREA = 49,640 Sq.Ft.

OPEN SPACE LOT 71 21,700 Ac.

OPEN SPACE LOT 69 21,720 Ac.

STATE OF MARYLAND DEPARTMENT OF FOREST AND PARKS LIBER 333 / FOLIO 302 ZONED R-20

CENTERLINE ROAD DATA: R=306.00' L=304.49' DELTA=55.1231° I=465.23'

TENTATIVELY APPROVED DEPT. OF PLANNING AND ZONING HOWARD COUNTY PLANNING DIRECTOR DATE 4/21/96

MATCH LINE PLAN SEE SHEET 3 SCALE: 1"=50'

OWNER AND DEVELOPER: MT. HEBRON, INC. 2105 MT. HEBRON DRIVE ELLICOTT CITY, MARYLAND 21042

Signature: Charles J. Crovo, Sr. DATE: 3/14/96



PRELIMINARY PLAN MT. HEBRON SECTION 23 PHASES II AND III SECOND ELECTION DISTRICT HOWARD COUNTY, MARYLAND DECEMBER 27, 1995 SHEET 2 OF 7

FISHER, COLLINS & CARTER, INC. CIVIL ENGINEERING CONSULTANTS & LAND SURVEYORS

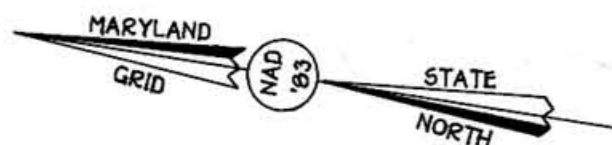

MATCH LINE SEE SHEET 2

GREENHAVEN COURT

STATE OF MARYLAND
DEPARTMENT OF
FOREST AND PARKS
333 / 302
ZONED R-20

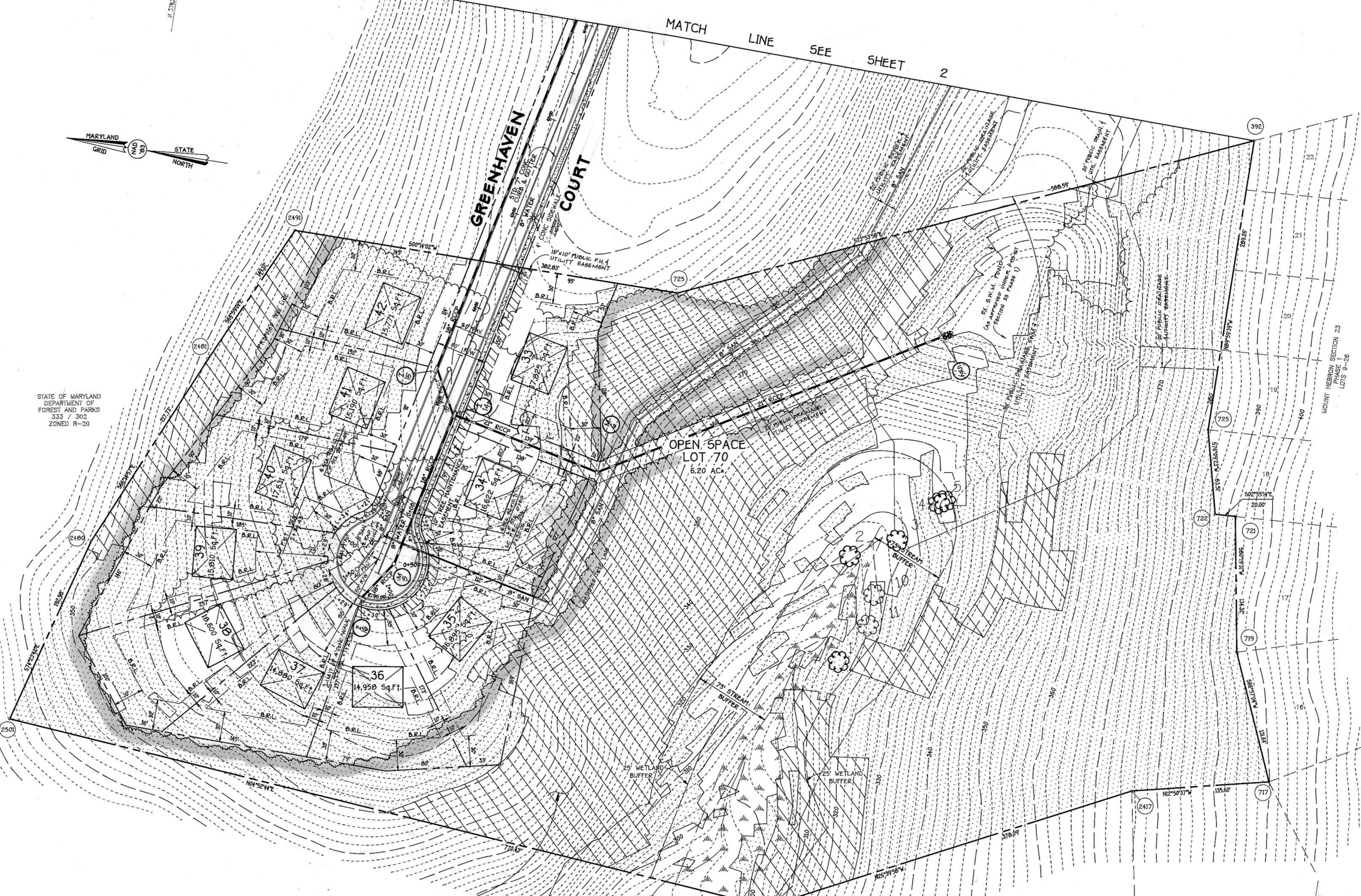

OPEN SPACE
LOT 70
6.20 AC.

STEEP SLOPE
AREA = 136,555 Sq.Ft.

STATE OF MARYLAND
DEPARTMENT OF
FOREST AND PARKS
333 / 302
ZONED R-20

TENTATIVELY APPROVED
DEPT. OF PLANNING AND
ZONING OF
HOWARD COUNTY

Charles J. Croft 6/21/96
PLANNING DIRECTOR DATE

PRELIMINARY PLAN
MT. HEBRON
SECTION 23
PHASES II AND III
SECOND ELECTION DISTRICT
HOWARD COUNTY, MARYLAND
DECEMBER 20, 1995
SHEET 9 OF 7

FISHER, COLLINS & CARTER, INC.
CIVIL ENGINEERING CONSULTANTS & LAND SURVEYORS
CENTURIAL SQUARE OFFICE PARK - 10272 BALTIMORE NATIONAL PIKE
ELLICOTT CITY, MARYLAND 21042
1408 01 - 2395

OWNER AND DEVELOPER
MT. HEBRON, INC.
2106 MT. HEBRON DRIVE
ELLICOTT CITY, MARYLAND 21042

PLAN
SCALE: 1" = 50'



Charles J. Croft
CHARLES J. CROFT, SR.
3/14/96
DATE

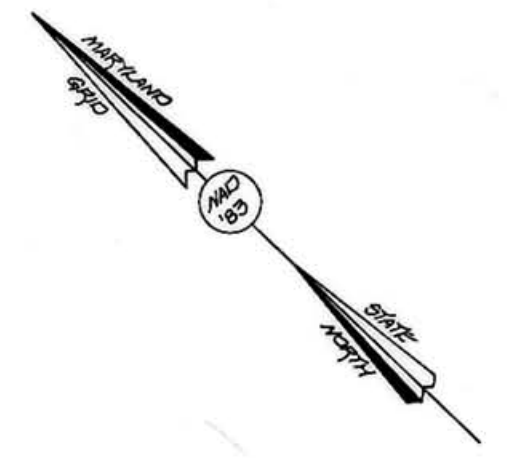

STATE OF MARYLAND DEPARTMENT
OF FOREST AND PARKS
0/6 PATAPSCO VALLEY
STATE PARK
LIBER 377 / FOLIO 582
ZONED R-20

MATCH LINE SEE SHEET 2

OPEN SPACE
71
21,709 sq. ft.

OPEN SPACE
71

DUNLEER
ROAD

CENTERLINE CURVE DATA
R=400.00'
L=162.59'
DELTA=23°17'22"

CONTRACTOR SHALL REMOVE BK T-DRAIN
AROUND AND BY DEAD END UNDERPASS
LIMIT OF SUBMISSION E STA. 31+23.46
REMOVABLE SLOPE EASEMENT
TO BE ABANDONED

BALTIMORE GAS & ELECTRIC COMPANY BY AND
LIBER 1912 / FOLIO 60
ZONED R-20

TENTATIVELY APPROVED
DEPT. OF PLANNING AND
ZONING OF
HOWARD COUNTY

PLANNING DIRECTOR *[Signature]* DATE 4/21/96
CH

PRELIMINARY PLAN
MT. HEBRON
SECTION 23
PHASES II AND III
SECOND ELECTION DISTRICT
HOWARD COUNTY, MARYLAND
DECEMBER 27, 1995
SHEET 4 OF 7

FISHER, COLLINS & CARTER, INC.
CIVIL ENGINEERING CONSULTANTS & LAND SURVEYORS
CENTRAL SQUARE OFFICE PARK - 10272 BALTIMORE NATIONAL PIKE
ELLICOTT CITY, MARYLAND 21044
(410) 461-2855

OWNER AND DEVELOPER
MT. HEBRON, INC.
2106 MT. HEBRON DRIVE
ELLICOTT CITY, MARYLAND 21042

PLAN
SCALE: 1"=50'



[Signature]
CHARLES J. CARPIO, SR.
DATE 3/14/96

LEGEND

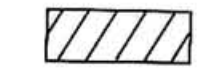
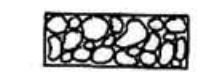
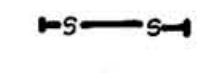
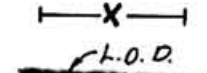
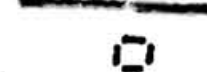
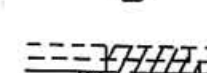
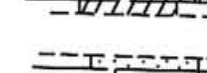
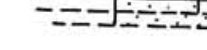
-  EX. PAVING TO BE REMOVED
-  STABILIZED CONSTRUCTION ENTRANCE
-  SILT FENCE
-  TREE PROTECTION FENCE
-  LIMIT OF DISTURBANCE
-  INLET PROTECTION
-  25% OR GREATER SLOPES
-  15% - 24.99% SLOPES

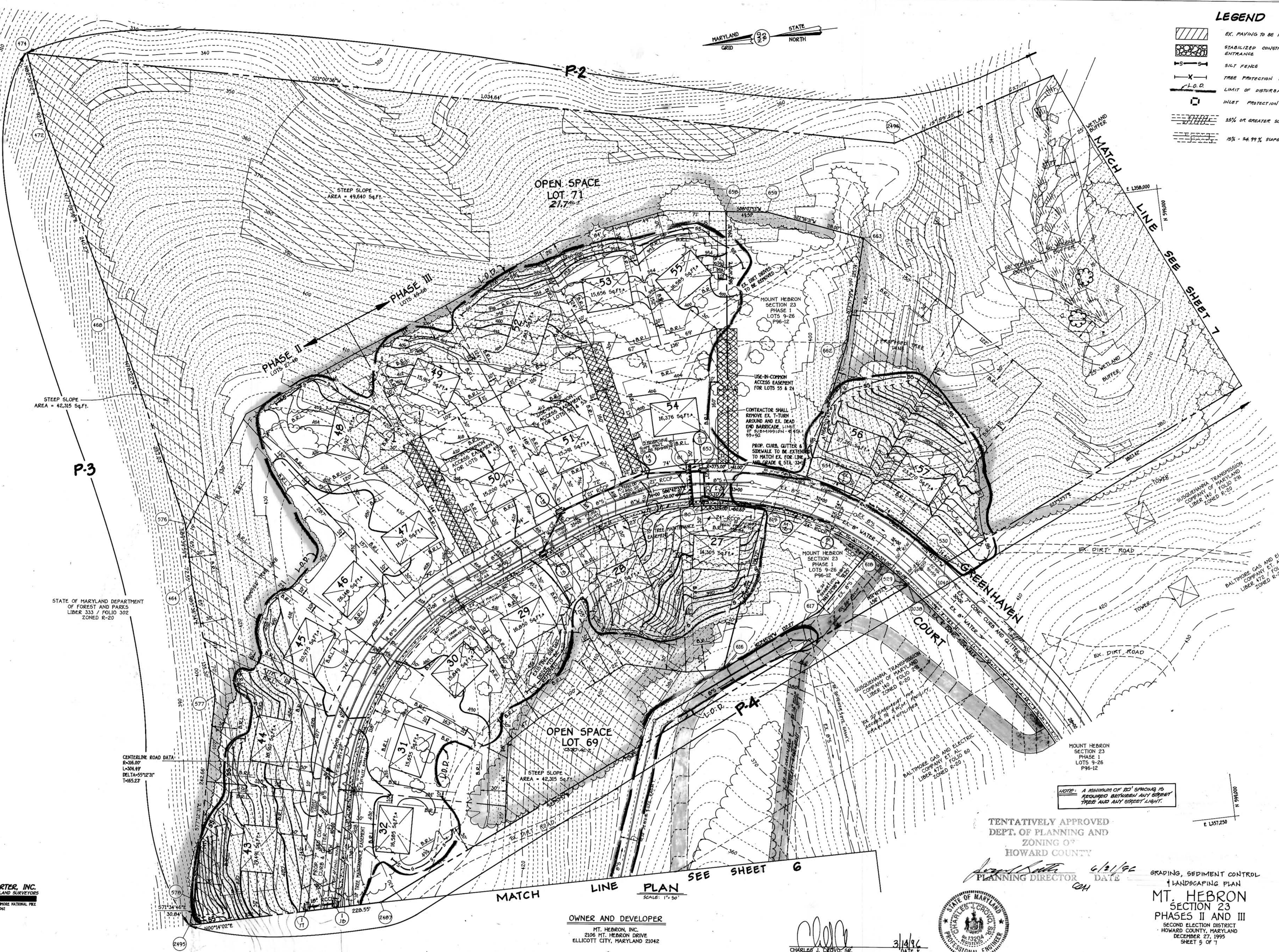
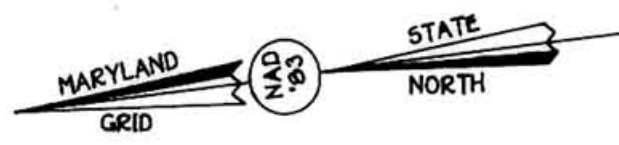

STEEP SLOPE AREA = 42,315 Sq.Ft.

STATE OF MARYLAND DEPARTMENT OF FOREST AND PARKS LIBER 333 / FOLIO 302 ZONED R-20

CENTERLINE ROAD DATA:
R=36.07
L=304.49
DELTA=55°12'31"
T=185.23'

OPEN SPACE LOT 71
21,740 Sq.Ft.

OPEN SPACE LOT 69
22,042 Sq.Ft.

CONTRACTOR SHALL REMOVE EX. T-TURN AROUND AND EX. DEAD END BARRICADE (11411) AT 508+11.91 (11411) 99+50.00

MOUNT HEBRON SECTION 23 PHASE I LOTS 9-26 P96-12

NOTE: A MINIMUM OF 20' SPACING IS REQUIRED BETWEEN ANY STREET TREES AND ANY STREET LIGHT.

TENTATIVELY APPROVED
DEPT. OF PLANNING AND ZONING OF
HOWARD COUNTY

PLANNING DIRECTOR DATE 6/21/96

GRADING, SEDIMENT CONTROL & LANDSCAPING PLAN
MT. HEBRON SECTION 23 PHASES II AND III
SECOND ELECTION DISTRICT HOWARD COUNTY, MARYLAND
DECEMBER 27, 1995
SHEET 5 OF 7







FISHER, COLLINS & CARTER, INC.
CIVIL ENGINEERING CONSULTANTS & LAND SURVEYORS
CENTRAL SQUARE OFFICE PARK - 10772 BALTIMORE NATIONAL PIKE
ELLICOTT CITY, MARYLAND 21117
4100 461 - 2025

OWNER AND DEVELOPER
MT. HEBRON, INC.
2106 MT. HEBRON DRIVE
ELLICOTT CITY, MARYLAND 21142

CHARLES J. CROVO, SR.
DATE 3/14/96

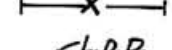

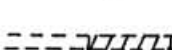
LEGEND

-  EX. PAVING TO BE REMOVED
-  STABILIZED CONSTRUCTION ENTRANCE
-  SILT FENCE
-  TREE PROTECTION FENCE
-  LIMIT OF DISTURBANCE
-  INLET PROTECTION
-  25% OR GREATER SLOPES
-  15% - 24.99% SLOPES

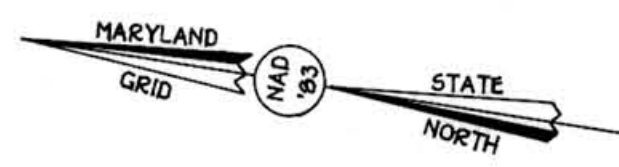

MATCH LINE SEE SHEET 5

STATE OF MARYLAND
DEPARTMENT OF
FOREST AND PARKS
333 / 302
ZONED R-20

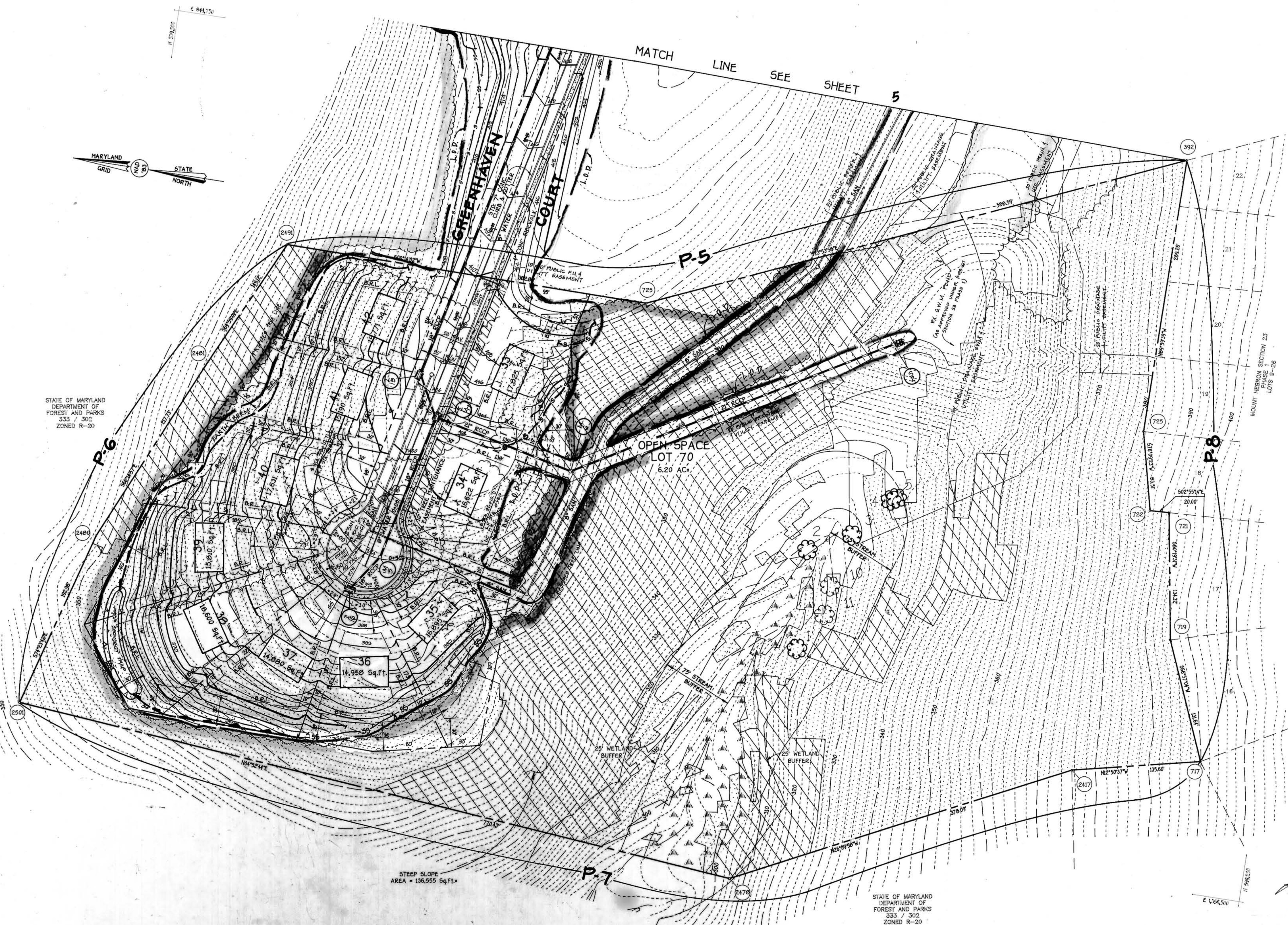

STEEP SLOPE
AREA = 136,955 Sq.Ft.

STATE OF MARYLAND
DEPARTMENT OF
FOREST AND PARKS
333 / 302
ZONED R-20

TENTATIVELY APPROVED
DEPT. OF PLANNING AND
ZONING OF
HOWARD COUNTY

Charles J. Czako, Sr. 6/2/96
PLANNING DIRECTOR DATE

GRADING, SEDIMENT CONTROL
& LANDSCAPING PLAN

MT. HEBRON
SECTION 23
PHASES II AND III
SECOND ELECTION DISTRICT
HOWARD COUNTY, MARYLAND
DECEMBER 28, 1995
SHEET 6 OF 7

FISHER, COLLINS & CARTER, INC.
CIVIL ENGINEERING CONSULTANTS & LAND SURVEYORS
CENTRAL SQUARE OFFICE PARK - 10777 BALTIMORE NATIONAL PIKE
ELLICOTT CITY, MARYLAND 21042
410-410-2000



OWNER AND DEVELOPER
MT. HEBRON, INC.
2106 MT. HEBRON DRIVE
ELLICOTT CITY, MARYLAND 21042

PLAN
SCALE: 1" = 50'

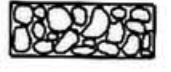
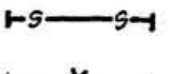
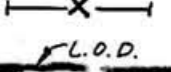
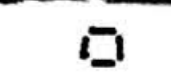

Charles J. Czako, Sr.
CHARLES J. CZAKO, SR.
3/14/96
DATE

LEGEND

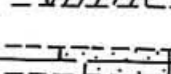
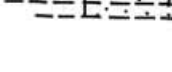
-  EX. PAVING TO BE REMOVED
-  STABILIZED CONSTRUCTION ENTRANCE
-  SILT FENCE
-  TREE PROTECTION FENCE
-  LIMIT OF DISTURBANCE
-  INLET PROTECTION
-  25% OR GREATER SLOPES
-  15% - 24.99% SLOPES

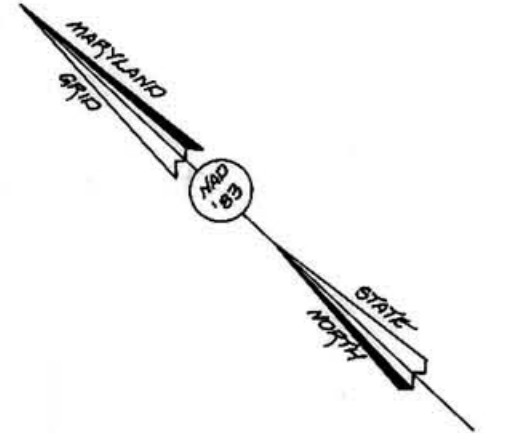

STATE OF MARYLAND DEPARTMENT OF FOREST AND PARKS
c/o PATAPSCO VALLEY STATE PARK
LIBER 377 / FOLIO 582
ZONED R-20

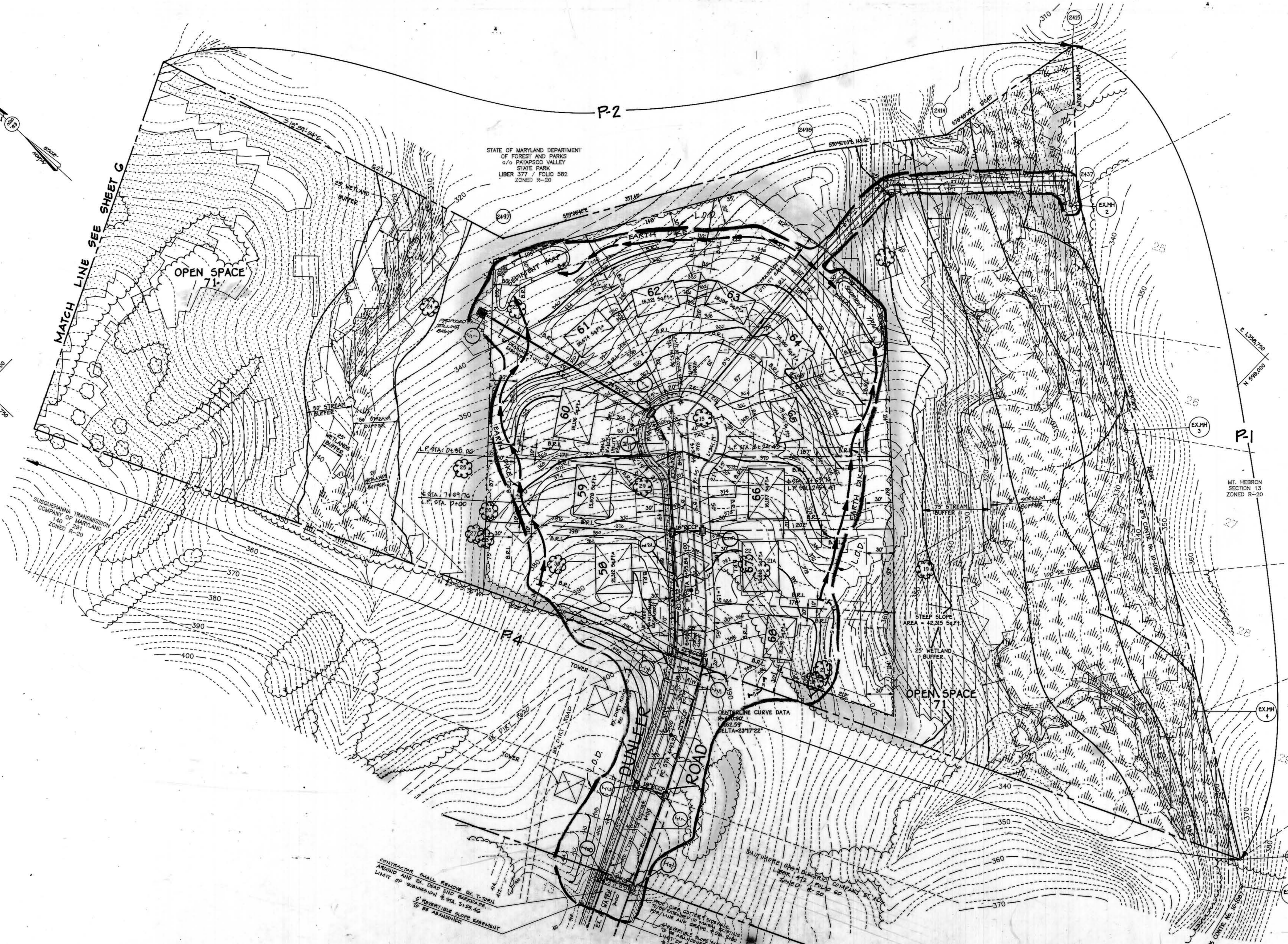

CONTRACTOR SHALL REMOVE EX. T-DRAIN AROUND AND EX. DEAD END BARBERCAFE LIMIT OF SUBMISSION E. STA. 31+99.46
S' OVERLOOKING SLOPE EASEMENT TO BE ABANDONED

CENTRAL LINE CURVE DATA
R=62.59
DELTA=23°17'22"

TENTATIVELY APPROVED
DEPT. OF PLANNING AND ZONING OF
HOWARD COUNTY

[Signature] 6/21/96
PLANNING DIRECTOR DATE

GRADING, SEDIMENT CONTROL
& LANDSCAPE PLAN
MT. HEBRON
SECTION 23
PHASES II AND III
SECOND ELECTION DISTRICT
HOWARD COUNTY, MARYLAND
DECEMBER 27, 1995
SHEET 7 OF 7

FISHER, COLLINS & CARTER, INC.
CIVIL ENGINEERS, CONSULTANTS & LAND SURVEYORS
CENTRAL SQUARE OFFICE PARK - 10772 BALTIMORE NATIONAL PIKE
ELLCOTT CITY, MARYLAND 21042
410 481-2855

OWNER AND DEVELOPER
MT. HEBRON, INC.
2106 MT. HEBRON DRIVE
ELLCOTT CITY, MARYLAND 21042

PLAN
SCALE: 1" = 50'



[Signature]
CHARLES J. CROFT, SR.
DATE: 3/18/96