

SOILS CLASSIFICATION CHART

TYPE	DESCRIPTION
CgC2	CHESTER GRAVELLY SILT LOAM, 8 TO 15 PERCENT SLOPES, MODERATELY ERODED
Cs	COMUS SILT LOAM
GIA	GLENELG LOAM, 0 TO 3 PERCENT SLOPES
GIC2	GLENELG LOAM, 8 TO 15 PERCENT SLOPES, MODERATELY ERODED
GIB2	GLENVILLE SILT LOAM, 8 TO 15 PERCENT SLOPES, MODERATELY ERODED
MgB2	MANOR GRAVELLY LOAM, 3 TO 8 PERCENT SLOPES, MODERATELY ERODED
MgC2	MANOR GRAVELLY LOAM, 8 TO 15 PERCENT SLOPES, MODERATELY ERODED
MgC3	MANOR GRAVELLY LOAM, 8 TO 15 PERCENT SLOPES, SEVERELY ERODED
MID2	MANOR LOAM, 15 TO 25 PERCENT SLOPES, MODERATELY ERODED
MID3	MANOR LOAM, 15 TO 25 PERCENT SLOPES, SEVERELY ERODED
ME	MANOR LOAM, 25 TO 45 PERCENT SLOPES

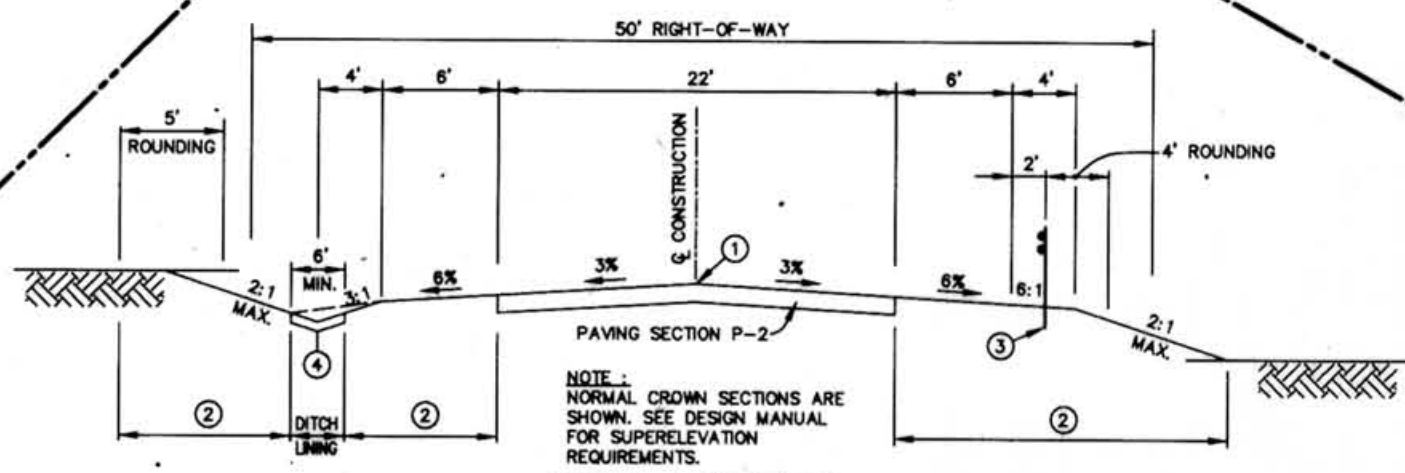

- OPEN SECTION**
- ① PROFILE GRADE LINE (PGL), SEE DESIGN MANUAL.
 - ② INDICATES 2" TOPSOIL, SEED AND MULCH.
 - ③ GUARDRAIL, WHERE REQUIRED BY THE DESIGN MANUAL.
- NOTE: NORMAL CROWN SECTIONS ARE SHOWN, SEE DESIGN MANUAL FOR SUPERELEVATION REQUIREMENTS.
- DITCH CROSS SECTION SLOPE MAY BE FLATTENED TO PROVIDE A SMALL SWALE FLOW IS SMALL, AS APPROVED BY DPW.
- ④ AT OR NEAR THE CREST OF VERTICAL CURVES WHERE QUANTITY OF SWALE FLOW IS SMALL, AS APPROVED BY DPW.
- ⑤ 20 LATCH DESIGNAL OFFSETS.

TYPICAL SECTION CUL-DE-SAC STREET

NO SCALE
FROM CL STA 24+06 TO CL STA 32+04

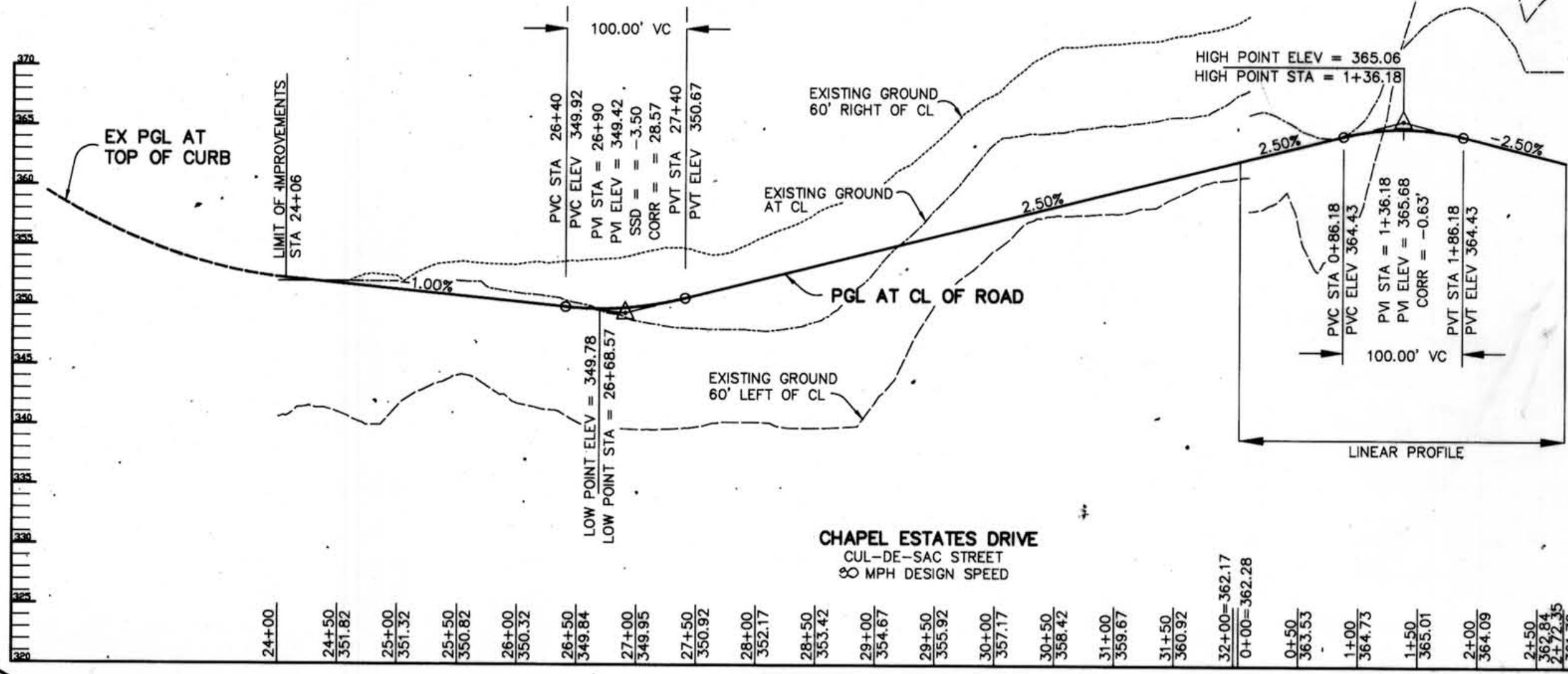

SCALE:
HOR. 1"=100'
VERT. 1"=10'

LEGEND

- 15% TO 24.9% STEEP SLOPES
- 25% AND GREATER STEEP SLOPES
- LIMIT OF DISTURBANCE

TENTATIVELY APPROVED
DEPT. OF PLANNING AND ZONING OF
HOWARD COUNTY
PLANNING DIRECTOR 8/15/95
DATE

APPROVED FOR PRIVATE WATER AND PRIVATE SEWERAGE SYSTEMS.
J. J. [Signature] 7-20-95
COUNTY HEALTH OFFICER DATE

DATE NO.	REVISION

OWNER / DEVELOPER
ERIC MIKOLASKO
c/o J.M. INC.
5570 STERRETT PLACE
SUITE 205
COLUMBIA, MARYLAND 21044

PROJECT **CHAPEL WOODS III
LOTS 28 - 36 & PARCEL A**
A RESUBDIVISION OF LOTS 7 AND 8

AREA TAX MAP NO. 29 PARCELS 86
5th ELECTION DISTRICT
HOWARD COUNTY, MARYLAND

TITLE PRELIMINARY GRADING PLAN,
DRAINAGE AREA MAP, ROAD PROFILE AND
LANDSCAPE PLAN.

RIEMER MUEGGE & ASSOCIATES, INC.
Planners • Engineers • Surveyors
8818 Centre Park Drive • Suite 200 • Columbia, Md 21045
410-997-8900 FAX: 410-997-9282

7-12-95
DATE

DESIGNED BY: C.J.R.
DRAWN BY: DAM
PROJECT NO: 28814
DATE: JULY 12, 1995
SCALE: AS SHOWN
DRAWING NO. 3 OF 3

SCHEDULE A
PERIMETER LANDSCAPE EDGE

CATEGORY	ADVANCE TO PERIMETER PROPERTIES			
	1	2	3	4
Perimeter Edge				
Landscape Type	A	A	A	A
Linear Feet of Perimeter	500	500	1500	750
Credit for Existing Vegetation	yes	yes	yes	yes
Yes to Linear Feet	550	550	1500	750
Describe below if needed				
Number of Plants Required	0 # 0	10 # 0	20 # 1	12 # 2
Shade Trees				
Evergreen Trees				
Shrubs				
Number of Plants Provided				
Shade Trees				
Evergreen Trees				
Shrubs				
Describe the plant substitution credits below if needed				

* 1 Credit for existing woods to remain in areas of wetland mitigation (F-25-C21 & WF-C27, Chapel Woods III (F-25-C22, The Forest), Separating lots 28-34 and the Preservation Parcel A.

* 2 Credit for existing woods to remain.

NOTE: This plan has been prepared in accordance with the provisions of Section 16.124 of the Howard County Code and the Landscape Manual.

PROPERTY OF MALLAN REA JR.
558/841
ZONED RC

PROPERTY OF STATE OF MARYLAND
224/440
ZONED RC

PROPERTY OF THE CHASE
LOT 48
PLAT NO. 7284
ZONED RC

PROPERTY OF CHAPEL WOODS II
LOT 17
PLAT NO. 9325
ZONED RC

FORMERLY CHAPEL WOODS II
LOT 8
PLAT NO. 9326

PROPERTY OF CHAPEL WOODS II
LOT 6
PLAT NO. 9328
ZONED RC

PROPERTY OF CHAPEL WOODS II
LOT 9
PLAT NO. 9326
ZONED RC

PROPERTY OF CHAPEL WOODS II
LOT 5
PLAT NO. 9327
ZONED RC

PROPERTY OF PATRICK L. & LOUISE D. HINSHON
L-1885 F-190
ZONED RC

HOLLY HOUSE DIVISION
P.B. 7 P. 22

Septic Areas Shown
For Record Plats
#7518 and 7519

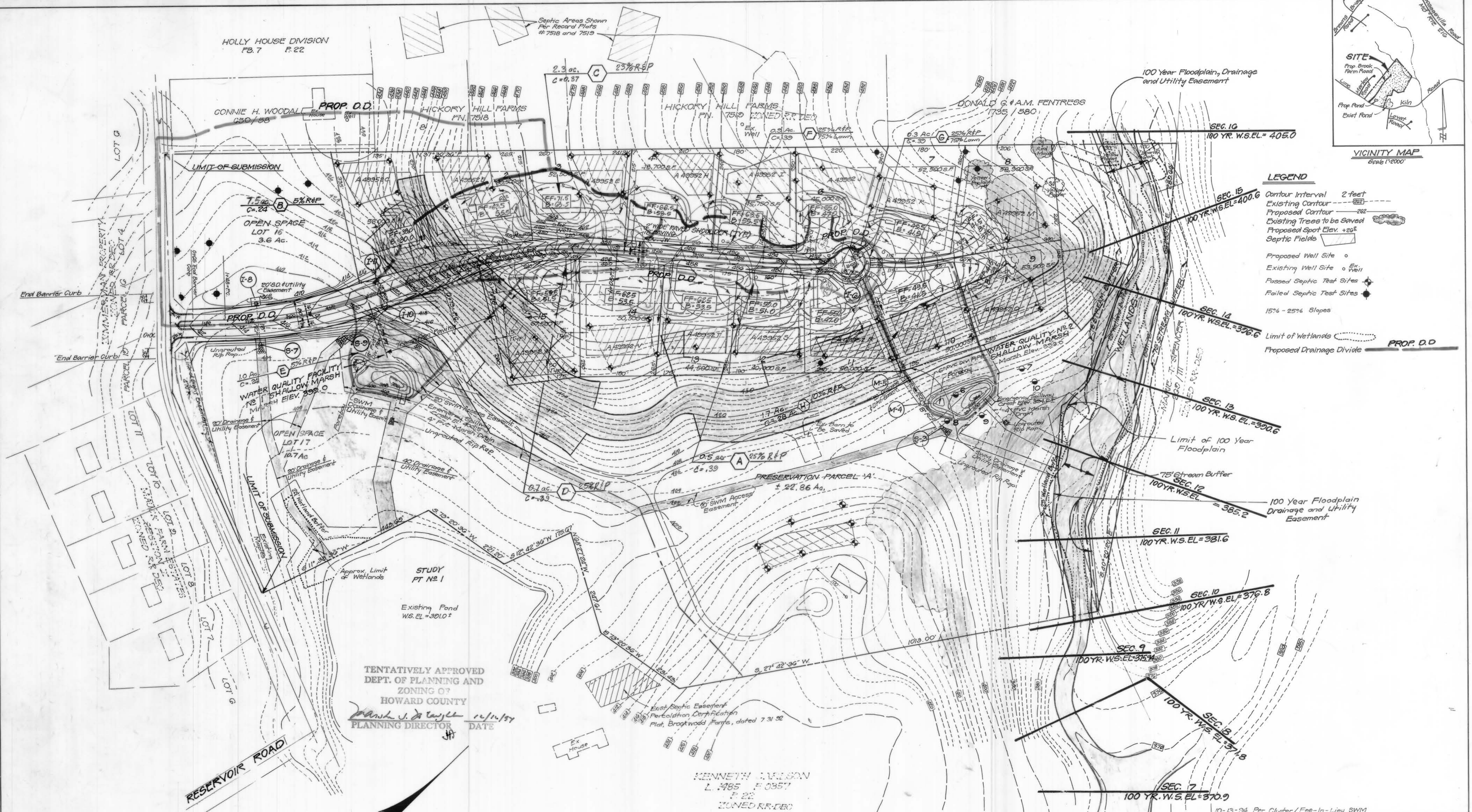
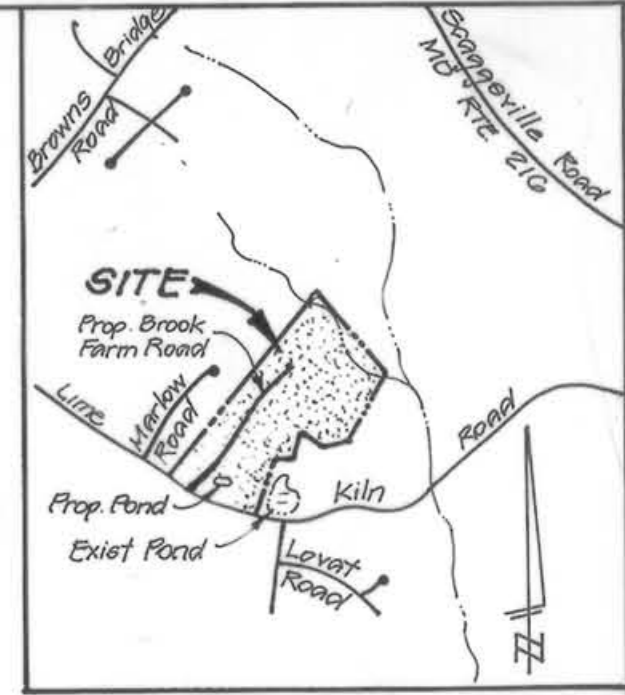

- LEGEND**
- Contour Interval 2 feet
 - Existing Contour
 - Proposed Contour
 - Existing Trees to be Saved
 - Proposed Spot Elev. +20'
 - Septic Fields
 - Proposed Well Site
 - Existing Well Site
 - Passed Septic Test Sites
 - Failed Septic Test Sites
 - 15% - 25% Slopes
 - Limit of Wetlands
 - Proposed Drainage Divide

TENTATIVELY APPROVED
DEPT. OF PLANNING AND
ZONING OF
HOWARD COUNTY
Paul J. Taylor 12/11/94
PLANNING DIRECTOR DATE

KENNETH WILSON
L. 485 P. 0357
P. 22
ZONED RR-DEO

APPROVED: FOR INDIVIDUAL SEWERAGE
AND WATER SYSTEMS
James M. ... 12/2/94
COUNTY HEALTH OFFICE Date

DESIGNED	WHT	SCALE	1"=100'
DRAWN	ZAH	DRAWING	20F2
CHECKED	WHT	JOB NO.	94-064
DATE	6/16/94	FILE NO.	94-064-P
OWNER/DEVELOPER	GARMAN ASSOCIATES C/O Bldg 122 Ellicott City, Md 21043		

