

No.	NORTH	EAST
1	532 126.39	845 482.90
2	532 082.94	845 574.97
3	531 890.40	845 604.63
4	531 825.89	845 746.56
5	531 563.95	845 639.76
6	532 786.50	845 319.04
7	531 075.00	843 713.63
8	531 459.41	845 285.83

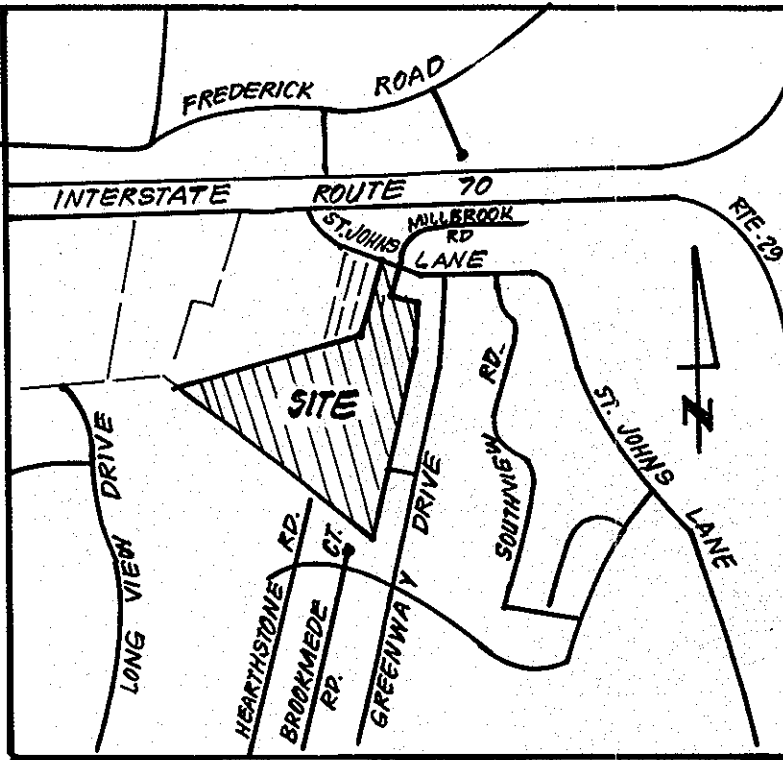

VICINITY MAP
SCALE: 1"=100'

GENERAL NOTES

1. Topography was compiled from aerial survey.
2. This site is located on Tax Map # 17, Parcel # 113.
3. Public Water & Sewer to be utilized.
4. See Soils Map #15.
5. Installation of traffic control devices shall be in accordance with the latest edition of the manual of uniform control devices.
6. Sediment & Erosion Control Measures to be provided with the submission of the Road Construction and Site Development Plans.
7. All utilities shown as existing from available plans & records.
8. Recording Reference: L. 920 F. 761.
9. For flag or pipelam lots, refuse collection, snow removal and road maintenance are provided to the junction of the flag or pipelam and road R/W line only, and not onto the flag or pipelam lot driveway.
10. Street trees shall be provided as per 16.131 of Howard County Subdivision Regulations.
11. Street lights to be provided as per 16.150.
12. All Existing Structures shall be removed.

OPEN SPACE TABULATION				
Lot Size	No. of Lots	AREA	% OPEN SPACE	OPEN SPACE REQUIRED
20,000	20	11.50 Ac.	6%	0.69
18,000	5	2.17 Ac.	10%	0.21
16,000	13	5.10 Ac.	20%	1.02
14,000	39	13.00 Ac.	30%	3.90
TOTAL:	77	31.77 Ac.		5.82

LEGEND

1. Contour Interval: 5 Ft.
2. Existing Contour: ---
3. Proposed Storm Drain: [Symbol]

SITE ANALYSIS

1. Zone: R-20
2. Tract Area: 42.48 Ac.
3. Number of Lots Proposed: 77
4. Proposed Density: 1.80 DU/Ac.
5. Open Space Proposed: 6.27 ± Ac.
6. Open Space Required: 5.82 ± Ac.
7. Right-of-Way Dedication: 4.43 ± Ac.
8. Minimum "Dry Ground Open Sp." req'd: ± 2.91 Ac.
9. Minimum "Dry Ground Open Sp." provided: ± 4.27 Ac.

UNFINALLY APPROVED ON FEB 6, 1987

OFFICE OF PLANNING AND ZONING
HOWARD COUNTY
J. Donald Harris 4-9-87
PLANNING DIRECTOR

REFERENCE: 8-87-15 ; P-87-24

<p>CLARK • FINEROCK • SACKETT, INC. ENGINEERS • PLANNERS • SURVEYORS 11315 LOCKWOOD DRIVE SILVER SPRING, MARYLAND 20904 (301) 593-3400</p>		
DESIGNED E.P.	<p>PRELIMINARY PLAN LOTS 1 THRU 79</p> <p>BOONE FARM</p> <p>2ND ELECTION DISTRICT HOWARD COUNTY MARYLAND TAX MAP NO. 17 PARCEL NO. 113</p>	SCALE 1"=100'
DRAWN KIW		DRAWING 10F1
CHECKED E.P.		JOB NO. 86-078
DATE 11-21-86	OWNER: MARY F. BLANTON 2782 ST. JOHN'S LANE ELLCOTT CITY, MD. 21043	FILE NO. 86-078-P



2-2-87 REVISED FROM 75 TO 79 LOT TOTAL
2-2-87 PER D.P.F. COMMENTS
REVISED: 1-14-86 PER D.P.F. COMMENTS