

AREA DATA

Total Area 595.8 acres
 Area of Roads 38.4 acres
 Area of Parcels 557.4 acres
 Number of Parcels 7

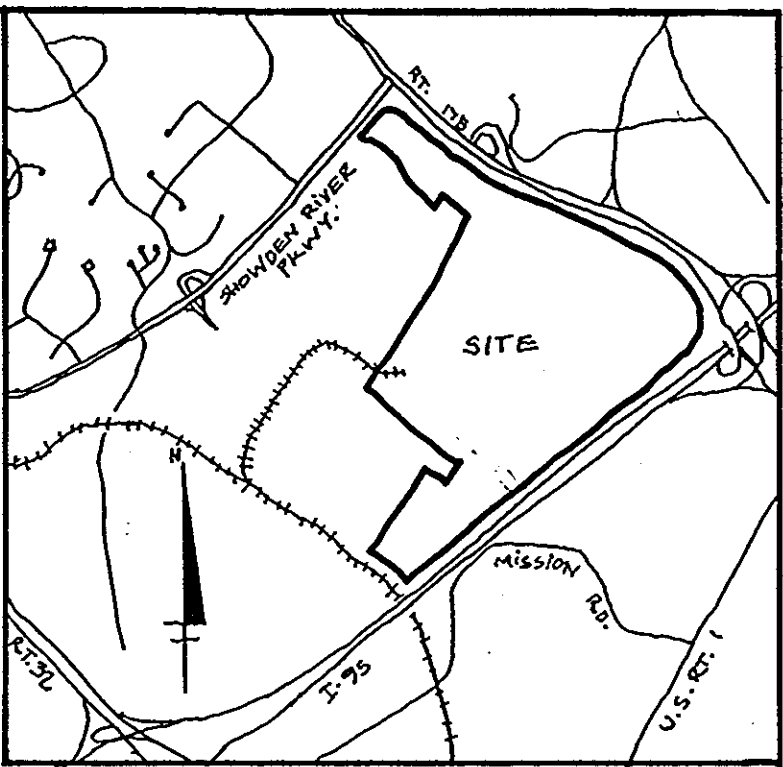

VICINITY MAP
 Scale: 1" = 3500'

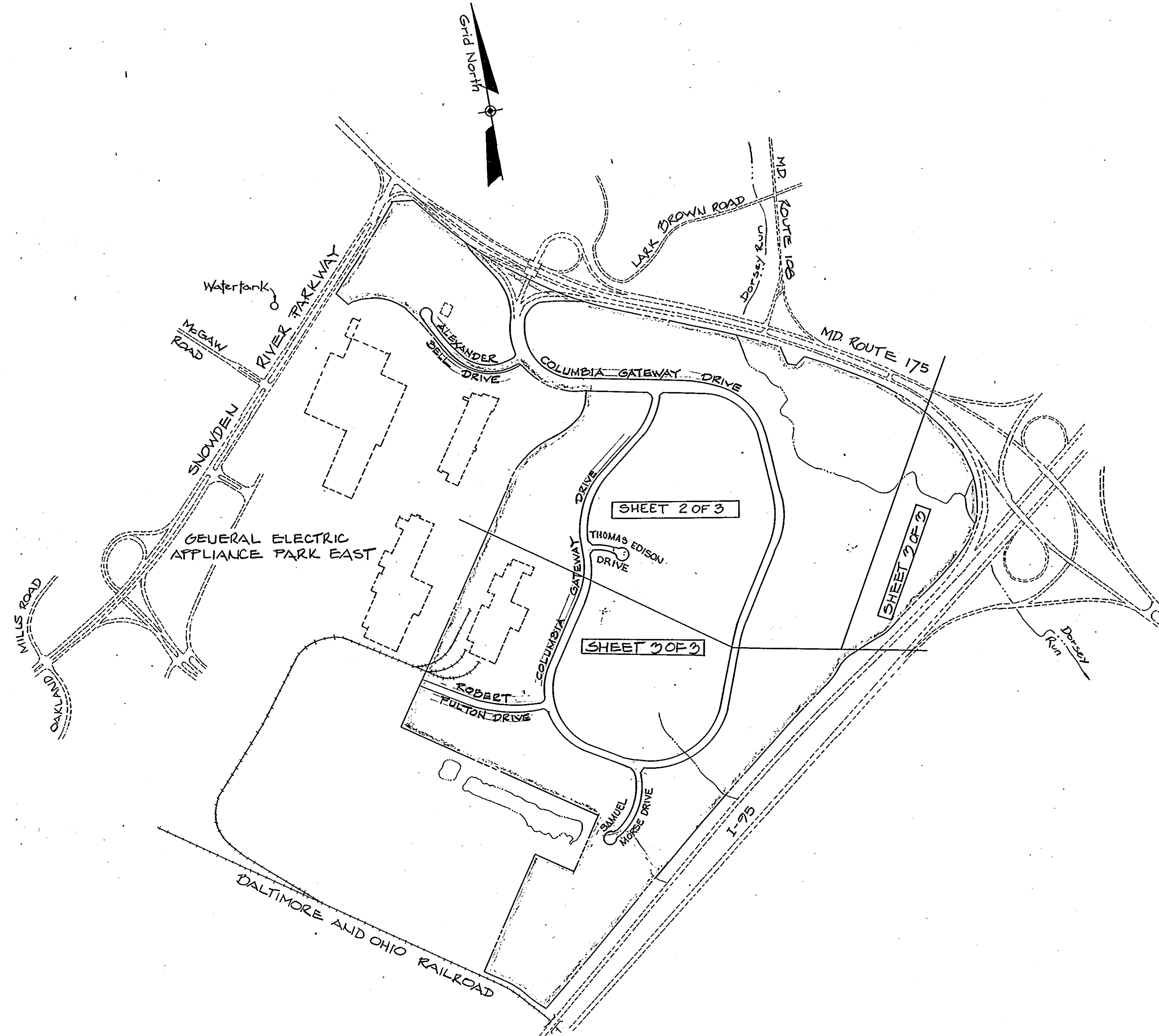

INDEX MAP
 Scale: 1" = 200'

GENERAL NOTES

1. Zoning is M-1.
2. Topography taken from aerial topo prepared for Howard County under Project C-4-0119 in 1977.
3. Public water and sewer to be utilized by extending existing 24" private water & 18" private sewer after acceptance by the Department of Public Works.
4. All street R/W's are 80' wide except as noted.
5. The lots or parcels shown on these plans are subject to the supplemental sewer in-aid-of-construction charge, created by Section 20.31 A of the Howard County Code, and the Executive Order No. 76-9.
6. Standard Symbols:
 Proposed Headwalls \square Proposed Pipes \equiv
 Proposed Inlets \square Proposed Concrete \equiv
 Proposed Manholes \circ Sidewalks \equiv
7. See Office of Planning and Zoning files, VP-85-34, VP-85-35 and S-85-28, and P-86-22.
8. Sediment control measures to be provided by subsequent Grading Plans, Final Subdivision Plans and Site Development Plans.

SPECIAL NOTES

1. The Dorsey Run 100 year flood plain is based upon a study prepared by Greenhorne & O'Mara, Inc. in 1976 and updated by Whitman, Requardt and Associates in 1985.
2. Stormwater management pond locations and storage figures are intended to satisfy the requirements for road construction only. Additional measures required for development of the parcels will be shown on future site plans.

TENTATIVELY APPROVED ON JUNE 16, 1986
 DATE
 OFFICE OF PLANNING AND ZONING OF
 HOWARD COUNTY
J. Ronald Hanning 6-27-86
 PLANNING DIRECTOR DATE

REV. NO.	DATE	DESCRIPTION
2	4/16/86	* Per 6/16/86 P-86-61 Approval
1	11/20/85	As Per D.P.W. Comments

**COLUMBIA GATEWAY
 REVISED
 PRELIMINARY PLAN**
 6th ELECTION DISTRICT
 OF HOWARD COUNTY, MARYLAND
 OWNER AND DEVELOPER
 THE HOWARD RESEARCH & DEVELOPMENT CORP.
 THE ROUSE BUILDING
 COLUMBIA, MARYLAND 21044
 SHEET 1 OF 3

TAX MAPS 36, 42 and 43
 PART OF PARCEL 587
 DATE: 4/16/86
 2/18/85
 SCALE: AS SHOWN
 P-86-61

WHITMAN, REQUARDT AND ASSOCIATES
 ENGINEERS
 2215 ST. PAUL STREET
 BALTIMORE, MARYLAND 21218
Kenneth A. McCord
 KENNETH A. McCord P.E. NO. 1974

* REVISED OUTLINE TO INCLUDE ACQUISITION OF WHEELER, ADDED THOMAS EDISON DRIVE AND CHANGED ALIGNMENT OF SAMUEL MORSE DRIVE

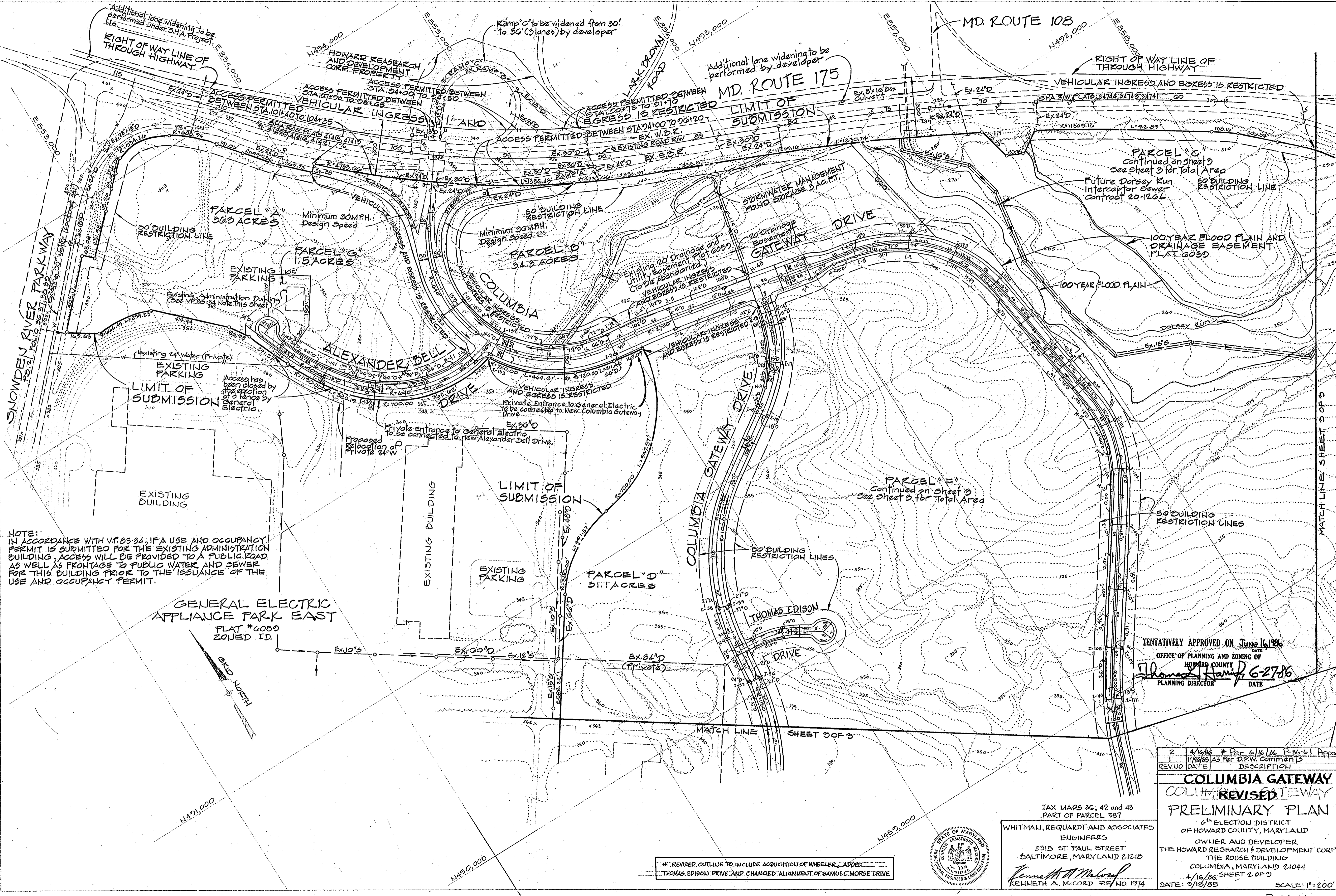

NOTE:
 IN ACCORDANCE WITH V.T. 85-34, IF A USE AND OCCUPANCY PERMIT IS SUBMITTED FOR THE EXISTING ADMINISTRATION BUILDING, ACCESS WILL BE PROVIDED TO A PUBLIC ROAD AS WELL AS FRONTAGE TO PUBLIC WATER AND SEWER FOR THIS BUILDING PRIOR TO THE ISSUANCE OF THE USE AND OCCUPANCY PERMIT.

GENERAL ELECTRIC APPLIANCE PARK EAST
 PLAT #6050
 ZONED ID.

TENTATIVELY APPROVED ON June 16, 1986
 OFFICE OF PLANNING AND ZONING OF HOWARD COUNTY
 Thomas H. Hays, PLANNING DIRECTOR
 DATE 6-27-86

2	4/1/86	* Per 6/16/86 P-86-61 Approval
1	11/24/85	AS Per D.P.W. Comments
REV. NO.	DATE	DESCRIPTION

COLUMBIA GATEWAY
REVISOR
PRELIMINARY PLAN
 6th ELECTION DISTRICT OF HOWARD COUNTY, MARYLAND
 OWNER AND DEVELOPER
 THE HOWARD RESEARCH & DEVELOPMENT CORP.
 THE ROUSE BUILDING
 COLUMBIA, MARYLAND 21044
 4/16/86 SHEET 2 OF 3
 DATE: 3/18/85 SCALE: 1"=200'

TAX MAPS 36, 42 and 43
 PART OF PARCEL 587
 WHITMAN, REQUARDT AND ASSOCIATES
 ENGINEERS
 2315 ST PAUL STREET
 BALTIMORE, MARYLAND 21218
 Kenneth A. McCord
 KENNETH A. MCCORD P.E. NO 1974

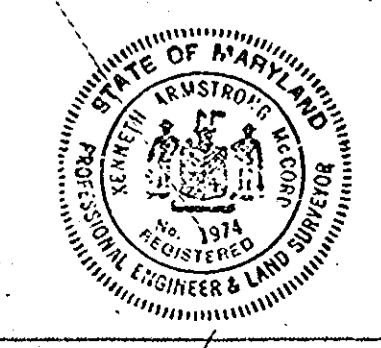

* REVISOR OUTLINE TO INCLUDE ACQUISITION OF WHEELER, ADDED THOMAS EDISON DRIVE AND CHANGED ALIGNMENT OF SAMUEL MORSE DRIVE

NOTE: IN ACCORDANCE WITH V.P. 85-34, IF A USE AND OCCUPANCY PERMIT IS SUBMITTED FOR THE EXISTING DRYER BUILDING, ACCESS WILL BE PROVIDED TO A PUBLIC ROAD AS WELL AS FRONTAGE TO PUBLIC WATER AND SEWER FOR THIS BUILDING PRIOR TO THE ISSUANCE OF THE USE AND OCCUPANCY PERMIT.

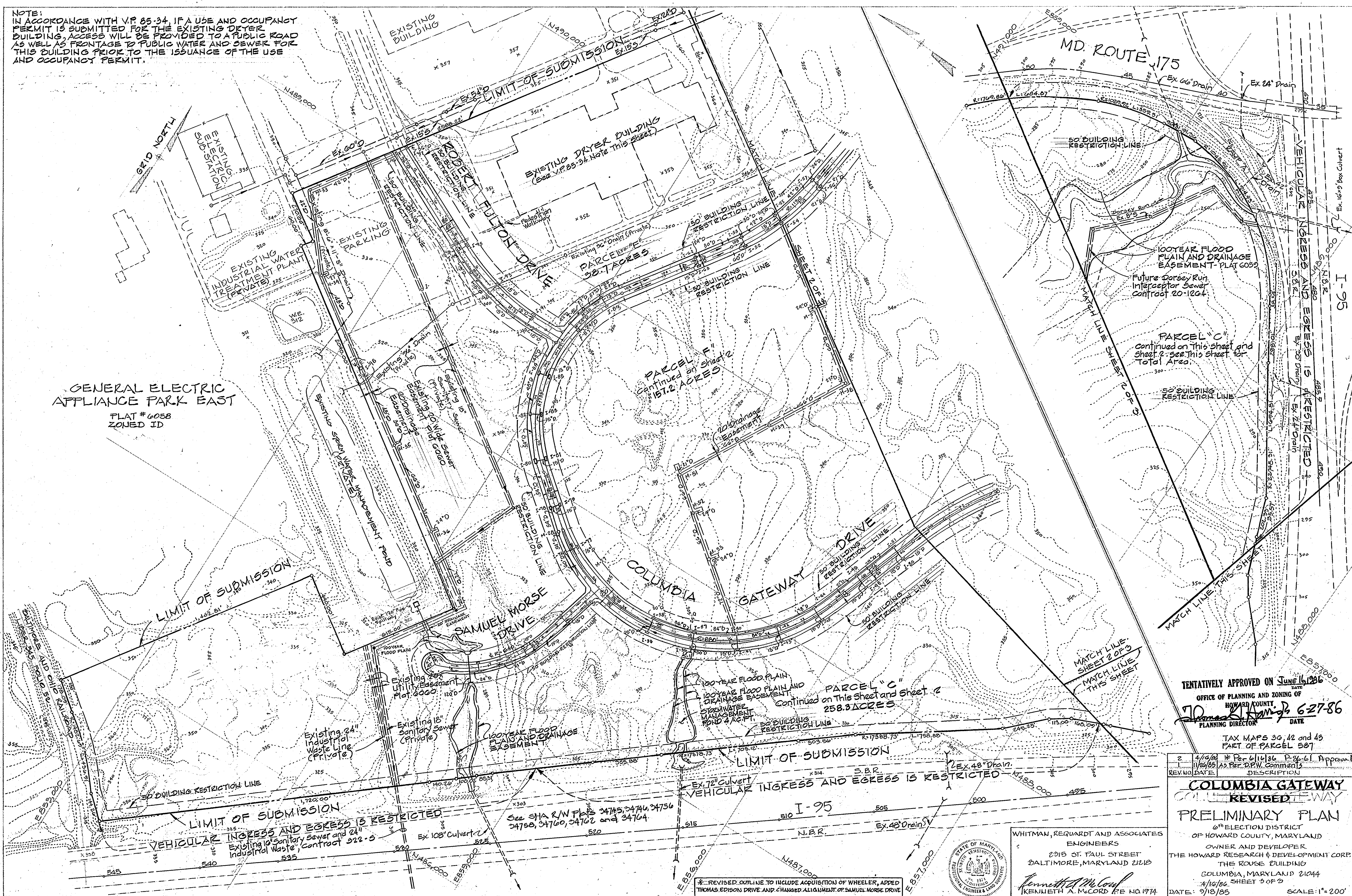

GENERAL ELECTRIC APPLIANCE PARK EAST
FLAT # 6058
ZONED ID

TENTATIVELY APPROVED ON June 16, 1986
DATE
OFFICE OF PLANNING AND ZONING OF
HOWARD COUNTY
70 *James H. Hanley* **627-86**
PLANNING DIRECTOR DATE
TAX MAPS 30, 42 and 43
PART OF PARCEL 587

2	4/16/86	* Per 6/16/86 P-86-61 Approval
1	11/26/85	As Per D.P.W. Comments
REV. NO.	DATE	DESCRIPTION

COLUMBIA GATEWAY COLLECTOR REVISION
PRELIMINARY PLAN
6th ELECTION DISTRICT
OF HOWARD COUNTY, MARYLAND
OWNER AND DEVELOPER
THE HOWARD RESEARCH & DEVELOPMENT CORP.
THE ROUSE BUILDING
COLUMBIA, MARYLAND 21044
4/16/86 SHEET 3 OF 3
DATE: 9/13/85 SCALE: 1"=200'

WHITMAN, REQUARDT AND ASSOCIATES
ENGINEERS
2015 ST. PAUL STREET
BALTIMORE, MARYLAND 21218
Kenneth A. McCord
KENNETH A. MCCORD P.E. NO. 1974

* REVISED OUTLINE TO INCLUDE ACQUISITION OF WHEELER, ADDED THOMAS EDISON DRIVE AND CHANGED ALIGNMENT OF SAMUEL MORSE DRIVE