

INTERSTATE - 70
(B.R.C. R/W PLAT NO. A1600)

TO BALTIMORE

RD 7

VICINITY MAP
SCALE 1" = 100'

GENERAL NOTES

1. TAX MAP - 19 ; BLOCK - 11 ; PARCEL - 14
2. DEED REFERENCE - 1001, 1476
3. EXISTING ZONING - R
4. PRIVATE WATER AND PRIVATE SEWERAGE TO BE UTILIZED
5. MINIMUM LOT SIZE - 3 ACRES
6. TOTAL NO. OF LOTS - 9
7. TOTAL AREA OF LOTS - 36.00 AC.
8. TOTAL AREA OF ROAD DEDICATION - 0.50 AC.
9. TOTAL AREA OF SITE - 36.50 AC.
10. SEDIMENT CONTROL MEASURES TO BE PROVIDED ON FINAL ROAD CONSTRUCTION PLANS.
11. VERTICAL CURVA BASED ON HOWARD COUNTY 1" = 20'
12. BOUNDARY SHOWN HEREON IS BASED ON THE MARYLAND STATE PLANE COORDINATE SYSTEM.

THE LOTS SHOWN HEREON COMPLY WITH THE MINIMUM OWNERSHIP WIDTH AND LOTS REQUIRED BY THE MARYLAND STATE DEPARTMENT OF HEALTH AND MENTAL HYGIENE. THIS AREA DESIGNATES A PRIVATE SEWERAGE BASINMENT OF 10,000 SQUARE FEET AS REQUIRED BY THE MARYLAND STATE DEPARTMENT OF HEALTH AND MENTAL HYGIENE FOR INDIVIDUAL SEWAGE DISPOSAL. IMPROVEMENTS OF ANY NATURE IN THIS AREA ARE RESTRICTED UNTIL PUBLIC SEWERAGE IS AVAILABLE. THESE IMPROVEMENTS SHALL BECOME NULL AND VOID UPON CONNECTION TO A PUBLIC SEWERAGE SYSTEM. THE COUNTY HEALTH OFFICER SHALL HAVE THE AUTHORITY TO GRANT VARIANCES FOR ENCROACHMENTS INTO THE PRIVATE SEWERAGE BASINMENT. A MODIFIED SEWERAGE BASINMENT SHALL NOT BE NECESSARY. ALL PERCOLATION TEST HOLES SHOWN HEREON HAVE BEEN FIELD LOCATED AND SHOWN HEREON (0)

PERCOLATION TEST DATA

LOT NO.	AVERAGE PER TIME IN MIN FOR 2 INCH	MAX. DEPTH PERMITTED FOR EFFLUENT PIPS TO FALTER SEWERAGE DISPOSAL AREA AT ITS HIGHEST ELEV. WITH REF. TO EX. GRADE AT TIME OF TEST
1	3 MIN.	4'
2	4 "	4'
3	3 "	3'
4	3 "	4'
5	4 "	4'
6	3 "	4'
7	3 "	3'
8	4 "	4'
9	18 "	5'

APPROVED: FOR PRIVATE WATER AND PRIVATE SEWERAGE SYSTEMS, HOWARD COUNTY HEALTH DEPARTMENT
James H. Smith 3-3-86
 HOWARD COUNTY HEALTH OFFICER DATE

TENTATIVELY APPROVED ON Mar 13, 1986
 OFFICE OF PLANNING AND ZONING OF
 HOWARD COUNTY
James H. Smith 4-18-86
 PLANNING DIRECTOR DATE

OWNER & DEVELOPER
 BROOKS LEE FAMILY PROPERTY, INC.
 13896 GEORGIA AVENUE
 WHEATON, MARYLAND 20906
 TEL: 305-7000

boender associates
 inc.
 consulting engineers
 land surveyors
 land planners



TITLE: PRELIMINARY PLAN	
PROJECT: CLOVER HILL	
LOCATION: 7 1/2 AC. PAR. 15	ORCEL: 14, 1, 2, 3, 4, 5, 6, 7, 8, 9, 10, 11, 12, 13, 14, 15, 16, 17, 18, 19, 20
3 RD. ELECTION DISTRICT	HOWARD CO., MD.
SCALE: 1" = 100'	DESIGNED BY: D.R.
DRAWN BY: D.R.	CHECKED BY: D.R.
DATE: OCTOBER, 1985	
FIELD BOOK: 05288	PAGE NO.: 1 OF 1

COURTHOUSE SQUARE
 3566 ELLICOTT MILLS DRIVE
 ELLICOTT CITY, MD. 21043
 (301) 465-7777

CURVE DATA

CLOVER HILL COURT STA 0+00 TO STA 1+40
 R = 125', L = 140', T = 78.51'

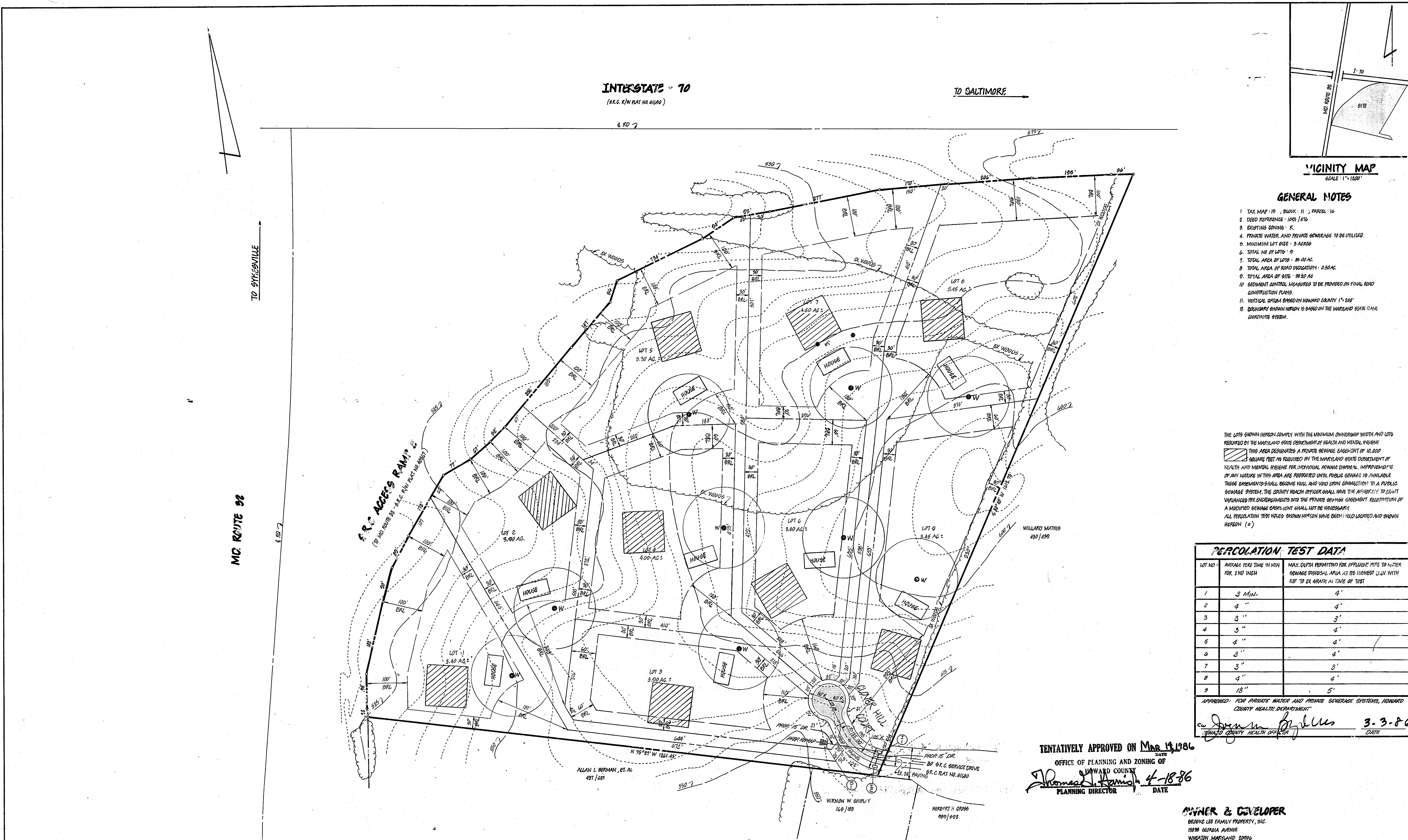

TO SYKESVILLE

MC ROUTE 92