

LOT SIZE AND MANDATORY OPEN SPACE DATA				
LOT SIZE	NO. OF LOTS	AREA OF LOTS	MANDATORY OPEN SPACE	AREA OF OPEN SPACE
20,000 OR GREATER	8	3,871 Ac.±	6%	0.232 Ac.±
18,000 - 19,999	3	1,263 Ac.±	10%	0.126 Ac.±
16,000 - 17,999	15	5,826 Ac.±	20%	1.165 Ac.±
14,000 - 15,999	28	9,404 Ac.±	30%	2.821 Ac.±
TOTAL	54	20,364 Ac.±	---	4.344 Ac.±

DENSITY TABULATION:									
OPEN SPACE REQUIRED	OPEN SPACE PROVIDED	GROSS AREA	FLOOD PLAIN STEEP SLOPES	NET AREA	NO. OF DWELLING UNITS ALLOWED	FLOOD PLAIN LOT ADJUSTMENT	TOTAL NO. OF DWELLING UNITS ALLOWED	TOTAL NO. OF DWELLING UNITS PROPOSED	DENSITY PER ACRE
4.34 AC.±	6.86 AC.±	23,85 AC.±	1.25 AC.±	28.70 AC.±	63.0	--	63.0	54.0	1.88

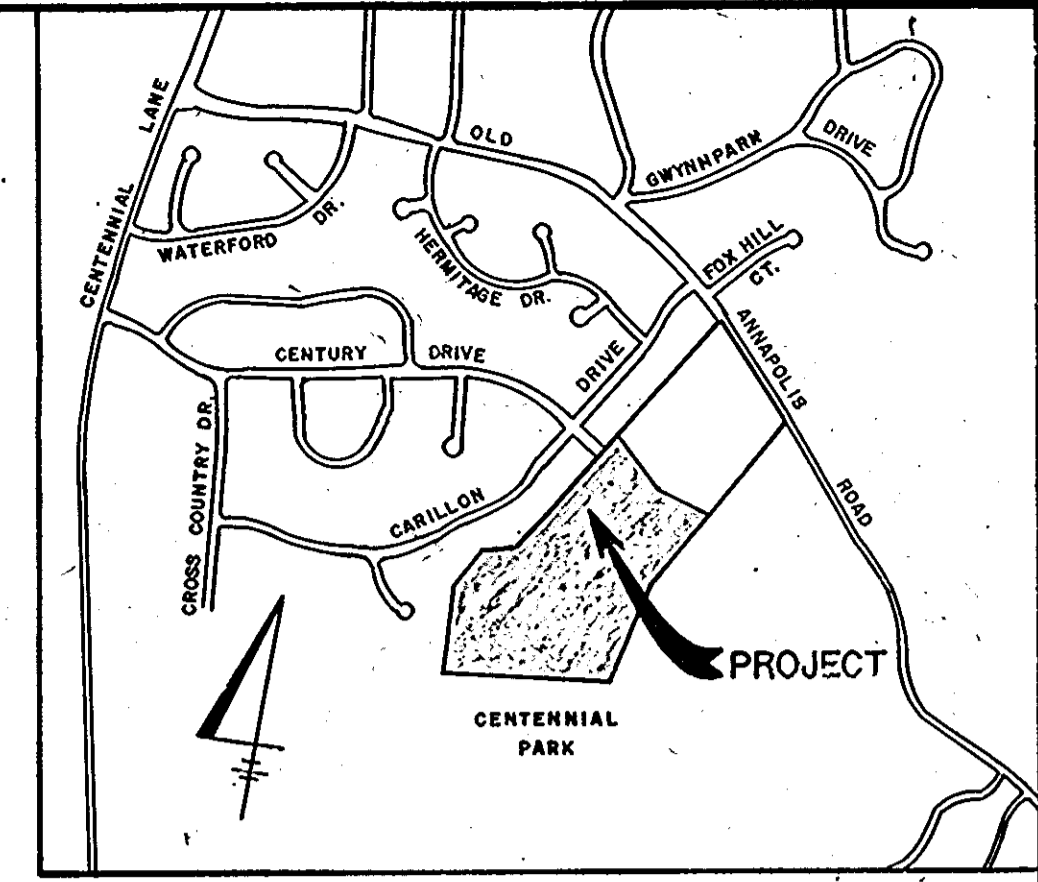

VICINITY MAP  
SCALE: 1"=1200'

COORDINATE TABLE:		
NO.	NORTH	EAST
1	516297.02	840801.71
2	516182.87	840958.83
3	515857.39	841296.59
4	515457.55	840977.78
5	514827.06	840694.33
6	514890.10	839690.30
7	515066.61	839705.23
8	515311.58	839723.27
9	515539.76	839898.30
10	515555.88	840130.74
11	516075.10	840598.93
12	516038.12	841137.57

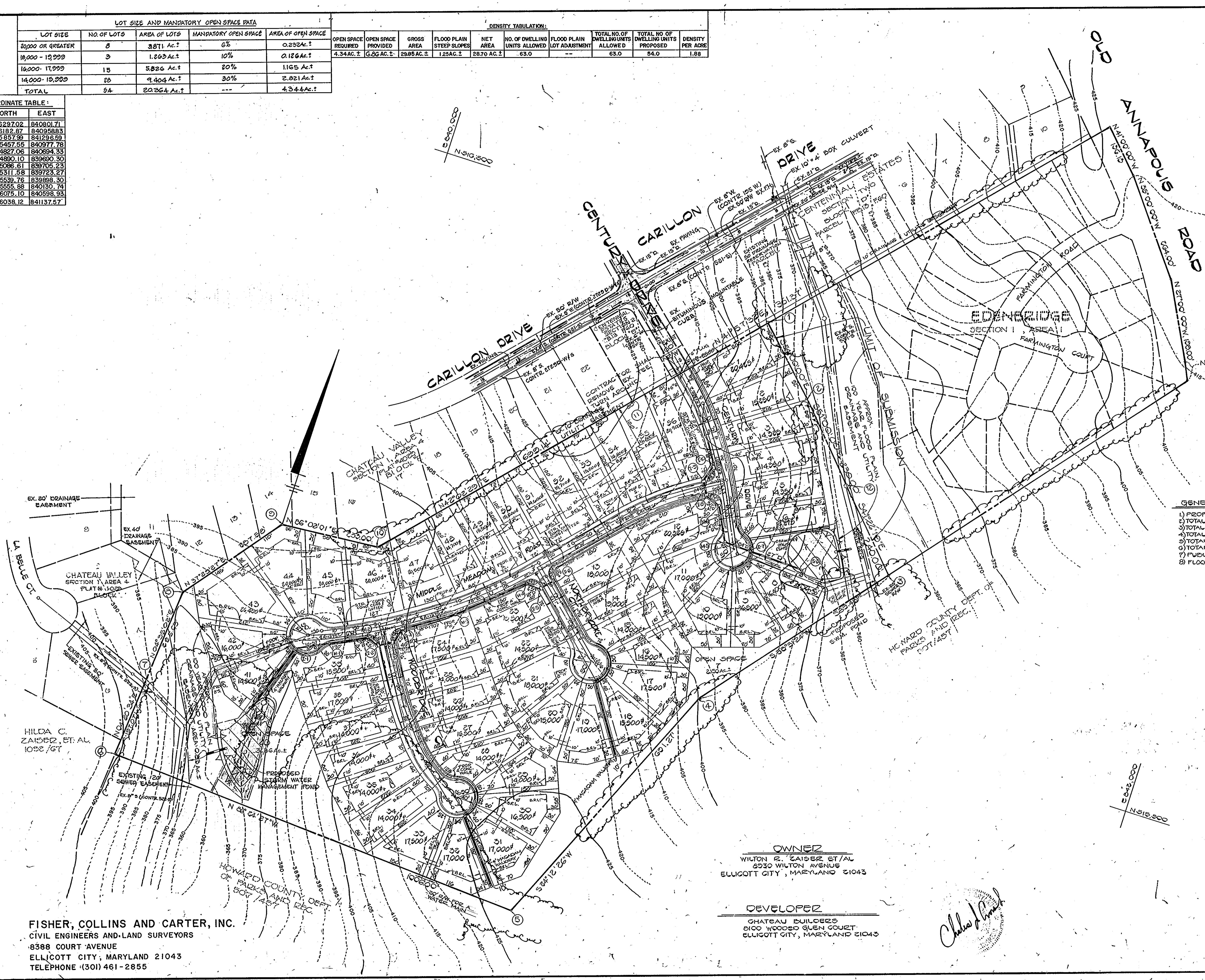

- GENERAL NOTES:
- 1) PROPERTY ZONING - R-20
  - 2) TOTAL AREA OF LOTS - 20.36 AC.
  - 3) TOTAL AREA OF ROADS - 3.73 AC.
  - 4) TOTAL AREA OF OPEN SPACE - 3.86 AC.
  - 5) TOTAL AREA OF PROPERTY - 23.95 AC.
  - 6) TOTAL NUMBER OF BUILDABLE LOTS - 54
  - 7) PUBLIC WATER AND SEWER SYSTEMS WILL BE USED.
  - 8) FLOOD PLAIN DELINEATION BASED UPON EDENBRIDGE SEC. I AREA 1 (P2023)

TEMPORARILY APPROVED ON SEPT. 27, 1985  
 OFFICE OF PLANNING AND ZONING OF  
 HOWARD COUNTY  
*John A. Hamling* 10-7-85  
 PLANNING DIRECTOR DATE

FISHER, COLLINS AND CARTER, INC.  
 CIVIL ENGINEERS AND LAND SURVEYORS  
 8388 COURT AVENUE  
 ELLICOTT CITY, MARYLAND 21043  
 TELEPHONE (301) 461-2855

OWNER  
 WILTON R. ZAISEZ ET AL  
 8930 WILTON AVENUE  
 ELLICOTT CITY, MARYLAND 21043

DEVELOPER  
 CHATEAU BUILDERS  
 810 WOODS GLEN COURT  
 ELLICOTT CITY, MARYLAND 21043

*Charles J. ...*

PRELIMINARY PLAN  
 EDENBRIDGE  
 SECTION I AREA 2  
 TAX MAP # 30 PART OF PARCEL 213  
 2ND ELECTION DISTRICT HOWARD COUNTY, MARYLAND  
 SCALE: 1"=100' JULY 24, 1985  
 S85 49