

**GENERAL NOTES**

1. TOPOGRAPHY SHOWN HEREON IS FROM AERIAL MAPS FLOWN IN 1965 AND PREPARED BY MAPS, INC.
2. ALL DIMENSIONS SHOWN ARE APPROXIMATE DIMENSIONS.
3. ALL COORDINATES SHALL BE BASED ON THE MARYLAND STATE GRID SYSTEM.
4. ALL ELEVATIONS SHOWN ARE BASED ON U.S.C. AND G.S. MEAN SEA LEVEL DATUM 1929.
5. THE FLOOD PLAIN SHOWN WAS TAKEN FROM MAPS PREPARED BY CENTURY ENGINEERING OF THE LITTLE PATUXENT RIVER - HYDROLOGY MODEL 100 YEAR FLOOD STUDY DATED 1978.
6. S.W.M. FOR THIS SUBDIVISION WILL BE PROVIDED BY A CENTRAL FACILITY CREATED BY THE GOV AND 96" COLVERTS AS SHOWN ON PLAN, IN ACCORDANCE WITH AN AGREEMENT EXECUTED WITH HOWARD COUNTY IN NOV. 1979 IN CONJUNCTION WITH THE COLUMBIA MALL EXPANSION (SDP 80-01).

**NOTE:**  
 ULTIMATE CONSTRUCTION WILL INCLUDE SIDEWALK FROM HICKORY RIDGE ROAD TO LITTLE PATUXENT PARKWAY, BOTH SIDES, TEMPORARY PATHWAY WILL BE SUBSTITUTED DURING INITIAL CONSTRUCTION.

**SITE ANALYSIS**

1. ZONING - NEW TOWN
2. TOTAL ACREAGE : 7.3 ACRES
3. TOTAL LOTS & PARCELS : 11
4. TOTAL NUMBER OF PARCELS : 1
5. TOTAL ROADWAY AREA : 7.2 ACRES

TABULATION OF NEW TOWN LAND USE	
LAND USE	ACRES
COMMERCIAL	7.3
ROADWAY 7.3	7.3
TOTAL AREA	7.3

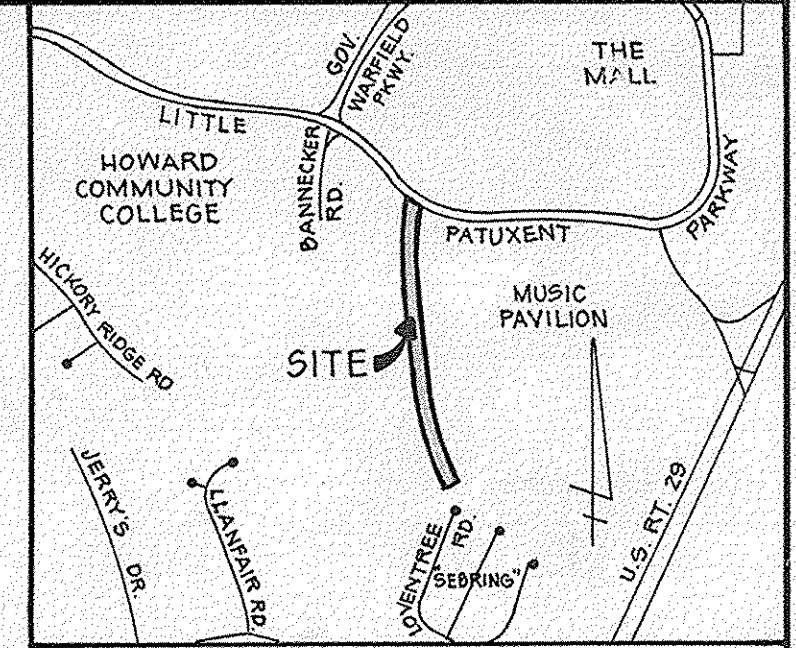

**VICINITY MAP**  
 SCALE : 1" = 2000'

TOWN CENTER  
 SECTION 2 AREA 2  
 THE HOWARD RESEARCH & DEVELOPMENT CORP.  
 LIBER 463 FOLIO 196  
 ZONED NEW TOWN - COMMERCIAL

**NOTE:**  
 FOR 100 YEAR FLOOD PLAIN ELEVATIONS  
 SEE STORM WATER MANAGEMENT REPORT  
 FOR TOWN CENTER & VILLAGE OF HICKORY RIDGE  
 PREPARED BY CENTURY ENGINEERING, INC., 1985.

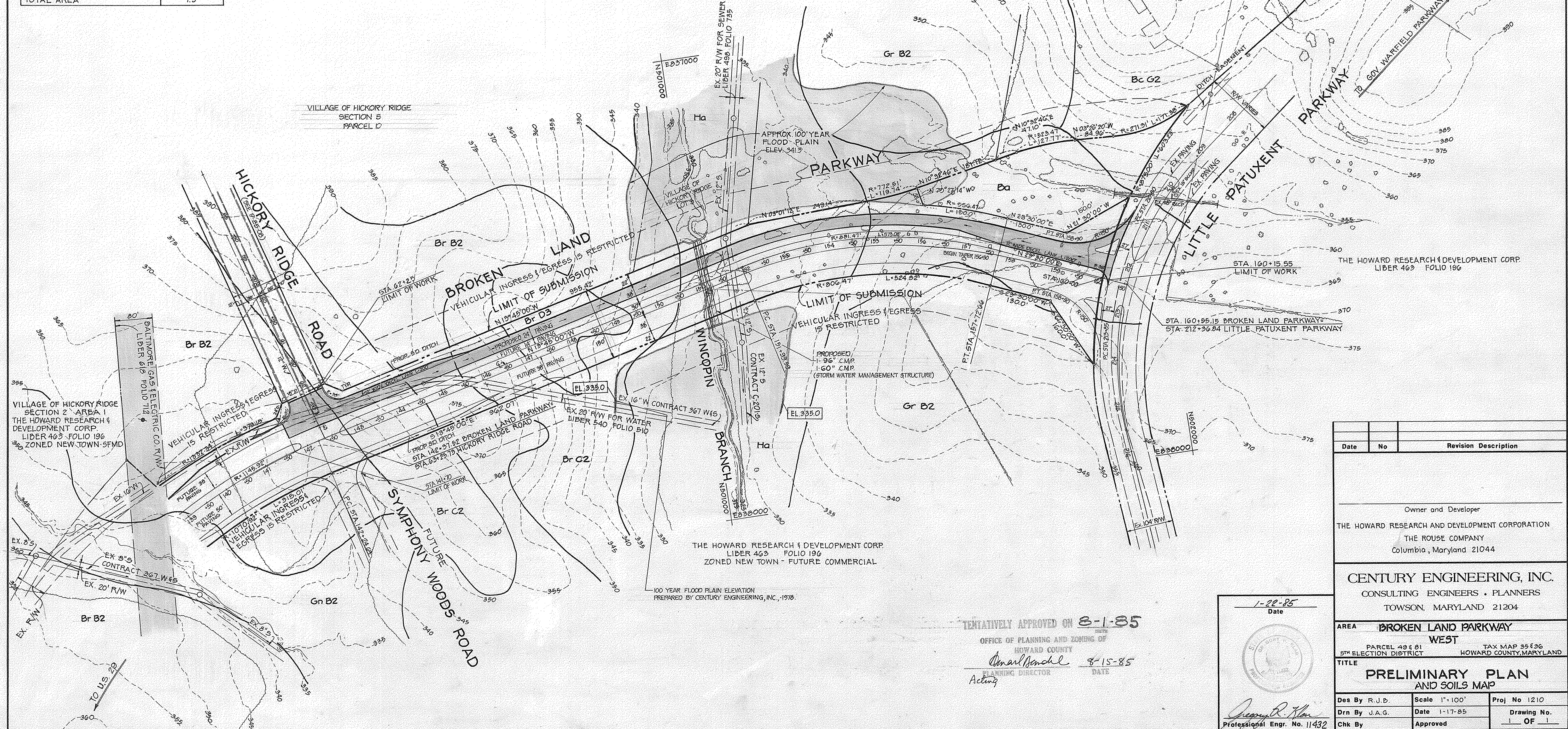

Date	No	Revision Description
Owner and Developer THE HOWARD RESEARCH AND DEVELOPMENT CORPORATION THE ROUSE COMPANY Columbia, Maryland 21044		
CENTURY ENGINEERING, INC. CONSULTING ENGINEERS • PLANNERS TOWSON, MARYLAND 21204		
AREA <b>BROKEN LAND PARKWAY WEST</b> PARCEL 48 & 81 TAX MAP 35 & 36 5TH ELECTION DISTRICT HOWARD COUNTY, MARYLAND		
TITLE <b>PRELIMINARY PLAN AND SOILS MAP</b>		
Des By R.J.B.	Scale 1" = 100'	Proj No 1210
Drn By J.A.G.	Date 1-17-85	Drawing No.
Chk By	Approved	1 OF 1

TEMPORARILY APPROVED ON **8-1-85**  
 OFFICE OF PLANNING AND ZONING OF  
 HOWARD COUNTY  
*Donald Benschel* 8-15-85  
 PLANNING DIRECTOR DATE

