

**GENERAL NOTES**

1. TOPOGRAPHY SHOWN HEREON IS FROM AERIAL MAPS FLOWN IN 1965 AND PREPARED BY MAPS, INC.
2. WATER AND SEWER SERVICES SHALL BE PROVIDED BY PUBLIC SYSTEMS.
3. ALL DIMENSIONS SHOWN ARE APPROXIMATE DIMENSIONS.
4. THE 100 YR. FLOOD PLAIN IS INCLUDED IN TABULATION OF OPEN SPACE.
5. ALL COORDINATES SHALL BE BASED ON THE MARYLAND STATE GRID SYSTEM.
6. MINIMUM BUILDING SETBACK RESTRICTIONS FROM PROPERTY LINES AND RIGHT-OF-WAY OF ANY PUBLIC WILL BE IN ACCORDANCE WITH THE FINAL DEVELOPMENT PLAN CRITERIA PHASE 190 WITHIN THE NEW TOWN DISTRICT.
7. ALL ELEVATIONS SHOWN ARE BASED ON U.S.C. AND G.S. MEAN SEA LEVEL DATUM 1929.
8. THE FLOOD PLAIN SHOWN WAS TAKEN FROM MAPS PREPARED BY CENTURY ENGINEERING OF THE LITTLE PATUXENT RIVER - HYDROLOGY MODEL 100 YEAR FLOOD STUDY DATED 1978.
9. SWM FOR THIS SUBDIVISION WILL BE PROVIDED BY A CENTRAL FACILITY ON THE WINGOPIN BRANCH (LOT 3) IN ACCORDANCE WITH AN AGREEMENT EXECUTED WITH HOWARD COUNTY IN NOV. 1979 IN CONJUNCTION WITH THE COLUMBIA MALL EXPANSION (SDP 80-01).

**SITE ANALYSIS**

1. ZONING: NEW TOWN
2. TOTAL ACREAGE: 67.8 ACRES
3. TOTAL LOTS & PARCELS: 5
4. TOTAL NUMBER OF PARCELS: 2
5. TOTAL OPEN SPACE LOTS: 3
6. TOTAL ROADWAY AREA: 5.1 ACRES

TABULATION OF NEW TOWN LAND USE	
LAND USE	ACRES
APARTMENTS	39.3
COMMERCIAL	5.1
ROADWAY	5.1
OPEN SPACE	23.4
TOTAL AREA	67.8

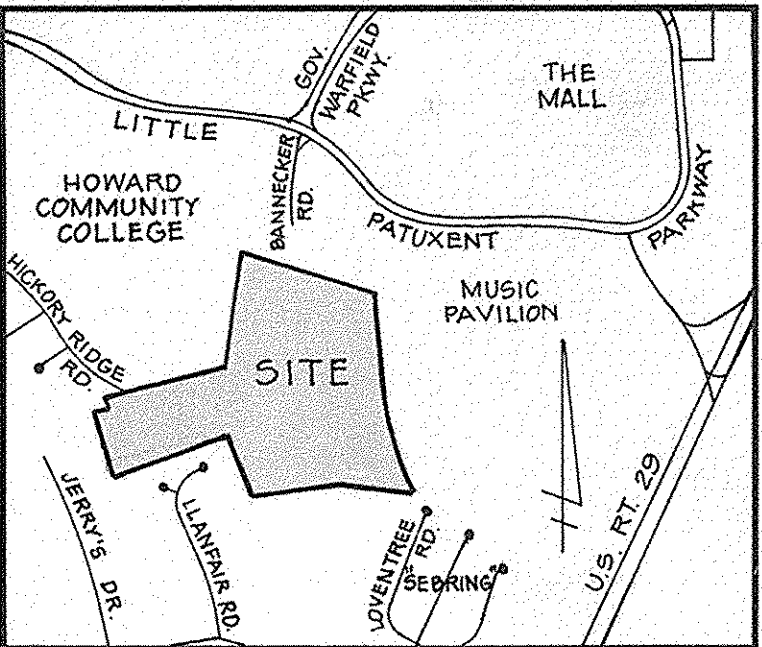

**VICINITY MAP**  
SCALE: 1"=2000'

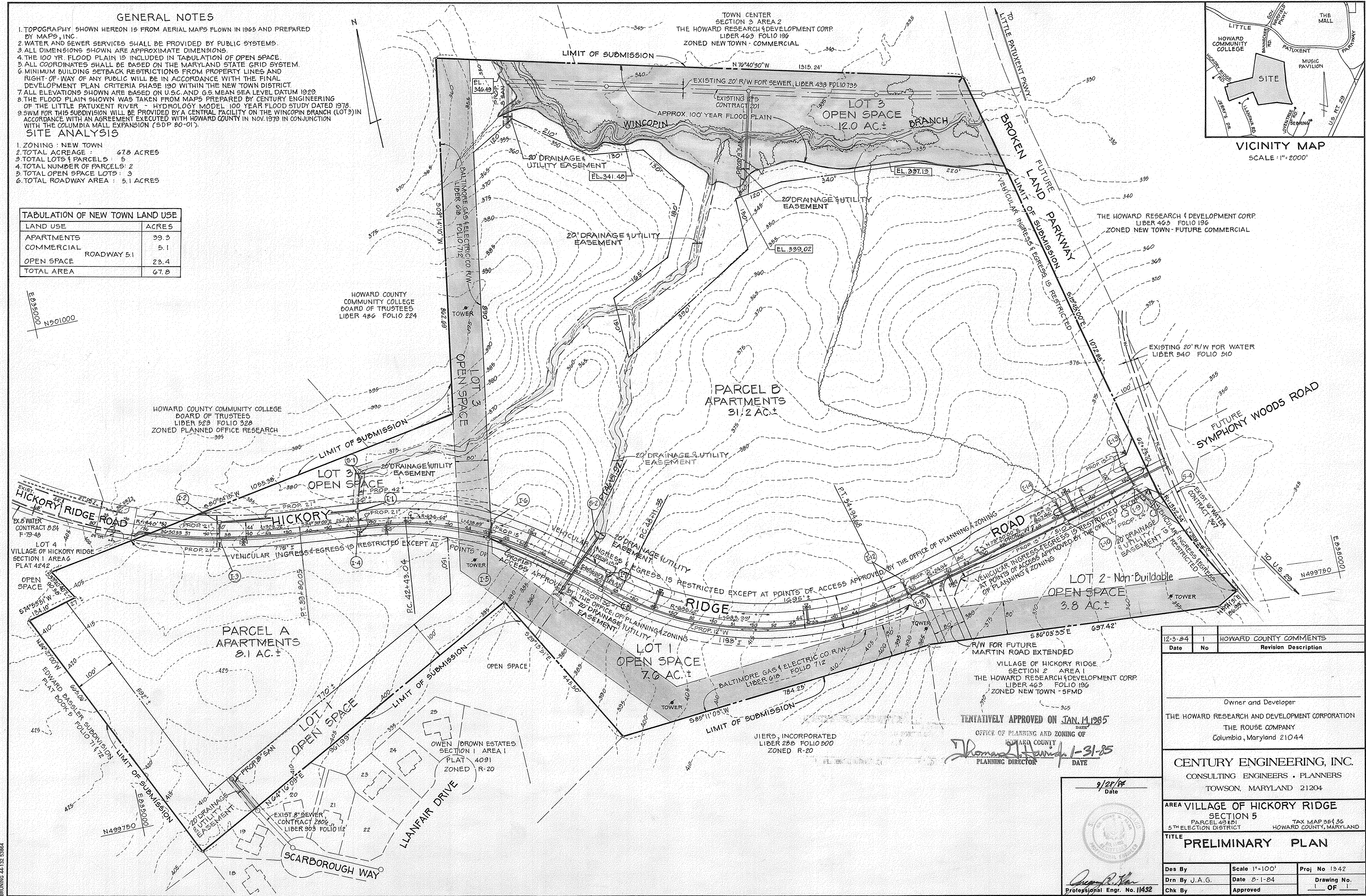

Date	No	HOWARD COUNTY COMMENTS
		Revision Description

Owner and Developer  
 THE HOWARD RESEARCH AND DEVELOPMENT CORPORATION  
 THE ROUSE COMPANY  
 Columbia, Maryland 21044

**CENTURY ENGINEERING, INC.**  
 CONSULTING ENGINEERS - PLANNERS  
 TOWSON, MARYLAND 21204

AREA VILLAGE OF HICKORY RIDGE  
 SECTION 5  
 PARCEL 49 & 21 TAX MAP 351 36  
 5TH ELECTION DISTRICT HOWARD COUNTY, MARYLAND

**TITLE PRELIMINARY PLAN**

Des By	Scale 1"=100'	Proj No 1342
Drn By J.A.G.	Date 8-1-84	Drawing No
Chk By	Approved	1 OF 1

TENTATIVELY APPROVED ON JAN. 14, 1985  
 OFFICE OF PLANNING AND ZONING OF  
 HOWARD COUNTY  
 Planning Director  
 DATE 1-31-85

9/25/84  
 Date  
 Professional Engr. No. 11432