

COORDINATE TABLE		
No.	NORTH	EAST
1	499 047.76	848 037.62
2	497 796.18	848 423.07
3	497 103.58	849 978.42
4	496 684.54	849 878.72
5	496 634.84	849 878.72
6	496 116.83	847 307.02
7	495 082.00	847 894.00
8	497 635.00	847 978.00
9	497 528.00	848 183.00
10	497 454.00	848 172.00
11	497 388.00	848 127.00
12	497 350.00	848 086.39
13	497 310.00	848 103.39
14	497 272.00	848 103.39
15	497 232.00	848 842.93
16	497 192.00	848 842.93
17	497 152.00	848 842.93
18	497 112.00	848 651.99
19	496 980.26	848 549.42
20	496 890.26	848 342.42
21	496 870.70	848 264.40
22	496 843.79	848 083.62
23	496 803.82	847 930.72
24	496 605.00	848 225.00
25	496 500.00	848 290.00
26	496 335.00	848 530.00
27	496 405.00	848 570.00
28	496 378.00	848 848.00
29	496 400.00	848 850.00
30	496 535.00	849 288.00
31	496 640.00	849 288.00
32	496 818.00	849 542.00
33	496 878.00	849 682.00
34	496 800.72	849 848.53
35	496 769.15	849 042.95
36	496 706.41	848 230.92
37	497 325.00	848 349.39
38	497 278.00	848 573.39
39	497 278.00	848 792.39
40	497 224.00	848 813.39
41	497 158.00	848 819.39
42	497 103.39	848 807.99

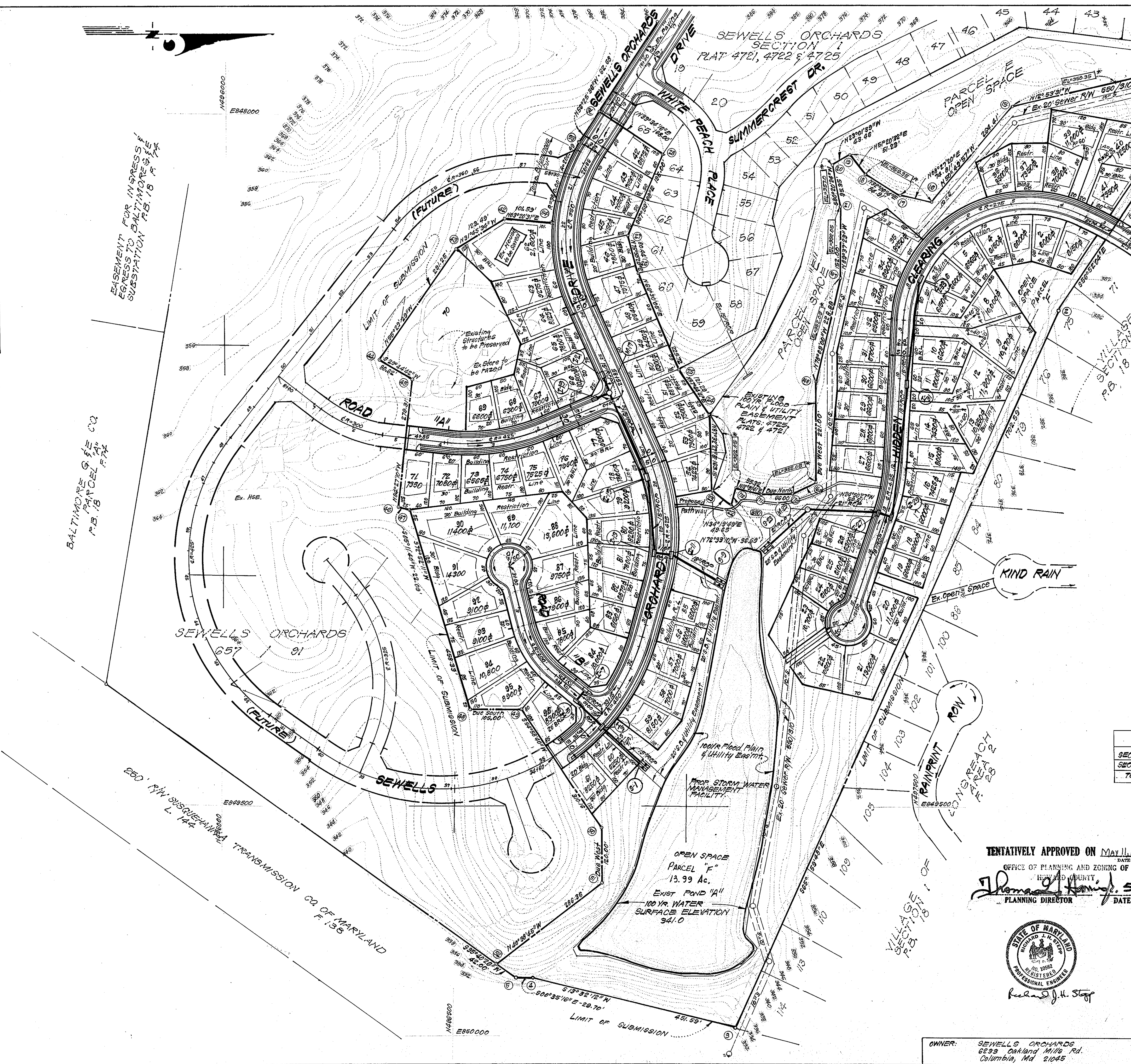

**GENERAL NOTES**

1. Topography was compiled from Aerial surveys
2. The area included in this submission is located on Tax Map #38 Parcel #27.
3. Installation of Traffic Control Devices shall be in accordance with the latest edition of the Manual of Uniform Control Devices.
4. Public Water and Sewer to be utilized.
5. Sediment and Erosion Control Measures to be provided with the submission of Rd. Const. and Site Development Plan.
6. All Public Utilities shown as existing were compiled from available records.
7. See Soils Map # 25
8. For flag or pipe stem lots, refuse collection, snow removal and road maintenance are provided to the junction of the flag or pipe stem lot drive way.
9. See Office of Planning & Zoning File 8-78-11, P-80-08, F-81-05, F-81-34 and 47-82-05.
10. Coordinates shown hereon are in the Maryland State Plane Coordinate System and are based on Howard County Control Station "Sewells".

**SITE ANALYSIS:**

1. Zoning: RSC
2. No. of Lots: 97
3. Area Tabulation: See Table
4. Density: Section 1 = 3.32, Section 2 = 2.59 TOTAL = 3.00

	AREA (TOTAL)	ROADWAY DEDICATION	OPEN SPACE PROVIDED	OPEN SPACE WITHIN FLOOD PLAIN	OPEN SPACE WITHIN FLOOD PLAIN	No. LOTS PERMIT SHOWN	No. LOTS PERMIT SHOWN
SECTION 1	46.38 Ac.	9.84 Ac.	9.28 Ac.	11.41 Ac.	4.30 Ac.	168	154
SECTION 2	37.02 Ac.	4.53 Ac.	7.40 Ac.	4.00 Ac.	4.00 Ac.	132	36
TOTAL	83.40 Ac.	14.37 Ac.	16.68 Ac.	25.40 Ac.	8.30 Ac.	300	250

**LEGEND:**

1. Existing Contour (2' Interval)
2. Existing Storm Drainage
3. Proposed Storm Drainage
4. Building Restriction Lines:
5. 100 Yr. Flood Plain Elevation: EL=357.00'

TENTATIVELY APPROVED ON MAY 11, 1983  
 OFFICE OF PLANNING AND ZONING OF HOWARD COUNTY  
*Thomas J. Hamill*, 5-16-83  
 PLANNING DIRECTOR DATE

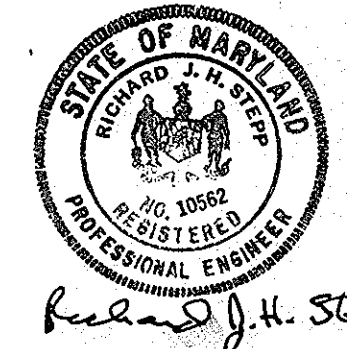

**CLARK • FINEROCK & SACKETT**  
 ENGINEERS • PLANNERS • SURVEYORS  
 11315 LOCKWOOD DRIVE SILVER SPRING, MARYLAND 20904 (301) 593-3400

DESIGNED	PRELIMINARY PLAN		SCALE
DRAWN	SEWELLS ORCHARD		1"=100'
CHECKED	SECTION TWO		DRAWING
	6TH ELECTION DISTRICT		1 of 1
	HOWARD COUNTY, MARYLAND		JOB NO.
	FOR: LIGHTPOINT ASSOCIATES		81-023
	P.O. BOX 319		FILE NO.
	Columbia, Maryland 21044		81-023-P
DATE	4-10-81		

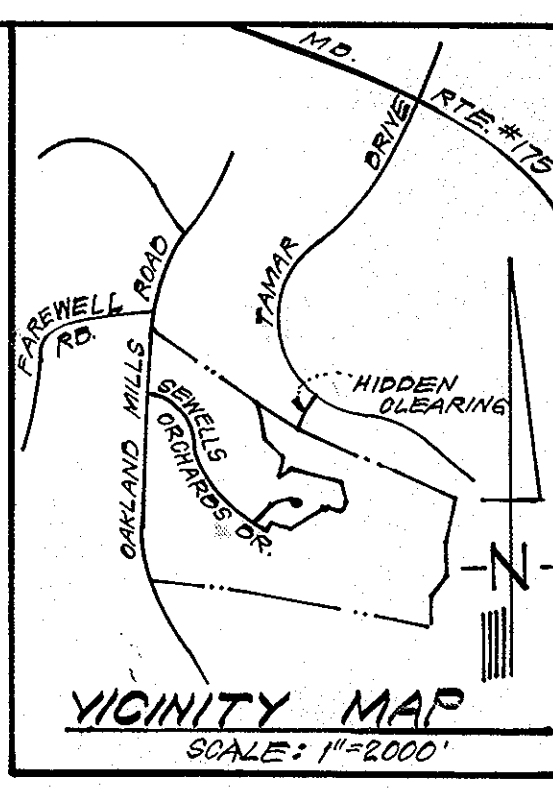

EASEMENT FOR INGRESS & EGRESS TO BALTIMORE ST. SUBSTATION P.B. 18 F.F.C.

BALTIMORE S.F.E. CO. PARCEL #14 F.F.C.

VILLAGE SECTION 18 P.B. 18