

VICINITY MAP
SCALE: 1" = 2,000'

LOT AND AREA DATA

TOTAL NUMBER OF LOTS (OPEN SPACE & PARCELS)	17
PARCELS	9
OPEN SPACE LOTS	11
TOTAL AREA	88.1 ACRES
AREA OF ROADS	8.0 ACRES
AREA OF PARCELS	55.8 ACRES
AREA OF OPEN SPACE LOTS	24.3 ACRES

GENERAL NOTES

1. Zoning - New Town (Employment Center - Industrial and Open Space) except as shown.
2. Topography taken from aerial topo, prepared by Maps, Incorporated.
3. Public water and sewer systems to be made available and utilized.
4. All building restriction lines shall be in accordance with Final Development Plan Phase 1B7.
5. All street R/W's are 80' wide except as noted.
6. The lots or parcels shown on these plans are subject to the supplement sewer in-aid-of construction charge created by Section 20.311A of the Howard County Code, and the Executive Order No. 72-9.
7. "See Office of Planning & Zoning File, S 77-32c."
8. Standard Symbols:

Proposed Headwalls	Proposed Pipes	
Proposed Inlets	Proposed Concrete Sidewalks	
Proposed Manholes	Major Open Space	
Rip Rap (20' Minimum)	Pathway System	

STORM WATER MANAGEMENT
AT THE REQUEST OF THE HOWARD COUNTY DEPARTMENT OF PUBLIC WORKS, A STORM WATER MANAGEMENT STUDY, BY WHITMAN, REQUARDT AND ASSOCIATES HAS BEEN SUBMITTED BY THE HOWARD RESEARCH AND DEVELOPMENT CORPORATION.

INDEX MAP
Scale: 1" = 200'

TENTATIVELY APPROVED ON FEB. 18, 1982
DATE
OFFICE OF PLANNING AND ZONING OF
HOWARD COUNTY
Thomas J. Staniel 3-2-82
PLANNING DIRECTOR DATE

FORMERLY
VILLAGE OF KINGS CONTRIVANCE
SECTION 3 AREA 3

2	2-24-82	Changed Subdivision Name
1	1-7-82	As per P&Z and Planning Comments
NO.	DATE	DESCRIPTION OF REVISION
COLUMBIA RIVERS CORPORATE PARK SECTION 2 AREA 1		
PRELIMINARY PLAN		
6 TH ELECTION DISTRICT OF HOWARD COUNTY, MD.		
OWNER AND DEVELOPER HOWARD RESEARCH AND DEVELOPMENT CORP. COLUMBIA, MARYLAND		
DATE: JULY 27, 1981		SCALE: AS SHOWN
SHEET 1 OF 3		

WHITMAN, REQUARDT & ASSOCIATES
ENGINEERS
BALTIMORE, MARYLAND
Kenneth A. McCord
KENNETH A. MCCORD P.E. NO. 1074

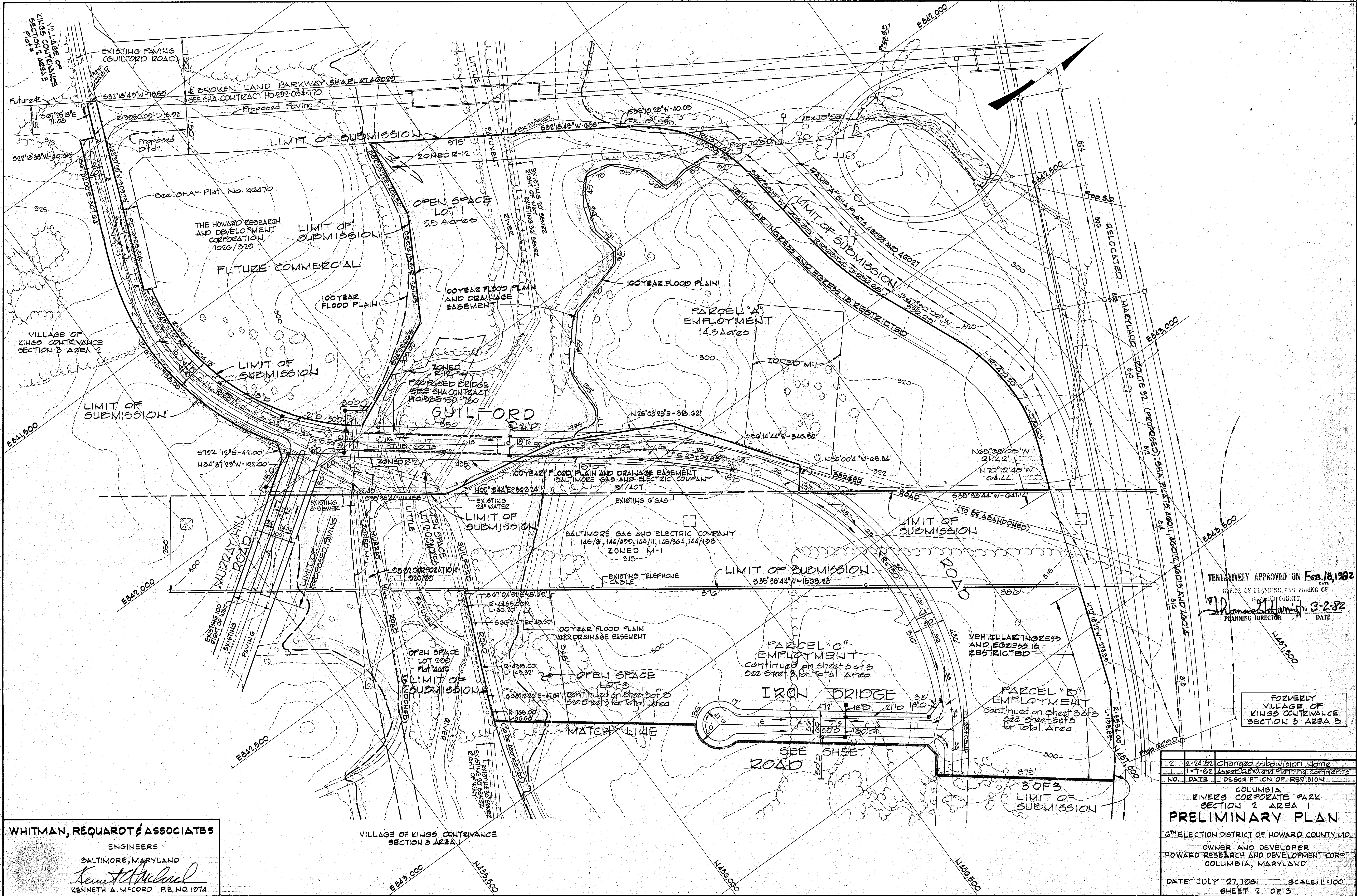

TENTATIVELY APPROVED ON **Feb. 18, 1982**
 DATE
 OFFICE OF PLANNING AND ZONING OF
 HOWARD COUNTY
Thomas J. Hough 3-2-82
 PLANNING DIRECTOR DATE

FORMERLY
 VILLAGE OF
 KINGS CONTRIVANCE
 SECTION 3 AREA 3

NO.	DATE	DESCRIPTION OF REVISION
2	2-24-82	Changed subdivision name
1	1-7-82	Added D.R.V. and Planning Comments

COLUMBIA
 RIVERS CORPORATE PARK
 SECTION 2 AREA 1
PRELIMINARY PLAN
 6TH ELECTION DISTRICT OF HOWARD COUNTY, MD.
 OWNER AND DEVELOPER
 HOWARD RESEARCH AND DEVELOPMENT CORP.
 COLUMBIA, MARYLAND
 DATE: JULY 27, 1981 SCALE: 1"=100'
 SHEET 2 OF 3

WHITMAN, REQUARDT & ASSOCIATES
 ENGINEERS
 BALTIMORE, MARYLAND
Kenneth A. McCord
 KENNETH A. MCCORD P.E. NO. 19714



WHITMAN, REQUARDT & ASSOCIATES
 ENGINEERS
 BALTIMORE, MARYLAND
Kenneth A. McCord
 KENNETH A. MCCORD P.E. NO. 1974

TENTATIVELY APPROVED ON **FEB. 18, 1982**
 DATE
 OFFICE OF PLANNING AND ZONING OF
 HOWARD COUNTY
Thomas J. Harris 3-2-82
 PLANNING DIRECTOR DATE

FORMERLY
 VILLAGE OF KINGS CONTRIVANCE
 SECTION 3 AREA 3

NO.	DATE	DESCRIPTION OF REVISION
2	2-24-82	Change Subdivision Name
1	1-7-82	As per P&Z and Planning Comments

COLUMBIA
 RIVERS CORPORATE PARK
 SECTION 2 AREA 1
PRELIMINARY PLAN
 6TH ELECTION DISTRICT OF HOWARD COUNTY, MD.
 OWNER AND DEVELOPER
 HOWARD RESEARCH AND DEVELOPMENT CORP.
 COLUMBIA, MARYLAND
 DATE: JULY 27, 1981 SCALE: 1"=100'
 SHEET 3 OF 3
 P-82-02.c