

GENERAL NOTES:

1. Topography compiled from Aerial Survey acquired from Ho. Co.
2. The area included is located on Tax Map #24 P's 1098, 1099, 1100 & 1101.
3. Installation of Traffic Control Devices shall be in accordance with The Manual of Uniform Control Devices, latest edition.
4. Public Water and Sewer to be Utilized.
5. Sediment & Erosion Control to be provided with the submission of the Road Construction & Development Plans.
6. Property shown is located on soils Map # 20.
7. Zoning: R-20
8. No. of Lots: 35 (Buildable) 3 (Open Space) = 38 Total
9. See Office of Planning and Zoning File: 9-80-14.
10. Area of Roadway Dedication: 2.22 Ac.
11. Total Area: 19.31 Acres
12. Density: 1.81 Lots/Acre.

SIZE (Sq. Ft.)	No.	AREA (Ac.)	O.S. Req'd.	O.S. Req'd. (Ac.)	OPEN SPACE PROVIDED		
					GROSS (Ac.)	WITHIN Flood PLAIN	WITHIN Slope > 25%
20,000 or Larger	19	6.15	6%	0.37			
18,000 to 19,999	7	3.03	10%	0.30			
16,000 to 17,999	9	3.49	20%	0.70			
14,000 to 15,999	6	2.02	30%	0.61			
TOTALS:	35	14.69	-	1.98	2.40	1.24 Ac	0

LEGEND:

1. Contour Interval 5 Ft.
2. Existing Contour
3. Typical Lot:
4. Building Restriction Line (B.R.L.)

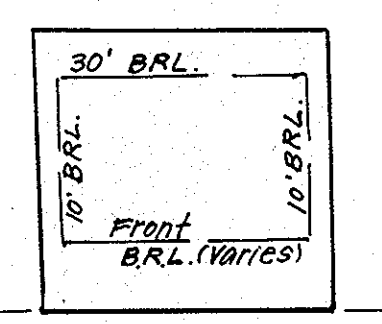

COORDINATE TABLE

No.	NORTH	EAST
1	10,000.00	10,000.00
2	9985.61	10,101.36
3	9956.01	10,440.26
4	9809.43	10,494.02
5	9734.85	10,541.68
6	9574.36	10,807.37
7	9498.48	10,644.14
8	9018.12	10,715.36
9	8921.51	10,741.02
10	8854.12	10,538.28
11	8819.26	10,502.74
12	8665.30	10,634.56
13	8557.04	10,553.80
14	8724.46	10,279.39
16	8890.55	9981.83
17	8888.09	9833.38
18	9211.77	9824.55
19	9186.47	9435.72
20	9362.71	9434.22
21	9219.18	9456.58
22	9382.88	9447.72
23	9672.18	9815.02

TENTATIVELY APPROVED ON **MAR 17, 1981**
 OFFICE OF PLANNING AND ZONING OF
 HOWARD COUNTY
 PLANNING DIRECTOR **Ronald J. Haney** 11-2-81
 DATE

OWNER: TAYLOR JOINT VENTURE
 P.O. Box 272, College Ave.
 Ellicott City, Md 21043

CLARK • FINEROCK & SACKETT
 ENGINEERS • PLANNERS • SURVEYORS
 11315 LOCKWOOD DRIVE SILVER SPRING, MARYLAND 20904 (301) 593-3400

DESIGNED W.R.M.C.	PRELIMINARY PLAN LOTS 1 THRU 38 TAYLOR PROPERTY SECTION ONE 2ND ELECTION DISTRICT HOWARD COUNTY, MARYLAND FOR: LAND SERVICES INC. 5454 Wisconsin Ave. Suite 1105 Bethesda, Md. 20015	SCALE 1"=100'
DRAWN K.I.W.		DRAWING 10P-1
CHECKED W.R.M.C.		JOB NO. 79-069
DATE 2-2-1981		FILE NO. 79-069-P