

VICINITY MAP
SCALE: 1"=2000'

BENCH MARKS
B.M. MONUMENT "SEWELL" ELEV. 403.21
CONCRETE MONUMENT - BRONZE DISC.
ON TOP, 25' LEFT OF E OAKLAND MILLS
ROAD (WEST SIDE) ALONG SOUTH
PROPERTY LINE.

B.M. R.P. SPIKE, SIDE OF B.G. & E.
ELEV. = 411.75 POLE # 169272

- GENERAL NOTES**
- TAX MAP 36 PART OF PARCEL 247
 - EXISTING ZONING: R-5C
 - PUBLIC WATER AND SEWER ARE TO BE UTILIZED.
 - DEED REFERENCE: G57/01
 - PROPOSED NO. OF LOTS
 - A. SINGLE FAMILY DETACHED: 86 - MIN. LOT SIZE 6000 S.F.
 - B. SINGLE FAMILY SEMI-DETACHED: 58 - MIN. LOT SIZE 2700 S.F.
 - AREA COMPUTATIONS
 - A. TOTAL GROSS AREA: 40.1 AC.
 - B. AREA OF SEMI-DETACHED LOTS: 5.2 AC.
 - C. AREA OF DETACHED LOTS: 17.0 AC.
 - D. AREA P/W: 9.2 AC.
 - OPEN SPACE
 - 1. FLOODPLAIN AND STEEP SLOPES: 34 AC.
 - 2. OTHER: 59 AC.
 - 3. TOTAL: 87 AC. OR 22%
 - ALL CONSTRUCTION TO BE IN ACCORDANCE WITH THE HOWARD CO. ROAD CONSTRUCTION CODE AND SPECIFICATIONS. HORIZONTAL AND VERTICAL CONTROL IS BASED ON HOWARD COUNTY DATUM.
 - STREET TREES TO BE SHOWN ON A TREE PLANTING PLAN @ FINAL PLAN SUBMISSION.
 - LOTS 1-42 DETACHED LOTS.
LOT 43 EXIST. DWLG. TO REMAIN.
LOTS 44-96 DETACHED LOTS.
LOTS 97-154 ATTACHED LOTS
 - 10' WIDTH FEE SIMPLE ACCESS P/W 4' WIDE PATHWAY
 - THIS DEVELOPMENT UNDER SEWER MORATORIUM.

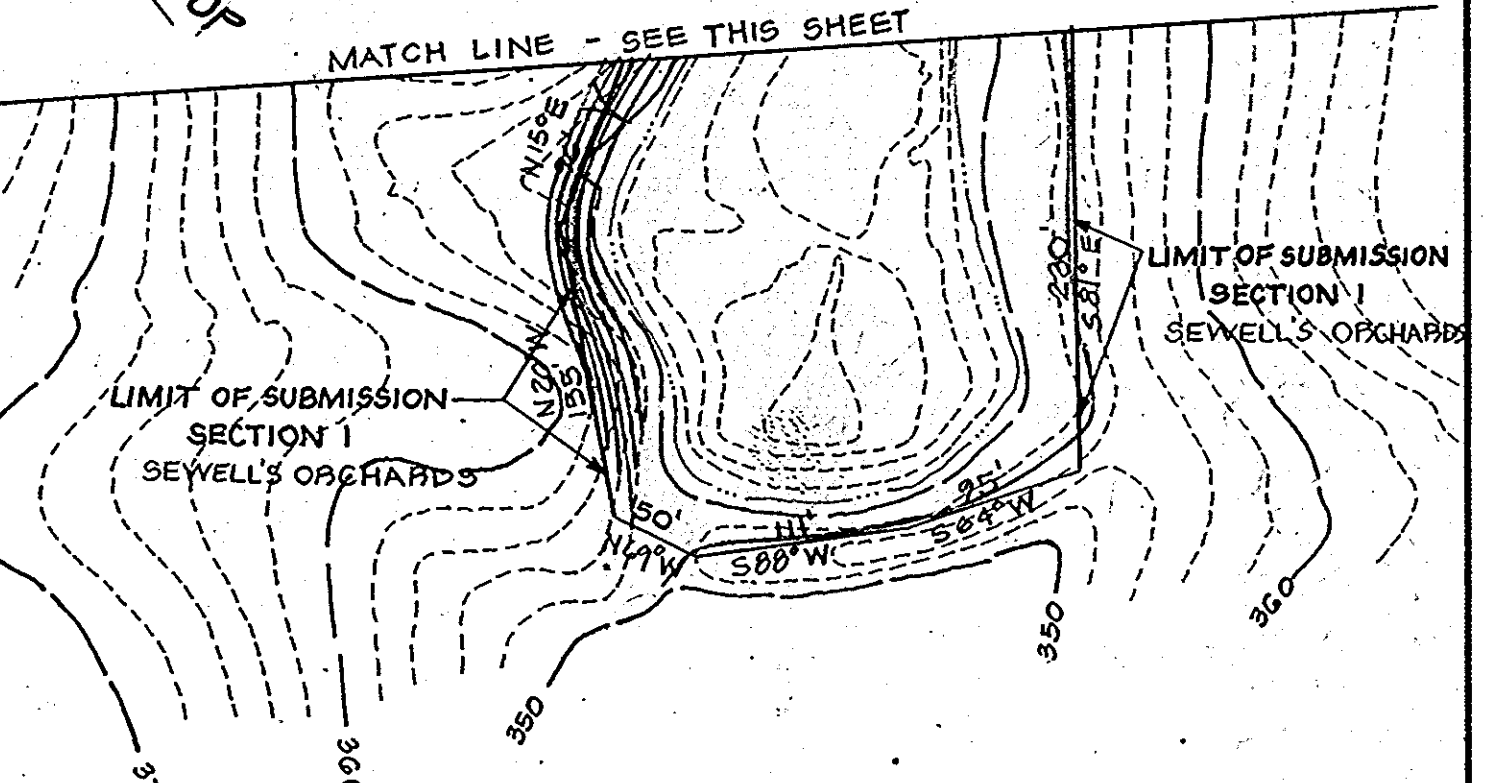

STATE OF MARYLAND
PROFESSIONAL ENGINEER
REGISTERED
Robert May Jr.
10-15-79

TENTATIVELY APPROVED ON Nov. 26, 1979
OFFICE OF PLANNING AND ZONING OF
HOWARD COUNTY
Thomas Hammett, 1-8-80
PLANNING DIRECTOR DATE

OWNER
SEWELL'S ORCHARDS
6233 OAKLAND MILLS RD.
COLUMBIA, MD 21045

DEVELOPER
MARLEA DEVELOPMENT CO.
P.O. BOX 519
COLUMBIA, MD 21044

TITLE			
PRELIMINARY PLAN			
PROJECT			
SEWELL'S ORCHARDS - SECTION I			
LOCATION		GTH ELECTION DISTRICT	
HOWARD COUNTY, MD.			
DATE:	OCT., 1979	DESIGN BY:	W.H.N.
DRAWN BY:	W.H.N.	CHECKED BY:	R.L.M.
SCALE:	1" = 100'	JOB NO.:	78224
DRAWING NO.:	1 OF 1		
boender associates			
SUIE 102-101 TOWN & COUNTRY PROFESSIONAL BUILDING ELLCOTT CITY, MARYLAND 21043 BALTIMORE 301-468-7777 SALISBURY 301-748-1286			
engineers/surveyors/planners			