

| COORDINATE TABLE | | | | | |
|------------------|-----------|-----------|-----------|-----------|-----------|
| No. | NORTH | EAST | NO. NORTH | EAST | |
| 17 | 487369.63 | 832282.03 | 62 | 488613.51 | 832826.47 |
| 18 | 488102.34 | 832305.31 | 63 | 488611.45 | 832916.89 |
| 19 | 488165.30 | 832412.31 | 70 | 488379.16 | 832909.98 |
| 21 | 488288.86 | 832269.22 | 80 | 488544.18 | 832950.84 |
| 22 | 488312.34 | 832225.08 | 81 | 488595.98 | 832948.66 |
| 23 | 488275.25 | 832979.6 | 82 | 488778.10 | 832987.31 |
| 29 | 488665.61 | 832089.55 | 94 | 488132.13 | 831790.17 |
| 30 | 488723.45 | 832386.97 | 95 | 487965.36 | 831589.21 |
| 31 | 488133.00 | 832436.05 | 96 | 487938.50 | 831823.50 |
| 32 | 488134.34 | 832442.92 | 97 | 488039.64 | 831885.28 |
| 33 | 488819.19 | 832683.80 | 98 | 487958.90 | 832037.06 |
| 48 | 488551.88 | 832910.28 | 99 | 487901.06 | 832006.29 |
| 49 | 488563.35 | 832819.86 | 100 | 487877.58 | 832050.43 |
| 50 | 488527.16 | 832593.89 | 101 | 487814.69 | 832168.27 |
| 51 | 488449.53 | 832435.36 | 102 | 487936.76 | 832211.09 |
| 52 | 488494.44 | 832413.38 | 103 | 487920.26 | 832276.20 |
| 53 | 488507.64 | 832440.34 | 104 | 488321.41 | 832532.98 |
| 54 | 488541.09 | 832451.80 | 105 | 488397.94 | 832689.27 |
| 55 | 488588.80 | 832428.05 | 106 | 488003.63 | 832182.75 |
| 56 | 488697.05 | 832392.10 | 107 | 487959.49 | 832159.47 |
| 57 | 488706.60 | 832441.18 | 108 | 487974.81 | 832130.47 |
| 58 | 488810.79 | 832473.34 | 109 | 487964.48 | 832096.66 |
| 59 | 488863.08 | 832496.70 | 110 | 488018.95 | 832153.95 |
| 60 | 488851.62 | 832530.15 | 111 | 488052.76 | 832143.63 |
| 61 | 488872.07 | 832571.91 | | | |

| LOT AREA TABULATION | | | | | | |
|-----------------------|-------------|----------------------|--------------------------|-----------------------------|-----------------------------------|-------|
| Lot Size (S.F.) | No. of Lots | Area of Lots (Acres) | Open Space Req'd (Acres) | Open Space Provided (Acres) | | |
| | | | | Gross | Within Flood Plain and 25% Slopes | Net |
| - | 17 | 6.7400 | 1.1900 | 1.255 | None | 1.255 |
| 20,000 or larger | 5 | 2.6244 | 6% 0.1575 | | | |
| 16,000 to 19,999 | 4 | 1.7738 | 10% 0.1774 | | | |
| 16,000 to 17,999 | 3 | 1.1437 | 20% 0.2287 | | | |
| 14,000 to 15,999 | 14 | 4.8278 | 30% 1.4483 | 2.613 | 0.884 | 1.729 |
| Total (Both Sections) | 43 | 17.1097 | 3.2019 | 3.868 | 0.884 | 2.984 |

| CURVE DATA | | | | | | |
|------------|--------|-----------|--------|--------|--------|---------------|
| No. | RADIUS | Δ | ARC | TAN | CHORD | BEARING |
| 55-56 | 435.00 | 5°05'00" | 14.52 | 57.59 | 114.19 | N 16°33'10" W |
| 57-58 | 385.00 | 15°05'00" | 101.35 | 50.97 | 101.06 | S 18°33'10" E |
| 61-62 | 445.00 | 33°41'30" | 261.67 | 134.74 | 257.91 | N 80°45'15" E |
| 63-64 | 425.00 | 45°21'00" | 32.24 | 18.13 | 32.23 | N 80°13'54" W |
| 60-48 | 375.00 | 66°18'41" | 41.31 | 20.68 | 41.29 | S 70°14'50" E |
| 49-50 | 395.00 | 33°41'30" | 232.28 | 119.60 | 228.94 | S 80°45'15" W |
| 51-21 | 375.00 | 35°53'50" | 134.95 | 121.47 | 231.12 | S 45°57'30" W |
| 22-52 | 425.00 | 35°53'50" | 266.28 | 137.67 | 261.94 | N 45°57'30" E |
| 106-17 | 325.00 | 18°55'53" | 107.38 | 54.18 | 106.90 | S 7°27'14" E |
| 103-107 | 375.00 | 18°55'53" | 128.81 | 62.52 | 123.34 | N 71°27'14" W |
| 103-102 | 375.00 | 10°16'38" | 67.20 | 33.72 | 67.18 | N 75°46'52" W |

| DENSITY TABULATION | | | | | | | | |
|--------------------|------------|-------------------------|-----------|----------------------|---------------------|-------------------------|----------------------|------------------|
| SECTION/AREA | GROSS AREA | FLOOD PLAIN/STEEPSLOPES | NET AREA | No. of UNITS ALLOWED | 1.1' LOT ADJUSTMENT | TOTAL No. UNITS ALLOWED | TOTAL UNITS PROPOSED | DENSITY PER ACRE |
| 1/1 | 10,302 AC | 0 | 10,302 AC | 22,438 | 0 | 22,438 | 17 | 1.650 |
| 1/2 | 14,868 AC | .884 | 13,984 AC | 30,457 | 3,238 | 33,695 | 26 | 1.745 |
| 1/3 | 21,531 AC | 6,507 | 15,024 AC | 32,722 | 4,689 | 37,411 | 30 | 1.393 |
| TOTALS | 46,701 AC | 7,391 | 39,290 AC | 85,617 | 7,927 | 93,544 | 73 | 1.563 |

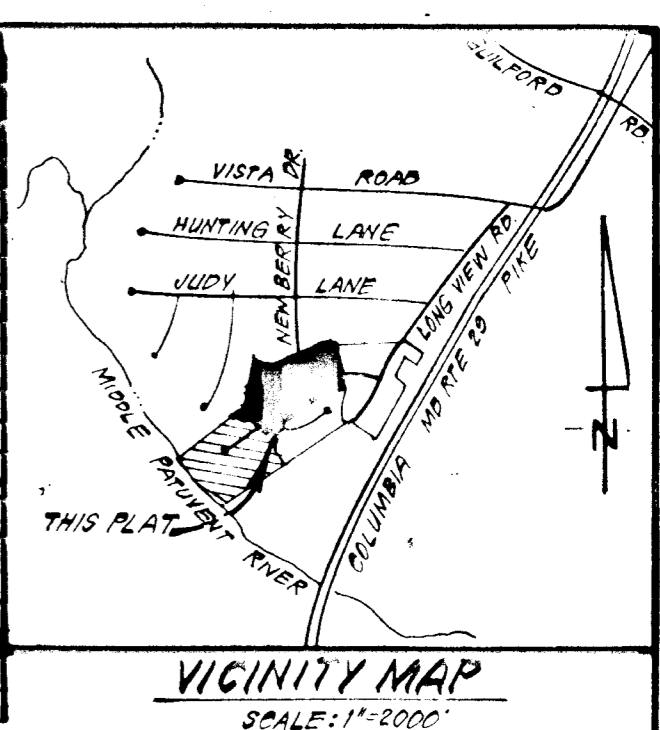

- NOTES:
1. 4"x4"x36" Concrete monuments indicated thus: ⊕
 2. Tax Map No. 41, Parcel No. 405.
 3. All coordinates shown hereon are based on the Maryland State Grid System.
 4. Subject property is Zoned: R-20 per 10-3-77 Comprehensive Zoning Plan.
 5. For Flag or easement lots, refuse collection, snow removal and road maintenance are provided to the junction of the flag or pipestem and the road right of way line only and not onto the flag or pipestem lot driveway.
 6. See Files: S-83-01 & P-83-07.
 7. ELEV 284.2 Indicates 100 Yr. Flood Plain Elevation

TABULATION OF FINAL PLAT

- (1) Total number of lots: 26 Buildable + 1 Open Space
- (2) Total area of buildable lots: 10.370 Acres
- (3) Total area of open space lots: 2.613 Acres
- (4) Total area of roadways to be recorded: 1.882 Acres
- (5) Total area of subdivision to be recorded: 14.868 Acres

This subdivision is subject to Section 18.122B of the Howard County Code. Public Water and Sewer service has been granted under the terms and provisions thereof, effective 3-20-84, on which date developer agreement No. 34-1180D was filed and accepted.

Plans for Public Water and Public Sewerage Systems have been approved by the Dept. of Health and Mental Hygiene and these facilities will be available to all lots offered for sale.

Stanley S. Halle
Stanley Halle
4/6/84
Date

APPROVED: FOR PUBLIC WATER & PUBLIC SEWERAGE SYSTEMS IN CONFORMANCE WITH THE MASTER PLAN OF WATER & SEWERAGE FOR HOWARD CO.

Joseph H. Hines 4-3-84
COUNTY HEALTH OFFICER DATE

APPROVED: HOWARD COUNTY OFFICE OF PLANNING AND ZONING.

Thomas H. Hines 4-4-84
DIRECTOR DATE

APPROVED: FOR PUBLIC WATER AND PUBLIC SEWERAGE STORM DRAINAGE SYSTEMS AND PUBLIC ROADS HOWARD CO. DEPT. OF PUBLIC WORKS

John F. Neuman 3-31-84
DIRECTOR DATE

OWNER'S DEDICATION

We, Stanley Halle Communities, Inc., a Maryland Corporation, by Stanley Halle, President, owner of the property shown hereon, hereby adopt this plan of subdivision and in consideration of the approval of this Final Plat by the Office of Planning and Zoning, establish the minimum building restriction lines and grant unto Howard County, Maryland, its successors and assigns: (1) the right to lay, construct and maintain sewers, drains, water pipes and other municipal utilities and services in and under all roads and street right of way and the specific easement areas shown hereon; (2) the right to require dedication for public use the beds of streets and/or roads, flood plains and open space where applicable and for good and other valuable consideration, hereby grant the right and option to Howard County to acquire the fee simple title to the beds of the streets and/or roads and flood plains, storm drains, utilities and open space where applicable; (3) the right to require dedication of waterways and drainage easements for the specific purpose of their construction, repair and maintenance and (4) that no building or similar structure of any kind shall be erected on or over said easements and rights of way.

Witness my hand this 6th day of Jan., 1984.

Stanley S. Halle
Stanley Halle, President

SURVEYORS CERTIFICATE

I hereby certify that the Final Plat shown hereon is correct; that it is a subdivision of part of the land conveyed by J. Nevitt Evans, Sr. et al, Trustees, to Stanley Halle Communities, Inc., a Maryland Corporation by deed dated January 3, 1983, and recorded among the Land Records of Howard County, Maryland, in Liber 1137 of Folio 051 and that all monuments are in place, or will be in place, prior to acceptance of the streets in the subdivision by Howard County, as shown, in accordance with the Annotated Code of Maryland, as amended.

9-2-83
DATE

Donald B. Sackett
DONALD B. SACKETT
Registered Land Surveyor
Md. No. 6059

RECORDED AS PLAT 5443
ON 4-11-84, AMONG THE LAND RECORDS OF HOWARD COUNTY, MARYLAND

RIVERSIDE
LOTS 1 THRU 27
SECTION 1 AREA 2

TAX MAP No. 41 PARCEL No. 405
SHEET 1 OF 1
5th Election District, Howard County, Maryland
SCALE: 1"=100'

CLARK FINEFROCK & SACKETT
ENGINEERS, PLANNERS, SURVEYORS
11315 LOCKWOOD DRIVE
SILVER SPRING, MARYLAND 20904

#981

F-84-40 C.7