

COORDINATES		
NO	NORTH	EAST
1	4556.91	4727.84
2	4939.26	4070.42
3	5558.99	4430.86
4	5251.56	4886.91
5	5012.89	4747.67
6	4893.94	4941.30
7	4828.44	4905.64
8	4838.48	4888.74

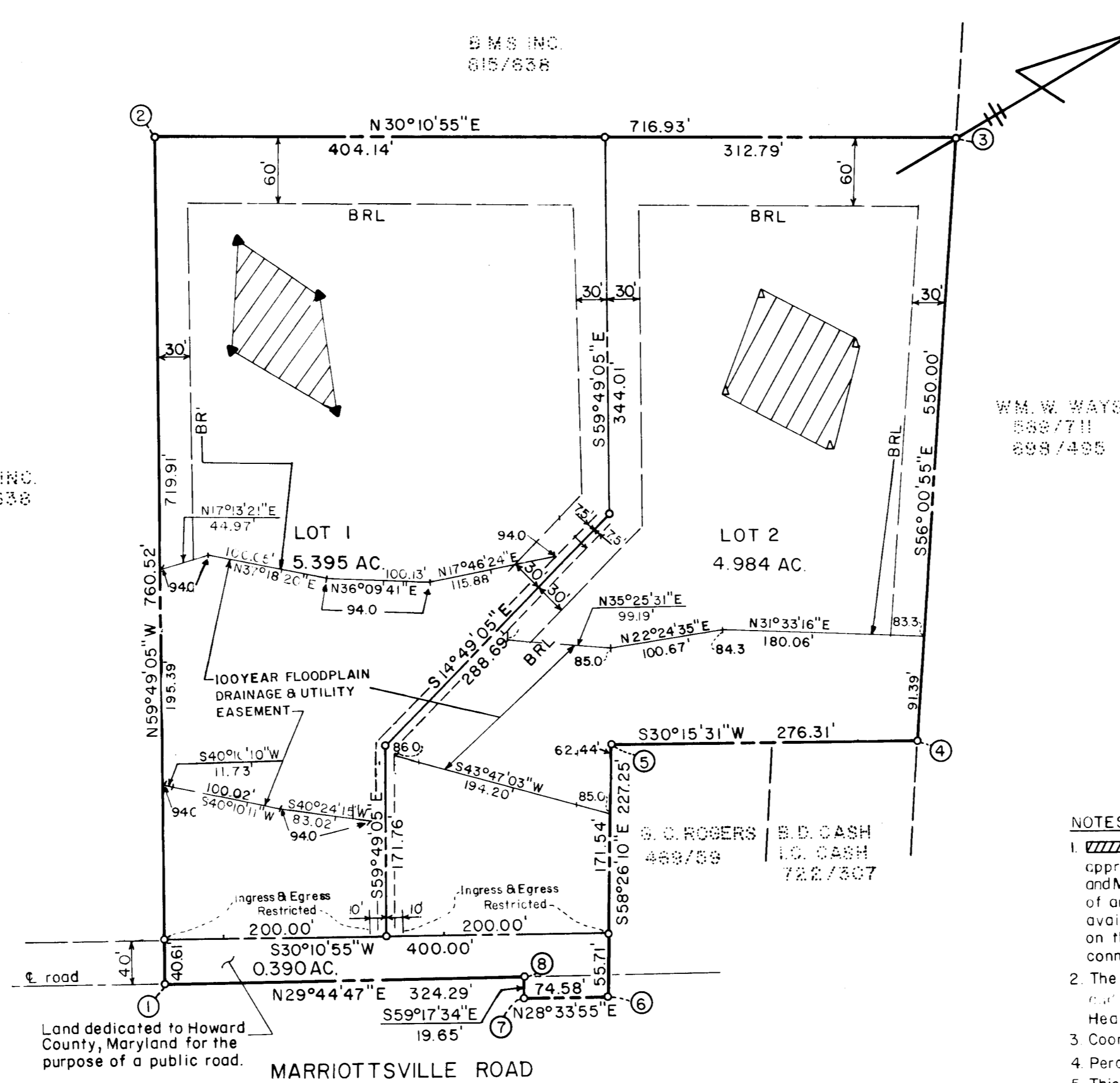
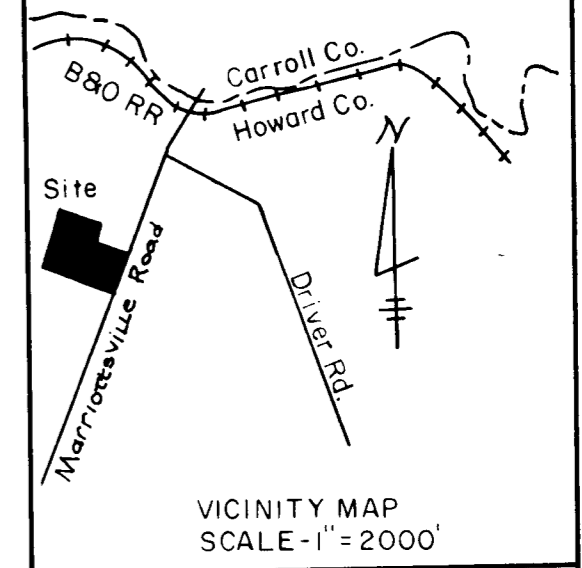

WM. W. WAYS
558/711
698/495

PLAT # 4094

NOTES

1. [Hatched Area] This area designates a private sewerage easement of approximately 10,000 sq. ft. as required by the Maryland State Department of Health and Mental Hygiene for individual sewage disposal. Improvements of any nature in this area are restricted until public sewage is available and servicing any residential structure constructed on this site. This easement shall become null and void upon connection to a public sewage system.
2. The lot shown hereon comply with the minimum ownership width and lot areas as required by the Maryland State Department of Health and Mental Hygiene.
3. Coordinates shown hereon are assumed.
4. Percolation tests have been field located.
5. This plat subject to VP-77-65.
6. Access drive requires twin 108" diameter culverts.

Total number of lots 2
Total area of lots 10.379 Ac.
Total area of roadways 0.390 Ac.
Total area of subdivision 10.769 Ac.

APPROVED: For private water and private sewerage systems.
Howard County Health Department

Regina Boyles 9-11-78
County Health Officer Date

APPROVED: Howard County Office of Planning and Zoning

Director Date

APPROVED: For storm drainage systems and public roads.

Howard County Department of Public Works
Richard E. Freudenberger 9/13/78
Director Date

OWNER'S CERTIFICATE

We, B.M.S., Inc. a Maryland Corporation by Billy R. Smith, President owners of the property shown and described hereon, hereby adopt this plan of subdivision, and in consideration of the approval of this Final Plat by the Office of Planning and Zoning, establish the minimum building restriction lines and grant unto Howard County, Maryland, its successors and assigns, (1) the right to lay, construct and maintain sewers, drains, water pipes and other municipal utilities and services, in and under all roads and street right-of-ways and the specific easement areas shown hereon; (2) dedicate to public use the beds of the streets and/or roads and floodplains and open space where applicable, and for One Dollar (\$1.00) consideration, hereby grant the right and option to Howard County to acquire the fee simple title to the beds of the streets and/or roads and floodplains and open space where applicable; (3) that no building or similar structure of any kind shall be erected on or over the said easements and right-of-ways; and (4) it is further agreed that maintenance of all waterways, drainage easements and/or floodplains shown hereon are the responsibility of the property owner, its successors and assigns.

Witness hand this _____ day of _____, 1978

SURVEYOR'S CERTIFICATE

I hereby certify that the final plat shown hereon is correct; that it is a subdivision of part of the lands conveyed. By L. J. Grossman and B. J. Sachs to B. M. S., Inc. by deed dated March 30, 1977, and recorded in the Land Records of Howard County in Liber 815, Folio 638 and that all monuments are in place as shown in accordance with the annotated code of Maryland, as amended.

Date

Henry V Oheim # 4156

B. M. S. PROPERTY

THIRD ELECTION DISTRICT
HOWARD COUNTY, MARYLAND
SCALE 1" = 100'
JANUARY, 1978

PLAT # 4094

Tydings-Oheim Assoc., Inc.
Land Surveyors
Construction Surveyors
8370 Court Avenue
Ellicott City, Md.
21043
301-465-0660

OWNER & DEVELOPER
B. M. S., Inc.
4049 Linthicum Road
Dayton, Md.
21036

BRUNING 44-142-35466

#7767