

**GENERAL NOTES:**

1. All Storm Drainage shall be constructed in accordance with the latest details and specifications of Howard County.
2. Types of Storm Drainage Structures refer to the Standard Details of Howard County.
3. Information concerning underground utilities was obtained from available records, but the Contractor must determine the exact location and elevation of the mains by digging test pits, by hand, at all utility crossings, well in advance of construction.
4. All utility companies shall be notified 24 hrs in advance of construction.
5. Extreme care shall be taken during grading operations and storm drainage construction in vicinity of ex 36" RCP due to the cover conditions over the pipe.
6. Provide Positive drainage to Ex. swale on lots F-17 & F-18 and to proposed Str. I-10 by grading to spot elevations and proposed contours shown.

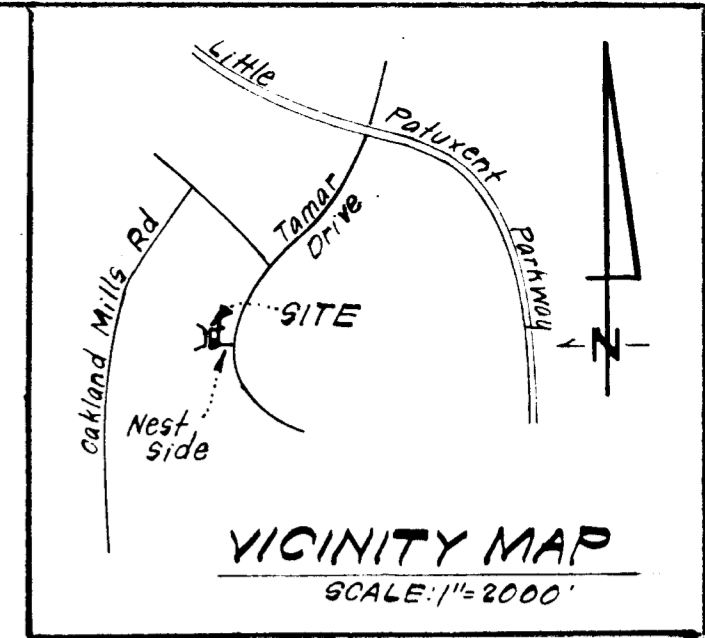

**LEGEND:**

- |                            |                    |
|----------------------------|--------------------|
| 1. Contour Interval        | 2 Ft.              |
| 2. Existing Contour        | --- 380 ---        |
| 3. Proposed Contour        | --- 380 ---        |
| 4. Spot Elevation          | +805               |
| 5. Direction of Drainage   | →                  |
| 6. Existing Storm Drainage | --- Ex 15" RCP --- |
| 7. Proposed Storm Drainage | --- 15" RCP ---    |

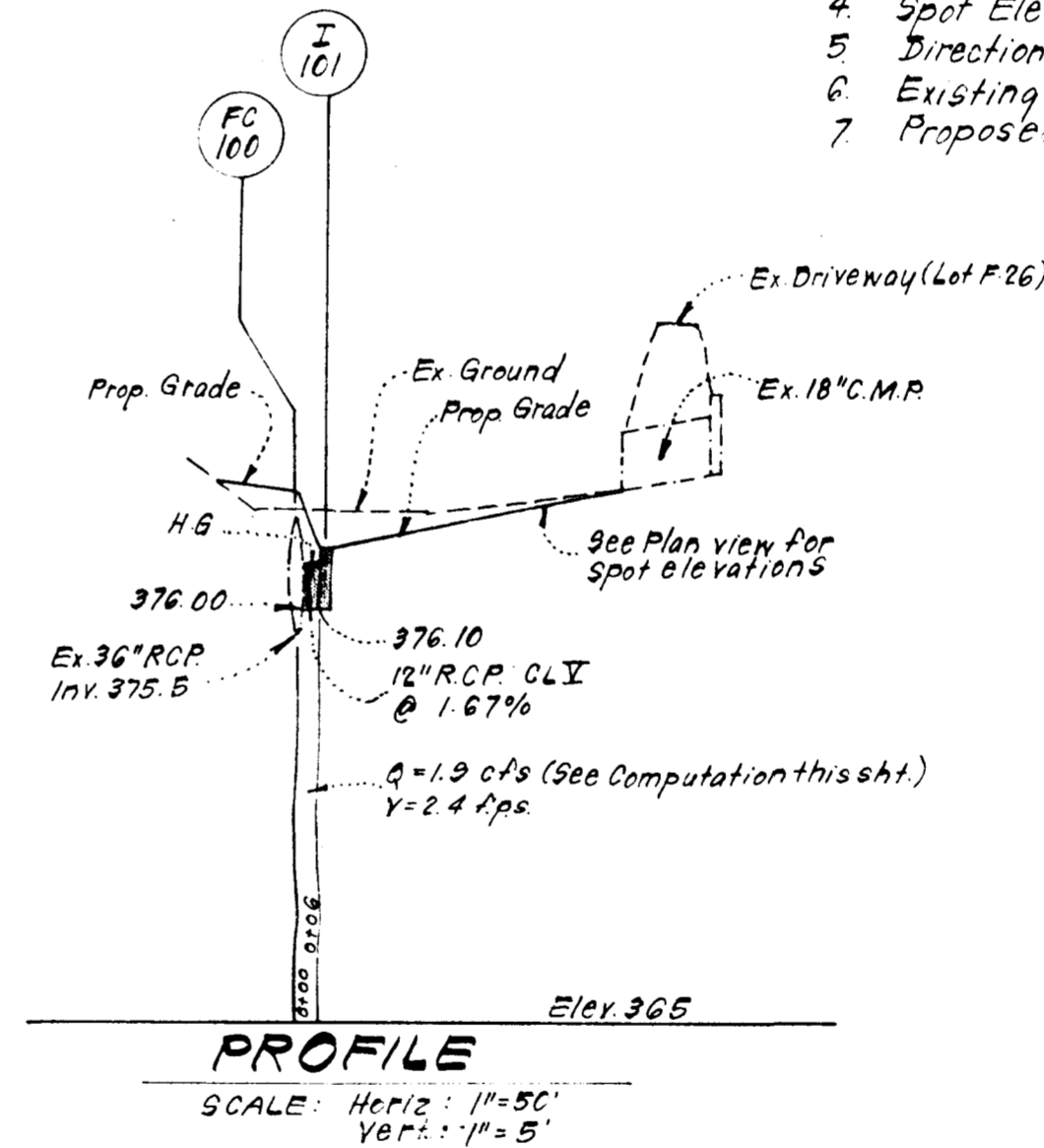

Computation of  $Q_{10}$   
 $A = 0.8$  Acres  
 (DA from plans prepared by John J. Allen Assoc., April 1975.)  
 $T.C. = 17 - P.I./8 = 17 - 25/8 = 13.9$   
 $I_{10} = 5.8$  in/hr.  $C = .40$   
 $Q_{10} = A.C. \times I_{10}$   
 $= .8 \times .40 \times 5.8 = 1.9$  cfs.

STRUCTURE SCHEDULE							
No.	TYPE	INV. IN.	INV. OUT.	TOP ELEVATION		REMARKS	LOCATION
				Upper	Lower		
I-101	YARD INLET	-	376.10	377.62		Ho Co Std. Fig. 4.14	See Plan
FC-100	FIELD CONNECTION	376.00	-	-		Ho Co Std. Fig. 3.23	See Plan

#100



J. J. Allen  
1-11-80

see PLAT # 3711

RECEIVED  
JAN 24 '80

<b>CLARK • FINEFROCK &amp; SACKETT</b> ENGINEERS • PLANNERS • SURVEYORS 11315 LOCKWOOD DRIVE • SILVER SPRING, MARYLAND 20904 • (301) 593-3400		
DESIGNED R.J.S.	<b>STORM DRAINAGE ADDITION</b> <b>LOTS F-18, F-26 &amp; F-27</b> <b>COLUMBIA</b> VILLAGE OF LONGREACH SECTION 1 AREA 2 6th ELECTION DISTRICT HOWARD COUNTY, MARYLAND	SCALE As Shown
DRAWN K.I.W.		DRAWING 1041
CHECKED R.J.S.		JOB NO. 77-979
DATE Jan., 1980		FILE NO. 77-979-D
		FOR: CAMPBELL - MARDALL CONSTRUCTION CO. 5115 Hesperus Drive Columbia, Md 21044