

Section #5

J.R. CURTIS
P.E. # L.S. NO. 852
ELLICOTT CITY, MD

PROFILE - SCALE
HORIZ. 1" = 50'
VERT. 1" = 5'

R 5 - ROAD DETAIL - H.C.R.D.

ATHOLTON MANOR - SECTION FIVE
FIFTH ELECTION DISTRICT - HOWARD COUNTY, MD
ELMER D. SNOOK - OWNER & DEVELOPER
- FEB-1959 -

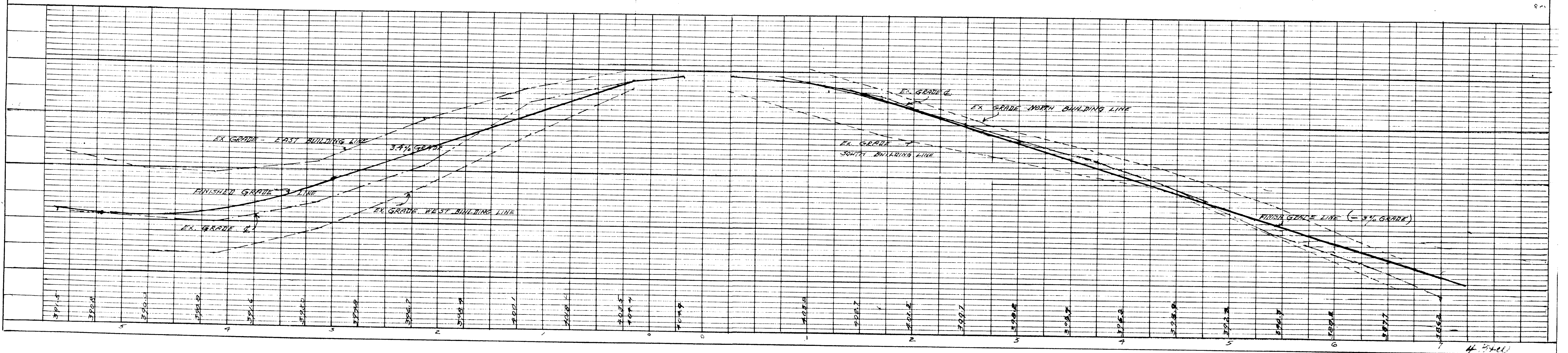
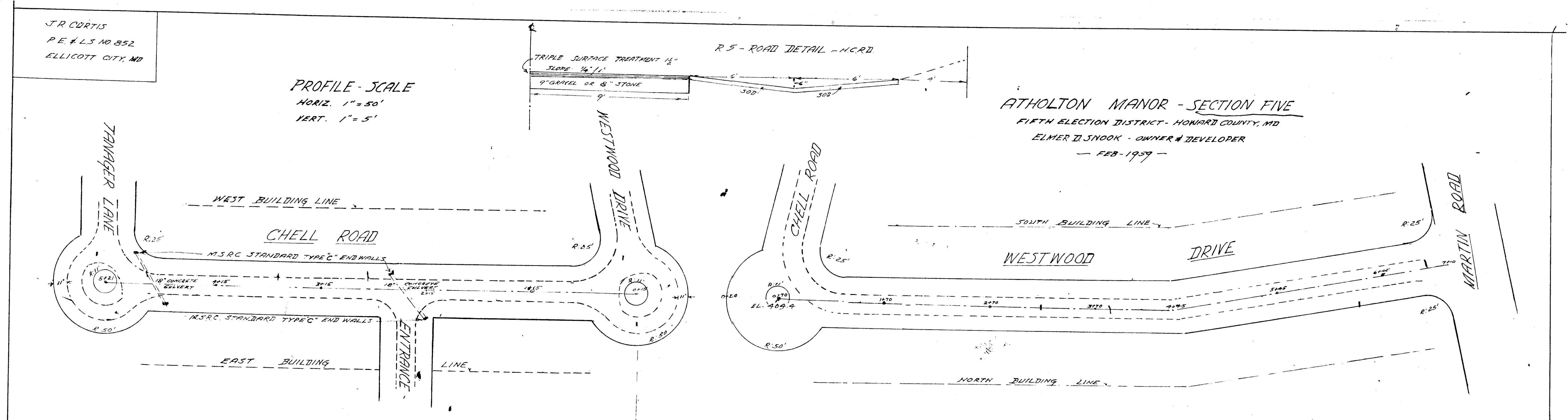

APPROVED
HOWARD COUNTY ROADS DEPT.
DATE 2/27/59
SIGNED Herman Skell

238

37 R-P-34

XXAT-59-001

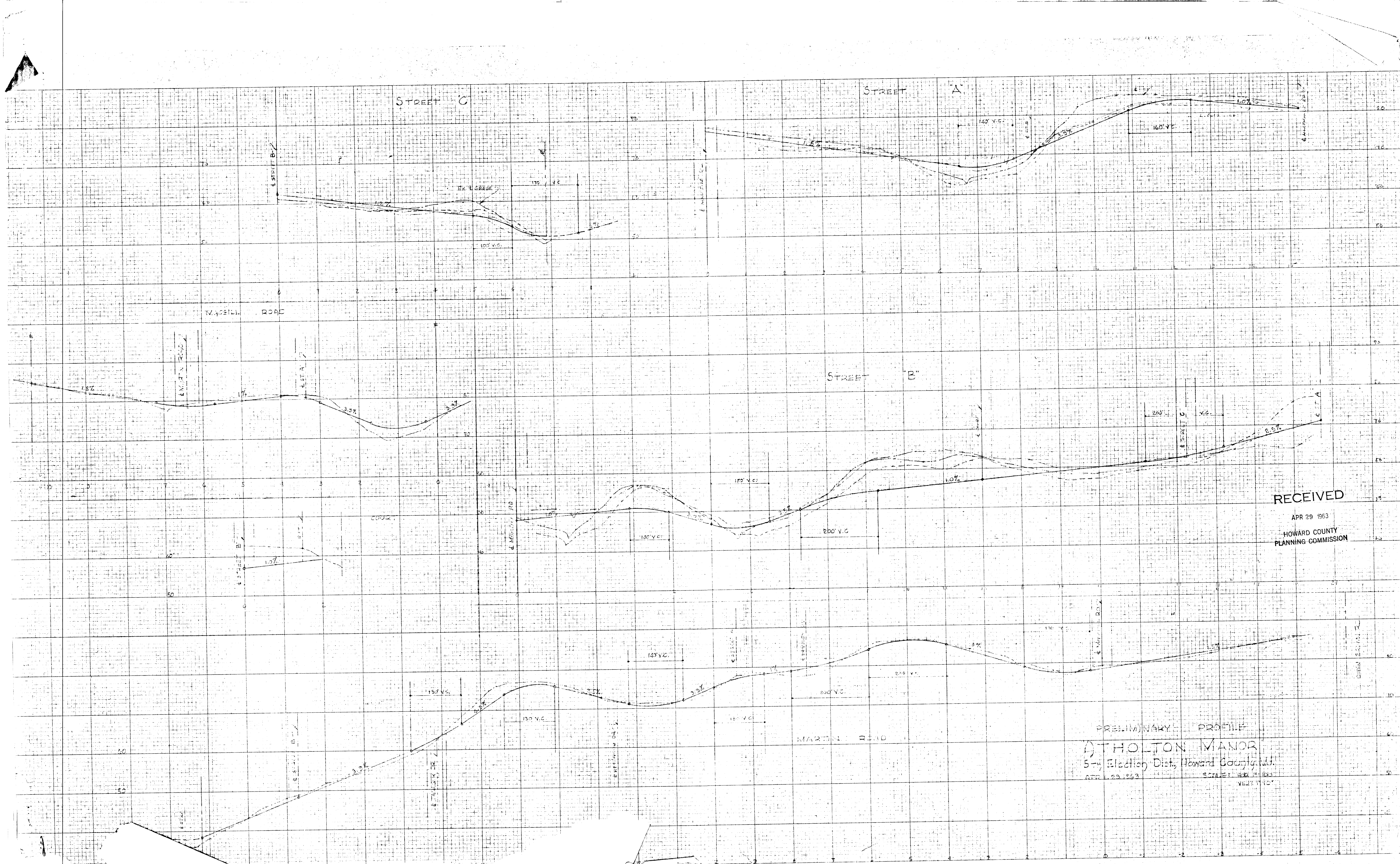

RECEIVED

APR 29 1963

HOWARD COUNTY
PLANNING COMMISSION

PRELIMINARY PROFILE
 ATHOLTON MANOR
 5th Election Dist, Howard County, Md.
 APR 23 1963 SCALE: HORIZ. 1"=100'
 VERT. 1"=10'

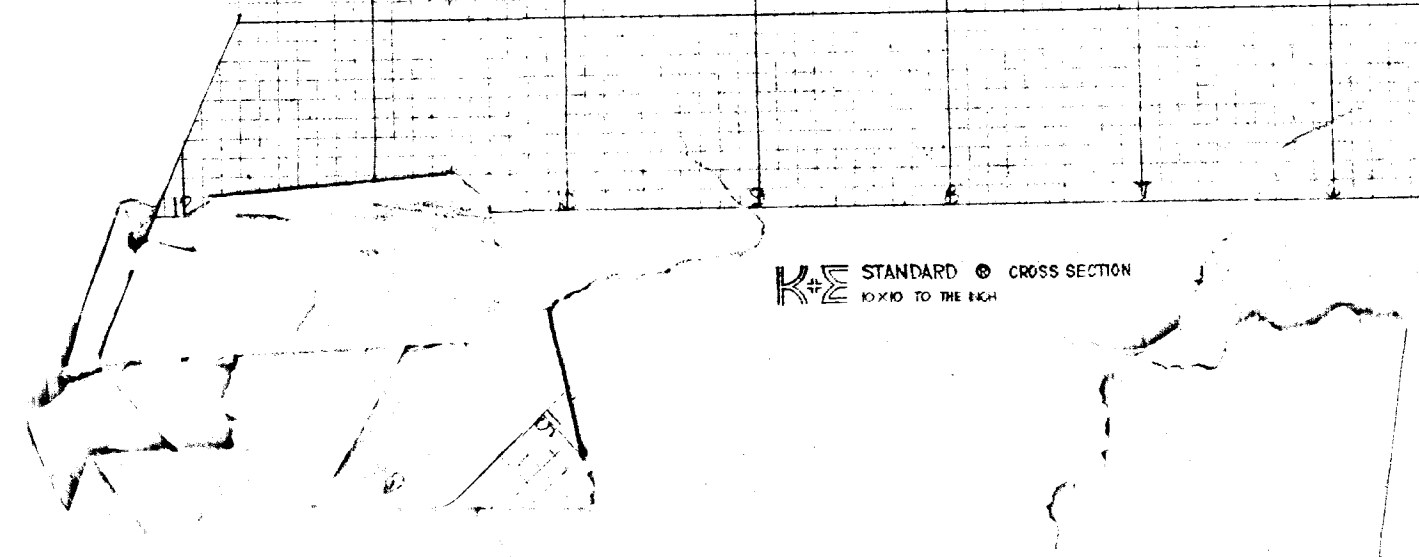

STANDARD CROSS SECTION
 KEIFFEL & ESSER CO.
 MADE IN U.S.A.

RECEIVED

APR 29 1963

HOWARD COUNTY
PLANNING COMMISSION

XXAT-59-002