

HAUL ROAD BASELINE				
STA	DIST	BEARING	NORTH	EAST
PC 0+00	00.00	N 28° 15' 00" W	834.451, 520	825.435, 432
PT 1 (BLS)	01.38	N 28° 15' 00" W	834.451, 520	825.435, 432
PT 2 (BLS)	02.76	N 28° 15' 00" W	834.451, 520	825.435, 432
PT 3 (BLS)	04.14	N 28° 15' 00" W	834.451, 520	825.435, 432
PT 4 (BLS)	05.52	N 28° 15' 00" W	834.451, 520	825.435, 432
PT 5 (BLS)	06.90	N 28° 15' 00" W	834.451, 520	825.435, 432
PT 6 (BLS)	08.28	N 28° 15' 00" W	834.451, 520	825.435, 432
PT 7 (BLS)	09.66	N 28° 15' 00" W	834.451, 520	825.435, 432
PT 8 (BLS)	11.04	N 28° 15' 00" W	834.451, 520	825.435, 432
PT 9 (BLS)	12.42	N 28° 15' 00" W	834.451, 520	825.435, 432
PT 10 (BLS)	13.80	N 28° 15' 00" W	834.451, 520	825.435, 432
PT 11 (BLS)	15.18	N 28° 15' 00" W	834.451, 520	825.435, 432
PT 12 (BLS)	16.56	N 28° 15' 00" W	834.451, 520	825.435, 432
PT 13 (BLS)	17.94	N 28° 15' 00" W	834.451, 520	825.435, 432
PT 14 (BLS)	19.32	N 28° 15' 00" W	834.451, 520	825.435, 432
PT 15 (BLS)	20.70	N 28° 15' 00" W	834.451, 520	825.435, 432
PT 16 (BLS)	22.08	N 28° 15' 00" W	834.451, 520	825.435, 432
PT 17 (BLS)	23.46	N 28° 15' 00" W	834.451, 520	825.435, 432
PT 18 (BLS)	24.84	N 28° 15' 00" W	834.451, 520	825.435, 432
PT 19 (BLS)	26.22	N 28° 15' 00" W	834.451, 520	825.435, 432
PT 20 (BLS)	27.60	N 28° 15' 00" W	834.451, 520	825.435, 432
PT 21 (BLS)	28.98	N 28° 15' 00" W	834.451, 520	825.435, 432
PT 22 (BLS)	30.36	N 28° 15' 00" W	834.451, 520	825.435, 432
PT 23 (BLS)	31.74	N 28° 15' 00" W	834.451, 520	825.435, 432
PT 24 (BLS)	33.12	N 28° 15' 00" W	834.451, 520	825.435, 432
PT 25 (BLS)	34.50	N 28° 15' 00" W	834.451, 520	825.435, 432
PT 26 (BLS)	35.88	N 28° 15' 00" W	834.451, 520	825.435, 432
PT 27 (BLS)	37.26	N 28° 15' 00" W	834.451, 520	825.435, 432
PT 28 (BLS)	38.64	N 28° 15' 00" W	834.451, 520	825.435, 432
PT 29 (BLS)	40.02	N 28° 15' 00" W	834.451, 520	825.435, 432
PT 30 (BLS)	41.40	N 28° 15' 00" W	834.451, 520	825.435, 432
PT 31 (BLS)	42.78	N 28° 15' 00" W	834.451, 520	825.435, 432
PT 32 (BLS)	44.16	N 28° 15' 00" W	834.451, 520	825.435, 432
PT 33 (BLS)	45.54	N 28° 15' 00" W	834.451, 520	825.435, 432
PT 34 (BLS)	46.92	N 28° 15' 00" W	834.451, 520	825.435, 432
PT 35 (BLS)	48.30	N 28° 15' 00" W	834.451, 520	825.435, 432
PT 36 (BLS)	49.68	N 28° 15' 00" W	834.451, 520	825.435, 432
PT 37 (BLS)	51.06	N 28° 15' 00" W	834.451, 520	825.435, 432
PT 38 (BLS)	52.44	N 28° 15' 00" W	834.451, 520	825.435, 432
PT 39 (BLS)	53.82	N 28° 15' 00" W	834.451, 520	825.435, 432
PT 40 (BLS)	55.20	N 28° 15' 00" W	834.451, 520	825.435, 432
PT 41 (BLS)	56.58	N 28° 15' 00" W	834.451, 520	825.435, 432
PT 42 (BLS)	57.96	N 28° 15' 00" W	834.451, 520	825.435, 432
PT 43 (BLS)	59.34	N 28° 15' 00" W	834.451, 520	825.435, 432
PT 44 (BLS)	60.72	N 28° 15' 00" W	834.451, 520	825.435, 432
PT 45 (BLS)	62.10	N 28° 15' 00" W	834.451, 520	825.435, 432
PT 46 (BLS)	63.48	N 28° 15' 00" W	834.451, 520	825.435, 432
PT 47 (BLS)	64.86	N 28° 15' 00" W	834.451, 520	825.435, 432
PT 48 (BLS)	66.24	N 28° 15' 00" W	834.451, 520	825.435, 432
PT 49 (BLS)	67.62	N 28° 15' 00" W	834.451, 520	825.435, 432
PT 50 (BLS)	69.00	N 28° 15' 00" W	834.451, 520	825.435, 432
PT 51 (BLS)	70.38	N 28° 15' 00" W	834.451, 520	825.435, 432
PT 52 (BLS)	71.76	N 28° 15' 00" W	834.451, 520	825.435, 432
PT 53 (BLS)	73.14	N 28° 15' 00" W	834.451, 520	825.435, 432
PT 54 (BLS)	74.52	N 28° 15' 00" W	834.451, 520	825.435, 432
PT 55 (BLS)	75.90	N 28° 15' 00" W	834.451, 520	825.435, 432
PT 56 (BLS)	77.28	N 28° 15' 00" W	834.451, 520	825.435, 432
PT 57 (BLS)	78.66	N 28° 15' 00" W	834.451, 520	825.435, 432
PT 58 (BLS)	80.04	N 28° 15' 00" W	834.451, 520	825.435, 432
PT 59 (BLS)	81.42	N 28° 15' 00" W	834.451, 520	825.435, 432
PT 60 (BLS)	82.80	N 28° 15' 00" W	834.451, 520	825.435, 432
PT 61 (BLS)	84.18	N 28° 15' 00" W	834.451, 520	825.435, 432
PT 62 (BLS)	85.56	N 28° 15' 00" W	834.451, 520	825.435, 432
PT 63 (BLS)	86.94	N 28° 15' 00" W	834.451, 520	825.435, 432
PT 64 (BLS)	88.32	N 28° 15' 00" W	834.451, 520	825.435, 432
PT 65 (BLS)	89.70	N 28° 15' 00" W	834.451, 520	825.435, 432
PT 66 (BLS)	91.08	N 28° 15' 00" W	834.451, 520	825.435, 432
PT 67 (BLS)	92.46	N 28° 15' 00" W	834.451, 520	825.435, 432
PT 68 (BLS)	93.84	N 28° 15' 00" W	834.451, 520	825.435, 432
PT 69 (BLS)	95.22	N 28° 15' 00" W	834.451, 520	825.435, 432
PT 70 (BLS)	96.60	N 28° 15' 00" W	834.451, 520	825.435, 432
PT 71 (BLS)	97.98	N 28° 15' 00" W	834.451, 520	825.435, 432
PT 72 (BLS)	99.36	N 28° 15' 00" W	834.451, 520	825.435, 432
PT 73 (BLS)	100.74	N 28° 15' 00" W	834.451, 520	825.435, 432
PT 74 (BLS)	102.12	N 28° 15' 00" W	834.451, 520	825.435, 432
PT 75 (BLS)	103.50	N 28° 15' 00" W	834.451, 520	825.435, 432
PT 76 (BLS)	104.88	N 28° 15' 00" W	834.451, 520	825.435, 432
PT 77 (BLS)	106.26	N 28° 15' 00" W	834.451, 520	825.435, 432
PT 78 (BLS)	107.64	N 28° 15' 00" W	834.451, 520	825.435, 432
PT 79 (BLS)	109.02	N 28° 15' 00" W	834.451, 520	825.435, 432
PT 80 (BLS)	110.40	N 28° 15' 00" W	834.451, 520	825.435, 432
PT 81 (BLS)	111.78	N 28° 15' 00" W	834.451, 520	825.435, 432
PT 82 (BLS)	113.16	N 28° 15' 00" W	834.451, 520	825.435, 432
PT 83 (BLS)	114.54	N 28° 15' 00" W	834.451, 520	825.435, 432
PT 84 (BLS)	115.92	N 28° 15' 00" W	834.451, 520	825.435, 432
PT 85 (BLS)	117.30	N 28° 15' 00" W	834.451, 520	825.435, 432
PT 86 (BLS)	118.68	N 28° 15' 00" W	834.451, 520	825.435, 432
PT 87 (BLS)	120.06	N 28° 15' 00" W	834.451, 520	825.435, 432
PT 88 (BLS)	121.44	N 28° 15' 00" W	834.451, 520	825.435, 432
PT 89 (BLS)	122.82	N 28° 15' 00" W	834.451, 520	825.435, 432
PT 90 (BLS)	124.20	N 28° 15' 00" W	834.451, 520	825.435, 432
PT 91 (BLS)	125.58	N 28° 15' 00" W	834.451, 520	825.435, 432
PT 92 (BLS)	126.96	N 28° 15' 00" W	834.451, 520	825.435, 432
PT 93 (BLS)	128.34	N 28° 15' 00" W	834.451, 520	825.435, 432
PT 94 (BLS)	129.72	N 28° 15' 00" W	834.451, 520	825.435, 432
PT 95 (BLS)	131.10	N 28° 15' 00" W	834.451, 520	825.435, 432
PT 96 (BLS)	132.48	N 28° 15' 00" W	834.451, 520	825.435, 432
PT 97 (BLS)	133.86	N 28° 15' 00" W	834.451, 520	825.435, 432
PT 98 (BLS)	135.24	N 28° 15' 00" W	834.451, 520	825.435, 432
PT 99 (BLS)	136.62	N 28° 15' 00" W	834.451, 520	825.435, 432
PT 100 (BLS)	138.00	N 28° 15' 00" W	834.451, 520	825.435, 432

HAUL ROAD CURVE DATA				
CURVE No.	A	D	R	T
1A	24.0000	4.79	300.00	92.98
1B	24.0000	4.79	300.00	92.98
2	40.0000	12.96	200.00	12.82

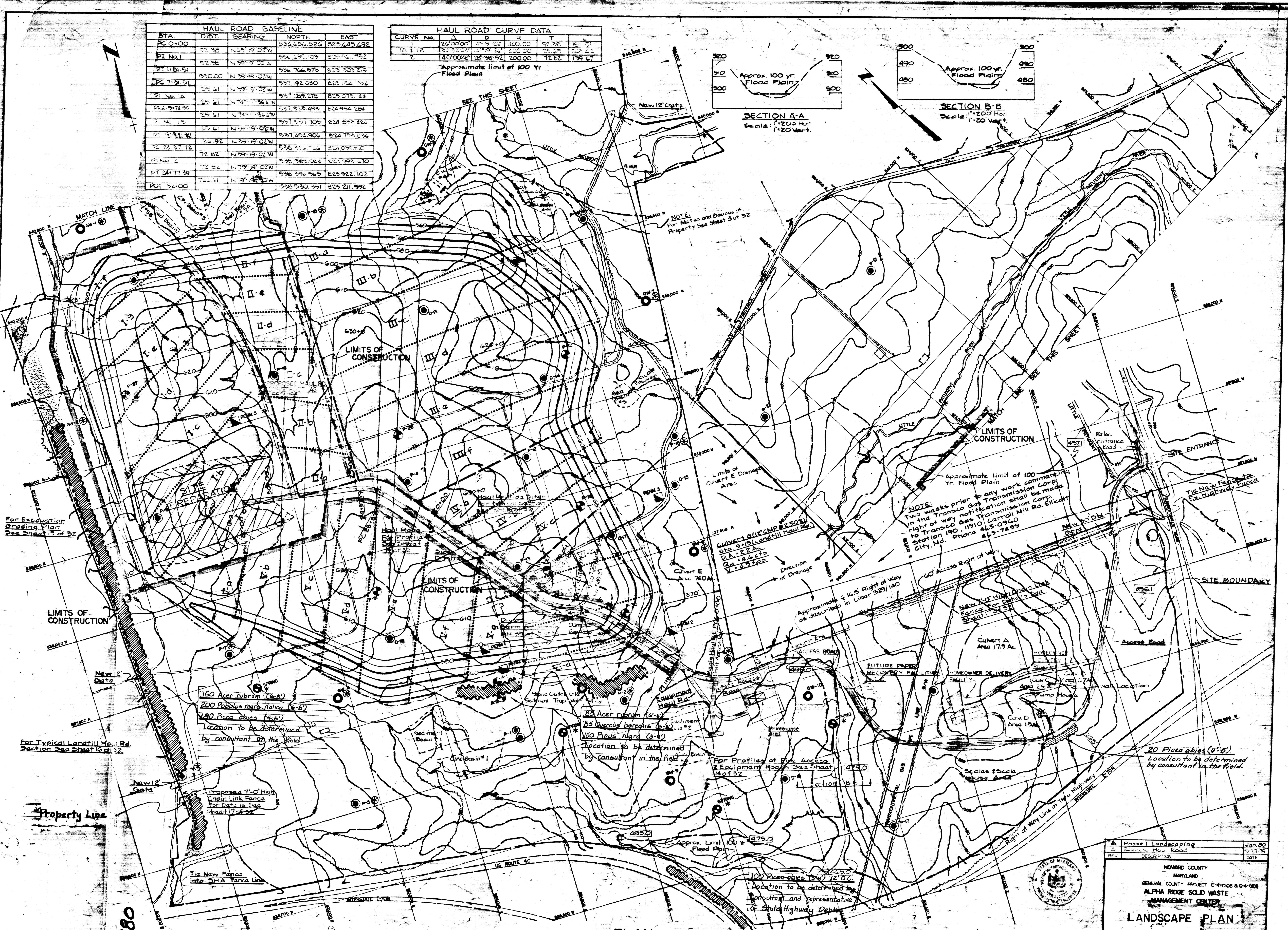
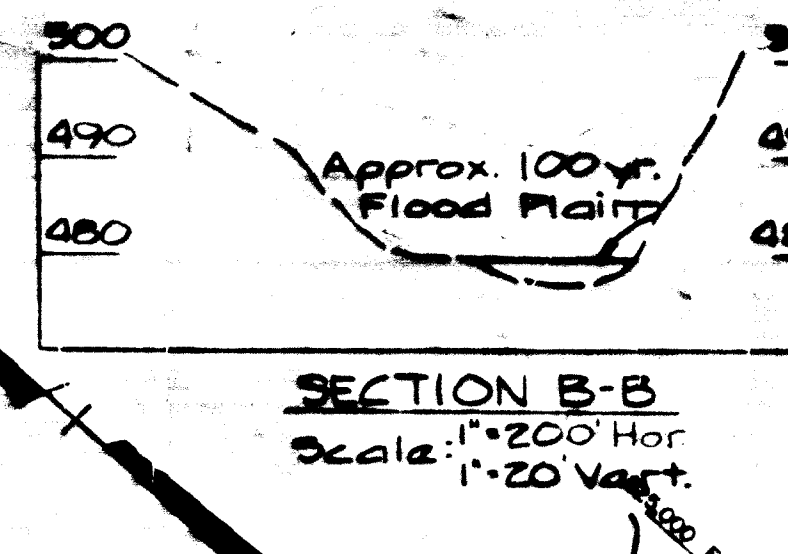
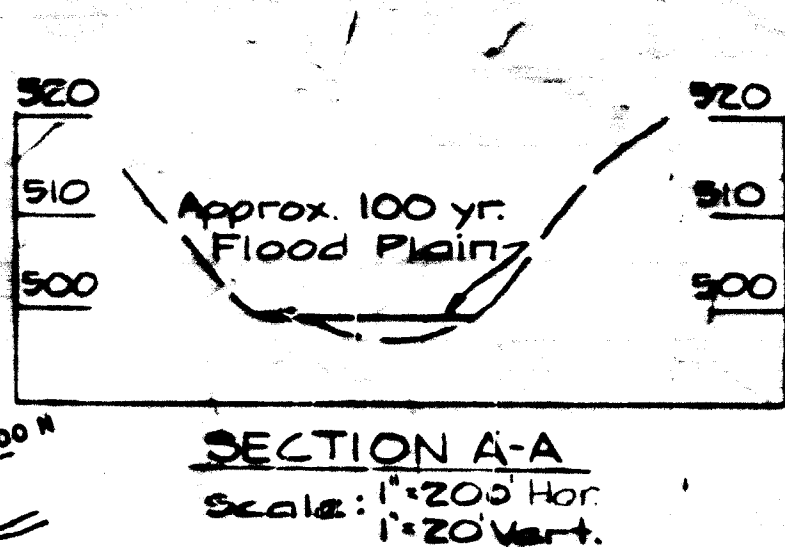

150 Acer rubrum (4-4)
 200 Populus nigra Italica (6-6)
 120 Picea abies (4-5)
 Location to be determined by consultant in the field

85 Acer rubrum (4-4)
 85 Quercus borealis (4-4)
 120 Pinus nigra (3-4)
 Location to be determined by consultant in the field

20 Picea abies (4-5)
 Location to be determined by consultant in the field

PLAN
 SCALE: 1" = 200'

Phase I Landscaping
 HOWARD COUNTY
 MARYLAND
 GENERAL COUNTY PROJECT C-4-008 B-0-008
 ALPHA RIDGE SOLID WASTE
 MANAGEMENT CENTER
 LANDSCAPE PLAN
 SCALE: 1" = 200' HORIZONTAL, 1" = 20' VERTICAL
 DATE: MARCH, 1979