

INLET: Box's do not look like in 11" open in street of Standard open in 6"

RECEIVED
MAR 11 1963
HOWARD COUNTY
PLANNING COMMISSION

- GENERAL NOTES:**
1. All inlets are to be SRC. 5 1/2" H Type Inlets Widths of inlets are to be modified to meet incoming or outgoing pipe
 2. All endwalls are to be SRC. 5 1/2"
 3. Refer to WSSC. 5 1/2" Details for the construction of WSSC. 5 1/2" B Type Manholes.
 4. All slopes shown on storm drain pipes are the minimum required slopes

NOTE: This plan approved by Howard County Road Dept. May 1962

CHIEF ENGINEER OF THE
METROPOLITAN COMMISSION OF HOWARD COUNTY

Sheet No. 1 of 1
EXISTING & UNDER CONSTRUCTION STORM DRAINAGE & PAVING PLAN SECTIONS 8, 9 & 10 ALLVIEW ESTATES HOWARD COUNTY, MARYLAND.

DESIGNED BY R.D.L.	SCALE: 1" = 100'	DATE: May 1962
DRAWN BY Z.H.	GREENHORNE AND O'MARA CIVIL ENGINEERS LAND SURVEYOR 6715 - KENILWORTH AVE. RIVERDALE, MD	
APPROVED BY OWNER Howard County Development Corp. #2 Allview Drive ELlicott City, Md.	JOB NO. 1	FILE NO.

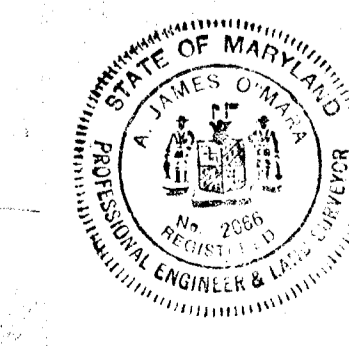

TYPICAL PAVING SECTION
30' & 60' R/W CH PAVING
No. 5. 715

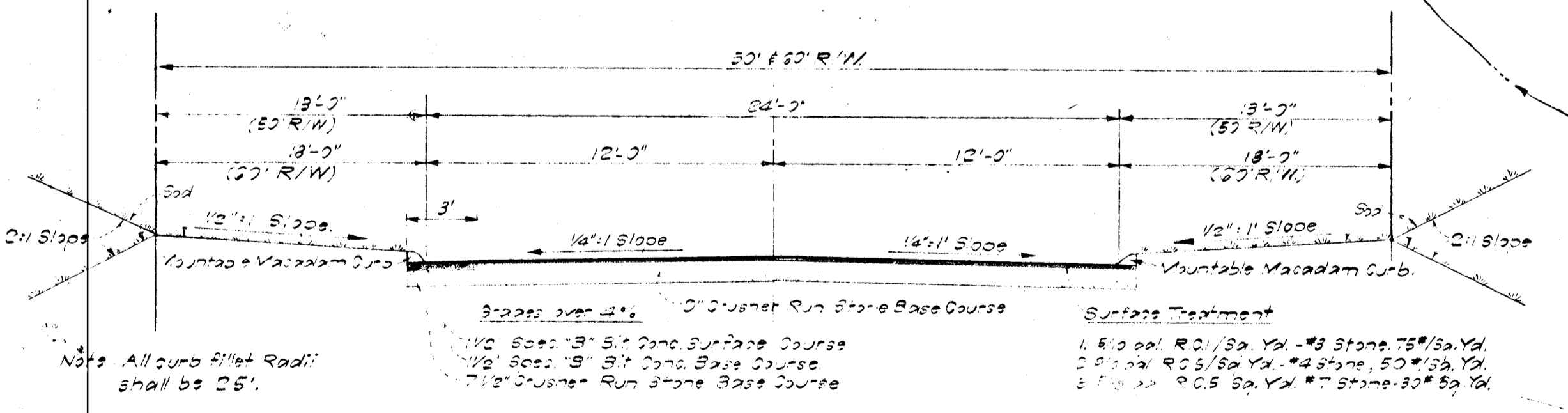

Note: All curb fillet radii shall be 25'

Grades over 4% 12" Crushed Run Stone Base Course
No. 5. 715
Subgrade Treatment
1. 6" 1/2" R.O. / 2" 1/2" 1/2" Stone 15# / 2" 1/2" 1/2" Stone 15# / 2" 1/2" 1/2" Stone 15# / 2" 1/2" 1/2" Stone 15#

DATE _____ BY _____
 SURVEYED _____
 PLAN ALIGNMENT CHECKED _____
 NOTE BOOK NO. _____
 RT. OF WAY CHECKED _____

DATE _____ BY _____
 SURVEYED _____
 PROFILE GRADES CHECKED _____
 NOTE BOOK NO. _____
 STRUCTURE NOTATIONS _____

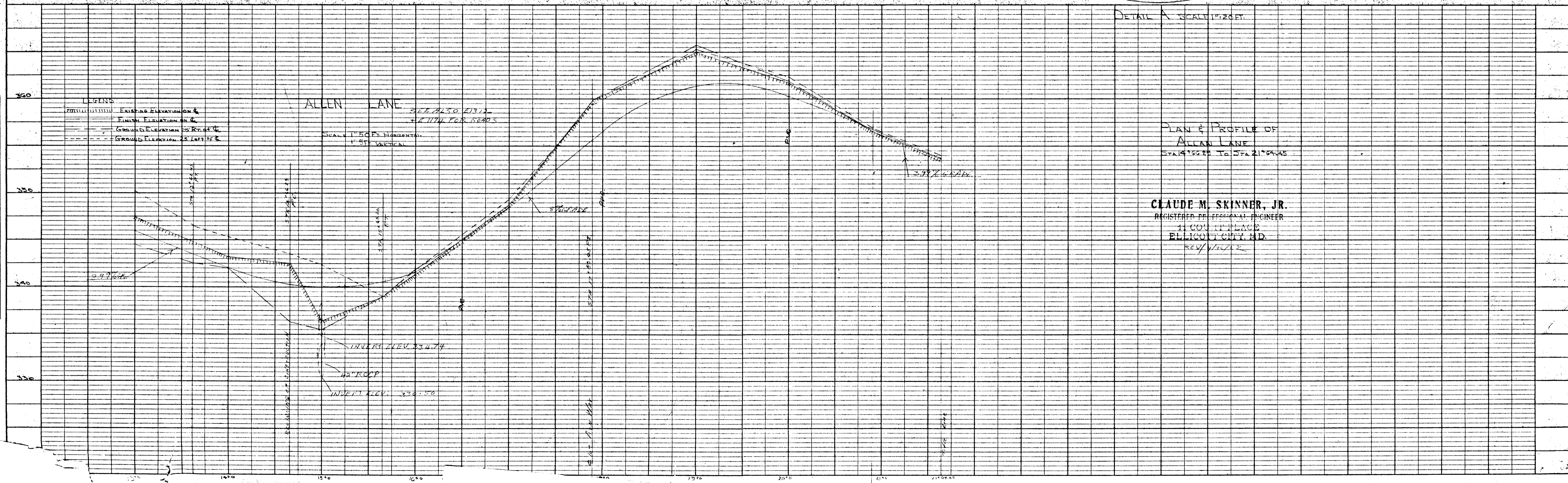
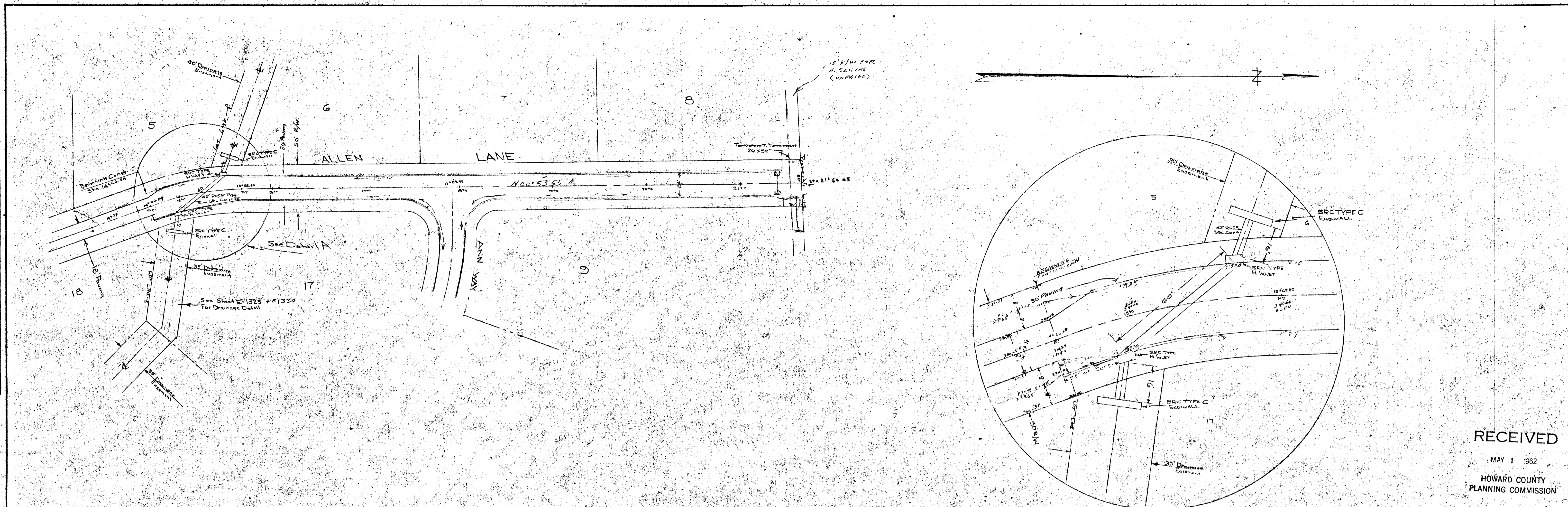

DETAIL A SCALE 1"=20 FT.

PLAN & PROFILE OF ALLEN LANE STA 14+00 TO STA 21+00

CLAUDE M. SKINNER, JR.
 REGISTERED PROFESSIONAL ENGINEER
 11 COURT PLACE
 ELLICOTT CITY, MD.
 REV 1/15/72

RECEIVED
 MAY 1 1962
 HOWARD COUNTY
 PLANNING COMMISSION